

Crown Park Improvements

- Schedule and Process
- Design Revisions
- Cost Update
- Discussion

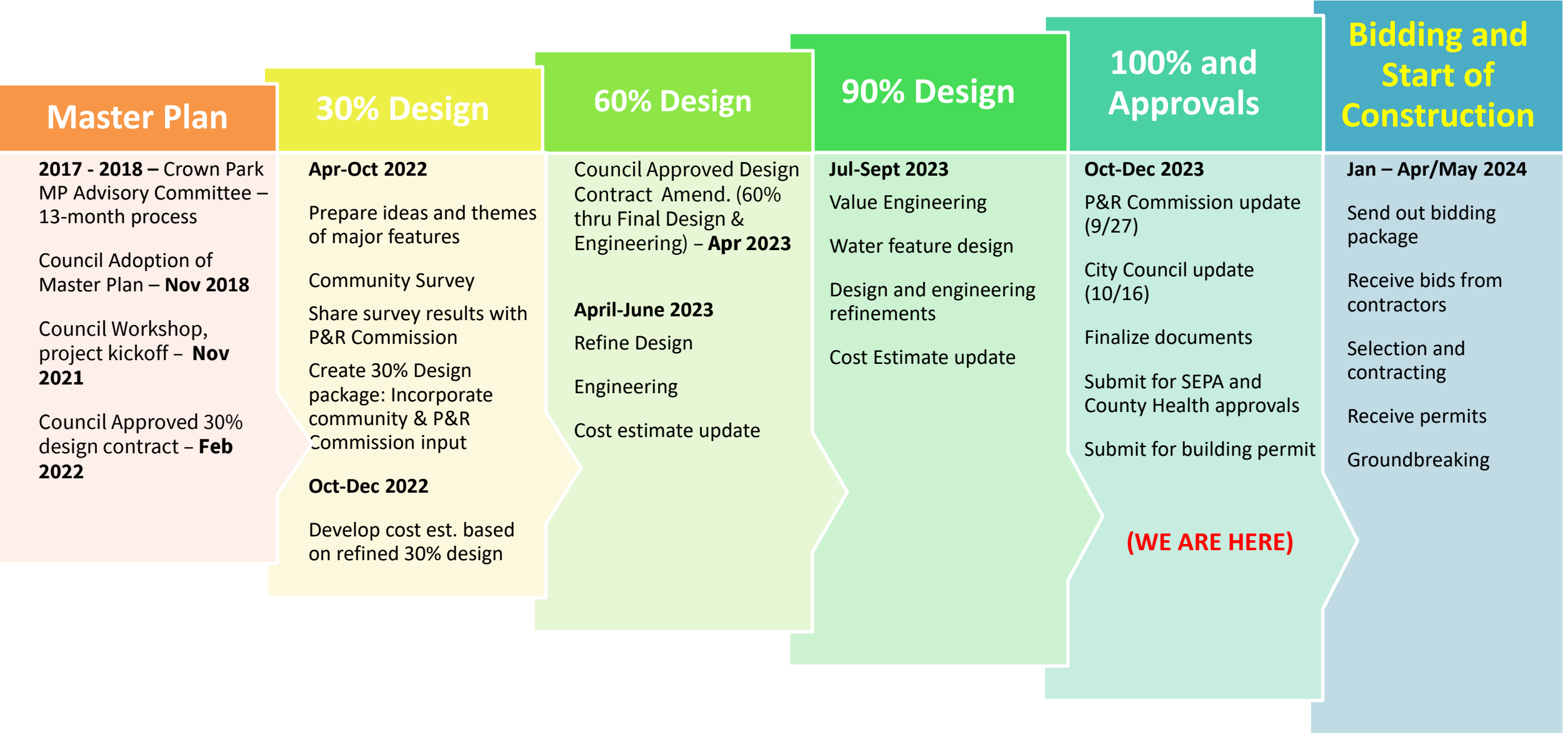

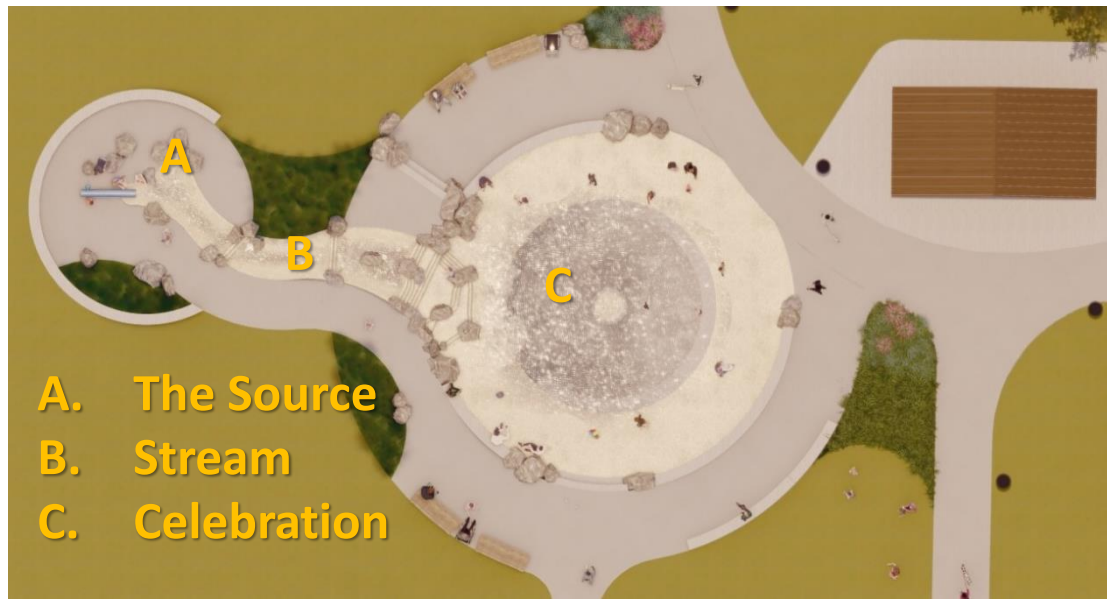



The Source

Celebration

Water Feature Design



Water Feature Design



A: The Weave



B: Water O

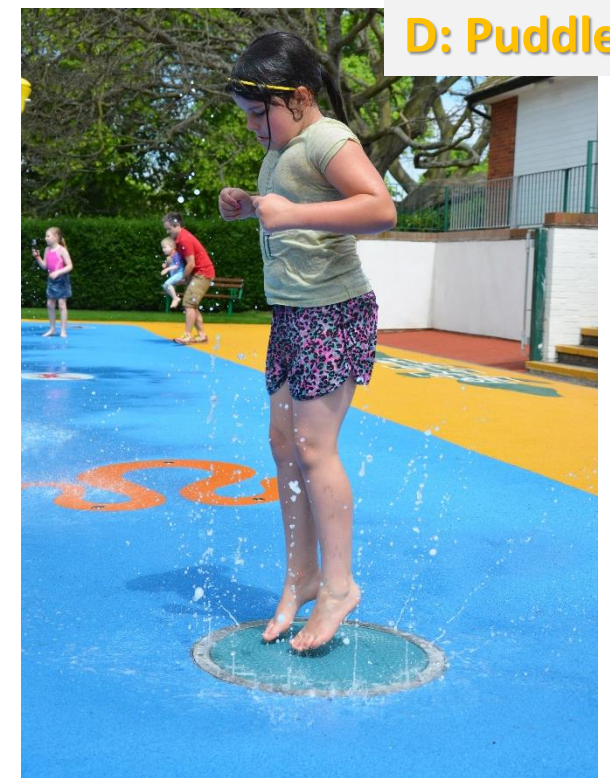

D: Puddle

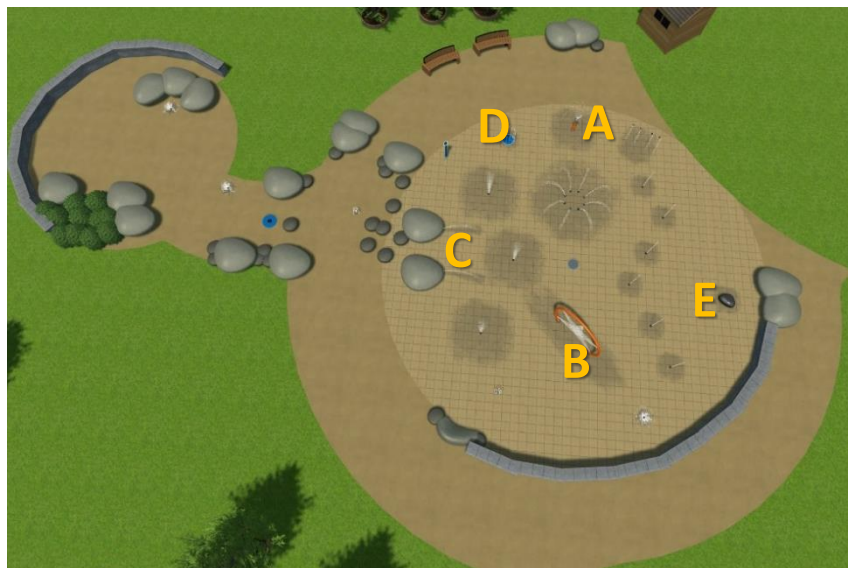

C: The Wave



E: Surf Stone

Water Feature Design



F: Water Tunnel



G: Pop-it



H: Monster-5



I: Misty Mountain



J: Tulip



K: The Doughnut

Water Feature Design

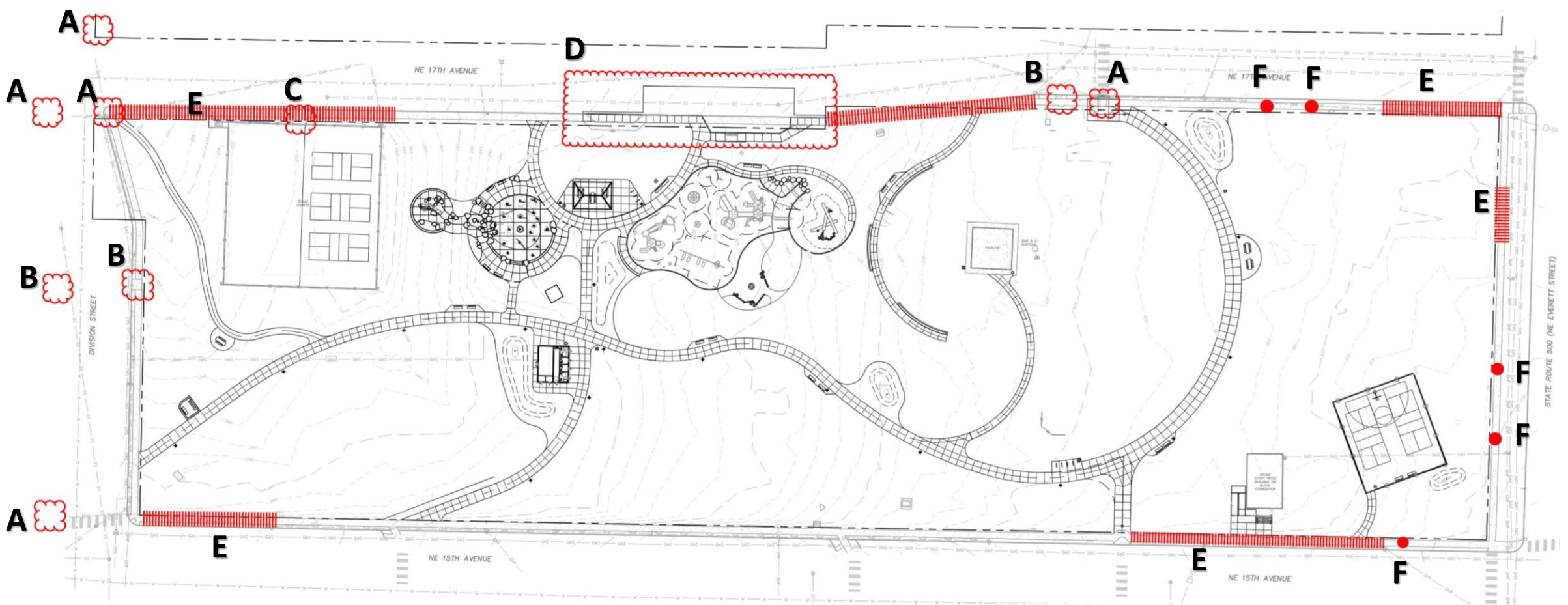

- A. Improve Five (5) ADA Ramps for Compliance.
- B. Remove Three (3) Non-Compliant ADA Ramps.
- C. Improve Maintenance Entrance to Tennis Courts.
- D. Add Angled Parking - Two (2) ADA Stalls - and Improve Sidewalks.
- E. Replace Approximately 800 Linear Feet of sidewalk.
- F. Grind Sidewalk where heaving at Five (5) Locations.

Right-of-Way Improvements

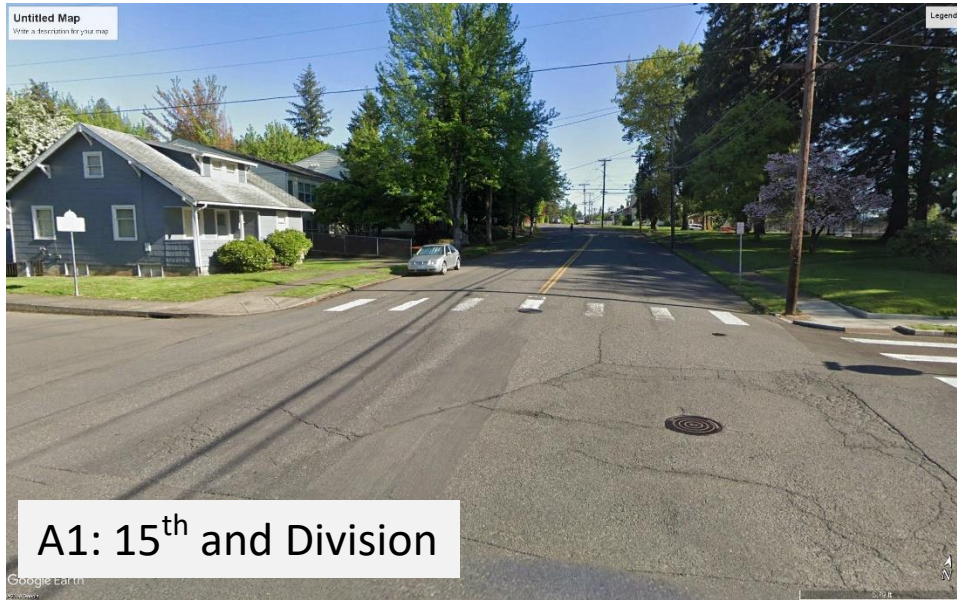

A. Improve ADA Ramps for Compliance.



Right-of-Way Improvements

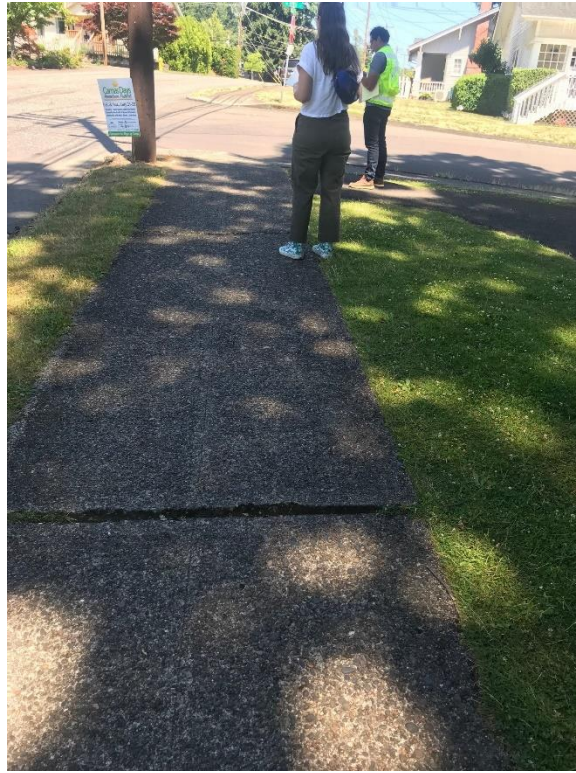

- E. Replace Approximately 800 Linear Feet of sidewalk.
- F. Grind Sidewalk where heaving at Five (5) Locations.

Right-of-Way Improvements

			VE - Item 1	VE - Item 2	VE - Item 3	VE - Item 4	VE - Item 5	VE - Item 6	VE - Item 7	VE - Item 8	VE - Item 9	VE - Item 10	VE - Item 11
	Full Park Master Plan Estimate	Full Park 30% Estimate	Recirculating System	Picnic Shelter	EWf for Turf Surfacing	Reduce Irrigation	Change Path to AC	Remove Sports Court	Remove ROW Improvements	Reduce Plantings by 1/2	Amphitheater	Seed Stormwater Planters	West Half of Park *
HARD COSTS	\$ 4,010,000	\$ 5,412,000	\$ 5,098,000	\$ 5,314,000	\$ 5,133,000	\$ 5,097,000	\$ 5,259,000	\$ 5,318,000	\$ 5,352,000	\$ 5,289,000	\$ 5,340,000	\$ 5,381,000	\$ 4,073,000
Inflation (15%, 10%)	\$ 601,500	\$ 811,800	\$ 764,700	\$ 797,100	\$ 769,950	\$ 764,550	\$ 788,850	\$ 797,700	\$ 802,800	\$ 793,350	\$ 801,000	\$ 807,150	\$ 610,950
Contingency 25% at MP Level 20% at 30pct Level	\$ 1,002,500	\$ 1,082,400	\$ 1,019,600	\$ 1,062,800	\$ 1,026,600	\$ 1,019,400	\$ 1,051,800	\$ 1,063,600	\$ 1,070,400	\$ 1,057,800	\$ 1,068,000	\$ 1,076,200	\$ 814,600
TOTAL HARD COST	\$ 5,614,000	\$ 7,306,200	\$ 6,882,300	\$ 7,173,900	\$ 6,929,550	\$ 6,880,950	\$ 7,099,650	\$ 7,179,300	\$ 7,225,200	\$ 7,140,150	\$ 7,209,000	\$ 7,264,350	\$ 5,498,550
SOFT COSTS	\$ 620,500	\$ 620,500	\$ 620,500	\$ 620,500	\$ 620,500	\$ 620,500	\$ 620,500	\$ 620,500	\$ 620,500	\$ 620,500	\$ 620,500	\$ 620,500	\$ 620,500
TOTAL PROJECT COST	\$ 6,234,500	\$ 7,926,700	\$ 7,502,800	\$ 7,794,400	\$ 7,550,050	\$ 7,501,450	\$ 7,720,150	\$ 7,799,800	\$ 7,845,700	\$ 7,760,650	\$ 7,829,500	\$ 7,884,850	\$ 6,119,050
		Savings:	\$ 423,900	\$ 132,300	\$ 376,650	\$ 425,250	\$ 206,550	\$ 126,900	\$ 81,000	\$ 166,050	\$ 97,200	\$ 41,850	\$ 1,807,650
	Savings Needed	\$ 1,692,200											
	VE Items 1-10												
	Sum	\$ 2,077,650											

* West Half of Park does NOT include recirculating system

30% Design - Value Engineering Options



Design Changes for Cost Savings

1. Reduced planting areas
2. Removed irrigation w/in tree groves, added coupling attachments for hand watering as needed
3. Reduced seat walls, boulders, and logs around playground and amphitheater
4. Removed gravel pathways on the east side of park
5. Simplified storm drainage – reduced piping
6. Moved Owner Furnished items out of contract.

Design Alternate Reductions

- A. Remove picnic shelter structure (\$97,000)
- B. Remove new sports court/pickleball and restripe tennis court (\$141,100)
- C. Remove amphitheater path and seating (\$68,600)

Partnership with Public Works

Rights-of-way and ADA improvements

Design Revisions

Crown Park Improvements - Cost Est.

	Master Plan	30%	60%	90%
Hard Costs	\$4,010,000	\$5,412,000	\$5,650,000	\$3,900,000**
Inflation (15,10,4,3)	\$601,500	\$811,800	\$226,000	\$111,759
Contingency (25,20,15,15)	\$1,002,500	\$1,082,400	\$847,500	\$558,795
Total Hard Costs	\$5,614,00	\$7,306,00	\$6,723,500	\$4,602,000
Soft Costs	\$620,500	\$620,500	\$620,500	\$620,500
Owner Purchased Items	Included Above	Included Above	Included Above	\$1,406,477**
Total Project Costs	\$6,234,500	\$7,926,700	\$7,344,000	\$6,628,977

* Hard Cost Savings at 90% due to \$343,500 in design changes.

**Removing Owner Purchased Items from Contract to eliminate Contractor's % Add-ons.

Design Alternate Reductions – (\$306,700)

- A. Remove picnic shelter structure (\$97,000)
- B. Remove new sports court/pickleball & restripe tennis court (\$141,100)
- C. Remove amphitheater path and seating (\$68,600)

Costs

Crown Park Improvements - Cost Est.

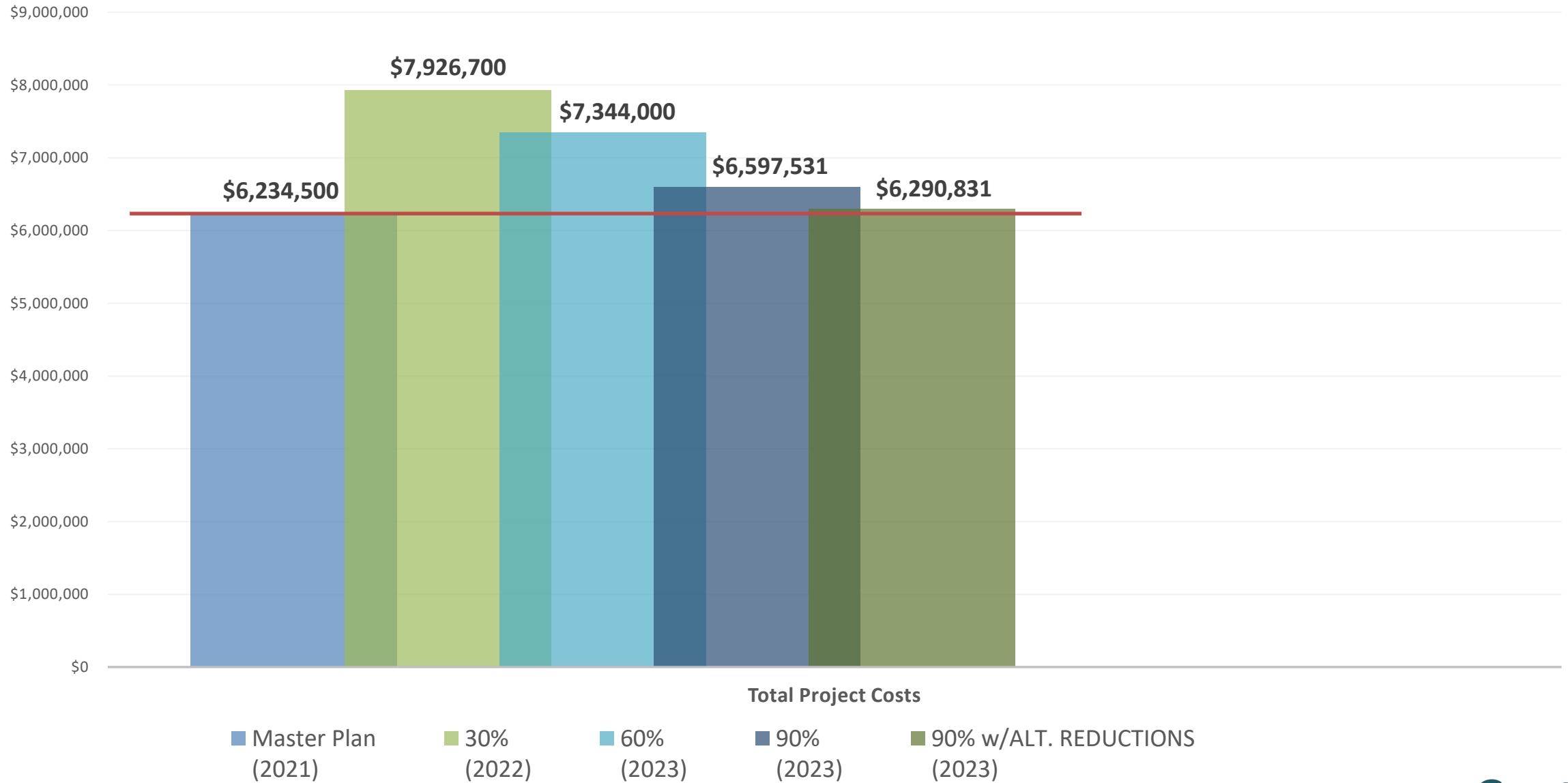



100% and Approvals

Oct-Dec 2023

P&R Commission update (9/27)

City Council update (10/16)

Finalize documents

Submit for SEPA & County Health approvals

Submit for building permit

Bidding and Start of Construction

Jan – Apr/May 2024

Send out bidding package

Receive bids from contractors

Selection and contracting

Receive permits

Groundbreaking

Next Steps



Questions & Feedback

