

**PANCHASARP FARMS
PUBLIC IMPROVEMENT DISTRICT
CITY OF BURLESON, TEXAS**

**ANNUAL SERVICE PLAN UPDATE
(ASSESSMENT YEAR 9/1/23 - 8/31/24)**

**APPROVED BY CITY COUNCIL ON:
AUGUST 21, 2023**

PREPARED BY:

MUNICAP, INC.
— PUBLIC FINANCE —

PANCHASARP FARMS PUBLIC IMPROVEMENT DISTRICT

ANNUAL SERVICE PLAN UPDATE (ASSESSMENT YEAR 9/1/23 – 8/31/24)

TABLE OF CONTENTS

I. INTRODUCTION	1
II. UPDATE OF THE SERVICE PLAN	3
A. UPDATED SOURCES AND USES FOR PUBLIC IMPROVEMENTS	3
B. FIVE YEAR SERVICE PLAN.....	4
C. ANNUAL BUDGET – PHASE #1	6
D. ANNUAL INSTALLMENTS PER UNIT - PHASE #1	9
E. ANNUAL BUDGET – PHASE #2	9
F. ANNUAL INSTALLMENTS PER UNIT - PHASE #2	12
III. UPDATE OF THE ASSESSMENT PLAN	14
IV. UPDATE OF THE ASSESSMENT ROLL	15
A. PARCEL UPDATES.....	15
B. PREPAYMENT OF ASSESSMENTS	16

APPENDIX A - PID MAP

APPENDIX B - PREPAID PARCELS

APPENDIX C - LAND USE CLASS AND EQUIVALENT UNITS

APPENDIX D-1 - PHASE #1 2023-24 ASSESSMENT ROLL - ALL PARCELS

APPENDIX D-2 - PHASE #1 2023-24 ASSESSMENT ROLL SUMMARY - FOR LOTS TRIGGERED IN
2020-21

APPENDIX D-3 - PHASE #1 2023-24 ASSESSMENT ROLL SUMMARY - FOR LOTS TRIGGERED IN
2021-22

APPENDIX D-4 - PHASE #1 2023-24 ASSESSMENT ROLL SUMMARY - FOR LOTS TRIGGERED IN
2022-23

APPENDIX E-1 - PHASE #2 2023-24 ASSESSMENT ROLL - ALL PARCELS

APPENDIX E-2 - PHASE #2 2023-24 ASSESSMENT ROLL SUMMARY - FOR LOTS TRIGGERED IN
2022-23

APPENDIX E-3 - PHASE #2 2023-24 ASSESSMENT ROLL SUMMARY - FOR LOTS TRIGGERED IN
2023-24

APPENDIX F - PID ASSESSMENT NOTICE

I. INTRODUCTION

The Panchasarp Farms Public Improvement District (the “PID”) was created pursuant to Chapter 372, Texas Local Government Code, as amended (the “PID Act”) and Resolution CSO#981-02-2019 of the City Council on February 4, 2019, to finance certain public improvement projects for the benefit of the property in the PID. The City approved the Phase #1 Reimbursement Agreement in the aggregate initial amount of \$377,134 pursuant to a resolution adopted by the City Council on February 3, 2020, to finance, refinance, provide or otherwise assist in the acquisition, construction and maintenance of the public improvements provided for the benefit of the property in the PID. The Phase #1 Reimbursement Agreement amount was updated to \$374,055 based on a new allocation of revised Equivalent Units as shown in Appendix C (the “Phase #1 Reimbursement Agreement”).

A service and assessment plan dated February 3, 2020 (the “Service and Assessment Plan”) was prepared at the direction of the City identifying the public improvements (the “Authorized Improvements”) to be provided by the PID, the costs of the Authorized Improvements, the indebtedness to be incurred for the Authorized Improvements, and the manner of assessing the property in the PID for the costs of the Authorized Improvements. The Service and Assessment Plan was updated for the Phase #2 Reimbursement Agreement in the aggregate principal amount of \$482,718 (the “Phase #2 Reimbursement Agreement”) on March 21, 2022 (the “Updated Service and Assessment Plan”). Pursuant to Chapter 372 of the Texas Local Government Code, as amended (the “PID Act”), the Updated Service and Assessment Plan must be reviewed and updated annually for the purpose of determining the annual budget for the Authorized Improvements. This document is the annual update of the Updated Service and Assessment Plan for 2023-24 (the “Annual Service Plan Update”).

The City also adopted an assessment roll for Phase #1 of the PID and Phase #2 of the PID attached as Appendix F (the “Phase #1 Assessment Roll”) and Appendix G (the “Phase #2 Assessment Roll”), respectively, to the Updated Service and Assessment Plan identifying the assessments on each Parcel of Assessed Property, based on the method of assessment identified in the Updated Service and Assessment Plan. This Annual Service Plan Update also updates the Assessment Roll for 2023-24.

The Texas legislature passed House Bill 1543 as an amendment to the PID Act, requiring, among other things, (i) all Service and Assessment Plans and Annual Service Plan Updates be approved through City ordinance or order to be filed with the county clerk of each county in which all or part of the PID is located within seven days and (ii) include a copy of the notice form required by Section 5.014 of the Texas Property Code (the “PID Assessment Notice”) as disclosure of the obligation to pay PID Assessments. In light of these amendments to the PID Act, this Annual Service Plan Update includes a copy of the PID Assessment Notice as Appendix F and copy of this Annual Service Plan Update will be filed with the county clerk in each county in which all or a part of the PID is located not later than seven (7) days after the date the governing body of the City approves this Annual Service Plan Update.

Section 372.013 of the PID Act, as amended, stipulates that a person who proposes to sell or otherwise convey real property that is located in the PID, except in certain situation described in the PID Act, shall first give to the purchaser of the property a copy of the completed PID

Assessment Notice. The PID Assessment Notice shall be given to a prospective purchaser before the execution of a binding contract of purchase and sale, either separately or as an addendum or paragraph of a purchase contract. In the event a contract of purchase and sale is entered into without the seller provided the required notice, the purchaser, subject to certain exceptions described in the PID act, is entitled to terminate the contract.

The PID Assessment Notice shall be executed by the seller and must be filed in the real property records of the County in which the property is located at the closing of the purchase and sale of the property.

Capitalized terms shall have the meanings set forth in the Updated Service and Assessment Plan unless otherwise defined herein.

(remainder of this page is intentionally left blank)

II. UPDATE OF THE SERVICE PLAN

A. UPDATED SOURCES AND USES FOR PUBLIC IMPROVEMENTS

Pursuant to the Updated Service and Assessment Plan adopted by City Council, the initial total estimated costs of the Authorized Improvements were equal to \$2,931,839. According to the Updated Service and Assessment Plan, the costs spent as of March 21, 2022 for the Authorized Improvements were equal to \$699,955.

The Actual Costs of the portion of the Authorized Improvements to be financed in each Phase shall be allocated to the Assessed Property by spreading the entire Assessment across the Parcels based on the estimated Equivalent Units shown in Table II-A below.

Table II-A
Allocated Costs of Authorized Improvements per Phase

Phase	Original Estimated EU	Revised Estimated EU²	Percentage Allocation	Proportionate Share of Costs
Phase #1	82.25	81.48	12.76%	\$374,055
Phase #2	105.15	105.15	16.46%	\$482,718
Future Phases	452.01	452.01	70.78%	\$2,075,067
Total	639.41	638.64	100.00%	\$2,931,839

1- The numbers in this and subsequent tables are in some cases shown rounded to the nearest dollar; however, the calculations are made to the cent.

2- The Equivalent Units used to determine the Assessments for each Phase. The Equivalent Units reported for Phase #1 and Phase #2 are the final values.

Sources and Uses - Total

Table II-B on the following page summarizes the updated sources and uses of funds required to (i) construct all of the Authorized Improvements within the PID and (ii) establish the PID. See Table II-A above for the allocation percentage based on Phase.

(remainder of this page is intentionally left blank)

Table II-B
Sources and Uses of Funds – Total¹

Sources of Funds	Original Budget	Budget Revisions²	Revised Budget	Spent to Date¹	Remaining Balance²
Phase #1 Reimbursement Agreement	\$374,055	\$0	\$374,055	\$374,055	\$0
Phase #2 Reimbursement Agreement	\$482,718	\$0	\$482,718	\$325,900	\$156,817
Future Phase Reimbursement Agreement	\$2,075,067	\$0	\$2,075,067	\$0	\$2,075,067
Other funding sources	\$0	\$0	\$0	\$0	\$0
Total Sources	\$2,931,839	\$0	\$2,931,839	\$699,955	\$2,231,884
Uses of Funds					
<i>Authorized Improvements</i>					
Grading improvements	\$43,200	\$100,000	\$143,200	\$125,121	\$18,079
Irrigation improvements	\$316,310	\$0	\$316,310	\$96,754	\$219,556
Landscaping improvements	\$960,004	\$0	\$960,004	\$205,034	\$754,970
Site furnishings improvements	\$177,200	\$0	\$177,200	\$0	\$177,200
Site elements improvements	\$447,954	\$0	\$447,954	\$70,518	\$377,436
Playground improvements	\$517,812	\$0	\$517,812	\$73,585	\$444,227
Other soft costs including PID creation costs	\$469,359	(\$100,000)	\$369,359	\$128,943	\$240,416
Total Uses	\$2,931,839	\$0	\$2,931,839	\$699,955	\$2,231,884

1- The numbers in this and subsequent tables are in some cases shown rounded to the nearest dollar; however, the calculations are made to the cent.

2 - According to the Updated Service and Assessment Plan dated March 21, 2022. Current costs spent for the Authorized Improvements will be provided by the Developer and included in the Service and Assessment Plan updated for the Phase #3 levy.

Total Authorized Improvement Cost Variances

As shown in Table II-B above, there are no significant variances of the Authorized Improvement costs.

B. FIVE YEAR SERVICE PLAN

According to the PID Act, a service plan must cover a period of five years. Based upon the actual budget for the Authorized Improvements, the Annual Installments expected to be collected during the next five years is shown in Tables II-C-1 and II-C-2 on the following page.

(remainder of this page is intentionally left blank)

Table II-C-1
Annual Projected Indebtedness & Projected Annual Installments – Phase #1

Assessment Year Ending 09/01¹	Annual Projected Costs	Annual Projected Indebtedness	Phase #1 Projected Annual Installments^{2,3}
2021-2023	\$374,055	\$374,055	\$137,528
2024	\$0	\$0	\$57,047
2025	\$0	\$0	\$58,857
2026	\$0	\$0	\$59,121
2027	\$0	\$0	\$59,295
2028	\$0	\$0	\$59,536
2029	\$0	\$0	\$59,688
Total	\$374,055	\$374,055	\$491,072

1 - Projected Annual Installments for Assessment Years ending 2021-24 represent actual amounts billed and include applicable credits. Assessment Years ending 2025-2029 represent projected amounts and will be updated in future Annual Service Plan Updates.

2 - Represents the Annual Installments billed for Phase #1 Lots triggered as of May 31, 2023.

3 - Refer to Section C of this report for additional information regarding Phase #1's annual budget and Annual Installments.

4 - The numbers in this and subsequent tables are in some cases shown rounded to the nearest dollar; however, the calculations are made to the cent.

Table II-C-2
Annual Projected Indebtedness & Projected Annual Installments – Phase #2

Assessment Year Ending 09/01¹	Annual Projected Costs	Annual Projected Indebtedness	Phase #2 Projected Annual Installments^{2,3}
2022-2023	\$482,718	\$482,718	\$32,856
2024	\$0	\$0	\$41,186
2025	\$0	\$0	\$72,722
2026	\$0	\$0	\$72,664
2027	\$0	\$0	\$73,435
2028	\$0	\$0	\$73,353
2029	\$0	\$0	\$74,101
Total	\$482,718	\$482,718	\$440,317

1 - Projected Annual Installments for Assessment Years ending 2022-24 represent actual amounts billed and include applicable credits. Assessment Years ending 2025-2029 represent projected amounts and will be updated in future Annual Service Plan Updates.

2 - Represents the Annual Installments billed for Phase #2 Lots triggered as of May 31, 2023.

3 - Refer to Section E of this report for additional information regarding Phase #2's annual budget and Annual Installments.

4 - The numbers in this and subsequent tables are in some cases shown rounded to the nearest dollar; however, the calculations are made to the cent.

(remainder of this page is intentionally left blank)

C. ANNUAL BUDGET – PHASE #1

Phase #1 - Annual Installments

The Assessment imposed on any Parcel may be paid in full at any time. If not paid in full, the Assessment shall be payable in thirty (30) Annual Installments of principal and interest beginning with the tax year following the issuance of the Phase #1 Reimbursement Agreement. The collection of the first Annual Installment for a Phase #1 Lot or Parcel shall commence upon the earlier of: (i) with tax bills sent the first October following the issuance of the first building permit for each Lot within each Phase, such that Assessments are billed only for Lots for which a building permit has been issued, (ii) with tax bills sent the first October after issuance of a series of Phased PID Bonds for Phase #1 Assessed Property, such that upon the issuance of PID Bonds, all Assessments in the applicable Phase shall begin collection, or (iii) with tax bills sent the first October occurring after the expiration of two years from the date of the levy of Assessments on the Phase #1 Assessed Property, such that all Assessments in the applicable Phase begin collection immediately after the expiration of such two year period. Such first Annual Installment for a Phase #1 Lot or Parcel for which collection has begun, shall be due by January 31st of the following calendar year.

Table II-D below shows the amount of Assessments applicable to all Phase #1 Lots triggered as of June 30, 2022. As of June 30, 2022, the Assessment for all Phase #1 lots had been triggered.

Table II-D
Assessments on Phase #1 Lots with Building Permits as of June 30, 2023¹

Trigger Period	Annual Installment Condition Trigger	Number of Lots	Total EU	Total Assessments²
2020-21	Condition (i)	41	34.14	\$156,728.33
2021-22	Condition (i)	55	45.62	\$209,430.19
2022-23	Condition (iii)	2	1.72	\$7,896.10
Total		98	81.48	\$374,054.62

1 – Number of Lots represents the issuance of building permits according to the City.

2 – See various Assessment Rolls for the current total outstanding Assessment balances.

3 – The numbers in this and subsequent tables are in some cases shown rounded to the nearest dollar; however, the calculations are made to the cent.

Pursuant to the Updated Service and Assessment Plan, each Assessment shall bear interest at the rate on the Phase #1 Reimbursement Agreement commencing with the issuance of the Phase #1 Reimbursement Agreement. The effective interest rate of the Phase #1 Reimbursement Agreement interest payments is 5.10 percent per annum for 2023-24. Pursuant to Section 372.018 of the PID Act, the interest rate for that Assessment may not exceed a rate that is one-half of one percent higher than the actual interest rate paid on the debt. These payments, the Annual Installments of the Assessments, shall be billed by the City in 2023 and will be delinquent on February 1, 2024.

Pursuant to the Updated Service and Assessment Plan, the Annual Service Plan Update will show the remaining balance of the Assessments, the Annual Installment due for 2023-24 and the administrative expenses to be collected from each Parcel. Annual administrative expenses shall be allocated to each Parcel pro rata based on the Annual Installment on a Parcel to the total Annual Installments in the PID that are payable at the time of such allocation. Each Annual Installment

shall be reduced by any credits applied under applicable documents including the Updated Service and Assessment Plan, such as capitalized interest and interest earnings on any account balances and by any other funds available to the PID.

Annual Budgets for the Repayment of Indebtedness

Debt service proportionately allocated to each Lot where a building permit was issued will be paid on the Phase #1 Reimbursement Agreement from the collection of the Annual Installments. In addition, Annual Collection Costs are to be collected with the Annual Installments to pay expenses related to the collection of the Annual Installments.

Phase #1 Annual Installments to be collected for 2023-24

The proportional Phase #1 budget for the PID will be paid from the collection of Annual Installments collected for 2023-24 as shown in Table II-E below.

Table II-E
Budget for the Phase #1 Annual Installments
to be Collected for 2023-24

Descriptions	Budget for all Lots Based on Trigger Period			Total
	2020-21	2021-22	2022-23	
Interest payment on or after March 1, 2024	\$3,414	\$4,690	\$198	\$8,302
Interest payment on or after September 1, 2024	\$3,414	\$4,690	\$198	\$8,302
Principal payment on September 1, 2024	\$2,673	\$3,572	\$121	\$6,366
<i>Subtotal debt service on R.A.</i>	<i>\$9,502</i>	<i>\$12,951</i>	<i>\$518</i>	<i>\$22,970</i>
Administrative Expenses	\$5,106	\$6,822	\$257	\$12,185
Maintenance Assessment	\$9,173	\$12,257	\$462	\$21,892
<i>Subtotal Expenses</i>	<i>\$23,780</i>	<i>\$32,030</i>	<i>\$1,237</i>	<i>\$57,047</i>
Available Administrative Expense account	\$0	\$0	\$0	\$0
<i>Subtotal funds available</i>	<i>\$0</i>	<i>\$0</i>	<i>\$0</i>	<i>\$0</i>
Annual Installments	\$23,780	\$32,030	\$1,237	\$57,047

Debt Service Payments

Table II- F on the following page shows the Annual Installments to be collected for principal and interest based on the outstanding Assessment balance for each trigger period and the effective interest rate of 5.10 percent.

(remainder of this page is intentionally left blank)

Table II-F
Principal and Interest to be Collected for 2023-24

Lots in Trigger Period	Outstanding Assessment Balance	Principal Due	Effective Interest Rate	3/1 Interest Due	9/1 Interest Due	Annual Installments to be Collected for P&I
2020-21	\$133,898	\$2,673	5.10%	\$3,414	\$3,414	\$9,502
2021-22	\$183,904	\$3,572	5.10%	\$4,690	\$4,690	\$12,951
2022-23	\$7,775	\$121	5.10%	\$198	\$198	\$518
Total	\$325,577	\$6,366		\$8,302	\$8,302	\$22,970

1- The numbers in this and subsequent tables are in some cases shown rounded to the nearest dollar; however, the calculations are made to the cent.

Administrative Expenses

The Phase #1 proportional annual administrative expenses include the City, Administrator, and contingency fees for 2023-24 and are shown in Table II-G below.

Table II-G
Administrative Budget Breakdown

Lots in Trigger Period	2023-24 Estimated Budget
2020-21	\$5,106
2021-22	\$6,822
2022-23	\$257
Total	\$12,185

Maintenance Expenses

The Phase #1 proportional annual maintenance expenses to be proportionally collected for 2023-24 is shown below in Table II-H.

Table II-H
Maintenance Budget Breakdown¹

Lots in Trigger Period	2023-24 Estimated Budget
2020-21	\$9,173
2021-22	\$12,257
2022-23	\$462
Total	\$21,892

1- See Table II-D for a breakdown of the number of lots triggered within each period. The proportional annual maintenance expenses to be collected for 2023-24 are estimated to be \$269 per Lot.

2 - Pursuant to the Updated Service and Assessment Plan, Lots with prepaid Assessments will continue to pay a proportionate share of the total Maintenance Expense.

Available Administrative Expense Account

There are no available administrative expense funds to reduce the 2023-24 Annual Installment.

D. ANNUAL INSTALLMENTS PER UNIT - PHASE #1

According to the Updated Service and Assessment Plan, the Annual Installments shall be collected in an amount sufficient to pay (i) principal and interest on the Phase #1 Reimbursement Agreement and (ii) to cover Administrative Expenses of the PID.

According to the Developer, ninety-eight (98) units, representing 81.48 Equivalent Units, were anticipated to be built within Phase #1 of the PID. See Table II-A of this report for the trigger period breakdown of the ninety-eight (98) in Phase #1. Additionally, six (6) 60 ft Lots and three (3) 55 ft Lots have prepaid their Assessments in full as of May 31, 2023, resulting in a current outstanding Equivalent Unit balance for Phase#1 Lots of 73.95 (81.48 - 7.53 = 73.95).

The Annual Installment to be collected from each Parcel within Phase #1 of the PID, excluding prepaid Parcels, is calculated by multiplying the Annual Installment for each unit shown in Table II-I below by the total estimated Equivalent Units for each Parcel in the PID.

Table II-I
Annual Installment Per Equivalent Unit – Phase #1

Lots in Trigger Period	Principal	Interest	Administrative Expense	Maintenance Expense¹	Annual Installment
2020-21	\$86.87	\$221.93	\$165.93	\$268.68	\$743.40
2021-22	\$86.15	\$226.22	\$164.56	\$268.68	\$745.60
2022-23	\$70.46	\$230.53	\$149.55	\$268.68	\$719.22

1 – According to the Updated Service and Assessment Plan, all prepaid Lots are only obligated to pay the Maintenance Assessment expense upon full prepayment of PID Assessment.

The list of Parcels within Phase #1 of the PID, the corresponding lot types of the Parcels, the corresponding total Equivalent Units, the total outstanding Assessment, the annual principal and interest, the Administrative Expenses, Maintenance Expenses and the Annual Installment to be collected for 2023-24 are shown in the Assessment Roll Summaries attached hereto as Appendices D-1, D-2, D-3 and D-4.

E. ANNUAL BUDGET – PHASE #2

Phase #2 - Annual Installments

The Assessment imposed on any Parcel may be paid in full at any time. If not paid in full, the Assessment shall be payable in thirty (30) Annual Installments of principal and interest beginning with the tax year following the issuance of the Phase #2 Reimbursement Agreement. The collection of the first Annual Installment for a Phase #2 Lot or Parcel shall commence upon the earlier of: (i) with tax bills sent the first October following the issuance of the first building permit for each Lot within each Phase, such that Assessments are billed only for Lots for which a building permit has been issued, (ii) with tax bills sent the first October after issuance of a series of Phased PID Bonds for Phase #2 Assessed Property, such that upon the issuance of PID Bonds, all Assessments in the

applicable Phase shall begin collection, or (iii) with tax bills sent the first October occurring after the expiration of two years from the date of the levy of Assessments on the Phase #2 Assessed Property, such that all Assessments in the applicable Phase begin collection immediately after the expiration of such two year period. Such first Annual Installment for a Phase #2 Lot or Parcel for which collection has begun, shall be due by January 31st of the following calendar year.

Table II-J below shows the amount of Assessments applicable to the Phase #2 Lots triggered as of June 30, 2023.

Table II-J
Assessments on Phase #2 Lots with Building Permits as of June 30, 2023¹

Trigger Period	Annual Installment Condition Trigger	Number of Lots	Total EU	Total Assessments²
2022-23	Condition (i)	59	48.01	\$220,402.09
2023-24	Condition (i)	18	14.50	\$66,565.93
Total		77	62.51	\$286,968.02

1 – Number of Lots represents the issuance of building permits according to the City.

2 – See various Assessment Rolls for the current total outstanding Assessment balances.

3 – The numbers in this and subsequent tables are in some cases shown rounded to the nearest dollar; however, the calculations are made to the cent.

Pursuant to the Updated Service and Assessment Plan, each Assessment shall bear interest at the rate on the Phase #2 Reimbursement Agreement commencing with the issuance of the Phase #2 Reimbursement Agreement. The effective interest rate of the Phase #2 Reimbursement Agreement interest payments is 4.45 percent per annum for 2023-24. Pursuant to Section 372.018 of the PID Act, the interest rate for that Assessment may not exceed a rate that is one-half of one percent higher than the actual interest rate paid on the debt. These payments, the Annual Installments of the Assessments, shall be billed by the City in 2023 and will be delinquent on February 1, 2024.

Pursuant to the Updated Service and Assessment Plan, the Annual Service Plan Update will show the remaining balance of the Assessments, the Annual Installment due for 2023-24 and the administrative expenses to be collected from each Parcel. Annual administrative expenses shall be allocated to each Parcel pro rata based on the Annual Installment on a Parcel to the total Annual Installments in the PID that are payable at the time of such allocation. Each Annual Installment shall be reduced by any credits applied under applicable documents including the Updated Service and Assessment Plan, such as capitalized interest and interest earnings on any account balances and by any other funds available to the PID.

Annual Budgets for the Repayment of Indebtedness

Debt service proportionately allocated to each Lot where a building permit was issued will be paid on the Phase #2 Reimbursement Agreement from the collection of the Annual Installments. In addition, Annual Collection Costs are to be collected with the Annual Installments to pay expenses related to the collection of the Annual Installments.

Phase #2 Annual Installments to be collected for 2023-24

The proportional Phase #2 budget for the PID will be paid from the collection of Annual Installments collected for 2023-24 as shown in Table II-K below.

Table II-K
Budget for the Phase #2 Annual Installments
to be Collected for 2023-24

Descriptions	Budget for Lots Based on Trigger Period		TOTAL
	2022-23	2023-24	
Interest payment on or after March 1, 2024	\$4,242	\$1,481	\$5,723
Interest payment on or after September 1, 2024	\$4,242	\$1,481	\$5,723
Principal payment on September 1, 2024	\$2,978	\$1,022	\$4,000
<i>Subtotal debt service on R.A.</i>	<i>\$11,463</i>	<i>\$3,984</i>	<i>\$15,447</i>
Administrative Expenses	\$6,901	\$2,043	\$8,945
Maintenance Assessment	\$12,899	\$3,896	\$16,795
<i>Subtotal Expenses</i>	<i>\$31,263</i>	<i>\$9,923</i>	<i>\$41,186</i>
Available Administrative Expense account	\$0	\$0	\$0
<i>Subtotal funds available</i>	<i>\$0</i>	<i>\$0</i>	<i>\$0</i>
Annual Installments	\$31,263	\$9,923	\$41,186

1- The numbers in this and subsequent tables are in some cases shown rounded to the nearest dollar; however, the calculations are made to the cent.

Debt Service Payments

Table II-L below shows the Annual Installments to be collected for principal and interest based on the outstanding Assessment balance for each trigger period and the effective interest rate of 4.45 percent.

Table II-L
Principal and Interest to be Collected for 2023-24

Lots in Trigger Period	Outstanding Assessment Balance	Principal Due	Effective Interest Rate	3/1 Interest Due	9/1 Interest Due	Annual Installments to be Collected for P&I
2022-23	\$190,668	\$2,978	4.45%	\$4,242	\$4,242	\$11,463
2023-24	\$66,566	\$1,022	4.45%	\$1,481	\$1,481	\$3,984
Total	\$257,234	\$4,000		\$5,723	\$5,723	\$15,447

Administrative Expenses

The Phase #2 proportional annual administrative expenses include the City, Administrator, and contingency fees for 2023-24 and are shown in Table II-M on the following page.

Table II-M
Administrative Budget Breakdown

Lots in Trigger Period	2023-24 Estimated Budget
2022-23	\$6,901
2023-24	\$2,043
Total	\$8,945

1- The numbers in this and subsequent tables are in some cases shown rounded to the nearest dollar; however, the calculations are made to the cent.

Maintenance Expenses

The Phase #2 proportional annual maintenance expenses to be proportionally collected for 2023-24 is shown below in Table II-N.

Table II-N
Maintenance Budget Breakdown

Lots in Trigger Period	2023-24 Estimated Budget
2022-23	\$12,899
2023-24	\$3,896
Total	\$16,795

1- See Table II-J for a breakdown of the number of lots triggered within each period. The proportional annual maintenance expenses to be collected for 2023-24 are estimated to be \$269 per Lot.

2 - Pursuant to the Updated Service and Assessment Plan, Lots with prepaid Assessments will continue to pay a proportionate share of the total Maintenance Expense.

Available Administrative Expense Account

There are no available administrative expense funds to reduce the 2023-24 Annual Installment.

F. ANNUAL INSTALLMENTS PER UNIT - PHASE #2

According to the Updated Service and Assessment Plan, the Annual Installments shall be collected in an amount sufficient to pay (i) principal and interest on the Phase #2 Reimbursement Agreement and (ii) to cover Administrative Expenses of the PID.

According to the Developer, one-hundred thirty (130) units, representing 105.15 Equivalent Units, are anticipated to be built within Phase #2 of the PID. As of June 30, 2023, seventy-seven Phase #2 Lots have been triggered for Annual Installment collection, representing 56.77 Equivalent Units. See Table II-J of this report for the trigger period breakdown of the lots triggered in Phase #2. Additionally, three (3) 60 ft Lots and four (4) 55 ft Lots have prepaid their Assessments in full as of June 30, 2023, resulting in a current outstanding Equivalent Unit balance for Phase #2 Lots of 99.41 (105.15 - 5.74 = 99.41).

The Annual Installment to be collected from each Parcel within Phase #2 of the PID, excluding prepaid Parcels, is calculated by multiplying the Annual Installment for each unit shown in Table II-O below by the total estimated Equivalent Units for each Parcel in the PID.

Table II-O
Annual Installment Per EU – Phase #2

Lots in Trigger Period	Principal	Interest	Administrative Expense	Maintenance Expense	Annual Installment
2022-23	\$70.46	\$200.73	\$163.26	\$268.68	\$703.13
2023-24	\$70.46	\$204.29	\$140.92	\$268.68	\$684.35

The list of Parcels within Phase #2 of the PID, the corresponding lot types of the Parcels, the corresponding total Equivalent Units, the total outstanding Assessment, the annual principal and interest, the Administrative Expenses, Maintenance Expenses and the Annual Installment to be collected for 2023-24 are shown in the Assessment Roll Summaries attached hereto as Appendices E-1, E-2 and E-3.

(remainder of this page is intentionally left blank)

III. UPDATE OF THE ASSESSMENT PLAN

The Updated Service and Assessment Plan adopted by the City Council describes that the Authorized Improvement costs shall be allocated to the Assessed Property equally based on the equivalent number of residential dwelling units anticipated to be built on each Parcel once such property is fully developed, and that such method of allocation will result in the imposition of equal shares of the Authorized Improvement costs to Parcels similarly benefited.

Pursuant to Section VI.G of the Updated Service and Assessment Plan, “The collection of the first Annual Installment for a Phase #1 Lot or Parcel shall commence upon the earlier of: (i) with tax bills sent the first October following the issuance of the first building permit for each Lot within each Phase, such that Assessments are billed only for Lots for which a building permit has been issued, (ii) with tax bills sent the first October after issuance of a series of Bonds for Phase #1 Assessed Property, such that upon the issuance of Bonds, all Assessments in the applicable Phase shall begin collection, or (iii) with tax bills sent the first October occurring after the expiration of two years from the date of the levy of Assessments on the Phase #1 Assessed Property, such that all Assessments in the applicable Phase begin collection immediately after the expiration of such two year period. Such first Annual Installment for a Phase #1 Lot or Parcel for which collection has begun, shall be due by January 31st of the following calendar year.”

Pursuant to Section VI.G of the Updated Service and Assessment Plan, “The collection of the first Annual Installment for a Phase #2 Lot or Parcel shall commence upon the earlier of: (i) with tax bills sent the first October following the issuance of the first building permit for each Lot within each Phase, such that Assessments are billed only for Lots for which a building permit has been issued, (ii) with tax bills sent the first October after issuance of a series of Bonds for Phase #2 Assessed Property, such that upon the issuance of Bonds, all Assessments in the applicable Phase shall begin collection, or (iii) with tax bills sent the first October occurring after the expiration of two years from the date of the levy of Assessments on the Phase #2 Assessed Property, such that all Assessments in the applicable Phase begin collection immediately after the expiration of such two year period. Such first Annual Installment for a Phase #2 Lot or Parcel for which collection has begun, shall be due by January 31st of the following calendar year.”

Assessment Methodology

This method of assessing property, as updated in prior Annual Service Plan Updates, has not been changed and Assessed Property will continue to be assessed as provided for in the Updated Service and Assessment Plan.

IV. UPDATE OF THE ASSESSMENT ROLL

Pursuant to the Updated Service and Assessment Plan, the Assessment Rolls shall be updated each year to reflect:

- (i) the identification of each Parcel
- (ii) the Assessment for each Parcel of Assessed Property, including any adjustments authorized by the Updated Service and Assessment Plan or in the PID Act;
- (iii) the Annual Installment for the Assessed Property for the year (if the Assessment is payable in installments); and
- (iv) payments of the Assessment, if any, as provided by Section VI.F of the Updated Service and Assessment Plan.

The summary of updated Assessment Roll is shown in Appendix D of this report. Each Parcel in the PID is identified, along with the Assessment on each Parcel and the Annual Installment to be collected from each Parcel. Assessments are to be reallocated for the subdivision of any Parcels.

A. PARCEL UPDATES

According to the Updated Service and Assessment Plan, upon the subdivision of any Parcel, the Administrator shall reallocate the Assessment for the Parcel prior to the subdivision among the new subdivided Parcels according to the following formula:

$$A = B \times (C \div D)$$

Where the terms have the following meanings:

- A = the Assessment for each new subdivided Parcel
- B = the Assessment for the Parcel prior to subdivision
- C = the estimated number of Equivalent Units to be built on each new subdivided Parcel
- D = the sum of the estimated number of Equivalent Units to be built on all of the new subdivided Parcels

The calculation of the estimated number of Equivalent Units to be built on a Parcel shall be performed by the Administrator and confirmed by the City Council based on the information available regarding the use of the Parcel. The estimate as confirmed shall be conclusive. The number of units to be built on a Parcel may be estimated by net land area and reasonable density ratios.

According to the Johnson County Appraisal District and the Developer, a final plat for Phase #1 was filed and recorded on December 11, 2019, and amended on July 17, 2020. As a result, ninety-eight (98) residential Lots were subdivided and were officially recognized in the official Johnson County roll in 2019.

According to the City, building permits for forty-one (41) Phase #1 Lots had been issued as of July 31, 2020. As a result, condition (i) had been satisfied for the respective 41 Lots, and the first Annual Installments were due no later than January 31, 2021, for each Lot.

According to the City, building permits for an additional fifty-five (55) Phase #1 Lots had been issued during the period of August 1, 2020 through June 30, 2021. As a result, condition (i) has

been satisfied for the respective 55 Lots, and the first Annual Installment for these Lots were due no later than January 31, 2022 for each Lot.

Pursuant to condition (iii) of Section VI-G of the Updated Service and Assessment Plan, the remaining two (2) Phase #1 Lots were triggered for collection in 2022 and the first Annual Installment for these Lots were due no later than January 31, 2023 for each Lot.

According to the Johnson County Appraisal District and the Developer, a final plat for Phase #2 was filed and recorded on December 22, 2021. As a result, one-hundred thirty (130) residential Lots were subdivided and were officially recognized in the official Johnson County roll in 2021.

According to the City, building permits for fifty-nine (59) Phase #2 Lots had been issued as of June 30, 2022. As a result, condition (i) had been satisfied for the respective 59 Lots, and the first Annual Installments were due no later than January 31, 2023 for each lot.

Thereafter, according to the City, additional building permits for eighteen (18) Phase #2 Lots had been issued as of June 30, 2023. As a result, condition (i) had been satisfied for the respective eighteen (18) Lots triggered in 2023-24, and the first Annual Installments will be due no later than January 31, 2024 for each lot.

B. PREPAYMENT OF ASSESSMENTS

There have been sixteen (16) Assessment prepayments as of June 30, 2023. See Appendix B of this report for additional prepayment related information.

The complete Assessment Roll is available for review at the City Hall, located at 141 W. Renfro Street, Burleson, Texas 76028.

(remainder of this page is intentionally left blank)

APPENDIX A
PID MAP

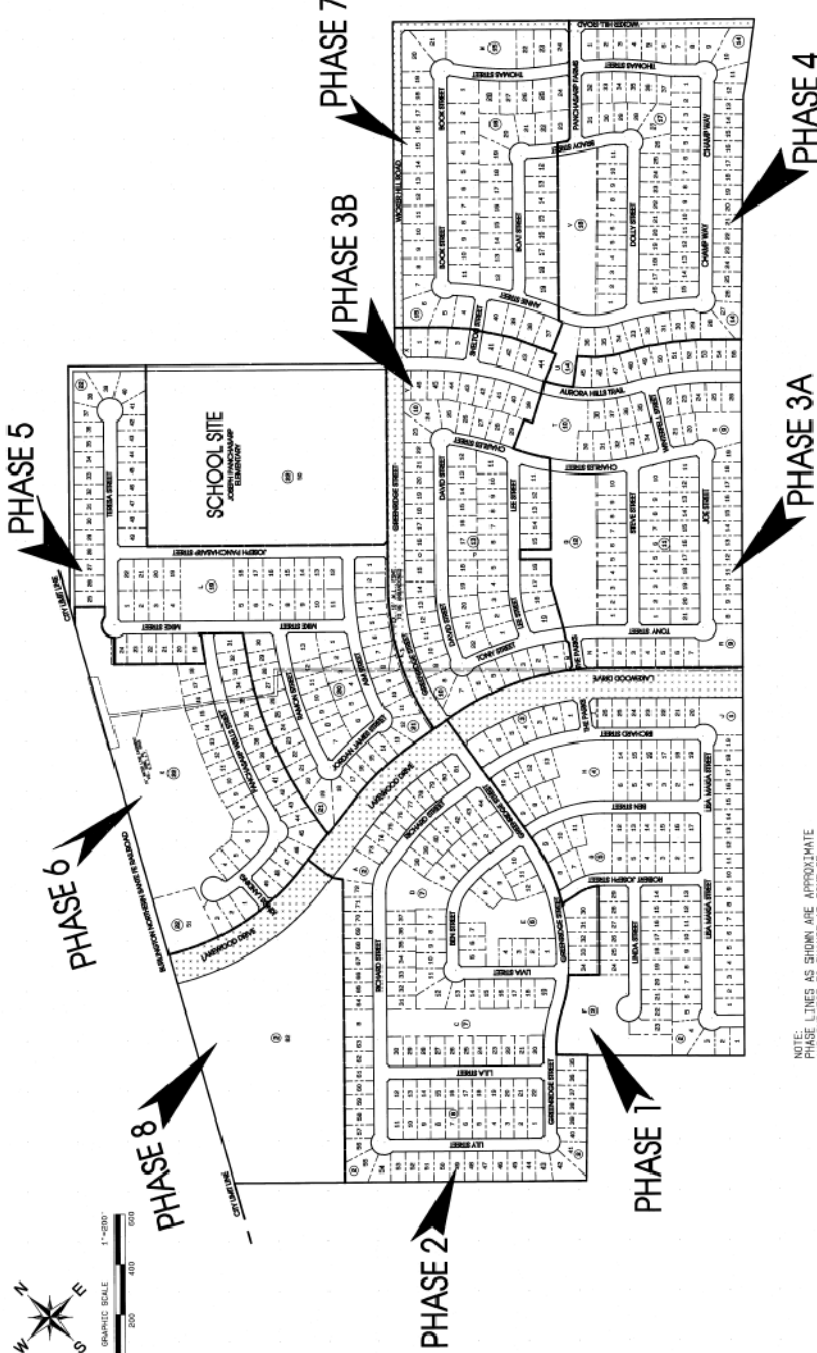
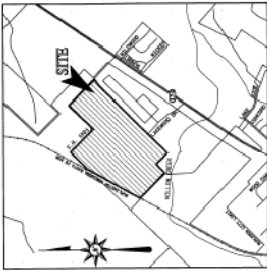

PRELIMINARY PLAT
 FOR
THE PARKS AT PANCHASARP FARMS
PHASES 1-8
 20.877 ACRES
 H.G. CATLETT SURVEY, ABSTRACT NO. 179
 H.G. CATLETT SURVEY, ABSTRACT NO. 178
 CITY OF BURLESON, JOHNSON COUNTY, TEXAS
 659 SINGLE SPACE LOTS
 31 OPEN SPACE FAMILY LOTS
 OCTOBER, 2016
 EXISTING ZONING: PD PLANNED DEVELOPMENT
 SHEET 1 OF 9

GOODWIN
MARSHALL
 CIVIL ENGINEERS & ARCHITECTS
 1400 MARSHALL ST., SUITE 100
 MCKINNEY, TEXAS 75069
 PHONE: 972-308-4703
 FAX: 972-308-4704
 TYPED BY: 10/10/16

OWNER/DEVELOPER:
PANCHASARP C.L.P.
 4020 N. MACARTHUR BLVD.
 STE 122 778
 IRVING, TX 75038

The plat holder, this developer, shall not be responsible for any mistakes, errors, omissions, or other defects in this plat. The plat holder, this developer, shall not be responsible for any mistakes, errors, omissions, or other defects in this plat. The plat holder, this developer, shall not be responsible for any mistakes, errors, omissions, or other defects in this plat.

PRE DIRECTION	STREET NAME	STREET WIDTH	AREA (SQ. FT.)
N-S	LARKWOOD DRIVE	50'	7,500
N-S	MACARTHUR BLVD	70'	10,500
N-S	COCKE STREET	50'	7,500
TOTAL OPEN SPACE AREA:			
155,000			

NOTE: PHASE LINES AS SHOWN ARE APPROXIMATE AND SUBJECT TO CHANGE AT TIME OF FINAL PLATTING.

PARCEL	LOT TYPE	DEVELOPMENT SUMMARY							
		TYPE A	TYPE B	TYPE C	TYPE D	TYPE E	TYPE F	TYPE G	TYPE H
PHASE 1	SP	50	60	60	60	60	60	60	60
PHASE 2	SP	30	40	35	35	35	35	35	35
PHASE 3	SP	25	30	30	30	30	30	30	30
PHASE 4	SP	20	25	25	25	25	25	25	25
PHASE 5	SP	15	20	20	20	20	20	20	20
PHASE 6	SP	10	15	15	15	15	15	15	15
PHASE 7	SP	5	10	10	10	10	10	10	10
PHASE 8	SP	5	10	10	10	10	10	10	10
TOTAL		155	195	210	210	210	210	210	210
SCHOOL SITE	SP								
TOTAL		155	195	210	210	210	210	210	210

LEGEND
 SP Single Family
 SF Multi-Family
 CM Commercial

APPENDIX B
PREPAID PARCELS

APPENDIX B
LIST OF PREPAID PARCELS

Parcel ID	Prepayment Date	Amount	Full/Partial¹
126.2233.01120	Oct-20	\$3,980.56	Full
126.2233.02150	Oct-20	\$3,980.56	Full
126.2233.01030	Nov-20	\$3,980.56	Full
126.2233.03060	Nov-21	\$3,566.55	Full
126.2233.02120	Dec-21	\$3,948.05	Full
126.2233.01200	Aug-21	\$3,948.05	Full
126.2233.05130	Nov-21	\$3,626.70	Full
126.2233.04100	Jul-21	\$3,948.05	Full
126.2233.03040	Jan-22	\$3,626.70	Full
126.2233.20720	Oct-22	\$3,626.70	Full
126.2233.20245	Jan-23	\$3,626.70	Full
126.2233.20813	Jan-23	\$3,626.70	Full
126.2233.20803	Apr-23	\$3,626.70	Full
126.2233.20740	May-23	\$3,948.05	Full
126.2233.20719	Jun-23	\$3,948.05	Full
126.2233.20244	Jun-23	\$3,948.05	Full

1 - Pursuant to the Updated Service and Assessment Plan, Lots with prepaid Assessments will continue to pay a proportionate share of the Maintenance Expense.

APPENDIX C
LAND USE CLASS AND EQUIVALENT UNITS

LAND USE CLASS AND EQUIVALENT UNITS

For purposes of allocating the Assessments, the Assessed Property has been classified in one of six Lot Types. Table C-1 below shows the original proposed residential Lot Types within the PID.

Table C-1
Proposed Development within the PID (Original)¹

Lot Type	Description	Proposed Development	
Lot Type 1	70 Ft Lots	43	Units
Lot Type 2	65 Ft Lots	73	Units
Lot Type 3	60 Ft Lots	315	Units
Lot Type 4	55 Ft Lots	228	Units
Lot Type 5	Multi-Family	250	Units
Total		909	Units

¹ As originally provided by the Developer

Pursuant to the Developer, the proposed development plan within the PID has been updated as shown in Table C-2 below.

Table C-2
Proposed Development within the PID (Updated)

Lot Type	Description	Proposed Development	
Lot Type 1	70 Ft Lots	43	Units
Lot Type 2	65 Ft Lots	73	Units
Lot Type 3	60 Ft Lots	304	Units
Lot Type 4	55 Ft Lots	239	Units
Lot Type 5	Multi-Family	250	Units
Total		909	Units

¹ As updated by the Developer

Table C-3 below shows the original proposed residential Lot Types within Phase #1.

Table C-3
Proposed Development – Phase #1 (Original)

Lot Type	Description	Proposed Development	
Lot Type 1	70 Ft Lots	0	Units
Lot Type 2	65 Ft Lots	0	Units
Lot Type 3	60 Ft Lots	69	Units
Lot Type 4	55 Ft Lots	29	Units
Lot Type 5	Multi-Family	0	Units
Total		98	Units

Table C-4 on the following page shows the updated proposed residential Lot Types within Phase #1.

Table C-4
Proposed Development – Phase #1 (Updated)

Lot Type	Description	Proposed Development	
Lot Type 1	70 Ft Lots	0	Units
Lot Type 2	65 Ft Lots	0	Units
Lot Type 3	60 Ft Lots	58	Units
Lot Type 4	55 Ft Lots	40	Units
Lot Type 5	Multi-Family	0	Units
Total		98	Units

Table C-5 below shows the updated proposed residential Lot Types within Phase #2.

Table C-5
Proposed Development – Phase #2

Lot Type	Description	Proposed Development	
Lot Type 1	70 Ft Lots	0	Units
Lot Type 2	65 Ft Lots	0	Units
Lot Type 3	60 Ft Lots	35	Units
Lot Type 4	55 Ft Lots	95	Units
Lot Type 5	Multi-Family	0	Units
Total		130	Units

As explained under Section IV.D, for purpose of this Updated Service and Assessment Plan, the City Council has determined that the Actual Costs of the portion of the Park Improvements to be financed shall be allocated to the Future Phases Assessed Property by spreading the entire Assessment across the Parcels based on the estimated Equivalent Units.

For purposes of this Updated Service and Assessment Plan, the City Council has determined that the Assessments shall be allocated to the Future Phases Assessed Property on the basis of the average home value of each Lot Type, and that such method of allocation will result in the imposition of equal shares of the Assessments on Parcels similarly benefited. In determining the average home value of each Lot Type, the City Council has taken into consideration (i) the type of lots (i.e., 70 Ft, 65 Ft, etc.); (ii) current and projected home prices; (iii) the costs of the Authorized Improvements, and (iv) the ability of different property types to utilize and benefit from the Authorized Improvements.

Having taken into consideration the matters described above, the City Council has determined that allocating the Assessments among Parcels based on average home value is best accomplished by creating classifications of benefited Parcels based on the “Lot Types” defined above. These classifications (from Lot Type 1 (70 Ft Lots) representing the highest value to Lot Type 5 (Multi-Family Lot) representing the lowest value for residential lots are set forth in Table C-6. Assessments are allocated to each Lot Type on the basis of the average home value for each class of lots. This is accomplished by giving each Lot Type an Equivalent Unit factor. Equivalent Units are the ratio of the average value of lots within each assessment class, setting the Equivalent Unit factor for Lot Type 1 (70 Ft Lots) to 1.00.

Table C-6
Equivalent Unit Factors

Lot Type	Estimated Average	
	Unit Value	Equivalent Unit Factor
Lot Type 1 (70 Ft Lot)	\$340,000	1.00 per dwelling unit
Lot Type 2 (65 Ft Lot)	\$315,000	0.93 per dwelling unit
Lot Type 3 (60 Ft Lot)	\$293,000	0.86 per dwelling unit
Lot Type 4 (55 Ft Lot)	\$269,000	0.79 per dwelling unit
Lot Type 6 (Multi-Family)	\$105,000	0.31 per dwelling unit

The original total estimated Equivalent Units within the PID are shown in Table C-7 as calculated based on the Equivalent Unit factors shown above in Table C-6 and estimated Lot Types and number of units estimated to be built within the PID as shown in Table C-2.

Table C-7
Equivalent Units- Total (Original)

Lot Type	No. of units	Equivalent Unit Factor	Total Equivalent Units
Lot Type 1 (70 Ft Lot)	43	1.00	43.00
Lot Type 2 (65 Ft Lot)	73	0.93	67.89
Lot Type 3 (60 Ft Lot)	315	0.86	270.90
Lot Type 4 (55 Ft Lot)	228	0.79	180.12
Lot Type 6 (Multi-Family)	250	0.31	77.50
Total Equivalent Units	909		639.41

The updated total estimated Equivalent Units within the PID are shown in Table C-8 as calculated based on the Equivalent Unit factors shown above in Table C-6 and estimated Lot Types and number of units estimated to be built within the PID as shown in Table C-1.

Table C-8
Equivalent Units- Total (Updated)

Lot Type	No. of units	Equivalent Unit Factor	Total Equivalent Units
Lot Type 1 (70 Ft Lot)	43	1.00	43.00
Lot Type 2 (65 Ft Lot)	73	0.93	67.89
Lot Type 3 (60 Ft Lot)	304	0.86	261.44
Lot Type 4 (55 Ft Lot)	239	0.79	188.81
Lot Type 6 (Multi-Family)	250	0.31	77.50
Total Equivalent Units	909		638.64

The original total estimated Equivalent Units for Phase #1 are shown in Table C-9 below as calculated based on the Equivalent Unit factors shown above in Table C-6 and estimated Lot Types and number of units estimated to be built within Phase #1 as shown in Table C-3.

Table C-9
Equivalent Units- Phase #1 (Original)

Lot Type	No. of units	Equivalent Unit Factor	Total Equivalent Units
Lot Type 1 (70 Ft Lot)	0	1.00	0.00
Lot Type 2 (65 Ft Lot)	0	0.93	0.00
Lot Type 3 (60 Ft Lot)	69	0.86	59.34
Lot Type 4 (55 Ft Lot)	29	0.79	22.91
Lot Type 6 (Multi-Family)	0	0.31	0.00
Total Equivalent Units	98		82.25

The updated total estimated Equivalent Units for Phase #1 are shown in Table C-10 as calculated based on the Equivalent Unit factors shown above in Table C-6 and estimated Lot Types and number of units estimated to be built within Phase #1 as shown in Table C-4.

Table C-10
Equivalent Units- Phase #1 (Updated)

Lot Type	No. of units	Equivalent Unit Factor	Total Equivalent Units
Lot Type 1 (70 Ft Lot)	0	1.00	0.00
Lot Type 2 (65 Ft Lot)	0	0.93	0.00
Lot Type 3 (60 Ft Lot)	58	0.86	49.88
Lot Type 4 (55 Ft Lot)	40	0.79	31.60
Lot Type 6 (Multi-Family)	0	0.31	0.00
Total Equivalent Units	98		81.48

The total estimated Equivalent Units for Phase #2 are shown in Table C-11 on the following page as calculated based on the Equivalent Unit factors shown above in Table C-6 and estimated Lot Types and number of units estimated to be built within Phase #2 as shown in Table C-4.

Table C-11
Equivalent Units- Phase #1 (Original)

Lot Type	No. of units	Equivalent Unit Factor	Total Equivalent Units
Lot Type 1 (70 Ft Lot)	0	1.00	0.00
Lot Type 2 (65 Ft Lot)	0	0.93	0.00
Lot Type 3 (60 Ft Lot)	69	0.86	59.34
Lot Type 4 (55 Ft Lot)	29	0.79	22.91
Lot Type 6 (Multi-Family)	0	0.31	0.00
Total Equivalent Units	98		82.25

APPENDIX D-1
PHASE #1 ASSESSMENT ROLL – ALL PARCELS

Appendix D-1
Phase #1 Assessment Roll

Lots
Assessment
Equivalent Units

98
\$374,055
81.48

Year	Principal	Interest	Administrative Expense		Annual Installment
			Maintenance Assessment	Other Administrative Expenses	
1	\$5,741	\$19,077	\$21,892	\$11,483	\$58,192
2	\$5,741	\$18,784	\$21,892	\$11,712	\$58,129
3	\$6,379	\$18,491	\$21,892	\$11,946	\$58,708
4	\$6,379	\$18,166	\$21,892	\$12,185	\$58,622
5	\$7,017	\$17,841	\$21,892	\$12,429	\$59,178
6	\$7,017	\$17,483	\$21,892	\$12,678	\$59,069
7	\$7,655	\$17,125	\$21,892	\$12,931	\$59,603
8	\$7,655	\$16,734	\$21,892	\$13,190	\$59,471
9	\$8,293	\$16,344	\$21,892	\$13,454	\$59,982
10	\$8,931	\$15,921	\$21,892	\$13,723	\$60,466
11	\$8,931	\$15,466	\$21,892	\$13,997	\$60,285
12	\$9,569	\$15,010	\$21,892	\$14,277	\$60,748
13	\$10,207	\$14,522	\$21,892	\$14,277	\$60,898
14	\$10,845	\$14,002	\$21,892	\$14,277	\$61,015
15	\$10,845	\$13,448	\$21,892	\$14,277	\$60,462
16	\$11,483	\$12,895	\$21,892	\$14,277	\$60,547
17	\$12,120	\$12,310	\$21,892	\$14,277	\$60,599
18	\$12,758	\$11,692	\$21,892	\$14,277	\$60,619
19	\$13,396	\$11,041	\$21,892	\$14,277	\$60,606
20	\$14,034	\$10,358	\$21,892	\$14,277	\$60,561
21	\$14,672	\$9,642	\$21,892	\$14,277	\$60,483
22	\$15,948	\$8,894	\$21,892	\$14,277	\$61,010
23	\$16,586	\$8,080	\$21,892	\$14,277	\$60,835
24	\$17,224	\$7,234	\$21,892	\$14,277	\$60,627
25	\$18,500	\$6,356	\$21,892	\$14,277	\$61,024
26	\$19,138	\$5,413	\$21,892	\$14,277	\$60,719
27	\$20,413	\$4,437	\$21,892	\$14,277	\$61,019
28	\$21,051	\$3,395	\$21,892	\$14,277	\$60,616
29	\$22,327	\$2,322	\$21,892	\$14,277	\$60,818
30	\$23,200	\$1,183	\$21,892	\$14,277	\$60,552
Total	\$374,055	\$363,664	\$656,751	\$410,992	\$1,805,462

1 - The interest is calculated using a 5.10% interest rate for years 1 through 5 and an interest rate of 5.10% thereafter.

2 - The Administrative Expenses shown include estimates for the operations and maintenance of the Authorized Improvements, assessment collection costs, and other PID administrative expenses. These estimates will be updated each year as part of the Annual Service Plan Update.

APPENDIX D-2
PHASE #1 2023-24 ASSESSMENT ROLL SUMMARY – FOR LOTS TRIGGERED IN
2020-21

Appendix D-2
Panchasarp Farms Public Improvement District
Phase #1 Assessment Roll Summary - 2020-21 Trigger Parcels

Parcel	Estimated No. of units	Lot Type	Original Equivalent Units	Outstanding Equivalent Units	Outstanding Assessments	Principal	Interest	Administrative Expenses	Maintenance Expenses	Annual Installment
126.2233.01030	1	60 Ft	0.86	Prepaid	Prepaid	Prepaid	Prepaid	Prepaid	\$231.06	\$231.06
126.2233.01050	1	60 Ft	0.86	0.86	\$3,742.36	\$74.70	\$190.86	\$142.70	\$231.06	\$639.33
126.2233.01120	1	60 Ft	0.86	Prepaid	Prepaid	Prepaid	Prepaid	Prepaid	\$231.06	\$231.06
126.2233.01130	1	55 Ft	0.79	0.79	\$3,437.75	\$68.62	\$175.33	\$131.08	\$212.25	\$587.29
126.2233.01140	1	60 Ft	0.86	0.86	\$3,742.36	\$74.70	\$190.86	\$142.70	\$231.06	\$639.33
126.2233.02020	1	60 Ft	0.86	0.86	\$3,742.36	\$74.70	\$190.86	\$142.70	\$231.06	\$639.33
126.2233.02030	1	55 Ft	0.79	0.79	\$3,437.75	\$68.62	\$175.33	\$131.08	\$212.25	\$587.29
126.2233.02040	1	55 Ft	0.79	0.79	\$3,437.75	\$68.62	\$175.33	\$131.08	\$212.25	\$587.29
126.2233.02050	1	55 Ft	0.79	0.79	\$3,437.75	\$68.62	\$175.33	\$131.08	\$212.25	\$587.29
126.2233.02070	1	60 Ft	0.86	0.86	\$3,742.36	\$74.70	\$190.86	\$142.70	\$231.06	\$639.33
126.2233.02080	1	60 Ft	0.86	0.86	\$3,742.36	\$74.70	\$190.86	\$142.70	\$231.06	\$639.33
126.2233.02130	1	55 Ft	0.79	0.79	\$3,437.75	\$68.62	\$175.33	\$131.08	\$212.25	\$587.29
126.2233.02140	1	55 Ft	0.79	0.79	\$3,437.75	\$68.62	\$175.33	\$131.08	\$212.25	\$587.29
126.2233.02150	1	60 Ft	0.86	Prepaid	Prepaid	Prepaid	Prepaid	Prepaid	\$231.06	\$231.06
126.2233.02190	1	60 Ft	0.86	0.86	\$3,742.36	\$74.70	\$190.86	\$142.70	\$231.06	\$639.33
126.2233.02200	1	60 Ft	0.86	0.86	\$3,742.36	\$74.70	\$190.86	\$142.70	\$231.06	\$639.33
126.2233.02210	1	55 Ft	0.79	0.79	\$3,437.75	\$68.62	\$175.33	\$131.08	\$212.25	\$587.29
126.2233.02220	1	55 Ft	0.79	0.79	\$3,437.75	\$68.62	\$175.33	\$131.08	\$212.25	\$587.29
126.2233.02230	1	55 Ft	0.79	0.79	\$3,437.75	\$68.62	\$175.33	\$131.08	\$212.25	\$587.29
126.2233.02240	1	55 Ft	0.79	0.79	\$3,437.75	\$68.62	\$175.33	\$131.08	\$212.25	\$587.29
126.2233.02250	1	60 Ft	0.86	0.86	\$3,742.36	\$74.70	\$190.86	\$142.70	\$231.06	\$639.33
126.2233.02280	1	60 Ft	0.86	0.86	\$3,742.36	\$74.70	\$190.86	\$142.70	\$231.06	\$639.33
126.2233.02290	1	55 Ft	0.79	0.79	\$3,437.75	\$68.62	\$175.33	\$131.08	\$212.25	\$587.29
126.2233.03020	1	60 Ft	0.86	0.86	\$3,742.36	\$74.70	\$190.86	\$142.70	\$231.06	\$639.33
126.2233.03030	1	55 Ft	0.79	0.79	\$3,437.75	\$68.62	\$175.33	\$131.08	\$212.25	\$587.29
126.2233.03060	1	55 Ft	0.79	Prepaid	Prepaid	Prepaid	Prepaid	Prepaid	\$212.25	\$212.25
126.2233.03070	1	60 Ft	0.86	0.86	\$3,742.36	\$74.70	\$190.86	\$142.70	\$231.06	\$639.33
126.2233.04050	1	60 Ft	0.86	0.86	\$3,742.36	\$74.70	\$190.86	\$142.70	\$231.06	\$639.33
126.2233.04090	1	60 Ft	0.86	0.86	\$3,742.36	\$74.70	\$190.86	\$142.70	\$231.06	\$639.33
126.2233.04140	1	60 Ft	0.86	0.86	\$3,742.36	\$74.70	\$190.86	\$142.70	\$231.06	\$639.33
126.2233.04160	1	60 Ft	0.86	0.86	\$3,742.36	\$74.70	\$190.86	\$142.70	\$231.06	\$639.33
126.2233.04170	1	55 Ft	0.79	0.79	\$3,437.75	\$68.62	\$175.33	\$131.08	\$212.25	\$587.29
126.2233.05040	1	60 Ft	0.86	0.86	\$3,742.36	\$74.70	\$190.86	\$142.70	\$231.06	\$639.33
126.2233.05050	1	55 Ft	0.79	0.79	\$3,437.75	\$68.62	\$175.33	\$131.08	\$212.25	\$587.29
126.2233.05070	1	60 Ft	0.86	0.86	\$3,742.36	\$74.70	\$190.86	\$142.70	\$231.06	\$639.33
126.2233.05090	1	60 Ft	0.86	0.86	\$3,742.36	\$74.70	\$190.86	\$142.70	\$231.06	\$639.33
126.2233.05100	1	60 Ft	0.86	0.86	\$3,742.36	\$74.70	\$190.86	\$142.70	\$231.06	\$639.33
126.2233.05110	1	60 Ft	0.86	0.86	\$3,742.36	\$74.70	\$190.86	\$142.70	\$231.06	\$639.33
126.2233.05150	1	60 Ft	0.86	0.86	\$3,742.36	\$74.70	\$190.86	\$142.70	\$231.06	\$639.33
126.2233.05160	1	55 Ft	0.79	0.79	\$3,437.75	\$68.62	\$175.33	\$131.08	\$212.25	\$587.29
126.2233.05170	1	60 Ft	0.86	0.86	\$3,742.36	\$74.70	\$190.86	\$142.70	\$231.06	\$639.33
126.2233.01001	0	Common Area	0.00	0.00	\$0.00	\$0.00	\$0.00	\$0.00	\$0.00	\$0.00
126.2233.01002	0	Common Area	0.00	0.00	\$0.00	\$0.00	\$0.00	\$0.00	\$0.00	\$0.00
126.2233.02001	0	Common Area	0.00	0.00	\$0.00	\$0.00	\$0.00	\$0.00	\$0.00	\$0.00
126.2233.04001	0	Common Area	0.00	0.00	\$0.00	\$0.00	\$0.00	\$0.00	\$0.00	\$0.00
126.2233.05001	0	Common Area	0.00	0.00	\$0.00	\$0.00	\$0.00	\$0.00	\$0.00	\$0.00
Total	41		34.14	30.77	\$133,898.25	\$2,672.87	\$6,828.81	\$5,105.64	\$9,172.59	\$23,779.91

APPENDIX D-3
PHASE #1 2023-24 ASSESSMENT ROLL SUMMARY – FOR LOTS TRIGGERED IN
2021-22

Appendix D-3
Panchasarp Farms Public Improvement District
Phase #1 Assessment Roll Summary - 2021-22 Trigger Parcels

Parcel	Estimated No. of units	Lot Type	Original Equivalent Units	Outstanding Equivalent Units	Outstanding Assessments	Principal	Interest	Administrative Expenses	Maintenance Expenses	Annual Installment
126.2233.01010	1	55 Ft	0.79	0.79	\$3,504.19	\$68.06	\$178.71	\$130.00	\$212.25	\$589.02
126.2233.01020	1	55 Ft	0.79	0.79	\$3,504.19	\$68.06	\$178.71	\$130.00	\$212.25	\$589.02
126.2233.01040	1	55 Ft	0.79	0.79	\$3,504.19	\$68.06	\$178.71	\$130.00	\$212.25	\$589.02
126.2233.01060	1	60 Ft	0.86	0.86	\$3,814.69	\$74.09	\$194.55	\$141.52	\$231.06	\$641.21
126.2233.01070	1	60 Ft	0.86	0.86	\$3,814.69	\$74.09	\$194.55	\$141.52	\$231.06	\$641.21
126.2233.01080	1	60 Ft	0.86	0.86	\$3,814.69	\$74.09	\$194.55	\$141.52	\$231.06	\$641.21
126.2233.01090	1	60 Ft	0.86	0.86	\$3,814.69	\$74.09	\$194.55	\$141.52	\$231.06	\$641.21
126.2233.01100	1	55 Ft	0.79	0.79	\$3,504.19	\$68.06	\$178.71	\$130.00	\$212.25	\$589.02
126.2233.01110	1	60 Ft	0.86	0.86	\$3,814.69	\$74.09	\$194.55	\$141.52	\$231.06	\$641.21
126.2233.01150	1	60 Ft	0.86	0.86	\$3,814.69	\$74.09	\$194.55	\$141.52	\$231.06	\$641.21
126.2233.01160	1	55 Ft	0.79	0.79	\$3,504.19	\$68.06	\$178.71	\$130.00	\$212.25	\$589.02
126.2233.01170	1	60 Ft	0.86	0.86	\$3,814.69	\$74.09	\$194.55	\$141.52	\$231.06	\$641.21
126.2233.01180	1	60 Ft	0.86	0.86	\$3,814.69	\$74.09	\$194.55	\$141.52	\$231.06	\$641.21
126.2233.01190	1	55 Ft	0.79	0.79	\$3,504.19	\$68.06	\$178.71	\$130.00	\$212.25	\$589.02
126.2233.01200	1	60 Ft	0.86	Prepaid	Prepaid	Prepaid	Prepaid	Prepaid	\$231.06	\$231.06
126.2233.01210	1	60 Ft	0.86	0.86	\$3,814.69	\$74.09	\$194.55	\$141.52	\$231.06	\$641.21
126.2233.01220	1	55 Ft	0.79	0.79	\$3,504.19	\$68.06	\$178.71	\$130.00	\$212.25	\$589.02
126.2233.01230	1	60 Ft	0.86	0.86	\$3,814.69	\$74.09	\$194.55	\$141.52	\$231.06	\$641.21
126.2233.01240	1	55 Ft	0.79	0.79	\$3,504.19	\$68.06	\$178.71	\$130.00	\$212.25	\$589.02
126.2233.01250	1	60 Ft	0.86	0.86	\$3,814.69	\$74.09	\$194.55	\$141.52	\$231.06	\$641.21
126.2233.01001	0	Common Area	0.00	0.00	\$0.00	\$0.00	\$0.00	\$0.00	\$0.00	\$0.00
126.2233.01002	0	Common Area	0.00	0.00	\$0.00	\$0.00	\$0.00	\$0.00	\$0.00	\$0.00
126.2233.02010	1	55 Ft	0.79	0.79	\$3,504.19	\$68.06	\$178.71	\$130.00	\$212.25	\$589.02
126.2233.02060	1	55 Ft	0.79	0.79	\$3,504.19	\$68.06	\$178.71	\$130.00	\$212.25	\$589.02
126.2233.02090	1	60 Ft	0.86	0.86	\$3,814.69	\$74.09	\$194.55	\$141.52	\$231.06	\$641.21
126.2233.02100	1	60 Ft	0.86	0.86	\$3,814.69	\$74.09	\$194.55	\$141.52	\$231.06	\$641.21
126.2233.02110	1	55 Ft	0.79	0.79	\$3,504.19	\$68.06	\$178.71	\$130.00	\$212.25	\$589.02
126.2233.02120	1	60 Ft	0.86	Prepaid	Prepaid	Prepaid	Prepaid	Prepaid	\$231.06	\$231.06
126.2233.02160	1	55 Ft	0.79	0.79	\$3,504.19	\$68.06	\$178.71	\$130.00	\$212.25	\$589.02
126.2233.02170	1	60 Ft	0.86	0.86	\$3,814.69	\$74.09	\$194.55	\$141.52	\$231.06	\$641.21
126.2233.02180	1	60 Ft	0.86	0.86	\$3,814.69	\$74.09	\$194.55	\$141.52	\$231.06	\$641.21
126.2233.02260	1	55 Ft	0.79	0.79	\$3,504.19	\$68.06	\$178.71	\$130.00	\$212.25	\$589.02
126.2233.02270	1	55 Ft	0.79	0.79	\$3,504.19	\$68.06	\$178.71	\$130.00	\$212.25	\$589.02
126.2233.02001	0	Common Area	0.00	0.00	\$0.00	\$0.00	\$0.00	\$0.00	\$0.00	\$0.00
126.2233.03010	1	55 Ft	0.79	0.79	\$3,504.19	\$68.06	\$178.71	\$130.00	\$212.25	\$589.02
126.2233.03040	1	55 Ft	0.79	Prepaid	Prepaid	Prepaid	Prepaid	Prepaid	\$212.25	\$212.25
126.2233.03050	1	55 Ft	0.79	0.79	\$3,504.19	\$68.06	\$178.71	\$130.00	\$212.25	\$589.02
126.2233.04010	1	55 Ft	0.79	0.79	\$3,504.19	\$68.06	\$178.71	\$130.00	\$212.25	\$589.02
126.2233.04020	1	60 Ft	0.86	0.86	\$3,814.69	\$74.09	\$194.55	\$141.52	\$231.06	\$641.21
126.2233.04030	1	55 Ft	0.79	0.79	\$3,504.19	\$68.06	\$178.71	\$130.00	\$212.25	\$589.02
126.2233.04040	1	60 Ft	0.86	0.86	\$3,814.69	\$74.09	\$194.55	\$141.52	\$231.06	\$641.21
126.2233.04060	1	60 Ft	0.86	0.86	\$3,814.69	\$74.09	\$194.55	\$141.52	\$231.06	\$641.21
126.2233.04070	1	55 Ft	0.79	0.79	\$3,504.19	\$68.06	\$178.71	\$130.00	\$212.25	\$589.02
126.2233.04080	1	55 Ft	0.79	0.79	\$3,504.19	\$68.06	\$178.71	\$130.00	\$212.25	\$589.02
126.2233.04100	1	60 Ft	0.86	Prepaid	Prepaid	Prepaid	Prepaid	Prepaid	\$231.06	\$231.06
126.2233.04110	1	60 Ft	0.86	0.86	\$3,814.69	\$74.09	\$194.55	\$141.52	\$231.06	\$641.21
126.2233.04120	1	60 Ft	0.86	0.86	\$3,814.69	\$74.09	\$194.55	\$141.52	\$231.06	\$641.21
126.2233.04130	1	60 Ft	0.86	0.86	\$3,814.69	\$74.09	\$194.55	\$141.52	\$231.06	\$641.21
126.2233.04180	1	55 Ft	0.79	0.79	\$3,504.19	\$68.06	\$178.71	\$130.00	\$212.25	\$589.02
126.2233.04190	1	60 Ft	0.86	0.86	\$3,814.69	\$74.09	\$194.55	\$141.52	\$231.06	\$641.21
126.2233.04001	0	Common Area	0.00	0.00	\$0.00	\$0.00	\$0.00	\$0.00	\$0.00	\$0.00
126.2233.05010	1	60 Ft	0.86	0.86	\$3,814.69	\$74.09	\$194.55	\$141.52	\$231.06	\$641.21
126.2233.05020	1	55 Ft	0.79	0.79	\$3,504.19	\$68.06	\$178.71	\$130.00	\$212.25	\$589.02
126.2233.05030	1	60 Ft	0.86	0.86	\$3,814.69	\$74.09	\$194.55	\$141.52	\$231.06	\$641.21
126.2233.05060	1	60 Ft	0.86	0.86	\$3,814.69	\$74.09	\$194.55	\$141.52	\$231.06	\$641.21
126.2233.05080	1	60 Ft	0.86	0.86	\$3,814.69	\$74.09	\$194.55	\$141.52	\$231.06	\$641.21
126.2233.05120	1	60 Ft	0.86	0.86	\$3,814.69	\$74.09	\$194.55	\$141.52	\$231.06	\$641.21
126.2233.05130	1	55 Ft	0.79	Prepaid	Prepaid	Prepaid	Prepaid	Prepaid	\$212.25	\$212.25
126.2233.05140	1	60 Ft	0.86	0.86	\$3,814.69	\$74.09	\$194.55	\$141.52	\$231.06	\$641.21
126.2233.05001	0	Common Area	0.00	0.00	\$0.00	\$0.00	\$0.00	\$0.00	\$0.00	\$0.00
Total	55		45.62	41.46	\$183,903.68	\$3,571.65	\$9,379.09	\$6,822.48	\$12,256.98	\$32,030.20

APPENDIX D-4
PHASE #1 2023-24 ASSESSMENT ROLL SUMMARY – FOR LOTS TRIGGERED IN
2022-23

Appendix D-4
Panchasarp Farms Public Improvement District
Phase #1 Assessment Roll Summary - 2022-23 Trigger Parcels

Parcel	Estimated No. of units	Lot Type	Original Equivalent Units	Outstanding Equivalent Units	Outstanding Assessments	Principal	Interest	Administrative Expenses	Maintenance Expenses	Annual Installment
126.2233.01260	1	60 Ft	0.86	0.86	\$3,887.45	\$60.60	\$198.26	\$128.61	\$231.06	\$618.53
126.2233.04150	1	60 Ft	0.86	0.86	\$3,887.45	\$60.60	\$198.26	\$128.61	\$231.06	\$618.53
Total	2		1.72	1.72	\$7,774.90	\$121.20	\$396.52	\$257.23	\$462.12	\$1,237.06

APPENDIX E-1
PHASE #2 ASSESSMENT ROLL – ALL PARCELS

Appendix E-1
Phase #2 Assessment Roll

Lots	130
Assessment	\$482,718
Total Units	105.15

Year	Administrative Expense				
	Principal	Interest	Maintenance Assessment	Other Administrative Expenses	Annual Installment
1	\$7,409	\$21,481	\$28,251	\$14,818	\$71,959
2	\$7,409	\$21,151	\$28,251	\$15,115	\$71,926
3	\$8,232	\$20,822	\$28,251	\$15,417	\$72,722
4	\$8,232	\$20,455	\$28,251	\$15,725	\$72,664
5	\$9,056	\$20,089	\$28,251	\$16,040	\$73,435
6	\$9,056	\$19,686	\$28,251	\$16,360	\$73,353
7	\$9,879	\$19,283	\$28,251	\$16,688	\$74,101
8	\$9,879	\$18,843	\$28,251	\$17,021	\$73,995
9	\$10,702	\$18,404	\$28,251	\$17,362	\$74,719
10	\$11,525	\$17,927	\$28,251	\$17,709	\$75,413
11	\$11,525	\$17,415	\$28,251	\$18,063	\$75,254
12	\$12,349	\$16,902	\$28,251	\$18,425	\$75,926
13	\$13,172	\$16,352	\$28,251	\$18,425	\$76,200
14	\$13,995	\$15,766	\$28,251	\$18,425	\$76,437
15	\$13,995	\$15,143	\$28,251	\$18,425	\$75,814
16	\$14,818	\$14,520	\$28,251	\$18,425	\$76,015
17	\$15,641	\$13,861	\$28,251	\$18,425	\$76,178
18	\$16,465	\$13,165	\$28,251	\$18,425	\$76,306
19	\$17,288	\$12,432	\$28,251	\$18,425	\$76,396
20	\$18,111	\$11,663	\$28,251	\$18,425	\$76,450
21	\$18,934	\$10,857	\$28,251	\$18,425	\$76,467
22	\$20,581	\$10,015	\$28,251	\$18,425	\$77,271
23	\$21,404	\$9,099	\$28,251	\$18,425	\$77,179
24	\$22,227	\$8,146	\$28,251	\$18,425	\$77,049
25	\$23,874	\$7,157	\$28,251	\$18,425	\$77,707
26	\$24,697	\$6,095	\$28,251	\$18,425	\$77,468
27	\$26,343	\$4,996	\$28,251	\$18,425	\$78,015
28	\$27,167	\$3,823	\$28,251	\$18,425	\$77,666
29	\$28,813	\$2,614	\$28,251	\$18,425	\$78,103
30	\$29,939	\$1,332	\$28,251	\$18,425	\$77,947
Total	\$482,718	\$409,495	\$847,537	\$530,386	\$2,270,136

1 - The interest is calculated using a 4.45% interest rate for years 1 through 5 and an interest rate of 4.45% thereafter.

2 - The Administrative Expenses shown include estimates for the operations and maintenance of the Authorized Improvements, assessment collection costs, and other PID administrative expenses. These estimates will be updated each year as part of the Annual Service Plan Update.

APPENDIX E-2
PHASE #2 2023-24 ASSESSMENT ROLL SUMMARY – FOR LOTS TRIGGERED IN
2022-23

Appendix E-2
Panchasarp Farms Public Improvement District
Phase #2 Assessment Roll Summary - 2022-23 Trigger Parcels

Parcel	Estimated No. of units	Lot Type	Original Equivalent Units	Outstanding Equivalent Units	Outstanding Assessments	Principal	Interest	Administrative Expenses	Maintenance Expenses	Annual Installment
126.2233.20231	1	55 Ft	0.79	0.79	\$3,563.47	\$55.67	\$158.57	\$128.98	\$212.25	\$555.47
126.2233.20233	1	60 Ft	0.86	0.86	\$3,879.22	\$60.60	\$172.63	\$140.41	\$231.06	\$604.69
126.2233.20234	1	55 Ft	0.79	0.79	\$3,563.47	\$55.67	\$158.57	\$128.98	\$212.25	\$555.47
126.2233.20236	1	55 Ft	0.79	0.79	\$3,563.47	\$55.67	\$158.57	\$128.98	\$212.25	\$555.47
126.2233.20237	1	55 Ft	0.79	0.79	\$3,563.47	\$55.67	\$158.57	\$128.98	\$212.25	\$555.47
126.2233.20238	1	60 Ft	0.86	0.86	\$3,879.22	\$60.60	\$172.63	\$140.41	\$231.06	\$604.69
126.2233.20239	1	55 Ft	0.79	0.79	\$3,563.47	\$55.67	\$158.57	\$128.98	\$212.25	\$555.47
126.2233.20242	1	55 Ft	0.79	0.79	\$3,563.47	\$55.67	\$158.57	\$128.98	\$212.25	\$555.47
126.2233.20243	1	55 Ft	0.79	0.79	\$3,563.47	\$55.67	\$158.57	\$128.98	\$212.25	\$555.47
126.2233.20244	1	60 Ft	0.86	Prepaid	Prepaid	Prepaid	Prepaid	Prepaid	\$231.06	\$231.06
126.2233.20245	1	55 Ft	0.79	Prepaid	Prepaid	Prepaid	Prepaid	Prepaid	\$212.25	\$212.25
126.2233.20246	1	60 Ft	0.86	0.86	\$3,879.22	\$60.60	\$172.63	\$140.41	\$231.06	\$604.69
126.2233.20247	1	55 Ft	0.79	0.79	\$3,563.47	\$55.67	\$158.57	\$128.98	\$212.25	\$555.47
126.2233.20248	1	55 Ft	0.79	0.79	\$3,563.47	\$55.67	\$158.57	\$128.98	\$212.25	\$555.47
126.2233.20249	1	55 Ft	0.79	0.79	\$3,563.47	\$55.67	\$158.57	\$128.98	\$212.25	\$555.47
126.2233.20251	1	55 Ft	0.79	0.79	\$3,563.47	\$55.67	\$158.57	\$128.98	\$212.25	\$555.47
126.2233.20253	1	55 Ft	0.79	0.79	\$3,563.47	\$55.67	\$158.57	\$128.98	\$212.25	\$555.47
126.2233.20255	1	55 Ft	0.79	0.79	\$3,563.47	\$55.67	\$158.57	\$128.98	\$212.25	\$555.47
126.2233.20260	1	55 Ft	0.79	0.79	\$3,563.47	\$55.67	\$158.57	\$128.98	\$212.25	\$555.47
126.2233.20261	1	55 Ft	0.79	0.79	\$3,563.47	\$55.67	\$158.57	\$128.98	\$212.25	\$555.47
126.2233.20262	1	55 Ft	0.79	0.79	\$3,563.47	\$55.67	\$158.57	\$128.98	\$212.25	\$555.47
126.2233.20263	1	55 Ft	0.79	0.79	\$3,563.47	\$55.67	\$158.57	\$128.98	\$212.25	\$555.47
126.2233.20266	1	60 Ft	0.86	0.86	\$3,879.22	\$60.60	\$172.63	\$140.41	\$231.06	\$604.69
126.2233.20267	1	55 Ft	0.79	0.79	\$3,563.47	\$55.67	\$158.57	\$128.98	\$212.25	\$555.47
126.2233.20270	1	60 Ft	0.86	0.86	\$3,879.22	\$60.60	\$172.63	\$140.41	\$231.06	\$604.69
126.2233.20271	1	55 Ft	0.79	0.79	\$3,563.47	\$55.67	\$158.57	\$128.98	\$212.25	\$555.47
126.2233.20272	1	60 Ft	0.86	0.86	\$3,879.22	\$60.60	\$172.63	\$140.41	\$231.06	\$604.69
126.2233.20276	1	60 Ft	0.86	0.86	\$3,879.22	\$60.60	\$172.63	\$140.41	\$231.06	\$604.69
126.2233.20277	1	55 Ft	0.79	0.79	\$3,563.47	\$55.67	\$158.57	\$128.98	\$212.25	\$555.47
126.2233.20280	1	60 Ft	0.86	0.86	\$3,879.22	\$60.60	\$172.63	\$140.41	\$231.06	\$604.69
126.2233.20601	1	55 Ft	0.79	0.79	\$3,563.47	\$55.67	\$158.57	\$128.98	\$212.25	\$555.47
126.2233.20602	1	60 Ft	0.86	0.86	\$3,879.22	\$60.60	\$172.63	\$140.41	\$231.06	\$604.69
126.2233.20605	1	55 Ft	0.79	0.79	\$3,563.47	\$55.67	\$158.57	\$128.98	\$212.25	\$555.47
126.2233.20609	1	60 Ft	0.86	0.86	\$3,879.22	\$60.60	\$172.63	\$140.41	\$231.06	\$604.69
126.2233.20610	1	60 Ft	0.86	0.86	\$3,879.22	\$60.60	\$172.63	\$140.41	\$231.06	\$604.69
126.2233.20703	1	55 Ft	0.79	0.79	\$3,563.47	\$55.67	\$158.57	\$128.98	\$212.25	\$555.47
126.2233.20708	1	55 Ft	0.79	0.79	\$3,563.47	\$55.67	\$158.57	\$128.98	\$212.25	\$555.47
126.2233.20710	1	60 Ft	0.86	0.86	\$3,879.22	\$60.60	\$172.63	\$140.41	\$231.06	\$604.69
126.2233.20712	1	55 Ft	0.79	0.79	\$3,563.47	\$55.67	\$158.57	\$128.98	\$212.25	\$555.47
126.2233.20718	1	55 Ft	0.79	0.79	\$3,563.47	\$55.67	\$158.57	\$128.98	\$212.25	\$555.47
126.2233.20719	1	60 Ft	0.86	Prepaid	Prepaid	Prepaid	Prepaid	Prepaid	\$231.06	\$231.06
126.2233.20720	1	55 Ft	0.79	Prepaid	Prepaid	Prepaid	Prepaid	Prepaid	\$212.25	\$212.25
126.2233.20723	1	55 Ft	0.79	0.79	\$3,563.47	\$55.67	\$158.57	\$128.98	\$212.25	\$555.47
126.2233.20725	1	55 Ft	0.79	0.79	\$3,563.47	\$55.67	\$158.57	\$128.98	\$212.25	\$555.47
126.2233.20726	1	60 Ft	0.86	0.86	\$3,879.22	\$60.60	\$172.63	\$140.41	\$231.06	\$604.69
126.2233.20732	1	55 Ft	0.79	0.79	\$3,563.47	\$55.67	\$158.57	\$128.98	\$212.25	\$555.47
126.2233.20734	1	60 Ft	0.86	0.86	\$3,879.22	\$60.60	\$172.63	\$140.41	\$231.06	\$604.69
126.2233.20738	1	60 Ft	0.86	0.86	\$3,879.22	\$60.60	\$172.63	\$140.41	\$231.06	\$604.69
126.2233.20739	1	60 Ft	0.86	0.86	\$3,879.22	\$60.60	\$172.63	\$140.41	\$231.06	\$604.69
126.2233.20740	1	60 Ft	0.86	Prepaid	Prepaid	Prepaid	Prepaid	Prepaid	\$231.06	\$231.06
126.2233.20744	1	60 Ft	0.86	0.86	\$3,879.22	\$60.60	\$172.63	\$140.41	\$231.06	\$604.69
126.2233.20803	1	55 Ft	0.79	Prepaid	Prepaid	Prepaid	Prepaid	Prepaid	\$212.25	\$212.25
126.2233.20804	1	55 Ft	0.79	0.79	\$3,563.47	\$55.67	\$158.57	\$128.98	\$212.25	\$555.47
126.2233.20808	1	55 Ft	0.79	0.79	\$3,563.47	\$55.67	\$158.57	\$128.98	\$212.25	\$555.47
126.2233.20810	1	55 Ft	0.79	0.79	\$3,563.47	\$55.67	\$158.57	\$128.98	\$212.25	\$555.47
126.2233.20812	1	55 Ft	0.79	0.79	\$3,563.47	\$55.67	\$158.57	\$128.98	\$212.25	\$555.47
126.2233.20813	1	55 Ft	0.79	Prepaid	Prepaid	Prepaid	Prepaid	Prepaid	\$212.25	\$212.25
126.2233.20815	1	55 Ft	0.79	0.79	\$3,563.47	\$55.67	\$158.57	\$128.98	\$212.25	\$555.47
126.2233.20817	1	55 Ft	0.79	0.79	\$3,563.47	\$55.67	\$158.57	\$128.98	\$212.25	\$555.47
126.2233.20001	0	Common Area	0.00	0.00	\$0.00	\$0.00	\$0.00	\$0.00	\$0.00	\$0.00
126.2233.20002	0	Common Area	0.00	0.00	\$0.00	\$0.00	\$0.00	\$0.00	\$0.00	\$0.00
126.2233.20003	0	Common Area	0.00	0.00	\$0.00	\$0.00	\$0.00	\$0.00	\$0.00	\$0.00
126.2233.20004	0	Common Area	0.00	0.00	\$0.00	\$0.00	\$0.00	\$0.00	\$0.00	\$0.00
126.2233.20005	0	Common Area	0.00	0.00	\$0.00	\$0.00	\$0.00	\$0.00	\$0.00	\$0.00
Total	59		48.01	42.27	\$190,668.27	\$2,978.44	\$8,484.74	\$6,901.10	\$12,899.12	\$31,263.39

APPENDIX E-3
PHASE #2 2023-24 ASSESSMENT ROLL SUMMARY – FOR LOTS TRIGGERED IN
2023-24

Appendix E-2
Panchasarp Farms Public Improvement District
Phase #2 Assessment Roll Summary - 2023-24 Trigger Parcels

Parcel	Estimated No. of units	Lot Type	Original Equivalent Units	Outstanding Equivalent Units	Outstanding Assessments	Principal	Interest	Administrative Expenses	Maintenance Expenses	Annual Installment
126.2233.20232	1	55 Ft	0.79	0.79	\$3,626.70	\$55.67	\$161.39	\$111.33	\$212.25	\$540.64
126.2233.20241	1	55 Ft	0.79	0.79	\$3,626.70	\$55.67	\$161.39	\$111.33	\$212.25	\$540.64
126.2233.20250	1	55 Ft	0.79	0.79	\$3,626.70	\$55.67	\$161.39	\$111.33	\$212.25	\$540.64
126.2233.20252	1	55 Ft	0.79	0.79	\$3,626.70	\$55.67	\$161.39	\$111.33	\$212.25	\$540.64
126.2233.20254	1	55 Ft	0.79	0.79	\$3,626.70	\$55.67	\$161.39	\$111.33	\$212.25	\$540.64
126.2233.20279	1	55 Ft	0.79	0.79	\$3,626.70	\$55.67	\$161.39	\$111.33	\$212.25	\$540.64
126.2233.20607	1	55 Ft	0.79	0.79	\$3,626.70	\$55.67	\$161.39	\$111.33	\$212.25	\$540.64
126.2233.20608	1	60 Ft	0.86	0.86	\$3,948.05	\$60.60	\$175.69	\$121.20	\$231.06	\$588.54
126.2233.20611	1	60 Ft	0.86	0.86	\$3,948.05	\$60.60	\$175.69	\$121.20	\$231.06	\$588.54
126.2233.20704	1	60 Ft	0.86	0.86	\$3,948.05	\$60.60	\$175.69	\$121.20	\$231.06	\$588.54
126.2233.20705	1	55 Ft	0.79	0.79	\$3,626.70	\$55.67	\$161.39	\$111.33	\$212.25	\$540.64
126.2233.20707	1	55 Ft	0.79	0.79	\$3,626.70	\$55.67	\$161.39	\$111.33	\$212.25	\$540.64
126.2233.20709	1	55 Ft	0.79	0.79	\$3,626.70	\$55.67	\$161.39	\$111.33	\$212.25	\$540.64
126.2233.20724	1	55 Ft	0.79	0.79	\$3,626.70	\$55.67	\$161.39	\$111.33	\$212.25	\$540.64
126.2233.20733	1	60 Ft	0.86	0.86	\$3,948.05	\$60.60	\$175.69	\$121.20	\$231.06	\$588.54
126.2233.20809	1	55 Ft	0.79	0.79	\$3,626.70	\$55.67	\$161.39	\$111.33	\$212.25	\$540.64
126.2233.20811	1	55 Ft	0.79	0.79	\$3,626.70	\$55.67	\$161.39	\$111.33	\$212.25	\$540.64
126.2233.20816	1	55 Ft	0.79	0.79	\$3,626.70	\$55.67	\$161.39	\$111.33	\$212.25	\$540.64
Total	18		14.50	14.50	\$66,565.93	\$1,021.70	\$2,962.18	\$2,043.40	\$3,895.80	\$9,923.09

APPENDIX F
PID ASSESSMENT NOTICE

PID Assessment Notice

NOTICE OF OBLIGATION TO PAY PUBLIC IMPROVEMENT DISTRICT ASSESSMENT TO
THE CITY OF BURLESON, TEXAS
CONCERNING THE FOLLOWING PROPERTY

[insert property address]

As the purchaser of the real property described above, you are obligated to pay assessments to the City of Burleson, Texas (the "City"), for the costs of a portion of a public improvement or services project (the "Authorized Improvements") undertaken for the benefit of the property within the Parks at Panchasarp Farms Public Improvement District (the "District") created under Subchapter A, Chapter 372, Local Government Code.

AN ASSESSMENT HAS BEEN LEVIED AGAINST YOUR PROPERTY FOR THE AUTHORIZED IMPROVEMENTS, WHICH MAY BE PAID IN FULL AT ANY TIME. IF THE ASSESSMENT IS NOT PAID IN FULL, IT WILL BE DUE AND PAYABLE IN ANNUAL INSTALLMENTS THAT WILL VARY FROM YEAR TO YEAR DEPENDING ON THE AMOUNT OF INTEREST PAID, COLLECTION COSTS, ADMINISTRATIVE COSTS, AND DELINQUENCY COSTS.

The exact amount of the assessment may be obtained from the City. The exact amount of each annual installment will be approved each year by the City Council in the Annual Service Plan Update for the District. More information about the assessments, including the amounts and due dates, may be obtained from the City or MuniCap, Inc., the District Administrator for the City, located at 600 E. John Carpenter Fwy, Suite 150, Irving, Texas 75062 and available by telephone at (469) 490-2800 or (866) 648-8482 (toll free) and email at txpid@municap.com.

Your failure to pay any assessment or any annual installment may result in penalties and interest being added to what you owe or in a lien on and the foreclosure of your property.

Date: _____

Signature of Seller

Signature of Seller

The undersigned purchaser acknowledges receipt of this notice before the effective date of a binding contract for the purchase of the real property at the address described above.

Date: _____

Signature of Purchaser

Signature of Purchaser

STATE OF TEXAS §

§

COUNTY OF _____ §

The foregoing instrument was acknowledged before me by _____ and _____, known to me to be the person(s) whose name(s) is/are subscribed to the foregoing instrument, and acknowledged to me that he or she executed the same for the purposes therein expressed, in the capacity stated and as the act and deed of the above-referenced entities as an authorized signatory of said entities.

Given under my hand and seal of office on this _____, 20__.

Notary Public, State of Texas