

# Oncor Electric Delivery Encroachment on Easement Agreement



City Council

March 18, 2024



# RA Development, Ltd

Project Manager / Developer

Serves as project manager per 380 Agreement approved on June 7, 2021

Responsible for designing and constructing Lakewood Drive and sanitary sewer lift station, force main and gravity main

4A Economic Development Corporation Board to reimburse RA Development, Ltd for costs associated with the construction of Lakewood Drive

# Encroachment Agreement

Required when proposed facilities cross  
Oncor's easements

Includes limitations and regulations such as  
the following –

- No blasting is permitted
- Equipment / material not allowed to be stored
- Any street or road crossings are only allowed per the design approved by Oncor
- No signs or lights permitted
- Pre-approved fencing no taller than 8 feet
- Landscaping must be approved by Oncor

Oncor Electric Delivery  
777 Main Street  
Suite 707  
Fort Worth, Texas 76102  
(o) 817-215-6288  
chad.whitehead@oncor.com

Chad Whitehead  
Right of Way Agent Sr.



January 29, 2024

City of Burleson  
Attn: Justin Bond  
236 E Ellison  
Burleson, TX 76028

Re: Request # 2022-5308CW

Proposed Encroachment on Easement for one new street/road crossing (Lakewood Drive), one 24" RCP storm drain crossing, one 15" pvc sanitary sewer line crossing, one 16" force main crossing and grading across Oncor 160' wide easement (E-52739). All crossings are between Transmission Str. 30/1 – 30/3 on the Decordova – Cleburne Tap – Everman Sw. 345 KV lines (U0211) in Johnson County, Texas.

Dear Justin:

Attached, please find an original Encroachment on Easement document for the proposed new street w/ sidewalks (Lakewood Dr.) & utility crossings in Johnson County, Texas.

Please print the attached document twice and have both documents executed, notarized by the City and return both originals to my attention for final signature by Oncor and recording.

Once the documents have been fully signed, I will then forward one (1) fully signed copy to you for your file. You may call me at 817-215-6288 should you have any questions.

Sincerely,

*Chad Whitehead*

Chad Whitehead, RWP  
Oncor Right of Way Agent Sr.  
Transmission Engineering

# Lakewood Drive

4-lane divided roadway

10-foot shared path within parkway on both sides

Existing UCS overhead electric lines parallel to roadway to be buried from CR 1016 to CR 1020

Pedestrian and street lighting proposed from CR 1020 to FM 1902

Roadway and proposed utilities cross under existing Oncor powerlines located in 150-foot easement





# Encroachments

1. Lakewood Drive paving and associated storm drain improvements
2. 16-inch sewer force main
3. 15-inch gravity sewer

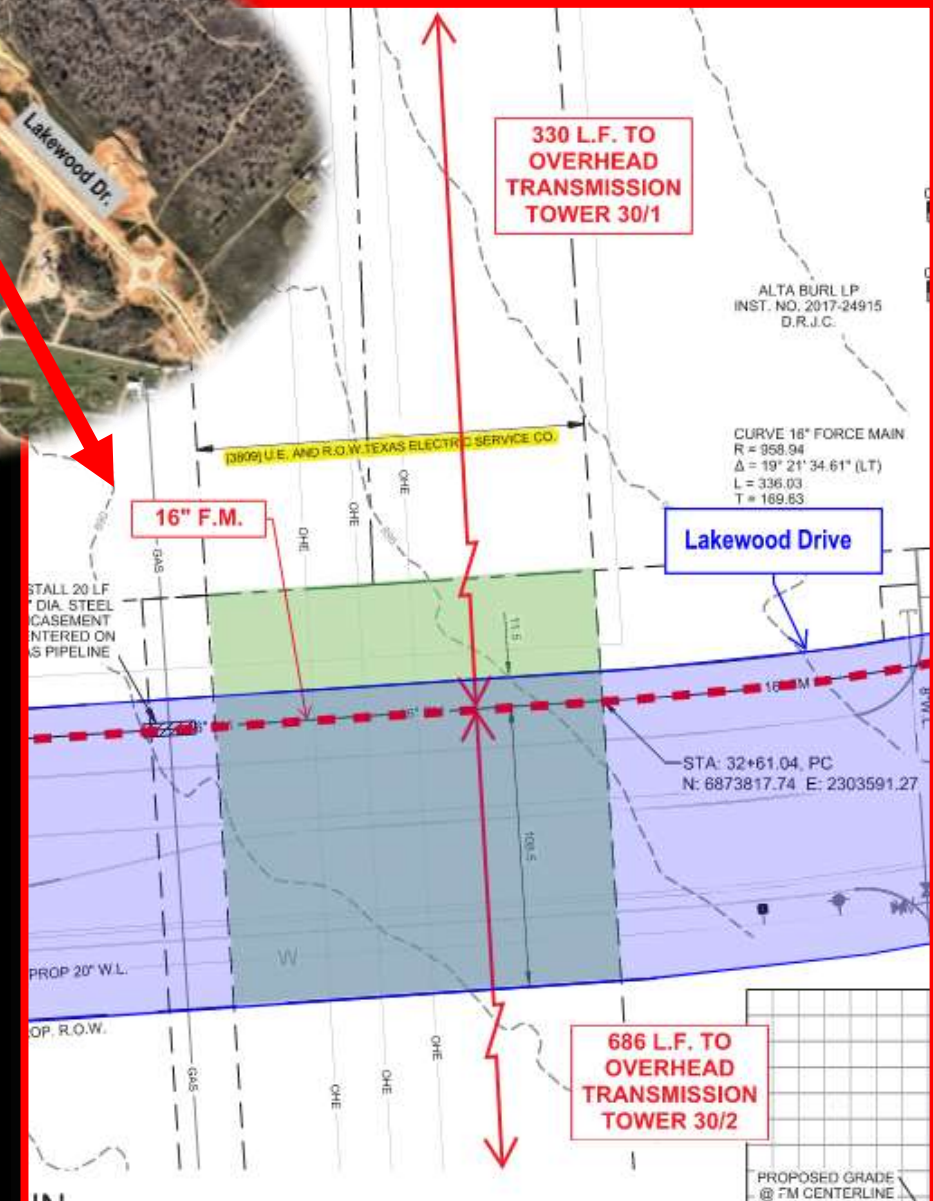
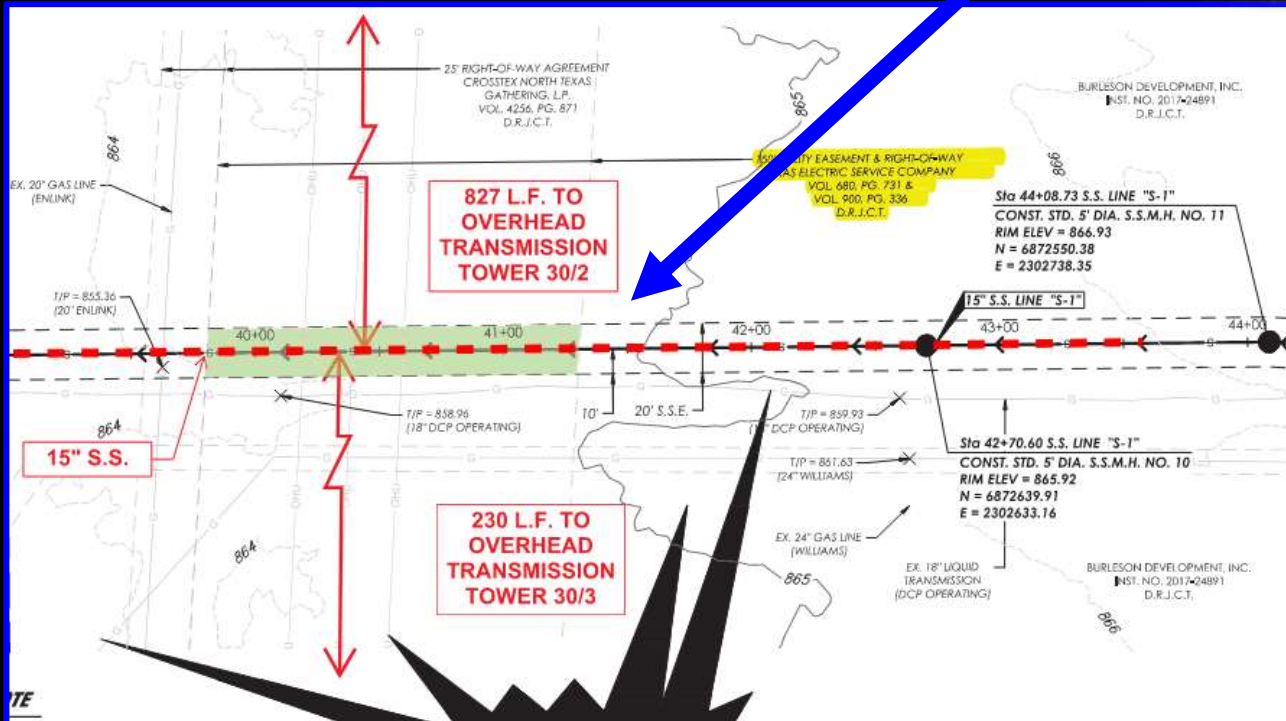



# Action Requested

**Approve an Encroachment  
on Easement agreement  
with Oncor Electric Delivery  
Company, LLC**



**Staff  
Contact**

**Michelle McCullough  
Assistant Director/City Engineer  
817-426-9616  
mmccullough@burlesontx.com**