

Shannon Creek

November 14, 2022

Staff Presenter: Jen Basham, Director of Parks and Recreation



Shannon Creeks Classification

Shannon Creek is centrally located as part of our park system and creates linkages between multiple trails, parks, and open space.

- Total park acreage within a mile- 90.512 acres
- Shannon Creek (Current Phase)- 14.86 acres
- Linear linkages to total park system- 25.54 acres
- Total acres including linear linkages- 116.05 acres
- **Shannon Creek is positioned to serve over 4,000 households within 1 mile**



Background

- Shannon Creek development was identified as a priority in the 2019 park and recreation master plan
- The project began initial public engagement in 2021
- Staff presented the results of the public engagement and the opinion of probable cost to Council on November 8, 2021

Council supported moving forward with the design of Shannon Creek Park with a budget of \$ \$3,233,640 for construction

- The final design contract was presented to Council February 7, 2022

Council awarded the contract to Studio Outside for \$488,985

Engagement Round 1

Online Survey- 303 respondents

In-person town hall- 28 attendees

Amenities supported through the first round of public engagement

These items were listed as part of the final design contract brought forward in February

- Naturalized areas and trails
- Paved trails
- Manicured open space
- Large barrier free playground
Nature themed, with shade
- Fishing pond
- Sports court
- Fitness equipment
- Parking
- Restroom





Second Round of Public Engagement

On-Site Town Hall- August 10- 32 attendees signed in, more joined throughout meeting

Online Survey- 509 responses

Town Hall Stand out Comments



- Use the creekside corridor for parking and restrooms
- Lighted sports courts
- No bathrooms near homes
- No parking on Stillwater
- Families want play equipment
- Nature trails and ponds please

Survey Information

In addition to the on-site town hall the community could respond to an online survey. The survey presented amenities in different configurations and scale. All options included the same amenities.

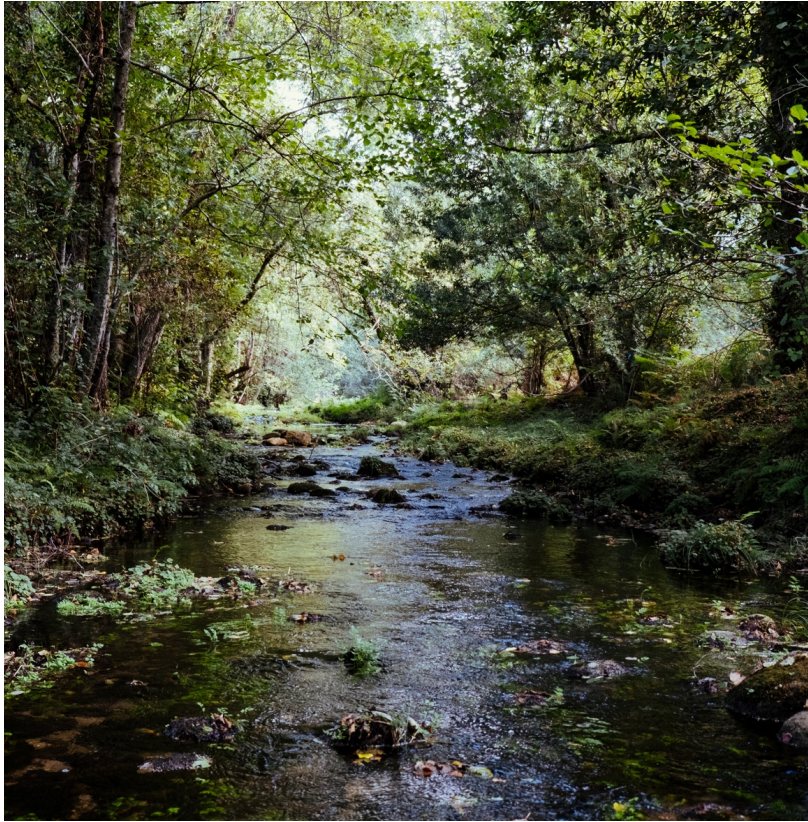

- Parking
- Restroom
- Nature and Paved Trail
- Natural Playground and Inclusive Playground
- Play lawn
- Pond
- Landscape screen between park and homes
- Sports Court
- Pavilion

Close up of Option 1

Includes: Parking, bathroom, nature trail, nature play, playground, pavilion, sports court, play lawn, pond, pavilion, and screening



Close up of Option 2

Includes: Parking, bathroom, nature trail, nature play, playground, pavilion, sports court, play lawn, pond, pavilion, and screening

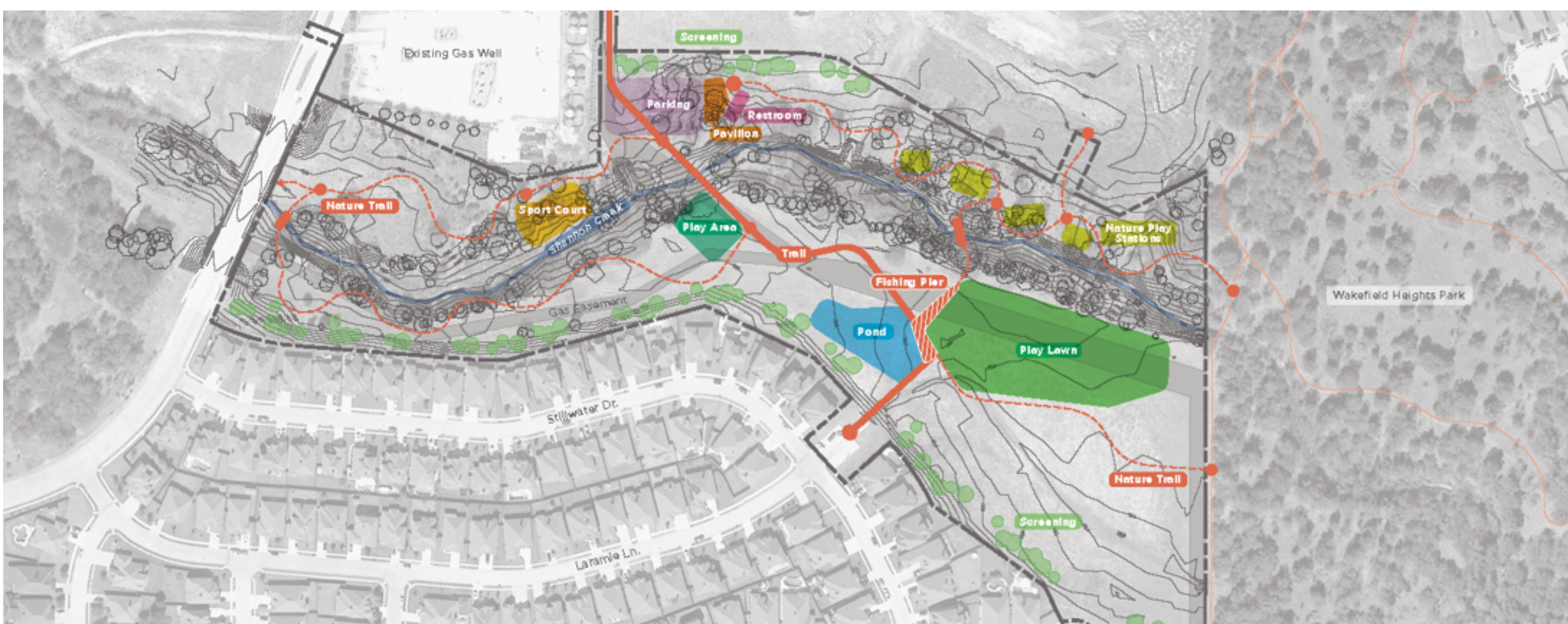

Close up of Option 3 (Preferred option from survey)

Includes: Parking, bathroom, nature trail, nature play, playground, pavilion, sports court, play lawn, pond, pavilion, and screening



Final Design Survey Results

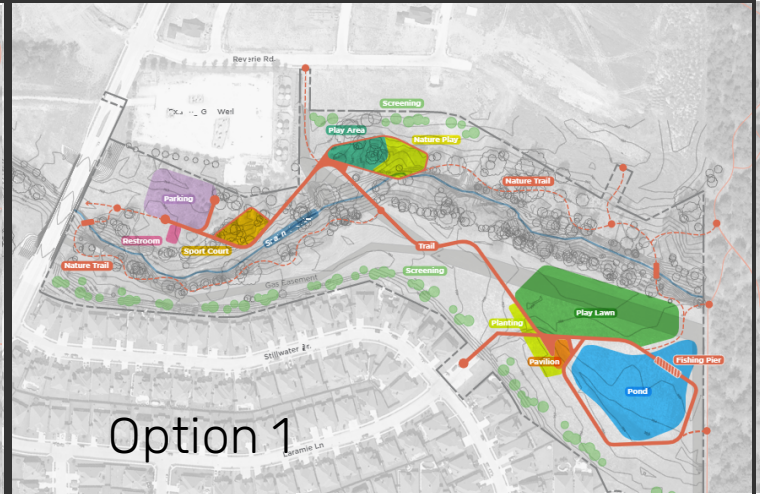
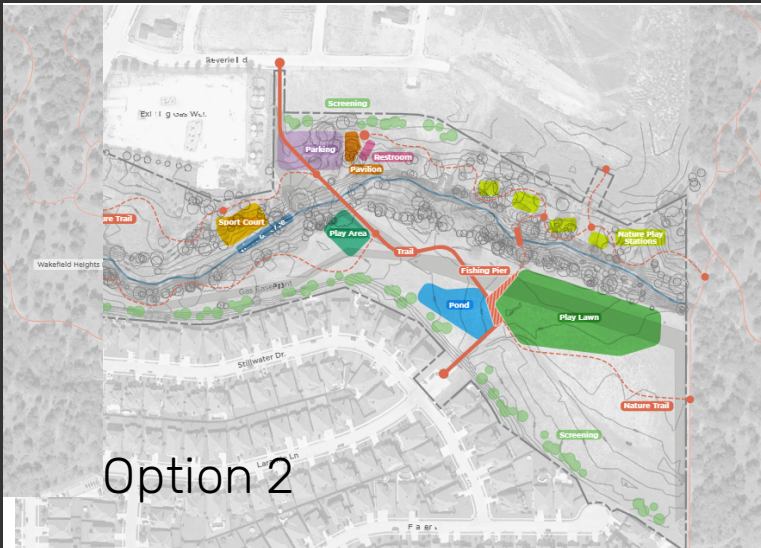
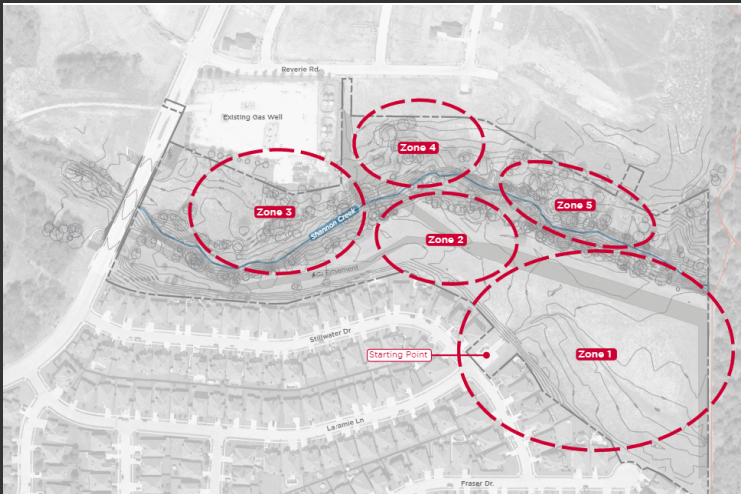

71%

Have children, 36% between the age of 0-5

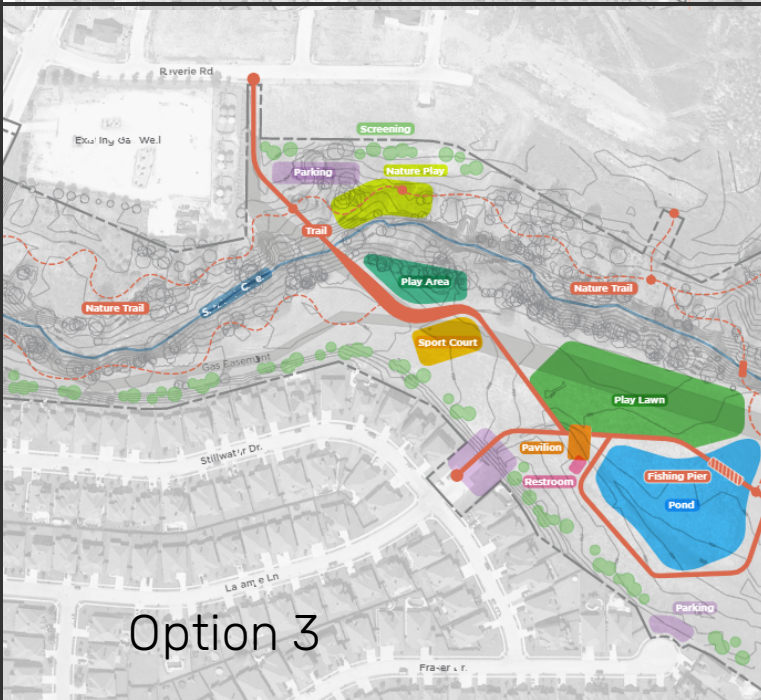

38% like option 1
18% like option 2
44% like option 3
Additional requests made for splash pad, and dog park

Current Challenges

Funding, Feedback and Phasing



- Current funding for the project \$3,233,640
- Current opinion of cost to construct \$6,679,855
- Net difference \$3,446,215
- Due to the mixed nature of the responses and the available funding, staff is proposing a reduced scope for the initial construction and placing additional amenities into future phases as funding becomes available

Phase I



- Pond- \$337,250
Will include drainage improvements for the site
- Play Lawn- \$309,500
- Paved Trail-\$514,100
- Nature Trail- \$262,250
- Nature Play- \$161,750
- Parking- \$570,000
West lot- \$441,500
South lot-\$128,500
- General Costs-\$352,450
(Monument sign, vegetative screening, native grass and seeding, invasive removal)
- Contingency (15%)-\$432,509
- Contractor conditions and overhead(15%)
-\$351,832
- Total-\$3,315,904.25

Estimated 24 months to design and construct

Phase II



- Restroom-\$272,000
- Dog Park- \$156,895
- Parking North Lot-\$306,900
- Contingency (20%)-\$169,232
- Contractor conditions and overhead (15%)
-\$110,369
- Total-\$1,015,397

Estimated 9 months to design and construct

Phase III



- Pavilion and Restroom Combo-\$597,200
- Playground- \$372,500
- Sports Courts (Lit)-\$ 150,000
- Rain Garden and Plantings- \$72,700
- Contingency (20%)-\$238,480
- Contractor conditions and overhead (15%) -\$178,860
- Design-\$186,014
Would be an additional cost for a future contract
- Total-\$1,795,754

Estimated 24 months to design and construct



Direction

✓ Complete project in one phase with all amenities as presented (36 months)

✓ Complete project in phases

Staff Recommendation

Phase 1- Passive (24 months)

Phase 2-Dog park and restroom (9 months)

Phase 3- Active (24 months)

Would result in additional design, mobilization, and construction fees as well as 21 additional months before full build out

✓ Not move forward with the project

Feedback

