

INTERLOCAL AGREEMENT

with Johnson County Special Utility District for
Water Facilities within Lakewood Dr ROW



INTERLOCAL AGREEMENT

ALLOWS WATER FACILITIES IN CITY ROW

- Burleson would be financially responsible for any future relocation of JCSUD water facilities if the City realigns Lakewood Drive in the future
- JCSUD retains maintenance responsibility for their water facilities and will reimburse the City for the cost to restore grass, sidewalk, curbing, and pavement as a result of maintenance of the existing JCSUD water facilities. All repairs will be coordinated with the City
- Agreement will eliminate the need for exclusive JCSUD easements outside of the City's right-of-way, reducing overall cost of the project and avoid delays in construction

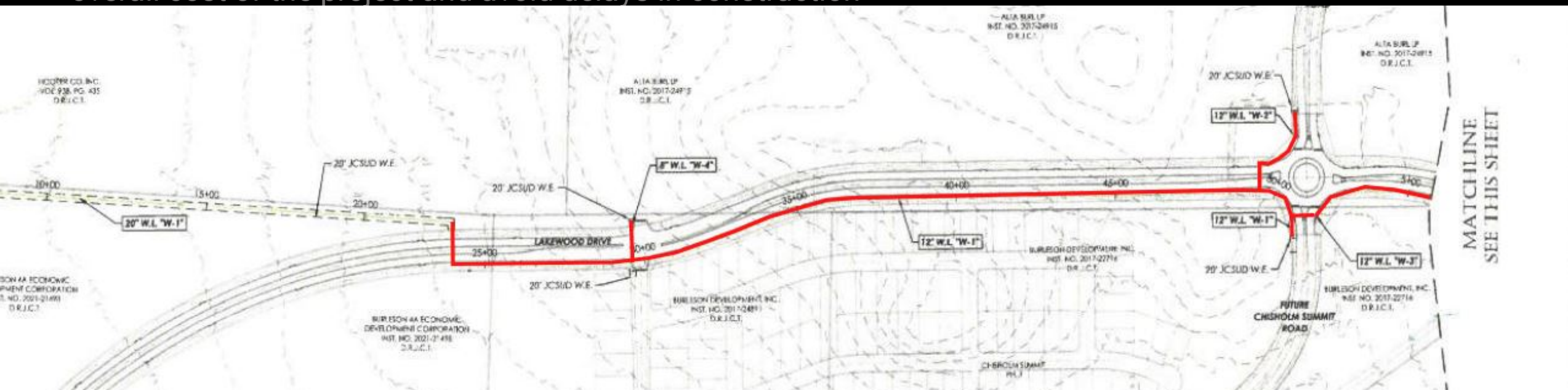

OPTIONS

RECOMMENDED



APPROVE

Approve an interlocal agreement with Johnson County Special Utility District (JCSUD) regarding placement of JCSUD water facilities within the City of Burleson's right-of-way of Lakewood Drive.



DENY

Deny an interlocal agreement with Johnson County Special Utility District (JCSUD) regarding placement of JCSUD water facilities within the City of Burleson's right-of-way of Lakewood Drive.

