

Oncor Electric Delivery, LLC Encroachment on Easement Agreement

City Council
July 21, 2025

Encroachment Agreement

Required when proposed facilities cross
Oncor's easements

Includes limitations and regulations such as
the following –

- No blasting is permitted
- Equipment / material not allowed to be stored
- Any street or road crossings are only allowed per the design approved by Oncor
- No signs or lights permitted
- Pre-approved fencing no taller than 8 feet
- Landscaping must be approved by Oncor

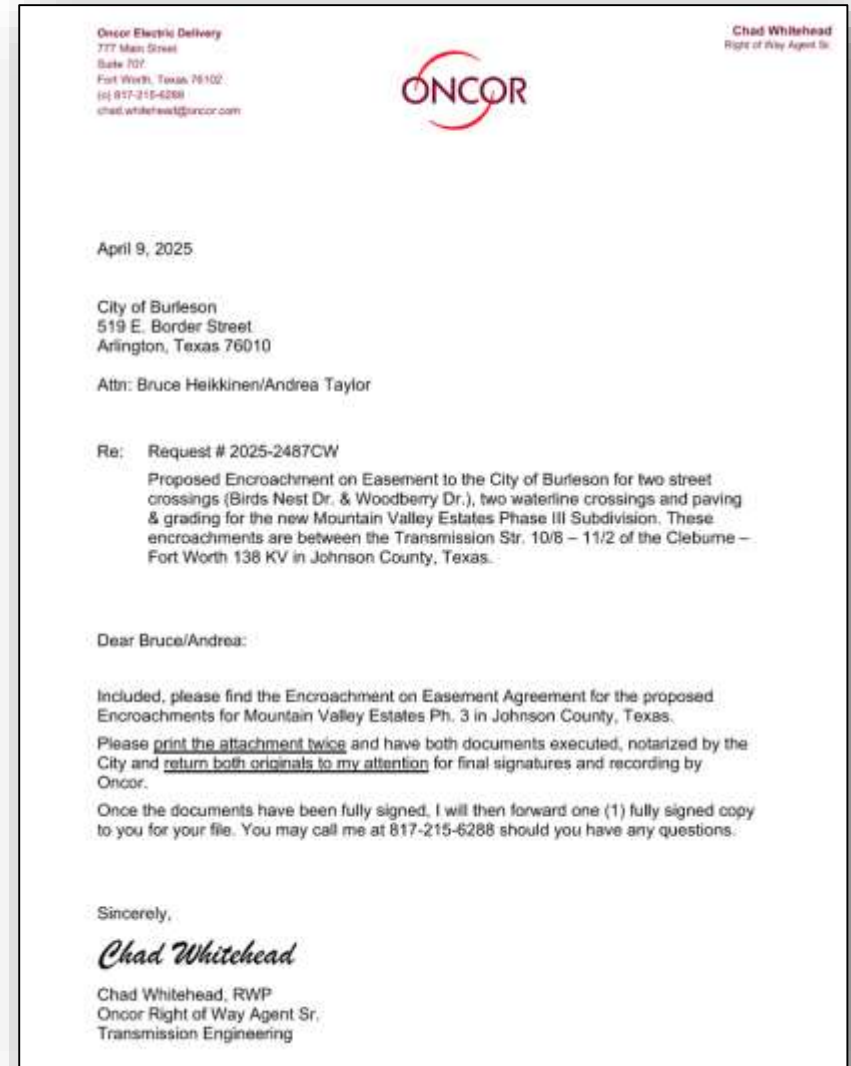

Public Improvements Encroaching Easement

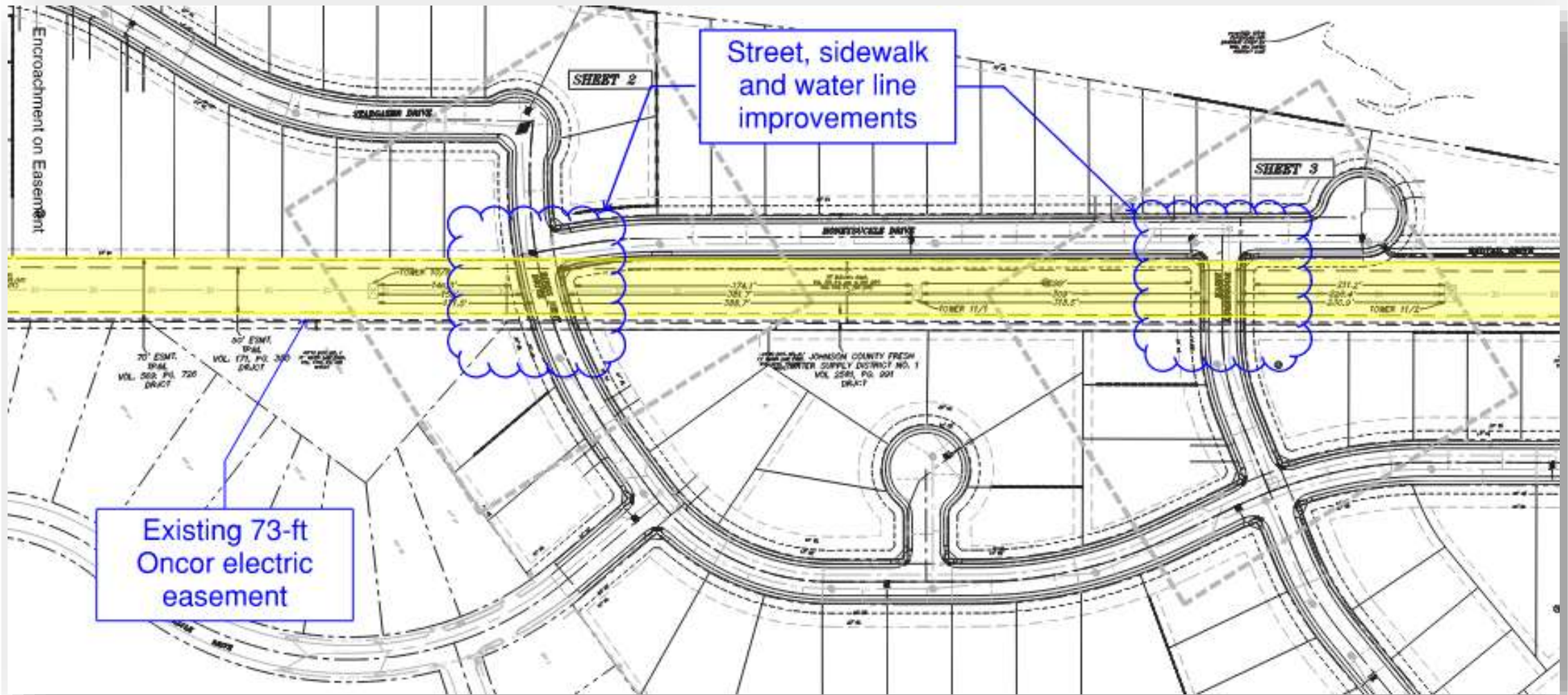

Staff Recommendation

**Approve an Encroachment on Easement agreement
with Oncor Electric Delivery Company, LLC for the
Mountain Valley Residential Development**

Questions/Comments

Michelle McCullough, P.E., CFM
Deputy Director/City Engineer

817-426-9616

mmccullough@burlesontx.com