

Proposal for
City of Burleson

Prepared by



09/30/2024
PROJECT: 171736
Centennial Park – Grant 2024 – Three Options
(REVISED)



800-438-2780 | cunninghamrec.com

Hello!

We are excited for the opportunity to work with you on your upcoming exciting new playground project! For almost 60 years, Cunningham Recreation has designed and built thousands of playgrounds for children of all ages and all abilities. We partner with municipalities, schools, architects and youth organizations to plan, design and build their vision from the ground-up.

Cunningham Recreation is the exclusive representative for GameTime park and playground equipment in North Carolina, South Carolina, Virginia, West Virginia, Arkansas, Kansas, Missouri, Illinois, Oklahoma, Texas, Tennessee, Iowa, Nebraska, North Dakota, South Dakota, Delaware, Maryland, and DC.

The following pages will provide greater detail about our proposal(s), more information on Cunningham Recreation and GameTime and how we can meet the goals of your project.

Please reach out with any questions or additional details. I look forward to working with you.

Sincerely,



Hunter Barron
Sales Associate
945-283-1589
hunter@cunninghamrec.com



About Cunningham Recreation and GameTime



Since 1929, GameTime has been a pioneer in the commercial playground equipment industry. GameTime has continued to bring meaningful research around the importance of play to the design, engineering, manufacture, and delivery of play equipment. GameTime Play Equipment's work has elevated industry standards on safety, physical and mental development, inclusion, and intergenerational interaction.

GameTime play systems, site furnishings and amenities are constructed from the highest quality materials and are backed by the industry's best warranty and customer service. Equipment is manufactured to meet current ASTM, CPSC and ADA guidelines for playground safety and accessibility.

For almost 60 years, Cunningham Recreation has been providing commercial park and playground equipment from design to construction. We are proud to serve as GameTime Play Equipment's exclusive representative in North Carolina, South Carolina, Virginia, West Virginia, Arkansas, Kansas, Missouri, Illinois, Oklahoma, Tennessee, Texas, Iowa, Nebraska, North Dakota, South Dakota, Delaware, Maryland, and DC.

Cunningham Recreation has adequate coverage in each territory to ensure our customers receive professional assistance and excellent customer service.

Range of Installation and Services

GameTime holds an ISO 9001 certification, which validates our high-quality manufacturing standards and our commitment to excellence in the design, production, installation, inspection and testing of our products. Our ISO 14001 certification supports our dedication to environmental sustainability and our commitment to eliminating waste, implementing recycling practices in our manufacturing facility, and offering recycled and recyclable products to our customers.

Cunningham Recreation specializes in complete park and playground solutions. We offer a full range of commercial park and play equipment for children of all ages and all abilities, and we have completed thousands of installations.

Cunningham Recreation offers a variety of resources and design approaches for planning and maintaining parks and playgrounds.



Both Cunningham Recreation and GameTime are considered leaders in the playground industry. Why not partner with a leader? Our research, design principles, innovative products and available resources are at your disposal.



SIGNATURE PROJECTS



Southeast Metro Park – Austin, TX

This playground is for all ages and abilities; and somewhat of an outdoor museum. Its focal point is that of a Mosasaur, a prehistoric sea creature, discovered years ago in Travis County. Children are able to explore the full-length skeleton of the Mosasaur including crawling through the gigantic open toothed mouth. The playground provides a colorful and inclusive experience with its custom GFRC sea turtles and sea coral climbers, half spheres and other playful landscape features. It is completed with poured-in-place rubber safety surfacing.

Total Cost: \$600,000

College View Park – Carthage, TX

This 3-acre park is designed to reach all ages and abilities! It includes a GameTime inclusive play structure with integrated shade and freestanding play items consisting of an arch saucer swing, a 3-bay swing with adaptive seats, an inclusive whirl, multiple sensory wave seats, a Tri Runner and freestanding musical components. The project is completed with 7400 sq ft of poured-in-place rubber safety surfacing. A walking path wraps the area with multiple freestanding fitness components, several shades with benches and a gazebo.

Total Cost: \$700,000



Alcott Station Park – Mesquite, TX

This unique 5 acre park features a large GameTime Modern City play structure with beautiful turf safety surfacing as well as a Thrive 450 adult outdoor fitness area with poured-in-place rubber safety surfacing; and a two mile walking trail connecting all the other amenities in the park. Employees of the adjacent businesses as well as residents of the local neighborhoods are sure to utilize this beautiful space.

Total Cost: \$250,000



Option 3

Centennial Park - Option 3 Burleson, TX

Design • Build • PLAY!



Color Palette: Avalon

Centennial Park - Option 3 Burleson, TX

Design • Build • PLAY!



Color Palette: Avalon

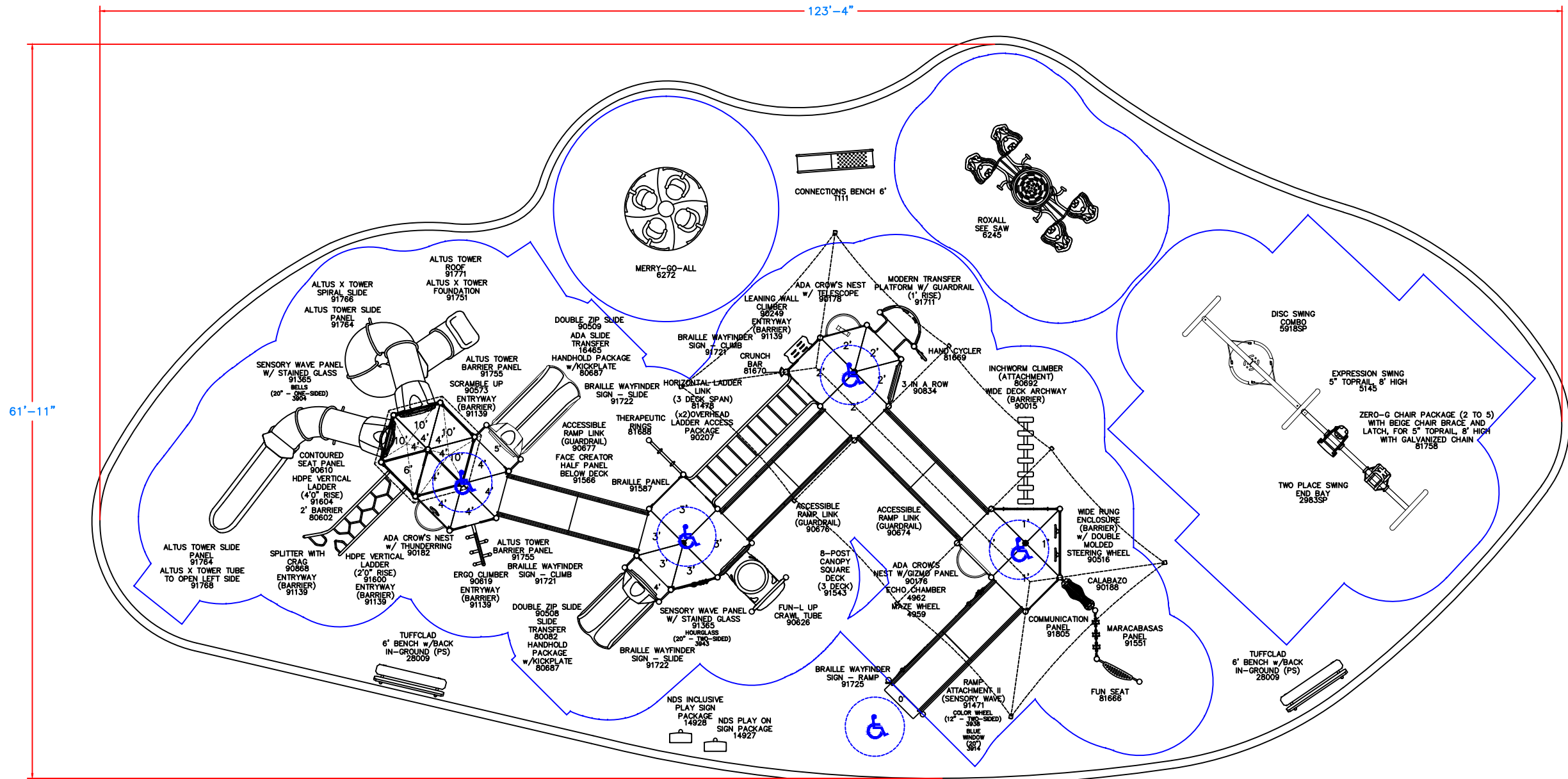

SURFACING	
TYPE	PIP
SQ FT	5,333
DEPTH	4.5"
CURBING	
TYPE	CNCR
LN FT	297
HT	8.5"

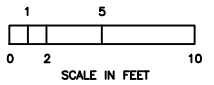

150 PlayCore Drive SE
Fort Payne, AL 35967
www.gametime.com

City of Burleson
Centennial Park Option 3 (Revised)
Burleson, TX
Representative
Cunningham Recreation

This play equipment is recommended for children ages 2-5 & 5-12

Minimum Area Required:
Scale:
This drawing can be scaled only when in an 24" x 36" format

IMPORTANT: Soft resilient surfacing should be placed in the use zones of all equipment, as specified for each type of equipment, and at depths to meet the critical fall heights as specified by the U.S. consumer Product Safety Commission, ASTM standard F 1487 and Canadian Standard CAN/CSA-Z-614

Drawn By:
TCV
Date:
09/26/2024
Drawing Name:
171736-01-03R1



GameTime c/o Cunningham Recreation
 PO Box 240981
 Charlotte, NC 28224
 800.438.2780
 704.525.7356 FAX

09/30/2024
 Quote #
 171736-01-05

Centennial Park (2024 Grant) - Option 3 (Revised)

City of Burleson
 Attn: Daniel Shafer
 550 NW Summercrest Blvd
 Burleson, TX 76028
 United States
 Phone: 817-944-9237
 dshafer@burlesontx.com

Ship to Zip 76028

Quantity	Part #	Description	Unit Price	Amount
1	RDU	GameTime - Modular PowerScope Altus Tower Ramped Play Structure for Ages 5-12 [Accent: _____] [Basic: _____] [Deck:Pvc: _____] [Accent2: _____] [Tube: _____] [2ColorHDPE: _____] [Arch: _____] [RotoPlastic: _____] [HDPE: _____] [Fabric1: _____]	\$248,562.00	\$248,562.00
		(1) 3904 -- Bells 20" 1S		
		(1) 3914 -- Blue Window 20" 1S		
		(1) 3938 -- Color Wheel 12" 2S		
		(1) 3943 -- Hourglass 20" 2S		
		(1) 4959 -- Maze Wheel		
		(1) 4962 -- Echo Chamber		
		(1) 16465 -- Slide Transfer (Ada)		
		(6) 16700 -- Ada49"Sq Punch Steel Deck		
		(16) 16701 -- Ada 49"Tri Punch Steel Dk		
		(2) 16803 -- Ada Wide Triangular Platform		
		(3) 80076 -- Deck Flat Cap Pkg		
		(1) 80082 -- Slide Transfer		
		(1) 80602 -- 2'-0"Entrance Barrier		
		(2) 80687 -- Handhold/Kick Plate Pkg		
		(1) 80692 -- Inchworm Climber Attach		
		(1) 81478 -- Horiz Ladder Link 147"		
		(1) 81666 -- Fun Seat		
		(1) 81669 -- Hand Cyclor		
		(1) 81670 -- Crunch Bar		
		(1) 81688 -- Therapeutic Rings Attch		
		(1) 90015 -- Wide Deck Archway W/ Barrier		
		(1) 90176 -- Ada Crow'S Nest W/ Gizmo		
		(1) 90178 -- Ada Crow'S Nest W/Telescope		
		(1) 90182 -- Ada Crow'S Nest W/ Thunderring		
		(1) 90188 -- Calabazo Panel		



GameTime c/o Cunningham Recreation
 PO Box 240981
 Charlotte, NC 28224
 800.438.2780
 704.525.7356 FAX

09/30/2024
 Quote #
 171736-01-05

Centennial Park (2024 Grant) - Option 3 (Revised)

Quantity	Part #	Description	Unit Price	Amount
		(2) 90207 -- Overhead Ladder Access Package		
		(1) 90249 -- 2' Leaning Wall Climber		
		(1) 90262 -- 4' Upright, Alum		
		(1) 90263 -- 5' Upright, Alum		
		(3) 90264 -- 6' Upright, Alum		
		(3) 90265 -- 7' Upright, Alum		
		(6) 90266 -- 8' Upright, Alum		
		(5) 90267 -- 9' Upright, Alum		
		(4) 90268 -- 10' Upright, Alum		
		(1) 90269 -- 11' Upright, Alum		
		(1) 90508 -- 4' Double Zip Slide, Std Dk		
		(1) 90509 -- 5' Double Zip Slide, Std Dk		
		(1) 90516 -- Wide Rng Encl Dbl Mold S. Whl Bar Abov		
		(1) 90573 -- Scramble Up (3'-6" To 5'-0")		
		(1) 90610 -- Contoured Panel (Above)		
		(1) 90619 -- Ergo Climber (4'-0" & 4'-6")		
		(1) 90626 -- Fun-L Crawl Tube Attachment		
		(1) 90674 -- Std Access Ramp Link 3 Dk Gr		
		(1) 90676 -- Std Access Ramp Link Gr 2'-6" & 3'		
		(1) 90677 -- Std Access Ramp Link Gr 3'-6" & 4'		
		(1) 90834 -- 3-in-a-Row Panel		
		(1) 90868 -- Splitter 6'		
		(5) 91139 -- Entryway - Barrier		
		(2) 91365 -- Sensory Wave Panel w/ stained glass		
		(1) 91471 -- 1' Sensory Wave Ramp Att. II		
		(1) 91543 -- 8-Post Canopy Square Deck (3 deck)		
		(1) 91551 -- Maracabasas Panel (Below Deck)		
		(1) 91566 -- Face Creator Half Panel		
		(1) 91587 -- Braille Panel		
		(1) 91600 -- HDPE Vertical Ladder 2'0"		
		(1) 91604 -- HDPE Vertical Ladder 4'0"		
		(1) 91711 -- Modern Transfer w/Guardrail 1' Rise		
		(2) 91721 -- Wayfinder Sign - Climb		
		(2) 91722 -- Wayfinder Sign - Slide		
		(1) 91725 -- Wayfinder Sign - Ramp		
		(1) 91751 -- Altus X Tower Foundation		
		(2) 91755 -- Altus Tower Barrier Panel		



GameTime c/o Cunningham Recreation
 PO Box 240981
 Charlotte, NC 28224
 800.438.2780
 704.525.7356 FAX

09/30/2024
 Quote #
 171736-01-05

Centennial Park (2024 Grant) - Option 3 (Revised)

Quantity	Part #	Description	Unit Price	Amount
		(2) 91764 -- AltusTower Slide Panel		
		(1) 91766 -- Altus X Tower Spiral Slide		
		(1) 91768 -- Altus X Tower Tube To Left		
		(1) 91771 -- Modern Hex Roof		
		(1) 91805 -- Communication Board		
		(1) 91829 -- 5" Upright Extension w/ Cap 6'		
		(6) 91830 -- 5" Upright Extension w/o Cap 6'		
		(4) G90262 -- 4' Upright, Galv		
		(1) G90266 -- 8' Upright, Galv		
		(10) G90268 -- 10' Upright, Galv		
		(1) G90269 -- 11' Upright, Galv		
		(7) G90273 -- 15' Upright, Galv		
1	RDU	GameTime - PowerScape Swings with Disc Swing [Basic: _____] [RotoPlastic: _____]	\$16,808.00	\$16,808.00
		(1) 5918SP -- Disc Swing Add-A-Bay		
		(1) 2983SP -- Two Play Swing End Bay, 8'		
		(1) 5145 -- Expression Swing 5" X 8'		
		(1) 81758 -- 5" Zero-G Chair (2-5)-Galv Chain		
1	6272	GameTime - Merry-Go-All [Basic: _____] [Roto Plastic: _____]	\$9,859.00	\$9,859.00
1	6245	GameTime - RoxAll See Saw [Accent: _____] [Basic: _____] [Roto Plastic: _____]	\$13,296.00	\$13,296.00
2	28009	GT-Site - 6' P/S Bench W/Back Inground [Basic: _____] [Coated Site: _____]	\$1,025.00	\$2,050.00
1	T111	GT-Site - Connections Bench 6' Surf Mt/Portable [RB Frame PC: _____]	\$1,500.00	\$1,500.00
1	14927	GameTime - NDS Play On Sign Package		
1	14928	GameTime - NDS Inclusive Play Sign Package		
1	178749	GameTime - Owner's Kit	\$89.00	\$89.00
1	POURED	GT-Impax - Poured in Place Rubber Safety Surfacing (SF)- <ul style="list-style-type: none"> Area: <u>5,333</u> Sq.Ft. Materials: (50% Standard Color / 50% Black) Depth: 4.5" for 10' CFH Freight to Site Installation of Rubber Surfacing Only; Regular Wages 	\$132,856.00	\$132,856.00
1	INSTALL	MISC - Installation of Above Equipment	\$78,055.00	\$78,055.00
1	INSTALL	MISC - Provision and Installation of Sub-Base	\$18,640.00	\$18,640.00
1	INSTALL	GameTime - Concrete Curbs (LF)	\$29,060.00	\$29,060.00



GameTime c/o Cunningham Recreation
 PO Box 240981
 Charlotte, NC 28224
 800.438.2780
 704.525.7356 FAX

09/30/2024
 Quote #
 171736-01-05

Centennial Park (2024 Grant) - Option 3 (Revised)

Quantity	Part #	Description	Unit Price	Amount
1	INSTALL	GameTime - ADA Ramp Access and Sidewalk Connection (5' x 15') to Parking Lot	\$4,195.00	\$4,195.00
1	INSTALL	GameTime - Drainage (LF)	\$4,895.00	\$4,895.00
1	INSTALL	MISC - Light Grading	\$18,640.00	\$18,640.00
1	2024 GT-Grant	<p>MISC - 2024 Matching Funds Grant-</p> <p>Grant Rules and Limitations:</p> <p>To qualify for up to 100% matching grant, list price of the qualifying playground system must exceed \$75,000, and payment in full must accompany your order. For play systems with a list price of less than \$75,000 and greater than \$25,000 with payment in full, GameTime playground grants are available with matching funds up to 80%. For play systems that exceed \$25,000, and purchased with credit terms, matching funds are available up to 65%. Matching funds are subject to rounding rules and may vary based on qualified purchase. No other offer, discount, or special programs can be used with this grant program. This special matching fund offer applies to PowerScape®, PrimeTime®, Xscape®, and Modern City® systems only. Up to 50% matching funds for select outdoor fitness equipment, including THRIVE®, Challenge Course, KidCourse, and The Stadium®. VistaRope®, freestanding net structures, TuffForms, Landmark Design, GTSymphony freestanding, other freestanding play products, and Play On! non-system events are not eligible for funding. All applications must be received and validated by the project administrator by October 18, 2024. GameTime reserves the right to decline any application for a GameTime grant. GameTime will accept grant orders until October 25, 2024, or until all eligible funds are disbursed, whichever comes first. Customer must be able to receive order by December 31, 2024, subject to transportation availability. GameTime reserves the right to terminate this offer at any time without notice. GameTime playground grants can only be applied to additional GameTime purchases and only in conjunction with the original purchase. Standard policies and warranties as listed in the 2024 GameTime Playground Design Guide apply. Freight and applicable sales tax are extra and not included. Other terms and restrictions may apply. Contact your local GameTime representative for complete details.</p>		
			Sub Total	\$578,505.00
			Grant	(\$127,396.01)
			Estimated Freight	\$14,917.81
			Total	\$466,026.80

Comments

* Site must be clear, level, free of obstructions, and accessible. Site should permit installation equipment access. Purchaser shall be responsible for unknown conditions such as buried utilities, tree stumps, bedrock or any concealed materials or conditions that may result in additional costs.



GameTime c/o Cunningham Recreation
PO Box 240981
Charlotte, NC 28224
800.438.2780
704.525.7356 FAX

09/30/2024
Quote #
171736-01-05

Centennial Park (2024 Grant) - Option 3 (Revised)

GAMETIME - TERMS & CONDITIONS:

- **PRICING:** Due to fluctuating economic conditions, pricing is valid for 30 days and is subject to change. Please request updated pricing if your quote is older than 30 days before making a purchase.
- **TERMS OF SALE:** For equipment & material purchases, Net 30 days from date of invoice for governmental agencies and those with approved credit. All others, full payment for equipment, taxes and freight up front. Balance for services & materials due upon completion or as otherwise negotiated upon credit application review. Pre-payment may be required for equipment orders totaling less than \$5,000. Payment by VISA, MasterCard, or AMEX is accepted (**If you elect to pay by credit card, GameTime charges a 2.50% processing fee that is assessed on the amount of your payment. This fee is shown as a separate line item and included in the total amount charged to your credit card. You have the option to pay by check, ACH or Wire without any additional fees.**). Checks should be made payable to Playcore Wisconsin, Inc. dba GameTime unless otherwise directed. **Any order exceeding \$300,000 will require progress payments during the course of completion.**
- **CREDIT APPLICATION:** Required for all non-governmental agencies and those entities who have not purchased from GameTime within the previous twelve calendar months.
- **FINANCE CHARGE:** A 1.5% monthly finance charge (or maximum permitted by law) will be added to all invoices over 30 days past due.
- **CASH WITH ORDER DISCOUNT:** Orders for GameTime equipment paid in full at time of order via check or electronic funds transfer (EFT) are eligible for a 3% cash-with-order (CWO) discount. Consult local sales representative for CWO terms.
- **ORDERS:** All orders shall be in writing by purchase order, signed quotation or similar documentation. Purchase orders must be made out to Playcore Wisconsin, Inc. dba GameTime.
- **FREIGHT CHARGES:** Shipments shall be F.O.B. destination. Freight charges prepaid and added separately.
- **SHIPMENT: Standard Lead time is 6-8 weeks (some items may take longer)** after receipt and acceptance of purchase order, credit application, color selections and approved drawings or submittals.
- **PACKAGING:** All goods shall be packaged in accordance with acceptable commercial practices and marked to preclude confusion during unloading and handling.
- **RECEIPT OF GOODS:** Customer shall coordinate, receive, unload, inspect and provide written acceptance of shipment. Any damage to packaging or equipment must be noted when signing delivery ticket. If damages are noted, receiver must submit a claim to Cunningham Recreation within 15 Days. Receiver is also responsible for taking inventory of the shipment and reporting any concealed damage or discrepancy in quantities received within 60 days of receipt.
- **RETURNS:** Returns are only available on shipments delivered within the last 60 days. A 25% (min.) restocking fee will be deducted from any credit due. Customer is responsible for all packaging & shipping charges. Credit is based on condition of items upon return. All returns must be in unused and merchantable condition. GameTime reserves the right to deduct costs associated with restoring returned goods to merchantable condition. Uprights & custom products cannot be returned.
- **TAXES:** Sales tax is shown as a separate line item when included. A copy of your tax exemption certificate must be submitted at time of order or taxes will be added to your invoice.

INSTALLATION CONDITIONS:

- **ACCESS:** The site must be clear, level, and provide unrestricted access for trucks and machinery. Any site that is inaccessible may incur additional charges.
- **STORAGE:** The customer is responsible for providing a secure area for off-loading and storing equipment during installation. Once equipment is delivered to the site, the owner assumes responsibility for any theft or vandalism unless alternative arrangements are made and documented in the quotation.
- **FOOTER EXCAVATION:** Installation pricing is based on footer excavation through earth/soil only, prior to the installation of drains, subbase, or surfacing. The customer is responsible for any unforeseen conditions such as buried utilities (public or private), tree stumps, rocks, or any other concealed materials or conditions that may result in additional labor or material costs.
- **UTILITIES:** The installer will contact 811 to locate all public utilities before layout and excavation of footer holes. The owner is responsible for identifying any private utilities. Cunningham Recreation and the installer are not liable for any damage to unmarked private utilities.
- **ADDITIONAL COSTS:** Pricing is based on a single mobilization for installation unless otherwise stated. The price includes only the items specified in this quotation. Additional site work or specialized equipment needs may result in price adjustments.
- **SITE CONDITIONS:** The site must have a slope of less than 1.5%. Any excavation or grading required to achieve an acceptable slope is the responsibility of others unless otherwise noted. All demolition and site preparation must be completed before the installation crew is mobilized.
- **GENERAL INSTALLATION NOTES:** Installation will be performed according to the manufacturer's specifications by a GameTime-certified installer. A one-year warranty on all labor is provided from the date of completion. Product warranty and service claims may not include labor.



GameTime c/o Cunningham Recreation
PO Box 240981
Charlotte, NC 28224
800.438.2780
704.525.7356 FAX

09/30/2024
Quote #
171736-01-05

Centennial Park (2024 Grant) - Option 3 (Revised)

ACCEPTANCE OF QUOTATION:

Acceptance of this proposal indicates your agreement to the terms and conditions stated herein.

Accepted By (printed): _____ Title: _____

Telephone: _____ Fax: _____

P.O. Number: _____ Date: _____

Purchase Amount: **\$466,026.80**

SALES TAX EXEMPTION CERTIFICATE #: _____

(PLEASE PROVIDE A COPY OF CERTIFICATE)

Salesperson's Signature

Customer Signature

BILLING INFORMATION:

Bill to: _____

Contact: _____

Address: _____

Address: _____

City, State: _____ Zip: _____

Tel: _____ Fax: _____

E-mail: _____

SHIPPING INFORMATION:

Ship to: _____

Contact: _____

Address: _____

Address: _____

City, State: _____ Zip: _____

Tel: _____ Fax: _____

E-mail: _____

MATERIAL COLOR OPTIONS

METAL	PLASTIC	HDPE	2 COLOR HDPE
Black		Black	Black/White
Starlight Black	Champagne		
Metallic		Dolphin Gray	Gray/Black
White			White/Black
Vanilla	Beige	Beige	Beige/Green
Champagne			
Beige	Brown	Brown	Brown/White
Brown			
Bronze	Green	Green	Green/White
Dark Green			
Green	Chartreuse		
Sage		Spring Green	Spring Green/White
Ice Butter	Spring Green		
Ice Mint			
Chartreuse	Azure	Azure	Azure/White
Spring Green			
Ocean	Sky Blue	Sky Blue	Sky Blue/White
Azure			
Sea Mist	Blue	Blue	Blue/White
Sky Blue	Periwinkle	Purple	Purple/White
Blue	Royal Purple	Burgundy	Burgundy/White
Periwinkle			
Royal Purple	Burgundy	Red	Red/White
Burgundy	Red	Orange	Orange/White
Red	Orange		
Orange	Yellow	Yellow	Yellow/Black
Butterscotch			
Yellow			

Actual colors may differ from the images represented here. Contact your local GameTime representative for sample materials.

MATERIAL COLOR OPTIONS

SHADE FABRIC

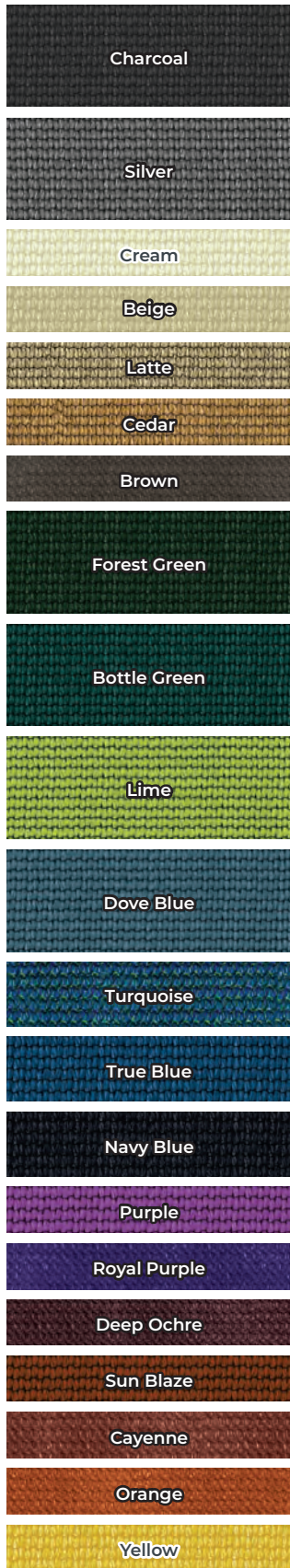

VISTAROPÉ™ STANDARD

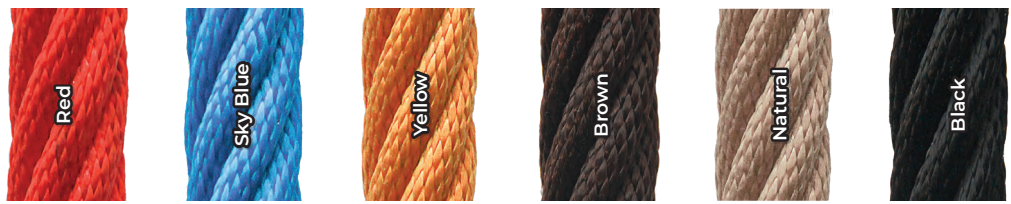

VISTAROPÉ™ CUSTOM

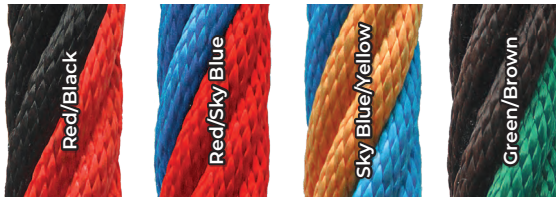

*Colors for VistaRope products only. All standard GameTime ropes are black.

SPECIAL ROCK

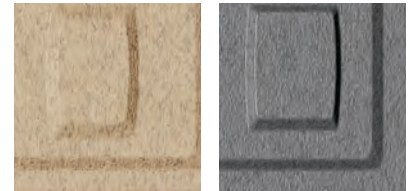

Sandstone

Deep Granite

WALLCANO® HANDHOLDS



Red

Green

Blue

Beige

SITE RECYCLED PLASTIC LUMBER

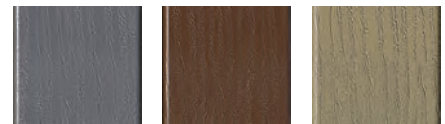

Gray

Tudor

Sand

DECKS

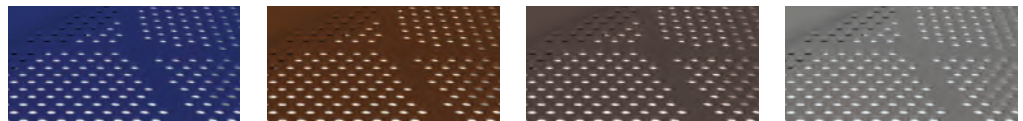

Blue

Brown

NEW! Chocolate

Gray