

An aerial photograph of a green soccer field with white boundary lines. A semi-transparent green rectangular box is overlaid on the left side of the field, containing white text. The field has several players visible, and a large white circle is marked in the center. The background shows a paved area and some trees.

Exhibit 2 - Staff Presentation-Bartlett

Park Board
January 5, 2023

Presented by Jen Basham, Director of Parks and Recreation

Overview

- ① Background
- ② Current Layout
- ③ New Layout
- ④ Project Scope
- ⑤ Bid Summary
- ⑥ Timeline
- ⑦ Action Options

Background

- The City has a long standing partnership with Burleson Soccer Association to manage soccer leagues for the community. The current site at Bartlett is maintained by BISA, and the City funds the utilities and surrounding maintenance for the park
- 2016 - Bartlett Park Soccer Complex built with 16 fields on 8 acres of City property adjacent to the Recreation Center
- 2021 - Burleson Independent Soccer Association (BISA) inquires about possibility to have fields renovated due to severe grading issues which caused safety concerns
- Early 2022 - Soccer field renovations added to Parks and Recreation's Capital Improvement Program (CIP) to address turf and grading issues identified
- Spring 2022 - Parks met with BISA to collect feedback on ideal layout for soccer programming at site
- Summer 2022 - Entered into agreement with Kimley Horn and Associates for renovation and grading plans for soccer fields

Current Layout-16 total fields, with 14 usable fields

Challenges with grading exist across all 16 fields, fields 8 & 10 have become unusable for play due to conditions

Current State

AGE GROUP	FIELD COUNT
-----------	-------------

U4	2
U5 to U6	4
U7 to U8	4
U9 to U10	2
U11 to U12	2
U13 and Above	0
Total Fields	14

- Field #8 & #10 currently unusable due to grading issues
- No U13+ field currently at Summercrest
- U7-U8 fields located far south end of facility away from restrooms and playground

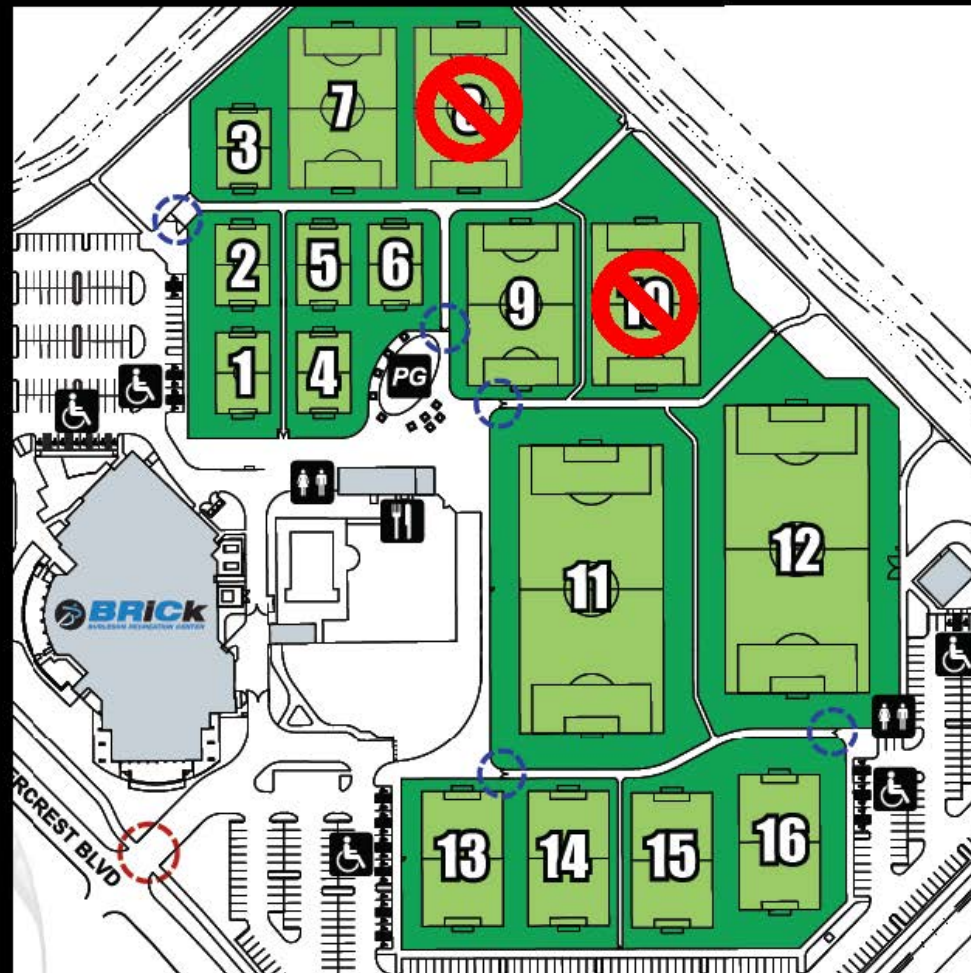



Proposed State

AGE GROUP	FIELD COUNT
U4	2
U5 to U6	4
U7 to U8	4
U9 to U10	4
U11 to U12	2
U13 and Above	1
Total Fields	17

Changes:

- Plus 2 U9-U10 Fields
- Plus 1 U13+ Field
- All U8 and below fields located on North end of facility closer to restrooms and playground.

-  = Preferred Lighting Layout
-  = Possible Shade Sites



Lighting and shade was not included as part of the scope of this project.
BISA has provided preferred lighting layouts as a future CIP request

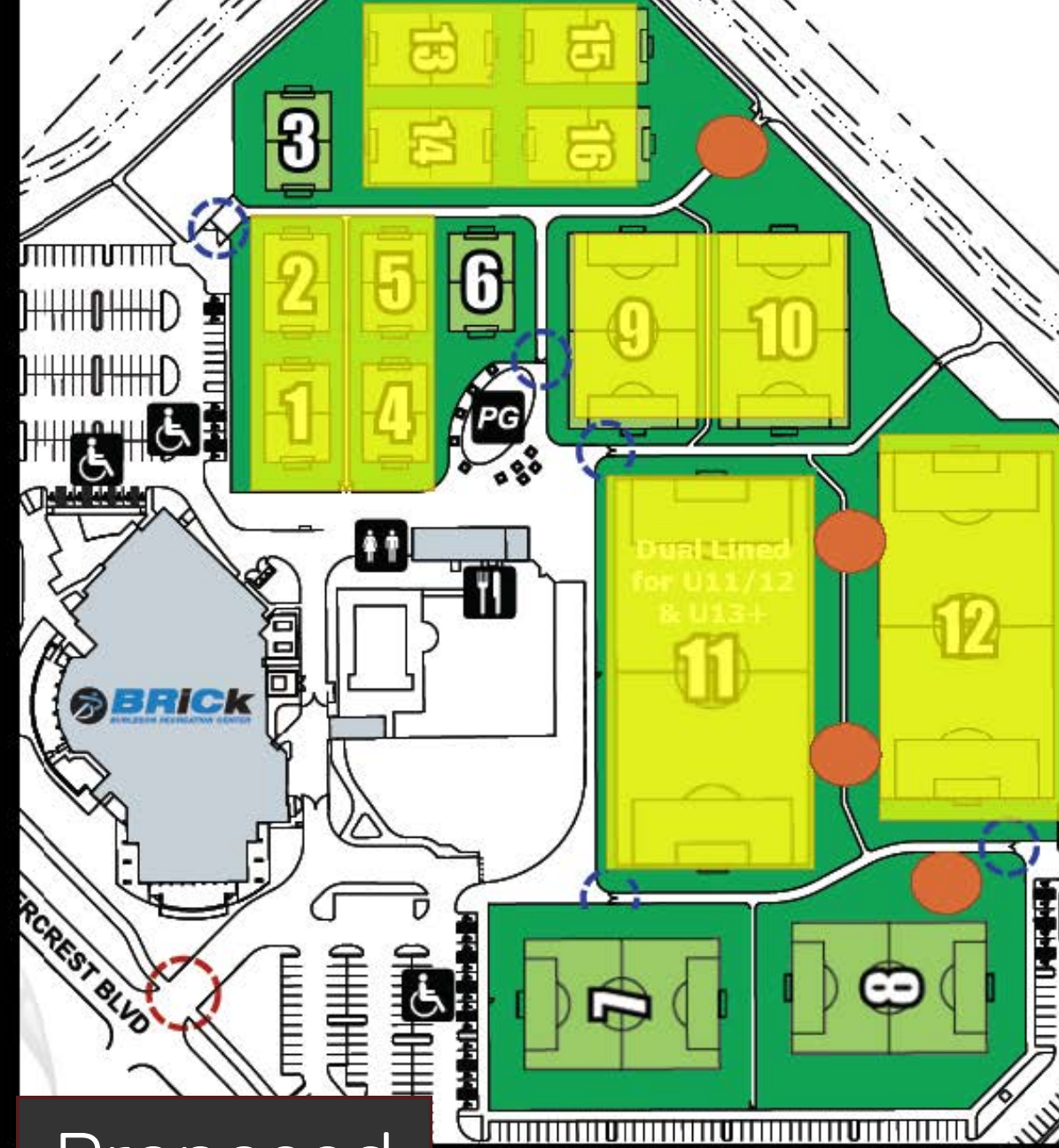
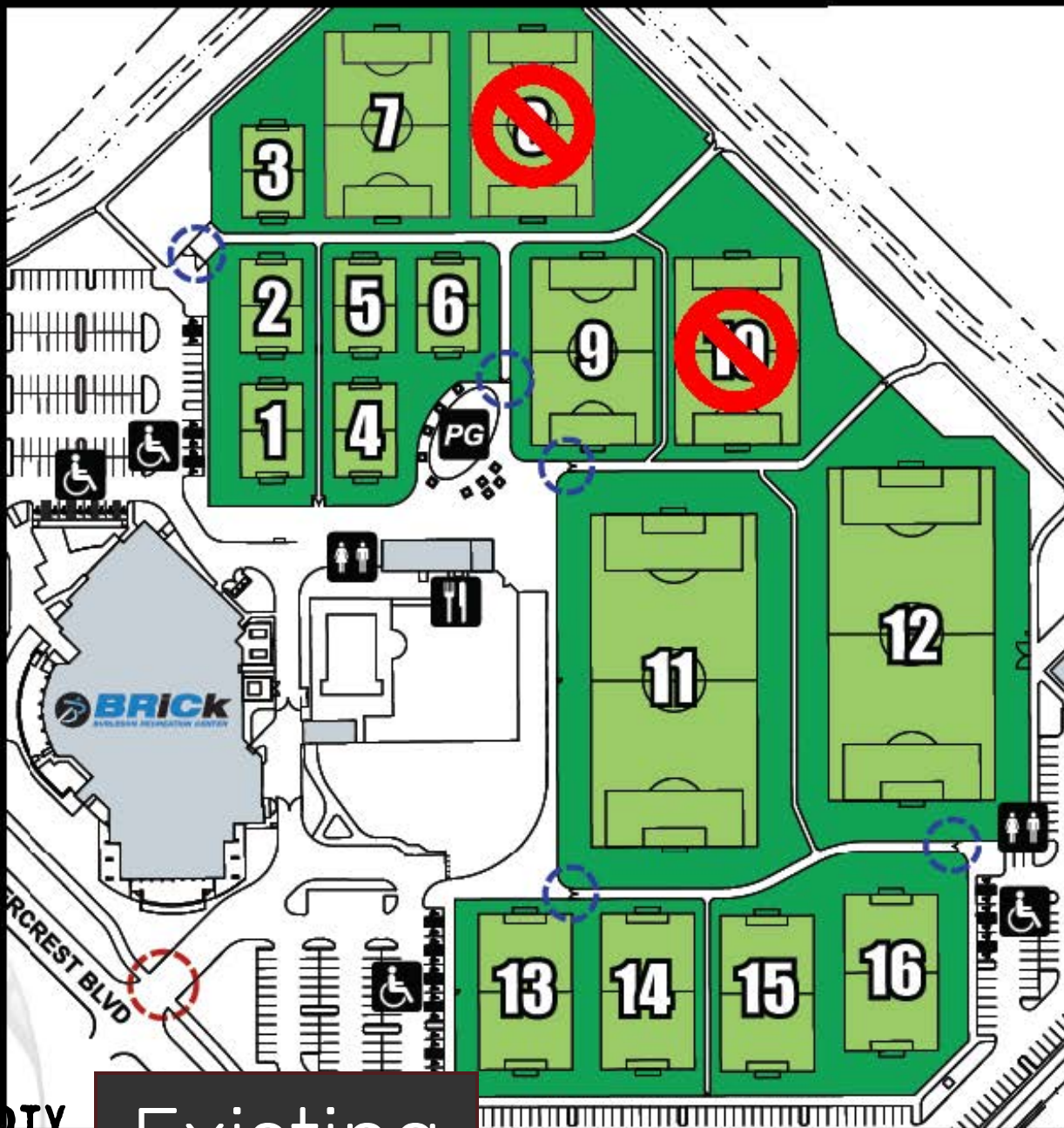

Existing

Proposed

Project Scope

- Regrading to area to maximize drainage, playability and safety within floodplain and floodway compliance
- Installing irrigation to new layout
- Amending soils with approved materials
- Planting new Latitude 36 Bermudagrass sod on all fields and common areas within complex for better quality of play
- Removed unnecessary connector paths to maximize playable areas
- Improved layout to better maximize playability and user experience for families with kids in multiple age groups



Bid Summary



- Funding: \$1,500,000 has been programmed into the FY 2023 Parks CIP for this project
- RFB was issued and scored on the following criteria:
 - Cost of Goods
- Total Qualified Bids: 4
- Bid Range:
 - High \$1,589,723.90
 - Low \$1,002,698.60
- Recommended Best Overall Value
 - Contractor: G Rod Construction
 - Bid:\$1,002,698.60
 - This includes 10% contingency of \$100,269.86

Estimated Timeline

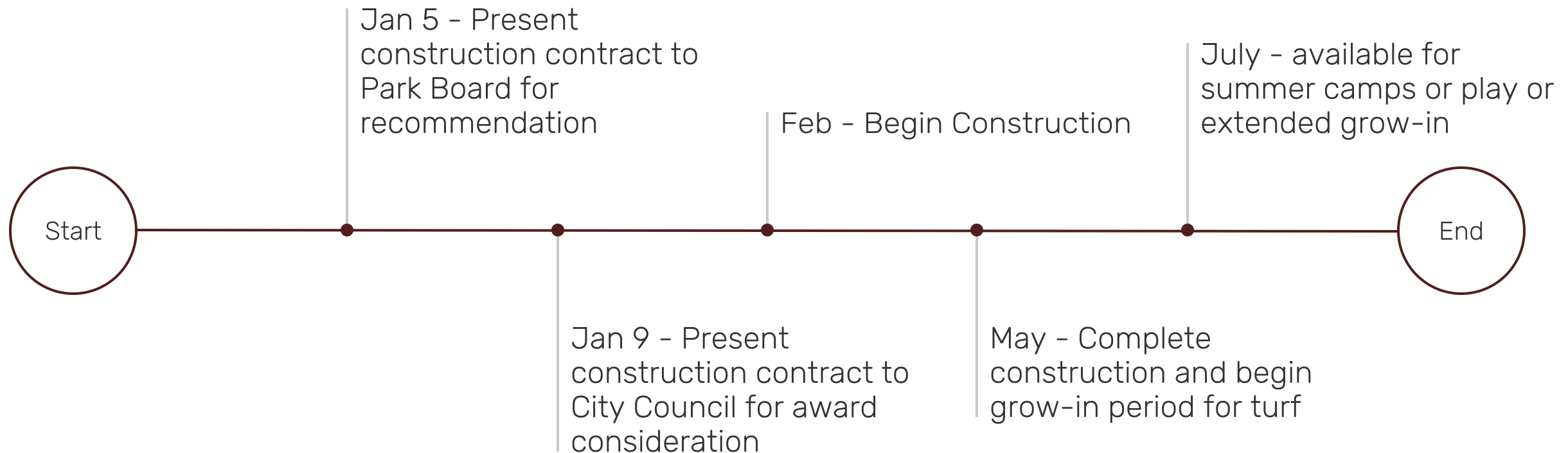

Options

Staff recommendation



Recommend awarding a contract
with G Rod Construction in the
amount of \$1,002,698.60 for the
construction of soccer fields at
Bartlett Park



Deny