

A TRACT OF LAND SITUATED IN THE DENNIS EVES SURVEY, ABSTRACT NO. 229, JOHNSON COUNTY, MISSOURI, BEING A PORTION OF A TRACT OF LAND CONVEYED TO ANIMAL FARMERS, LLC, IN AND TO BE SHOWN AS A TRACT OF LAND, CONVEYED TO THE TEXAS OIL FIELD, SAID TRACT ALSO BEING A PORTION OF A TRACT OF LAND CONVEYED TO JAMES CLIFTON ANSTROM AND DESCRIBED AS TRACT 1 IN THAT DEED RECORDED IN VOLUME JAMES CLIFTON ANSTROM AND DESCRIBED AS TRACT 2 IN THAT DEED RECORDED IN VOLUME JAMES CLIFTON ANSTROM AND DESCRIBED AS TRACT 2 IN THAT DEED RECORDED IN VOLUME 2080, PAGE 282, D.O.C.T. AND TOGETHER WITH A PORTION OF A TRACT OF LAND CONVEYED TO JAMES CLIFTON ANSTROM AND DESCRIBED AS TRACT 2 IN THAT DEED RECORDED IN VOLUME 2080, PAGE 282, D.O.C.T. AND BEING MORE PARTICULARLY DESCRIBED BY ARTICLES AND BONDS AS FOLLOWS:

[illegible]

THENCE N 19°30.36' W ALONG SAID NORTHEASTERLY RIGHT-OF-WAY LINE, A DISTANCE OF 855.08 FEET TO A 1/2" IRON ROD SET WITH A CAP STAMPED "RPLS 5544";

THENCE N 15°52.01' W, A DISTANCE OF 285.81 FEET TO A 1/2" IRON ROD SET WITH A CAP STAMPED "RPLS 5544", AND THE BEGINNING OF A NON-TANGENT CURVE TO THE RIGHT WITH A RADIUS OF 1384.22 FEET AND WHOSE LONG CHORD BEARS N 01°27'05" E, 108.66 FEET;

THEENCE CONTINUING ALONG SAID NON-TANGENT CURVE TO THE RIGHT THROUGH A CENTRAL ANGLE OF 04°29'56", AN ARC LENGTH OF 108.69 FEET TO A 1/2" IRON ROD SET WITH A CAP STAMPED "RPLS 5544";

THESE CONTINUING ALONG SAID TANGENT CURVE TO THE LEFT THROUGH A CENTRAL ANGLE OF 57°19'28", AN ARC LENGTH OF 777.67 FEET TO A 1/2" IRON ROD SET WITH A CAP STAMPED "R/L 5544".

THENCE N 30°38'56" W, A DISTANCE OF 37.19 FEET TO A TXDOT MONUMENT FOUND;  
THENCE N 09°24'28" E, A DISTANCE OF 44.37 FEET TO A TXDOT MONUMENT FOUND;

THENCE N 44°08'07" E, A DISTANCE OF 711.93 FEET TO A TXDOT MONUMENT FOUND

THENCE N 43°29'46" W, A DISTANCE OF 25.47 FEET TO A TXDOT MONUMENT FOUND IN THE SOUTHEASTERLY RIGHT-OF-WAY LINE OF FARM TO MARKET HIGHWAY NO. 1902 (80° R-O-W);

THEENCE N 46°16'14" E ALONG SAID SOUTHEASTERLY RIGHT-OF-WAY LINE, A DISTANCE OF 912.52 FEET TO A 1/2" IRON ROD SET WITH A CAP STAMPED "RPLS 5544" AND THE BEGINNING OF A NON-INGANT CURE TO THE LEFT WITH A RADIUS OF 1948.88 FEET AND WHOSE LONG CHORD BEARS N 36°58'36" E, 645.08 FEET;

THESE CONTINUING ALONG SAID NON-TANGENT CURVE TO THE LEFT THROUGH A CENTRAL ANGLE OF 190°31.0". AN ARC LENGTH OF 646.06 FEET TO A 1/2" IRON ROD FOUND WITH A CAP STAMPED "RRLS 5544" FOR THE MOST SOUTHWESTERLY CORNER OF A TRACT OF LAND CONVEYED TO BURLINSON 4A ECONOMIC DEVELOPMENT CORPORATION IN THAT DEED RECORDED IN INSTRUMENT NO. 2021-22172. D.R.J.C.11;

THE SOUTHWEST LINE OF SAID BURELSON 4A ECONOMIC DEVELOPMENT CORPORATION TRACT, A DISTANCE OF 6,700 FEET TO A 1/2" MON RAIL FOUND FOR THE MOST SOUTHERLY CORNER OF THE SAID BURELSON 4A ECONOMIC DEVELOPMENT CORPORATION TRACT, THE SOUTHWEST CORNER OF THE SAID BURELSON 4A ECONOMIC DEVELOPMENT CORPORATION TRACT, A DISTANCE OF 2026.17 FEET TO THE POINT OF BEGINNING AND CONTAINING 130,446 ACRES OF LAND, MORE OR LESS.

BASIS OF BEARINGS ARE BASED ON NORTH AMERICAN DATUM OF 1983, TEXAS NORTH CENTRAL ZONE, DERIVED FROM GPS OBSERVATIONS.

PREPARED BY ME OR UNDER MY DIRECTION PURSUANT TO 22 TEXAS  
ADMINISTRATIVE CODE § 138.95.

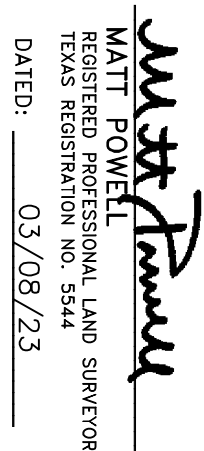

0' 150' 300'

SCALE: 1" = 150'

AN AERIAL EXHIBIT OF  
**130.446 ACRES**  
OF LAND SITUATED IN THE  
DENNIS DYKES SURVEY  
ABSTRACT NO. 229  
JOHNSON COUNTY, TEXAS