

F3. Brian Dwiggins for Borealis Coffee Company, LLC., 500 Wood Street Unit 113, Request for One Additional Class BV Liquor License **(continued from September 29, 2011)**

F3a. General Planning Concept and Summary of Unity Park- presented by Joe Brito and John H. Lusk, RA, AIA

F3b. Recommendation from Town Administrator and Fire Chief

F3c. Recommendation from Town Administrator and Police Chief

F3d. Recommendation – Town Administrator and Director of Community Development

Sweeney/Teixeira- Voted unanimously to refer to the solicitor to prepare an ordinance amendment to increase the number of BVL (limited) liquor licenses by one; and call for public hearing.

Prior to the vote taken, the petitioner Brian Dwiggins of 144 Whipple Road, Smithfield, RI spoke on behalf of the request. Mr. Dwiggins apologized for his absence at the September 29, 2021 council meeting. He explained to the council that he and his wife, and partner in the business, were eager to grow and evolve their business. Mr. Dwiggins explained to the council that they currently operate a café in Riverside and he provided the council with a history of their establishment.

Mr. Dwiggins noted that they were looking to add craft cocktails and create a space that would be a catalyst for the community.

Mrs. Jess Dwiggins of 144 Whipple Road, Smithfield, RI also spoke on behalf of the request. She explained that they were looking to create a space that would allow for open mic nights, game nights, weekend brunches, and a space where people can go for a dessert and after dinner drink.

Mr. Dwiggins noted that based on prior experience, the establishment for selling coffee, and no liquor, was not

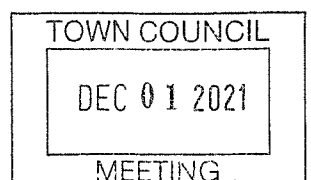

sustainable after 3pm. He stated that they didn't want to be closing the café at a time the other establishments in Unity Park were opening.

Mrs. Jess Dwigginns stated that they were in previous negotiations with the town of Warren and had plans of opening their new business in Warren. She said that the developer of Unity Park, Mr. Joseph Brito, had reached out to them to consider opening their establishment in Bristol.

Vice Chairwoman Parella stated that she thought the concept was a "great Idea". She stated that the town looked forward to Unity Park becoming successful; and that it was a big win to have the establishment located in Bristol.

Councilman Ley stated that he had recently visited the Borealis Coffee shop in Riverside; and that he would be in support of the petition based on the recommendations and the closing time of 10pm.

Councilman Sweeney stated that he was excited about the culture of the business and launching it in the Unity Park Development. He stated it would be an economic driver and is in support of granting a full liquor license.

Councilman Teixeira stated that he had recently walked around Unity Park. He explained that there was a recent creation of a full liquor license in the development that had not opened yet. He stated that he would have an issue with granting another full liquor license upfront without understanding the impact on the surrounding neighborhood.

Vice Chairwoman Parella stated that the consideration made for Borealis Coffee may set pertinence to other coffee shops looking to do the same. She asked the petitioners if it would be feasible for the business to start off with a limited liquor license.

Mrs. Jess Dwigginns responded that they didn't want to miss out on the synergy of the distillery opening next door; and that their intent was to capture their clientele right at the beginning and avoid not making a good first impression.

Chairman Calouro stated that he could not support a full liquor license request at this time; however, he would agree to a limited liquor license. He explained that it had been the town's past practice to issue a limited, beer and wine, license with a

review in six months before considering a full liquor license. He stated that there were two establishments set to open with liquor licenses and a brewery. He explained that he would have to consider the impact that would have on the neighborhood before considering another full liquor license.

Developer Joseph Brito of 161 Poppasquash Road addressed the council. Mr. Brito explained that he understood the notion that the first impression was always the best impression. He also understood the council's authority to issue a limited liquor license with a review in six months before considering a full liquor license. He asked that the council may consider reversing the process and issuing a full liquor license first and then review in six months, based on all the positive recommendations.

Mr. Brito noted that he was concerned that the business may lose momentum and that he wanted to ensure customers returned.

Mr. Brito asked the council to consider the value of the development of Unity Park on the surrounding neighborhoods. He explained that the improvements made in Unity Park have also increased the value of homes in the neighborhood.

Councilman Ley stated that he was aware of the concerns of the surrounding neighborhood; however he noted that since the request for a Full liquor License would require a public hearing, the neighbors would essentially have an opportunity to voice their opinions. He suggested that the council consider full liquor licenses requests on a case by case basis.

Councilman Sweeney noted the business would bring value to Bristol and he would hate to lose a good business to another town.

Assistant Solicitor Teitz explained that there is no written policy on issuing a limited license with a six month review period before considering a full license. He noted that it has been past practice and it is per the council's discretion. He also noted that the process for rescinding a liquor license is not an easy process.

Chairman Calouro said that he wanted to be fair and consistent and that he wanted to be courteous of the surrounding neighbors.

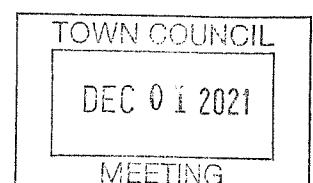
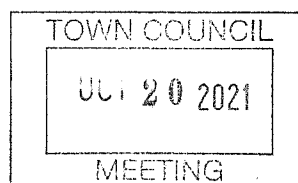



LICENSE REQUEST: BV LTD. INTOXICATING
BEVERAGE LICENSE

PETITION TO THE TOWN COUNCIL:

To the Honorable Town Council of the Town of Bristol:
The undersigned hereby respectfully requests of your
Honorable Body to be granted a

BV LTD INTOXICATING BEVERAGE LICENSE

FOR:

(NAME OF ESTABLISHMENT)

BOREALIS COFFEE COMPANY, LLC

AT:

(ADDRESS OF ESTABLISHMENT)

500 Wood St, Unit 113
Bristol 02809

BY:

(NAME OF APPLICANT)

BRIAN DWIGGINS

**** PLEASE ATTACH SKETCH INDICATING THE AREAS FROM WHICH
LIQUOR WILL BE SERVED AND CONSUMED.**

Fee for License: \$500 per year plus advertising and
certified mailing costs

Also required is ~~Victualing~~ License: \$75/year
(Payable after Council approves the license.)

Please attend the Council
Meeting on:

*SIGNATURE: _____

NAME: BRIAN DWIGGINS

(PLEASE PRINT NAME OF APPLICANT)

ADDRESS: 144 WHIPPLE RD

(ADDRESS OF APPLICANT)

TOWN: SMITHFIELD, RI 02917

DATE OF BIRTH: _____

BUSINESS TELEPHONE #: 401-429-8774 (cell)

HOME TELEPHONE #: _____

Date Received: 10/25/21

TAX STAMP

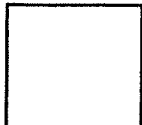

TO BE USED BY FINANCE
DEPARTMENT

*BY SIGNING THIS PETITION, I CONSENT TO EXAMINATION AND
RELEASE OF RECORDS AND INFORMATION REGARDING MY
BACKGROUND, INCLUDING POLICE RECORDS, EDUCATIONAL
INFORMATION, RESIDENCE RECORDS, AND ANY COURT
RECORDS.

TOWN COUNCIL

DEC 01 2021

TOWN CLERK'S OFFICE
BRISTOL, RHODE ISLAND
2021 OCT 25 AM 9:25

STATE OF RHODE ISLAND

CITY/TOWN OF BRISTOL

BOARD OF LICENSE COMMISSIONERS
APPLICATION FOR LIQUOR LICENSE

RETAILER CLASS: A___BH___BM___BT___BV___BVL___C___E___ED___J___T___ 2:00 A.M. ___

Business Structure: ☐ Corporation ☐ Partnership ☒ LLC ☐ Individual

BOREALIS COFFEE COMPANY, LLC
Name of Applicant/Corporation

D/B/A

500 WOOD ST UNIT 113 BRISTOL RI 02809
Address of Premise

401-429-8774 brian@borealiscoffee.com
Phone Number of Business Email Address

State - Incorporated: Rhode Island Date of Incorporation: April 18 2014

Name, Address, Telephone of all Officers/Members with percentage ownership:

<u>BRIAN DWIGGINS</u>	<u>144 WHIPPLE RD SMITHFIELD, RI</u>	<u>401-429-8774</u>	<u>50</u>
President/Member Name	Address	Phone	% Ownership
<u>JESSIE DWIGGINS</u>	<u>144 WHIPPLE RD SMITHFIELD, RI</u>	<u>401-862-6319</u>	<u>50</u>
Vice President/Member Name	Address	Phone	% Ownership
Secretary/Member Name	Address	Phone	% Ownership
Treasurer/Member Name	Address	Phone	% Ownership

Name and Address of All Directors or Board Members, with percentage ownership:

Name	Address	Phone	% Ownership
Name	Address	Phone	% Ownership
Name	Address	Phone	% Ownership

If application is on behalf of undisclosed principal or party, please give details:

Does Applicant Own Premises? Yes___NoX Is Property Mortgaged? Yes___NoX or Leased? YesXNo___

Give Name and Address of Mortgagee (Bank or Mortgage Holder) or Lessor (Landlord) and Amount of Extent

TUPELO REALTY, LLC 99 TUPELO ST, BRISTOL RI \$3500/MO - 3 YEARS
Name Address Amount - Term

Have any Officers, Members or Stockholders ever been arrested or convicted of a crime? Yes ___ No ☒ If yes, explain:

Is any other business to be carried on in Licensed Premises? Yes ☒ No ___ If yes, explain:

coffee shop w/ food program throughout the day. Same entity, though.

Is Applicant or any of its Officers, Members or Stockholders interested directly or indirectly, as principle or associate, or in any manner whatsoever, in any retail license issued under Title 3 of the RI General Laws? If yes, explain:

No

Is Applicant the owner or operator of any other business? If yes, explain:

Partners in Coffee Pathway, LLC - real estate holding company. Jessie Driggins: Yogurt Wellness, LLC

State amount of capital invested in the business?

For this location - estimate of \$250,000 (just beginning build out as of this application)

Do you have now, or will you be installing, a draught system Yes ___ No ☒

I hereby certify that the above statements are true to the best of my knowledge and belief:

Applicant Signature

9/16/21
Date

1. Every question on Application Form must be answered. Any false statement made by the Applicant will be sufficient grounds for the denial of the application or the revocation of the license in case one has been granted.
2. Corporation having 25 or more stockholders need not file a list of the names and addresses of stockholders - (Question #8)
3. Attention is called to the requirements RIGL §3-5-10:
 - (A) All newly elected officers, members, or directors must be reported to the Board of License Commissioners within 30 days.
 - (B) Any acquisition by any person of more than ten per cent (10%) of any class of corporate stock must be reported within 30 days.
 - (C) Any transfer of fifty percent (50%) or more of any class of corporate stock can be made only by written application to the licensing board subject to the procedures for a transfer of a license.

APPLICATION FOR TRANSFER OF LICENSE ONLY

Transfer of Location _____ Name _____ Stock _____ Current Retail Class _____

Name of Transferor (applicant/old owner) _____

d/b/a _____

Address _____

The above hereby petitions the Licensing Board to transfer the said license to:

New Location (If any): _____

New Name (If any): _____

If change of stockholders, list old and new stockholders: _____

Signature of Transferor (old owner) _____

Date _____

Signature of Transferee (New Owner) _____

Date _____

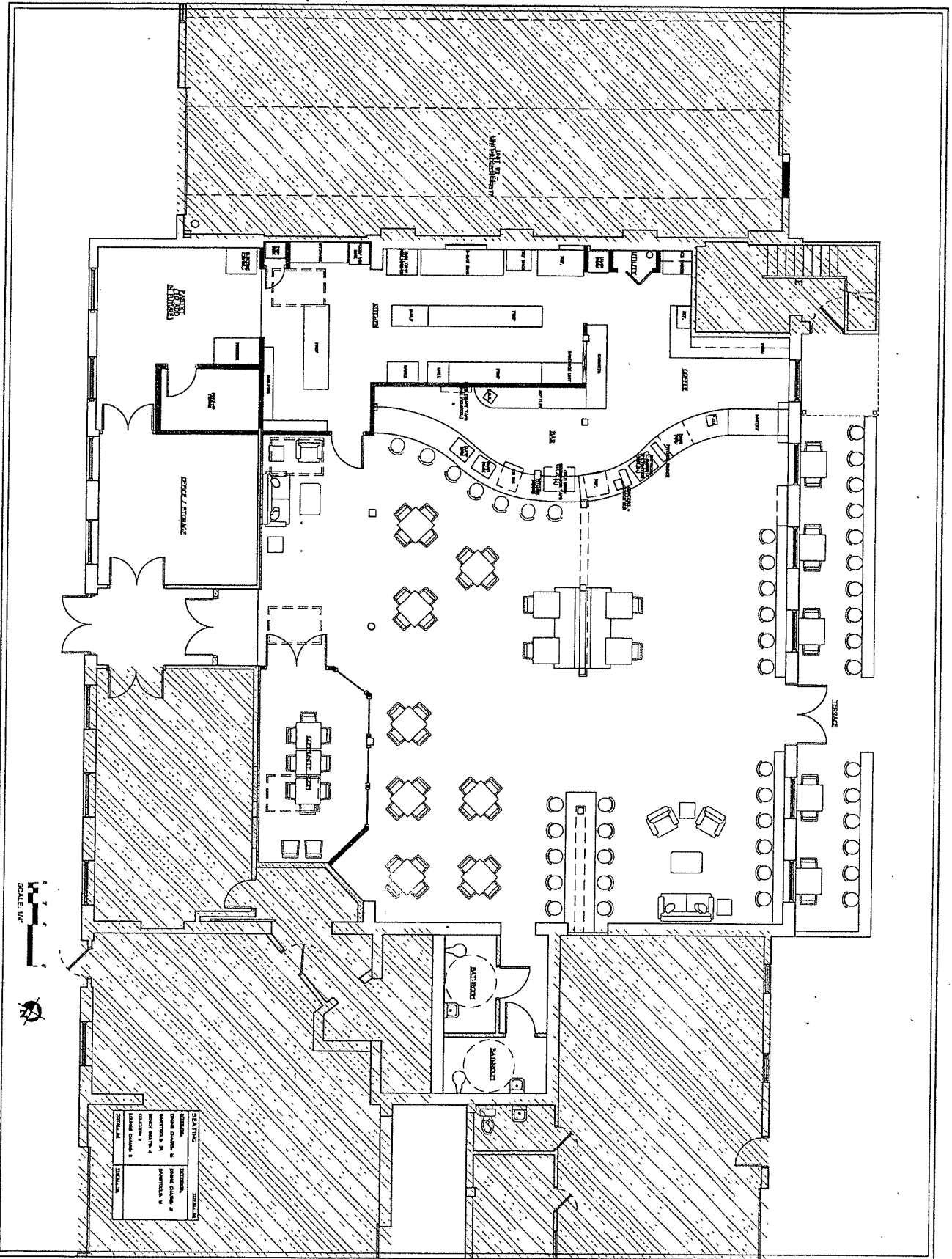

DATE: 07/20/00
DRAWN BY: J.S. GIL
PROJECT NUMBER: 7401

SCALE: 1/4" = 1'-0"

LECTURE
ARCHITECT: HIGHER, P.C.
180 HIGH STREET • BRISTOL, RI 02809
401.386.8850 • FAX 401.410.0078

TENANT FIT-OUT
FOR:
BOREALIS COFFEE COMPANY
500 WOOD STREET
BRISTOL, RI 02809
PLAN

ISSUED FOR:
OWNER REVIEW
PRELIMINARY ONLY
NOT FOR CONSTRUCTION

NOTES:
1. THIS PLAN IS A PRELIMINARY DESIGN AND IS NOT TO BE USED FOR CONSTRUCTION.
2. THE CLIENT IS RESPONSIBLE FOR OBTAINING ALL NECESSARY PERMITS AND APPROVALS.
3. THE CLIENT IS RESPONSIBLE FOR OBTAINING ALL NECESSARY INSURANCE COVERAGE.
4. THE CLIENT IS RESPONSIBLE FOR OBTAINING ALL NECESSARY CONTRACTS.
5. THE CLIENT IS RESPONSIBLE FOR OBTAINING ALL NECESSARY SCHEDULES.

LEGEND:
SEATING: 1. ROUND TABLES, 2. SQUARE TABLES, 3. LONG TABLES, 4. BAR SEATING, 5. KITCHEN, 6. RESTROOM, 7. STORAGE, 8. ENTRY, 9. LOBBY, 10. CONFERENCE ROOM, 11. OFFICE, 12. BREAK ROOM, 13. JANETRY, 14. ELEVATOR, 15. STAIRS, 16. MECHANICAL, 17. ELECTRICAL, 18. PLUMBING, 19. HVAC, 20. OTHER.

Borealis Bristol Bar Floorplan Description

Hours of Operation:

Full café hours:

Open at 6 am M-F, 7 am on weekends

Close at 8 pm Sunday – Thursday, 10 pm on Friday/Saturday

Bar Hours (tentative to be discussed with Town Council)

Monday – Friday alcohol available from 2 - close pm

Weekends, from 10 am (brunch) – close

The yellow highlighted area is the alcohol service area. Alcoholic beverages will only be available for customer pickup at the bar, with one drink per customer (or proof of ID for any additional drinks).

We will not be offering table service or employ a regular wait staff. The exception is if people order food and drink together, in which case a staff member will run the order to the table after the order was placed at the bar or counter.

The blue highlighted area will be for an occasional jazz combo, musician, or entertainer. We only have space for 3-4 piece jazz combos or small acoustic acts and do not intend to have large or loud performances.



MENU

BREAKFAST

Available Starting at 7 AM

Strictly Biscuit

3

House made biscuit with house strawberry jam and butter

Borealis Breakfast Sando

6

Two eggs over a homemade biscuit with cabot white cheddar. Add turkey bacon, avocado, tomato, and/or pesto. It'll fill you up! (Available until 11 AM).

The Third Wave

7

Our version of avocado toast. Smashed avocado, pickled radish, everything spice and sprouts. (Plant Based) (Vegan/Gluten Free Upon Request)

Jessie's Hummus Toast

7

Our house hummus (from Jessie's family recipe), pepitas, Moroccan carrots, olive oil & za'atar spice on multigrain toast. (Plant Based) (Vegan/Gluten Free Upon Request)

LUNCH

Available Starting at 11 AM

Just the Cheese, Please

6

White cheddar cheese on buttered and grilled sourdough bread.

Boom Roasted

8

Roasted sweet potato sandwich with house pesto, tomato, caramelized onions, wilted kale and white cheddar on grilled multigrain bread.

A Coodle Doodle Doo

9

Smoked chicken breast, sprouts, tomato, house pickles, and honey mustard on toasted multigrain bread.

The Jules

10

Turkey bacon, avocado, Gotham Green's romaine, tomato, and house mayo on toasted sourdough bread.

ADD ONS

Two Strips Turkey Bacon
Pesto
Gluten Free Bread

+ 1.50
+ 1.00
+ 1.00

Tomato
Avocado

+ 0.50
+ 1.50

Coffee Bar Menu
Available during all hours of operation

To Drink:

Hot Coffee \$2.25-3.5

Drip brew

Chemex pourover

Iced Coffee \$2.85 - \$4.85

Nitro cold brew

Cold Brew

Flash brewed iced coffee

Espresso

Espresso \$2.50

Cappuccino \$3.5

Latte \$3.25 - \$3.65

Iced Latte \$3.75 - 4.70

Mocha \$4.10 - \$4.50

Iced Mocha \$4.40 - #5.35

Hot Tea (MEM Tea) \$2.25

Loose leaf tea: Earl grey, English Breakfast, Blood Orange Hibiscus, Golden Green Tea,
Lemon Chamomile, Spicy Chai

Iced Tea \$2.55 - #3.05

Earl Grey, Blood Orange Hibiscus, Golden Green

Tea Lattes (hot or iced): \$3.35 - 4.35

Spicy Chai

London Fog

Matcha

Minta Matcha

Misc:

Hot Chocolate \$2.50 - \$3.00

Golden Milk \$3.45 - 4.05

Milk

To Eat:

Local pastry (will likely change, add, or omit some of these as we start producing some of our own)

Pain D'Avignon \$4-4.50

Chocolate Croissant

Almond Croissant

Apple Chaisson

Spinach and Feta turnover

Illuminated Oven \$3 - \$4.50

Muffins: blueberry, carrot cake, seasonal

Scones: lemon ginger, blueberry, seasonal

Cookies: oatmeal raisin, chocolate chip

Date and Nut bar

Grab N Go \$3 - \$4.0

D's Lectables: cookies and power bars

Bellichi's Best biscotti: various flavors

Vega: protein bars and granola bars

Bottled drinks:

Water, VitaCoco, assorted juices, (coming soon:) Yacht club soda



BAR MENU

SWEET TREATS

Available All Day

Burgundian Waffle

6

Our friends make awesome leige-style waffles. We wanted to share them with you. Nice and hot, topped with cinnamon sugar. Add whip cream if you're into it.

Seasonal Pie of the Day

7

What's better than pie with a cup of coffee or your after dinner drink? Treat yourself to our roasting pie special.

Local Ice Cream (Vegan)

8

Our friends at Like No Udder make awesome ice cream AND it's vegan. Flavors vary, but we'll be happy to let you know if you ask.

Brownies vs Blondies

4.5

Which is your favorite? We've got both. Or do a 50/50 if your partner if you know they're going to eat half anyway! (for more baked goods, check out our pastry case!)

SAVORY SNACKS

Available All Day

Seasonal Grain Bowl

6

Quinoa bowl made to order with wilted kale, crispy chick peas,

House Salad

7

Gotham Greens romaine, tomatos, house croutons, chopped carrots, red onion. Nothing fancy, but you'll feel better about eating this than just Scotch and ice cream.

Jessie's Hummus Toast

7

Family recipe hummus, moroccan carrots, pepitas, olive oil, and z'atar spice on thick slice of sourdough toast.

Snack Plate

9

Crackers, assorted cheeses, olives, and veggie sticks with a side of house hummus

Just the cheese, please

6

Grilled cheese on sourdough. Simple delicious. Add tomato, avocado, or pesto for a small upcharge.

NIBBLES

Fruit Tart

5

Apple Crisp

6

Carrot Cake

6

Scoop of Ice Cream

4

Chocolate Chip Cookie

2

Oatmeal Raisin Cookie

2



BEER & WINE

WINE

WHITE AND SPARKLING

Chardonnay	PRICES
Sauvignon Blanc	TBD
Pinot Grigio	
White Blend	
Rose	
Rose	
Champagne	
Champagne	

RED

Pinot Noir	PRICES
Pinot Noir	TBD
Malbec	
Montepulciano	
Red Blend	
Cabernet Sauvignon	
Cabernet Sauvignon	
Red Blend	

SWEET & AFTER DINNER WINE

Riesling			
Gewurztraminer	PRICES	Port	PRICES
Ice wine (1/2 btl)	TBD	Sherry	TBD

BEER

CANNED BEER

Buttonwoods Beer	PRICES
Buttonwoods Beer	TBD
Foolproof Sour	
Foolproof Rose Saison	
Narragansett	
Origin Beer Project	
Origin Beer Project	
Proclamation	
Proclamation	
Local Beer	

BOTTLED BEER

Lagunitas Day Beer	PRICES
Lagunitas IPA	TBD
Modelo	
Modelo Negro	
New Belgium Fat Tire	
New Belgium 1554	
Pabst Blue Ribbon	
Sierra Nevada Pale	



PETITION TO THE TOWN COUNCIL

To the Honorable Town Council of the Town of Bristol:

The undersigned hereby respectfully requests:

Borealis Coffee is an existing artisanal coffee roasting company established in 2014. The business currently operates a cafe in Riverside with a roasting facility in Pawtucket. This narrative is for a new location at Unity Park in Bristol (500 Wood St) opening late in 2021.

We are petitioning the Honorable Town Council to create an additional liquor license so that Borealis Coffee may continue our evolution and tap into a new trend in specialty coffee by adding craft cocktails and decadent desserts. We have always been a community-focused business with an emphasis on quality products, customer engagement, and creating a welcoming environment for all. Our goal is to add to our existing reputation as a leading coffee shop in New England and become not just a morning spot, but also an after-work or evening destination to serve all the East Bay of RI and beyond.

With the excitement building in Unity Park, Borealis will be able to add additional value to our menu options and keep hours that align with our neighboring businesses. Coffee is a generally a morning beverage, and we have learned from our Riverside location that despite good afternoon and evening events, fun activities for all ages, and engaging our community that it's hard to be open into the evening without a wider range of food and drinks. We're excited to be opening what we hope to be a small hub for local jazz combos, open mic nights, poetry nights, game nights, and more fun evening activities that appeal to a wide range of interests other than just coffee.

Our pastry chef will create a delicious morning menu of baked goods for the coffee crowd, and we will transition into a delightful spread of sweet treats, desserts, and pairings for an afternoon bite. We will also offer a handful of appetizers to accompany our craft cocktails such as cheese plates, charcuterie board, stuffed grape leaves, and similar untraditional bar food items (no chicken wings or bowls of stale pretzels).

Borealis will become the go-to spot in the East Bay for a low-key afternoon or evening with a friend, loved one, or co-worker. We have no interest in being a late night spot or loud club, we just want to add to our love of food and well-executed craft beverages in an upscale environment, not unlike Pastiche on Federal Hill. We hope the Council will help us in achieving this by creating an additional BV Full liquor license for us.

Thanks for your consideration!

-Brian and Jessie Dwiggins

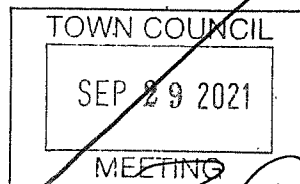

2021 SEP 15 PM 1:02

PLEASE NOTE:

Petition must be returned by 4:00 p.m., two (2) weeks prior to the Town Council meeting to place your request on the docket of the _____ meeting for review and possible action. It is Council policy that action might not be taken on petitions unless recommendations, if necessary, from appropriate departments are received prior to the Council meeting.

DATE RECEIVED: 9/15/21

SIGNATURE: _____

NAME: Brian Dwiggins for Borealis Coffee Company, LLC

ADDRESS: 500 Wood St, Unit 113 Residence address: 144 Whipple Rd

TOWN: Bristol Residence town: Smithfield

BUSINESS TEL. NO. _____

RESIDENCE TEL. NO. 401-429-8774

LEGAL NOTICE

TOWN OF BRISTOL PUBLIC HEARING INTOXICATING BEVERAGE LICENSE CLASS BV LIMITED

Application for license to keep for sale and to sell intoxicating beverages, in accordance with Title 3 of the General Laws of 1956, and all amendments thereof, and additions thereto has been made at this office as follows:

Borealis Coffee Company, LLC
Brian & Jessie Dwiggins
500 Wood Street, Unit 113

The Town Council will be in session in the Council Chambers, Town Hall on Wednesday evening, December 1, 2021 beginning at 7:00 PM at which time and place all persons remonstrating the granting of the above license are entitled to and will be heard. Said remonstrance must be filed on or before the time of hearing and must be accompanied with a plat.

Individuals requesting interpreter services for the deaf or hard of hearing must notify the Town Clerk's Office at 253-7000, 72 hours in advance of the hearing date.

By Order of the Town Council
Melissa Cordeiro
COUNCIL CLERK

November 18 & 24, 2021

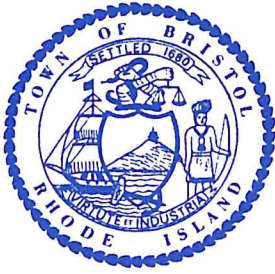

TOWN CLERK'S OFFICE

Melissa Cordeiro, Town Clerk

10 Court Street
Bristol, Rhode Island 02809-2208
Tel. 401-253-7000
Fax 401-253-2647
Email: mcordeiro@bristolri.gov
www.bristolri.gov

TOWN OF BRISTOL
PUBLIC HEARING
INTOXICATING BEVERAGE LICENSE
Class BV Limited

Application for license to keep for sale and to sell intoxicating beverages, in accordance with Title 3 of the General Laws of 1956, and all amendments thereof, and additions thereto has been made at this office as follows:

Borealis Coffee Company, LLC
Brian & Jessie Dwigins
500 Wood Street, Unit 113

The Town Council will be in session in the Council Chambers, Town Hall on Wednesday evening, December 1, 2021 beginning at 7:00 PM at which time and place all persons remonstrating the granting of the above license are entitled to and will be heard. Said remonstrance must be filed on or before the time of hearing and must be accompanied with a plat.

Individuals requesting interpreter services for the deaf or hard of hearing must notify the Town Clerk's Office at 253-7000, 72 hours in advance of the hearing date.

By Order of the Town Council
Melissa Cordeiro
COUNCIL CLERK

Nov18 & 24, 2021

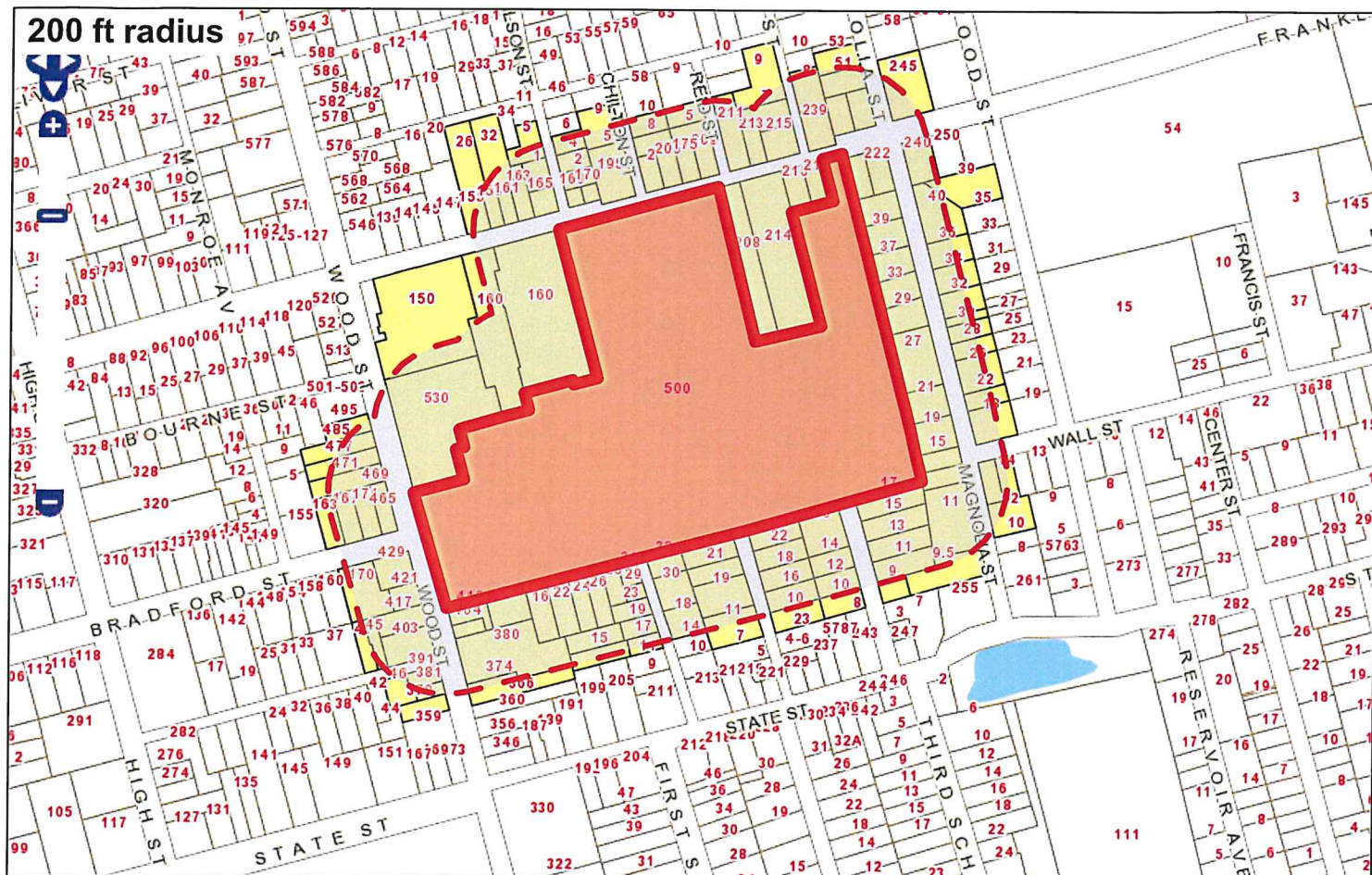

Town of Bristol, Rhode Island

Selected Parcel: 500 WOOD STREET ID: 29-1

Printed on 11/17/2021

100 m
200 ft



MainStreetMaps
MainStreetGIS, LLC
www.mainstreetgis.com

This map is for informational purposes only. It is not for appraisal of, description of, or conveyance of land. The Town of Bristol, Rhode Island and MainStreetGIS, LLC assume no legal responsibility for the information contained herein.

Parcel ID: 17-100
PANSA, ANDREW S
149 HIGH ST
BRISTOL RI 02809

Parcel ID: 17-101
PANSA, ANDREW S
149 HIGH ST
BRISTOL RI 02809

Parcel ID: 17-102
CASTIGLIEGO, NICHOLAS TRUSTEE
6 FREEBORN RD
BRISTOL RI 02809

Parcel ID: 17-103
AFONSO, THERESA & NELSON JT
14 PROSPECT ST
BRISTOL RI 02809

Parcel ID: 17-104
BARROW, LINDSAY
167 BRADFORD ST
BRISTOL RI 02809

Parcel ID: 17-136
PACHECO, NORBERTO E.
FILOMENA TE
163 BRADFORD ST
BRISTOL RI 02809

Parcel ID: 17-156
469 WOOD STREET, LLC
469 WOOD ST
BRISTOL RI 02809

Parcel ID: 17-97
CORRIVEAU, JOSHUA M
495 WOOD ST
BRISTOL RI 02809

Parcel ID: 17-99
PANSA, ANDREW S
149 HIGH ST
BRISTOL RI 02809

Parcel ID: 18-1
429 WOOD STREET, LLC
101 TUPELO ST
BRISTOL RI 02809

Parcel ID: 18-13
BRISTOL SPORTS CLUB
417 WOOD ST
BRISTOL RI 02809

Parcel ID: 18-14
NUNES PROPERTY MANAGEMENT, LLC
21 CLIFTON RD
BRISTOL RI 02809

Parcel ID: 18-15
STARLIGHT, LLC
1 TINA CT
BRISTOL RI 02809

Parcel ID: 18-2
COMMON PUB
C/O ANTHONY POISSANT
427 WOOD STREET
BRISTOL RI 02809

Parcel ID: 18-24
GILBERT AND SARAH ALMEIDA
FAMILY LTD
FAMILY LIMITED PARTNERSHIP
P O BOX 507
BRISTOL RI 02809

Parcel ID: 18-25
JSA INVESTMENTS, LLC
10 BRADFORD ST
BARRINGTON RI 02806

Parcel ID: 18-26
GILBERT & SARAH ALMEIDA FAMILY
P O BOX 507
BRISTOL RI 02809

Parcel ID: 18-5
TIMWELL HOLDINGS, LLC
PO BOX 585
TIVERTON RI 02878

Parcel ID: 18-53
LOPEZ, VINICIO O &
MIRNA C. TE
4 ROBBINS DR
BARRINGTON RI 02806

Parcel ID: 18-55
CAVALIERI, STEPHEN J
45 CONGREGATIONAL ST
BRISTOL RI 02809

Parcel ID: 23-1
FRANCO, VIRGINIO C
ILD
239 FRANKLIN STREET
BRISTOL RI 02809

Parcel ID: 23-10
REGO, ANTONIO & MARIA LE TE
RESENDES, S & ANDRADE, C TC
41 ACADEMY AVENUE
BRISTOL RI 02809

Parcel ID: 23-11
GARDINER, TIMOTHY A.
LORI A.
27 LISA LANE
BRISTOL RI 02809

Parcel ID: 23-12
VIEIRA, JOSE M.
211 FRANKLIN ST.
BRISTOL RI 02809

Parcel ID: 23-14
NEW ENGLAND HOME BUYERS, LLC
27 ROSEDALE AVE
BARRINGTON RI 02806

Parcel ID: 23-160
ALMEIDA, GILBERT L.
CLAUDETTE
84 PERRY ST
BRISTOL RI 02809

Parcel ID: 23-161
FRANCO, VIRGINIO C
ILD
239 FRANKLIN STREET
BRISTOL RI 02809

Parcel ID: 23-162
FRANCO, VIRGINIO C
ILD
239 FRANKLIN STREET
BRISTOL RI 02809

Parcel ID: 23-165
CORDEIRO, MARIA E LE
CORDEIRO, RAUL & MARIA L TE
51 MAGNOLIA ST.
BRISTOL RI 02809

Parcel ID: 23-168
AGOSTINI, JOSHUA D
53 MAGNOLIA ST
BRISTOL RI 02809

Parcel ID: 23-19
RIBEIRO, MARIA J.
209 FRANKLIN ST
BRISTOL RI 02809

Parcel ID: 23-20
PEZZULLO, ZACHARY A
471 METACOM AVE
BRISTOL RI 02809

Parcel ID: 23-21
NAPPI, JACOB N
5 REID ST
BRISTOL RI 02809

Parcel ID: 23-212
MEDEIROS, JOAO D.
8 GRAY ST.
BRISTOL RI 02809

Parcel ID: 23-22
AVELLINO HOLDINGS, LLC
PO BOX 9083
PROVIDENCE RI 02940

Parcel ID: 23-25
OLIVEIRA, MARY E, TRUSTEE, MARY E
OLIVEIRA LIVING TRUST
9 FRANCESCA LN
BRISTOL RI 02809

Parcel ID: 23-26
MONROE, DAVID R &
MARCIA M TRUSTEES
297 CHASES LANE
MIDDLETOWN RI 02842

Parcel ID: 23-27
SIMAS, PAULO & FILOMENA C LE
SIMAS, SAMANTHA & ALYSSA
8 CHILTON ST
BRISTOL RI 02809

Parcel ID: 23-28
DUARTE, JESSICA L.
RAYMOND L. TC
10 CHILTON ST
BRISTOL RI 02809

Parcel ID: 23-31
TURNBULL, EDWARD G.
C. LYNNE ETUX
195 FRANKLIN ST
BRISTOL RI 02809

Parcel ID: 23-33
ZEITLER, JOHN M.
38 KING PHILIP AVE
BRISTOL RI 02809

Parcel ID: 23-34
OUTSIDE PERSPECTIVE, LLC
72 VISTA CIR
NORTH KINGSTOWN RI 02852

Parcel ID: 23-37
BENEVIDES, CARMINA
2 WILSON ST
BRISTOL RI 02809

Parcel ID: 23-38
VLACO, DUANE
11 TROUT WAY
WEST WAREHAM MA 02576

Parcel ID: 23-39
BENEVIDES, CARMINA
2 WILSON ST
BRISTOL RI 02809

Parcel ID: 23-40
BORTONE, FABIO
4 Wilson Street
Bristol RI 02809

Parcel ID: 23-41
SAO REALTY COMPANY
PO BOX 14529
E PROVIDENCE RI 02914

Parcel ID: 23-69
FERRO, KEVIN J.
165 FRANKLIN ST
BRISTOL RI 02809

Parcel ID: 23-71
MACHADO REALTY, LLC
22 CENTER STREET
BRISTOL RI 02809

Parcel ID: 23-73
TEIXEIRA, JOSE C.
2 DOLLY DR
BRISTOL RI 02809

Parcel ID: 23-75
MEDEIROS, ANDREW J.
163 FRANKLIN STREET
BRISTOL RI 02809

Parcel ID: 23-77
MONIZ, JOSEPH F. ET UX
LUBELIA M. MONIZ TE
2 BORGES ST
BRISTOL RI 02809

Parcel ID: 23-78-007
RODRIGUES, JOYCE C.
209 HOPE ST
BRISTOL RI 02809

Parcel ID: 23-78-008
FILIFE, JOAO A.
MARIA F.
159 FRANKLIN ST UNIT 8C
BRISTOL RI 02809

Parcel ID: 23-79
CABRAL, LAUDALINA A (1/3),
GERMANO, MARIA FILOMENA A (1/3) &
MACHADO, ADELINO (1/3) TC
38 TILBURY DR
BRISTOL RI 02809

Parcel ID: 23-80-004
RODRIGUES, JOYCE C.
209 HOPE ST
BRISTOL RI 02809

Parcel ID: 23-80-005
RODRIGUES, JOYCE C
209 HOPE ST
BRISTOL RI 02809

Parcel ID: 23-80-003
RODRIGUES, JOYCE C.
209 HOPE ST
BRISTOL RI 02809

Parcel ID: 23-80-002
RODRIGUES, RONALD J.
JOYCE C. TE
209 HOPE ST
BRISTOL RI 02809

Parcel ID: 23-80-001
RODRIGUES, RONALD J
209 HOPE STREET
BRISTOL RI 02809

Parcel ID: 23-80-006
RODRIGUES, JOYCE C
209 HOPE ST
BRISTOL RI 02809

Parcel ID: 23-81
ZHAO, MIAO
WU, XUEFENG TE
111 HORIZON DR
TIVERTON RI 02878

Parcel ID: 23-9
CABRAL, KEVIN J
7 GRAY ST
BRISTOL RI 02809

Parcel ID: 24-1
PACHECO, PAUL C ET UX
ALCIDA PACHECO TE
17 ORCHARD ST
BRISTOL RI 02809

Parcel ID: 24-14
O'CONNOR CASTRO, DOROTHY LE
ANANIA, PATRICIA A
1 ALMA AVENUE
BRISTOL RI 02809

Parcel ID: 24-15
CONTE, ANDREW JR
30 ROCK ST
BRISTOL RI 02809

Parcel ID: 24-17
DEMAREST, PATRICIA M
31 ROCK ST
BRISTOL RI 02809

Parcel ID: 24-18
ANDRADE, ALFREDO ET UX
MARIA L. ANDRADE TE
28 SHAWS LN
BRISTOL RI 02809

Parcel ID: 24-19
SANTOS, HAROLD
HATHAWAY, LINDA TE
23 ROCK ST
BRISTOL RI 02809

Parcel ID: 24-2
PACHECO, PAUL C ET UX
ALCIDA PACHECO TE
17 ORCHARD ST
BRISTOL RI 02809

Parcel ID: 24-20
BAIROS, DELIA (S)
19 ROCK ST
BRISTOL RI 02809

Parcel ID: 24-21
BAIROS, DELIA (S)
19 ROCK ST
BRISTOL RI 02809

Parcel ID: 24-22
SPANGLER, JASON D
17 ROCK ST
BRISTOL RI 02809

Parcel ID: 24-23
CABRAL, MARIA A &
SILVA, LAUDALINA
5 LAUREL LN
WARREN RI 02885

Parcel ID: 24-3
DASILVA, HENRIQUE P.
NOEMIA M LIFE EST
19 RYAN AVE
BRISTOL RI 02809

Parcel ID: 24-30
MARTIN, KEITH A &
ANGELA M
5 KEVIN COURT
BRISTOL RI 02809

Parcel ID: 24-31
LEMONS, VIOLANTE I. LIFE EST
DELEMONS, OSCAR I AND JOSEPH M
26 SHAWS LANE
BRISTOL RI 02809

Parcel ID: 24-32
QUINLAN, JEFFREY
EDWARD JT
68 BENNINGTON RD
CRANSTON RI 02920

Parcel ID: 24-33
EGAN, JONATHAN M & VANESSA A TE
1206 MIDDLE RD
PORTSMOUTH RI 02871

Parcel ID: 24-34
BOLOTA, JOAO M.
ESMERIA F. ETAL JT
12 SHAW'S LN
BRISTOL RI 02809

Parcel ID: 24-35
FLORA, MARIA ALMERINDA LE
BETTENCOURT, MARGARIDA ETAL
4 SHAWS LN
BRISTOL RI 02809

Parcel ID: 24-36
GOGLIA, VICTOR P. &
ANN MARIE TE
380 WOOD ST
BRISTOL RI 02809

Parcel ID: 24-37
GOGLIA, VICTOR P. &
ANN MARIE TE
380 WOOD ST
BRISTOL RI 02809

Parcel ID: 24-5
TWO PRINCE LLC
490 RIVERSIDE DR
TIVERTON RI 02878

Parcel ID: 24-79
MCMENIMEN, SCOTT
32 ROCK ST
BRISTOL RI 02809

Parcel ID: 24-80
PETTA KIMBERLY
29 ROCK ST
BRISTOL RI 02809

Parcel ID: 24-83
MCCOMBE, SPENCER &
MICHELLE TE
7 THURSTON AVE
NEWPORT RI 02840

Parcel ID: 29-1-030
UNITY PARK LLC
99 TUPELO ST
BRISTOL RI 02809

Parcel ID: 29-1-045
ZELLER RESEARCH LTD
500 WOOD ST BLDG 34
BRISTOL RI 02809

Parcel ID: 29-1-020
BRISTOL PROPERTIES ASSOC LLC
411 FIFTH AVE 4TH FLOOR
NEW YORK NY 10019

Parcel ID: 29-1-010
UNITY PARK LLC
99 TUPELO ST
BRISTOL RI 02809

Parcel ID: 29-1-021
UNITY PARK LLC
99 TUPELO ST
BRISTOL RI 02809

Parcel ID: 29-10
MEDEIROS, MARIA A TRUSTEE
MARIA A MEDEIROS LIV TRUST
27 MAGNOLIA ST
BRISTOL RI 02809

Parcel ID: 29-11
FRANCO, DOMENIC A JR
PO BOX 446
BRISTOL RI 02809

Parcel ID: 29-14
ARRUDA, ARISTIDES
NORBINA LIFE
C/O 28 MAGNOLIA STREET
BRISTOL RI 02809

Parcel ID: 29-17
CHARTIER, MONICA, TRUSTEE
MONICA CHARTIER DECLARATION O
36 PLATT STREET
BRISTOL RI 02809

Parcel ID: 29-19
BROWN, RICHARD &
ALYSSA TE
21 MAGNOLIA ST
BRISTOL RI 02809

Parcel ID: 29-2
MARTINS, ANTONIO A. TRUSTEE
ANTONIO A. MARTINS REV LIV TR
208 FRANKLIN ST
BRISTOL RI 02809

Parcel ID: 29-23
LIMA, JAMES LE
REM-TAVARES, FRANCIS & RICHARD TC
22 MAGNOLIA ST
BRISTOL RI 02809

Parcel ID: 29-25
COUTO, JOSE T & MARIA P TE LE
REM: COUTO, PETER A
19 MAGNOLIA ST
BRISTOL RI 02809

Parcel ID: 29-29
LAGARTO, STEVEN A.
LISA A. ETUX
18 MAGNOLIA ST
BRISTOL RI 02809

Parcel ID: 29-31
TAVARES, ANGELO & JENNIFER TE
216 FRANKLIN ST
BRISTOL RI 02809

Parcel ID: 29-32
ROSA, MARIA C
MARY L
218 FRANKLIN ST
BRISTOL RI 02809

Parcel ID: 29-33
DUARTE, FRANCIS J. ET UX
BETTY J. DUARTE TE
222 FRANKLIN ST.
BRISTOL RI 02809

Parcel ID: 29-34
DUARTE, FRANCIS JOSEPH &
BETTY JANE TRUSTEES
222 FRANKLIN ST.
BRISTOL RI 02809

Parcel ID: 29-35
BRUM, MARIA LEOPOLDINA
25 MANCHESTER ST
BRISTOL RI 02809

Parcel ID: 29-39
DUARTE, FRANCIS J. ET UX
BETTY J. DUARTE TE
222 FRANKLIN ST.
BRISTOL RI 02809

Parcel ID: 29-4
BOTELHO, JOSE L. ET UX
MARIE F. BOTELHO TE
29 MAGNOLIA STREET
BRISTOL RI 02809

Parcel ID: 29-40
GAME MANAGEMENT, LCC
9 JANE LANE
BRISTOL RI 02809

Parcel ID: 29-41-001
MICCIS, LLC
39 BUTTONWOOD ST UNIT 1
BRISTOL RI 02809

Parcel ID: 29-41-002
PENSICO TRUST COMPANY
CUSTODIAN FBO
44 FOSDYKE ST
PROVIDENCE RI 02906

Parcel ID: 29-42
BURKE, JERRY A. JR.
ET UX SUSAN A
39 MAGNOLIA ST
BRISTOL RI 02809

Parcel ID: 29-45
FERREIRA, AGOSTINHO P. ET UX
VANDA C.
37 MAGNOLIA ST
BRISTOL RI 02809

Parcel ID: 29-46
WEIDMANN, DANIEL L &
KEDDIE, KRISTINA M TE
36 MAGNOLIA ST
BRISTOL RI 02809

Parcel ID: 29-49
STEGALL, ROSEMARY S
SHARON JT
34 MAGNOLIA ST
BRISTOL RI 02809

Parcel ID: 29-5
BRANQUINHO, JOAO & ALDA LE
BOTELHO, KRYSTAL MARIE
32 MAGNOLIA ST
BRISTOL RI 02809

Parcel ID: 29-51
MEDEIROS, DANIEL R.
MARIA R. ETUX
33 MAGNOLIA ST
BRISTOL RI 02809

Parcel ID: 29-53
ELDER CARE ONE, INC.
150 FRANKLIN STREET
BRISTOL RI 02809

Parcel ID: 29-54
ALMEIDA, DAVID & THERESA C JT
20 DORAN AVE
BRISTOL RI 02809

Parcel ID: 29-55
ELDER CARE TWO, INC.
160 FRANKLIN ST
BRISTOL RI 02809

Parcel ID: 29-58
FRANCO, DOMENIC A JR
PO BOX 446
BRISTOL RI 02809

Parcel ID: 29-59
WSA PROPERTY, INC.
150 FRANKLIN ST
BRISTOL RI 02809

Parcel ID: 29-60
BRISTOL ASSISTED LIVING, LP
C/O FRANKLIN COURT ASSIST LIV
180 FRANKLIN ST
BRISTOL RI 02809

Parcel ID: 30-139
WOOLHOUSE, PHILLIP DAVID
9 EASTERBROOKS AVE
BRISTOL RI 02809

Parcel ID: 30-21
GOULART, JAMES
14 MAGNOLIA ST
BRISTOL RI 02809

Parcel ID: 30-22
GOULART, JAMES
14 MAGNOLIA ST
BRISTOL RI 02809

Parcel ID: 30-23
CABRAL, PAUL M.
LOURDES C.
12 MAGNOLIA ST
BRISTOL RI 02809

Parcel ID: 30-30
BERRETTO, PAULINE MARIA
148 HIGH ST
BRISTOL RI 02809

Parcel ID: 30-33
WARD, TERESA J.
DACOSTA, TRACY M
11 MAGNOLIA STREET
BRISTOL RI 02809

Parcel ID: 30-39
COLLAMORE-HARPER, ERICA LEIGH
& HARPER, JUSTIN JT
17 EASTERBROOKS AVE
BRISTOL RI 02809

Parcel ID: 30-40
CIRILLO, LOUIS P.
SUSAN E. CO-TRS & CIRILLO FAM
28 CENTRAL ST.
BRISTOL RI 02809

Parcel ID: 30-41
TAVARES, VIRGINIA L &
MANUEL A. TE
13 EASTERBROOKS AVE
BRISTOL RI 02809

Parcel ID: 30-42
BORGES, SILVERIO A. ETUX
CONNIE BORGES TE
65 NARROWS ROAD
BRISTOL RI 02809

Parcel ID: 30-43
CHILTON, WILLIAM B
9 1/2 EASTERBROOKS AVE
BRISTOL RI 02809

Parcel ID: 30-46
GEYER, JOHN
NANCY C
18 EASTERBROOKS AVE
BRISTOL RI 02809

Parcel ID: 30-47
COBB, JOHN G. &
ROSE A TE
14 EASTERBROOKS AVE
BRISTOL RI 02809

Parcel ID: 30-48
GAME MANAGEMENT, LLC
9 JANE LANE
BRISTOL RI 02809

Parcel ID: 30-49
MADEIRA, JOAO F.
MARIA F. TE
10 EASTERBROOKS AVE
BRISTOL RI 02809

Parcel ID: 30-52
TAVARES, MARY ROSE TRUSTEE
2 FRANCA DRIVE
BRISTOL RI 02809

Parcel ID: 30-53
TAVARES, MARY ROSE TRUSTEE
2 FRANCA DRIVE
BRISTOL RI 02809

Parcel ID: 30-54
KREFT, ROBERT M, TRUSTEE-ROBERT
M KREFT TRUST
17 SANDY LN
BRISTOL RI 02809

Parcel ID: 30-55
BERTENSHAW, DENISE & LOPES,
DIANNE
16 RYAN AVENUE
BRISTOL RI 02809

Parcel ID: 30-56
KREFT, ROBERT M, TRUSTEE-ROBERT
M KREFT TRUST
17 SANDY LN
BRISTOL RI 02809