



PETITION TO THE TOWN COUNCIL

LICENSE REQUEST: STATE STREET SEASONAL OUTDOOR

EXPANSION With ALCOHOL SERVICE LICENSE

Expires: May 31, 2024

To the Honorable Town Council of the Town of Bristol:
The undersigned hereby respectfully requests of your Honorable Body to be granted a

STATE STREET SEASONAL OUTDOOR EXPANSION -W/ ALCOHOL SERVICE LICENSE

NAME OF ESTABLISHMENT: FOGLIA

ADDRESS: 31 STATE ST.

PROPOSED NUMBER OF SEATS: NEW OUTDOOR SPACE 12

*HOURS OF OPERATION: TH-SAT 5p.m. → 9p.m. SUN. 4p.m. → 8p.m.

*hours of outdoor service of food and drink shall cease 10:00 p.m. on Sunday through Thursday, and no later than 11:00 p.m., on Friday and Saturday.

- ☐ Petition Fee \$100
- ☐ A line drawing or plat plan stamped by a license professional showing entire parking area to be used along with the number of placement or location of tables & seats w/ approximate dimensions of each.
- ☐ Certificate of Liability Insurance (no less than \$1,000,000 naming the town additionally insured.
- ☐ Photos or other graphic representation—including color & materials of furniture & Shade structures.

Please attend the Council Meeting on _____

SIGNATURE: [Signature]

NAME: Peter Carvelli

Petition must be returned by _____

ADDRESS: _____

TOWN: Br

Petition mailed on _____

DATE OF BIRTH: _____

BUSINESS TELEPHONE: _____

HOME TELEPHONE: _____

EMAIL: ch

TAX STAMP

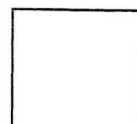

TO BE USED BY FINANCE DEPARTMENT

*BY SIGNING THIS PETITION, I CONSENT TO EXAMINATION AND RELEASE OF RECORDS AND INFORMATION REGARDING MY BACKGROUND, INCLUDING POLICE RECORDS, EDUCATIONAL INFORMATION, RESIDENCE RECORDS, AND ANY COURT RECORDS.

TOWN COUNCIL
MAY 31 2023
MEETING

2023 MAY 19 PM 1:39

TOWN CLERK'S OFFICE
BRISTOL, RHODE ISLAND

(Cell)

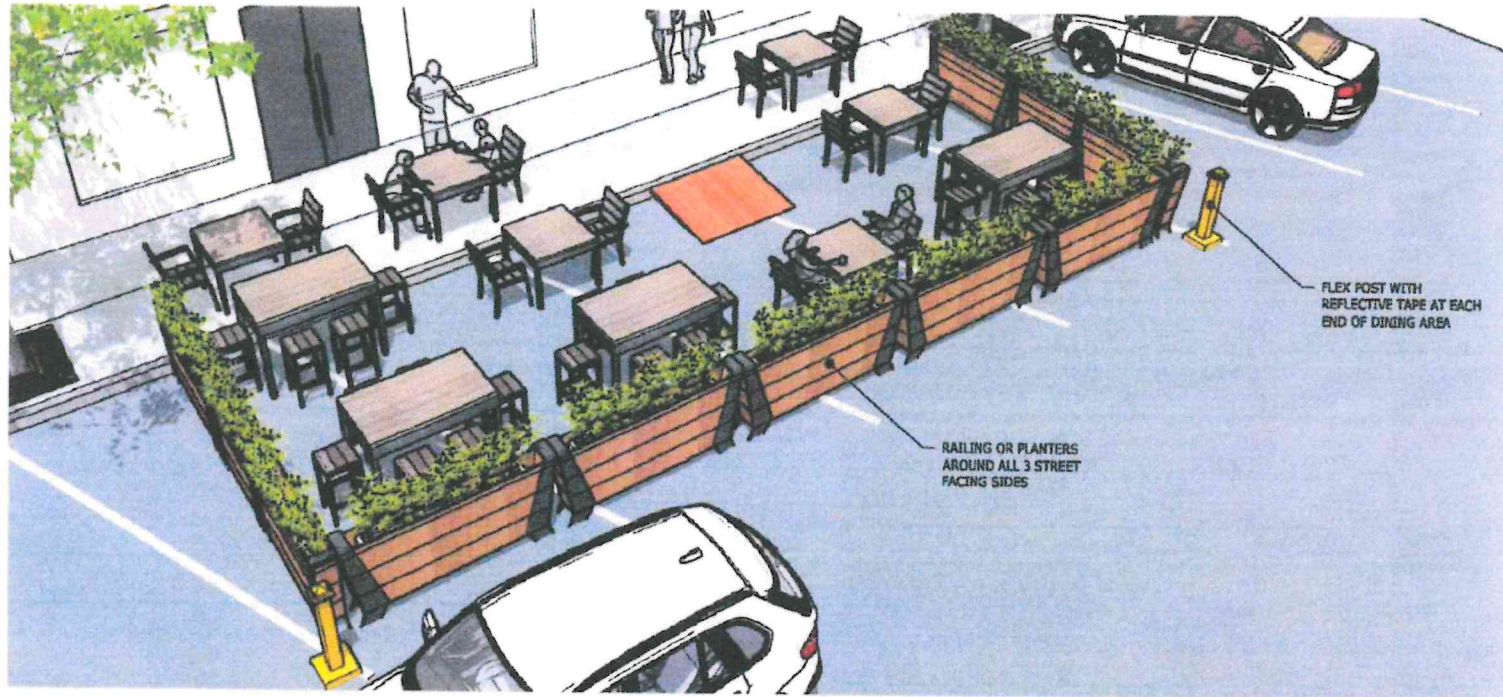

Lower State Street Proposed Design for Outdoor Dining Area Perimeter

Wood Material Construction - Dark edge band with natural lighter wood center

Planters on top of wood barriers

Jersey Barriers at corners along street side covered with wood planter to match perimeter planters.

Search 400,000+ products

Black Outdoor Restaurant Tables and Sets



Lancaster Table & Seating Harbor Black 36" Square Outdoor Standard Height Table with Modern Legs

FROM **\$85.10**/Each

Try this Lancaster Table & Seating Harbor Black 36" Square Outdoor Standard Height Table with Modern Legs instead! With similar benefits and features, this item is an ideal alternative to your current item.

Lancaster Table & Seating 36" x 36" Black Powder-Coated Aluminum Dining Height Outdoor Table with Umbrella Hole
Item # 427CAU3636BK



Buy 10 or more

\$145.73/Each

Discounted shipping with

Buy 1 - 9

\$159.99/Each

Notify me when this product is back in stock

Email Address

Send

You will only be emailed once the product becomes available. We won't add you to our email list or share your data.

Wish List

Rapid Reorder



BLACK METAL TABLE + CHAIRS
36" X 36" MAX.



CANVAS UMBRELLA
COLOR: GREEN.

10% Off*

>
(htt
< ps:
(htt //4
ps: 8b
//4 arri
8b ers
arri .co
ers m/
.co pro
m/ du
pro cts
du /6-
cts de
/bi co-
n- bin
blo :
ck- blo
lift ck/
er/))

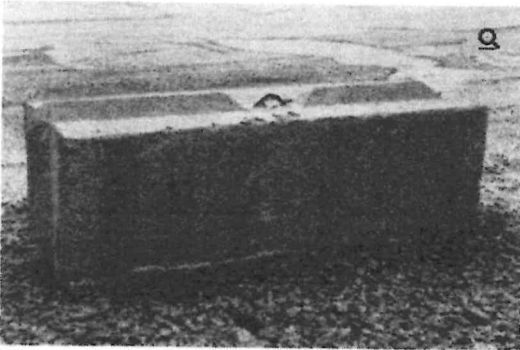

Concrete Bin Block

2'x2'x6' Concrete Bin Blocks are a generic term to describe interlocking, stackable concrete blocks. Made with leftover concrete and a great low-cost alternative to jersey barriers, Concrete Bin Blocks carry many names: Ecology blocks, lug blocks, mafia blocks, knob blocks, v-blocks, waste blocks, storage blocks, and others. Pair this with our Concrete Block Lifter (https://48barriers.com/products/bin-block-lifter/) to easily assemble the structure you need.

Bin Block dimensions vary by location.

Dimensions:

2' H x 2' W x 6' L (Full Block) Weight: Approx. 3,600 lbs
2' H x 2' W x 3' L (Half Block) Weight: Approx. 1,800 lbs

Various sizes available depending on location:
2.5'H x 2.5'W x 5'L Weight: Approx. 4,700 lbs

Get a Quote

Or Call Us Below:

866-744-0281(tel: +18667440281)

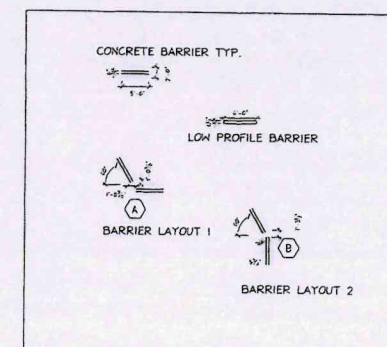
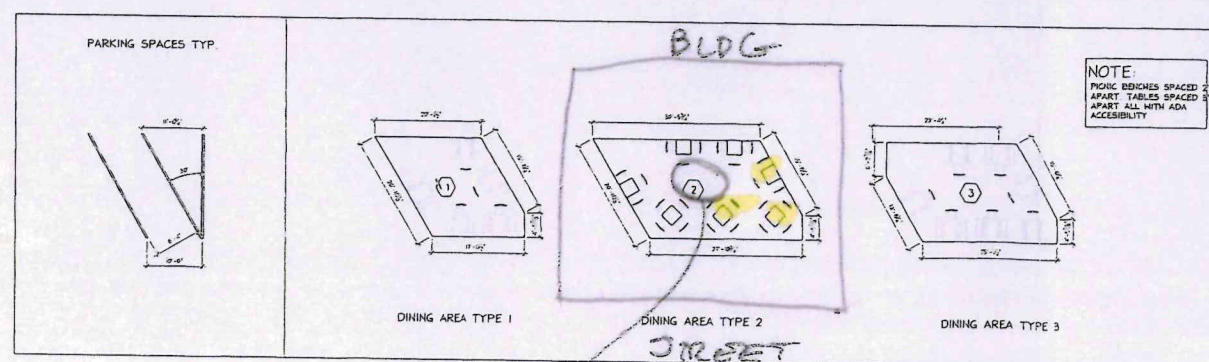
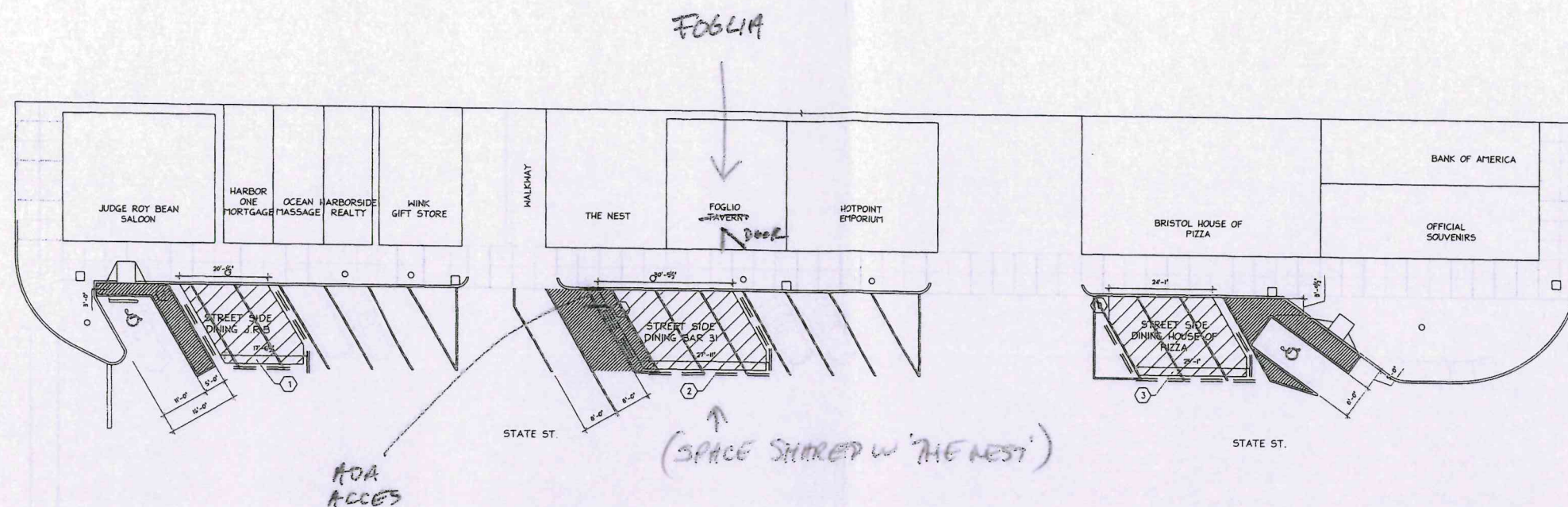

ADMA
MANEUVERABILITY
WILL BE MAINTAINED.

STATE STREET
OUTDOOR SEATING PLAN

0' 4' 8' 12'

SCALE = 3/32"



GENERAL NOTES

1. DO NOT SCALE DRAWINGS. Notify Architect if additional dimensioning is required.
2. Contractor shall verify all dimensions in the field and notify Architect of any discrepancies.
3. The Contractor shall provide all material indicated, graphically, as annotated or as needed for a complete and proper installation, and shall notify Architect of any discrepancies in identification of the materials required.
4. Large scale plans of details shall take precedence over smaller scale drawings.
5. All work shall be in conformance with the Federal, State and Local Building Codes and other governing bodies.
6. All work to be performed and inspected as required by the local governing code enforcement office.
7. All work is to be installed in accordance with manufacturer's recommendations and specifications.

COPYRIGHT © 2021 - JHL TEXTURE P.C.
DRAWING ALTERATION
 IT IS A VIOLATION OF LAW FOR ANY PERSON
 UNLESS ACTING UNDER THE DIRECTION OF LICENSED
 ARCHITECT, PROFESSIONAL ENGINEER, LANDSCAPE
 ARCHITECT, OR LAND SURVEYOR TO ALTER ANY
 ITEM ON THIS DOCUMENT IN ANY WAY.
 ANY LICENSEE WHO ALTERS THIS DOCUMENT IS
 REQUIRED BY LAW TO DO SO WITH HIS OR HER SEAL AND
 THE NOTATION "ALTERED BY: FOLLOWED BY HIS OR
 HER SIGNATURE AND SPECIFIC DESCRIPTION OF THE
 ALTERATIONS."

PI	REVISION DESCRIPTION	DATE	BY
6			
5			
4			
3			
2			
1			

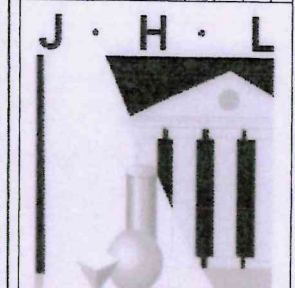

TECTURE
ARCHITECT • ENGINEER, P.C.

97 Main Street • Hornell NY 14843
607.324.4329 • Fax 607.324.4025

ISSUED FOR:
REVIEW 05-03-23

OUTDOOR DINING
AND PARKING FOR:
LOWER
STATE STREET

STATE STREET
Bristol, RI 02809

FIRST FLOOR
DEMOLITION
PLAN

DATE: 04-01-21	DRAWING NUMBER:
SCALE: AS NOTED	A0.01
DRAWN BY: JRD	
PROJECT NUMBER:	

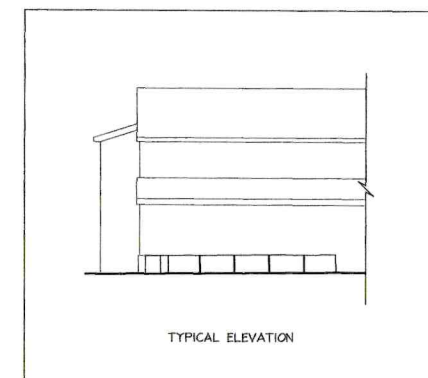
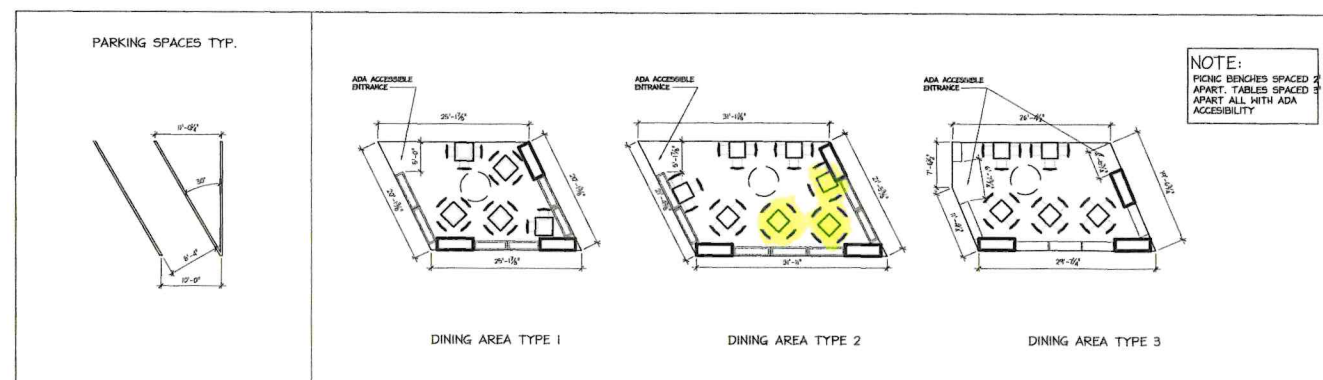
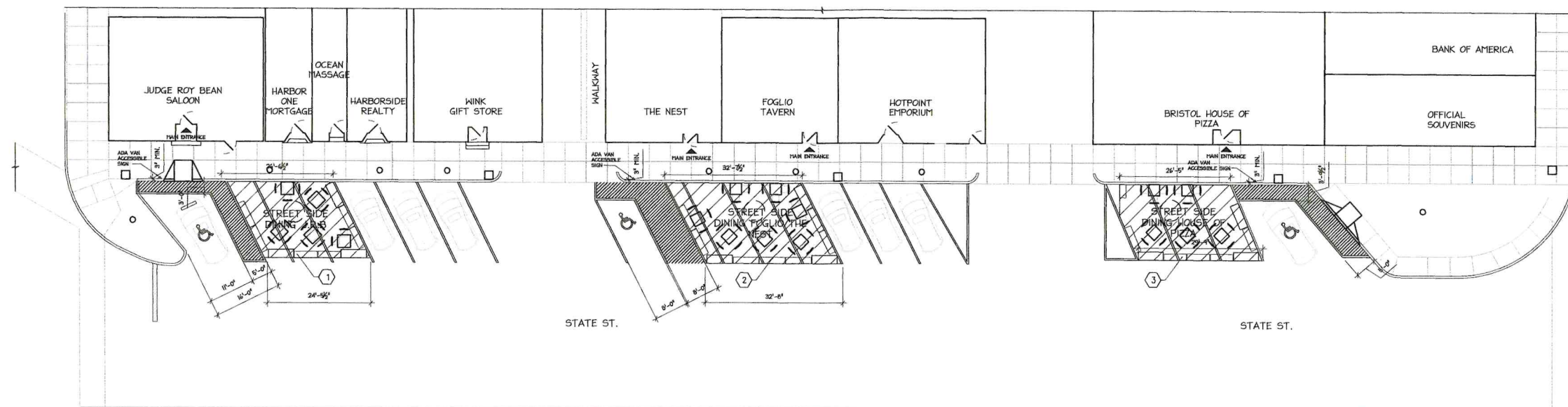

- 3: The Contractor shall provide, as indicated, graphically, as appropriate, for a complete and correct installation, and shall notify the owner of any discrepancies in identification of materials required.
- 4: Large scale plans of details shall take precedence over smaller scale details.
- 5: All work shall be in conformity with the Federal, State and Local Codes and other governing codes.
- 6: All work to be performed as required by the local government enforcement office.
- 7: All work is to be installed in accordance with manufacturer's recommended specifications.

COPYRIGHT © 2021 - JHL TECTUM
DRAWING ALTERATION
IT IS A VIOLATION OF LAW FOR ANY
UNLESS ACTING UNDER THE DIRECTION
ARCHITECT, PROFESSIONAL ENGINEER,
ARCHITECT, OR LAND SURVEYOR TO
ITEM ON THIS DOCUMENT IN ANY
ANY LICENSEE WHO ALTERS THIS DOCUMENT
REQUIRED BY LAW TO AFFIX HIS OR HER
THE NOTATION "ALTERED BY" FOLLOWED
HER SIGNATURE AND SPECIFIC DESCRIPTION
ALTERATIONS

9			
6			
7			
6			
5			
4			
3			



TECTU
ARCHITECT • ENGINEER

97 Main Street • Hornell
607.324.4329 • Fax 607.

ISSUED FOR
REVIEW 05-24-



OUTDOOR DINING
AND PARKING
LOWER
STATE STREET

STATE STREET
Bristol, RI 02801

OUTDOOR SEATING PL

DATE: 05-03-23	DRAWING
SCALE: AS NOTED	A
DRAWN BY: JRD	
PROJECT NUMBER:	

A1

STATE STREET
OUTDOOR SEATING PLAN
SCALE: 1/16" = 1'-0"

ENLARGED OUTDOOR
SEATING PLAN 2

DATE: 05-03-23	DRAWING
SCALE: AS NOTED	A1
DRAWN BY: JRD	
PROJECT NUMBER:	

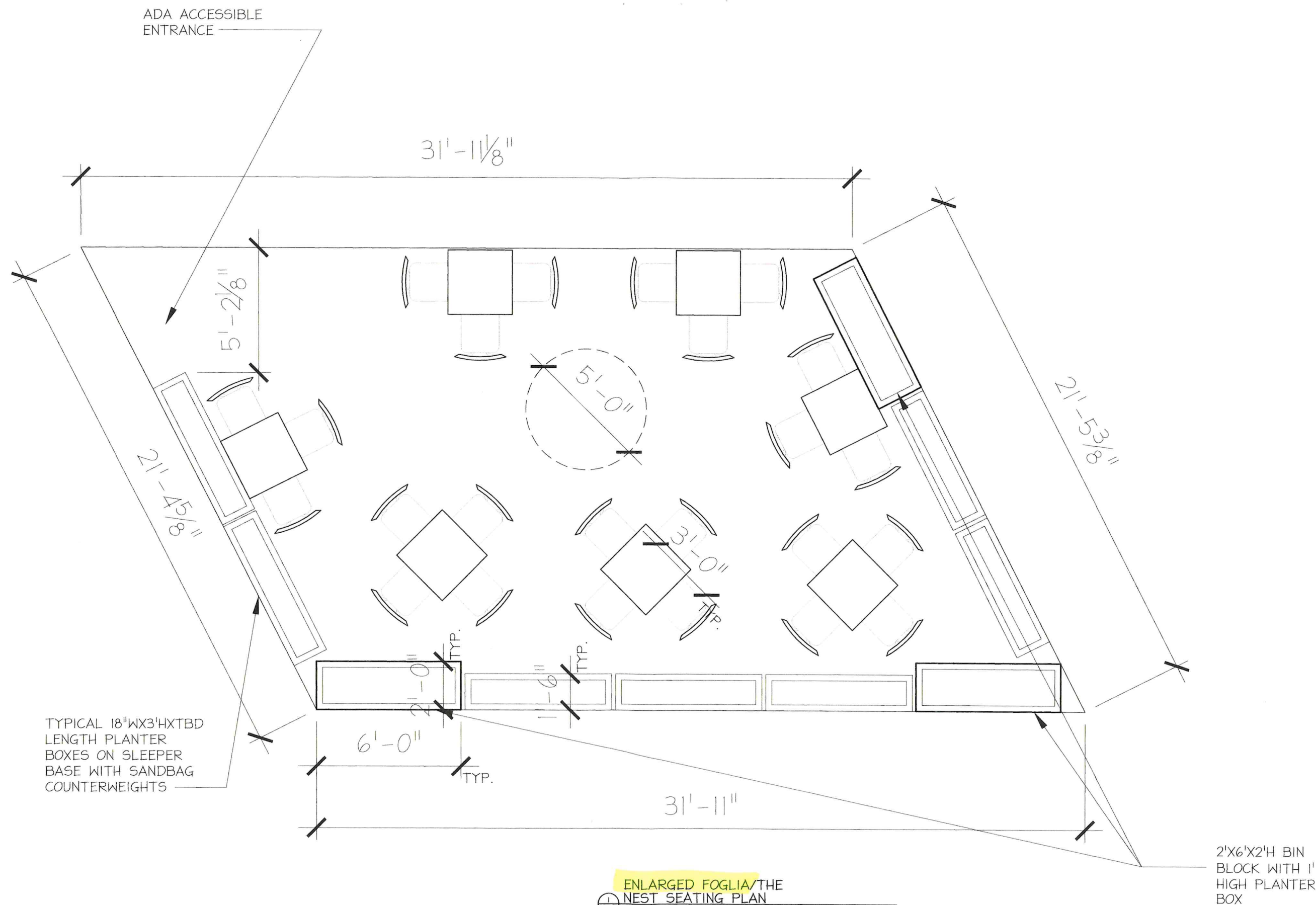

ENLARGED FOGLIA/THE
NEST SEATING PLAN

- 3: The Contractor shall provide indicated, graphically, as annex needed for a complete and pre installation, and shall notify of any discrepancies in identical materials required.
- 4: Large scale plans of details s precedence over smaller scale
- 5: All work shall be in conform: the Federal, State and Local Codes and other governing bo
- 6: All work to be performed as required by the local govern enforcement office.
- 7: All work is to be installed in with manufacturer's recommen specifications.

COPYRIGHT © 2021 - JHL TEXTURE
DRAWING ALTERATION:
IT IS A VIOLATION OF LAW FOR ANY
UNLESS ACTING UNDER THE DIRECTION
ARCHITECT, PROFESSIONAL ENGINEER,
ARCHITECT, OR LAND SURVEYOR TO
ITEM ON THIS DOCUMENT IN ANY
ANY LICENSEE WHO ALTERS THIS DOC
REQUIRED BY LAW TO AFFIX HIS OR HEI
THE NOTATION "ALTERED BY" FOLLOWE
HER SIGNATURE AND SPECIFIC DESCRIP
ALTERATIONS

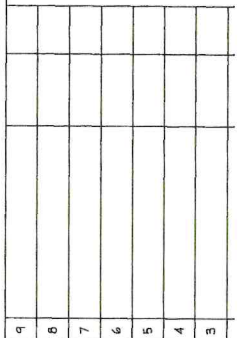

TECTUI
ARCHITECT • ENGINEER

97 Main Street • Hornell NY 14843
607.324.4329 • Fax 607.324.4330

ISSUED FOR:
REVIEW 05-24-

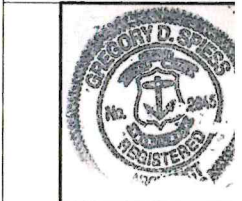

OUTDOOR DINING
AND PARKING
LOWER
STATE STREET

STATE STREET
Bristol, RI 0280

ENLARGE
FOGLIA/ THE N
LAYOUT PL

DATE: 05-24-23	DRAWING A1
SCALE: AS NOTED	
DRAWN BY: CRC	
PROJECT NUMBER:	

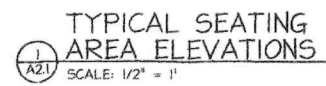

- COPYRIGHT © 2021 - JHL TEC
DRAWING ALTERATION
IT IS A VIOLATION OF LAW FOR A
UNLICENSED PERSON TO REPRODUCE OR
ARCHITECT, PROFESSIONAL ENGINEER,
ARCHITECT, OR LAND SURVEYOR
ITEM ON THIS DOCUMENT IN A
ANY LICENSEE WHO ALTERS THIS
REQUIRED BY LAW TO AFFIX HIS OR
THE NOTATION "ALTERED BY" FOLLOWED
HIS SIGNATURE AND SPECIFIC DISC
ALTERATIONS

DATE: 05-24-23	DRAWN A
SCALE: AS NOTED	
DRAWN BY: CRC	
PROJECT NUMBER:	



TOWN CLERK'S OFFICE
Melissa Cordeiro, Town Clerk

10 Court Street
Bristol, RI 02809
Tel. 401-253-7000
Fax. 401-253-2647
Email: Mcordeiro@bristolri.gov

MEMORANDUM

TO: Steven Contente
TOWN ADMINISTRATOR

FROM: Melissa Cordeiro
COUNCIL CLERK

DATE: May 19, 2023

RE: Peter Carvelli, Foglia, 31 State Street - -
Request for State Street Seasonal Outdoor Expansion
with Alcohol Service License

May we please have your recommendation or the recommendation of the department head you deem appropriate in order for the Council to review the request at the regular Town Council Meeting to be held tentatively on **May 31, 2023**.

All items for this docket must be received in the Clerk's office before 12:00 noon on Wednesday, May 24, 2023. All and any items received after the deadline will be held until the next council agenda.

Thank you for your cooperation and prompt reply.
Attachment