



Town of Bristol, Rhode Island
Zoning Board of Review

10 Court Street
Bristol, RI 02809
401-253-7000
www.bristolri.gov

File #2024-04

PUBLIC HEARING

Notice is hereby given by the Zoning Board of Review
that a public hearing will be held on the following application:

Monday, February 5, 2024
at 7:00 P.M.
Bristol Town Hall
10 Court Street

APPLICANT: **Larry Goldstein / TSL, LLC**
PROPERTY OWNER: **TSL, LLC**
LOCATION: **267 Thames Street**
PLAT: **9** LOT: **50**
ZONE: **Waterfront (W)**

APPLICANT IS REQUESTING A **DIMENSIONAL VARIANCE**: to modify exterior walls and roofline of a portion of the existing Bristol Harbor Inn hotel building and construct eight (8) new hotel rooming units on the third floor of the structure with less than the required lot area per rooming unit.

Edward M. Tanner,
Principal Planner / Zoning Enforcement Officer

Scanned copies of all applications and supporting materials will be available on the Town of Bristol web site at <https://www.bristolri.gov/government/boards/zoning-board-of-review/>. If you have any comments regarding this petition, but are unable to attend, you may submit your comments in writing to the Zoning Board via regular mail addressed to: Zoning Board of Review, Bristol Town Hall, 10 Court Street, Bristol, RI 02809 or via email to etanner@bristolri.gov. Written comments should be received no later than 12:00 p.m. on Thursday, February 1, 2024.



Town of Bristol, Rhode Island

TOWN OF BRISTOL
COMMUNITY DEV.

Department of Community Development
Zoning Board of Review

DEC 14 AM 11:58

APPLICATION

File No: 2024-04
Accepted by ZEO: EMT 12/4/2023

APPLICANT	Name: TSL, LLC (attn: Larry Goldstein)
	Address: 244 Gano Street
	City: Providence State: RI Zip: 02906
	Phone #: 401-453-0038 Email: larry@goldsteinassociates.com
PROPERTY OWNER	Name: TSL, LLC (attn: Larry Goldstein)
	Address: 244 Gano Street
	City: Providence State: RI Zip: 02906
	Phone #: 401-453-0038 Email: larry@goldsteinassociates.com

1. Location of subject property: 267 Thames Street, Bristol, RI

Assessor's Plat(s) #: 9 Lot(s) #: 50

2. Zoning district in which property is located: (W) Waterfront District

3. Zoning Approval(s) required (check all that apply):

Dimensional Variance(s) Special Use Permit Use Variance

4. Which particular provisions of the Zoning Ordinance is applicable to this application?:

Dimensional Variance Section(s): 28-112 Table C

Special Use Permit Section(s): _____

Use Variance Section(s): _____

5. In a separate written statement, please describe the grounds for the requested variance or special use permit and how the proposal will meet the standards found in Section 28-409 of the Zoning Ordinance.

6. How long have you owned the property?: 8 years

7. Present use of property: Hotel, Office, and Retail

8. Is there a building on the property at present?: Yes

9. Dimensions of existing building (size in feet, area in square feet, height of exterior in feet): _____

Existing building size is 52'-8" x 227'-1" (11,960 sq.ft.). Existing height is 50'-11 at the tallest part of the roof from lowest point in grade.

10. Proposed use of property: Continuation of hotel only on 2nd and 3rd floors of the Arch and Taylor/Diman building, but adding 8 units, with a continuation of office and retail space on first floor.

11. Give extent of proposed alterations: Demolition of existing roof structure of the eastern wing of existing building (Bristol Harbor Inn) as shown on attached plans, followed by a third floor addition with 8 identical hotel units. New windows will match existing windows on hotel.

12. Dimensions of proposed building/addition (size in feet, area in square feet, height of exterior in feet): _____
Proposed area of work is 6406 sq. ft. Proposed height of new work is within the existing height of the building, and contained within the 3rd and 4th floors.

13. If dimensional relief is being sought, please state the required and proposed dimensions and setback distances between the proposed building/addition and each lot line:

Front lot line(s):	Required Setback: <u>N/A</u>	Proposed Setback: <u>N/A</u>
Left side lot line:	Required Setback: <u>N/A</u>	Proposed Setback: <u>N/A</u>
Right side lot line:	Required Setback: <u>N/A</u>	Proposed Setback: <u>N/A</u>
Rear lot line:	Required Setback: <u>N/A</u>	Proposed Setback: <u>N/A</u>
Building height:	Required: <u>35'</u>	Proposed: <u>50'5" to new ridge</u>

Other dimensions (building size, lot coverage, lot area, parking, sign dimensions, etc.):
Required: _____ Proposed: _____

13. Number of families before/after proposed alterations: N/A Before _____ After _____

14. Have you submitted plans for the above alterations to the Building Official? No
If yes, has he refused a permit? _____ If refused, on what grounds? _____

15. Are there any easements on your property?: No (If yes, their location must be shown on site plan)

16. Which public utilities service the property?: Water: Yes Sewer: Yes

17. Is the property located in the Bristol Historic District or is it an individually listed property?: Yes

18. Is the property located in a flood zone? Yes If yes, which one?: VE 14

I, the undersigned, attest that all the information provided on this application is true and accurate to the best of my knowledge:

Applicant's Signature: Larry Goldstein Date: 12-13-23

Print Name: Larry Goldstein

Property Owner's Signature: Larry Goldstein Date: 12-13-23

Print Name: Larry Goldstein

Name of attorney or agent (engineer, architect, etc.), if any, who is authorized to represent the applicant:

Name: Spencer McCombe, Architect Telephone #: 401-662-6338

Address: Cordtsen Design Architecture, 42 West Main Rd., Middletown, RI 02842



CORDTSEN DESIGN ARCHITECTURE, INC
42 West Main Rd • Middletown • RI
CordtsenDesign.com • 401.619.4689

Grounds for Requested Variance for Bristol Harbor Inn, 267 Thames Street, Bristol RI

Variance requested for 8 Additional Rooming Units

1. The applicant is requesting dimensional relief to add eight (8) new hotel rooming units to the 3rd floor of this building, to bring the hotel use on this parcel up to a total of 71 rooming units, which would require 106,500 square feet of lot area. This lot contains approximately 74,488 square feet of lot area; so the variance requested with respect to lot area per rooming unit is 32,012 square feet. The variance would provide for 1,049 square feet per rooming unit rather than the required 1,500 square feet for a variance of 451 square feet per rooming unit. (A variance allowing 1,182 square feet per rooming unit, and 126,000 square feet of lot area, was approved on 09-27-2018 when the required square footage per rooming unit was 2,000 square feet.) The reason the applicant requires dimensional relief is that there are hardships that exist due to unique characteristics of the subject land and their structures located on the property, and not to the general character of the surrounding area. The unique characteristics of the subject land and structures are that this entire mixed-use development is comprised of largely historic colonial buildings, including a former warehouse building converted into a restaurant. It is a very unique setup that is densely developed out, that is mixed-use in nature, and is limited in terms of what can be done with it. The section of the building being considered for the variance -- a portion of the 3rd floor of the main hotel building -- has existing egress and circulation without the 4 rooms on each side. The parcel shares parking with other businesses and that arrangement works well for all parties. No additional parking would be required according to our calculations.
2. The hardship is not the result of any prior action on the part of the applicant. The physical layout of the commercial space is what has been in place for a number of years. The applicant did not build these colonial buildings but is trying to make the best use of them not only for their own benefit, but for the benefit of the unique historic downtown waterfront district, which is significantly important to the town's economic success. This is the only hotel in the East Bay which is significantly undersized. This hardship is not due to an economic disability on the part of the applicant or the desire to realize greater financial gain, but to make the best use of an underutilized area of the existing building. Although it is recognized that the applicant is in fact a business, and seeks to make a profit in the renting of additional hotel rooming units, the conversion of this space on the 3rd floor would contribute to the overall ability of the operator of the hotel to serve the needs of the community.
3. The granting of relief would not alter the general characteristics of the surrounding area or impair the intent or purpose of the Zoning Ordinance or the Comprehensive Plan of the Town of Bristol. From the exterior there will be a small change in appearance to the building, as approved by the Historic District Commission on 09-07-2023. It will not impair the intent of the Town's Comprehensive Plan, which

identifies the need for more economic activity and in particular the available hotel space to serve the tourist and hospitality business overall in the Town of Bristol.

4. The variance granted by the Board is the least relief from the provisions of the Zoning Ordinance necessary to remove the aforementioned hardship. The relief being requested is the least relief necessary and likely to be the last relief for hotel rooms that the applicant can ask for as there does not appear to be any more space that can be converted into hotel rooms, having converted some with previous variances.
5. The hardship that would be suffered by the owner if the dimensional variance were not granted would amount to more than a mere inconvenience, because the applicant would be unable to convert these existing upper floor spaces into additional rooming units, which will be a benefit to the community.



09/11/2023
02:09:01 PM
1 Pages

DECISION
Bk: 2223 Pg: 41
Instr: 2023-5900

TOWN HALL
10 COURT ST.
BRISTOL, RI
02809
401-253-7000

Bristol Historic District Commission
Decision Letter

September 8, 2023

TSL, LLC (Attn: Larry Goldstein)/
244 Gano St., Providence, RI 02906

RE: BHDC Review

259-267 Thames St, Bristol, RI (Bristol Harbor Inn)

Plat #9, Lot #40

Application 23-112

Dear Applicant:

At its September 7, 2023 meeting, the Bristol Historic District Commission reviewed your proposed work on the property noted above; the motion on your application was as follows:

To approve application 23-112 as presented to -

To approve application 23-112 as noted to add additional level to eastern wing of structure, windows to be approved by building official.

The Findings of Facts include that this decision conforms to the Secretary of the Interior's Standards for:

9 - New additions, exterior alterations, or related new construction will not destroy historic materials, features, and spatial relationships that characterize the property. The new work will be differentiated from the old and will be compatible with the historic materials, features, size, scale and proportion, and massing to protect the integrity of the property and its environment.

Commission member **John M. Allen** will be your project monitor. If you need to speak with your monitor(s) or are ready for final review of the completed project please call me at Town Hall, 401-253-7000 x153, and I will contact them for you.

The Certificate of Appropriateness, referred to at the meeting as the "Green Sheet", is part of your permit and will be issued on approval. Work cannot begin, nor a building permit obtained, without your signing this document. Once signed and completed, a copy of the Certificate will be sent to you via the online permitting software, authorizing you to begin your work.

Sincerely,

Nicholas Toth

Planner/HDC Clerk

Received for record at Bristol, RI
9/11/2023 02:09:01 PM



Owner

Owner 1	TSL LLC	% Owned	0.00
Owner 2		% Owned	0.00
Owner 3		% Owned	0.00
Address 244 GANO ST, PROVIDENCE, RI 02906-0000			

Previous Owners & Sales Information

Grantor	Date	Sale Price	Leg Ref	NAL	Deed Type
MILES AVE. PROPERTY CO, LLC	09/09/2015	7,482,000	1816-343	K	W
MILES AVE. PROPERTY CO, LLC	10/05/1998	0	668-172		W
O'CONNELL, J. REALTY CO.	12/10/1997	0	630-77		
COMMERCIAL FINANCE CORP. NEWPORT	01/01/1962	0	122-454		
PAULL, PRESCOTT B.	01/01/1952	0	122-453		

Assessment

Use Code	Bldg Value	SF/YI Value	Land Size	Land Value	AG Credit	Assessed Value
06	5,508,000	6,000	1.71	2,250,300	0	7,764,300
TOTAL	5,508,000	6,000	1.71	2,250,300	0	7,764,300

Source > Mkt Adj Cost VAL per SQ Unit/Card > 100.83 VAL per SQ Unit/Parcel > 111.08

Previous Assessments

Year	LUC	Building	SF/YI	Land Size	Land Value	AGR Credit	Appraised Value	Assessed Value
2022	06	5,508,000	6,000	2	2,250,300	0	7,764,300	7,764,300
2021	06	5,624,200	6,000	2	2,319,900	0	7,950,100	7,950,100
2020	06	5,584,100	6,000	2	2,319,900	0	7,910,000	7,910,000
2019	06	5,584,100	6,000	2	2,319,900	0	7,910,000	7,910,000
2018	06	6,596,900	6,000	2	925,700	0	7,528,600	7,528,600
2017	06	6,552,500	6,000	2	925,700	0	7,484,200	7,484,200

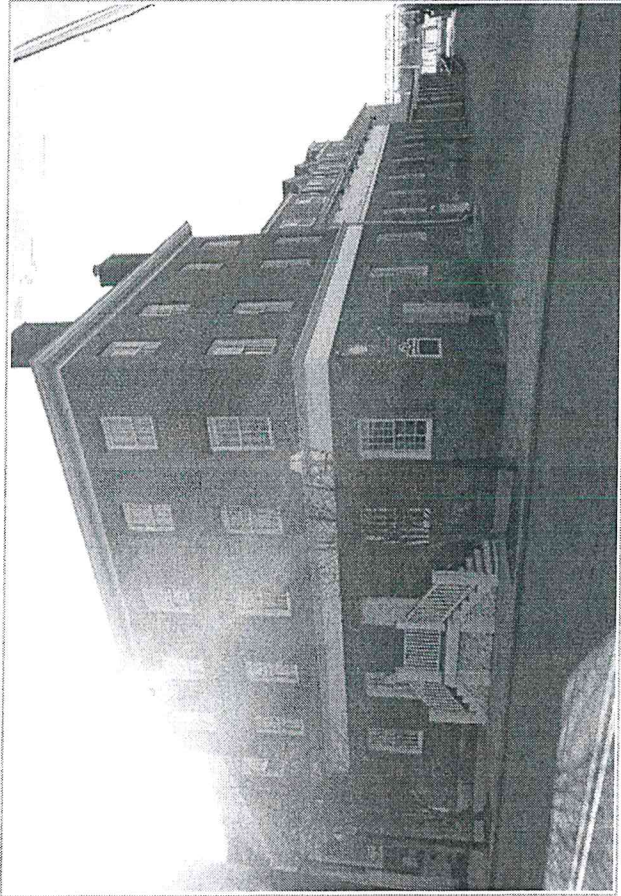

Unsketched Subareas:

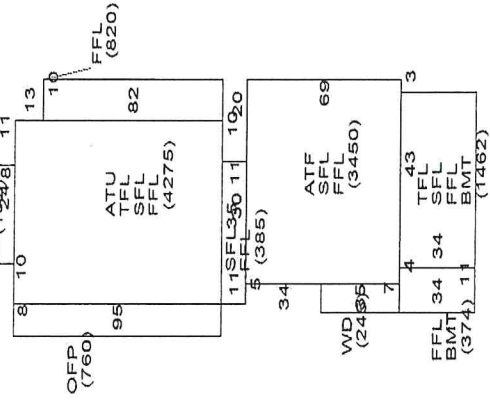

Land Information

Use Description	Units	Unit Type	Land Type	LT Fact	Unit Price	Adjusted	Neigh	Inf 1	Inf 1 %	Inf 2	Inf 2 %	Inf 3	Inf 3 %	Appr Value	Spec Land	Juris	Fact	Use Value	
1																			
2																			
3																			
4																			



Building Information

Description	Hotels	Story Height	3 Story	Description
BLDG Type	0	COM Units	40	
RES Units		BMT Floor		
Foundation	Wood	Frame 2	%	
EXT Wall 1	Clapboard	EXT Wall 2	%	
Roof Type 1	Gable	Roof Type 2	%	
Roof Cover 1	Asphalt Shir	Roof Cover 2	%	
INT Wall 1	Plaster	INT Wall 2	%	
Floors 1		Floors 2	%	
BMT Garages		Color		
Plumbing		Electrical		
Insulation		INT vs EXT		
Heat Fuel	Oil	Heat Type	Warm & Cool	
# Heat Sys		% Heated	100	
% Solar HW		% A/C		
% COM Wall		% Vacuum		
Ceiling HIGHT	7	Ceiling Type		
Parking Type		% Sprinkled	100	
EXT View				

Grade

Grade	Q3+	Q3+	Flood Hazard
Year Built	1900	EFF Year	2004
Alt LUC		Alt %	0.00

Other Factors

Code	Description	%
GD	GD - Good	13.0
Condition		
Functional		
Economic		
Special		
OV		

Depreciation

Code	Description	%
GD	GD - Good	13.0
Condition		
Functional		
Economic		
Special		
OV		

Total Depreciation % > 13.0

Basement

Code	Description	Area	Fin. Area	Rate	Undep V
1st FLOOR		10,958	#####	80.80	885,407
2nd FLOOR		9,764	9,764	80.80	788,932
3rd FLOOR		5,737	5,737	80.80	463,550
FBMC	COMM FIN BSM	1,836	1,836	28.28	51,922
ATF	FIN ATTIC	1,380	1,380	80.80	111,504
OPF	OPEN PORCH	760	0	9.79	7,440
ATU	UNF ATTIC	1,710	0	8.08	13,817
WD	WOOD DECK	245	0	15.70	3,847
BMT	BASEMENT	1,836	0	12.12	22,252
Total		34,226	#####		2,348,671

Remodeling History

Issue Date	Permit#	Closed Date	BP Type	Est. Cost	% Done	Status	Description/Directions
1							
2							
3							
4							
5							
6							
7							
8							
9							

Condo Data

Complex	Location	Tot Units	FL Level	# Floors	Bldg Seq
				0	2

Notes

BRISTOL HARBOR INN

Sub-Area Detail

Code	Description	Area	Fin. Area	Rate	Undep V
FFL	1st FLOOR	10,958	#####	80.80	885,407
SFL	2nd FLOOR	9,764	9,764	80.80	788,932
TFL	3rd FLOOR	5,737	5,737	80.80	463,550
FBMC	COMM FIN BSM	1,836	1,836	28.28	51,922
ATF	FIN ATTIC	1,380	1,380	80.80	111,504
OPF	OPEN PORCH	760	0	9.79	7,440
ATU	UNF ATTIC	1,710	0	8.08	13,817
WD	WOOD DECK	245	0	15.70	3,847
BMT	BASEMENT	1,836	0	12.12	22,252
Total		34,226	#####		2,348,671

Visit History

Date	Result	By
10/20/2021	REVIEW	AD
10/5/2018	REVIEW	JH
8/29/2018	MEASURED	JE
5/26/2015	ADJ-HEARIN	RN
1/11/2008	MEASURE	
1/11/2008	LISTED	
1/10/2008	MEASURE	
1/10/2008	LISTED	
1/10/2008	MEASURE	

Room Counts by Floor

Units	# Rooms	# Bedrooms	Floor Level
1	40	1	U
2			
3			
4			
Totals	40	40	

Special Features & Yard Items

Use	Description	A	Y/S	Qty	Length	Width	SF Size	Quality	Condition	Year	Assessed Value
1											
2											
3											
4											
5											
6											
7											
8											
9											
10											

Building Permits

Issue Date	Permit#	Closed Date	BP Type	Est. Cost	% Done	Status	Description/Directions
1							
2							
3							
4							
5							
6							
7							
8							
9							

Other Info.

AFDU
TermRental
PriorID1c
PriorID2a
PriorID2b
PriorID2c
PriorID3a
PriorID3b
PriorID3c

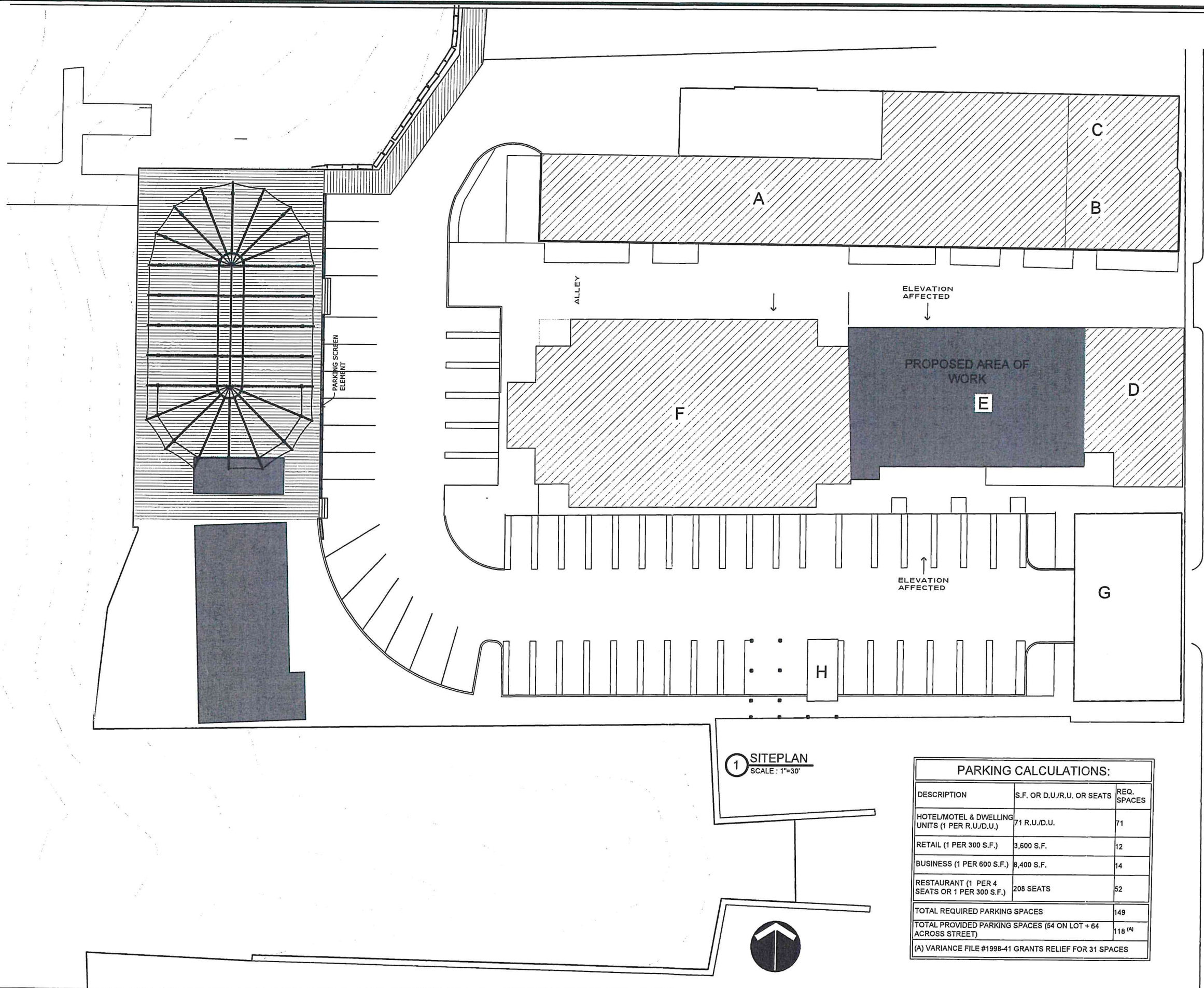

1 SITEPLAN
SCALE: 1"=30'

PARKING CALCULATIONS:		
DESCRIPTION	S.F. OR D.U./R.U. OR SEATS	REQ. SPACES
HOTEL/MOTEL & DWELLING UNITS (1 PER R,U/D,U.)	71 R,U/D,U.	71
RETAIL (1 PER 300 S.F.)	3,600 S.F.	12
BUSINESS (1 PER 600 S.F.)	8,400 S.F.	14
RESTAURANT (1 PER 4 SEATS OR 1 PER 300 S.F.)	208 SEATS	52
TOTAL REQUIRED PARKING SPACES		149
TOTAL PROVIDED PARKING SPACES (54 ON LOT + 64 ACROSS STREET)		118 (A)
(A) VARIANCE FILE #1998-41 GRANTS RELIEF FOR 31 SPACES		

BUILDING LEGEND:

- A Existing-James DeWolf Warehouse
- B Existing-Byron Diman's Counting House
- C Existing-William Taylor's Store
- D Existing/New-Bank of Bristol
- E Existing Bank of Bristol Addition
- F Existing Former Coal and Lumber Building
- G Existing Arch Building
- H Bike/Retail/Office
- I Existing-Wholesale Seafood
- J Existing Office Building
- K Boardwalk/Wedding Deck Office Building

Thames Street



CORPUS DESIGN ARCHITECTURE
42 West Main Road
Middletown, RI 02842
CorpusDesign.com
401.877.4681

PROGRESS PRINT
DATE: _____
NOT FOR CONSTRUCTION

REVISIONS:

DESCRIPTION:	SITE PLAN
SCALE:	AS NOTED
DATE:	08-09-2023

NHG BRISTOL HARBOR INN
259 THAMES STREET, BRISTOL RI 02809

A0.1

ALL CONSTRUCTION SHALL BE IN ACCORDANCE WITH THE BUILDING CODES AND REGULATIONS OF THE STATE OF RHODE ISLAND. THE DRAWING IS NOT TO BE USED FOR CONSTRUCTION OF ANY BUILDING WITHOUT FIRST OBTAINING THE WRITTEN AUTHORIZATION FROM CORPUS DESIGN ARCHITECTURE, INC.



1 EXISTING NORTH ELEVATION
Scale: 1/16" = 1'-0"

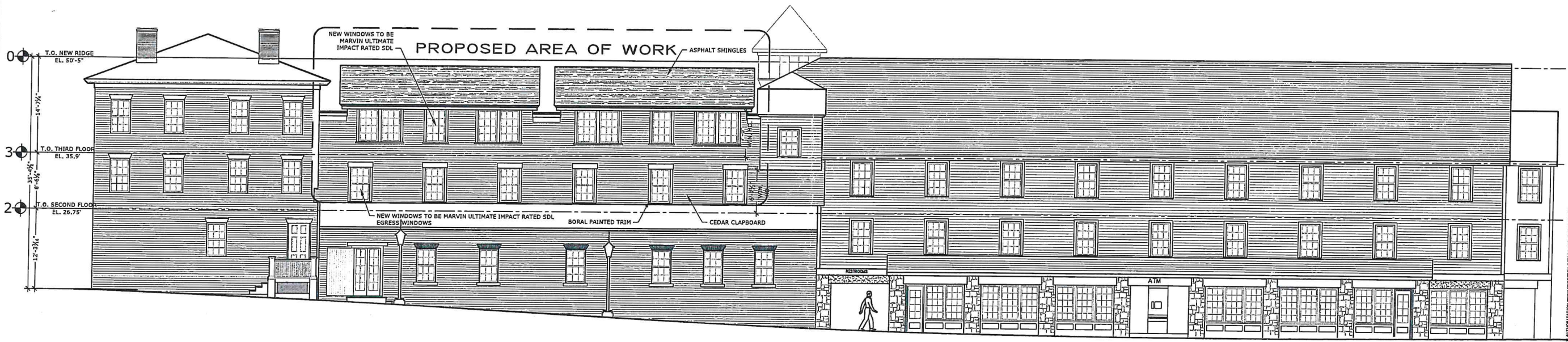

2 PROPOSED NORTH ELEVATION
Scale: 1/16" = 1'-0"

CDA
CORBEN
DESIGN
ARCHITECTURE
42 West Main Road
Medford, RI 02842
CorbenDesign.com
401.879.4489

PROGRESS PRINT
DATE: _____
NOT FOR CONSTRUCTION

REVISIONS:

DESCRIPTION:
FLOOR PLANS
SCALE: AS NOTED
DATE: 07-07-2023

NHG BRISTOL
HARBOR INN
259 THAMES STREET, BRISTOL RI 02809

A2.0

2023 © COPYRIGHT: THIS DRAWING IS NOT TO BE USED FOR MAKING ANY REPRODUCTION THEREOF, OR FOR CONSTRUCTION OF ANY BUILDING WITHOUT FIRST OBTAINING THE WRITTEN AUTHORIZATION FROM CORBEN DESIGN ARCHITECTURE, INC.



1 EXISTING SOUTH ELEVATION
Scale: 1/16" = 1'-0"



2 PROPOSED SOUTH ELEVATION
Scale: 1/8" = 1'-0"

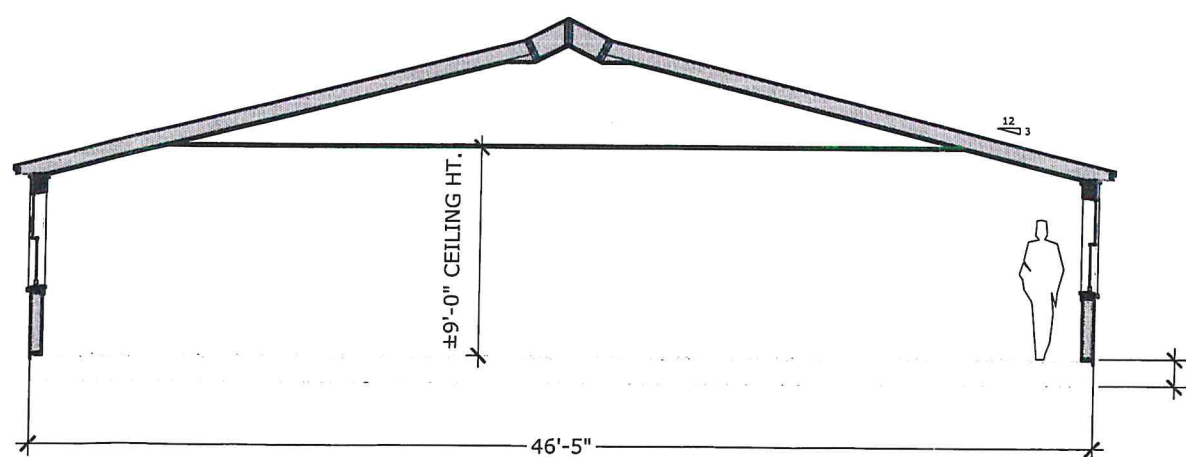
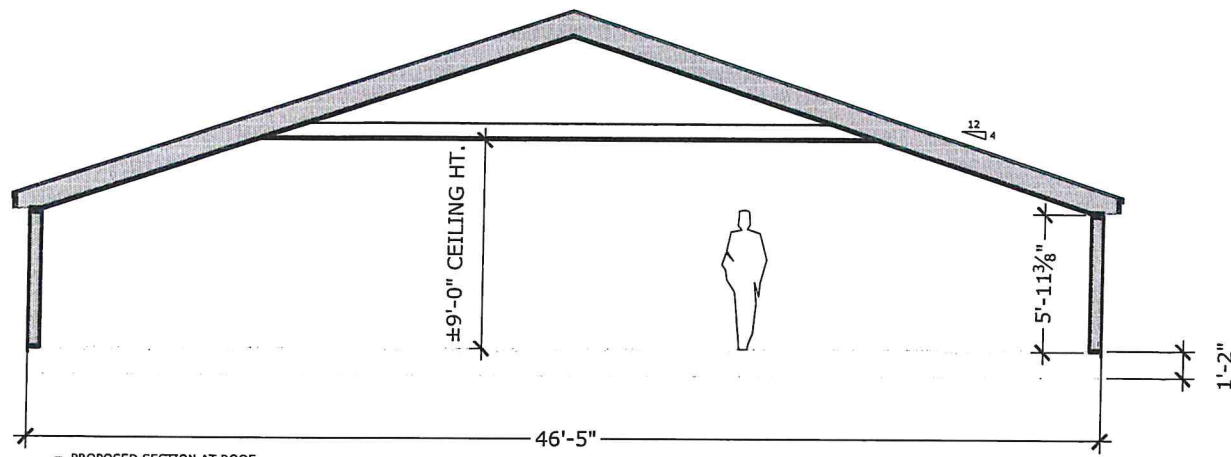

PROGRESS PRINT
DATE: NOT FOR CONSTRUCTION

REVISIONS:
DESCRIPTION:
FLOOR PLANS
SCALE: AS NOTED
DATE: 07-07-2023

NHG BRISTOL
HARBOR INN
259 THAMES STREET, BRISTOL RI 02809

A2.1

THIS DRAWING IS NOT TO BE USED FOR MAKING ANY REPRODUCTION THEREOF, OR FOR CONSTRUCTION OF ANY BUILDING WITHOUT FIRST OBTAINING THE WRITTEN AUTHORIZATION FROM THE ARCHITECT.

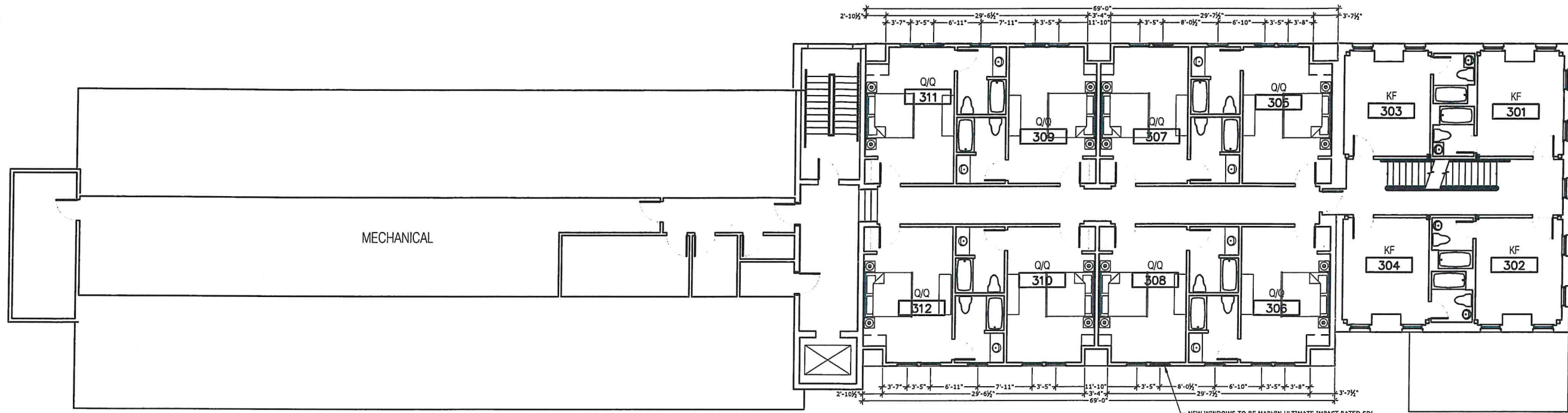

1 PROPOSED THIRD FLOOR PLAN
Scale: 1/16" = 1'-0"

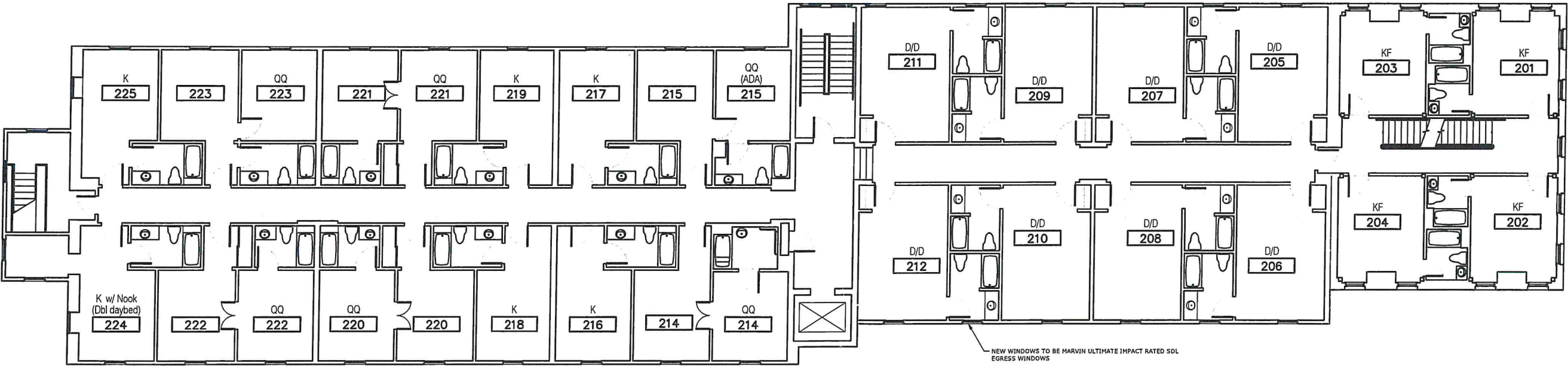

2 PROPOSED SECOND FLOOR PLAN
Scale: 1/16" = 1'-0"



PROGRESS PRINT
DATE: _____
NOT FOR CONSTRUCTION

REVISIONS:

DESCRIPTION:
FLOOR PLANS
SCALE: AS NOTED
DATE: 07-07-2023

NHG BRISTOL
HARBOR INN
259 THAMES STREET, BRISTOL RI 02809

A2.2

100% & CONTRACT. THIS DRAWING IS NOT TO BE USED FOR MARKING ANY REPRODUCTION THEORY OR FOR CONSTRUCTION OF ANY BUILDING WITHOUT FIRST OBTAINING THE WRITTEN AUTHORIZATION FROM CORDIEN DESIGN ARCHITECTURE, INC.



© EXTERIOR PHOTO 1



CORDTSEN
 ARCHITECTURE
 42 West Main Road
 Middletown, RI 02842
 CordtсенDesign.com
 401.819.4689

PROGRESS PRINT
 DATE: _____
 NOT FOR CONSTRUCTION

REVISIONS:

DESCRIPTION:
 EXTERIOR PHOTO

SCALE: AS NOTED

DATE: 07-07-2023

NHG BRISTOL
 HARBOR INN
 259 THAMES STREET, BRISTOL RI 02809

A7.0

2023 © COPYRIGHT. THIS DRAWING IS NOT TO BE USED FOR MARKING ANY REPRODUCTION THEREOF, OR FOR CONSTRUCTION OF ANY BUILDING, WITHOUT THE WRITTEN PERMISSION OF CORDTSEN ARCHITECTURE, P.C.



① EXTERIOR PHOTO 2



**CORDTSEN
DESIGN
ARCHITECTURE**
42 West Main Road
Middletown, RI 02842
CordtsenDesign.com
401.819.4689

PROGRESS PRINT

DATE: _____
NOT FOR CONSTRUCTION

REVISIONS:

DESCRIPTION: EXTERIOR PHOTO
SCALE: AS NOTED
DATE: 07-07-2023

**NHG BRISTOL
HARBOR INN**
259 THAMES STREET, BRISTOL RI 02809

A7.1

DATE: 07-07-2023 10:58 AM
 C:\Users\jacob\OneDrive\Documents\Projects\NHG Bristol Harbor Inn\A7.1 EXTERIOR PHOTO 2.rvt
 259 THAMES STREET, BRISTOL RI 02809
 NHG BRISTOL HARBOR INN
 259 THAMES STREET, BRISTOL RI 02809
 CORDTSEN DESIGN ARCHITECTURE
 42 WEST MAIN ROAD
 MIDDLETOWN, RI 02842
 401.819.4689
 CORDTSENDESIGN.COM



267 Thames Street - 200' Radius

Bristol, RI



January 11, 2024

1 inch = 281 Feet

www.cai-tech.com

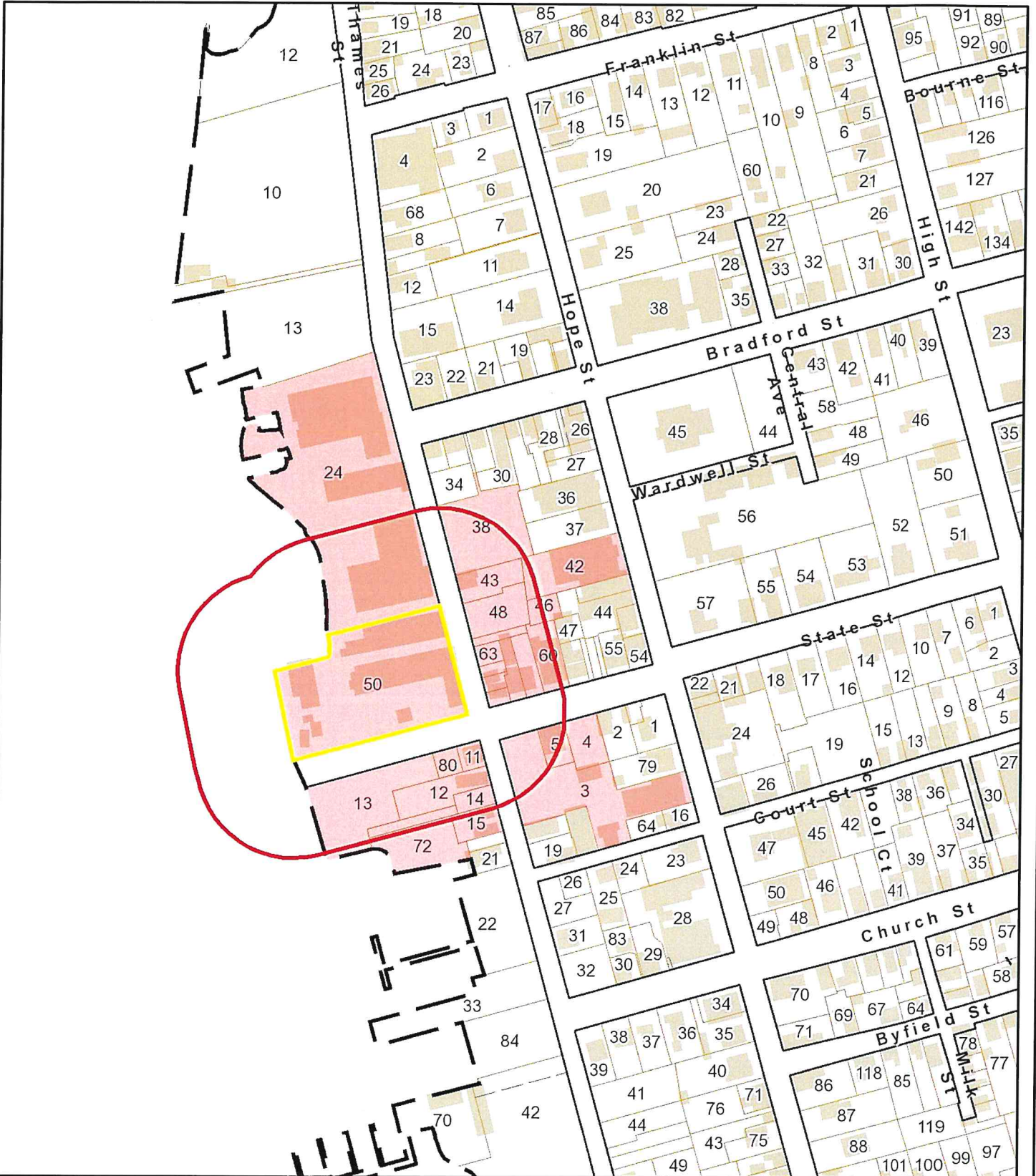

Data shown on this map is provided for planning and informational purposes only. The municipality and CAI Technologies are not responsible for any use for other purposes or misuse or misrepresentation of this map.



200 foot Abutters List Report

Bristol, RI
January 11, 2024

Subject Property:

Parcel Number: 9-50
CAMA Number: 9-50
Property Address: 267 THAMES ST

Mailing Address: TSL LLC
244 GANO ST
PROVIDENCE, RI 02906

Abutters:

Parcel Number: 10-11
CAMA Number: 10-11
Property Address: 235 THAMES ST

Mailing Address: BOZARTH, PETER
235 THAMES ST
BRISTOL, RI 02809

Parcel Number: 10-12
CAMA Number: 10-12-001
Property Address: 227 THAMES ST- UNIT #1

Mailing Address: CARTWRIGHT, CORINNE M & PAUL B D
227 THAMES ST., UNIT 1
BRISTOL, RI 02809

Parcel Number: 10-12
CAMA Number: 10-12-002
Property Address: 227 THAMES ST- UNIT #2

Mailing Address: OQUENDO, VIVIAN Y
227 THAMES ST, UNIT 2
BRISTOL, RI 02809

Parcel Number: 10-12
CAMA Number: 10-12-003
Property Address: 227 THAMES ST- UNIT #3

Mailing Address: BALZANO, JOHN G & CHRISTINE R TE
82 NEWPORT RD
HULL, MA 02045

Parcel Number: 10-12
CAMA Number: 10-12-004
Property Address: 227 THAMES ST UNIT #4

Mailing Address: COLOMBO, BRITT C & MARY L JT
227 THAMES ST
BRISTOL, RI 02809

Parcel Number: 10-12
CAMA Number: 10-12-005
Property Address: 227 THAMES ST UNIT #5

Mailing Address: MATTHEWS, CHARLES C. TARA W. TE
223 OAKLAND BEACH AVE
RYE, NY 10580

Parcel Number: 10-12
CAMA Number: 10-12-006
Property Address: 227 THAMES ST -UNIT #6

Mailing Address: THAMES STREET, LLC
227 THAMES ST, Unit 6
BRISTOL, RI 02809

Parcel Number: 10-12
CAMA Number: 10-12-007
Property Address: THAMES ST

Mailing Address: BALZANO, JOHN G & CHRISTINE R TE
82 NEWPORT RD
HULL, MA 02045

Parcel Number: 10-12
CAMA Number: 10-12-008
Property Address: THAMES ST

Mailing Address: OZTERMIYECI, MUSTAFA M.
341 THAMES ST UNIT 203
BRISTOL, RI 02809

Parcel Number: 10-12
CAMA Number: 10-12-009
Property Address: THAMES ST

Mailing Address: OZTERMIYECI, MUSTAFA M.
341 THAMES ST UNIT 203
BRISTOL, RI 02809



www.cai-tech.com

Data shown on this report is provided for planning and informational purposes only. The municipality and CAI Technologies are not responsible for any use for other purposes or misuse or misrepresentation of this report.



200 foot Abutters List Report

Bristol, RI
January 11, 2024

Parcel Number: 10-13 CAMA Number: 10-13 Property Address: THAMES ST	Mailing Address: TOWN OF BRISTOL 10 COURT ST BRISTOL, RI 02809
Parcel Number: 10-14 CAMA Number: 10-14 Property Address: THAMES ST	Mailing Address: TOWN OF BRISTOL VACANT LAND 10 COURT ST. BRISTOL, RI 02809
Parcel Number: 10-15 CAMA Number: 10-15 Property Address: 211 THAMES ST	Mailing Address: TOWN OF BRISTOL 10 COURT ST. BRISTOL, RI 02809
Parcel Number: 10-3 CAMA Number: 10-3-001 Property Address: 423 HOPE ST 1A	Mailing Address: MCKAY, SUSAN ANDON, TRUSTEE SUSAN ANDON MCKAY LIVING TRUST 186 OAKLAND ST WELLESLEY, MA 02481
Parcel Number: 10-3 CAMA Number: 10-3-002 Property Address: 423 HOPE ST 2B	Mailing Address: HAYES, MATTHEW D TRUSTEE MATTHEW D HAYES REV TRUST 423 HOPE ST UNIT B BRISTOL, RI 02809
Parcel Number: 10-3 CAMA Number: 10-3-003 Property Address: 423 HOPE ST 3C	Mailing Address: THOMPSON, RICHARD J - TRUSTEE RICHARD J THOMPSON TRUST 423 HOPE ST, UNIT C BRISTOL, RI 02809
Parcel Number: 10-3 CAMA Number: 10-3-004 Property Address: 423 HOPE ST 4D	Mailing Address: SMITH, DEBORAH ROSE & ALLEN, CHRISTOPHER TE 423 HOPE ST, UNIT D BRISTOL, RI 02809
Parcel Number: 10-3 CAMA Number: 10-3-005 Property Address: 423 HOPE ST 5E	Mailing Address: WARNER, GARY W & MURRAY, CATHERINE I JT PO BOX 808 BRISTOL, RI 02809
Parcel Number: 10-3 CAMA Number: 10-3-006 Property Address: 423 HOPE ST 6F	Mailing Address: NICHOLSON, TODD & 423 HOPE ST UNIT 6F BRISTOL, RI 02809
Parcel Number: 10-3 CAMA Number: 10-3-007 Property Address: 423 HOPE ST 7G	Mailing Address: CLARK, ALLEN M. & CLARK, WHITNEY O. TRUSTEES 423 HOE ST, UNIT G BRISTOL, RI 02809
Parcel Number: 10-3 CAMA Number: 10-3-008 Property Address: 423 HOPE ST 8H	Mailing Address: MACDONALD, JAMES C 423 HOPE ST, UNIT H BRISTOL, RI 02809
Parcel Number: 10-3 CAMA Number: 10-3-010 Property Address: 423 HOPE ST 10J	Mailing Address: SCOTT, WENDELL O & PATRICIA C TE 700 MOUNTAIN AVE WESTFIELD, NJ 07090



www.cai-tech.com

Data shown on this report is provided for planning and informational purposes only. The municipality and CAI Technologies are not responsible for any use for other purposes or misuse or misrepresentation of this report.

1/11/2024

Page 2 of 15



200 foot Abutters List Report

Bristol, RI
January 11, 2024

Parcel Number: 10-3
CAMA Number: 10-3-011
Property Address: 423 HOPE ST 11K

Mailing Address: PAGE, ROBERT W & MYRA M,
TRUSTEES PAGE FAMILY TRUST
423 HOPE ST, Unit K
BRISTOL, RI 02809

Parcel Number: 10-3
CAMA Number: 10-3-012
Property Address: 423 HOPE ST 12L

Mailing Address: MATRONE, SANTA W JR TRUSTEE
SANTA W MATRONE JR DEC TRUST
423 HOPE ST UNIT L-12
BRISTOL, RI 02809

Parcel Number: 10-3
CAMA Number: 10-3-013
Property Address: 423 HOPE ST 13M

Mailing Address: SAILOR, LLC
423 HOPE ST, Unit 13M
BRISTOL, RI 02809

Parcel Number: 10-3
CAMA Number: 10-3-014
Property Address: 423 HOPE ST 14N

Mailing Address: SHAPIRO, DEBORA WEST
423 HOPE ST, Unit UNIT 14N
BRISTOL, RI 02809

Parcel Number: 10-3
CAMA Number: 10-3-016
Property Address: 423 HOPE ST 16P

Mailing Address: BOWMAN, GREGORY W
423 HOPE ST, UNIT P
BRISTOL, RI 02809

Parcel Number: 10-3
CAMA Number: 10-3-017
Property Address: JOHN ST 1

Mailing Address: FIXSEN, WILLIAM
25 MARCONI DR
RANDOLPH, MA 02368

Parcel Number: 10-3
CAMA Number: 10-3-018
Property Address: JOHN ST 2

Mailing Address: TOPPA, JOHNA M
44 LINCOLN AVE
ATTLEBORO, MA 02703

Parcel Number: 10-3
CAMA Number: 10-3-019
Property Address: 15 JOHN ST 1

Mailing Address: POLLOCK, JORDAN
15 JOHN ST, UNIT 1
BRISTOL, RI 02809

Parcel Number: 10-3
CAMA Number: 10-3-020
Property Address: 17 JOHN ST 2

Mailing Address: MCRAE, BEVERLY SMITH & JOSEPH
KEITH TE
17 JOHN ST, UNIT 2
BRISTOL, RI 02809

Parcel Number: 10-3
CAMA Number: 10-3-021
Property Address: 423 HOPE ST 21U

Mailing Address: NAT PROPERTIES, LLC
26 PATRICIA ANN DR
BRISTOL, RI 02809

Parcel Number: 10-3
CAMA Number: 10-3-022
Property Address: 423 HOPE ST 22V

Mailing Address: 423 HOPE ST REDEVELOPMENT, LLC
C/O ACROPOLIS PROPERTY
MANAGEMENT 423 HOPE ST
BRISTOL, RI 02809

Parcel Number: 10-4
CAMA Number: 10-4
Property Address: STATE ST

Mailing Address: TOWN OF BRISTOL STATE STREET
10 COURT ST
BRISTOL, RI 02809



www.cai-tech.com

Data shown on this report is provided for planning and informational purposes only. The municipality and CAI Technologies are not responsible for any use for other purposes or misuse or misrepresentation of this report.

1/11/2024

Page 3 of 15



200 foot Abutters List Report

Bristol, RI
January 11, 2024

Parcel Number: 10-5 CAMA Number: 10-5-001 Property Address: 18 20 STATE ST 1	Mailing Address: NEW LEAF REALTY, LLC COMMERCIAL UNITS 1 & 2 18-20 STATE ST BRISTOL, RI 02809
Parcel Number: 10-5 CAMA Number: 10-5-002 Property Address: 18 20 STATE ST 2	Mailing Address: NEW LEAF REALTY, LLC COMMERCIAL UNITS 1 & 2 18-20 STATE ST BRISTOL, RI 02809
Parcel Number: 10-5 CAMA Number: 10-5-003 Property Address: 18 20 STATE ST 3	Mailing Address: EIGHTEEN TWENTY, LLC 52 TALCOTT ST BARRINGTON, RI 02806
Parcel Number: 10-5 CAMA Number: 10-5-004 Property Address: 18 20 STATE ST 4	Mailing Address: EIGHTEEN TWENTY, LLC 52 TALCOTT ST BARRINGTON, RI 02806
Parcel Number: 10-5 CAMA Number: 10-5-005 Property Address: 18 20 STATE ST 5	Mailing Address: EIGHTEEN TWENTY, LLC 52 TALCOTT ST BARRINGTON, RI 02806
Parcel Number: 10-5 CAMA Number: 10-5-006 Property Address: 18 20 STATE ST 6	Mailing Address: EIGHTEEN TWENTY, LLC 52 TALCOTT ST BARRINGTON, RI 02806
Parcel Number: 10-69 CAMA Number: 10-69 Property Address: THAMES ST	Mailing Address: TOWN OF BRISTOL VACANT LAND 10 COURT ST. BRISTOL, RI 02809
Parcel Number: 10-72 CAMA Number: 10-72 Property Address: THAMES ST	Mailing Address: TOWN OF BRISTOL VACANT LAND 10 COURT ST. BRISTOL, RI 02809
Parcel Number: 10-80 CAMA Number: 10-80 Property Address: THAMES ST	Mailing Address: BOZARTH, PETER 235 THAMES ST BRISTOL, RI 02809
Parcel Number: 9-24 CAMA Number: 9-24-001 Property Address: 345 THAMES ST 101N	Mailing Address: JOHNSON, PETER T & ANDREA R TE 345 THAMES ST UNIT N101 BRISTOL, RI 02809
Parcel Number: 9-24 CAMA Number: 9-24-002 Property Address: 345 THAMES ST 102N	Mailing Address: SAUL, DEBRA A 345 THAMES ST # 102 BRISTOL, RI 02809
Parcel Number: 9-24 CAMA Number: 9-24-003 Property Address: 345 THAMES ST 103N	Mailing Address: SB2, LLC 345 THAMES ST, UNIT N-110 BRISTOL, RI 02809



www.cai-tech.com

Data shown on this report is provided for planning and informational purposes only. The municipality and CAI Technologies are not responsible for any use for other purposes or misuse or misrepresentation of this report.

1/11/2024

Page 4 of 15



200 foot Abutters List Report

Bristol, RI
January 11, 2024

Parcel Number: 9-24 CAMA Number: 9-24-004 Property Address: 345 THAMES ST 104N	Mailing Address: BARRENECHEA, MARIO I. & ANA MARIA G. TE 345 THAMES ST UNIT N104 BRISTOL, RI 02809
Parcel Number: 9-24 CAMA Number: 9-24-005 Property Address: 345 THAMES ST 105N	Mailing Address: WAYLAND WILLIAM F & LORNA E TRUSTEES REVOC 345 THAMES ST UNIT 105 N BRISTOL, RI 02809
Parcel Number: 9-24 CAMA Number: 9-24-006 Property Address: 345 THAMES ST 106N	Mailing Address: DEMARCO, MICHAEL D. ELIZABETH M. TE 345 THAMES ST UNIT 106N BRISTOL, RI 02809
Parcel Number: 9-24 CAMA Number: 9-24-008 Property Address: 345 THAMES ST 108N	Mailing Address: CHRISTOPHER, JANET E TRUSTEE CHRISTOPHER FAMILY TRUST 345 THAMES ST #108 BRISTOL, RI 02809
Parcel Number: 9-24 CAMA Number: 9-24-009 Property Address: 345 THAMES ST 109N	Mailing Address: HURST, JAMES WILLIAM & RANDELLE LEE, TRUSTEES HURST FAMILY 2012 TRUST 345 THAMES ST, Unit N109 BRISTOL, RI 02809
Parcel Number: 9-24 CAMA Number: 9-24-010 Property Address: 345 THAMES ST 110N	Mailing Address: HOLLAND, JOYCE A. 345 THAMES ST UNIT 110N BRISTOL, RI 02809
Parcel Number: 9-24 CAMA Number: 9-24-011 Property Address: 345 THAMES ST 201N	Mailing Address: BUNN, JAMES BENNING SR & BUNN, JACQUELINE BRYAN TE 141A Main St Tuckahoe, NY 10707
Parcel Number: 9-24 CAMA Number: 9-24-012 Property Address: 345 THAMES ST 202N	Mailing Address: KUFFNER, TAMARA 9 WALNUT RD BARRINGTON, RI 02806
Parcel Number: 9-24 CAMA Number: 9-24-013 Property Address: 345 THAMES ST 203N	Mailing Address: SHERMAN, MAX CHRISTOPHER & MARY B. TE 746 SPINNAKER BEACHHOUSE VILLA SEABROOK ISLAND, SC 29456
Parcel Number: 9-24 CAMA Number: 9-24-014 Property Address: 345 THAMES ST 204N	Mailing Address: BERNARDO, MATTHEW P 345 THAMES ST, UNIT 204N BRISTOL, RI 02809
Parcel Number: 9-24 CAMA Number: 9-24-015 Property Address: 345 THAMES ST 205N	Mailing Address: MCSTAY, JAMES P. CHERYL A. ETUX TE 345 THAMES ST UNIT 205N BRISTOL, RI 02809
Parcel Number: 9-24 CAMA Number: 9-24-016 Property Address: 345 THAMES ST 206N	Mailing Address: OBRIEN, MICHAEL T. DENISE E. TE 345 THAMES ST UNIT 206N BRISTOL, RI 02809



www.cai-tech.com

Data shown on this report is provided for planning and informational purposes only. The municipality and CAI Technologies are not responsible for any use for other purposes or misuse or misrepresentation of this report.



200 foot Abutters List Report

Bristol, RI
January 11, 2024

Parcel Number: 9-24
CAMA Number: 9-24-017
Property Address: 345 THAMES ST 207N

Mailing Address: CAPODILUPO, PETER & JENNIFER C
345 Thames St Unit 207
Bristol, RI 02809

Parcel Number: 9-24
CAMA Number: 9-24-018
Property Address: 345 THAMES ST 208N

Mailing Address: FITZPATRICK, CAROL A., TRUSTEE
CAROL A FITZPATRICK REVOCABLE
TRUST
345 THAMES ST, UNIT 208N
BRISTOL, RI 02809

Parcel Number: 9-24
CAMA Number: 9-24-019
Property Address: 345 THAMES ST 209N

Mailing Address: SARKISIAN, HERBERT A. JANET E. TE
345 THAMES ST UNIT N209
BRISTOL, RI 02809

Parcel Number: 9-24
CAMA Number: 9-24-020
Property Address: 345 THAMES ST 210N

Mailing Address: FEINS, NEIL R & CHRISTINE TRUSTEES
19 MARSHAL ST
BROOKLINE, MA 02446

Parcel Number: 9-24
CAMA Number: 9-24-021
Property Address: 345 THAMES ST 301N

Mailing Address: ROSS, MICHAEL C & ASTRID L
TRUSTEES
363 ADAMS ST
DENVER, CO 80206

Parcel Number: 9-24
CAMA Number: 9-24-022
Property Address: 345 THAMES ST 302N

Mailing Address: ZELINGER, ELIZABETH A & GERALD D
TE
345 THAMES ST UNIT N302
BRISTOL, RI 02809

Parcel Number: 9-24
CAMA Number: 9-24-023
Property Address: 345 THAMES ST 303N

Mailing Address: SHAMS, NICOLE
345 THAMES ST., UNIT N-303
BRISTOL, RI 02809

Parcel Number: 9-24
CAMA Number: 9-24-024
Property Address: 345 THAMES ST 304N

Mailing Address: PHILLIPS, JOHN S & KIMBERLY L TE
345 THAMES ST 304N
BRISTOL, RI 02809

Parcel Number: 9-24
CAMA Number: 9-24-025
Property Address: 345 THAMES ST 305N

Mailing Address: HANKIN, ROBERT B & CHERYL B,
TRUSTEES ROBERT B & CHERYL B
HANKIN TRUST TC
56 RAMBLING DR
SCOTCH PLAINS, NJ 07076-2955

Parcel Number: 9-24
CAMA Number: 9-24-026
Property Address: 345 THAMES ST 306N

Mailing Address: LI, HSI-CHENG TRUSTEE
345 THAMES ST UNIT N306
BRISTOL, RI 02809

Parcel Number: 9-24
CAMA Number: 9-24-027
Property Address: 345 THAMES ST 307N

Mailing Address: SUTTON, HOWARD G & KIMBERLY G P
TE
14685 KELSON CIRCLE
NAPLES, FL 34114

Parcel Number: 9-24
CAMA Number: 9-24-028
Property Address: 345 THAMES ST 308N

Mailing Address: FRIDOVICH, SHEILA CONSTANCE TR
345 THAMES ST # N308
BRISTOL, RI 02809



www.cai-tech.com

Data shown on this report is provided for planning and informational purposes only. The municipality and CAI Technologies are not responsible for any use for other purposes or misuse or misrepresentation of this report.



200 foot Abutters List Report

Bristol, RI
January 11, 2024

Parcel Number: 9-24
CAMA Number: 9-24-029
Property Address: 345 THAMES ST 309N

Mailing Address: RIPP, PETER & MARI TRUSTEES
345 THAMES ST UNIT N309
BRISTOL, RI 02809

Parcel Number: 9-24
CAMA Number: 9-24-030
Property Address: 345 THAMES ST 310N

Mailing Address: BUSCH, ROBERT S. (1/2) TRUSTEE &
BUSCH, KATHLEEN B. (1/2) TRUSTEE
52 BENTWOOD COURT EAST
ALBANY, NY 12203

Parcel Number: 9-24
CAMA Number: 9-24-031
Property Address: 345 THAMES ST 401N

Mailing Address: LOUISE I. PLACIDO IRREVOCABLE
TRUST KAUFMAN, BRETT A. TRUSTEE
345 THAMES ST, Unit 401N
BRISTOL, RI 02809

Parcel Number: 9-24
CAMA Number: 9-24-032
Property Address: 345 THAMES ST 402N

Mailing Address: PINK, LOIS & ANDREW TRUSTEES
345 THAMES ST UNIT402N
BRISTOL, RI 02809

Parcel Number: 9-24
CAMA Number: 9-24-033
Property Address: 345 THAMES ST 403N

Mailing Address: BOLTON, ALICE C & FOREST E TE
345 THAMES ST UNIT 403N
BRISTOL, RI 02809

Parcel Number: 9-24
CAMA Number: 9-24-034
Property Address: 345 THAMES ST 404N

Mailing Address: VAN DEVENTER, MARY P. & BRENNAN,
KIMBERLY C. TRUSTEES
345 THAMES ST, UNIT 404N
BRISTOL, RI 02809

Parcel Number: 9-24
CAMA Number: 9-24-035
Property Address: 345 THAMES ST 405N

Mailing Address: FLORIO, IRENE M TRUSTEE IRENE M
FLORIO TRUST
345 THAMES ST UNIT 405N
BRISTOL, RI 02809

Parcel Number: 9-24
CAMA Number: 9-24-036
Property Address: 345 THAMES ST 406N

Mailing Address: JACKSON, LISA R
345 THAMES ST, UNIT N-406
BRISTOL, RI 02809

Parcel Number: 9-24
CAMA Number: 9-24-037
Property Address: 345 THAMES ST 407N

Mailing Address: RHODE, GRANT F & KATZ, JUDITH
TRUSTEES
345 THAMES ST UNT 407N
BRISTOL, RI 02809

Parcel Number: 9-24
CAMA Number: 9-24-038
Property Address: 345 THAMES ST 408N

Mailing Address: ROWE, ABIGAIL CAMPBELL & DAY,
SARAH CAMPBELL TRUSTEES
215 COTTONTAIL DRIVE
PORTSMOUTH, RI 02871

Parcel Number: 9-24
CAMA Number: 9-24-039
Property Address: 345 THAMES ST 409N

Mailing Address: MARTIN, WILLIAM R & JOAN P
TRUSTEES
345 THAMES ST UNIT 409N
BRISTOL, RI 02809

Parcel Number: 9-24
CAMA Number: 9-24-040
Property Address: 345 THAMES ST 410N

Mailing Address: CASTRIOTTA, LAURA J - TRUSTEE
LAURA J CASTRIOTTA TRUST
345 THAMES ST, UNIT N410
BRISTOL, RI 02809



www.cai-tech.com



200 foot Abutters List Report

Bristol, RI
January 11, 2024

Parcel Number: 9-24
CAMA Number: 9-24-041
Property Address: 345 THAMES ST 501N

Mailing Address: DAVIDSON, ASIA MARIA
345 THAMES ST, UNIT 501N
BRISTOL, RI 02809

Parcel Number: 9-24
CAMA Number: 9-24-042
Property Address: 345 THAMES ST 502N

Mailing Address: DUNN, JOHN G. JR TRUSTEE
345 THAMES ST UNIT N502
BRISTOL, RI 02809

Parcel Number: 9-24
CAMA Number: 9-24-043
Property Address: 345 THAMES ST 503N

Mailing Address: WANG, YINGFEI
59 CRESTVIEW RD
MILTON, MA 02186

Parcel Number: 9-24
CAMA Number: 9-24-044
Property Address: 345 THAMES ST 504N

Mailing Address: SUGARMAN, LOUIS TRST ETAL JT
MARAGHY, PAUL
345 THAMES ST UNIT 504N
BRISTOL, RI 02809

Parcel Number: 9-24
CAMA Number: 9-24-045
Property Address: 345 THAMES ST 505N

Mailing Address: CHAMPAGNE, MICHEALA J.
345 THAMES ST UNIT 505N
BRISTOL, RI 02809

Parcel Number: 9-24
CAMA Number: 9-24-046
Property Address: 345 THAMES ST 506N

Mailing Address: LUCINI, GREGORY L & PATRICIA A TE
345 THAMES ST UNIT 506N
BRISTOL, RI 02809

Parcel Number: 9-24
CAMA Number: 9-24-047
Property Address: 343 THAMES ST 101M

Mailing Address: SPANG, HENRY A IV & LINDA TE
343 THAMES ST UNIT M-101
BRISTOL, RI 02809

Parcel Number: 9-24
CAMA Number: 9-24-048
Property Address: 343 THAMES ST 102M

Mailing Address: HICKEY, MICHAEL J. & KATHLEEN O.
TRUSTEES
74 CARNEGIE HEIGHTS DR
PORTSMOUTH, RI 02871

Parcel Number: 9-24
CAMA Number: 9-24-049
Property Address: 343 THAMES ST 103M

Mailing Address: RATFORD, VINCENT MARGUERITE TE
343 THAMES ST UNIT 103M
BRISTOL, RI 02809

Parcel Number: 9-24
CAMA Number: 9-24-050
Property Address: 343 THAMES ST 104M

Mailing Address: ISRAEL, SCOTT & JAFFE, ALICE TE
88 ABBOT ST
ANDOVER, MA 01810

Parcel Number: 9-24
CAMA Number: 9-24-051
Property Address: 343 THAMES ST 301M

Mailing Address: CIVALE, CHRISTOPHER J & BELLAMY,
KARA E TRUSTEES
343 THAMES ST # M 301
BRISTOL, RI 02809

Parcel Number: 9-24
CAMA Number: 9-24-052
Property Address: 343 THAMES ST 302M

Mailing Address: FETTER, JANET M TRUSTEE JANET M
FETTER TRUST
343 THAMES ST 302M
BRISTOL, RI 02809



www.cai-tech.com

Data shown on this report is provided for planning and informational purposes only. The municipality and CAI Technologies are not responsible for any use for other purposes or misuse or misrepresentation of this report.

1/11/2024

Page 8 of 15



200 foot Abutters List Report

Bristol, RI
January 11, 2024

Parcel Number: 9-24
CAMA Number: 9-24-053
Property Address: 343 THAMES ST 303M

Mailing Address: GOODNOW, CHRISTOPHER & ANDREA
TE
343 THAMES ST, UNIT M-303
BRISTOL, RI 02809

Parcel Number: 9-24
CAMA Number: 9-24-054
Property Address: 343 THAMES ST 304M

Mailing Address: NASTRO, KIMBERLY & DAVID TE
29 WEST 85th ST, APT 3
NEW YORK, NY 10024

Parcel Number: 9-24
CAMA Number: 9-24-055
Property Address: 341 THAMES ST 101S

Mailing Address: KITS VAN HEYNINGEN, ROBERT W.
DEBRA A TE
18 FESSER AVE
BRISTOL, RI 02809

Parcel Number: 9-24
CAMA Number: 9-24-056
Property Address: 341 THAMES ST 102S

Mailing Address: JON JACQUELINE JORDAN RP TRUST
6924 HICKORY HILL AVE
MCLEAN, VA 22101

Parcel Number: 9-24
CAMA Number: 9-24-057
Property Address: 341 THAMES ST 103S

Mailing Address: JACKSON, DEBRA P
174 PINE GLEN DR
EAST GREENWICH, RI 02818

Parcel Number: 9-24
CAMA Number: 9-24-058
Property Address: 341 THAMES ST 104S

Mailing Address: LUDLOW, LYNN LEE & LAWRENCE,
JAMES S ESQ TRUSTEES-ABRAMSON &
LUDLOW TRUST
341 THAMES ST, UNIT 104S
BRISTOL, RI 02809

Parcel Number: 9-24
CAMA Number: 9-24-059
Property Address: 341 THAMES ST 105S

Mailing Address: FALTEN, PAUL J. & CAROL MILLIAN TE
341 THAME ST, Unit 105S
BRISTOL, RI 02809

Parcel Number: 9-24
CAMA Number: 9-24-060
Property Address: 341 THAMES ST 106S

Mailing Address: LEIBOWITZ, DAVID E & PEGGY A TE
341 THAMES ST UNIT 106S
BRISTOL, RI 02809

Parcel Number: 9-24
CAMA Number: 9-24-061
Property Address: 341 THAMES ST 107S

Mailing Address: BERKELEY, DUNCAN & AMY TE
67 CENTRAL ST
GEORGETOWN, MA 01833

Parcel Number: 9-24
CAMA Number: 9-24-062
Property Address: 341 THAMES ST 108S

Mailing Address: TETU, NORMAND P GINNY L. TE
190 BICENTENNIAL DR
HOOKSETT, NH 03106

Parcel Number: 9-24
CAMA Number: 9-24-063
Property Address: 341 THAMES ST 109S

Mailing Address: SAWYER, MICHAEL
341 THAMES ST, UNIT 109S
BRISTOL, RI 02809

Parcel Number: 9-24
CAMA Number: 9-24-064
Property Address: 341 THAMES ST 110S

Mailing Address: LEENUTAPHONG, DEBORAH LYNN &
NARUEKORN TRUSTEES
341 THAMES ST UNIT S110
BRISTOL, RI 02809



www.cai-tech.com

Data shown on this report is provided for planning and informational purposes only. The municipality and CAI Technologies are not responsible for any use for other purposes or misuse or misrepresentation of this report.

1/11/2024

Page 9 of 15



200 foot Abutters List Report

Bristol, RI
January 11, 2024

Parcel Number: 9-24
CAMA Number: 9-24-065
Property Address: 341 THAMES ST 201S

Mailing Address: LAPOINTE, WILLIAM H. & LAPOINTE,
DONNE M. TRUSTEES
3756 JUNGLE PLUM DR E
NAPLES, FL 34114

Parcel Number: 9-24
CAMA Number: 9-24-066
Property Address: 341 THAMES ST 202S

Mailing Address: BOUCHARD, KENNETH & RIKKI HANSEN
- TRUSTEES KENNETH P & RIKKI
HANSEN BOUCHARD TRUSTS
25 RELIANCE DR
BRISTOL, RI 02809

Parcel Number: 9-24
CAMA Number: 9-24-067
Property Address: 341 THAMES ST 203S

Mailing Address: OZTERMIYECI, MUSTAFA MURAT &
MATOOK, DEBORAH JOY TE
341 THAMES ST UNIT S203
BRISTOL, RI 02809

Parcel Number: 9-24
CAMA Number: 9-24-068
Property Address: 341 THAMES ST 204S

Mailing Address: CAMOSCI, ROBERT E & GAIL D TE
341 THAMES ST UNIT 204S
BRISTOL, RI 02809

Parcel Number: 9-24
CAMA Number: 9-24-069
Property Address: 341 THAMES ST 205S

Mailing Address: KAWAOKA, ERIC J & ESTA TRUSTEES
FAMILY TRUST
341 THAMES ST 205S
BRISTOL, RI 02809

Parcel Number: 9-24
CAMA Number: 9-24-070
Property Address: 341 THAMES ST 206S

Mailing Address: BRAVE, ILENE E & DENNIS G -
TRUSTEES ILENE E BRAVE TRUST
PO BOX 906
BROOKLANDVILLE, MD 21022

Parcel Number: 9-24
CAMA Number: 9-24-071
Property Address: 341 THAMES ST 207S

Mailing Address: PETERSON, JEFFREY
519 GREGORY AVE
WILMETTE, IL 60091

Parcel Number: 9-24
CAMA Number: 9-24-072
Property Address: 341 THAMES ST 208S

Mailing Address: GARRITY, JOHN
341 THAMES ST, UNIT 208S
BRISTOL, RI 02809

Parcel Number: 9-24
CAMA Number: 9-24-073
Property Address: 341 THAMES ST 209S

Mailing Address: FAY, PAUL D & CURTIS, JULIE M TE
1443 BEACON ST
BROOKLINE, MA 02446

Parcel Number: 9-24
CAMA Number: 9-24-074
Property Address: 341 THAMES ST 210S

Mailing Address: GRAY, ROBERT C & PATRICIA A
TRUSTEES
341 THAMES ST 210S
BRISTOL, RI 02809

Parcel Number: 9-24
CAMA Number: 9-24-075
Property Address: 341 THAMES ST 301S

Mailing Address: BRUNING, KARLA GANTZ, KATHLEEN
341 THAMES ST 301S
BRISTOL, RI 02809

Parcel Number: 9-24
CAMA Number: 9-24-076
Property Address: 341 THAMES ST 302S

Mailing Address: MORSE, ANN R. TRUSTEE ANN R.
MORSE 1993 TRUST
341 THAMES ST 302 S
BRISTOL, RI 02809



www.cai-tech.com

Data shown on this report is provided for planning and informational purposes only. The municipality and CAI Technologies are not responsible for any use for other purposes or misuse or misrepresentation of this report.

1/11/2024

Page 10 of 15



200 foot Abutters List Report

Bristol, RI
January 11, 2024

Parcel Number: 9-24
CAMA Number: 9-24-077
Property Address: 341 THAMES ST 303S

Mailing Address: MUSKET, DAVID B.
1655 BAY HARBOR LN
SARASOTA, FL 34231

Parcel Number: 9-24
CAMA Number: 9-24-079
Property Address: 341 THAMES ST 305S

Mailing Address: REIG, VIBEKE G TRUSTEE VIBEKE
REIG LIVING TRUST
341 THAMES ST UNIT S305
BRISTOL, RI 02809

Parcel Number: 9-24
CAMA Number: 9-24-080
Property Address: 341 THAMES ST 306S

Mailing Address: LYNCH, JOHN J TRUSTEE
341 THAMES ST UNIT S306
BRISTOL, RI 02809

Parcel Number: 9-24
CAMA Number: 9-24-081
Property Address: 341 THAMES ST 307S

Mailing Address: DEMARCO, GREGORY M. & AMY
TRUSTEES
341 THAMES ST S-307
BRISTOL, RI 02809

Parcel Number: 9-24
CAMA Number: 9-24-082
Property Address: 341 THAMES ST 308S

Mailing Address: WILKER, RICHARD E & WILKER,
PHYLLIS BLOOM TRUSTEES
341 THAMES ST UNIT S-308
BRISTOL, RI 02809

Parcel Number: 9-24
CAMA Number: 9-24-083
Property Address: 341 THAMES ST 309S

Mailing Address: KUBLIN, DONNA E & STANLEY B TR
341 THAMES ST UNIT 309S
BRISTOL, RI 02809

Parcel Number: 9-24
CAMA Number: 9-24-101
Property Address: THAMES ST

Mailing Address: STONE HARBOUR MARINA, LLC C/O
WILLIAM MARTIN
691 15TH AVE SOUTH
NAPLES, FL 34102-7424

Parcel Number: 9-24
CAMA Number: 9-24-102
Property Address: THAMES ST

Mailing Address: STONE HARBOUR MARINA, LLC C/O
JOHNSON, PETER & ANDREA
345 THAMES ST UNIT N101
BRISTOL, RI 02809

Parcel Number: 9-24
CAMA Number: 9-24-103
Property Address: THAMES ST

Mailing Address: STONE HARBOUR MARINA, LLC.
CHAMPAGNE, KEVIN & MICHAELA
4525 S. ATLANTIC AVE
PORT ORANGE, FL 32177-7061

Parcel Number: 9-24
CAMA Number: 9-24-104
Property Address: THAMES ST

Mailing Address: STONE HARBOUR MARINA, LLC.
NASTRO, DAVID & KIM
343 THAMES ST M304
BRISTOL, RI 02809

Parcel Number: 9-24
CAMA Number: 9-24-105
Property Address: THAMES ST

Mailing Address: STONE HARBOUR MARINA, LLC C/O
MUSKET, DAVID B.
1655 BAY HARBOR LN
SARASOTA, FL 34231

Parcel Number: 9-24
CAMA Number: 9-24-106
Property Address: THAMES ST

Mailing Address: STONE HARBOUR MARINA, LLC.
OZTERMIYECI, MUSTAFA M
341 THAMES ST S203
BRISTOL, RI 02809



www.cai-tech.com

Data shown on this report is provided for planning and informational purposes only. The municipality and CAI Technologies are not responsible for any use for other purposes or misuse or misrepresentation of this report.



200 foot Abutters List Report

Bristol, RI
January 11, 2024

Parcel Number: 9-24
CAMA Number: 9-24-107
Property Address: THAMES ST

Mailing Address: STONE HARBOUR MARINA, LLC C/O
VIBEKE REIG LIV TRUST
341 THAMES ST S305
BRISTOL, RI 02809

Parcel Number: 9-24
CAMA Number: 9-24-108
Property Address: THAMES ST

Mailing Address: STONE HARBOUR MARINA, LLC RIPP,
PETER & MARI
345 THAMES ST N309
BRISTOL, RI 02809

Parcel Number: 9-24
CAMA Number: 9-24-109
Property Address: THAMES ST

Mailing Address: STONE HARBOUR MARINA, LLC C/O
GREG LUNCINI
345 THAMES ST, Unit N506
BRISTOL, RI 02809-4116

Parcel Number: 9-24
CAMA Number: 9-24-110
Property Address: THAMES ST

Mailing Address: STONE HARBOUR MARINA, LLC C/O
MARIO BARRENECHEA
345 THAMES ST, Unit N104
BRISTOL, RI 02809

Parcel Number: 9-24
CAMA Number: 9-24-111
Property Address: THAMES ST

Mailing Address: STONE HARBOUR MARINA, LLC C/O
ROBERT & PATRICIA GRAY
341 THAMES ST UNT S210
BRISTOL, RI 02809-2407

Parcel Number: 9-24
CAMA Number: 9-24-112
Property Address: THAMES ST

Mailing Address: STONE HARBOUR MARINA, LLC C/O
JOHN G DUNN
345 THAMES ST N502
BRISTOL, RI 02809

Parcel Number: 9-24
CAMA Number: 9-24-113
Property Address: THAMES ST

Mailing Address: STONE HARBOUR MARINA LLC C/O
KUBLIN, DONNA & STAN
341 THAMES ST 309S
BRISTOL, RI 02809

Parcel Number: 9-24
CAMA Number: 9-24-114
Property Address: THAMES ST

Mailing Address: STONE HARBOUR MARINA, LLC C/O
ROBERT B HANKIN TRUST
56 RAMBLING DR
SCOTCH PLAINS, NJ 07076

Parcel Number: 9-24
CAMA Number: 9-24-115
Property Address: THAMES ST

Mailing Address: STONE HARBOUR MARINA, LLC C/O
CAPODILUPO, PETER & JENNIFER
345 THAMES ST UNIT 207
BRISTOL, 02809

Parcel Number: 9-24
CAMA Number: 9-24-116
Property Address: THAMES ST

Mailing Address: STONE HARBOUR MARINA, LLC JAMES
& RANDELLE HURST
345 THAMES ST UNIT 109N
BRISTOL, RI 02809

Parcel Number: 9-24
CAMA Number: 9-24-117
Property Address: THAMES ST

Mailing Address: STONE HARBOUR MARINA, LLC
TRUSTEES OF THE HURST FAMILY
345 THAMES ST 109N
BRISTOL, RI 02809

Parcel Number: 9-24
CAMA Number: 9-24-118
Property Address: THAMES ST

Mailing Address: STONE HARBOUR MARINA, LLC.
MICHAEL & DENISE O'BRIEN
345 THAMES ST 206N
BRISTOL, RI 02809



www.cai-tech.com

Data shown on this report is provided for planning and informational purposes only. The municipality and CAI Technologies are not responsible for any use for other purposes or misuse or misrepresentation of this report.



200 foot Abutters List Report

Bristol, RI
January 11, 2024

Parcel Number: 9-24
CAMA Number: 9-24-119
Property Address: THAMES ST

Mailing Address: STONE HARBOUR MARINA, LLC
HERBERT & JANET SARKISIAN
345 THAMES ST N209
BRISTOL, RI 02809

Parcel Number: 9-24
CAMA Number: 9-24-120
Property Address: THAMES ST

Mailing Address: STONE HARBOUR MARINA, LLC C/O
WILLIAM & DONNA LAPOINTE
TRUSTEES
341 THAMES ST S201
BRISTOL, RI 02809

Parcel Number: 9-24
CAMA Number: 9-24-121
Property Address: THAMES ST

Mailing Address: STONE HARBOUR MARINA, LLC. GINNY
& NORMAND TETU
190 BICENTENNIAL DR
HOOKSETT, NH 03106-2702

Parcel Number: 9-24
CAMA Number: 9-24-122
Property Address: THAMES ST

Mailing Address: STONE HARBOUR MARINA, LLC. C/O
ABRAMSON, SUSAN & EDWARD
341 THAMES ST UNT 104S
BRISTOL, RI 02809

Parcel Number: 9-24
CAMA Number: 9-24-123
Property Address: THAMES ST

Mailing Address: STONE HARBOUR MARINA, LLC. C/O
BUSCH, ROBERT & KATHLEEN
52 BENTWOOD CT
ALBANY, NY 12203-4810

Parcel Number: 9-24
CAMA Number: 9-24-124
Property Address: THAMES ST

Mailing Address: STONE HARBOUR MARINA, LLC. C/O
MATTHEW BERNARDO
345 THAMES ST, Unit 204N
BRISTOL, RI 02809

Parcel Number: 9-24
CAMA Number: 9-24-125
Property Address: THAMES ST

Mailing Address: STONE HARBOUR MARINA, LLC BUSCH,
ROBERT & KATHY
52 BENTWOOD CT
ALBANY, NY 12203

Parcel Number: 9-24
CAMA Number: 9-24-126
Property Address: THAMES ST

Mailing Address: STONE HARBOUR MARINA, LLC. C/O
NEIL & CHRISTINE FEINS
19 MARSHAL ST
BROOKLINE, MA 02446-5418

Parcel Number: 9-24
CAMA Number: 9-24-127
Property Address: THAMES ST

Mailing Address: STONE HARBOUR MARINA, LLC. C/O
BRAVE, ILENE E. & DENNIS G.
TRUSTEES
341 THAMES ST S206
BRISTOL, RI 02809

Parcel Number: 9-24
CAMA Number: 9-24-128
Property Address: THAMES ST

Mailing Address: STONE HARBOUR MARINA, LLC. LI, HSI-
CHENG
345 THAMES ST UNT 306 N
BRISTOL, RI 02809

Parcel Number: 9-24
CAMA Number: 9-24-129
Property Address: THAMES ST

Mailing Address: STONE HARBOUR MARINA, LLC. LI, HSI-
CHENG
345 THAMES ST UNIT 306N
BRISTOL, RI 02809-9195



www.cai-tech.com

Data shown on this report is provided for planning and informational purposes only. The municipality and CAI Technologies are not responsible for any use for other purposes or misuse or misrepresentation of this report.



200 foot Abutters List Report

Bristol, RI
January 11, 2024

Parcel Number: 9-24 CAMA Number: 9-24-130 Property Address: THAMES ST	Mailing Address: STONE HARBOUR MARINA, LLC C/O SHERMAN, MAX CHRISTOPHER & MARY B. 341 THAMES ST UNIT 205S BRISTOL, RI 02809
Parcel Number: 9-24 CAMA Number: 9-24-131 Property Address: THAMES ST	Mailing Address: STONE HARBOUR MARINA, LLC. JANET M FETTER REVOCABLE TRUST 1998 343 THAMES ST UNIT M302 BRISTOL, RI 02809
Parcel Number: 9-24 CAMA Number: 9-24-132 Property Address: THAMES ST	Mailing Address: STONE HARBOUR MARINA, LLC C/O MICHAEL & DENISE O'BRIEN 345 THAMES ST 206N BRISTOL, RI 02809
Parcel Number: 9-24 CAMA Number: 9-24-133 Property Address: THAMES ST	Mailing Address: STONE HARBOUR MARINA, LLC C/O JOHN S & KIMBERLY PHILLIPS 265 TWIN LAKES DR GETTYSBURG, PA 17325-8540
Parcel Number: 9-24 CAMA Number: 9-24-134 Property Address: THAMES ST	Mailing Address: STONE HARBOUR MARINA, LLC C/O GRANT RHODE 345 THAMES ST N407 BRISTOL, RI 02809
Parcel Number: 9-24 CAMA Number: 9-24-135 Property Address: THAMES ST	Mailing Address: STONE HARBOUR MARINA, LLC ARTHUR PLACIDO 345 THAMES ST N401 BRISTOL, RI 02809
Parcel Number: 9-24 CAMA Number: 9-24-136 Property Address: THAMES ST	Mailing Address: STONE HARBOUR MARINA, LLC C/O PAUL MARAGHY 345 THAMES ST, Unit N504 BRISTOL, RI 02809
Parcel Number: 9-24 CAMA Number: 9-24-137 Property Address: THAMES ST	Mailing Address: STONE HARBOUR MARINA SPANG, AUSTIN & LINDA 343 Thames Street Unit M101 Bristol, RI 02809
Parcel Number: 9-24 CAMA Number: 9-24-138 Property Address: THAMES ST	Mailing Address: STONE HARBOUR MARINA, LLC C/O CAMPBELL, MICHAEL 345 THAMES ST, UNIT N408 BRISTOL, RI 02809
Parcel Number: 9-24 CAMA Number: 9-24-139 Property Address: THAMES ST	Mailing Address: STONE HARBOUR MARINA, LLC C/O MARIO BARRENECHEA 345 THAMES ST, Unit N104 BRISTOL, RI 02809
Parcel Number: 9-38 CAMA Number: 9-38 Property Address: THAMES ST	Mailing Address: TSL LLC 244 GANO ST PROVIDENCE, RI 02906
Parcel Number: 9-42 CAMA Number: 9-42 Property Address: 515 HOPE ST	Mailing Address: FEDERAL PROPERTIES OF RI 328 HIGH ST BRISTOL, RI 02809



www.cai-tech.com

Data shown on this report is provided for planning and informational purposes only. The municipality and CAI Technologies are not responsible for any use for other purposes or misuse or misrepresentation of this report.

1/11/2024

Page 14 of 15



200 foot Abutters List Report

Bristol, RI
January 11, 2024

Parcel Number: 9-43
CAMA Number: 9-43
Property Address: 282 THAMES ST
Mailing Address: GARVIN, GAIL & GEORGE E TC
282 THAMES ST
BRISTOL, RI 02809

Parcel Number: 9-46
CAMA Number: 9-46
Property Address: HOPE ST
Mailing Address: FEDERAL PROPERTIES OF RI
328 HIGH ST
BRISTOL, RI 02809

Parcel Number: 9-48
CAMA Number: 9-48
Property Address: THAMES ST
Mailing Address: FEDERAL PROPERTIES OF RI
328 HIGH ST
BRISTOL, RI 02809

Parcel Number: 9-49
CAMA Number: 9-49
Property Address: 260 THAMES ST
Mailing Address: DANMOR REALTY, LLC
13 BAY RD
WARREN, RI 02885

Parcel Number: 9-50
CAMA Number: 9-50
Property Address: 267 THAMES ST
Mailing Address: TSL LLC
244 GANO ST
PROVIDENCE, RI 02906

Parcel Number: 9-60
CAMA Number: 9-60
Property Address: 29-31 STATE ST
Mailing Address: DANMOR REALTY, LLC
13 BAY RD
WARREN, RI 02885

Parcel Number: 9-61
CAMA Number: 9-61
Property Address: 17 STATE ST
Mailing Address: FEDERAL PROPERTIES OF RI INC.
PO BOX 27
BRISTOL, RI 02809

Parcel Number: 9-62
CAMA Number: 9-62
Property Address: 11 STATE ST
Mailing Address: 11 STATE STREET, LLC
116 PECK AVE
BRISTOL, RI 02809

Parcel Number: 9-63
CAMA Number: 9-63
Property Address: THAMES ST
Mailing Address: TOWN OF BRISTOL
10 COURT ST
BRISTOL, RI 02809

Parcel Number: 9-64
CAMA Number: 9-64
Property Address: THAMES ST
Mailing Address: TOWN OF BRISTOL
10 COURT ST
BRISTOL, RI 02809

Parcel Number: 9-65
CAMA Number: 9-65
Property Address: 1 STATE ST
Mailing Address: STATE PROPERTIES LLC
1 STATE ST
BRISTOL, RI 02809

Parcel Number: 9-74
CAMA Number: 9-74
Property Address: 246 THAMES ST
Mailing Address: RIVERS, ZACHARY N
PO Box 964
Bristol, RI 02809



www.cai-tech.com

Data shown on this report is provided for planning and informational purposes only. The municipality and CAI Technologies are not responsible for any use for other purposes or misuse or misrepresentation of this report.

11 STATE STREET, LLC
116 PECK AVE
BRISTOL, RI 02809

BRAVE, ILENE E & DENNIS G
ILENE E BRAVE TRUST
PO BOX 906
BROOKLANDVILLE, MD 21022

CIVALE, CHRISTOPHER J &
BELLAMY, KARA E TRUSTEES
343 THAMES ST # M 301
BRISTOL, RI 02809

423 HOPE ST REDEVELOPMENT
C/O ACROPOLIS PROPERTY
MANAGEMENT
423 HOPE ST
BRISTOL, RI 02809

BRUNING, KARLA
GANTZ, KATHLEEN
341 THAMES ST 301S
BRISTOL, RI 02809

CLARK, ALLEN M. &
CLARK, WHITNEY O. TRUSTEE
423 HOE ST, UNIT G
BRISTOL, RI 02809

BALZANO, JOHN G &
CHRISTINE R TE
82 NEWPORT RD
HULL, MA 02045

BUNN, JAMES BENNING SR &
BUNN, JACQUELINE BRYAN TE
141A Main St
Tuckahoe, NY 10707

COLOMBO, BRITT C &
MARY L JT
227 THAMES ST
BRISTOL, RI 02809

BARRENECHEA, MARIO I. & A
345 THAMES ST UNIT N104
BRISTOL, RI 02809

BUSCH, ROBERT S. (1/2) TR
BUSCH, KATHLEEN B. (1/2)
52 BENTWOOD COURT EAST
ALBANY, NY 12203

DANMOR REALTY, LLC
13 BAY RD
WARREN, RI 02885

BERKELEY, DUNCAN & AMY T
67 CENTRAL ST
GEORGETOWN, MA 01833

CAMOSCI, ROBERT E &
GAIL D TE
341 THAMES ST UNIT 204S
BRISTOL, RI 02809

DAVIDSON, ASIA MARIA
345 THAMES ST, UNIT 501N
BRISTOL, RI 02809

BERNARDO, MATTHEW P
345 THAMES ST, UNIT 204N
BRISTOL, RI 02809

CAPODILUPO, PETER & JENNI
345 Thames St Unit 207
Bristol, RI 02809

DEMARCO, GREGORY M. &
AMY TRUSTEES
341 THAMES ST S-307
BRISTOL, RI 02809

BOLTON, ALICE C & FOREST
345 THAMES ST UNIT 403N
BRISTOL, RI 02809

CARTWRIGHT, CORINNE M & P
227 THAMES ST., UNIT 1
BRISTOL, RI 02809

DEMARCO, MICHAEL D.
ELIZABETH M. TE
345 THAMES ST
UNIT 106N
BRISTOL, RI 02809

BOUCHARD, KENNETH & RIKKI
KENNETH P & RIKKI HANSEN
25 RELIANCE DR
BRISTOL, RI 02809

CASTRIOTTA, LAURA J - TRU
LAURA J CASTRIOTTA TRUST
345 THAMES ST, UNIT N410
BRISTOL, RI 02809

DUNN, JOHN G. JR TRUSTEE
345 THAMES ST UNIT N502
BRISTOL, RI 02809

BOWMAN, GREGORY W
423 HOPE ST, UNIT P
BRISTOL, RI 02809

CHAMPAGNE, MICHEALA J.
345 THAMES ST UNIT 505N
BRISTOL, RI 02809

EIGHTEEN TWENTY, LLC
52 TALCOTT ST
BARRINGTON, RI 02806

BOZARTH, PETER
235 THAMES ST
BRISTOL, RI 02809

CHRISTOPHER, JANET E TRUS
CHRISTOPHER FAMILY TRUST
345 THAMES ST #108
BRISTOL, RI 02809

FALTEN, PAUL J. &
CAROL MILLIAN TE
341 THAME ST, Unit 105S
BRISTOL, RI 02809

FAY, PAUL D &
CURTIS, JULIE M TE
1443 BEACON ST
BROOKLINE, MA 02446

GARVIN, GAIL &
GEORGE E TC
282 THAMES ST
BRISTOL, RI 02809

JACKSON, LISA R
345 THAMES ST, UNIT N-406
BRISTOL, RI 02809

FEDERAL PROPERTIES OF RI
328 HIGH ST
BRISTOL, RI 02809

GOODNOW, CHRISTOPHER & AN
343 THAMES ST, UNIT M-303
BRISTOL, RI 02809

JOHNSON, PETER T & ANDREA
345 THAMES ST UNIT N101
BRISTOL, RI 02809

FEDERAL PROPERTIES OF RI
PO BOX 27
BRISTOL, RI 02809

GRAY, ROBERT C & PATRICIA
341 THAMES ST 210S
BRISTOL, RI 02809

JON
JACQUELINE JORDAN RP TRUS
6924 HICKORY HILL AVE
MCLEAN, VA 22101

FEINS, NEIL R &
CHRISTINE TRUSTEES
19 MARSHAL ST
BROOKLINE, MA 02446

HANKIN, ROBERT B & CHERYL
ROBERT B & CHERYL B HANKI
56 RAMBLING DR
SCOTCH PLAINS, NJ 07076-2955

KAWAOKA, ERIC J & ESTA TR
341 THAMES ST 205S
BRISTOL, RI 02809

FETTER, JANET M TRUSTEE
JANET M FETTER TRUST
343 THAMES ST 302M
BRISTOL, RI 02809

HAYES, MATTHEW D TRUSTEE
MATTHEW D HAYES REV TRUST
423 HOPE ST UNIT B
BRISTOL, RI 02809

KITS VAN HEYNINGEN, ROBER
DEBRA A TE
18 FESSER AVE
BRISTOL, RI 02809

FITZPATRICK, CAROL A., TR
CAROL A FITZPATRICK REVOC
345 THAMES ST, UNIT 208N
BRISTOL, RI 02809

HICKEY, MICHAEL J. &
KATHLEEN O. TRUSTEES
74 CARNEGIE HEIGHTS DR
PORTSMOUTH, RI 02871

KUBLIN, DONNA E & STANLEY
341 THAMES ST UNIT 309S
BRISTOL, RI 02809

FIXSEN, WILLIAM
25 MARCONI DR
RANDOLPH, MA 02368

HOLLAND, JOYCE A.
345 THAMES ST UNIT 110N
BRISTOL, RI 02809

KUFFNER, TAMARA
9 WALNUT RD
BARRINGTON, RI 02806

FLORIO, IRENE M TRUSTEE
IRENE M FLORIO TRUST
345 THAMES ST UNIT 405N
BRISTOL, RI 02809

HURST, JAMES WILLIAM & RA
HURST FAMILY 2012 TRUST
345 THAMES ST, Unit N109
BRISTOL, RI 02809

LAPOINTE, WILLIAM H. &
LAPOINTE, DONNE M. TRUSTE
3756 JUNGLE PLUM DR E
NAPLES, FL 34114

FRIDOVICH, SHEILA CONSTAN
345 THAMES ST # N308
BRISTOL, RI 02809

ISRAEL, SCOTT & JAFFE, AL
88 ABBOT ST
ANDOVER, MA 01810

LEENUTAPHONG, DEBORAH LYN
NARUEKORN TRUSTEES
341 THAMES ST UNIT S110
BRISTOL, RI 02809

GARRITY, JOHN
341 THAMES ST, UNIT 208S
BRISTOL, RI 02809

JACKSON, DEBRA P
174 PINE GLEN DR
EAST GREENWICH, RI 02818

LEIBOWITZ, DAVID E &
PEGGY A TE
341 THAMES ST UNIT 106S
BRISTOL, RI 02809

LI, HSI-CHENG TRUSTEE
345 THAMES ST
UNIT N306
BRISTOL, RI 02809

MCRAE, BEVERLY SMITH & JO
17 JOHN ST, UNIT 2
BRISTOL, RI 02809

OZTERMIYECI, MUSTAFA M.
341 THAMES ST UNIT 203
BRISTOL, RI 02809

LOUISE I. PLACIDO IRREVOC
KAUFMAN, BRETT A. TRUSTEE
345 THAMES ST, Unit 401N
BRISTOL, RI 02809

MCSTAY, JAMES P.
CHERYL A. ETUX TE
345 THAMES ST UNIT 205N
BRISTOL, RI 02809

OZTERMIYECI, MUSTAFA MURA
MATOOK, DEBORAH JOY TE
341 THAMES ST UNIT S203
BRISTOL, RI 02809

LUCINI, GREGORY L &
PATRICIA A TE
345 THAMES ST UNIT 506N
BRISTOL, RI 02809

MORSE, ANN R. TRUSTEE
ANN R. MORSE 1993 TRUST
341 THAMES ST 302 S
BRISTOL, RI 02809

PAGE, ROBERT W & MYRA M,
PAGE FAMILY TRUST
423 HOPE ST, Unit K
BRISTOL, RI 02809

LUDLOW, LYNN LEE & LAWREN
TRUSTEES-ABRAMSON & LUDLO
341 THAMES ST, UNIT 104S
BRISTOL, RI 02809

MUSKET, DAVID B.
1655 BAY HARBOR LN
SARASOTA, FL 34231

PETERSON, JEFFREY
519 GREGORY AVE
WILMETTE, IL 60091

LYNCH, JOHN J TRUSTEE
341 THAMES ST UNIT S306
BRISTOL, RI 02809

NASTRO, KIMBERLY & DAVID
29 WEST 85th ST, APT 3
NEW YORK, NY 10024

PHILLIPS, JOHN S & KIMBER
345 THAMES ST 304N
BRISTOL, RI 02809

MACDONALD, JAMES C
423 HOPE ST, UNIT H
BRISTOL, RI 02809

NAT PROPERTIES, LLC
26 PATRICIA ANN DR
BRISTOL, RI 02809

PINK, LOIS &
ANDREW TRUSTEES
345 THAMES ST UNIT402N
BRISTOL, RI 02809

MARTIN, WILLIAM R &
JOAN P TRUSTEES
345 THAMES ST UNIT 409N
BRISTOL, RI 02809

NEW LEAF REALTY, LLC
COMMERCIAL UNITS 1 & 2
18-20 STATE ST
BRISTOL, RI 02809

POLLOCK, JORDAN
15 JOHN ST, UNIT 1
BRISTOL, RI 02809

MATRONE, SANTA W JR TRUST
SANTA W MATRONE JR DEC TR
423 HOPE ST UNIT L-12
BRISTOL, RI 02809

NICHOLSON, TODD &
423 HOPE ST UNIT 6F
BRISTOL, RI 02809

RATFORD, VINCENT
MARGUERITE TE
343 THAMES ST UNIT 103M
BRISTOL, RI 02809

MATTHEWS, CHARLES C.
TARA W. TE
223 OAKLAND BEACH AVE
RYE, NY 10580

OBRIEN, MICHAEL T.
DENISE E. TE
345 THAMES ST UNIT 206N
BRISTOL, RI 02809

REIG, VIBEKE G TRUSTEE
VIBEKE REIG LIVING TRUST
341 THAMES ST UNIT S305
BRISTOL, RI 02809

MCKAY, SUSAN ANDON, TRUST
SUSAN ANDON MCKAY LIVING
186 OAKLAND ST
WELLESLEY, MA 02481

OQUENDO, VIVIAN Y
227 THAMES ST, UNIT 2
BRISTOL, RI 02809

RHODE, GRANT F & KATZ, JU
345 THAMES ST UNT 407N
BRISTOL, RI 02809

RIPP, PETER & MARI TRUSTE
345 THAMES ST UNIT N309
BRISTOL, RI 02809

SHAMS, NICOLE
345 THAMES ST., UNIT N-303
BRISTOL, RI 02809

STONE HARBOUR MARINA, LLC
C/O CAMPBELL, MICHAEL
345 THAMES ST, UNIT N408
BRISTOL, RI 02809

RIVERS, ZACHARY N
PO Box 964
Bristol, RI 02809

SHAPIRO, DEBORA WEST
423 HOPE ST, Unit UNIT 14N
BRISTOL, RI 02809

STONE HARBOUR MARINA, LLC
C/O CAPODILUPO, PETER & J
345 THAMES ST UNIT 207
BRISTOL, 02809

ROSS, MICHAEL C &
ASTRID L TRUSTEES
363 ADAMS ST
DENVER, CO 80206

SHERMAN, MAX CHRISTOPHER
746 SPINNAKER BEACHHOUSE
VILLA
SEABROOK ISLAND, SC 29456

STONE HARBOUR MARINA, LLC
C/O GRANT RHODE
345 THAMES ST N407
BRISTOL, RI 02809

ROWE, ABIGAIL CAMPBELL &
DAY, SARAH CAMPBELL TRUST
215 COTTONTAIL DRIVE
PORTSMOUTH, RI 02871

SMITH, DEBORAH ROSE & ALL
423 HOPE ST, UNIT D
BRISTOL, RI 02809

STONE HARBOUR MARINA, LLC
C/O GREG LUNCINI
345 THAMES ST, Unit N506
BRISTOL, RI 02809-4116

SAILOR, LLC
423 HOPE ST, Unit 13M
BRISTOL, RI 02809

SPANG, HENRY A IV &
LINDA TE
343 THAMES ST UNIT M-101
BRISTOL, RI 02809

STONE HARBOUR MARINA, LLC
C/O JOHN G DUNN
345 THAMES ST N502
BRISTOL, RI 02809

SARKISIAN, HERBERT A.
JANET E. TE
345 THAMES ST UNIT N209
BRISTOL, RI 02809

STATE PROPERTIES LLC
1 STATE ST
BRISTOL, RI 02809

STONE HARBOUR MARINA, LLC
C/O JOHN S & KIMBERLY PHI
265 TWIN LAKES DR
GETTYSBURG, PA 17325-8540

SAUL, DEBRA A
345 THAMES ST # 102
BRISTOL, RI 02809

STONE HARBOUR MARINA
SPANG, AUSTIN & LINDA
343 Thames Street Unit M101
Bristol, RI 02809

STONE HARBOUR MARINA, LLC
C/O JOHNSON, PETER & ANDRE
345 THAMES ST UNIT N101
BRISTOL, RI 02809

SAWYER, MICHAEL
341 THAMES ST, UNIT 109S
BRISTOL, RI 02809

STONE HARBOUR MARINA LLC
C/O KUBLIN, DONNA & STAN
341 THAMES ST 309S
BRISTOL, RI 02809

STONE HARBOUR MARINA, LLC
C/O MARIO BARRENECHEA
345 THAMES ST, Unit N104
BRISTOL, RI 02809

SB2, LLC
345 THAMES ST, UNIT N-110
BRISTOL, RI 02809

STONE HARBOUR MARINA, LLC
ARTHUR PLACIDO
345 THAMES ST N401
BRISTOL, RI 02809

STONE HARBOUR MARINA, LLC
C/O MICHAEL & DENISE O'BR
345 THAMES ST 206N
BRISTOL, RI 02809

SCOTT, WENDELL O &
PATRICIA C TE
700 MOUNTAIN AVE
WESTFIELD, NJ 07090

STONE HARBOUR MARINA, LLC
BUSCH, ROBERT & KATHY
52 BENTWOOD CT
ALBANY, NY 12203

STONE HARBOUR MARINA, LLC
C/O MUSKET, DAVID B.
1655 BAY HARBOR LN
SARASOTA, FL 34231

STONE HARBOUR MARINA, LLC
C/O PAUL MARAGHY
345 THAMES ST, Unit N504
BRISTOL, RI 02809

STONE HARBOUR MARINA, LLC
TRUSTEES OF THE HURST FAM
345 THAMES ST 109N
BRISTOL, RI 02809

STONE HARBOUR MARINA, LLC
LI, HSI-CHENG
345 THAMES ST UNT 306 N
BRISTOL, RI 02809

STONE HARBOUR MARINA, LLC
C/O ROBERT & PATRICIA GRA
341 THAMES ST UNT S210
BRISTOL, RI 02809-2407

STONE HARBOUR MARINA, LLC
C/O ABRAMSON, SUSAN & EDW
341 THAMES ST UNT 104S
BRISTOL, RI 02809

STONE HARBOUR MARINA, LLC
MICHAEL & DENISE O'BRIEN
345 THAMES ST 206N
BRISTOL, RI 02809

STONE HARBOUR MARINA, LLC
C/O ROBERT B HANKIN TRUST
56 RAMBLING DR
SCOTCH PLAINS, NJ 07076

STONE HARBOUR MARINA, LLC
C/O BRAVE, ILENE E. & DEN
341 THAMES ST S206
BRISTOL, RI 02809

STONE HARBOUR MARINA, LLC
NASTRO, DAVID & KIM
343 THAMES ST M304
BRISTOL, RI 02809

STONE HARBOUR MARINA, LLC
C/O SHERMAN, MAX CHRISTOP
341 THAMES ST UNIT 205S
BRISTOL, RI 02809

STONE HARBOUR MARINA, LLC
C/O BUSCH, ROBERT & KATHL
52 BENTWOOD CT
ALBANY, NY 12203-4810

STONE HARBOUR MARINA, LLC
OZTERMIYECI, MUSTAFA M
341 THAMES ST S203
BRISTOL, RI 02809

STONE HARBOUR MARINA, LLC
C/O VIBEKE REIG LIV TRUST
341 THAMES ST S305
BRISTOL, RI 02809

STONE HARBOUR MARINA, LLC
C/O MATTHEW BERNARDO
345 THAMES ST, Unit 204N
BRISTOL, RI 02809

SUGARMAN, LOUIS TRST ETAL
MARAGHY, PAUL
345 THAMES ST UNIT 504N
BRISTOL, RI 02809

STONE HARBOUR MARINA, LLC
C/O WILLIAM & DONNA LAPOI
341 THAMES ST S201
BRISTOL, RI 02809

STONE HARBOUR MARINA, LLC
C/O NEIL & CHRISTINE FEIN
19 MARSHAL ST
BROOKLINE, MA 02446-5418

SUTTON, HOWARD G &
KIMBERLY G P TE
14685 KELSON CIRCLE
NAPLES, FL 34114

STONE HARBOUR MARINA, LLC
C/O WILLIAM MARTIN
691 15TH AVE SOUTH
NAPLES, FL 34102-7424

STONE HARBOUR MARINA, LLC
CHAMPAGNE, KEVIN & MICHAEL
4525 S. ATLANTIC AVE
PORT ORANGE, FL 32177-7061

TETU, NORMAND P
GINNY L. TE
190 BICENTENNIAL DR
HOOKSETT, NH 03106

STONE HARBOUR MARINA, LLC
HERBERT & JANET SARKISIAN
345 THAMES ST N209
BRISTOL, RI 02809

STONE HARBOUR MARINA, LLC
GINNY & NORMAND TETU
190 BICENTENNIAL DR
HOOKSETT, NH 03106-2702

THAMES STREET, LLC
227 THAMES ST, Unit 6
BRISTOL, RI 02809

STONE HARBOUR MARINA, LLC
JAMES & RANDELLE HURST
345 THAMES ST UNIT 109N
BRISTOL, RI 02809

STONE HARBOUR MARINA, LLC
JANET M FETTER REVOCABLE
343 THAMES ST UNIT M302
BRISTOL, RI 02809

THOMPSON, RICHARD J - TRU
RICHARD J THOMPSON TRUST
423 HOPE ST, UNIT C
BRISTOL, RI 02809

STONE HARBOUR MARINA, LLC
RIPP, PETER & MARI
345 THAMES ST N309
BRISTOL, RI 02809

STONE HARBOUR MARINA, LLC
LI, HSI-CHENG
345 THAMES ST UNIT 306N
BRISTOL, RI 02809-9195

TOPPA, JOHNA M
44 LINCOLN AVE
ATTLEBORO, MA 02703

TOWN OF BRISTOL
10 COURT ST
BRISTOL, RI 02809

ZELINGER, ELIZABETH A &
GERALD D TE
345 THAMES ST
UNIT N302
BRISTOL, RI 02809

TOWN OF BRISTOL
10 COURT ST.
BRISTOL, RI 02809

TOWN OF BRISTOL
STATE STREET
10 COURT ST
BRISTOL, RI 02809

TOWN OF BRISTOL
VACANT LAND
10 COURT ST.
BRISTOL, RI 02809

TSL LLC
244 GANO ST
PROVIDENCE, RI 02906

VAN DEVENTER, MARY P. &
BRENNAN, KIMBERLY C. TRUS
345 THAMES ST, UNIT 404N
BRISTOL, RI 02809

WANG, YINGFEI
59 CRESTVIEW RD
MILTON, MA 02186

WARNER, GARY W &
MURRAY, CATHERINE I JT
PO BOX 808
BRISTOL, RI 02809

WAYLAND WILLIAM F &
LORNA E TRUSTEES REVOC
345 THAMES ST UNT 105 N
BRISTOL, RI 02809

WILKER, RICHARD E &
WILKER, PHYLLIS BLOOM TRU
341 THAMES ST
UNIT S-308
BRISTOL, RI 02809