



Bristol Warren Regional School District

RIDE Necessity of School Construction Stage II



PMA Consultants

**PERKINS —
EASTMAN**

CONCEPT REVIEW | 08.07.2023



Bristol Warren Regional School District

MOUNT HOPE HIGH SCHOOL

**PERKINS —
EASTMAN**

Human by Design

Existing Site

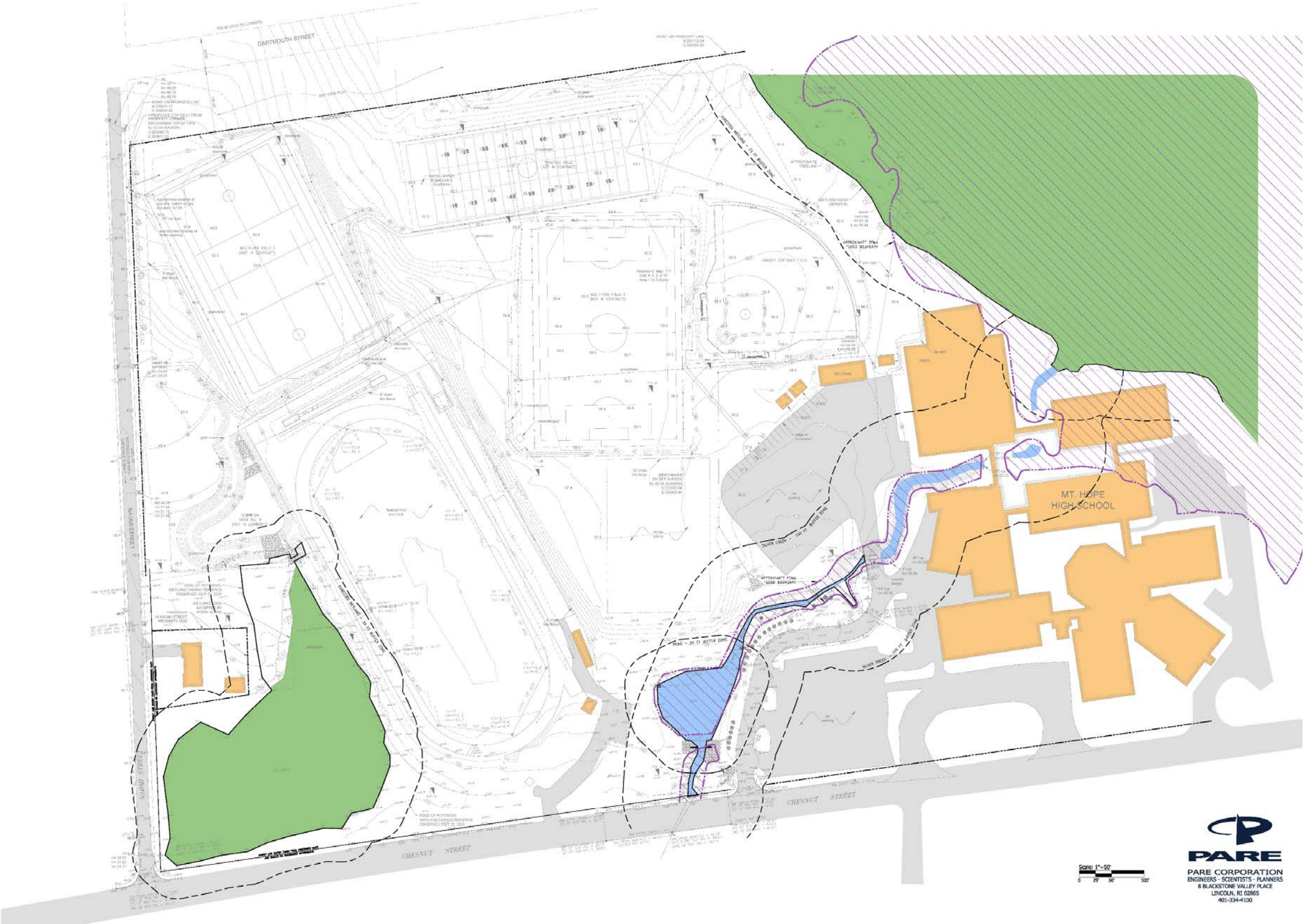

Site Restraints

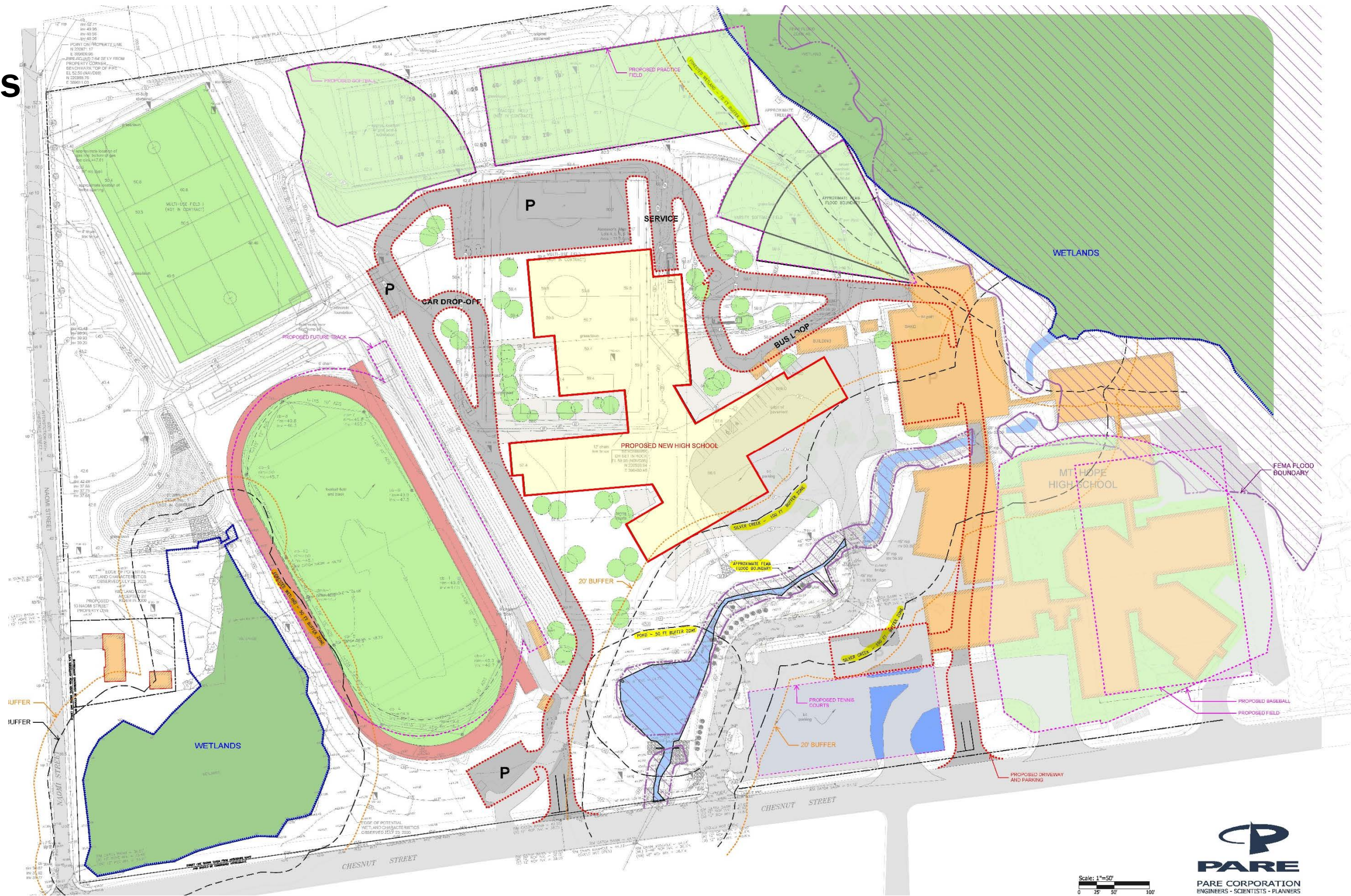

Site Plan

MOUNT HOPE HS

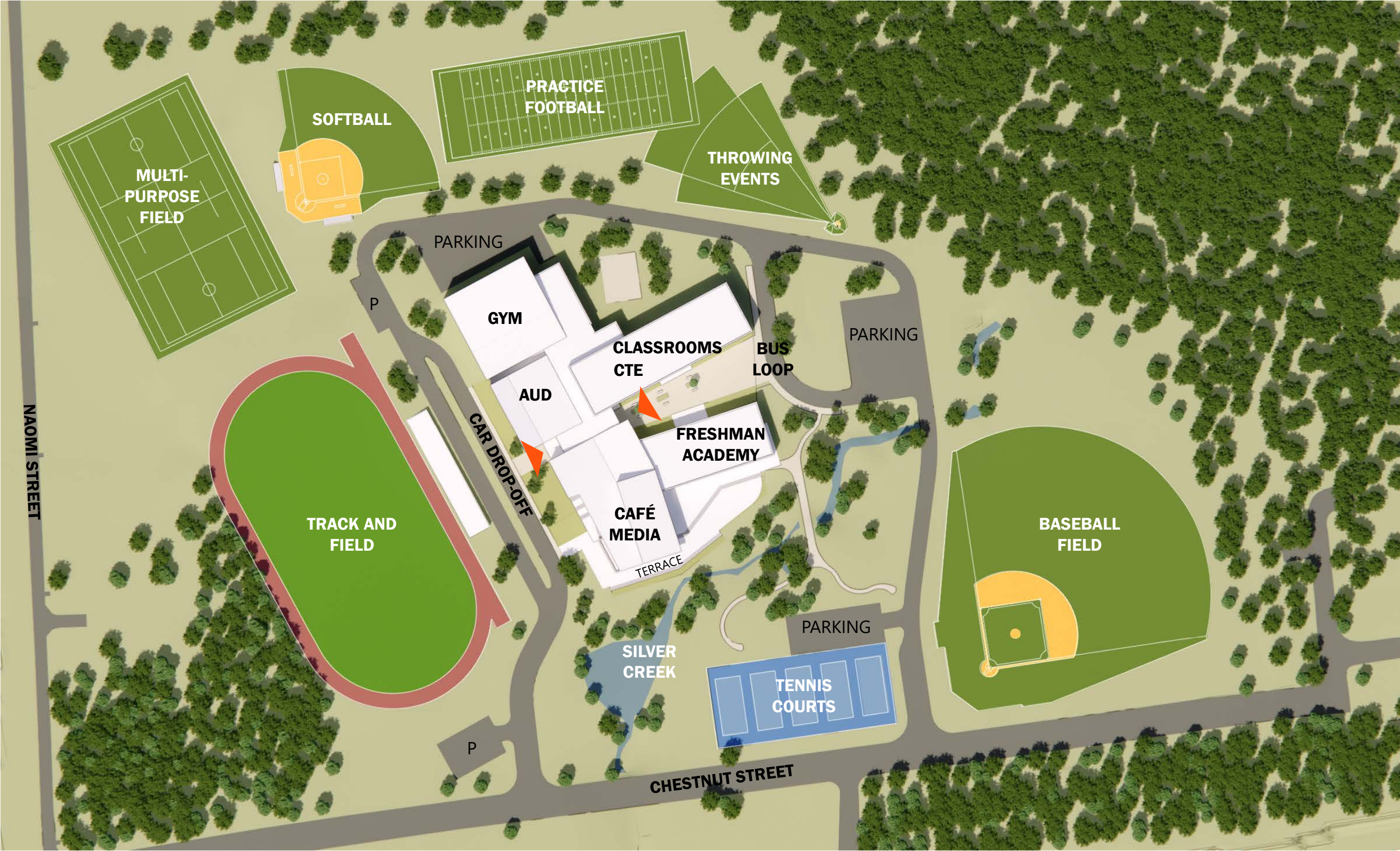

Main Entry Aerial

VIEW FROM WEST | CAR DROP-OFF

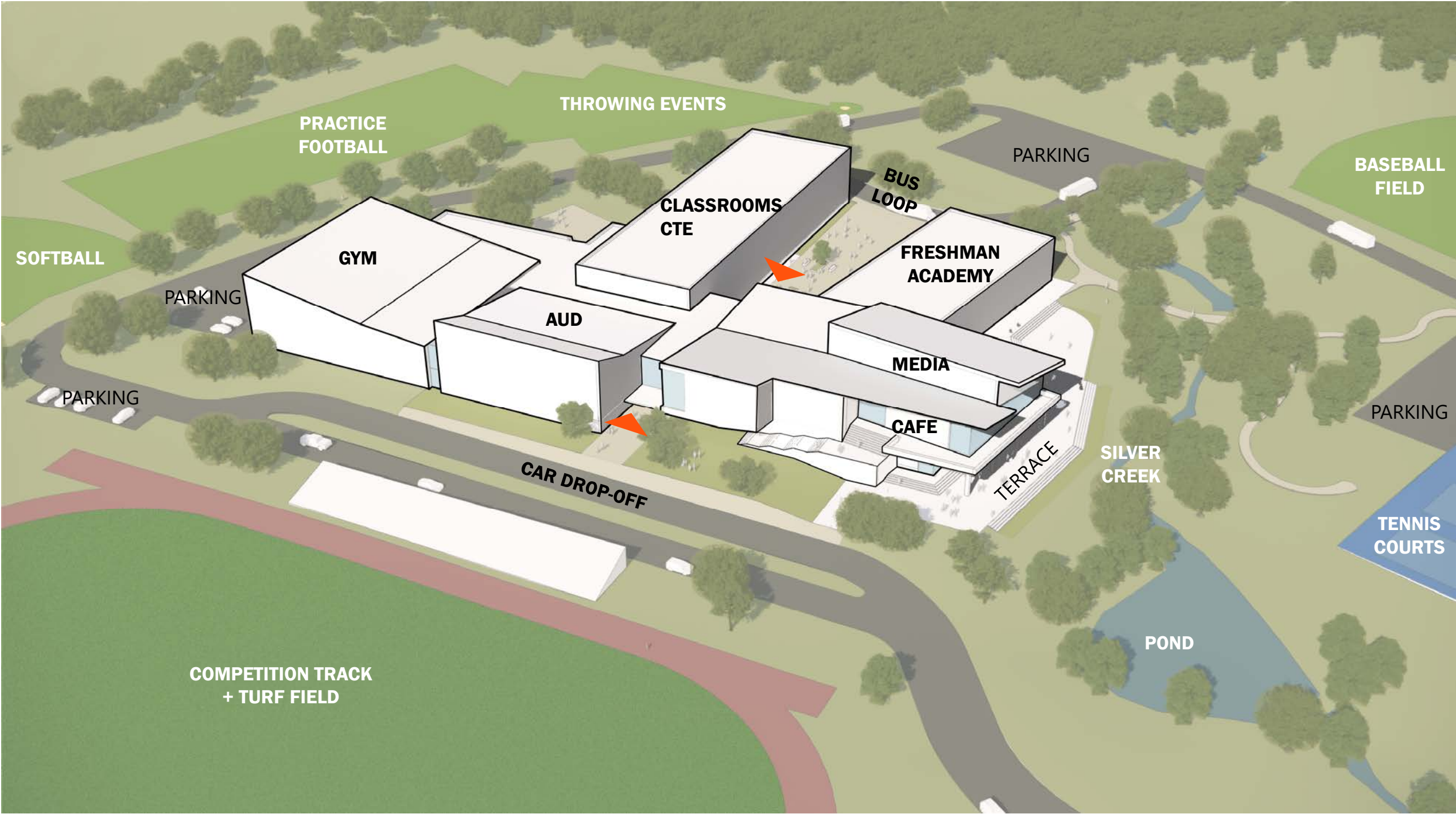

Courtyard Aerial

VIEW FROM EAST | BUS LOOP

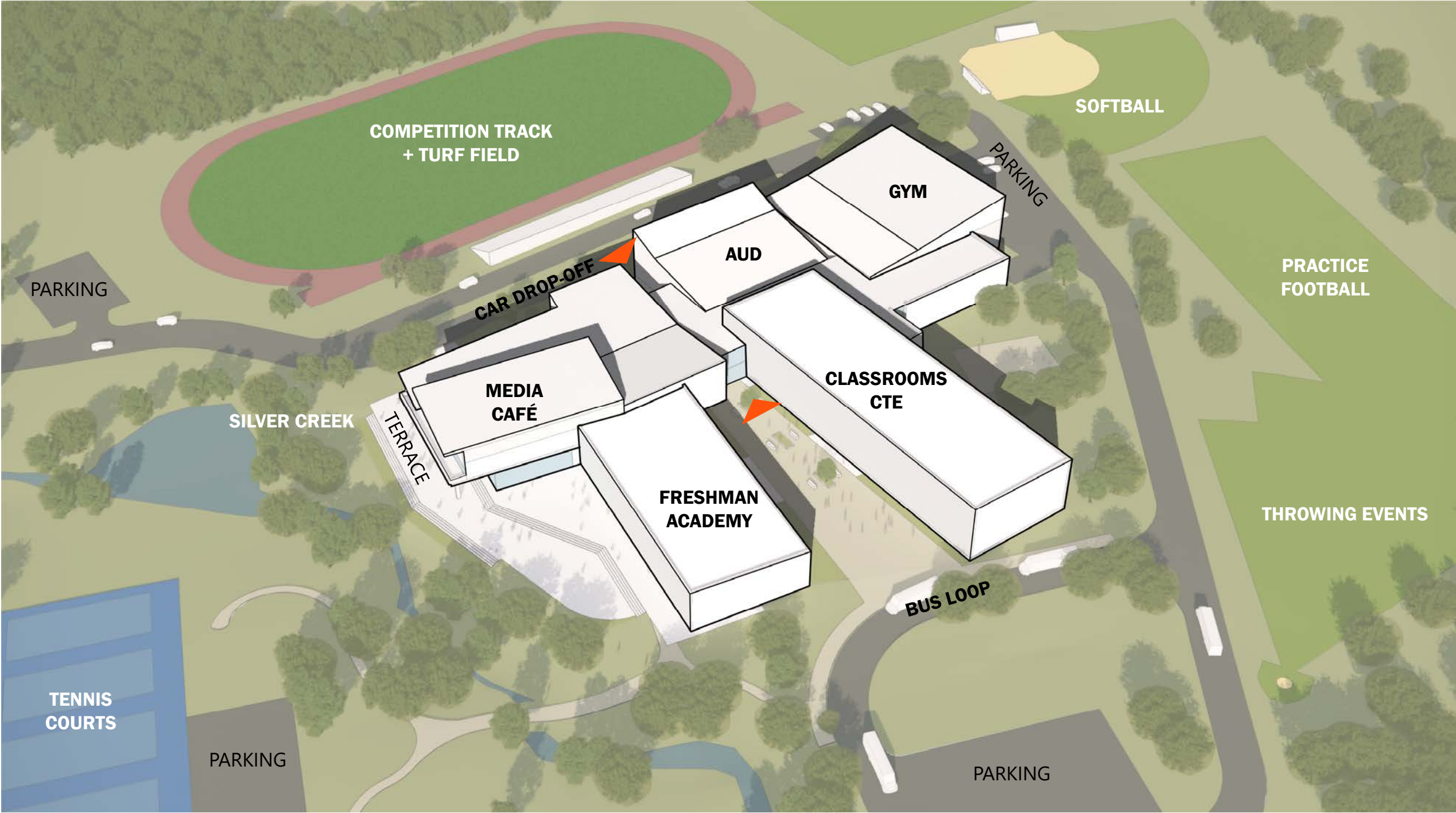

Site & First Floor Plan

BLUEWAYS & GREENWAYS

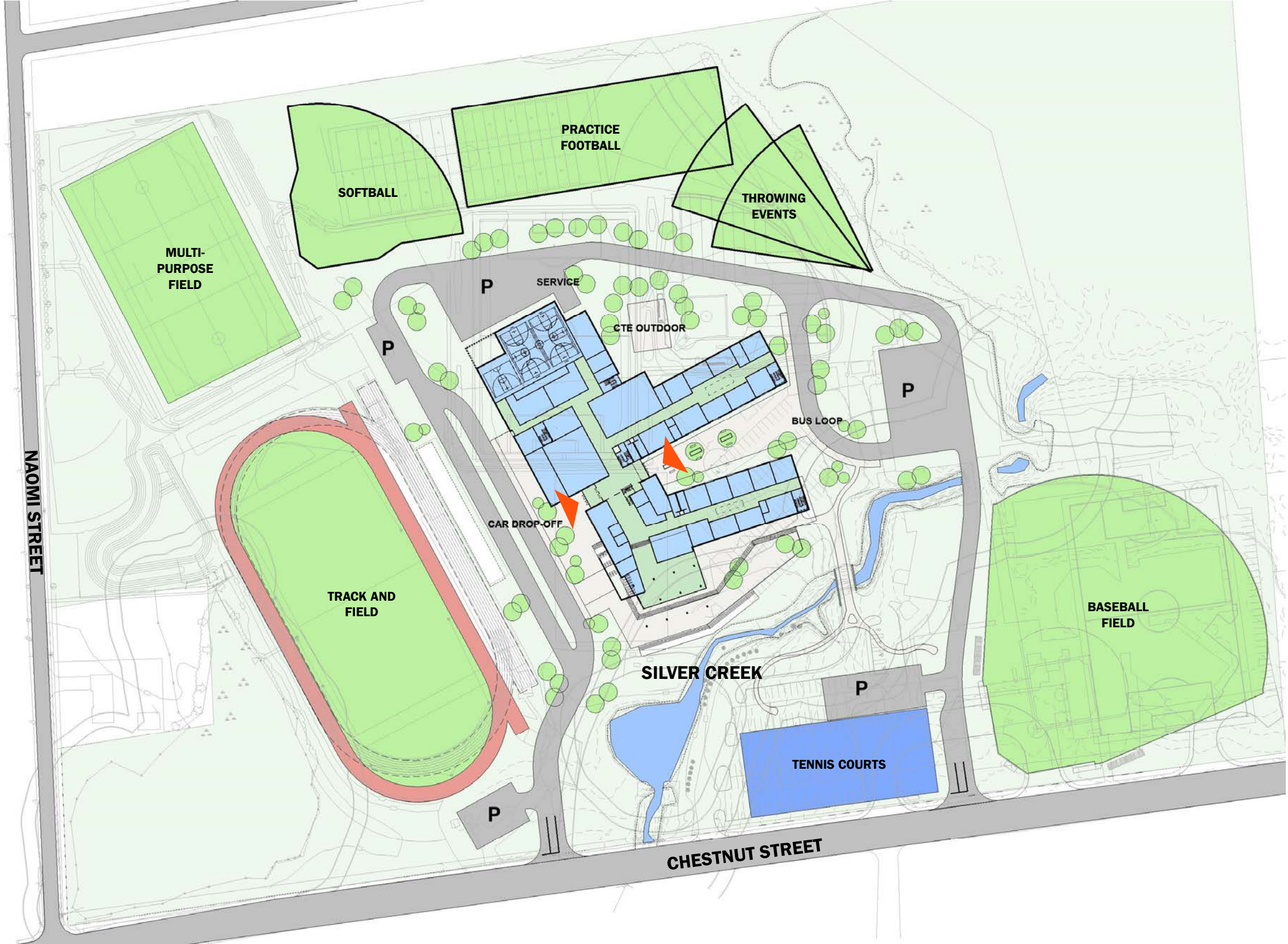

First Floor Plan





Third Floor Plan

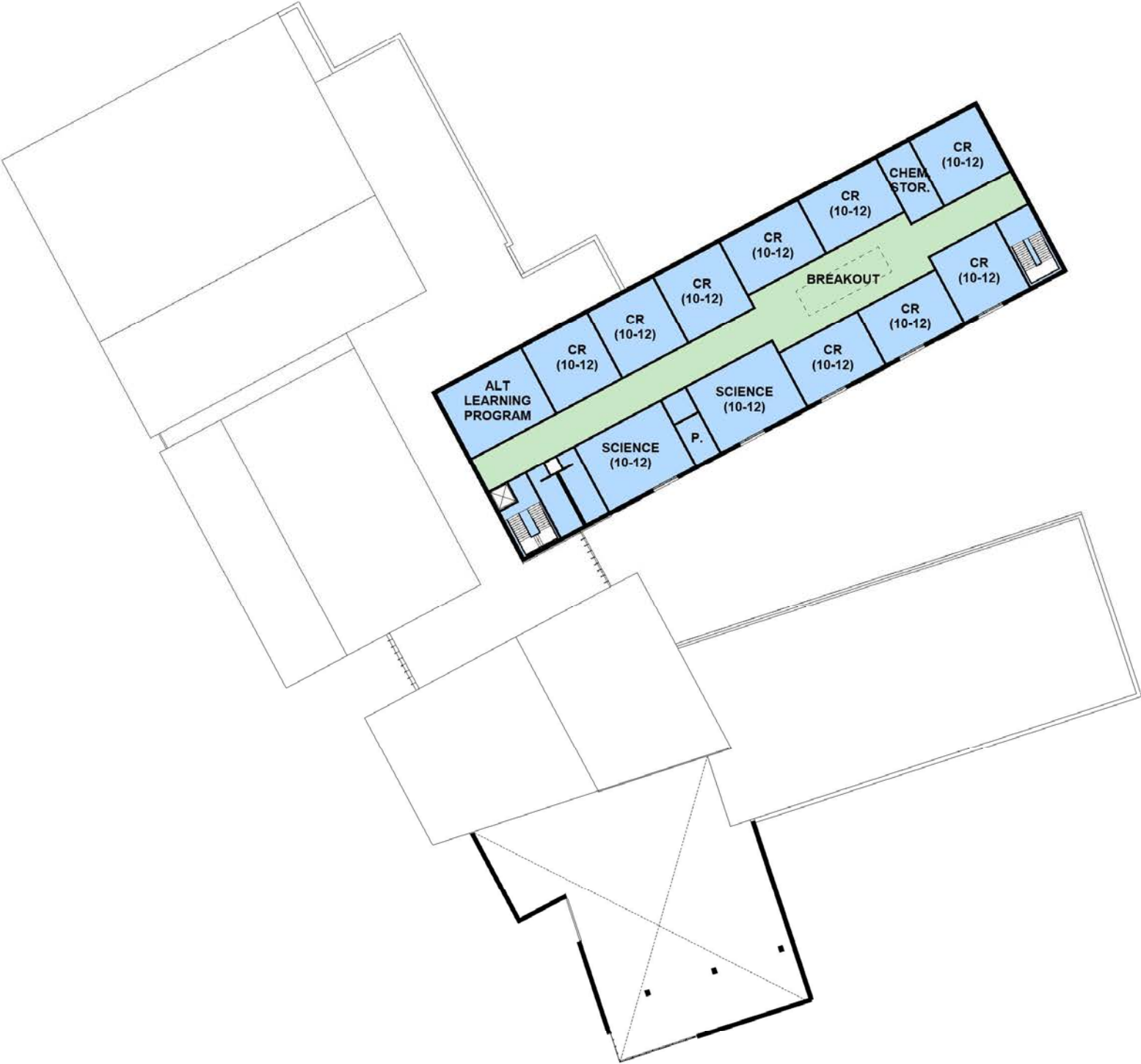

Inspiration

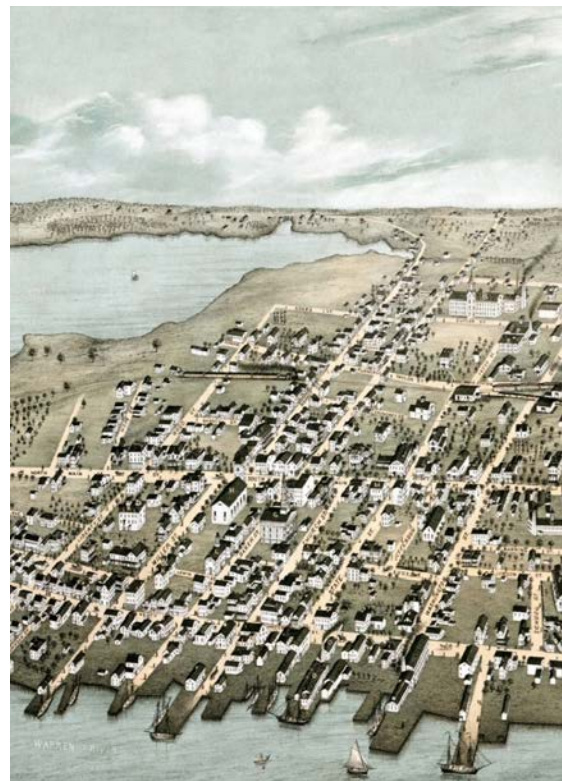

Student Commons | Café & Media

SILVER CREEK FACADE

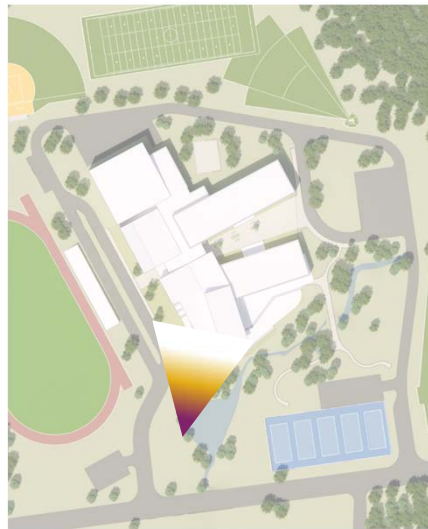

Main Entry

WEST FAÇADE

CAR DROP-OFF

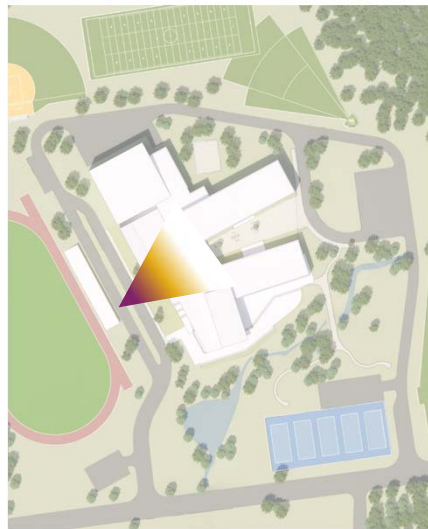

Courtyard Entry

EAST FAÇADE

BUS LOOP

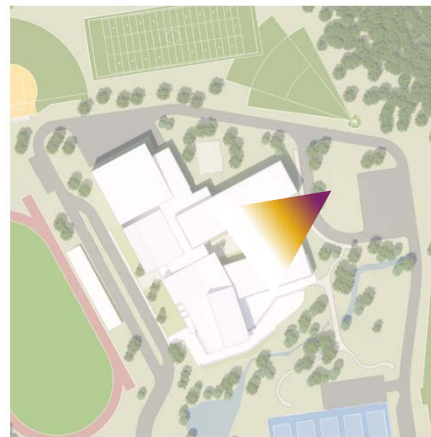



Bristol Warren Regional School District

COLT ANDREWS ELEMENTARY SCHOOL

**PERKINS —
EASTMAN**

Human by Design

Bristol-Warren Regional School District

- Legend:
- 901-1800 Enrollment
 - <900 Enrollment
 - XX Historic District

Rockwell ES
Grades PK – 5
25,609 SF
Poor Condition (31%-50%)

Mt. Hope HS
Grades 9 – 12
177,732 SF
Poor Condition (31%-50%)

Guiteras ES
Grades PK – 5
39,107 SF
Poor Condition (31%-50%)

Colt - Andrews ES
Grades 4 - 5 Grades K - 3
24,206 SF 31,817 SF
Average Condition (11%-30%)

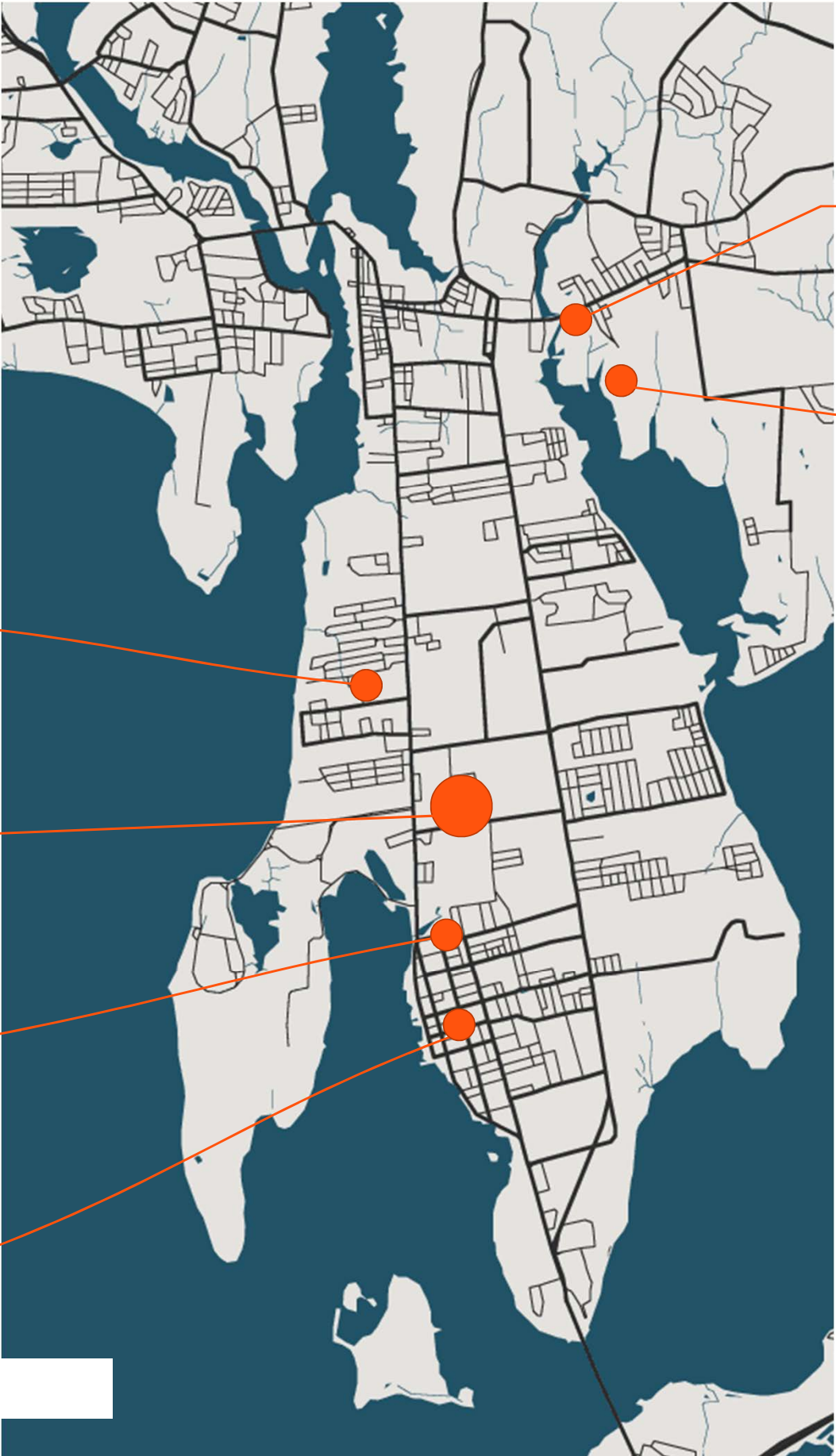

Kickemuit MS
Grades 6 – 8
149,915 SF
Poor Condition (31%-50%)

Hugh Cole ES
Grades PK – 5
84,536 SF
Average Condition (11%-30%)



Colt - Andrews

Current Site Plan

- Schools share same facilities
- Schools split by Bradford St.
- Dropoff on street
- Limited outdoor learning space
- Difficult to secure
- Unsightly chain-link fences



Colt – Andrews: Creating a Campus

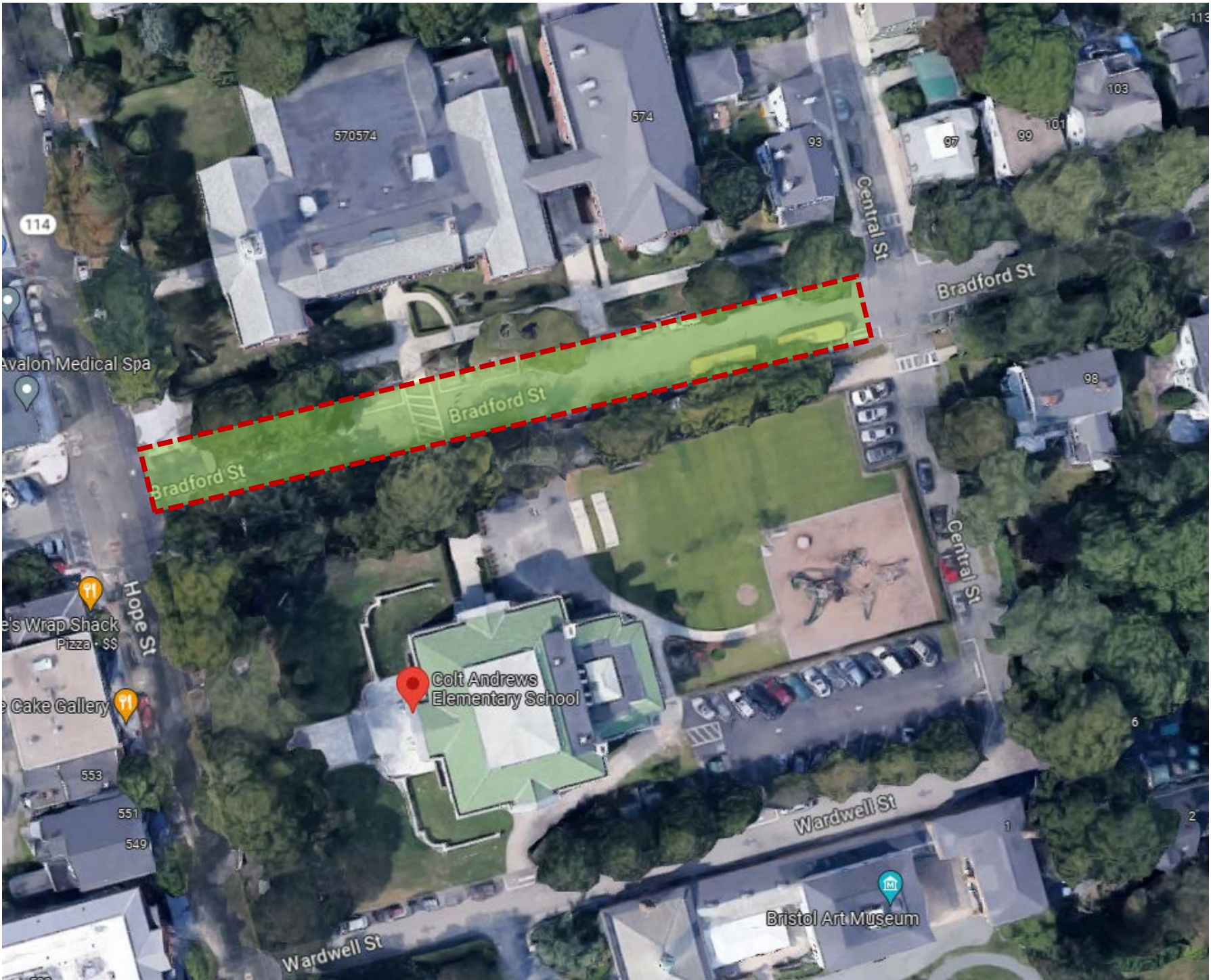

Colt School



Andrews School



Colt - Andrews

Proposed Campus Plan:

- Increased site safety & security
- Fire Access between buildings
- Buses cue in access drive
- Pedestrian path/market area
- More outdoor learning space
- More play space
- Historic quality perimeter fence
- Preserve Hope St. appearance



Colt - Andrews



Materials

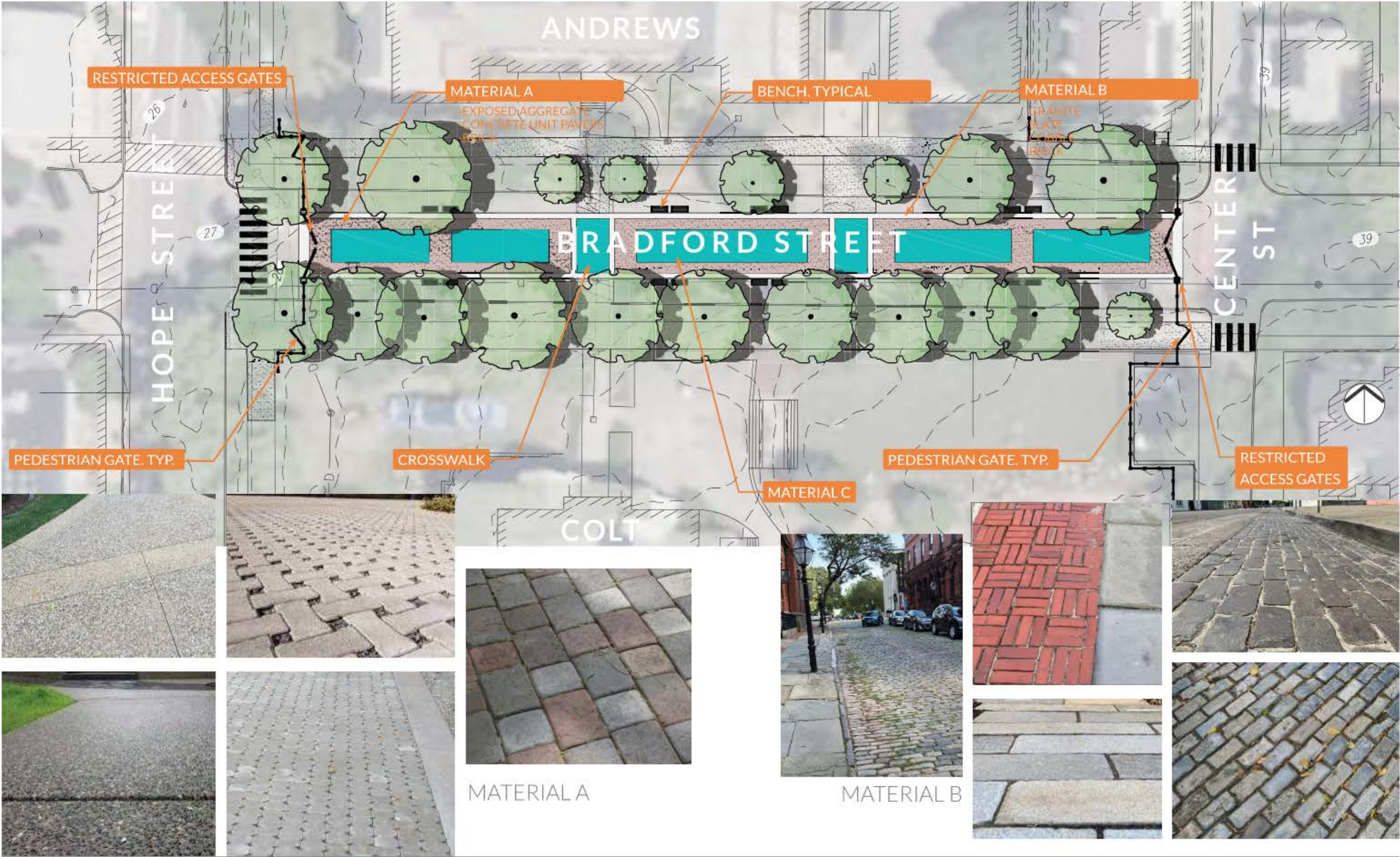

Bradford Street
Colt-Andrews School

Materials



ACCENT PAVEMENTS



FENCE AND GATES



FURNISHINGS

Bradford Street

Colt-Andrews School

PERKINS — **EASTMAN** BRISTOL WARREN SCHOOL DISTRICT

TRAVERSE
landscape architects