



Zoning Board of Review Application
Town of Bristol

Record ID: ZBR-26-12
26 Brookwood Road 79 500
March 13, 2026

| Applicant | |
|--|-----------------------------|
| Name of Applicant | Colleen Cavanaugh / King To |
| Who is Submitting this Application | Owner |
| | If other, Describe: |
| Owner's Name (If Different than Applicant) | |

| Location for Application | | | |
|---------------------------------|-------------------|------|-----|
| Property Type | Both | | |
| Zoning District | R-10 | | |
| Address, Plat, Lot | Address | Plat | Lot |
| | 26 Brookwood Road | 79 | 500 |

| Type of Application | |
|----------------------------|-------------------------------------|
| Application Type | Dimensional Variance |
| Proposed | Other (Lot coverage, Parking, etc.) |
| | If other, Detail: fence enclosure |
| New Building Type | If other, Detail: |

| Size of Proposed Building(s)/Addition(s) (If applicable) | |
|---|-----------|
| Total Square Footage | 900 feet |
| Width in Feet | 36.7 feet |
| Length in Feet | 28.5 feet |
| Height Above Grade | 6 feet |
| Number of Stories | 0 |

| Setbacks | |
|-------------------------|--------|
| Front Yard in Feet | 0 feet |
| Rear Yard in Feet | 0 feet |
| Left Side Yard in Feet | 0 feet |
| Right Side Yard in Feet | 0 feet |
| Height in Feet | 2 feet |

| | |
|----------------------------|--|
| Extension Request | |
| Date of Original Extension | |
| Date of First Extension | |

| |
|--|
| Provisions of Zoning Ordinance (If Known) |
|--|

Section 28-146(b)(1). Height of fence within front yard on a corner lot.

Describe the extent of the proposed alterations and the reasons for the requesting relief

After receiving permit in nov 2025, a garden enclosure was built to keep out deer. Neighbor's appeal was granted and a committee ruled to bring 6 foot fence to 4 feet. Fence had been built after permit issued. Cost of 10,000. Request variance to have remain as is. (see attached, provided narrative)

Existing Lot Specifications

| | |
|-------------------------|-----------------------------------|
| Current Use of Premises | Residential If other, explain: |
| Number of Units | |
| Lot Area | 17,800 |
| Lot Frontage | 138 |
| Lot Depth | 100 |

Existing Buildings & Structures

| | | |
|------------|-----------------|-------------------------------------|
| Structure: | Square Footage: | Building/Structure Detail if Other: |
|------------|-----------------|-------------------------------------|

Dear Members of the Bristol Zoning Committee,

I am requesting a variance for an existing garden enclosure at 26 Brookwood Road in Bristol.

After applying for and receiving a permit in November 2025, a garden enclosure was built. The enclosure was built to keep out deer. Deer had jumped over a previous three foot fence and destroyed most of the vegetables (tomatoes, squash, carrots, beets..) as well as pollinator plants within the fenced area. A six foot high fence was built to deter the deer.

One neighbor appealed this permit and the appeal was granted based on the zoning laws. The fence "partially obstructed their view." This enclosure is **open frame**. No other neighbors have objected. Unfortunately the permit issued was not in keeping with the city's zoning laws. This may have been because this is more of a garden enclosure than a fence. The committee ruled to reduce the height of the enclosure to four feet in keeping with zoning laws. Four feet will not deter the deer. The work on this project had been completed in December after the permit was granted and the approximate cost of the project was \$10,000.

We are requesting a variance so that we can keep the garden enclosure in place.

This enclosure is in the same footprint of a previous three foot high enclosure surrounding a vegetable garden. **The new enclosure is a custom-built, open-frame, decorative and protective garden enclosure that is aesthetically pleasing with straight lines and see through black welded wire. It is constructed with open wire panels to maintain visibility and neighborhood character. It is not privacy fencing, not a solid wall panel and not opaque. It is designed for plant protection and architectural continuity.** This garden enclosure is six feet high to keep out deer. There are wooden beams every 5 1/2 to 7 feet. Most of the structure is of black welded wire 2"x4" and 1'x1' which can easily be seen through. There is 6 inches of wire beneath the enclosure to keep out rabbits. The enclosure will weather to a pleasing grey color which will blend into the neighborhood.

I have been a Master Gardener since 2020. I have arranged raised beds for vegetables within the enclosure and have already transferred vulnerable pollinator plants to within the enclosure. Of note, I planted a large pollinator garden on the property in 2020 by adding enriched soil and planting native plants. There is a thriving bee and butterfly population there now. Most neighbors would agree that the yard visually enhances the neighborhood. In the past, neighborhood children have enjoyed picking carrots and snow peas from the garden.

We have attached a drawing to scale of our property and the garden enclosure as well as photos of the garden.

Thank you for your consideration.

Sincerely,

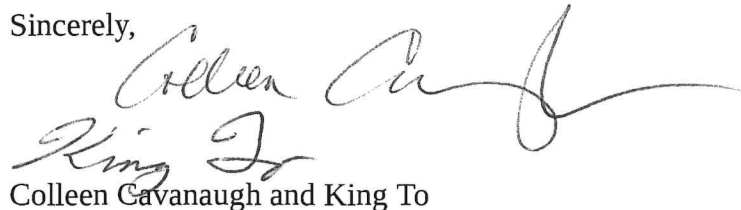

Colleen Cavanaugh and King To

26 BROOKWOOD RD
HOUSE

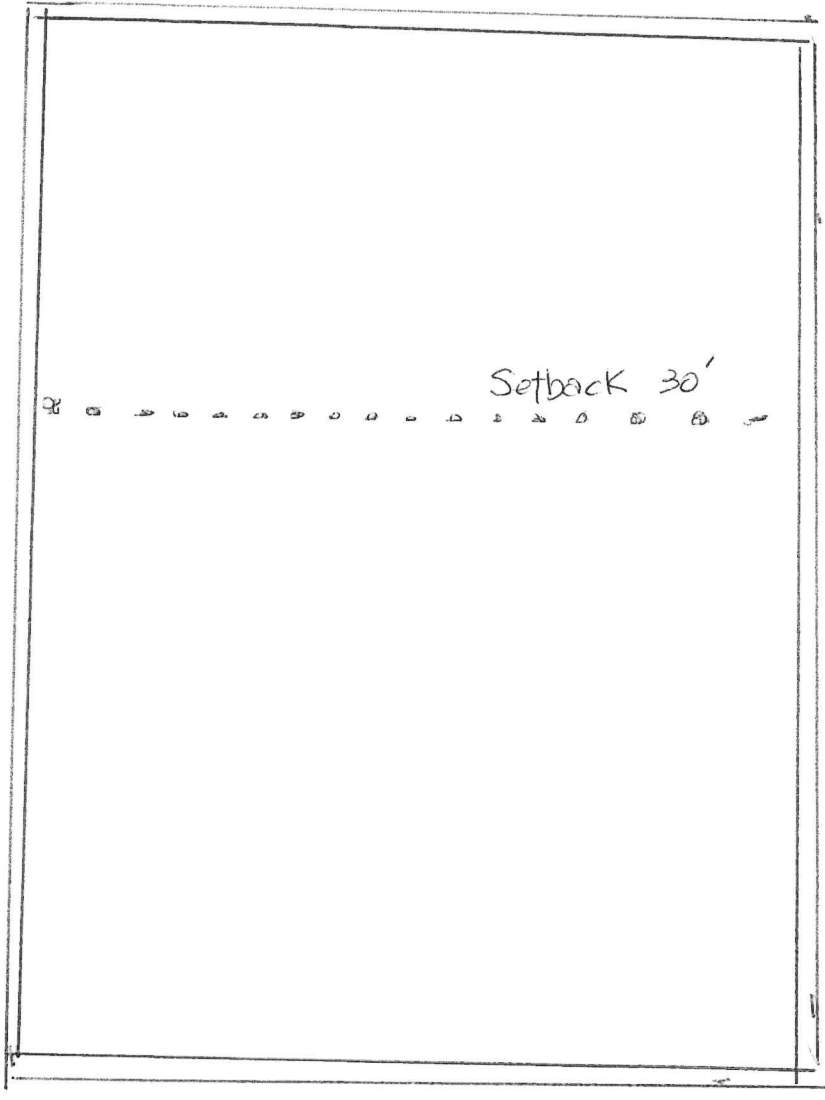

BROOKWOOD

DRIVEWAY

PROPERTY LINE 12'

Scale 1" = 6.67'

FILES





ON THE POLLINATOR PATHWAY
RESTORATION
RESTORE-FREE
NATIVE PLANTS
THIS PROPERTY IS



THE PEANUT BUTTER PATHWAY
SUPPORTING LOCAL PRODUCTION



Plat/Lot 079-0500-000

Account: 4759

LUC 27

Zone R-10

Assessment \$1,286,00

Building Information

| Description | Quantity | Quality |
|--------------|---------------|--------------|
| BLDG Type | Contempora | 3 Story |
| RES Units | 1 | 0 |
| Foundation | Concrete | BMT Floor |
| Frame 1 | Wood | Frame 2 |
| EXT Wall 1 | Vinyl Siding | EXT Wall 2 |
| Roof Type 1 | Gable | Roof Type 2 |
| Roof Cover 1 | Asphalt Shirs | Roof Cover 2 |
| INT Wall 1 | Drywall | INT Wall 2 |
| Floors 1 | Hardwood | Floors 2 |
| BMT Garages | | Color |
| Plumbing | | Electrical |
| Insulation | | INT vs EXT |
| Heat Fuel | Oil | Heat Type |
| # Heat Sys | | % Heated |
| % Solar HW | | % A/C |
| % COM Wall | | % Vacuum |
| Ceil HIGHT | | Ceiling Type |
| Parking Type | | % Sprinkled |
| EXT View | | |

Grade

| Year Built | 2012 | EFF Year | Alt LUC | Q3 | Q3 | Alt % |
|------------|------|----------|---------|----|----|-------|
| | | | 0.00 | | | |

Other Factors

| Flood Hazard | Topography | Street | Traffic |
|--------------|------------|--------------|---------|
| Bas \$/SQ | 220.00 | Size Adj | 0.92 |
| Constr Adj | 1.01 | Adj \$/SQ | 204.69 |
| Othr Feats | 54,860 | Grade Fac | 1.18 |
| Neigh Infl | 1.00 | Land Factor | 1.00 |
| Adj Total | 1,087,346 | Depreciation | 100,036 |
| Depr Total | 987,310 | | |

Sub-Area Detail

| Code | Description | Area | Fin. Area | Rate | Undep Val |
|-------|-------------|-------|-----------|--------|-----------|
| FFL | 1st FLOOR | 1,320 | 1,320 | 204.69 | 270,191 |
| SFL | 2nd FLOOR | 1,320 | 1,320 | 204.69 | 270,191 |
| TFL | 3rd FLOOR | 1,320 | 1,320 | 204.69 | 270,191 |
| EFP | ENCL PORCH | 280 | 0 | 16.71 | 4,679 |
| GAR | GARAGE | 1,080 | 0 | 33.70 | 36,396 |
| OPF | OPEN PORCH | 840 | 0 | 10.43 | 8,762 |
| WD | WOOD DECK | 420 | 0 | 14.79 | 6,212 |
| Total | | 6,580 | 3,960 | | 866,622 |

Visit History

| Date | Result | By |
|-----------|------------|----|
| 1/30/2025 | REVIEW | MP |
| 1/24/2025 | REVIEW | MP |
| 11/1/2021 | BP | |
| 7/12/2021 | REVIEW | |
| 4/11/2019 | HEARING NC | |
| 9/21/2018 | REVIEW | |
| 9/13/2018 | MEASURED | |
| 3/22/2013 | MEASURE | |
| 3/22/2013 | LISTED | |

Notes

PROPERTY SOLD IN 2 ESTATE DEEDS - DEED BK 1523 PGS 175 & 178 RESIDENCE UNDER CONSTRUCTION 12/11 EAS c/o issued 6-6-2012 mcb

Remodeling History

| Additions | Plumbing | Electric | Heating | General | 2022 |
|-----------|----------|----------|---------|---------|------|
| Interior | | | | | |
| Exterior | | | | | |
| Kitchen | | | | | |
| Bath(s) | | | | | |

Condo Data

| Complex | Location | Tot Units | FL Level | # Floors | Bldg Seq |
|---------|----------|-----------|----------|----------|----------|
| | | | | 0 | 1 |

Building Permits

| Issue Date | Permit # | Closed Date | BP Type | Est. Cost | % Done | Status | Description/Directions |
|------------|----------|-------------|---------|-----------|--------|--------|--|
| 02/02/2022 | M53491 | | MECH | 10,000 | 100 | Closed | Install 3 indoor wall hung coils with one hyper heat condensing unit |
| 01/27/2022 | E53469 | | ELEC | 2,200 | 100 | Closed | Wire sun room for power and lighting |
| 08/05/2021 | B52622 | | BLDG | 52,000 | 100 | Closed | Construct a 14'X20' Sunroom/Solarium off the front of existing building. |
| 09/23/2020 | B51075 | | BLDG | 9,500 | 100 | Closed | To construct a 12' X 16' utility shed at the rear of the existing house. |
| 09/20/2012 | M17706 | | MECH | 0 | 100 | Closed | INSTALL GAS PIPING TO GENERATOR |
| 04/16/2012 | P21263 | | PLUMB | 0 | 100 | Closed | INSTALL IRRIGATION BACKFLOW |
| 04/16/2012 | P21292 | | PLUMB | 0 | 100 | Closed | INSTALL LAWN SPRINKLERS |
| 12/06/2011 | M12301 | | MECH | 0 | 100 | Closed | INSTALL THREE DUCTLESS UNITS ON SECOND FLOOR AND ONE DUCTLESS |
| 11/16/2011 | E6646 | | ELEC | 0 | 100 | Closed | LOW VOLTAGE AUDIO SPEAKER PRE-WIRE |

Special Features & Yard Items

| Use | Description | A | Y/S | Qty | Length | Width | SF Size | Quality | Condition | Year | Assessed Value |
|-----|-------------|---|-----|-----|--------|-------|---------|---------|-----------|------|----------------|
| 1 | Shed | 1 | Y | 1 | 12 | 16 | 192 | 3 | AV | 2020 | 1,600 |
| 2 | | | | | | | | | | | |
| 3 | | | | | | | | | | | |
| 4 | | | | | | | | | | | |
| 5 | | | | | | | | | | | |
| 6 | | | | | | | | | | | |
| 7 | | | | | | | | | | | |
| 8 | | | | | | | | | | | |
| 9 | | | | | | | | | | | |
| 10 | | | | | | | | | | | |

Other Info.

| AFDU |
|--------------|
| rtTermRental |
| PriorD1c |
| PriorD2a |
| PriorD2b |
| PriorD2c |
| PriorD3a |
| PriorD3b |
| PriorD3c |

Room Counts by Floor

| Units | # Rooms | # Bedrooms | Floor Level |
|--------|---------|------------|-------------|
| 1 | 1 | 6 | 3 |
| 2 | | | U |
| 3 | | | |
| 4 | | | |
| Totals | 1 | 6 | 3 |



26 Brookwood Road - 300' Radius

Town of Bristol, RI

1 inch = 141 Feet



www.cai-tech.com

April 15, 2026

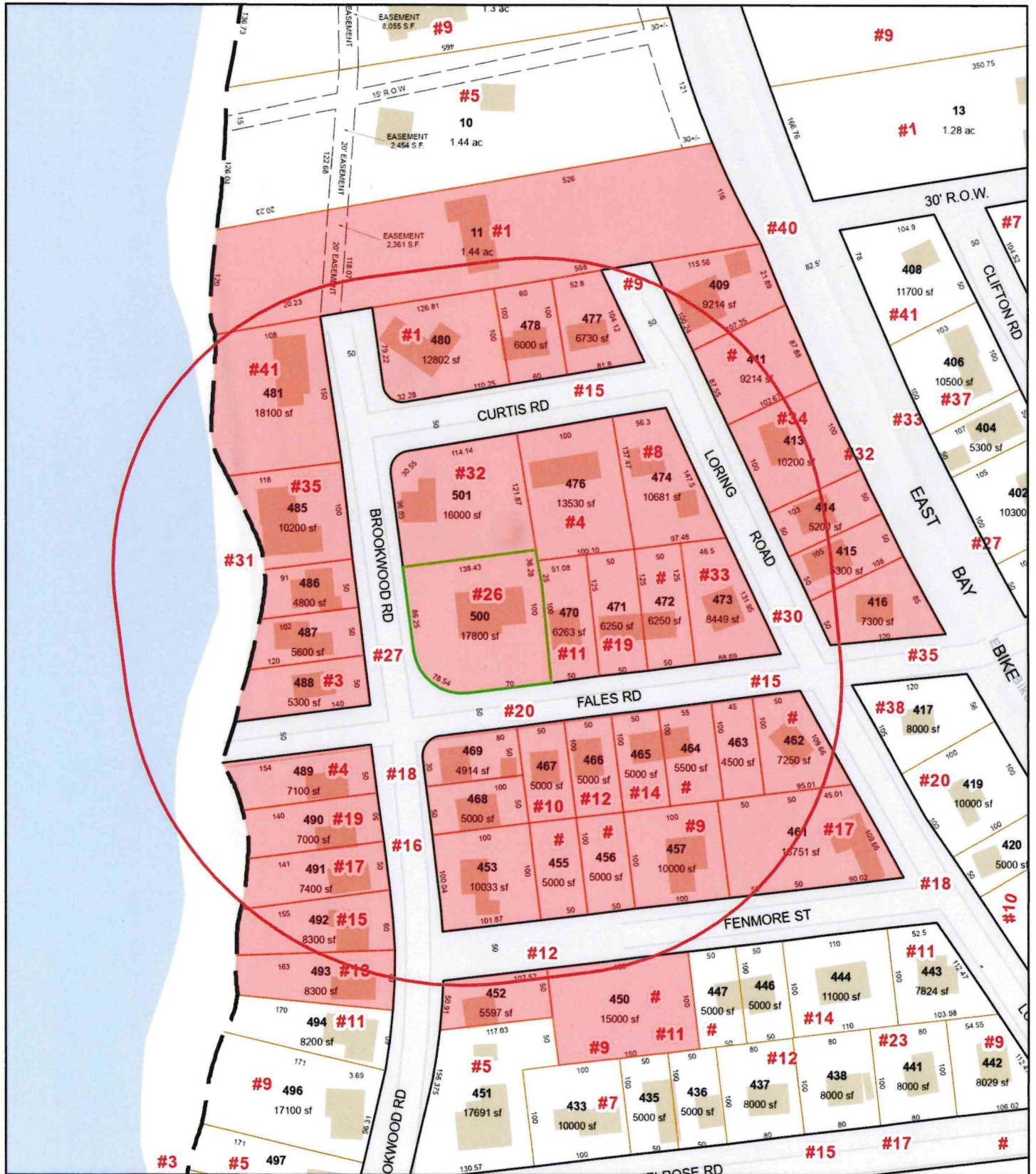

Data shown on this map is provided for planning and informational purposes only. The municipality and CAI Technologies are not responsible for any use for other purposes or misuse or misrepresentation of this map.



300 feet Abutters List Report

Bristol, RI
April 15, 2026

Subject Property:

Parcel Number: 79-500
CAMA Number: 79-500
Property Address: 26 BROOKWOOD RD

Mailing Address: TO, KING W. TRUSTEE
26 BROOKWOOD RD
BRISTOL, RI 02809

Abutters:

Parcel Number: 74-11
CAMA Number: 74-11
Property Address: 1 SHORE RD

Mailing Address: CAMPBELL SANDRA L
1 SHORE RD
BRISTOL, RI 02809

Parcel Number: 79-409
CAMA Number: 79-409
Property Address: 40 LORING RD

Mailing Address: ZAYDON, PAUL TRUSTEE & BISSETT,
AMELIA TRST TC
40 LORING RD
BRISTOL, RI 02809

Parcel Number: 79-411
CAMA Number: 79-411
Property Address: LORING RD

Mailing Address: MELLO, ROBERT W JR. ETUX MELLO,
DONNA A.
16 HILLSIDE RD
BRISTOL, RI 02809

Parcel Number: 79-413
CAMA Number: 79-413
Property Address: 34 LORING RD

Mailing Address: MELLO, ROBERT W ET UX MELLO,
SHEILA C JT
34 LORING ROAD
BRISTOL, RI 02809

Parcel Number: 79-414
CAMA Number: 79-414
Property Address: 32 LORING RD

Mailing Address: CROCKER, STEVEN E TRUSTEE SEVEN
E CROCKER LIVING TRUST
32 LORING RD
BRISTOL, RI 02809

Parcel Number: 79-415
CAMA Number: 79-415
Property Address: 30 LORING RD

Mailing Address: DAUBENEY, GLENN A. MARIA
30 LORING RD
BRISTOL, RI 02809

Parcel Number: 79-416
CAMA Number: 79-416
Property Address: 35 FALES RD

Mailing Address: PLOHR, BRADLEY
4 COX CT
BRISTOL, RI 02809

Parcel Number: 79-450
CAMA Number: 79-450
Property Address: FENMORE RD

Mailing Address: RINALDI, RICHARD & RINALDI, EILEEN
TRUSTEES
80 SHERRY AVE
BRISTOL, RI 02809

Parcel Number: 79-452
CAMA Number: 79-452
Property Address: 12 BROOKWOOD RD

Mailing Address: LEESER, DANIEL L & LILLIAN C
TRUSTEES LILLIAN C LEESER FAMILY
TRUST
11 CRESTWOOD DR
FRAMINGHAM, MA 01701

Parcel Number: 79-453
CAMA Number: 79-453
Property Address: 16 BROOKWOOD RD

Mailing Address: POLULAK, MYRON & JOANN TE
16 BROOKWOOD RD
BRISTOL, RI 02809



www.cai-tech.com



300 feet Abutters List Report

Bristol, RI
April 15, 2026

| | |
|---|--|
| Parcel Number: 79-455 CAMA Number: 79-455 Property Address: FENMORE RD | Mailing Address: MCCABE, MARION L. 10 FALES RD BRISTOL, RI 02809 |
| Parcel Number: 79-456 CAMA Number: 79-456 Property Address: FENMORE RD | Mailing Address: KRUSHNOWSKI, ERIC JOHN & CAROL LEE TRUSTEES 9 FENMORE RD BRISTOL, RI 02809 |
| Parcel Number: 79-457 CAMA Number: 79-457 Property Address: 9 FENMORE RD | Mailing Address: KRUSHNOWSKI, ERIC JOHN & CAROL LEE TRUSTEES 9 FENMORE RD BRISTOL, RI 02809 |
| Parcel Number: 79-461 CAMA Number: 79-461 Property Address: 17 LORING RD | Mailing Address: SIMMONS, VIRGINIA TRUST 17 LORING RD BRISTOL, RI 02809 |
| Parcel Number: 79-462 CAMA Number: 79-462 Property Address: LORING RD | Mailing Address: HENRIE, AMY LIPTON & ALEXANDER O'GORMAN TE 15 LORING RD BRISTOL, RI 02809 |
| Parcel Number: 79-463 CAMA Number: 79-463 Property Address: 15 LORING RD | Mailing Address: HENRIE, AMY LIPTON & ALEXANDER O'GORMAN TE 15 LORING RD BRISTOL, RI 02809 |
| Parcel Number: 79-465 CAMA Number: 79-465 Property Address: 14 FALES RD | Mailing Address: PERRY, SCOTT M. JR & JESSICA TE 14 FALES RD BRISTOL, RI 02809 |
| Parcel Number: 79-466 CAMA Number: 79-466 Property Address: 12 FALES RD | Mailing Address: MARTIN, CARLA A TRUSTEE HEATHER A MARTIN IRREVOCABLE TRUST 270 NEWLAND AVE WOONSOCKET, RI 02895 |
| Parcel Number: 79-467 CAMA Number: 79-467 Property Address: 10 FALES RD | Mailing Address: MCCABE, MARION L. 10 FALES RD BRISTOL, RI 02809 |
| Parcel Number: 79-468 CAMA Number: 79-468 Property Address: 18 BROOKWOOD RD | Mailing Address: TO, KING W. TRUSTEE 18 BROOKWOOD RD BRISTOL, RI 02809 |
| Parcel Number: 79-469 CAMA Number: 79-469 Property Address: 20 BROOKWOOD RD | Mailing Address: FERREIRA, PAULA E. 52 JENNYS LANE BARRINGTON, RI 02806 |
| Parcel Number: 79-470 CAMA Number: 79-470 Property Address: 11 FALES RD | Mailing Address: CONNELL, ROBIN D. & CONNELL, BYRON J. III, TRUSTEES 11 FALES RD BRISTOL, RI 02809 |



www.cai-tech.com



300 feet Abutters List Report

Bristol, RI
April 15, 2026

| | |
|---|--|
| Parcel Number: 79-471 CAMA Number: 79-471 Property Address: 19 FALES RD | Mailing Address: BABYAK, EDWARD E. JR & JACQUELINE D. TE 19 FALES ROAD BRISTOL, RI 02809 |
| Parcel Number: 79-472 CAMA Number: 79-472 Property Address: FALES RD | Mailing Address: BABYAK, EDWARD E. JR & JACQUELINE D. TE 19 FALES ROAD BRISTOL, RI 02809 |
| Parcel Number: 79-473 CAMA Number: 79-473 Property Address: 33 FALES RD | Mailing Address: PENATZER, JOHN JR & NEWTON, KIMBERLEY JT 33 FALES RD BRISTOL, RI 02809 |
| Parcel Number: 79-474 CAMA Number: 79-474 Property Address: 8 CURTIS RD | Mailing Address: MARISCAL, JUAN 8 CURTIS RD BRISTOL, RI 02809 |
| Parcel Number: 79-476 CAMA Number: 79-476 Property Address: 4 CURTIS RD | Mailing Address: SOUSA, JOSEPH 4 CURTIS RD BRISTOL, RI 02809 |
| Parcel Number: 79-477 CAMA Number: 79-477 Property Address: 9 CURTIS RD | Mailing Address: DAUBENEY, KEITH A 9 CURTIS ST BRISTOL, RI 02809 |
| Parcel Number: 79-478 CAMA Number: 79-478 Property Address: 15 CURTIS RD | Mailing Address: JONES, PAUL T. JR & JONES, LINDA TRUSTEES 15 CURTIS RD BRISTOL, RI 02809 |
| Parcel Number: 79-480 CAMA Number: 79-480 Property Address: 1 CURTIS RD | Mailing Address: ALIX, ALFRED W JR & ANNE L TE 1 CURTIS RD BRISTOL, RI 02809-1204 |
| Parcel Number: 79-481 CAMA Number: 79-481 Property Address: 41 BROOKWOOD RD | Mailing Address: CALVERT, STEVEN L. & PATRICIA L TRUSTEES 41 BROOKWOOD RD BRISTOL, RI 02809 |
| Parcel Number: 79-485 CAMA Number: 79-485 Property Address: 35 BROOKWOOD RD | Mailing Address: SWINNEY, JEFFREY D. & SWINNEY, ANNE E. TRUSTEES 35 BROOKWOOD RD BRISTOL, RI 02809 |
| Parcel Number: 79-486 CAMA Number: 79-486 Property Address: 31 BROOKWOOD RD | Mailing Address: RIGAMONTI, GIANFRANCO-TRUSTEE GIANFRANCO RIGAMONTI REV TRUST 31 BROOKWOOD RD BRISTOL, RI 02809 |
| Parcel Number: 79-487 CAMA Number: 79-487 Property Address: 27 BROOKWOOD RD | Mailing Address: GARCIA, GILBERTO ET UX SUZANNE LEWIS TE 27 BROOKWOOD ROAD BRISTOL, RI 02809 |



www.cai-tech.com

4/15/2026

Data shown on this report is provided for planning and informational purposes only. The municipality and CAI Technologies are not responsible for any use for other purposes or misuse or misrepresentation of this report.

Page 3 of 4



300 feet Abutters List Report

Bristol, RI
April 15, 2026

Parcel Number: 79-488
CAMA Number: 79-488
Property Address: 3 FALES RD

Mailing Address: GRABOWSKI, PETER C & ELLEN M T
TRUSTEES
3 FALES ROAD
BRISTOL, RI 02809

Parcel Number: 79-489
CAMA Number: 79-489
Property Address: 4 FALES RD

Mailing Address: MELLOR, MICHAEL MELLOR, MARY C
TE
403 W 1ST ST #202
S BOSTON, MA 02127

Parcel Number: 79-490
CAMA Number: 79-490
Property Address: 19 BROOKWOOD RD

Mailing Address: LUTTMANN, SEAN S. TRUSTEE
19 BROOKWOOD RD
BRISTOL, RI 02809

Parcel Number: 79-491
CAMA Number: 79-491
Property Address: 17 BROOKWOOD RD

Mailing Address: CRYAN, JOHN J & CRYAN, KAREN L TE
17 BROOKWOOD RD
BRISTOL, RI 02809

Parcel Number: 79-492
CAMA Number: 79-492
Property Address: 15 BROOKWOOD RD

Mailing Address: SCHULZE, ROBERT M. & SCHULZE,
MICHELLE T. TRUSTEES
P.O. BOX 46
BRISTOL, RI 02809

Parcel Number: 79-493
CAMA Number: 79-493
Property Address: 13 BROOKWOOD RD

Mailing Address: SCHULZE, ROBERT M. & SCHULZE,
MICHELLE T. TRUSTEES
P.O. BOX 46
BRISTOL, RI 02809

Parcel Number: 79-500
CAMA Number: 79-500
Property Address: 26 BROOKWOOD RD

Mailing Address: TO, KING W. TRUSTEE
26 BROOKWOOD RD
BRISTOL, RI 02809

Parcel Number: 79-501
CAMA Number: 79-501
Property Address: 32 BROOKWOOD RD

Mailing Address: TOYE, MARY P
32 BROOKWOOD RD
BRISTOL, RI 02809



www.cai-tech.com

Data shown on this report is provided for planning and informational purposes only. The municipality and CAI Technologies are not responsible for any use for other purposes or misuse or misrepresentation of this report.

ALIX, ALFRED W JR & ANNE
1 CURTIS RD
BRISTOL, RI 02809-1204

GARCIA, GILBERTO ET UX
SUZANNE LEWIS TE
27 BROOKWOOD ROAD
BRISTOL, RI 02809

MELLO, ROBERT W ET UX
MELLO, SHEILA C JT
34 LORING ROAD
BRISTOL, RI 02809

BABYAK, EDWARD E. JR & JA
19 FALES ROAD
BRISTOL, RI 02809

GRABOWSKI, PETER C & ELLE
3 FALES ROAD
BRISTOL, RI 02809

MELLO, ROBERT W JR. ETUX
MELLO, DONNA A.
16 HILLSIDE RD
BRISTOL, RI 02809

CALVERT, STEVEN L. & PATRI
41 BROOKWOOD RD
BRISTOL, RI 02809

HENRIE, AMY LIPTON &
ALEXANDER O'GORMAN TE
15 LORING RD
BRISTOL, RI 02809

MELLOR, MICHAEL
MELLOR, MARY C TE
403 W 1ST ST #202
S BOSTON, MA 02127

CAMPBELL SANDRA L
1 SHORE RD
BRISTOL, RI 02809

JONES, PAUL T. JR & JONES
15 CURTIS RD
BRISTOL, RI 02809

PENATZER, JOHN JR & NEWTO
33 FALES RD
BRISTOL, RI 02809

CONNELL, ROBIN D. &
CONNELL, BYRON J. III, TR
11 FALES RD
BRISTOL, RI 02809

KRUSHNOWSKI, ERIC JOHN &
9 FENMORE RD
BRISTOL, RI 02809

PERRY, SCOTT M. JR & JESS
14 FALES RD
BRISTOL, RI 02809

CROCKER, STEVEN E TRUSTEE
SEVEN E CROCKER LIVING TR
32 LORING RD
BRISTOL, RI 02809

LEESER, DANIEL L & LILLIA
LILLIAN C LEESER FAMILY T
11 CRESTWOOD DR
FRAMINGHAM, MA 01701

PLOHR, BRADLEY
4 COX CT
BRISTOL, RI 02809

CRYAN, JOHN J &
CRYAN, KAREN L TE
17 BROOKWOOD RD
BRISTOL, RI 02809

LUTTMANN, SEAN S. TRUSTEE
19 BROOKWOOD RD
BRISTOL, RI 02809

POLULAK, MYRON & JOANN TE
16 BROOKWOOD RD
BRISTOL, RI 02809

DAUBENEY, GLENN A.
MARIA
30 LORING RD
BRISTOL, RI 02809

MARISCAL, JUAN
8 CURTIS RD
BRISTOL, RI 02809

RIGAMONTI, GIANFRANCO-TRU
GIANFRANCO RIGAMONTI REV
31 BROOKWOOD RD
BRISTOL, RI 02809

DAUBENEY, KEITH A
9 CURTIS ST
BRISTOL, RI 02809

MARTIN, CARLA A TRUSTEE
HEATHER A MARTIN IRREVOCA
270 NEWLAND AVE
WOONSOCKET, RI 02895

RINALDI, RICHARD &
RINALDI, EILEEN TRUSTEES
80 SHERRY AVE
BRISTOL, RI 02809

FERREIRA, PAULA E.
52 JENNYS LANE
BARRINGTON, RI 02806

MCCABE, MARION L.
10 FALES RD
BRISTOL, RI 02809

SCHULZE, ROBERT M. &
SCHULZE, MICHELLE T. TRUS
P.O. BOX 46
BRISTOL, RI 02809

SCHULZE, ROBERT M. & SCHU
P.O. BOX 46
BRISTOL, RI 02809

SIMMONS, VIRGINIA TRUST
17 LORING RD
BRISTOL, RI 02809

SOUSA, JOSEPH
4 CURTIS RD
BRISTOL, RI 02809

SWINNEY, JEFFREY D. &
SWINNEY, ANNE E. TRUSTEES
35 BROOKWOOD RD
BRISTOL, RI 02809

TO, KING W. TRUSTEE
18 BROOKWOOD RD
BRISTOL, RI 02809

TO, KING W. TRUSTEE
26 BROOKWOOD RD
BRISTOL, RI 02809

TOYE, MARY P
32 BROOKWOOD RD
BRISTOL, RI 02809

ZAYDON, PAUL TRUSTEE &
BISSETT, AMELIA TRST TC
40 LORING RD
BRISTOL, RI 02809