

ORDINANCE NO. 5-7-2026-14

AN ORDINANCE OF THE TOWN COUNCIL OF THE TOWN OF BRISTOL, INDIANA AMENDING ORDINANCE 3-19-2026-05 TO CORRECT THE LEGAL DESCRIPTION OF TERRITORY VOLUNTARILY ANNEXED INTO THE TOWN OF BRISTOL, INDIANA

WHEREAS, the Town of Bristol, Indiana (the “Town”) is a duly formed municipal corporation within the State of Indiana governed by its duly elected Town Council (the “Council”); and

WHEREAS, on March 19, 2026, the Council adopted Ordinance No. 3-19-2026-05 (the “Annexation Ordinance”) annexing seven (7) parcels located at County Road 14, Bristol, Indiana, Washington and Jefferson Townships, Elkhart County, Indiana and identified in the Elkhart County, Indiana property records as Parcel Numbers 20-07-04-101-001.000-019, 20-03-32-300-003.000-030, 20-03-32-300-007.000-030, 20-03-32-400-002.000-030, 20-03-32-400-003.000-030, 20-07-05-100-004.000-019, 20-07-05-200-004.000-019, consisting of approximately 529 acres (the “Annexation Territory”), into the corporate boundaries of the Town, pursuant to the Annexation Ordinance; and

WHEREAS, following the adoption of the Annexation Ordinance, the Town was notified that the legal description for the Annexation Territory attached as Exhibit A to the Annexation Ordinance was incorrect due to a scrivener’s error in the legal description; and

WHEREAS, the Council confirms that the Annexation Ordinance was intended to annex the Annexation Territory as depicted on the map attached as Exhibit B to the Annexation Ordinance and as generally referenced by parcel numbers and acreage in the Annexation Ordinance, and that this Ordinance is intended solely to correct the legal description attached as Exhibit A to the Annexation Ordinance and not to alter the territory annexed; and

WHEREAS, the Council now desires to amend the Annexation Ordinance as set forth herein.

NOW, THEREFORE, BE IT ORDAINED by the Town Council of the Town of Bristol, Indiana, as follows:

- Section 1. The foregoing Recitals are fully incorporated herein by this reference.
- Section 2. Exhibit A of the Annexation Ordinance is hereby deleted in its entirety and replaced with Exhibit A attached hereto, which corrected legal description is intended to accurately reflect the territory annexed by the Annexation Ordinance and does not expand or otherwise modify the Annexation Territory.
- Section 3. The effective date of the Annexation Ordinance shall remain unchanged, and this Ordinance is intended solely as a corrective clarification of the legal description.

Section 4. Except as modified by this Ordinance, all provisions of the Annexation Ordinance shall remain in full force and effect.

Section 5. This Ordinance shall be in full force and effect from and after its passage in accordance with Indiana law.

* * * * *

ORDAINED BY THE TOWN COUNCIL OF THE TOWN OF BRISTOL, INDIANA,
ON THIS 7th DAY OF MAY, 2026.

TOWN COUNCIL OF THE
TOWN OF BRISTOL, INDIANA

Jeff Beachy, President

Cathy Burke

Gregg Tuholski

Doug DeSmith

[vacant]

ATTEST:

Cathy Antonelli, Clerk-Treasurer

KD_25148441_1.docx

EXHIBIT A
LEGAL DESCRIPTION OF ANNEXED TERRITORY

[Attached]

Exhibit 'A'

Project: Legal Description Kauffman Annexation

Page 1 of 2

Parcel ID: 20-03-32-300-003.000-030
20-03-32-300-007.000-030
20-03-32-400-002.000-030
20-03-32-400-003.000-030
20-07-05-100-004.000-019
20-07-05-200-004.000-019
20-07-04-101-001.000-109

All that of Section 5 and Section 6, Township 37 North Range 6 East, Jefferson Township, Elkhart County, Indiana; and that portion of Section 32, Township 38 North Range 6 East, Washington Township, Elkhart County, Indiana, described as follows;

Commencing at the Southwest corner of said Section 5; thence, North on the West line of said Section 5, 3,990.0 feet to the point of beginning; thence, continuing North on the West line of said Section 5, 764.58 feet; thence, South 89 degrees 43 minutes 18 seconds East 520.0 feet; thence, North parallel to the West line of said Section 5, 260.0 feet to the North line of said Section 5; thence, North 89 degrees 43 minutes 18 seconds West on the North line of said Section 5 520.0 feet to the Northwest corner of said Section 5 also the Southwest corner of Section 32, Township 38 North Range 6 East; thence, North on the West line of said Section 32 to the North line of the South half of the Southwest Quarter of said Section 32; thence, East on said North line to the West line of the Southeast Quarter of said Section 32; thence, North on said West line of said Section 32 to the South line of the recorded plat of Earthway Rail Park Phase IV (instrument no. 2021-10336, Elkhart County Recorder's Office); thence, South 89 degrees 23 minutes 47 seconds East on said South line, 2,653.59 feet to the East line of the Southwest Quarter of said Section 32; thence, South 0 degrees 3 minutes 41 seconds East along said East line, 1,905.20 feet to the North line of Section 4, Township 37 North Range 6 East; thence, South 89 degrees 14 minutes 00 seconds East 1,338.15 feet; thence, South 0 degrees 39 minutes 00 seconds West; thence, 1,068 feet to an iron stake in the centerline of County Road 14; thence, North 44 degrees 37 minutes 00 seconds West 28.44 feet; thence, North 89 degrees 14 minutes 00 seconds West 592.0 feet; thence, North 206.45 feet; thence, North 89 degrees 33 minutes 00 seconds West 714.29 feet to the East line

of Section 5, Township 37 North Range 6 East; thence, South 00 degrees 27 minutes 51 seconds East on said East line 2,258 feet (more or less) to a point 36.37 feet South of the Northwest corner¹ of lot 32 of the recorded plat of Whispering Valley Second, Elkhart County Recorders Office, Plat Book 12, Page 71; thence, West 656.94 feet; thence, South 00 degrees 05 minutes 15 seconds East 601.0 feet; thence, North 89 degrees 24 minutes 22 seconds West, 703.16 feet; thence, South 00 degrees 04 minutes 35 seconds East 1,371.20 feet to the South line of said Section 5; thence, North 89 degrees 19 minutes 54 seconds West on said South line, 448.27 feet; thence, North 00 degrees 40 minutes 06 seconds East, 350 feet; thence, North 89 degrees 19 minutes 54 seconds West 833.45 feet; thence, South 00 degrees 40 minutes 06 seconds West 350 feet to the South line of said Section 5; thence, North 89 degrees 19 minutes 54 seconds West on said South line 50.0 feet; thence, North 0 degrees 06 minutes 07 seconds West 3,982.02 feet; thence, North 89 degrees 12 minutes 59 seconds West 2,645.22 feet to the place of beginning.

Containing 533.5 Acres, more or less.

Subject to Easements of Record.

Subject to survey.

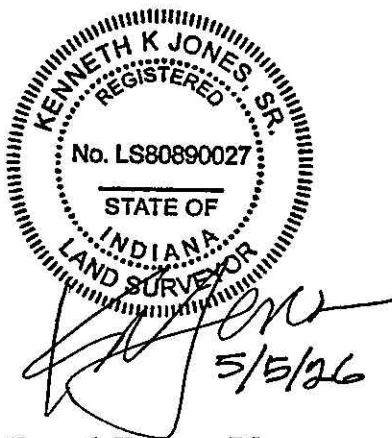

By: Kenneth K. Jones, PS
Date: March 18, 2026

Firm: Jones Petrie Rafinski
Job Number: 2026-00028