



## CITY COUNCIL AGENDA REPORT

**Meeting Date:** March 20, 2025

**From:** Noreen Leek, Parks & Recreation Director

**Subject:** Alvarado to San Benito Stairway Public Art Final Designs

### **Community Goal/Result**

Community Building

### **Purpose**

To increase citizens' appreciation of art, improve quality of life, and to enhance Brisbane's identity as a unique community within the greater Bay Area.

### **Recommendation**

Consider approval of the final designs from Angelina Duckett and McGrath Arts for public art on the stairway of Alvarado to San Benito.

### **Background**

In September 2024, the City Council approved the Public Art Committee's recommendation to publish an RFP soliciting proposals for a public art project at the stairway between Alvarado and San Benito. A total of nineteen (19) responsive proposals were received from a variety of artists. The Public Art Advisory Committee reviewed proposals and considered the issues of long-term conservation and maintenance of the art to ensure that the designs were durable, safe, and high-quality. They also considered the mission statement and selection criteria that were drafted as part of the master planning process. They voted unanimously to recommend two artists for the project: Angelina Duckett and McGrath Arts. Angelina Duckett would be responsible for creating a mosaic on the risers of the stairway. McGrath Arts would be responsible for designing lighting, handrails, and stairway landing panels that are artistic in nature. The City Council awarded both artist contracts on November 21, 2024.

### **Discussion**

The Public Art Committee met with the artists over the past few months and, alongside the artists, explicitly invited public input at their meeting on January 21, 2025. They reviewed conceptual designs, considered materials, and discussed compliance with City building codes and the City's dark-sky ordinance. After providing input on the artwork, the Public Art Advisory Committee voted unanimously to recommend the designs (Attachments 1 and 2) to the City Council. If the Council does not approve the proposed designs, it can refer the item back to the Public Art Advisory Committee for reconsideration.

### **Fiscal Impact**

Funding to support this project has already been approved and allocated by the City Council using funds that are available within the Public Art Fund (Fund 275). There is no additional fiscal impact resulting from this staff report.

**Attachments**

1. McGrath Arts Final Design Proposal
2. Angelina Duckett Final Design Proposal



---

Noreen Leek, Parks & Recreation Director

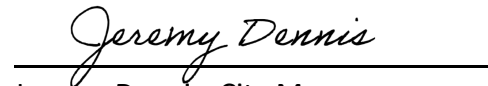

---

Jeremy Dennis, City Manager

**ALVARADO ST. TO SAN  
BENITO RD. STAIRCASE**

Final Design, Budget and Related  
Documents Phase

Brisbane, CA

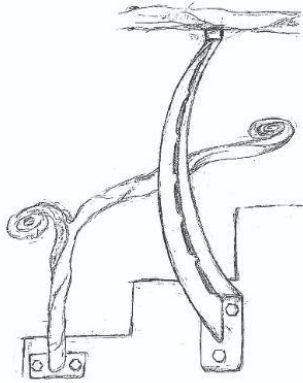

- **Type I Railings** 36" height are 1.25" Hammer twist tube
- Curved posts constructed from .25" plate, welded t post style.
- Posts are spaced 48" apart
- Children's grab bars constructed from 1" hammer twist with rolled ends, placed intermittently
- All posts are fascia mounted with stainless steel hardware with epoxy/anchor bolts

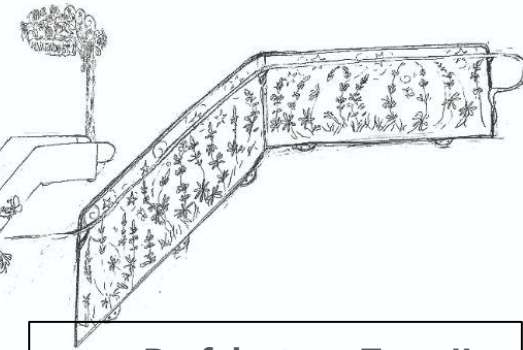

- **All metal work** will be smoothed to dull sharp protrusions/hazards
- Hot dip galvanizing
- Color will be durable enamel
- Coated with clear epoxy

- **Type II Railings** 42" tall have three zones and themes: Bay Laurel, Coast Live Oak, and Lupine
- Constructed of a combination of cut and textured 10 ga sheet metal with some forged elements attached
- Will have the names of the plants/butterflies cut out

- **Prefab steps Type II rail**
- Made from cut out sheet metal and some forged elements
- continued hammer twist hand rail on East Side.
- Will need specs prior to designing how we would mount it to the stairs

- **Luminary Sign Post** 9' tall made from 4" steel tubing and textured metal
- Mounted to 3/8" steel plate with gussets with artist signature and date
- South entrance is Morning Glory on the right, sign says "San Benito Rd." and arrow
- North entrance is Buckeye on the right says "Alvarado St." and arrow
- 24" footing with wet set anchor bolts - we will provide mounting template/ bracket
- DC transformer compartment
- 2700 K LED lights (facing down)
- Sign will be made from textured metal with mounted letters

- **Floral Pathway Lights** are 40" tall
- Proximity detector is a possibility
- Unique plants: CA Poppy, CA Fuschia, CA Wild Rose, Blue Nightshade, Douglas Iris, and Yarrow
- Mounted to 18-20" granite boulders
- 2700 LED downcast, or if facing up, there will be a butterfly on it to block the light.

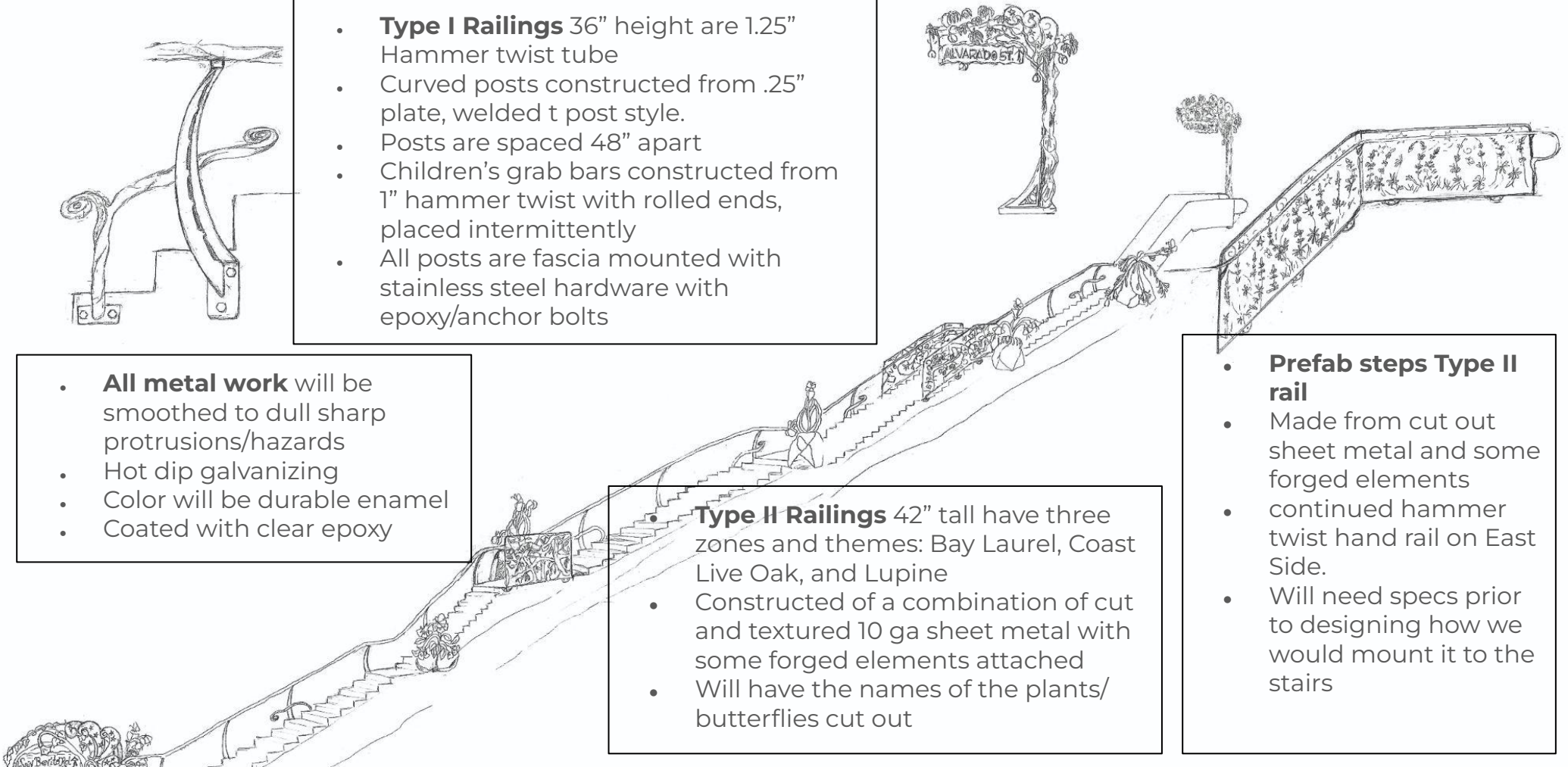

San Benito Rd

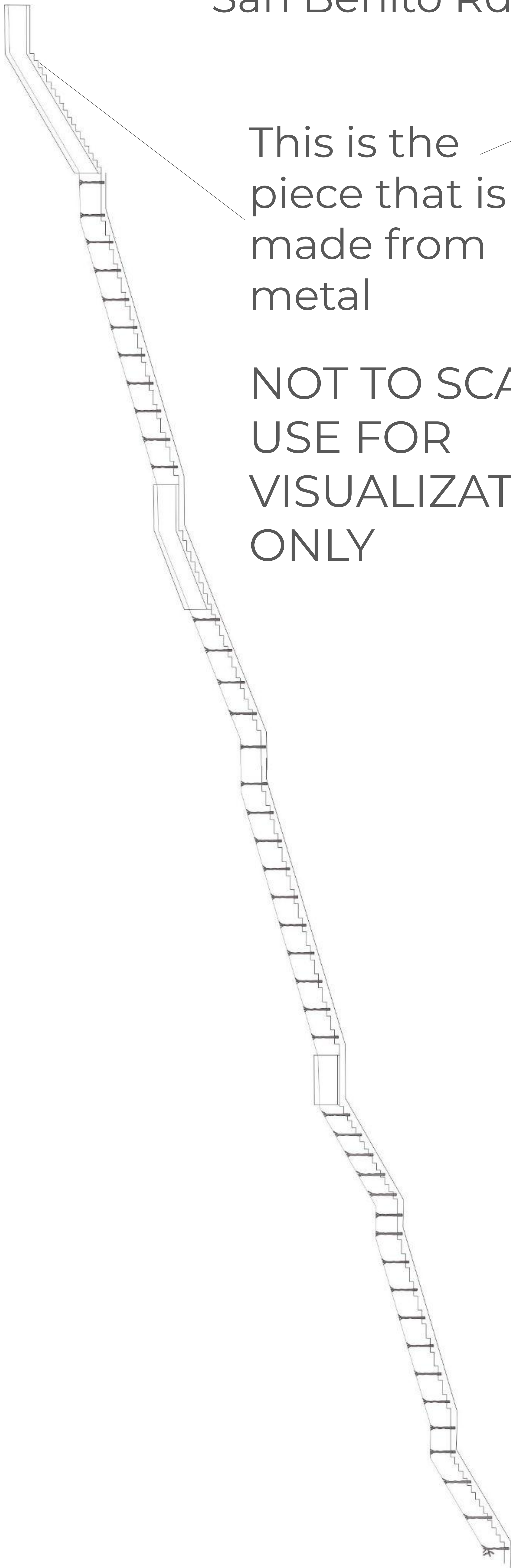

This is the  
piece that is  
made from  
metal

NOT TO SCALE  
USE FOR  
VISUALIZATION  
ONLY

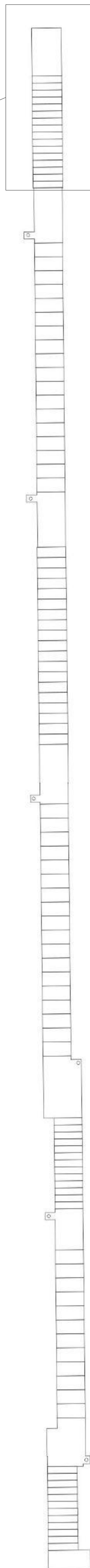

Alvarado Street



## TYPES I AND II HANDRAILS

➤ Hammer Twist pipe handrail

➤ Typical Posts for type I handrails  
➤ Fascia mounted

➤ Textured sheet metal tree trunks on Type II

➤ Leafy infill  
➤ Can discuss using other things such as scrolls, curves, and/or words  
➤ We will need to discuss collaboration with Angelina

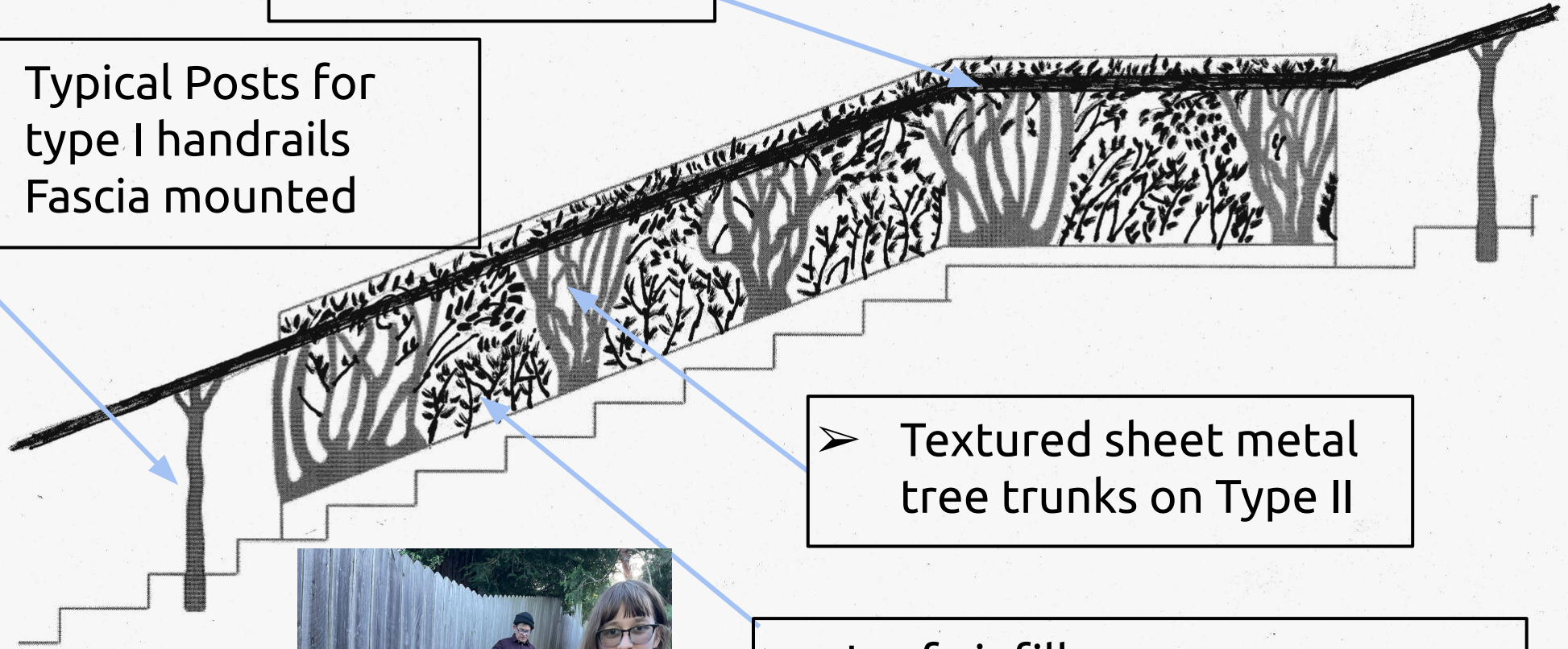

## TYPE II RAILINGS



Sample of textured metal trunks for the guard rails. They will be different types of trees on the 5 type II railings. We will be featuring oak, bay, buckeye, as well as flowers such as Lupine and CA Poppy. We will also include the Elfin and Mission Blue Butterfly. These panels will be designed once we see what kind of motifs are included in the mosaic panels.



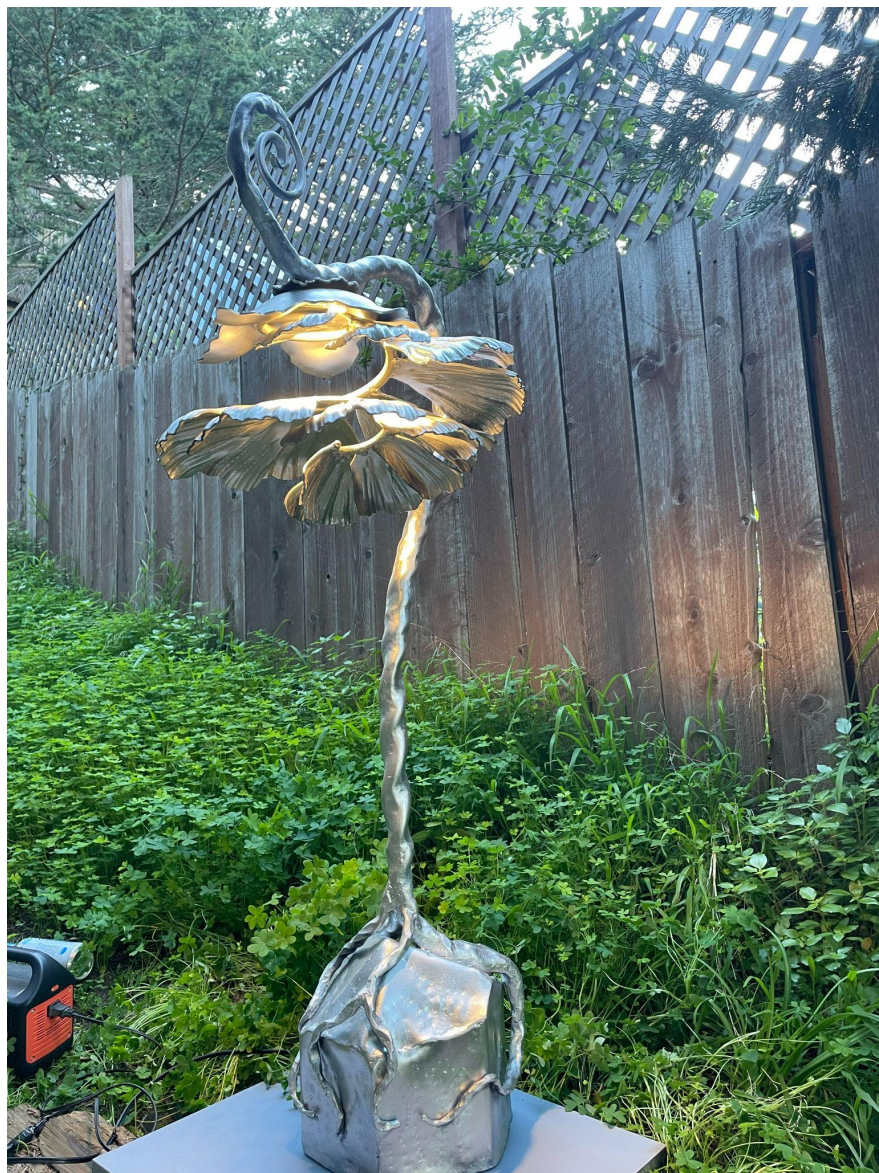

## FLORAL LIGHTED SCULPTURES

Template not to scale

We will provide these cut out in metal with our anchor bolts so that they can be wet set in the concrete.



**LUMINARY SIGNPOST  
NORTH**

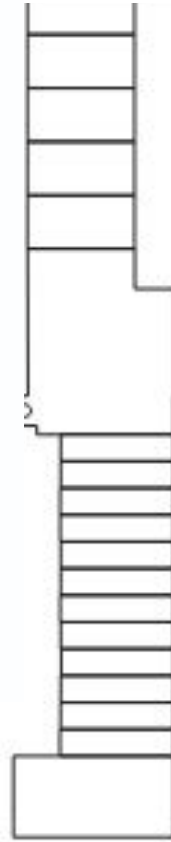

Alvarado St.

**LUMINARY SIGNPOST  
SOUTH**

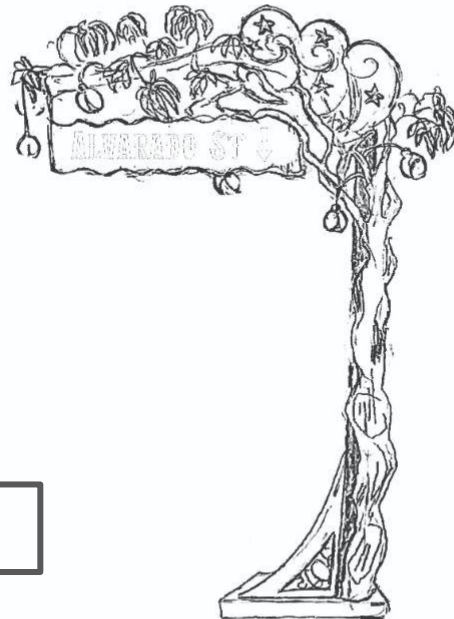
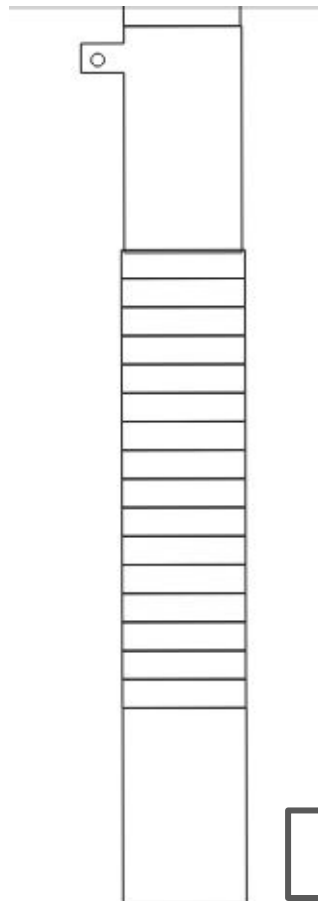

San Benito Rd.

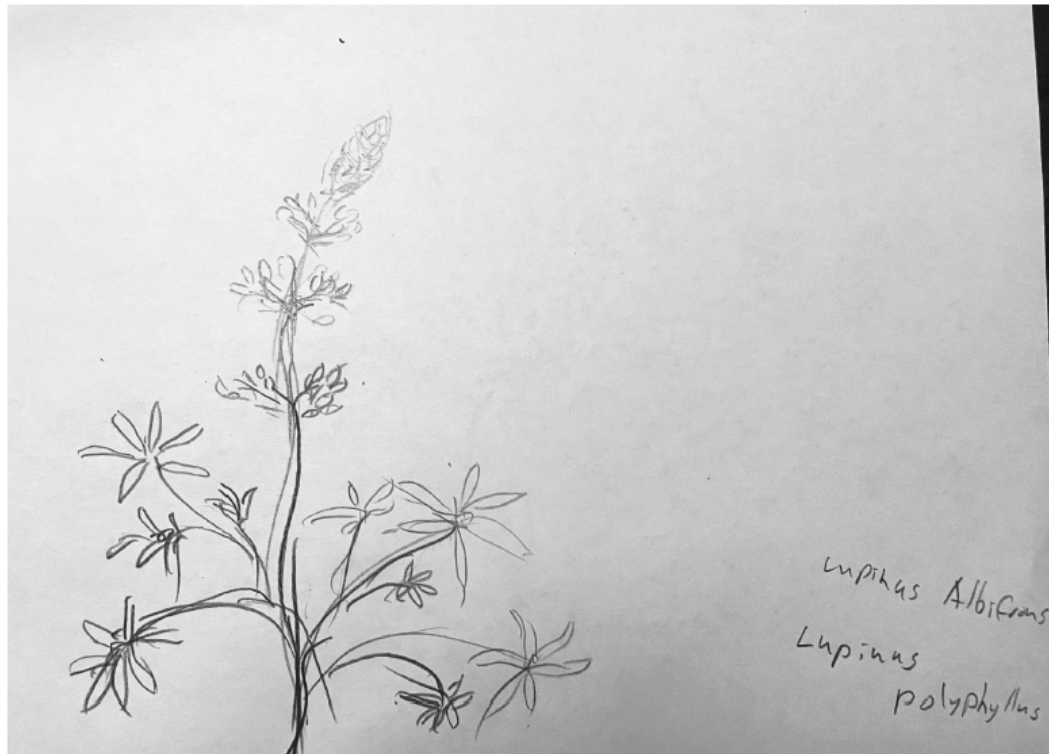



# ANGELINA DUCKETT MOSAICS

ARTIST: Angelina Duckett Mosaics  
655 32<sup>nd</sup> Avenue  
San Francisco, Ca 94121

## 1) PROJECT DESCRIPTION

Located in the City of Brisbane a new stairway will be constructed (Alvarado to San Benito) along a 12' wide property. The mosaic artwork will cover the concrete risers of the stairway which is expected to be 96 risers of 7" each in height with a variety of widths (12"/18"/24").

## 2) MATERIALS

Materials include:

Tile, adhesive, fiberglass mesh, tile tape, safety equipment supplies, thin set, grout.

All material used in the mural will be appropriate for exterior use. Professional grade cement based, polymer modified adhesive will be used to set the mosaic and all joints will be grouted with sanded, polymer modified grout intended for exterior applications.

A selection of vibrant colors is presented below, with a broader range to be integrated into the design elements, and subject to availability.











