

Z:\25\25\25\25\ENGINEERING\DRAWINGS\CONSTRUCTION PLANS\C4 PLANS\25\25\0004 - COWIC - New 19, 2021 - 7:09 AM

Z:\25\25\25\25\ENGINEERING\DRAWINGS\CONSTRUCTION PLANS\C4 PLANS\25\25\0004 - COWIC - New 19, 2021 - 7:09 AM

Z:\25\25\25\25\ENGINEERING\DRAWINGS\CONSTRUCTION PLANS\C4 PLANS\25\25\0004 - COWIC - New 19, 2021 - 7:09 AM

Z:\25\25\25\25\ENGINEERING\DRAWINGS\CONSTRUCTION PLANS\C4 PLANS\25\25\0004 - COWIC - New 19, 2021 - 7:09 AM

Z:\25\25\25\25\ENGINEERING\DRAWINGS\CONSTRUCTION PLANS\C4 PLANS\25\25\0004 - COWIC - New 19, 2021 - 7:09 AM

Z:\25\25\25\25\ENGINEERING\DRAWINGS\CONSTRUCTION PLANS\C4 PLANS\25\25\0004 - COWIC - New 19, 2021 - 7:09 AM

Z:\25\25\25\25\ENGINEERING\DRAWINGS\CONSTRUCTION PLANS\C4 PLANS\25\25\0004 - COWIC - New 19, 2021 - 7:09 AM

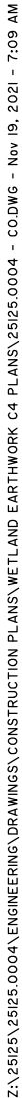
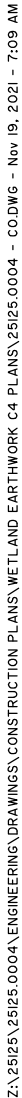
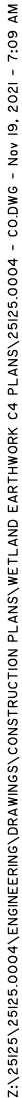

Z:\25\25\25\25\ENGINEERING\DRAWINGS\CONSTRUCTION PLANS\C4 PLANS\25\25\0004 - COWIC - New 19, 2021 - 7:09 AM

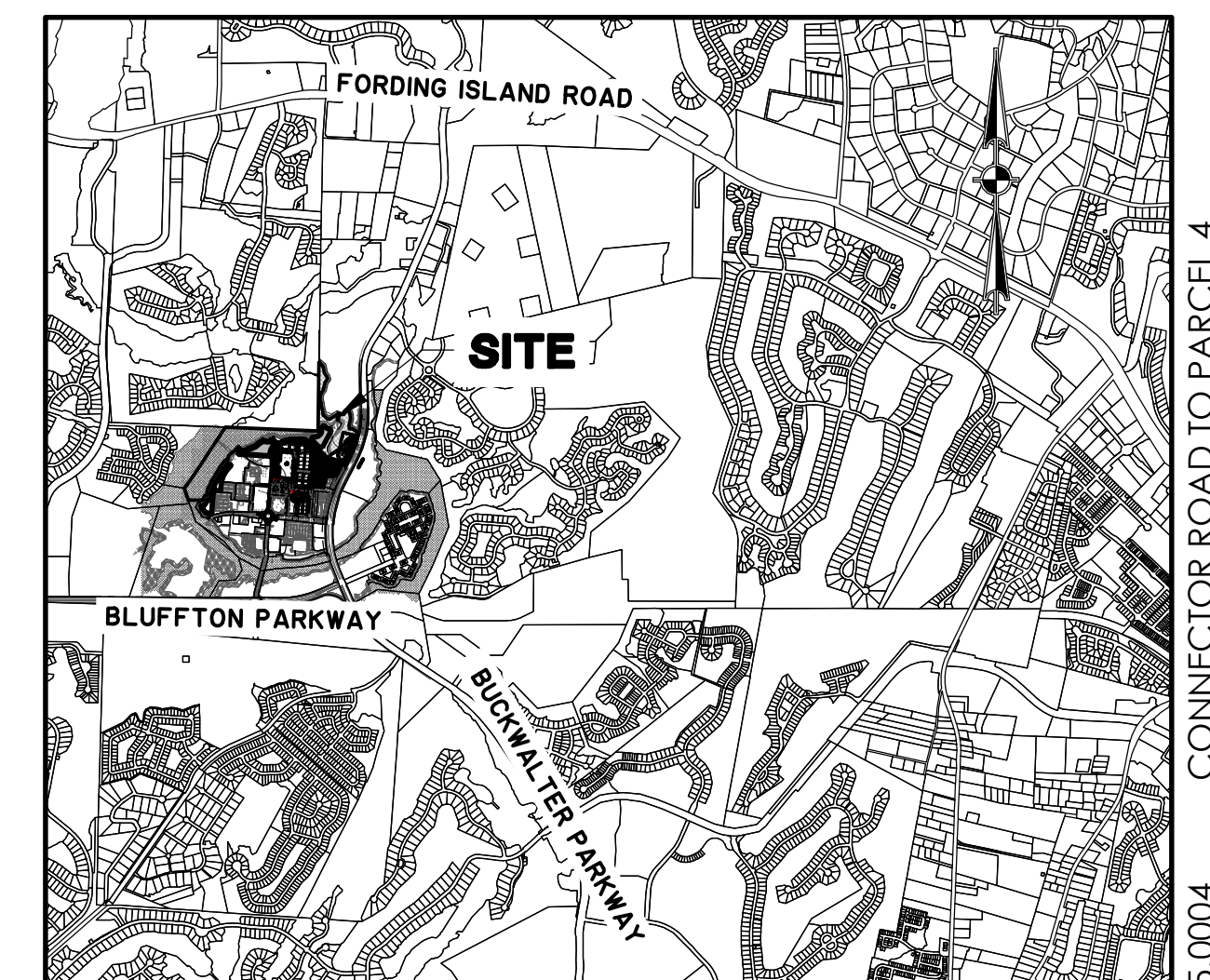
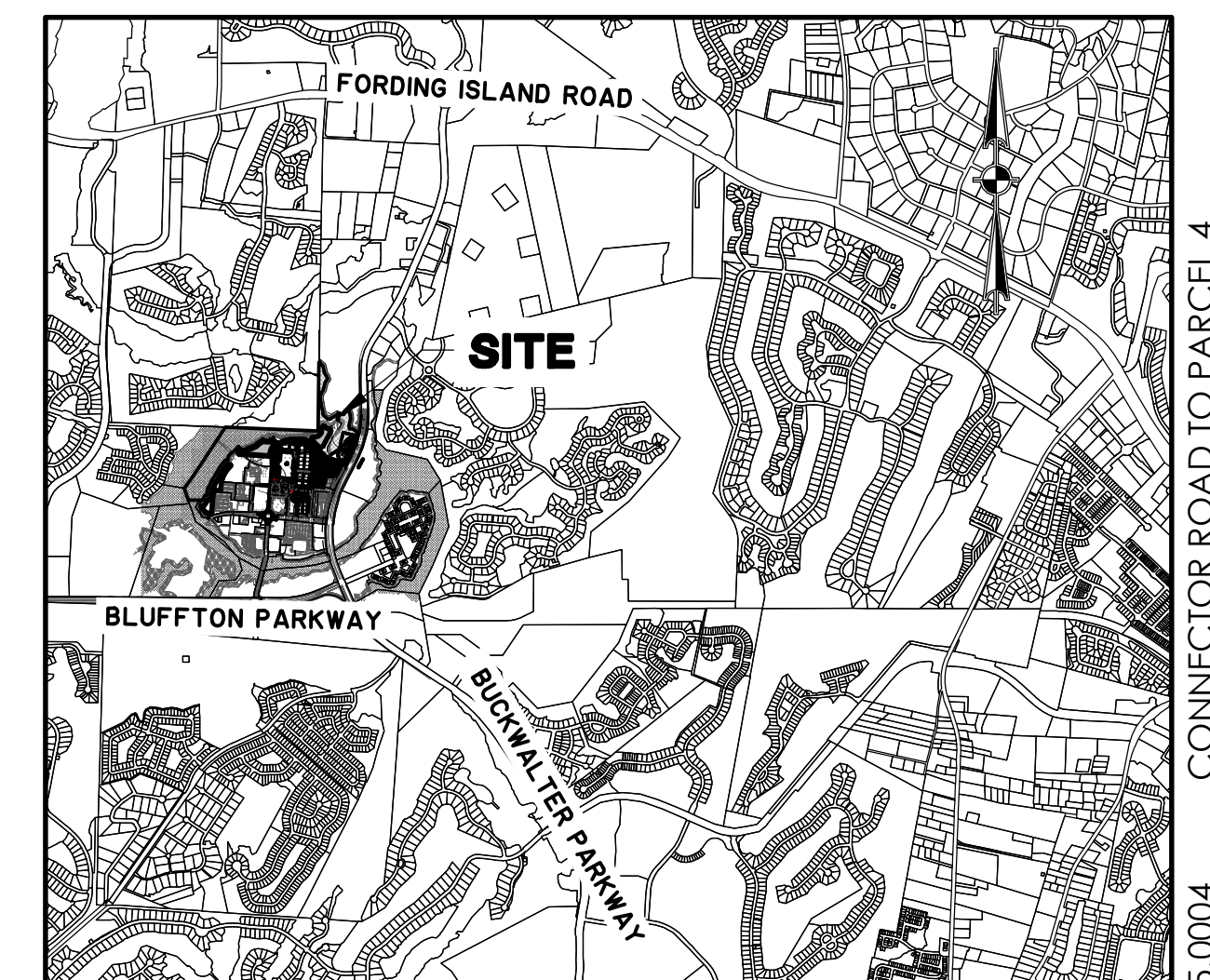
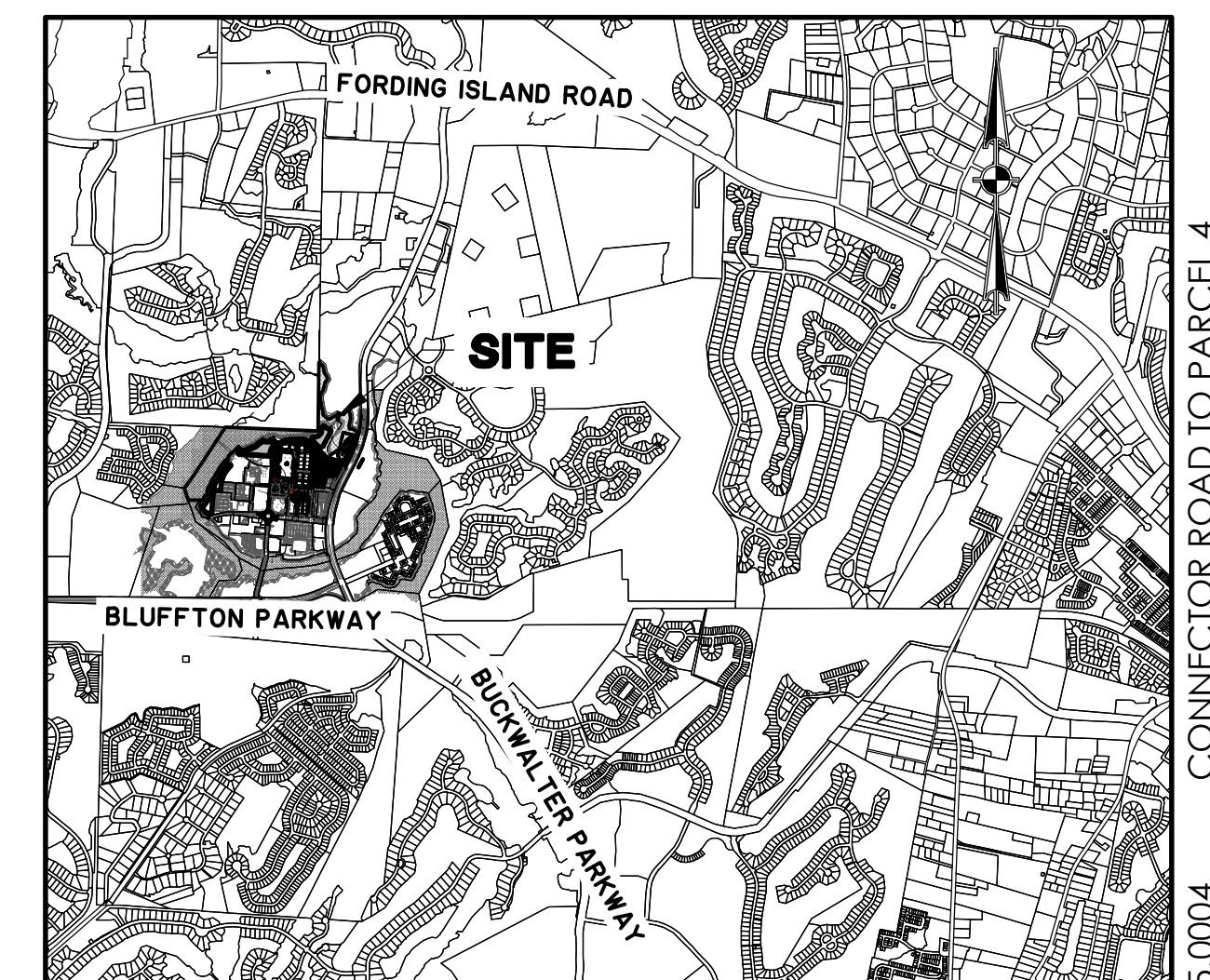

Z:\BIDD\2024\0004\ENGINEERING\DRAWINGS\CONSTRUCTION\PLANS\WETLAND\CAFTWORK\G1.1\WETLAND\CAFTWORK\G1.1.dwg - Nov 16, 2021 - 7:09 AM

ABBREVIATIONS

HDPE	HIGH DENSITY POLYETHYLENE	FR	FRAME	RCP	REINFORCED CONCRETE PIPE
BOT	BOTTOM	GB	GRADE BREAK	RJP	RESTRAINED JOINT PIPE
BFS	BEGIN FULL SUPER	GI	GRATE INLET	R/W	RIGHT-OF-WAY
BNC	BEGIN NORMAL CROWN	GV	GATE VALVE	RC	REVERSE CROWN
BNS	BEGIN NORMAL SHOULDER	INV	INVERT ELEVATION	SD	STORM DRAINAGE
BV	BUTTERFLY VALVE	JB	JUNCTION BOX	SDMH	STORM DRAINAGE MANHOLE
CI	CURB INLET	LF	LINEAR FEET	SF	SQUARE FEET
CV	CHECK VALVE	LC	LEVEL CROWN	SS	SANITARY SEWER
CPP	CORRUGATED PLASTIC PIPE	LSM	LOW SHOULDER MATCH	TC	TOP OF CONCRETE
DIP	DUCTILE IRON PIPE	MAX	MAXIMUM	TG	TOP OF GRAVEL
EL	ELEVATION	MIN	MINIMUM	TP	TOP OF PAVEMENT
EFS	END FULL SUPER	MH	MANHOLE	SW	TOP OF SIDEWALK
ENC	END NORMAL CROWN	OC	ON CENTER	TYP	TYPICAL
ENS	END NORMAL SHOULDER	PC	POINT OF CURVE	W	WATER
EOA	END OF ALIGNMENT	PH	POST HYDRANT	W/	WITH
FG	FINISH GRADE	PT	POINT OF TANGENT	WV	WATER VALVE
FH	FIRE HYDRANT	PVC	POLYVINYL CHLORIDE	YI	YARD INLET
FM	FORCE MAIN (SANITARY SEWER)	PV	PLUG VALVE		

WATER LEGEND

DESCRIPTION	EXISTING	PROPOSED
WATER MAIN	10" W	10" W
SINGLE SERVICE LATERAL		
DOUBLE SERVICE LATERAL		
VALVE AND BOX		
FIRE HYDRANT W/VALVE & BOX		
POST HYDRANT		
REDUCER		
BACKFLOW PREVENTOR		
CROSS		
TEE		
90° BEND - HORIZONTAL		
45° BEND - HORIZONTAL		
22-½° BEND - HORIZONTAL		
11-¼° BEND - HORIZONTAL		
BEND - VERTICAL		
CAP		

SEWER LEGEND

DESCRIPTION	EXISTING	PROPOSED
GRAVITY PIPE	SS	
SINGLE SERVICE LATERAL		
DOUBLE SERVICE LATERAL		
MANHOLE		
CLEANOUT		
FORCEMAIN	10" FM	10" FM
VALVE AND BOX		
FLUSH HYDRANT		
REDUCER		
BACKFLOW PREVENTOR		
CROSS		
TEE		
90° BEND - HORIZONTAL		
45° BEND - HORIZONTAL		
22-½° BEND - HORIZONTAL		
11-¼° BEND - HORIZONTAL		
BEND - VERTICAL		
PLUG		

HATCH LEGEND

SUITABLE ROAD FILL	
WETLAND	
PRESERVED WETLAND BUFFER	

DRAINAGE LEGEND

DESCRIPTION	EXISTING	PROPOSED
PIPE		
DITCH		
CURB INLET		
GRATE INLET		
JUNCTION BOX		
OUTLET STRUCTURE		

- BOUNDARY AND TOPOGRAPHIC INFORMATION PROVIDED BY THOMAS AND HUTTON. ALL TOPOGRAPHIC INFORMATION IS BASED ON AVAILABLE LIDAR DATA USING NAVD88 VERTICAL DATUM. COORDINATES ARE BASED ON THE SOUTH CAROLINA STATE PLANE COORDINATE SYSTEM OF NAD 1983. VERIFY CHANGES IN ELEVATIONS IN ROADBEDS AND OTHER AREAS RESULTING FROM CONTRACTOR CLEARING AND STRIPPING.
- SEE SURVEY CONTROL PLAN FOR BENCHMARKS. HORIZONTAL AND VERTICAL CONTROL SHOWN IN THESE PLANS ARE TO BE USED FOR ALL LAYOUT AND RECORD DATA FOR THIS PROJECT. IF DISCREPANCIES ARE FOUND CONTACT THOMAS AND HUTTON BEFORE PROCEEDING. IT IS THE CONTRACTOR'S RESPONSIBILITY TO ESTABLISH SUPPLEMENTAL CONTROL WITHIN THE PROJECT AS NEEDED. CONTRACTOR IS TO VERIFY ACCURACY OF ANY TEMPORARY BENCHMARKS SHOWN PRIOR TO UTILIZING THEM FOR CONSTRUCTION.
- THE EXISTING UNDERGROUND UTILITIES SHOWN HEREON ARE BASED UPON AVAILABLE INFORMATION. THE CONTRACTOR SHALL BE RESPONSIBLE FOR DETERMINING THE EXACT LOCATION OF ALL UTILITIES ENCOUNTERED DURING CONSTRUCTION. CONTRACTOR SHALL COORDINATE ALL WORK WITH THE OWNER AND UTILITY COMPANIES. THE CONTRACTOR SHALL NOTIFY THE ENGINEER IMMEDIATELY WITH ANY DISCREPANCIES AND TAKE STEPS TO PROTECT THE LINE(S) AND ENSURE CONTINUED SERVICE. DAMAGE CAUSED TO EXISTING UTILITIES BY THE CONTRACTOR SHALL BE REPAIRED BY THE CONTRACTOR AT NO ADDITIONAL COST. ADDITIONALLY, THE CONTRACTOR SHALL CONFIRM THE CONNECTION POINTS OF NEW UTILITIES TO EXISTING UTILITIES PRIOR TO BEGINNING NEW CONSTRUCTION.
- CONTRACTOR SHALL VERIFY EXISTING UTILITY ELEVATIONS AND INVERTS BEFORE STARTING WORK. THE CONTRACTOR SHALL NOTIFY ENGINEER IMMEDIATELY WITH DISCREPANCIES AND AWAIT WRITTEN RESPONSE FROM ENGINEER PRIOR TO PROCEEDING WITH INSTALLATION. EXISTING FRAMES, WITHIN DISTURBED LIMITS, SHALL BE ADJUSTED TO PROPOSED GRADES.
- SHOULD PIPE, FITTINGS, AND OTHER MATERIALS BE NEEDED IN ADDITION TO THAT SHOWN ON THE DRAWINGS BECAUSE PIPELINE WAS NOT INSTALLED TO THE ALIGNMENT AND PROFILE SHOWN, THEN THE CONTRACTOR IS RESPONSIBLE FOR OBTAINING THOSE NECESSARY MATERIALS AND PROVIDING THE EQUIPMENT AND LABOR TO INSTALL THEM TO MEET THE DESIGN INTENT OF THE WATER MAIN AT NO ADDITIONAL COST TO THE OWNER.
- THE CONTRACTOR SHALL NOTIFY THE OWNER AND THE ENGINEER 48 HOURS IN ADVANCE OF ALL REQUIRED TESTS AND OBSERVATIONS.
- ALL WATER USED FOR CONSTRUCTION SHALL BE METERED THROUGH AN ACCEPTABLE BACK FLOW PREVENTION DEVICE AND FIRE HYDRANT METER.
- REFER TO EROSION CONTROL SHEETS FOR NOTES REGARDING EROSION AND SEDIMENTATION CONTROL.
- ALL SIGNAGE AND STRIPING SHALL BE COMPLETED PER SCDOT STANDARDS.
- ALL TRAFFIC CONTROL SIGNS AND PAVEMENT MARKINGS SHALL BE IN ACCORDANCE WITH THE MANUAL ON "UNIFORM TRAFFIC CONTROL DEVICES FOR STREETS AND HIGHWAYS" AND "SOUTH CAROLINA MANUAL ON UNIFORM TRAFFIC CONTROL DEVICES" BOTH CURRENT EDITIONS.
- ALL MATERIALS AND ACCESSORIES SHALL, UNLESS OTHERWISE DIRECTED, BE UNLOADED AND STORED WHERE THEY WILL BE PROTECTED AND WILL NOT BE HAZARDOUS TO TRAFFIC. THEY SHALL, AT ALL TIMES, BE HANDLED WITH CARE TO AVOID DAMAGE. THE INTERIOR OF ALL PIPES, FITTINGS, AND OTHER ACCESSORIES SHALL BE KEPT FREE FROM DIRT AND FOREIGN MATTER AT ALL TIMES. CLEAN THE INTERIOR OF ALL PIPES BY BRUSHING, SWABING OR WASHING OUT BEFORE LAYING.
- CONTRACTOR SHALL FLUSH ALL INLETS AND PIPE AT THE COMPLETION OF CONSTRUCTION TO REMOVE SILT AND DEBRIS. THE CLEANING AND FLUSHING OF INLETS AND PIPE (EXISTING AND PROPOSED) SHALL BE CONSIDERED PART OF THE COST FOR PIPE ON THE PROJECT. ALL DRAINAGE SYSTEMS TO WHICH PIPES ARE TO BE CONNECTED SHALL BE FLUSHED.
- BACK FILL NECESSARY FOR THE CONSTRUCTION OF THIS PROJECT SHALL BE PROVIDED BY THE CONTRACTOR FROM ONSITE EXCAVATION SHOWN ON PLANS, OR SOURCES DEVELOPED BY THE CONTRACTOR AND CONFORMING TO THE CONTRACT SPECIFICATIONS. CONTRACTOR IS RESPONSIBLE FOR EXCAVATION, HAULING AND PLACING THE FILL AS SHOWN ON THE PLANS. GEOTECHNICAL CONSULTANT SHALL DETERMINE IF FILL MATERIALS ARE SUITABLE FOR FILL AREAS.
- ALL ITEMS WHICH MUST BE REMOVED BY THE CONTRACTOR DURING CONSTRUCTION, INCLUDING EARTHWORK MATERIAL, AND WHICH ARE NOT SHOWN TO BE PAID FOR OTHERWISE, ARE TO BE REMOVED WITHOUT ADDITIONAL PAYMENT.
- CONTRACTOR SHALL PROTECT OR RESET ALL EXISTING MARKERS AND PROPERTY CORNERS PRIOR TO FINAL PAYMENT. ALL REQUIRED MARKERS SHALL BE INSTALLED BY REGISTERED SURVEYOR IN THE STATE OF SOUTH CAROLINA.
- CONTRACTOR TO REMOVE ALL EROSION AND SEDIMENTATION CONTROL DEVICES PRIOR TO FINAL PAYMENT. COSTS FOR REMOVAL OF THESE DEVICES SHALL BE INCLUDED IN THE CORRESPONDING LINE ITEM COST ON THE BID FORM.
- ALL DAMAGE CAUSED BY CONSTRUCTION IS TO BE REPLACED AT THE CONTRACTOR'S EXPENSE.
- IT IS THE OBLIGATION OF THE CONTRACTOR TO MAKE THEIR OWN INTERPRETATION OF ALL SURFACE AND SUBSURFACE DATA AVAILABLE AS TO THE NATURE AND EXTENT OF THE MATERIALS TO BE EXCAVATED, WASTED, GRADED AND COMPACTED. THE INFORMATION SHOWN ON THESE PLANS IN NO WAY GUARANTEES THE AMOUNT OR NATURE OF THE MATERIALS TO BE ENCOUNTERED.
- THE CONTRACTOR SHALL NOT BEGIN CONSTRUCTION UNTIL THE PROPER PERMITS HAVE BEEN OBTAINED.
- THE CONTRACTOR SHALL BE RESPONSIBLE FOR PHASING OF CONSTRUCTION AND THE COORDINATION, SEQUENCING AND SUPERVISION OF CONSTRUCTION ACTIVITIES. ANY AND ALL COSTS ASSOCIATED WITH PROJECT PHASING WILL BE BORNE IN FULL BY THE CONTRACTOR. NO SEPARATE PAYMENT WILL BE MADE FOR ITEMS, MATERIALS OR PERSONNEL NOT SPECIFICALLY LISTED ON THE BID FORM.
- CONTRACTOR SHALL COORDINATE WITH AN OWNER DESIGNATED GEOTECHNICAL CONSULTANT TO ENSURE FILL PLACED IS SUITABLE FOR ROADWAY CONSTRUCTION AND IS PLACED IN LIFTS AS DEEMED APPROPRIATE BY THE GEOTECHNICAL ENGINEER.
- EACH EXISTING ROAD WILL BE CLEANED UP AND RESTORED DAILY. COORDINATE WITH OWNER IF ROADWAY ACCESS CANNOT BE MAINTAINED PRIOR TO PROCEEDING WITH BLOCKAGE.
- FRESHWATER WETLANDS EXIST IN THE PROJECT SITE. CONTRACTOR IS RESPONSIBLE FOR ADHERING TO ALL WETLAND AND WETLAND LINE BUFFERS THROUGHOUT CONSTRUCTION. CONTRACTOR SHALL OBTAIN A COPY OF WETLAND ARMY CORPS PERMIT #2001-IG-122 AND COMPLY WITH ALL REQUIREMENTS LISTED WITHIN WHEN PERFORMING WORK.
- CONTRACTOR SHALL GRADE AREAS TO DRAIN FOR POSITIVE FLOW PRIOR TO FINAL ACCEPTANCE.
- THE TOWN OF BLUFFTON STORMWATER DIVISION SHALL BE NOTIFIED AT LEAST 24 HOURS PRIOR TO ANY DEWATERING ACTIVITIES.
- THE CONTRACTOR SHALL BE RESPONSIBLE FOR ACQUIRING ALL PERMITS AND LICENSES, AS REQUIRED BY BEAUFORT COUNTY AND/OR THE TOWN OF BLUFFTON ORDINANCES.
- CONTRACTOR SHALL NOTIFY OWNER 45 DAYS IN ADVANCE, PRIOR TO BLOCKAGE OF EXISTING ROADWAY, TO ALLOW AMPLE TIME FOR ANY NOTIFICATIONS TO OTHERS.

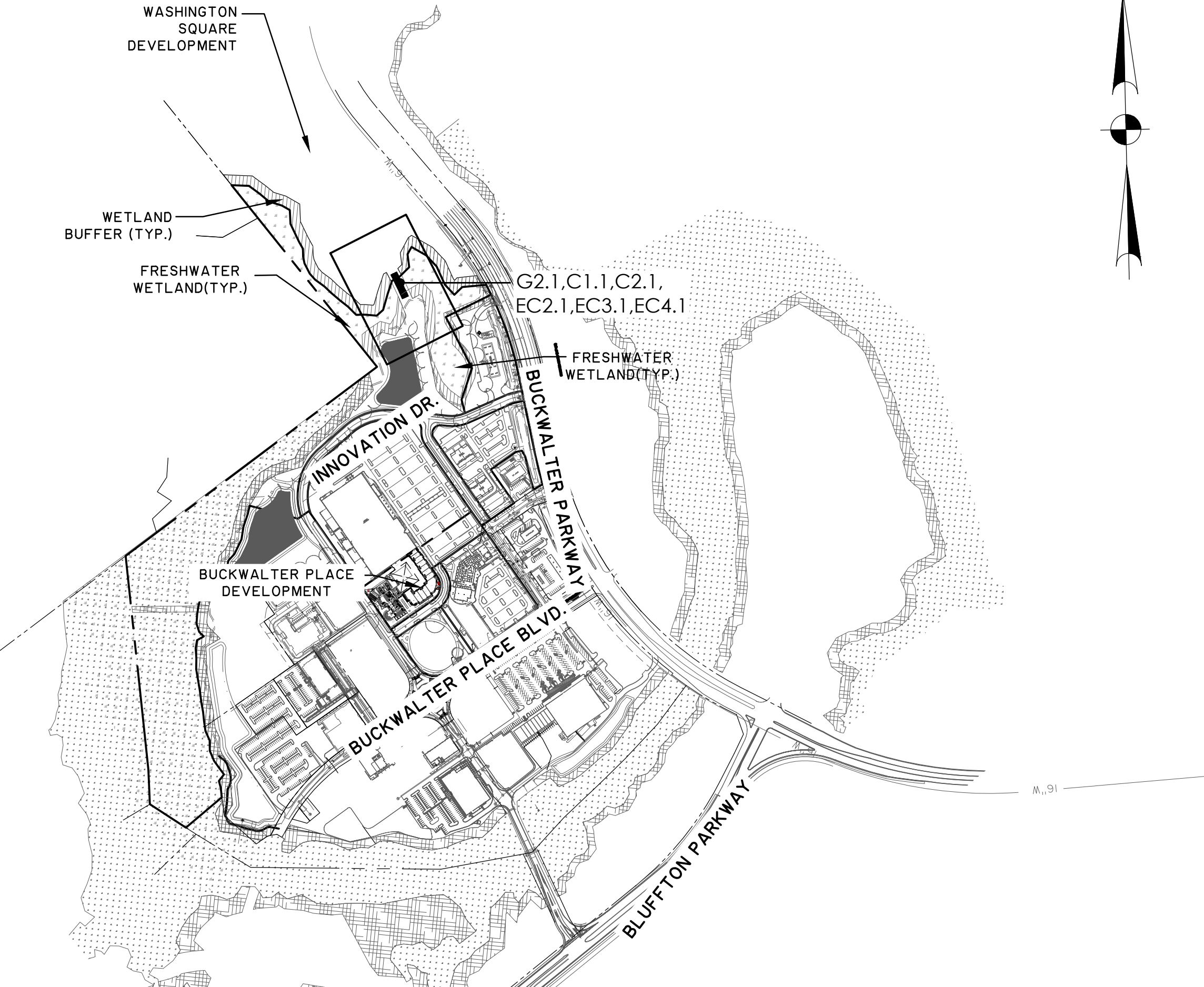

INDEX

SCALE: 1" = 500'

GENERAL NOTES

GENERAL INFORMATION

PREPARED FOR:
BC BUCKWALTER, LLC
2473 PERIMETER PARKWAY, BUILDING 100
AUGUSTA, GA 30909

UTILITIES: WATER AND SEWER

BEAUFORT JASPER WATER AND SEWER AUTHORITY
6 SNAKE ROAD
OKATIE, SC 29909
843-987-9250
ELECTRIC
PALMETTO ELECTRIC COOPERATIVE, INC.
ONE COOPERATIVE WAY
HARDEEVILLE, SC 29927
843-208-5512
TELEPHONE AND CABLE
HARGRAY COMMUNICATIONS
5 BUCK ISLAND ROAD
BLUFFTON, SC 29910
843-815-1676

COUNTY:

BEAUFORT COUNTY

MUNICIPALITY:

TOWN OF BLUFFTON

ZONING:

BUCKWALTER PUD

SURVEYOR:

THOMAS & HUTTON
50 PARK OF COMMERCE WAY
SAVANNAH, GA 31405
(912) 234-5300

ENGINEER:

THOMAS & HUTTON
50 PARK OF COMMERCE WAY
SAVANNAH, GA 31405
(912) 234-5300

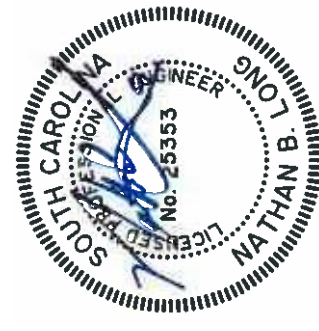
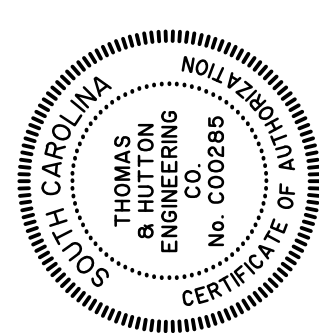

NO.	REVISIONS	BY	DATE



50 Park of Commerce Way
Savannah, GA 31405 • 912.234.5300
www.thomasandhutton.com

BC BUCKWALTER, LLC
BLUFFTON, SOUTH CAROLINA

CONNECTOR ROAD TO PARCEL 4

GENERAL NOTES AND SHEET INDEX

JOB NO:	J-25125.0004
DATE:	11/16/2021
DRAWN:	HAC
DESIGNED:	HAC
REVIEWED:	NBL
APPROVED:	NBL
SCALE:	AS SHOWN

G1.1

PERMIT SET - FOR REVIEW PURPOSES ONLY

LEGEND

	HORIZONTAL CONTROL POINT
	COMBINED-HORIZONTAL AND VERTICAL CONTROL

GRID NORTH, NAD83 (2011)
SOUTH CAROLINA SPC

- # NOTES
1. HORIZONTAL AND VERTICAL CONTROL SHOWN ON THIS SHEET SHOULD BE USED FOR ALL LAYOUT AND RECORD DATA FOR THIS PROJECT. IF DISCREPANCIES ARE FOUND, PLEASE CONTACT THOMAS & HUTTON PRIOR TO PROCEEDING. IT IS THE CONTRACTOR'S RESPONSIBILITY TO ESTABLISH SUPPLEMENTAL CONTROL WITHIN THE PROJECT AS NEEDED.
 2. ELEVATIONS FOR THIS PROJECT ARE BASED ON NAVD83.
 3. COORDINATES FOR THIS PROJECT ARE BASED ON THE SOUTH CAROLINA STATE PLANE COORDINATE SYSTEM, NAD83. DUE TO NORMAL VARIATIONS INHERENT TO ESTABLISHING COORDINATE POSITIONS, INDIVIDUAL GPS UNITS SHOULD BE LOCALIZED (OR CALIBRATED) TO THIS SITE.

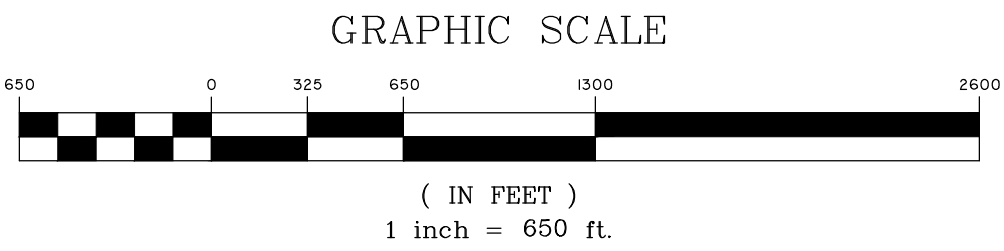
[illegible]

**THOMAS
&
HUTTON**

50 Park of Commerce Way
Savannah, GA 31405 • 912.234.5300
www.thomasandhutton.com

BC BUCKWALTER, LLC
BLUFFTON, SOUTH CAROLINA

CONNECTOR ROAD TO PARCEL 4

SURVEY CONTROL PLAN

JOB NO:	J-25125.0004
DATE:	11/18/2021
DRAWN:	HAC
DESIGNED:	HAC
REVIEWED:	NBL
APPROVED:	NBL
SCALE:	1" = 50'

V1.1

[illegible]

**THOMAS
&
HUTTON**

50 Park of Commerce Way
Savannah, GA 31405 • 912.234.5300
www.thomasandhutton.com

BC BUCKWALTER, LLC
BLUFFTON, SOUTH CAROLINA

CONNECTOR ROAD TO PARCEL 4

LAYOUT PLAN

JOB NO:	J-25125.0004
DATE:	11/18/2021
DRAWN:	HAC
DESIGNED:	HAC
REVIEWED:	NBL
APPROVED:	NBL
SCALE:	1" = 20'

C1.1

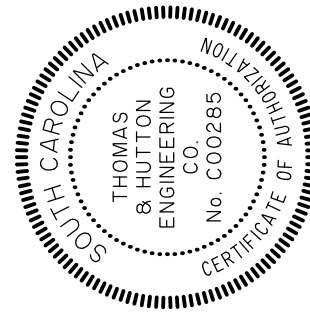
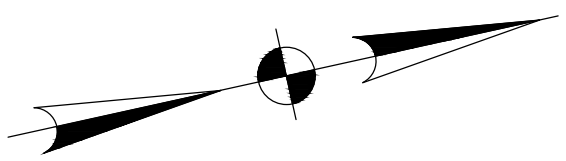
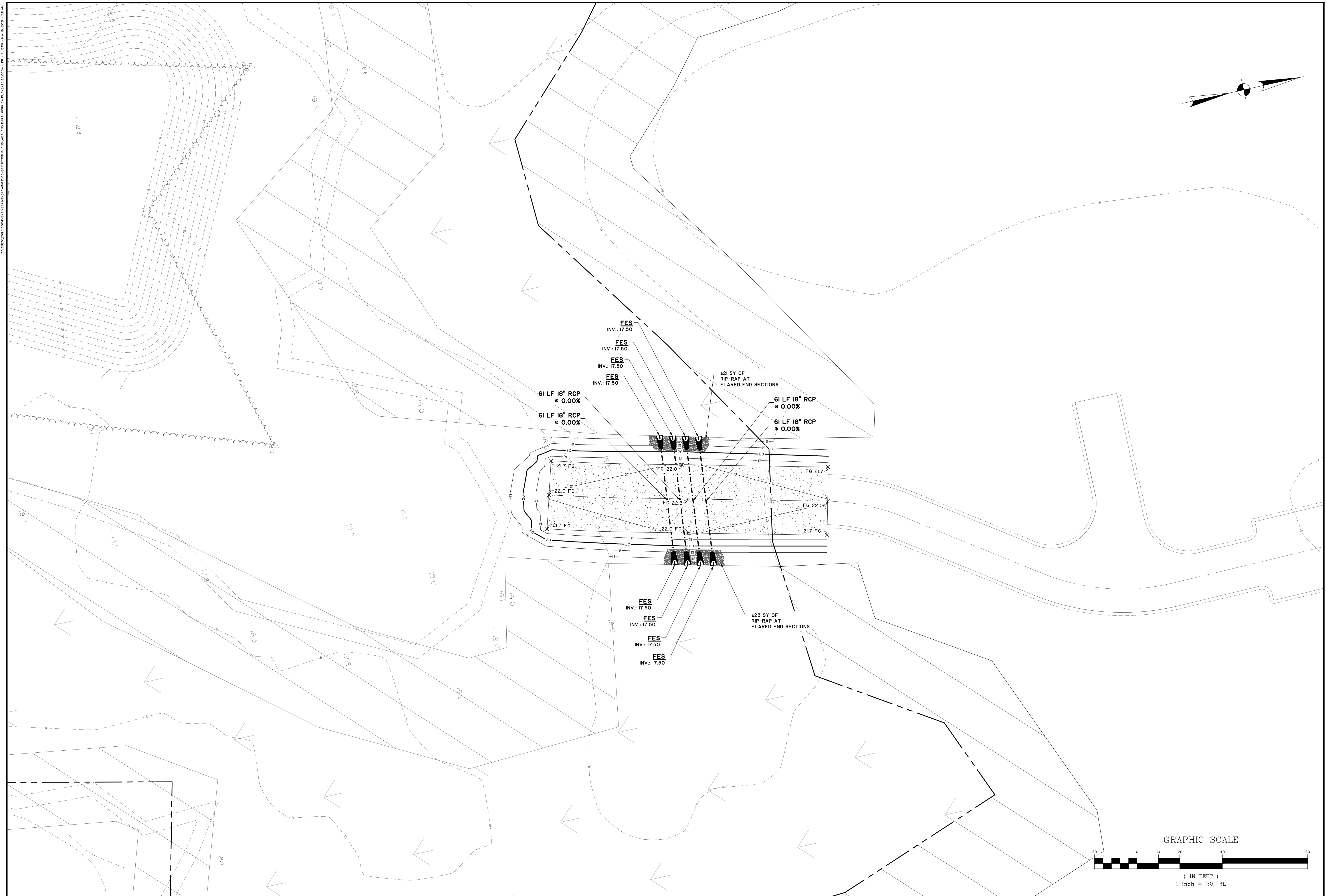

[illegible]

THOMAS & HUTTON
50 Park of Commerce Way
Savannah, GA 31405 • 912.234.5300
www.thomasandhutton.com

BC BUCKWALTER, LLC
BLUFFTON, SOUTH CAROLINA

CONNECTOR ROAD TO PARCE

GRADING & DRAINAGE PLAN

JOB NO:	J-25125.0004
DATE:	11/18/2021
DRAWN:	HAC
DESIGNED:	HAC
REVIEWED:	NBL
APPROVED:	NBL
SCALE:	1" = 20'

C2.1

PERMIT SET - FOR REVIEW PURPOSES ONLY

STORMWATER POLLUTION PREVENTION PLAN

TEMPORARY SEEDING - COASTAL

[illegible]

PERMANENT SEEDING - COASTAL

[illegible]

















EROSION CONTROL LEGEND

DESCRIPTION	PLAN SYMBOL
SILT FENCE	
CLEARING LIMITS	
DIVERSION DIKE	
DIVERSION BERM	
TEMPORARY DIVERSION	
PERMANENT DIVERSION	
SUBSURFACE DRAIN	
VEGETATED CHANNEL	
RIP RAP LINED CHANNEL	
ECB OR TRM LINED CHANNEL	
PAVED CHANNEL	
TREE PROTECTION	
SURFACE ROUGHENING	
TOP SOILING	
TEMPORARY SEEDING	
PERMANENT SEEDING	
MULCHING	

EROSION CONTROL LEGEND

DESCRIPTION	PLAN SYMBOL
EROSION CONTROL BLANKET OR TURF REINFORCEMENT MAT	
FLEXIBLE GROWTH MATRIX	
BONDED FIBER MATRIX	
SODDING	
SLOPED SODDING	
STAKED SOD	
STAKED SOD AROUND INLET	
RIPRAP	
OUTLET PROTECTION - RIP RAP	
OUTLET PROTECTION - ECB OR TRM	
DUST CONTROL	
POLYACRYLAMIDE (PAM)	
SEDIMENT BASIN	
SEDIMENT BASIN WITH SKIMMER	
SEDIMENT TRAP	
ROCK SEDIMENT DIKE	
SEDIMENT TUBE	

EROSION CONTROL LEGEND

DESCRIPTION	PLAN SYMBOL
ROCK CHECK DAM	
POROUS BAFFLES	
STABILIZED CONSTRUCTION ENTRANCE	
CONCRETE WASHOUT	
STORM DRAIN INLET PROTECTION - TYPE A FILTER FABRIC	
STORM DRAIN INLET PROTECTION - TYPE A SEDIMENT TUBE	
STORM DRAIN INLET PROTECTION - TYPE B HARDWARE FABRIC AND STONE	
STORM DRAIN INLET PROTECTION - TYPE C BLOCK AND GRAVEL	
STORM DRAIN INLET PROTECTION - TYPE D RIGID INLET FILTER	
STORM DRAIN INLET PROTECTION - TYPE E SURFACE COURSE CURB INLET FILTER	
STORM DRAIN INLET PROTECTION - TYPE F INLET TUBE	
STORM DRAIN INLET PROTECTION - TYPE G IMPERVIOUS AREA	
STORM DRAIN INLET PROTECTION - CATCH BASIN INSERT	
PIPE SLOPE DRAINS	
TEMPORARY STREAM CROSSING	
LEVEL SPREADER	

LIST OF ACRONYMS FOR SEDIMENT AND EROSION CONTROL

AASHTO	AMERICAN ASSOCIATION OF STATE HIGHWAY AND TRANSPORTATION OFFICIALS
AMD	ACRYLAMIDE POLYMER
BFM	BONDED FIBER MATRIX
BMP(S)	BEST MANAGEMENT PRACTICE(S)
CFS	CUBIC FEET PER SECOND
CMP	CORRUGATED METAL PIPE
DHEC	DEPARTMENT OF HEALTH AND ENVIRONMENTAL CONTROL
ECB	EROSION CONTROL BLANKET
EPA	UNITED STATES ENVIRONMENTAL PROTECTION AGENCY
EPSC	EROSION PREVENTION AND SEDIMENTATION CONTROL
FDA	UNITED STATES FOOD AND DRUG ADMINISTRATION
FGM	FLEXIBLE GROWTH MATRIX
HDPE	HIGH DENSITY POLYETHYLENE
MS4	MUNICIPAL SEPARATE STORM SEWER SYSTEM
MSDS	MATERIAL SAFETY DATA SHEETS
NPODES	NATIONAL POLLUTANT DISCHARGE ELIMINATION SYSTEM
PAM	POLYACRYLAMIDE OR POLYMER
RCP	REINFORCED CONCRETE PIPE
SCS	SOIL CONSERVATION SERVICE
SWPPP	STORMWATER POLLUTION PREVENTION PROGRAM
TRM	TURF REINFORCEMENT MAT
VFS	VEGETATED FILTER STRIP

CONSTRUCTION SEQUENCE

CONSTRUCTION ACTIVITY	SCHEDULE CONSIDERATION
INITIAL PHASE	
1 OBTAIN COPIES OF ALL PLAN APPROVALS AND OTHER APPLICABLE PERMITS.	CONTRACTOR TO HAVE ONSITE AT ALL TIMES DURING CONSTRUCTION.
2 FLAG THE WORK LIMITS AND BARRICADE TREES AND MARK BUFFER AREAS FOR PROTECTION.	HAVE LOCAL REGULATORY AGENCY INSPECT TREE BARRICADES.
3 HOLD PRE CONSTRUCTION CONFERENCE AT LEAST ONE WEEK PRIOR TO STARTING CONSTRUCTION.	REVIEW TREE PROTECTION (BARRICADE) WITH OWNER AND LOCAL REGULATORY AGENCY. TAKE PICTURES OF ALL PROTECTED TREES AND LOCATIONS WHERE SITE WORK TIES INTO EXISTING TO DOCUMENT PREDEVELOPMENT PROCEDURES.
4 INSTALL CONSTRUCTION ACCESS AND LAY DOWN AREAS	STABILIZE BARE AREAS IMMEDIATELY AND INSTALL CONSTRUCTION EXITS / ENTRANCES.
5 CONSTRUCT SEDIMENT FENCES	INSTALL SEDIMENT FENCES AFTER CONSTRUCTION SITE IS ACCESSED.
6 CONSTRUCT OUTLET PROTECTION. INSTALL SKIMMER.	INSTALL PRINCIPAL BASINS AFTER SEDIMENT FENCES IS INSTALLED.
7 ESTABLISH RUNOFF CONTROL - DIVERSIONS, PERIMETER DIKES, WATER BARS, AND OUTLET PROTECTION.	INSTALL PRINCIPAL SEDIMENT TRAPS AND BEFORE LAND GRADING. INSTALL ADDITIONAL RUNOFF-CONTROL MEASURES DURING GRADING.
8 LAND CLEARING AND GRADING-SITE PREPARATION CUTTING, FILLING AND GRADING, SEDIMENTATION TRAPS, BARRIERS, DIVERSIONS, DRAINS, SURFACE ROUGHENING.	BEGIN MAJOR CLEARING AND GRADING AFTER PRINCIPAL SEDIMENT AND KEY RUNOFF-CONTROL MEASURES ARE INSTALLED. CLEAR BROWNS AND DISPOSAL AREAS ONLY AS NEEDED. INSTALL ADDITIONAL CONTROL MEASURES AS GRADING PROGRESSES. MARK TREES AND BUFFER AREAS FOR PRESERVATION.
CONSTRUCTION PHASE	
1 RUNOFF CONVEYANCE SYSTEM- INSTALL STORM DRAINS, STABILIZE BANKS, CHANNELS, INSTALL INLET AND OUTLET PROTECTION, SLOPE DRAINS.	WHERE NECESSARY, STABILIZE BANKS AS EARLY AS POSSIBLE. INSTALL PRINCIPAL RUNOFF CONVEYANCE SYSTEM WITH RUNOFF- CONTROL MEASURES. INSTALL REMAINDER OF SYSTEM AFTER GRADING.
2 INSTALL WASTEWATER COLLECTION, WATER DISTRIBUTION AND STORM DRAINAGE SYSTEMS	APPLY TEMPORARY OR PERMANENT STABILIZATION MEASURES IMMEDIATELY ON ALL DISTURBED AREAS WHERE WORK IS DELAYED OR COMPLETE.

3	SURFACE STABILIZATION-TEMPORARY AND PERMANENT SEEDING, MULCHING, SODDING, RIP RAP.	APPLY TEMPORARY OR PERMANENT STABILIZATION MEASURES IMMEDIATELY ON ALL DISTURBED AREAS WHERE WORK IS DELAYED OR COMPLETE.
STABILIZATION PHASE		
4	BUILDING CONSTRUCTION- BUILDINGS UTILITIES, ROADS, ETC.	INSTALL NECESSARY EROSION AND SEDIMENTATION CONTROL PRACTICES AS WORK TAKES PLACE.
5	LANDSCAPING AND FINAL STABILIZATION - TOPSOILING, TREES AND SHRUBS, PERMANENT SEEDING, MULCHING, SODDING, RIP RAP. REMOVE SKIMMER.	LAST CONSTRUCTION PHASE- STABILIZE ALL OPEN AREAS, INCLUDING BORROW AND SPOIL AREAS. REMOVE AND STABILIZE ALL TEMPORARY CONTROL MEASURES.

BC BUCKWALTER, LLC

BLUFFTON, SOUTH CAROLINA

CONNECTOR ROAD TO PARCEL 4

ES & PC NOTES

JOB NO:	J-25I25.0004
DATE:	11/18/2021
DRAWN:	HAC
DESIGNED:	HAC
REVIEWED:	NBL
APPROVED:	NBL
SCALE:	N/A

EC1.2

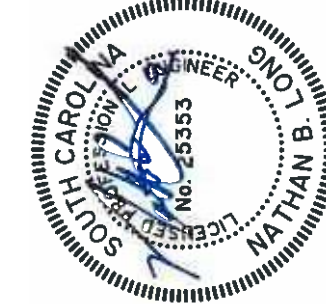
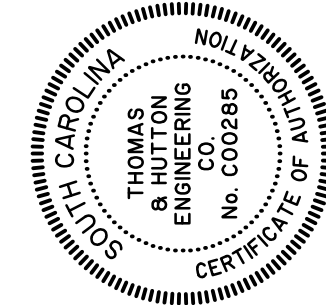

PERMIT SET - FOR REVIEW PURPOSES ONLY

