

Planting Details		
Call-out	Description	Detail
14.1	Tree Planting	1/L501
14.2	Palm Tree Planting	2/L501
14.3	Shrub Planting	3/L501
14.4	Ground Cover Planting	4/L501

PLANT KEY LEGEND

<u>Abbrev</u>	<u>Botanical Name</u>	<u>Common Name</u>
TREES		
SABP	Sabal palmetto	Cabbage Palm
UNDERSTORY TREES		
LAGM	Lagerstroemia indica x fauriei 'Muskogee'	Muskogee Crape Myrtle
SHRUBS		
BUXM	Buxus microphylla japonica	Japanese Boxwood
CAMS	Camellia sasanqua	Sasanqua Camellia
ILLP	Illicium parviflorum	Yellow Anise
PODM	Podocarpus macrophyllus	Podocarpus
GROUND COVERS, VINES & PERENNIALS		
LIRM	Liriope muscarli 'Big Blue'	Big Blue Liriope
TRAA	Trachelospermum asiaticum	Asiatic Jasmine

PLANTING REFERENCE NOTES:

- 1 EXISTING TREES TO REMAIN.
- 2 EXISTING TREES TO BE REMOVED.
- 3 MULCH DISTURBED AREAS DUE TO CONSTRUCTION.
- 4 CAREFULLY EXCAVATE PLANTING PITS IN VICINITY OF EXISTING TREES, WITHOUT DISTURBING TREE ROOTS.
- 5 COORDINATE PLANTING LAYOUT WITH EXISTING UTILITIES. REPORT ANY CONFLICTS TO LANDSCAPE ARCHITECT.

GENERAL NOTES:

4. ALL NOTES APPLY TO ALL DRAWINGS AND ALL TRADES.
5. REFER TO ENGINEERING PLANS FOR LAYOUT AND LOCATION OF UTILITIES AND ROADS
3. ALL SURVEY AND SITE INFORMATION WERE COMPILED FROM A VARIETY OF SOURCES AT VARIOUS TIMES. SITE INFORMATION MUST BE FIELD VERIFIED BEFORE CONSTRUCTION BEGINS. REPORT ANY DISCREPANCIES TO THE OWNER OR OWNER'S REPRESENTATIVE.
4. IT IS THE RESPONSIBILITY OF ALL CONTRACTORS AND TRADES TO COORDINATE THE INSTALLATION OF THEIR WORK WITH THE INSTALLATION OF WORK BY ALL OTHER CONTRACTORS AND TRADES.
5. THE REQUIREMENTS OF THE SPECIFICATIONS, DRAWINGS, GENERAL REQUIREMENTS, AND ALL ITEMS OF THE CONTRACT SHALL BE EQUALLY BINDING FOR ALL CONTRACTORS AND TRADES.
6. EACH CONTRACTOR IS REQUIRED TO MAINAIN FULL COLOR SETS OF THE CONTRACT DOCUMENTS FOR HIS EMPLOYEES USE ON THE PROJECT TO ASSURE THAT ALL WORK IS PROPERLY COORDINATED AND FOR REVIEWS BY COUNTY AND / OR MUNICIPALITY OFFICIALS FOR INSPECTIONS.
7. ALL CONTRACTORS AND ALL TRADES ARE RESPONSIBLE FOR OBTAINING THE CORRECT PERMITS AND INSPECTIONS PRIOR TO CONSTRUCTION AS REQUIRED BY LOCAL PLANNING, ZONING, BUILDING CODE AND OTHER TOWN AUTHORITIES.
8. W.J.K. LTD., THE OWNER AND / OR THE OWNER'S REPRESENTATIVE SHALL BE NOTIFIED OF ANY SITE CONDITIONS WHICH MAY NECESSITATE MODIFICATION TO THE PLAN. THE OWNER OR OWNER'S REPRESENTATIVE SHALL MAKE INFIELD MODIFICATIONS, IF NECESSARY.
9. CONTRACTOR SHALL PROVIDE AND FURNISH ALL MATERIALS, EQUIPMENT AND LABOR NECESSARY FOR ALL CONSTRUCTION, PROTECTION, MAINTENANCE AND RELATED ITEMS TO COMPLETE WORK INDICATED ON THE DRAWINGS.
10. BEFORE COMMENCING ANY WORK CONTRACTOR SHALL ASCERTAIN THE LOCATION OF ALL UTILITIES, SUB-SURFACE DRAINAGE, AND UNDERGROUND CONSTRUCTION SO THAT PROPER PRECAUTIONS MAY BE TAKEN NOT TO DISTURB ANY SUB-SURFACE IMPROVEMENTS. CONTRACTOR SHALL TAKE ALL NECESSARY PRECAUTIONS IN BRINGING EQUIPMENT ON TO AND OFF OF THE SITE, PROTECTING WALKS, PAVING, STEPS AND OTHER EXISTING CONSTRUCTION ON THE SITE. CONTACTS SHALL BE MADE BY CONTRACTOR WITH PROPER AUTHORITIES BEFORE AND DURING THIS WORK SO AS TO COMPLY WITH ALL REGULATIONS AND ORDINANCES.
11. CONTRACTOR SHALL FIELD LOCATE ALL UTILITIES AND CONFIRM / DETERMINE UTILITY ELEVATIONS PRIOR TO CONSTRUCTION. CONTRACTOR IS RESPONSIBLE FOR ANY DAMAGE AND MAKE REPAIRS AT THEIR OWN EXPENSE, THAT MAY OCCUR TO EXISTING UTILITIES IN ACCORDANCE WITH NATIONAL, STATE, AND LOCAL CODES.
12. CONTRACTOR SHALL VERIFY ALL EXISTING TREE CONDITIONS AND ELEVATIONS PRIOR TO CONSTRUCTION. CONTRACTOR SHALL NOTIFY THE OWNER OR OWNER'S REPRESENTATIVE OF ANY DISCREPANCIES PRIOR TO THEIR REMOVAL.
13. CONTRACTOR SHALL PROTECT AND INSTALL TREE PROTECTION FENCE AROUND THE DRIP LINE OF ALL TREES, NATURAL AREAS AND EXISTING VEGETATION TO REMAIN. TREE PROTECTION LOCATION SHALL BE APPROVED BY LANDSCAPE ARCHITECT PRIOR TO CONSTRUCTION.
14. ALL CONSTRUCTION FOR ALL TRADES SHALL CONFORM TO OR EXCEED THE PRODUCT MANUFACTURER'S RECOMMENDATIONS, REGULATIONS OF BEAUFORT COUNTY AND THE AMERICANS WITH DISABILITIES ACT, AND / OR OTHER APPLICABLE NATIONAL, STATE, AND LOCAL CODES AND ANY OTHER AVERNAGE AUTHORITY.
15. CONTRACTOR SHALL CONSTRUCT AS DIRECTED BY THE OWNER OR OWNER'S REPRESENTATIVE.
16. CONTRACTOR SHALL PROTECT THE GENERAL PUBLIC FROM CONSTRUCTION AREAS DURING CONSTRUCTION.
17. THE OWNER MAY REQUIRE FLAG MEN TO BE AVAILABLE DURING THE CONSTRUCTION PROCESS.
18. ANY DEVIATIONS FROM THESE PLANS MUST BE SPECIFICALLY APPROVED BY W.J.K. LTD., AND THE OWNER OR OWNER'S REPRESENTATIVE.

PLANTING NOTES:

1. CONTRACTOR IS RESPONSIBLE FOR INSPECTION OF EXISTING CONDITIONS, INCLUDING UTILITIES, AND PROMPTLY REPORTING ANY DISCREPANCIES OR CONFLICTS WITH PLANTING AREAS. REPORT INFORMATION TO OWNER, OWNER'S REPRESENTATIVE AND LANDSCAPE ARCHITECT.
2. CONTRACTOR SHALL FIELD LOCATE ALL UTILITIES. CONTRACTOR IS RESPONSIBLE FOR ANY DAMAGE AND MAKE REPAIRS THAT MAY OCCUR TO EXISTING UTILITIES IN ACCORDANCE WITH NATIONAL, STATE AND LOCAL CODES.
3. LANDSCAPE PLANTING AND / OR MULCHED AREAS TO BE FINE GRADED, HAND RAKED SMOOTH AND FREE OF DEBRIS.
4. CONTRACTOR TO PERFORM SOIL TESTS AS NECESSARY TO ASSURE PLANT HEALTH AND GROWTH.
5. MULCH ALL PLANTING BEDS TO A MIN. 3" DEPTH WITH MULCH SPECIFIED IN PLANT SCHEDULE.
6. CONTRACTOR VERIFIES THAT ALL PLANT MATERIAL IS DETERMINED AVAILABLE AS SPECIFIED WHEN BID / PROPOSAL IS SUBMITTED.
7. PLANT SCHEDULE WAS PREPARED FOR ESTIMATING PURPOSES ONLY. CONTRACTOR SHALL MAKE OWN QUANTITY TAKEOFFS USING DRAWINGS TO DETERMINE QUANTITIES TO HIS SATISFACTION. REPORTING QUANTITIES MAY BE CHALLENGED BY WHICH MAY AFFECT BIDDING.
8. GALLON SIZES ARE FOR PRICING PURPOSES ONLY. PLANT MUST MEET HEIGHTS AND WIDTHS SPECIFIED IN PLANT SCHEDULE.
9. ROOT TYPE MAY BE FREELY SUBSTITUTED IN CASE OF BALLED AND BURLAPPED OR CONTAINER GROWN, OTHER SPECIFICATIONS REMAINING UNCHANGED, EXCEPT IN THE CASE OF CONTAINER GROWN SPECIMEN TREES AS INDICATED IN THE TREE PLANTING SCHEDULE.
10. ANY SIGNIFICANT ROOTS ENCOUNTERED 2" DIA. AND LARGER SHALL BE DUG OUT BY HAND AND CLEANLY CUT BACK IN THE FOOTING / FOUNDATION AREA TO PROMOTE ROOT RE-GROWTH AND HELP ROOT ESTABLISHMENT.
11. ALL PLANT MATERIAL [EXCEPT SEASONAL COLOR] SHALL BE GUARANTEED AND REPLACED AS NECESSARY BY THE CONTRACTOR FOR ONE YEAR.
12. ALL SEASONAL COLOR SHALL BE GUARANTEED AND REPLACED AS NECESSARY BY THE CONTRACTOR FOR THREE MONTH TIME FRAMES.

IRRIGATION NOTES:

1. CONTRACTOR TO SUPPLY AUTOMATIC IRRIGATION SYSTEM, COMPLETE AND INSTALLED. SYSTEM TO INCLUDE ALL VALVES, PIPES, HEADS, FITTINGS, BACK FLOW CONTROLLER, AND IRRIGATION METER AND TO PROVIDE 100% COVERAGE FOR ALL NEW PLANTINGS. DRIP IRRIGATION TO BE USED FOR ALL PLANTINGS, EXCEPT LAWNS.
2. NO IRRIGATION COMPONENTS SHALL BE CLOSER THAN 12" TO ANY EDGE OF PAVEMENT OR CURB AND GUTTER. IRRIGATION SHALL NOT SPRAY BEYOND LANDSCAPED AREAS, OR INTO ANY UNDISTURBED BUFFERS. NO OVER SPRAY SHALL BE PERMITTED ONTO ADJACENT PROPERTIES OR PEDESTRIAN SIDEWALK AREAS.
3. LANDSCAPE CONTRACTOR TO FIELD VERIFY ALL COMPONENT LOCATIONS TO ENSURE APPROPRIATE COVERAGE.
4. LANDSCAPE CONTRACTOR SHALL LOCATE WATER SOURCE AND PROVIDE POWER TO CONTROLLER.
5. CONTROLLER LOCATION TO BE SPECIFIED BY OWNERS REPRESENTATIVE IN FIELD PRIOR TO CONSTRUCTION.
6. ALL DRIP TUBING SHALL BE COVERED WITH MIN. 3" OF MULCH.
7. ALL DRIP AND SPRAY ZONES SHALL BE SEPARATE.
8. CONTRACTOR SHALL SUBMIT FINAL IRRIGATION PLANS TO OWNER'S REPRESENTATIVE AND ALL REVIEWING BODIES / AGENCIES FOR FINAL APPROVAL PRIOR TO INSTALLATION.

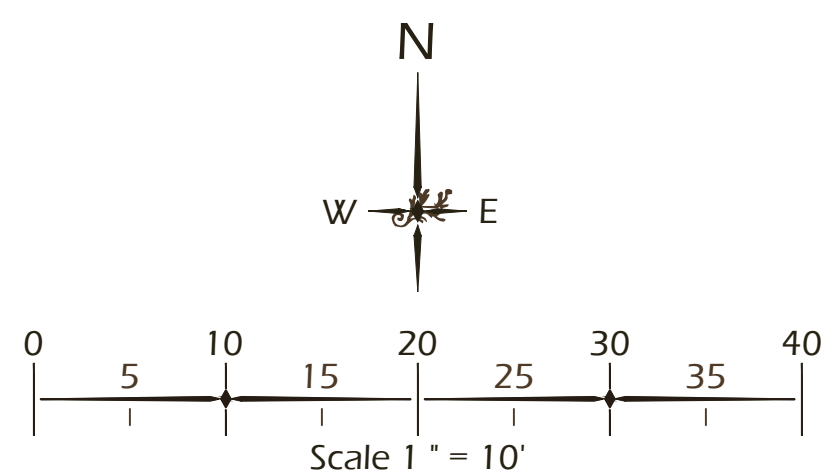

Winter Jones Keefe
Ltd. 
landscape architecture
land planning
www.wjkltd.com
88 Promenade Street, Suite 801 • Hurffon, South Carolina 29910 | 843.797.7411

©2021 WJK LTD.
DESIGN CONCEPTS, DRAWING, SHEETS,
LOGOS, SPECIFICATIONS, DETAILS,
WRITTEN MATERIAL SHALL NOT BE USED
OR REPRODUCED IN WHOLE OR IN PART
IN ANY FORM WITHOUT PRIOR WRITTEN
CONSENT OF WJK LTD.
THIS SHEET TO SCALE AT: 24"X36"

SITE DEVELOPMENT PLANS
FOR
PROMENADE LOT 9
BLUFFTON ROAD / BLUFFTON, SOUTH CAROLINA

DATE:	DEC 03, 2021
PROJECT NO.:	XXXXXX.XX
DRAWN BY:	JM
CHECKED BY:	DK

HPC SUBMITTAL
PLAN, NOT FOR
CONSTRUCTION

REVISIONS:

DRAWING TITLE
PLANTING PLAN

DRAWING NUMBER

L500

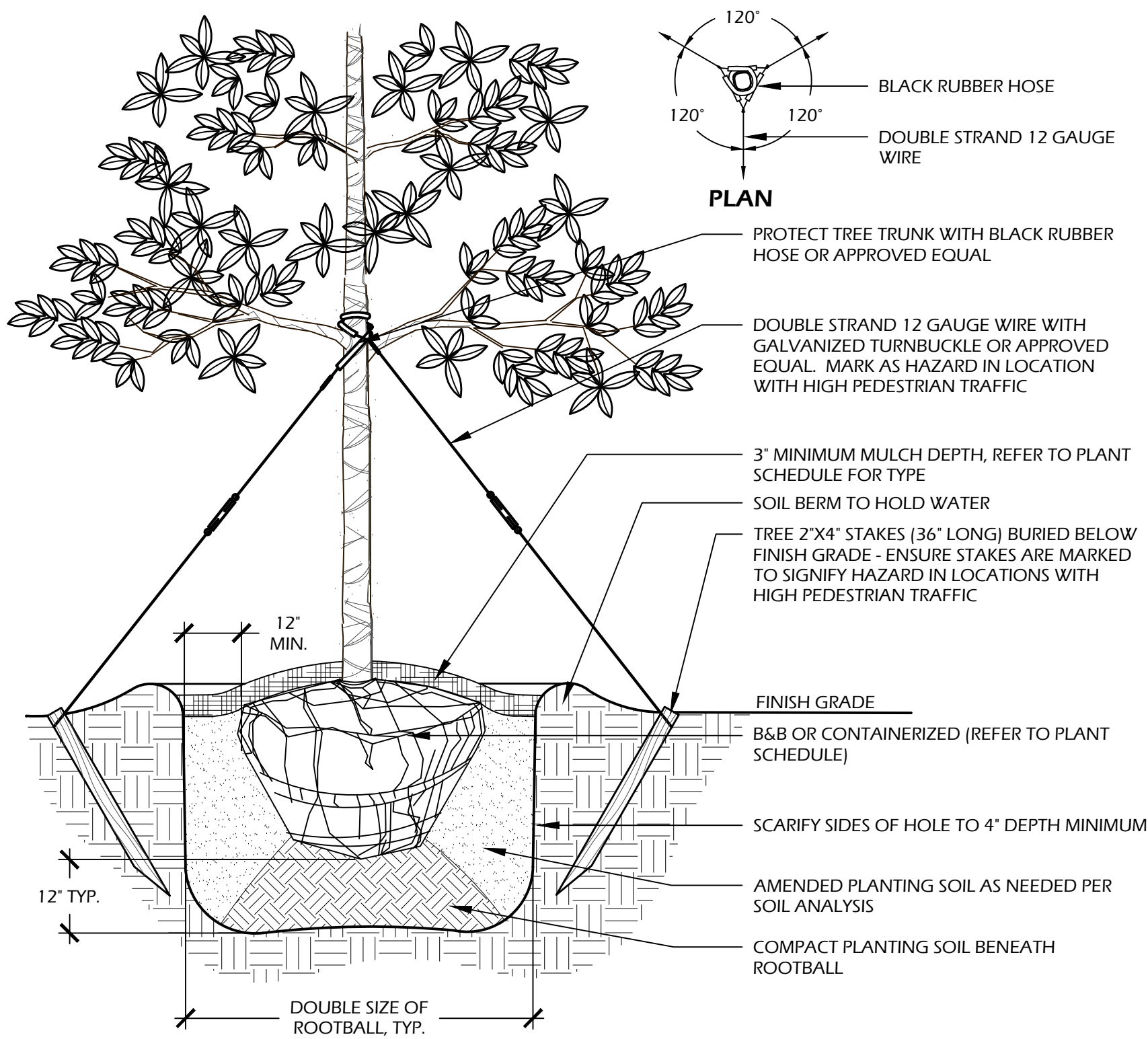

- NOTES:**
1. TREE STAKING OPTIONAL, HOWEVER, LANDSCAPE CONTRACTOR RESPONSIBLE FOR MAINTAINING TREES IN AN UPRIGHT (90 DEGREE/ PERPENDICULAR) POSITION FOR 1 YEAR AFTER PLANTING IS COMPLETE OR UNTIL TREE ROOT SYSTEM IS FULLY ESTABLISHED AND STURDY. FINAL TREE STAKING DETAILS AND PLACEMENT TO BE APPROVED BY OWNER'S REPRESENTATIVE.
 2. CONTRACTOR SHALL ASSURE PERCOLATION OF ALL PLANTING PITS PRIOR TO INSTALLATION.
 3. IN SEMI-IMPERVIOUS SOIL CONDITIONS, ROOTBALL ELEVATION SHALL BE 2" ABOVE FINISH GRADE. COORDINATE WITH OWNER'S REPRESENTATIVE PRIOR TO SETTING ROOTBALL ELEVATIONS.

1 // L501 TREE PLANTING
SCALE: N.T.S.

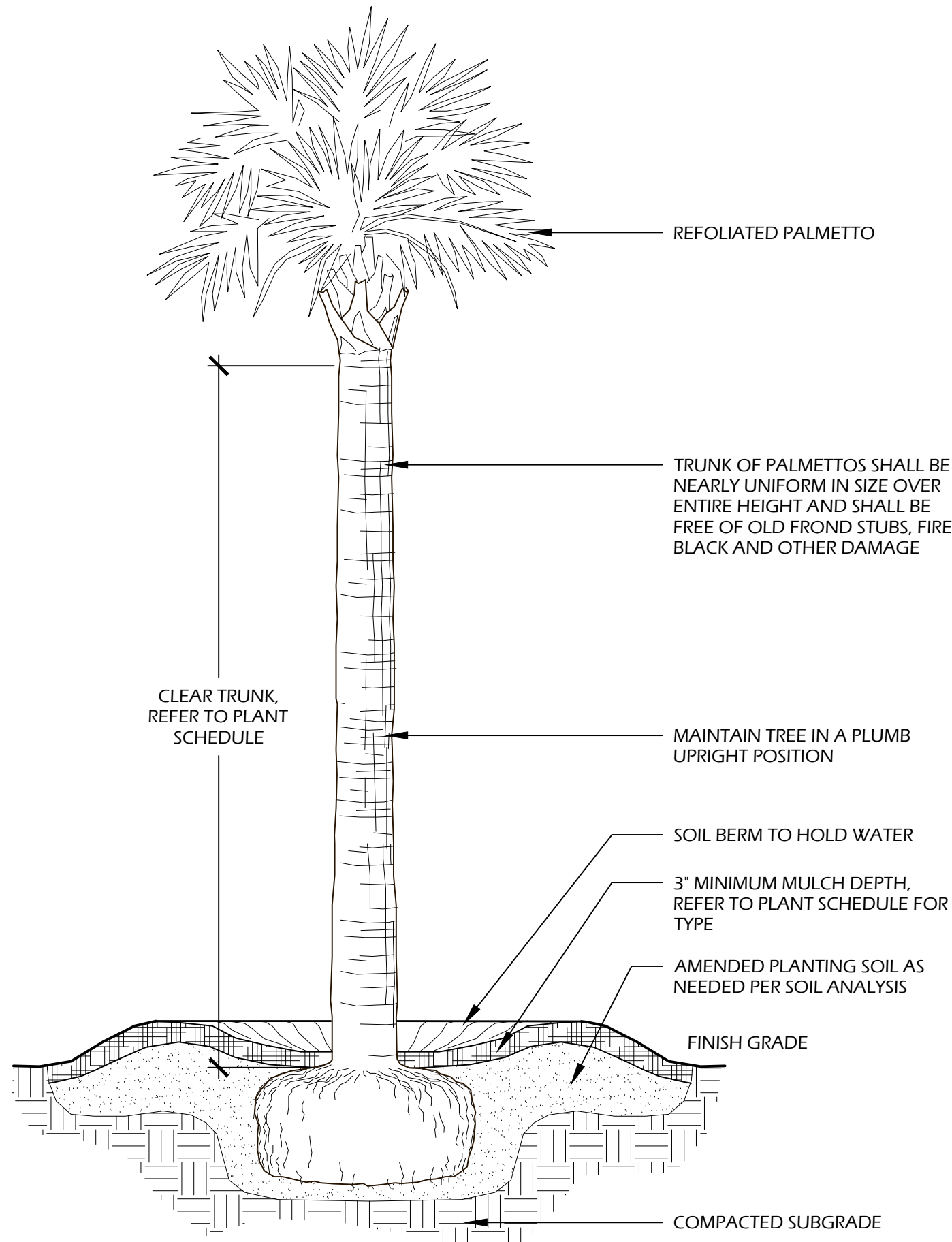

- NOTES:**
1. FINAL TREE STAKING DETAILS AND PLACEMENT TO BE APPROVED BY OWNER OR OWNER'S REPRESENTATIVE.
 2. CONTRACTOR SHALL ASSURE PERCOLATION OF ALL PLANTING PITS PRIOR TO INSTALLATION.
 3. SABAL PALMETTOS SHALL BE REFOLIATED, PROTECT CABBAGE HEAD FROM DAMAGE.

2 // L501 PALM TREE PLANTING
SCALE: N.T.S.

PLANT SCHEDULE:

Quantity	Abbrev	Botanical Name	Common Name	Height	Spread	Container	Cal./Spacing	Notes
TREES								
2	SABP	Sabal palmetto	Cabbage Palm	12'-16'	-	Cont.	-	Refoliated, full clear trunk, refer to plan for heights
UNDERSTORY TREES								
1	LAGM	Lagerstroemia indica x fauriei 'Muskogee'	Muskogee Crape Myrtle	10'-12'	5'-6'	45 gal.	-	Full
SHRUBS								
10	BUXM	Buxus microphylla japonica	Japanese Boxwood	12"x18"	12"x18"	7 gal.	-	Full
2	CAMS	Camellia sasanqua	Sasanqua Camellia	3'-4'	2'-3'	15 gal.	-	Full
10	ILLP	Illicium parviflorum	Yellow Anise	30"-36"	24"-30"	7 gal.	-	Full
6	PODM	Podocarpus macrophyllus	Podocarpus	36"-42"	24"-30"	15 gal.	-	Full
GROUND COVERS, VINES & PERENNIALS								
40	LIRM	Liriope muscari 'Big Blue'	Big Blue Liriope	12"x16"	8"-12"	1 gal.	18" O.C.	Full
30	TRAA	Trachelospermum asiaticum	Asiatic Jasmine	4'-6"	12" runners	1 gal.	18" O.C.	Full

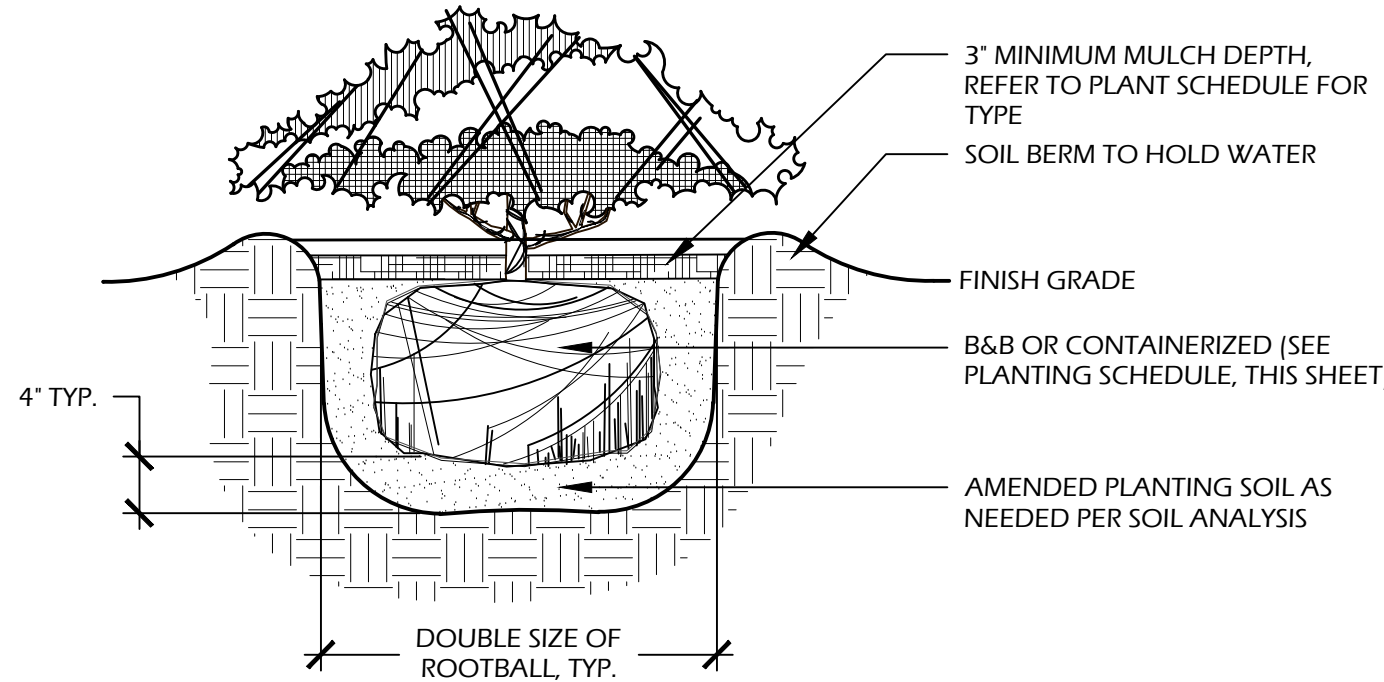

- NOTES:**
1. WHEN GROUNDCOVERS AND SHRUBS ARE USED IS MASSES, ENTIRE BED TO BE EXCAVATED TO RECEIVE PLANTING SOIL AND PLANT MATERIAL.
 2. CONTRACTOR SHALL ASSURE PERCOLATION OF ALL PLANTING PITS PRIOR TO INSTALLATION.
 3. IN SEMI-IMPERVIOUS SOIL CONDITIONS, ROOTBALL ELEVATION SHALL BE ±2" ABOVE FINISH GRADE. COORDINATE WITH OWNER'S REPRESENTATIVE PRIOR TO SETTING ROOTBALL ELEVATIONS.

3 // L501 SHRUB PLANTING
SCALE: N.T.S.

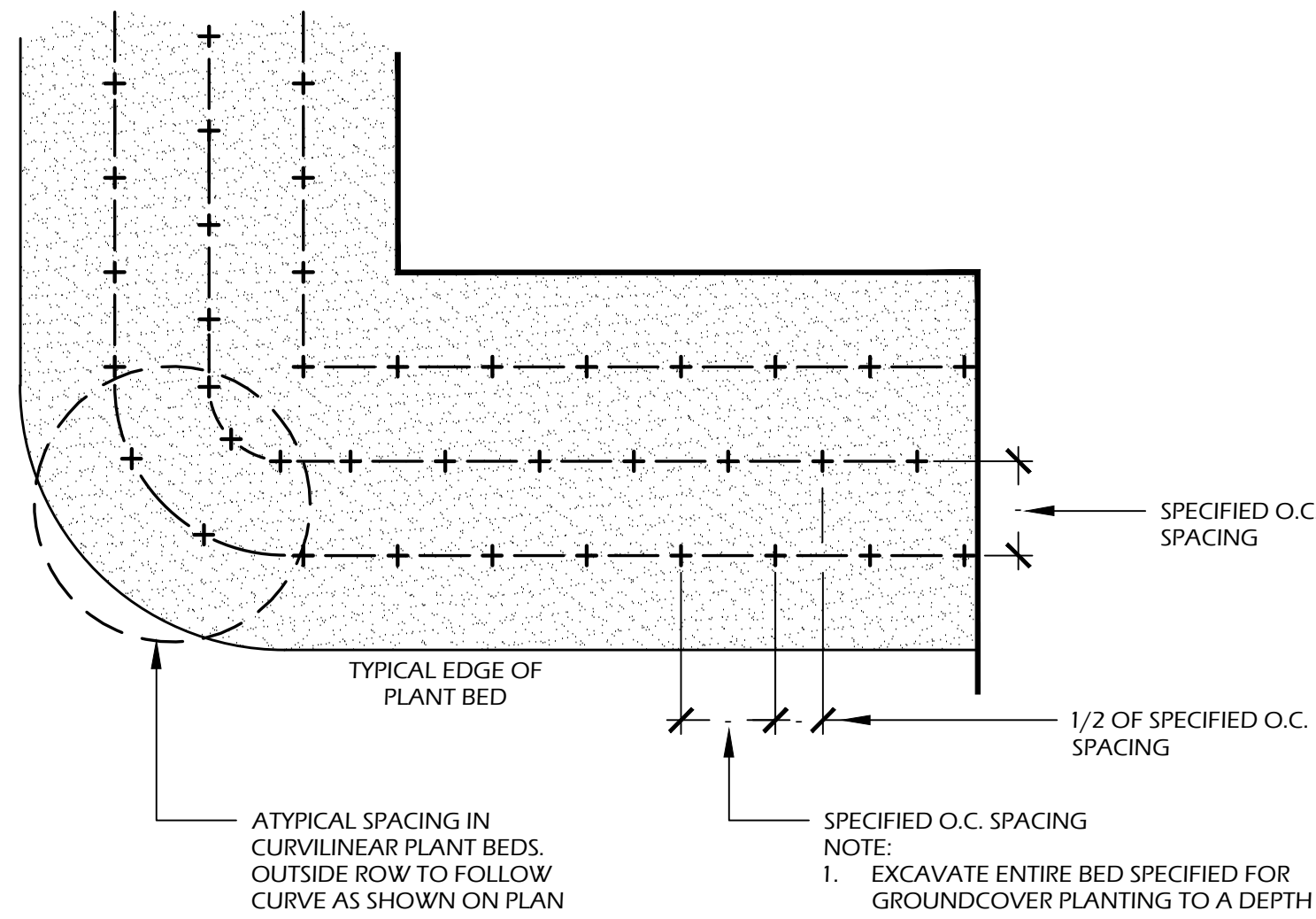

4 // L501 GROUND COVER PLANTING
SCALE: N.T.S.

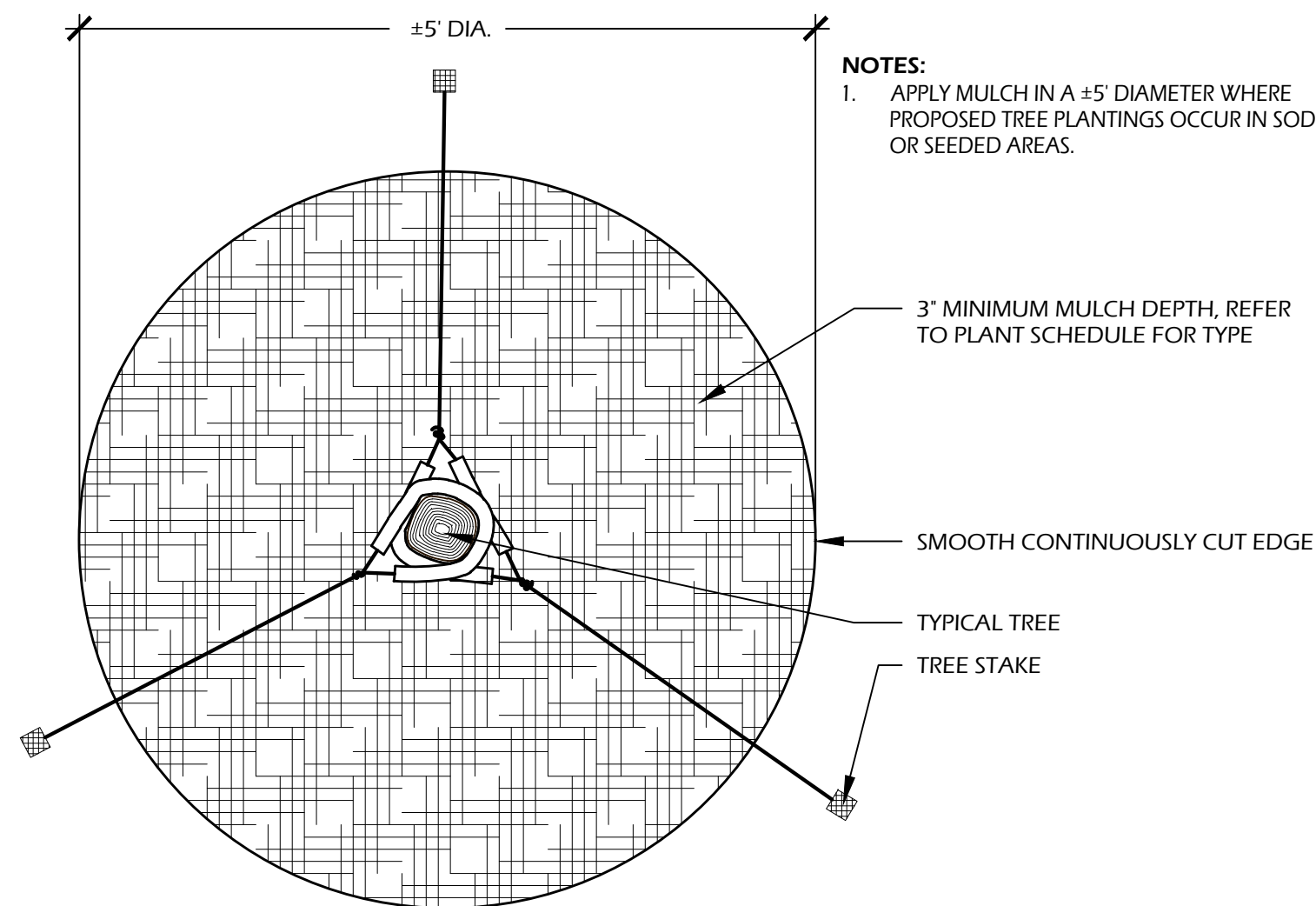

5 // L501 TREE STAKING
SCALE: N.T.S.