

DRAINAGE LEGEND			
CALL-OUT	SYMB.	DESCRIPTION	DETAIL
11.1		6' AREA DRAIN	7/L4
11.2		12' AREA DRAIN TYPE 1	8/L4
11.3		12' AREA DRAIN TYPE 2 (ATRIUM GRATE)	9/L4
11.4		8' FRENCH DRAIN	1/L5

NOTE: DRAINAGE SYMBOLS ARE GRAPHIC IN NATURE AND ARE NOT INTENDED TO BE TO SCALE. REFER TO SITE DETAILS FOR SIZES AND DIMENSIONS. IF NOT LOCATED ON PLAN AND SUB SURFACE DRAINAGE IS NEEDED, CONTRACTOR SHALL SUPPLY AREA DRAINS, FRENCH DRAINS AND DRY WELLS AS REQUIRED TO PROMOTE PROPER STORMWATER DRAINAGE (REFER TO DRAINAGE DETAILS, SHEET L4)

GRADING LEGEND	
SYMB.	DESCRIPTION
	SPOT GRADE
	DRAINAGE ARROW
	PROPOSED CONTOUR MAJOR
	PROPOSED CONTOUR MINOR
	EXISTING GRADE

GRADING ABBREVIATIONS			
ABBR.	DESCRIPTION	ABBR.	DESCRIPTION
BC	BOTTOM OF COLUMN	HP	HIGH POINT
BOC	BOTTOM OF CURB	RIM	TOP OF DRAIN
BS	BOTTOM OF STEP	TC	TOP OF COLUMN
BW	BOTTOM OF WALL	TOC	TOP OF CURB
FFE	FINISHED FLOOR ELEVATION	TS	TOP OF STEP
FG	FINISHED GRADE	TW	TOP OF WALL
LP	LOW POINT		

- GRADING REFERENCE NOTES:**
- MINIMIZE DISTURBANCE AROUND TREES TO REMAIN.
  - ALL PIPING UNDER HARDSCAPE SHALL BE SOLID H.D.P.E. PIPES.
  - CONTRACTOR SHALL TIE GUTTER DOWNSPOUTS INTO SUBSURFACE DRAINAGE SYSTEM WHENEVER POSSIBLE.
  - TIE INTO EXISTING GRADE. MEET SMOOTHLY AND EVENLY.
  - FEATHER BOTTOM OF SLOPE SMOOTHLY TO MEET EXISTING CONDITIONS.
  - CREATE SWALE AND BERM TO DIRECT WATER AWAY FROM HOUSE AND ADJACENT PROPERTIES.
  - PROVIDE POSITIVE DRAINAGE AWAY FROM BUILDING AND ADJACENT PROPERTY LINES.
  - DIRECT STORMWATER TOWARDS STREET OR EXISTING DRAINAGE DITCH, DRAINAGE SHALL NOT BE DIRECTED TOWARDS ADJACENT PROPERTY. **CONTRACTOR SHALL PROVIDE SUPPLEMENTAL AREA DRAINS, FRENCH DRAINS, AND DRY WELLS AS REQUIRED TO PROMOTE PROPER STORMWATER DRAINAGE, REFER TO SITE DETAILS.**
  - GENERAL CONTRACTOR SHALL PROVIDE STRUCTURAL SUBGRADE FOR DRIVEWAY. CONTRACTOR SHALL ADJUST GRADES TO PROVIDE POSITIVE DRAINAGE TO ROADWAY AND NATURAL AREAS.

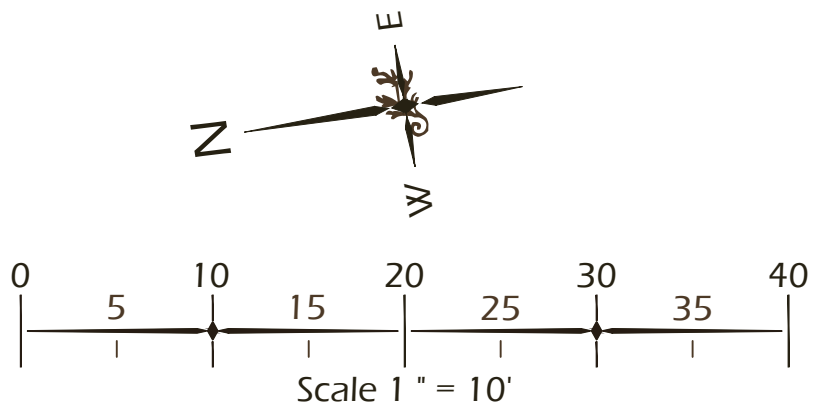

© 2023 WJK LTD.  
DESIGN CONCEPTS, DRAWING, SHEETS, LOGOS, SPECIFICATIONS, DETAILS, WRITTEN MATERIAL SHALL NOT BE USED OR REPRODUCED IN WHOLE OR IN PART IN ANY FORM WITHOUT PRIOR WRITTEN CONSENT OF WJK LTD.  
THIS SHEET TO SCALE AT: 24"X36"

SITE DEVELOPMENT PLANS  
FOR  
**SUOZZI RESIDENCE**  
BLUE CRAB STREET / LOT 24 (#7)  
TABBY RAODS / BLUFFTON, SOUTH CAROLINA

DATE:	JULY 24, 2023
PROJECT NO.:	XXXXXX
DRAWN BY:	MC
CHECKED BY:	DK

FINAL SUBMITTAL  
PLAN, NOT FOR  
CONSTRUCTION

REVISIONS:

DRAWING TITLE  
**GRADING PLAN**

DRAWING NUMBER

**L1**

CANOPY COVERAGE PLAN:

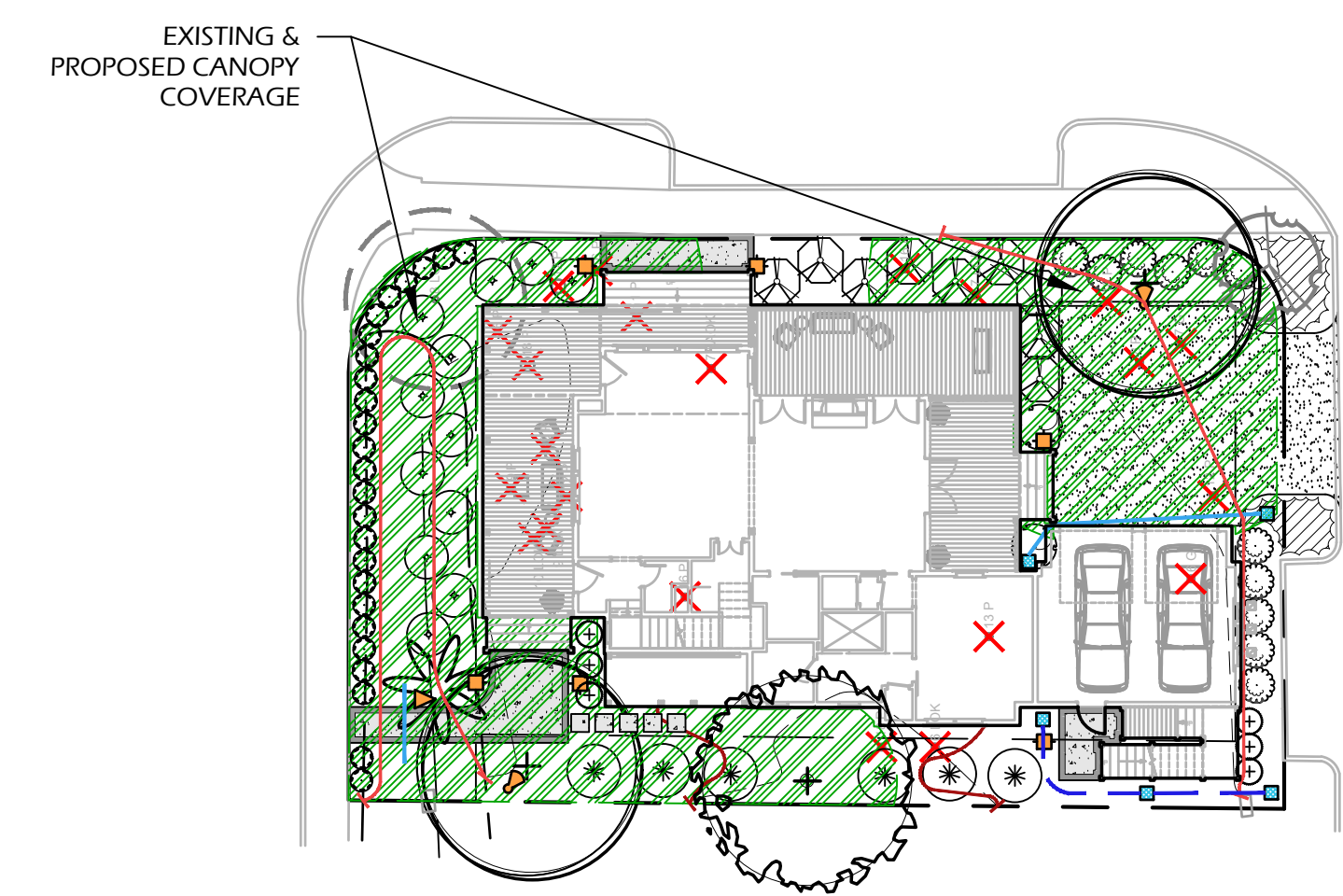

SCALE: 1" - 20'-0"

CANOPY COVERAGE TABLE	
DESCRIPTION	ACTUAL COVERAGE (SF)
TOTAL LIMIT OF WORK AREA	6,678 S.F.
BUILDING FOOTPRINT	±3,259 S.F.
REMAINING SITE AREA	3,419 S.F.
MATURE CANOPY COVERAGE (EXISTING AND PROPOSED)	2,606 S.F.
% CANOPY COVERAGE (75% MIN.)	76%

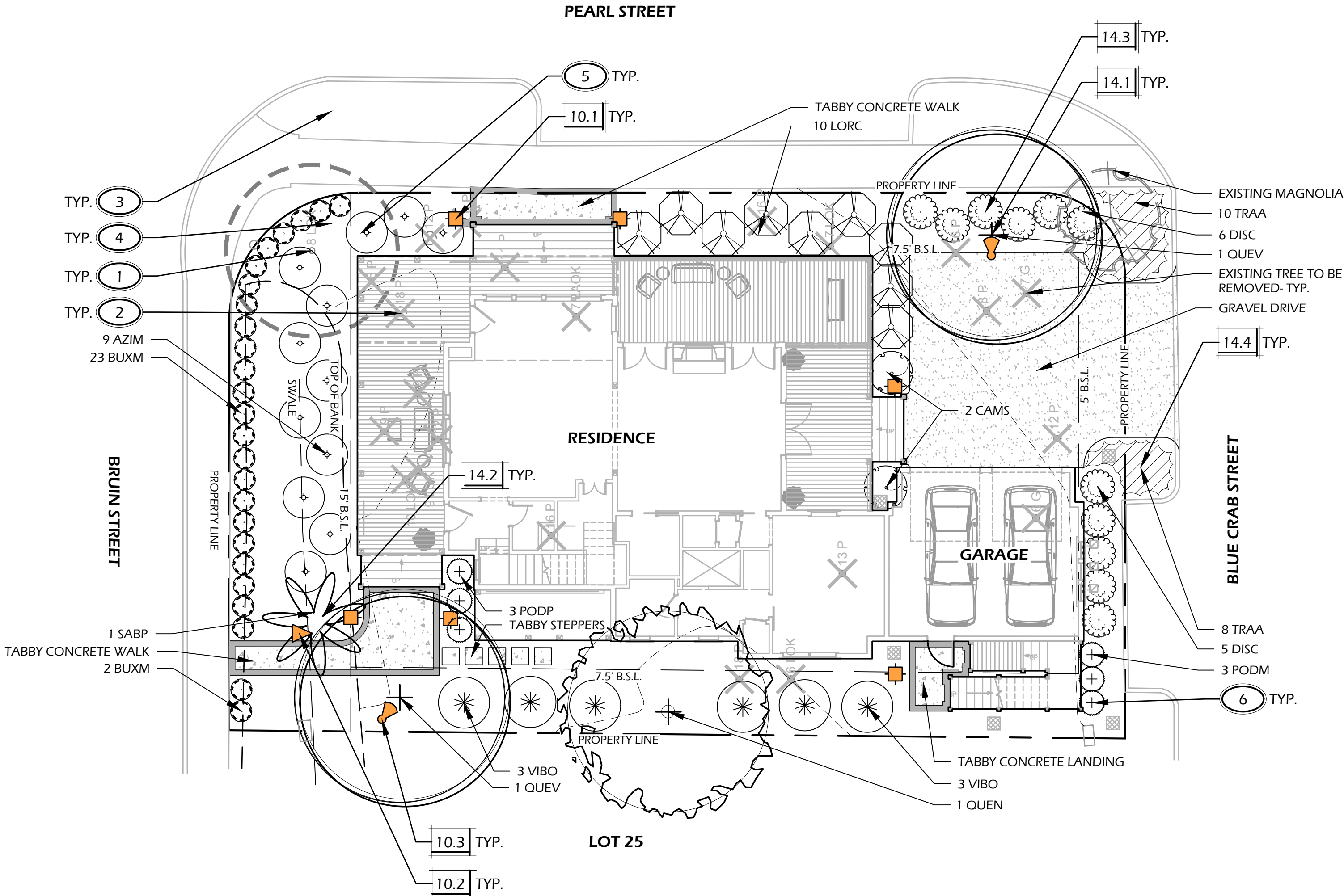

LIGHTING SCHEDULE				
CALL-OUT	SYMB.	QTY.	DESCRIPTION	DETAIL
10.1		6	PATH LIGHT	3/L4
10.2		1	NOSE LIGHT	4/L4
10.3		2	UP LIGHT	5/L4

NOTE: LIGHTING SYMBOLS ARE GRAPHIC IN NATURE AND ARE NOT INTENDED TO BE TO SCALE. REFER TO SITE DETAILS FOR SIZES AND DIMENSIONS.

PLANTING DETAILS		
CALL-OUT	DESCRIPTION	DETAIL
14.1	TREE PLANTING	1/L3
14.2	PALM TREE PLANTING	2/L3
14.3	SHRUB PLANTING	3/L3
14.4	GROUND COVER PLANTING	4/L3

PLANT KEY LEGEND

<b>TREES</b>		
QUEN	Quercus texana	Nuttall Oak
QUEV	Quercus virginiana	Live Oak
SABP	Sabal palmetto	Cabbage Palm
<b>UNDERSTORY TREES</b>		
ILEE	Ilex x attenuata 'East Palatka'	East Palatka Holly
<b>SHRUBS</b>		
AZIM	Azalea indica 'Mrs. G. G. Gerbing'	Mrs. G. G. Gerbing Azalea
BUXW	Buxus microphylla 'Wintergreen'	Wintergreen Boxwood
CAMS	Camellia sasanqua	Sasanqua Camellia
DISC	Distylium 'Coppertone' (PIIDIST-III PP25304)	Coppertone Distylium
LORC	Loropetalum chinense 'Chang Nian Hong'	Ever Red Fringe Flower
PODM	Podocarpus macrophyllus	Podocarpus
VIBO	Viburnum odoratissimum	Sweet Viburnum
<b>GROUND COVERS, VINES &amp; PERENNIALS</b>		
TRAA	Trachelospermum asiaticum	Asiatic Jasmine

PLANTING REFERENCE NOTES:

- EXISTING TREES TO REMAIN.
- EXISTING TREES TO BE REMOVED.
- CONTRACTOR SHALL REPAIR OR REPLACE ANY AND ALL GRASS DAMAGED DURING CONSTRUCTION.
- MULCH DISTURBED AREAS DUE TO CONSTRUCTION.
- CAREFULLY EXCAVATE SHRUB PITS IN VICINITY OF EXISTING TREES, WITHOUT DISTURBING TREE ROOTS.
- COORDINATE SHRUB LAYOUT WITH EXISTING UTILITIES. REPORT ANY CONFLICTS TO LANDSCAPE ARCHITECT.



© 2023 WJK LTD.  
DESIGN CONCEPTS, DRAWING, SHEETS, LOGOS, SPECIFICATIONS, DETAILS, WRITTEN MATERIAL SHALL NOT BE USED OR REPRODUCED IN WHOLE OR IN PART IN ANY FORM WITHOUT PRIOR WRITTEN CONSENT OF WJK LTD.  
THIS SHEET TO SCALE AT: 24"x36"

SITE DEVELOPMENT PLANS  
FOR  
**SUOZZI RESIDENCE**  
BLUE CRAB STREET / LOT 24 (#7)  
TABBY RAODS / BLUFFTON, SOUTH CAROLINA

DATE: JULY 24, 2023  
PROJECT NO.: XXXXX.XX  
DRAWN BY: MC  
CHECKED BY: DK

FINAL SUBMITTAL  
PLAN, NOT FOR  
CONSTRUCTION

REVISIONS:

DRAWING TITLE  
**LIGHTING AND PLANTING  
PLAN**

DRAWING NUMBER  
**L2**

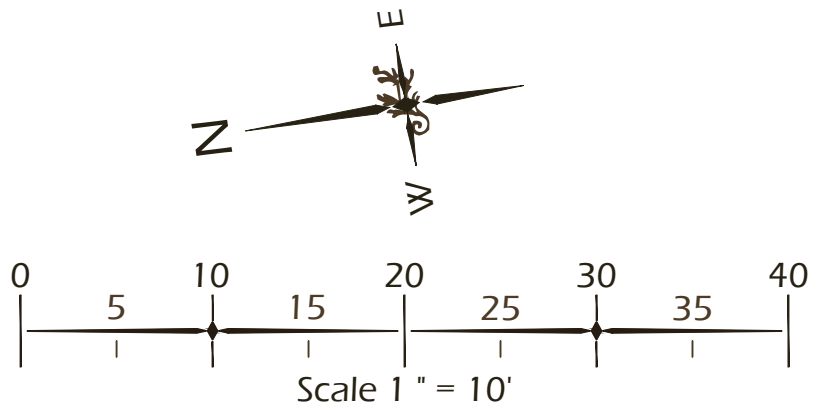

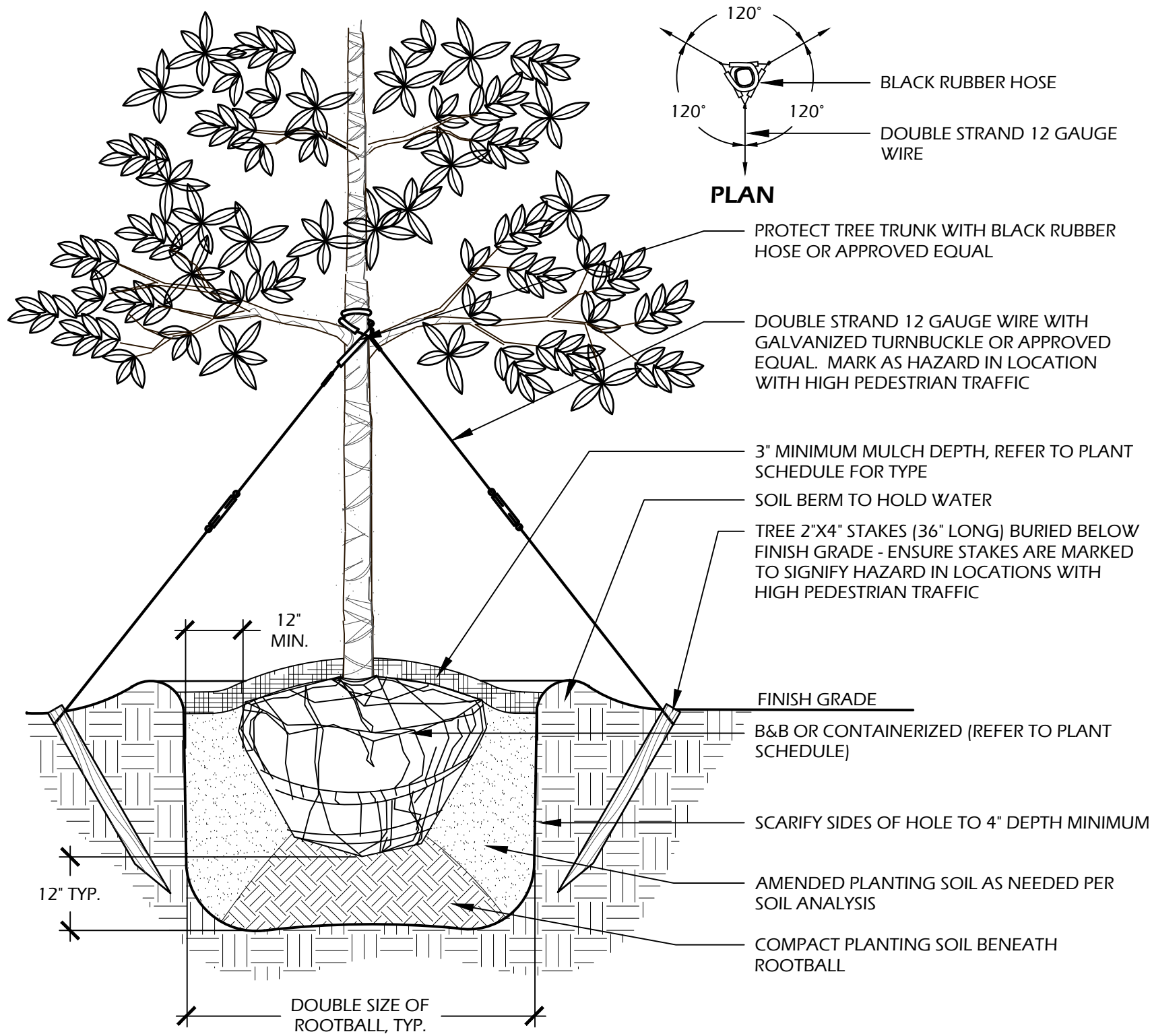

- NOTES:**
1. TREE STAKING OPTIONAL HOWEVER, LANDSCAPE CONTRACTOR RESPONSIBLE FOR MAINTAINING TREES IN AN UPRIGHT (90 DEGREE/ PERPENDICULAR) POSITION FOR 1 YEAR AFTER PLANTING IS COMPLETE OR UNTIL TREE ROOT SYSTEM IS FULLY ESTABLISHED AND STURDY. FINAL TREE STAKING DETAILS AND PLACEMENT TO BE APPROVED BY OWNER'S REPRESENTATIVE.
  2. CONTRACTOR SHALL ASSURE PERCOLATION OF ALL PLANTING PITS PRIOR TO INSTALLATION.
  3. IN SEMI-IMPERVIOUS SOIL CONDITIONS, ROOTBALL ELEVATION SHALL BE 2" ABOVE FINISH GRADE. COORDINATE WITH OWNER'S REPRESENTATIVE PRIOR TO SETTING ROOTBALL ELEVATIONS.

1 // L5 TREE PLANTING  
SCALE: N.T.S.

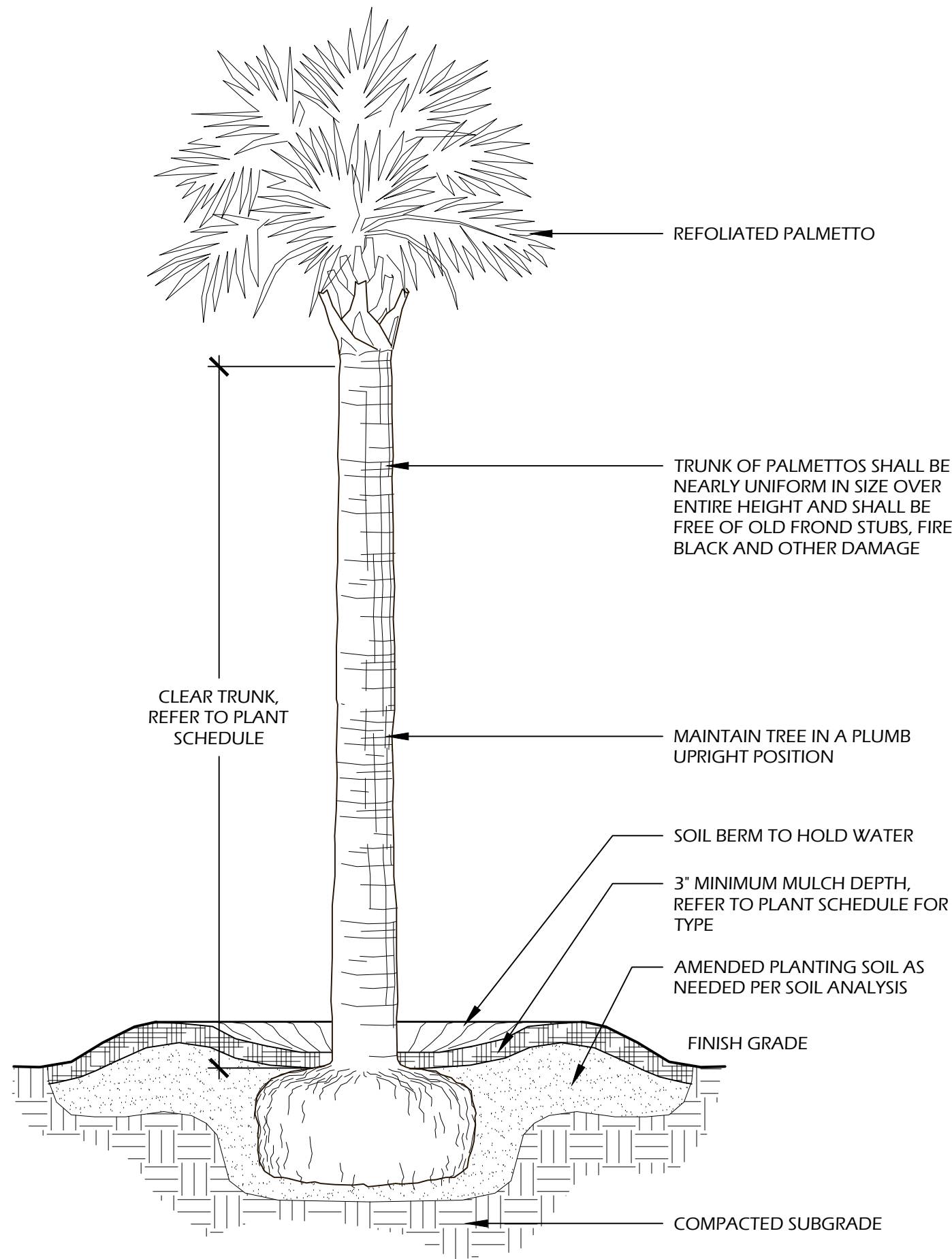

- NOTES:**
1. FINAL TREE STAKING DETAILS AND PLACEMENT TO BE APPROVED BY OWNER OR OWNER'S REPRESENTATIVE.
  2. CONTRACTOR SHALL ASSURE PERCOLATION OF ALL PLANTING PITS PRIOR TO INSTALLATION.
  3. SABAL PALMETTOS SHALL BE REFOLIATED, PROTECT CABBAGE HEAD FROM DAMAGE.

2 // L5 PALM TREE PLANTING  
SCALE: N.T.S.

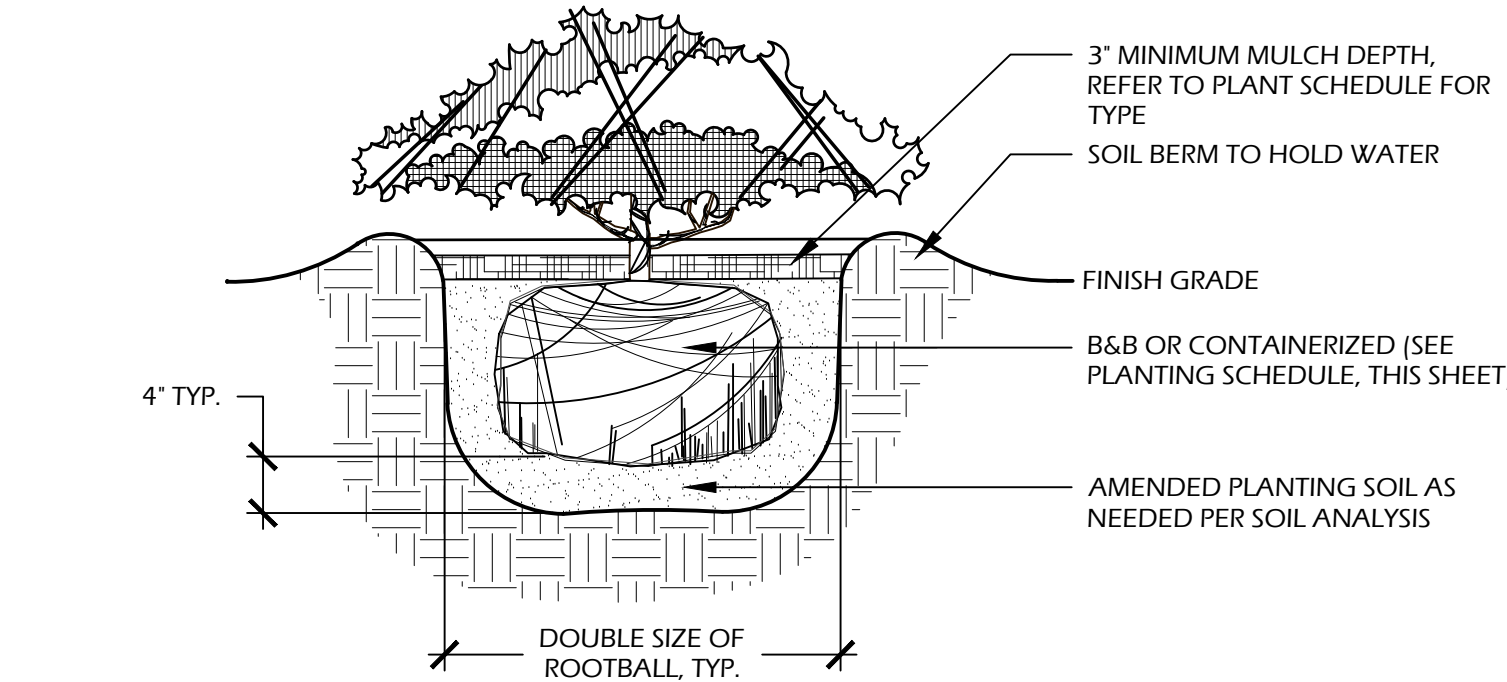

- NOTES:**
1. WHEN GROUNDCOVERS AND SHRUBS ARE USED IS MASSES, ENTIRE BED TO BE EXCAVATED TO RECEIVE PLANTING SOIL AND PLANT MATERIAL.
  2. CONTRACTOR SHALL ASSURE PERCOLATION OF ALL PLANTING PITS PRIOR TO INSTALLATION.
  3. IN SEMI-IMPERVIOUS SOIL CONDITIONS, ROOTBALL ELEVATION SHALL BE ±2" ABOVE FINISH GRADE. COORDINATE WITH OWNER'S REPRESENTATIVE PRIOR TO SETTING ROOTBALL ELEVATIONS.

3 // L5 SHRUB PLANTING  
SCALE: N.T.S.

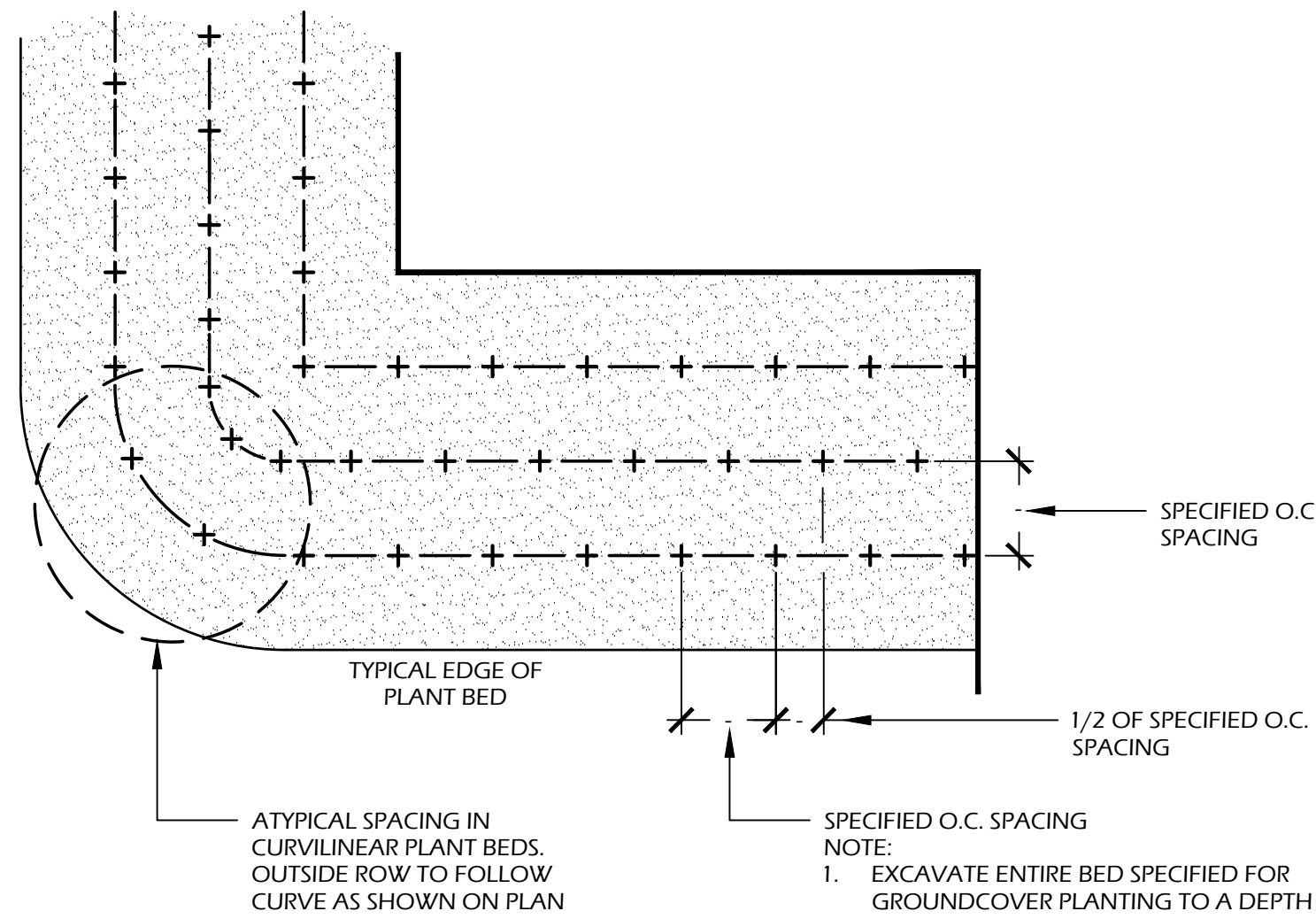

- NOTES:**
1. EXCAVATE ENTIRE BED SPECIFIED FOR GROUND COVER PLANTING TO A DEPTH OF 12"

4 // L5 GROUND COVER PLANTING  
SCALE: N.T.S.

PLANT SCHEDULE:

Quantity	Abbrev	Botanical Name	Common Name	Height	Spread	Container	Cal./Spacing	Notes
<b>TREES</b>								
1	QUEN	Quercus texana	Nuttall Oak	14'-16'	6'-8'	Cont.	4"	Full
2	QUEV	Quercus virginiana	Live Oak	14'-16'	6'-8'	Cont.	4"	Full
1	SABP	Sabal palmetto	Cabbage Palm	12'-16'	-	Cont.	-	Refoliated, full clear trunk, refer to plan for heights
<b>UNDERSTORY TREES</b>								
1	ILEE	Ilex x attenuata 'East Palatka'	East Palatka Holly	6'-7'	3'-4'	15 gal.	-	Full
<b>SHRUBS</b>								
12	AZIM	Azalea indica 'Mrs. G. G. Gerbing'	Mrs. G. G. Gerbing Azalea	30'-36"	24'-30"	7 gal.	-	Full
25	BUXW	Buxus microphylla 'Wintergreen'	Wintergreen Boxwood	12'-18"	12'-18"	7 gal.	-	Full
2	CAMS	Camellia sasanqua	Sasanqua Camellia	3'-4'	2'-3'	15 gal.	-	Full
11	DISC	Distylium 'Coppertone' (PIDIST-H PP25304)	Coppertone Distylium	24'-30"	24'-30"	7 gal.	-	Full
10	LORC	Loropetalum chinense 'Chang Nian Hong'	Ever Red Fringe Flower	30'-36"	24'-30"	7 gal.	-	Full
6	PODM	Podocarpus macrophyllus	Podocarpus	36'-42"	24'-30"	15 gal.	-	Full
6	VIBO	Viburnum odoratissimum	Sweet Viburnum	30'-36"	24'-30"	7 gal.	-	Full
<b>GROUND COVERS, VINES &amp; PERENNIALS</b>								
18	TRAA	Trachelospermum asiaticum	Asiatic Jasmine	4'-6"	12" runners	1 gal.	18" O.C.	Full
<b>SOD &amp; MULCH</b>								
1,200	MULCHSF	Pine Straw - all disturbed areas	Pine Straw	-	-	-	-	-

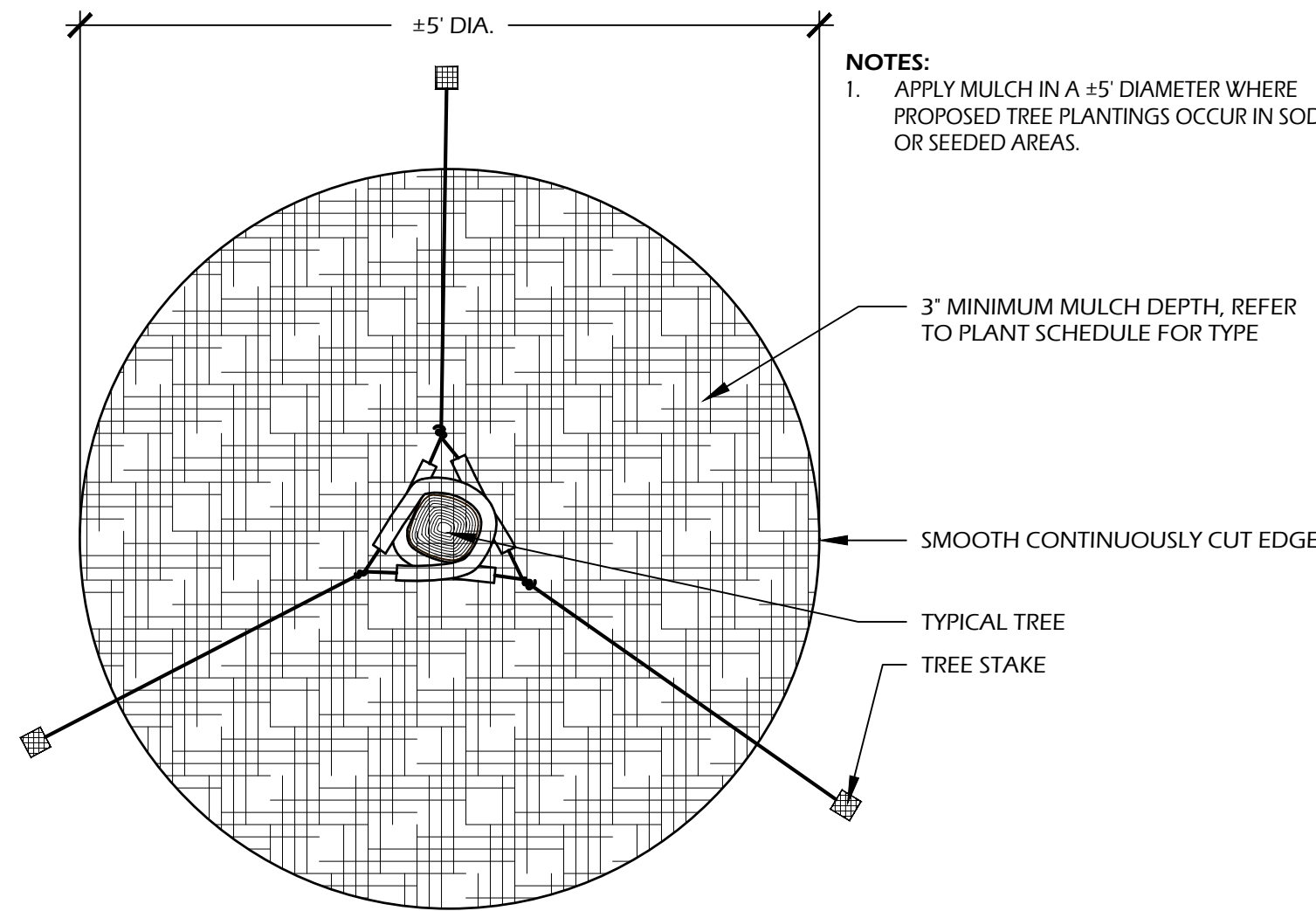

- NOTES:**
1. APPLY MULCH IN A ±5' DIAMETER WHERE PROPOSED TREE PLANTINGS OCCUR IN SOD OR SEEDED AREAS.

- 3" MINIMUM MULCH DEPTH, REFER TO PLANT SCHEDULE FOR TYPE
- SMOOTH CONTINUOUSLY CUT EDGE
- TYPICAL TREE
- TREE STAKE

5 // L5 TREE STAKING  
SCALE: N.T.S.

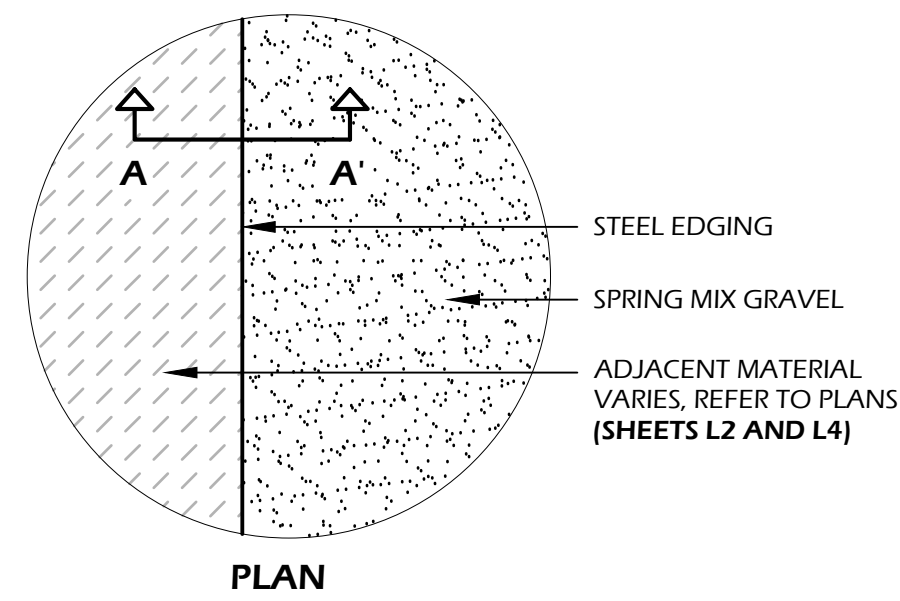

**EDGING AND STAKE INFORMATION:**  
**MANUFACTURER:**  
BORDER CONCEPTS, INC.  
7621 LITTLE AVE., SUITE 426  
CHARLOTTE, NC 28226  
**PHONE:** (800) 845.3343  
**WEB:** WWW.BORDERCONCEPTS.COM

**STEEL EDGE:** BORDER GUARD 3/16" X 4" X 16"  
**STAKES:** STANDARD STAKE 3/16" THICK X 15" LONG (6 PER 16')  
**COLOR:** BLACK

**NOTE:** INSTALL FLUSH PER MANUFACTURES SPECIFICATIONS

**OTHER INFORMATION:**  
**GEOTEXTILE FABRIC:** TYPAR 3401 OR APPROVED EQUAL  
**SOIL COMPACTION:** 95% STANDARD PROCTOR

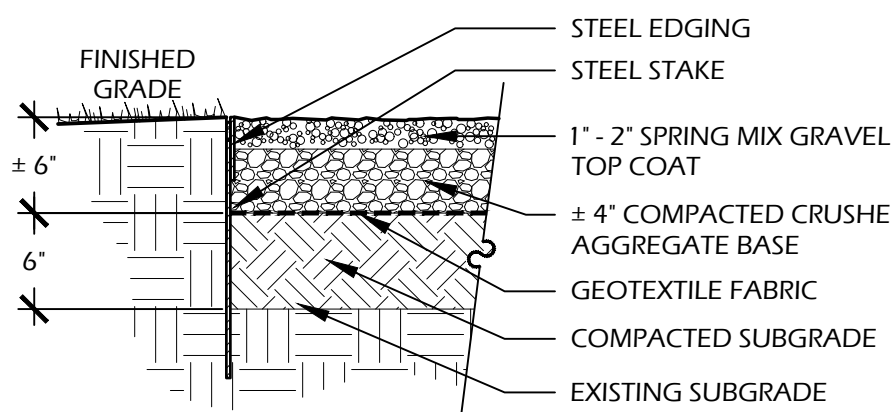

SECTION A-A'

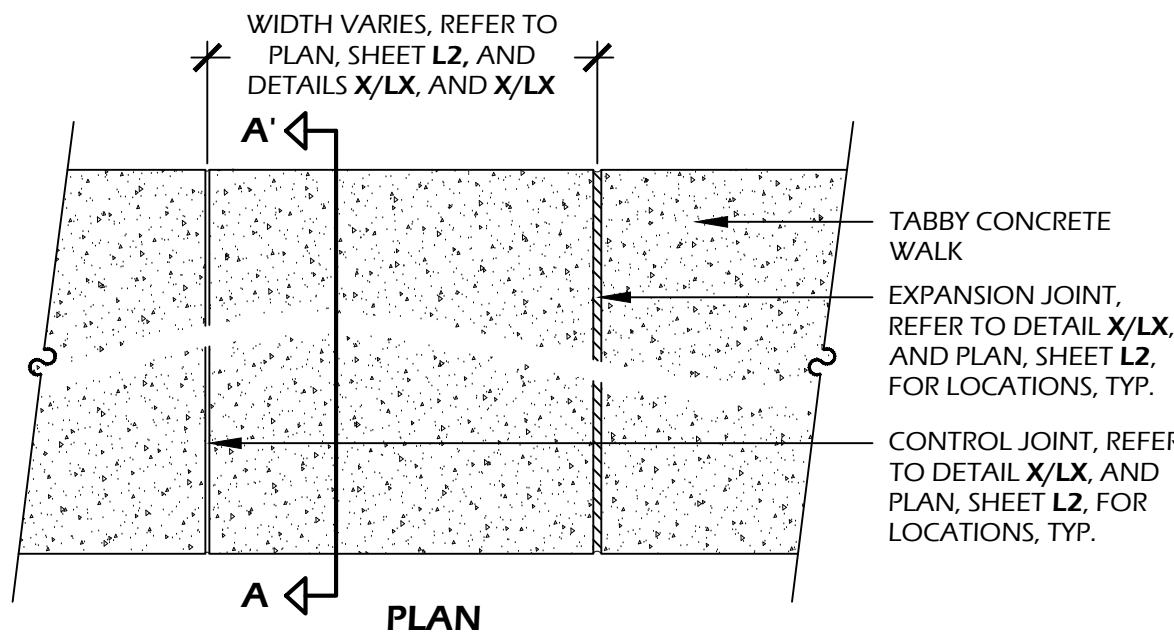

**CONCRETE INFORMATION:**  
**CONCRETE:** 3,000 P.S.I. AT 28 DAYS  
**FINISH:** TABBY SHELL

**SOIL INFORMATION:**  
**SOIL COMPACTION:** 95% STANDARD PROCTOR

**TABBY SPEC:**  
1. SHELL FINISH SHALL BE OYSTER SHELL MIX [EQUAL PARTS, SIZE #2, AND #3] HAND THROWN / SPREAD TO 100% COVERAGE ON FRESH POURED AND LEVELED CONCRETE.  
2. HAND FLOAT UNTIL SHELL IS SUBMERGED, THEN AFTER 90% CURED, LIGHTLY PRESSURE WASH UNTIL SHELL IS EXPOSED.

**NOTES:**  
1. PROVIDE 1% MIN., 2% MAX. CROSS SLOPE ON ALL PAVED SURFACES FOR POSITIVE DRAINAGE.  
2. REFER TO PLAN [SHEET L2] FOR WIDTHS OF WALK.  
3. CONSTRUCT EXPANSION JOINTS WHERE WALK MEETS CURBS, STEPS, WALLS OR FIXED SLABS.  
4. UPON REQUEST, CONTRACTOR SHALL PROVIDE 4'X4' SAMPLE OF CONCRETE WITH 2 SIZES OF OYSTER SHELL FINISH FOR APPROVAL BY OWNER OR LANDSCAPE ARCHITECT.

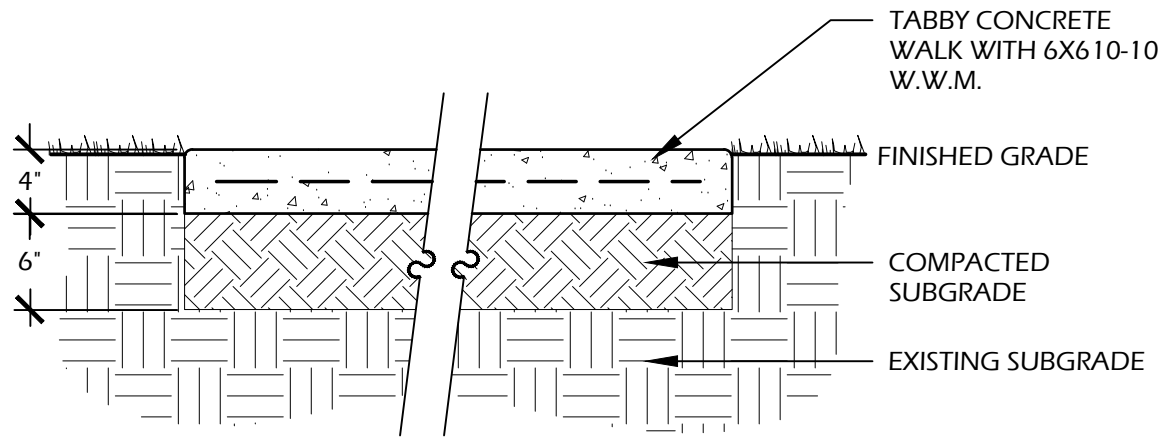

SECTION A-A'

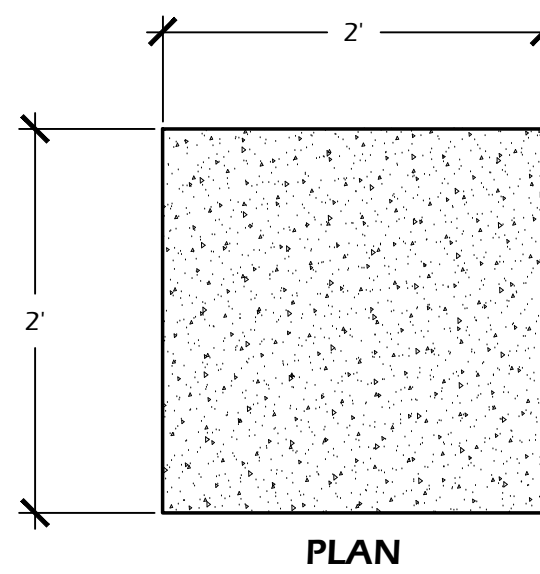

**CONCRETE INFORMATION:**  
**CONCRETE:** CAST IN PLACE, 3,000 P.S.I. AT 28 DAYS  
**FINISH:** TABBY SHELL

**TABBY SPEC:**  
1. SHELL FINISH SHALL BE OYSTER SHELL MIX [EQUAL PARTS, SIZE #2, AND #3] HAND THROWN / SPREAD TO 100% COVERAGE ON FRESH POURED AND LEVELED CONCRETE.  
2. HAND FLOAT UNTIL SHELL IS SUBMERGED, THEN AFTER 90% CURED, LIGHTLY PRESSURE WASH UNTIL SHELL IS EXPOSED.

**SOIL INFORMATION:**  
**SOIL COMPACTION:** 95% STANDARD PROCTOR

**NOTES:**  
1. PROVIDE 1% MIN., 2% MAX. CROSS SLOPE ON ALL PAVED SURFACES FOR POSITIVE DRAINAGE.  
2. UPON REQUEST, CONTRACTOR SHALL PROVIDE 2'X2' SAMPLE OF CONCRETE WITH 2 SIZES OF OYSTER SHELL FINISH FOR APPROVAL BY OWNER OR LANDSCAPE ARCHITECT.

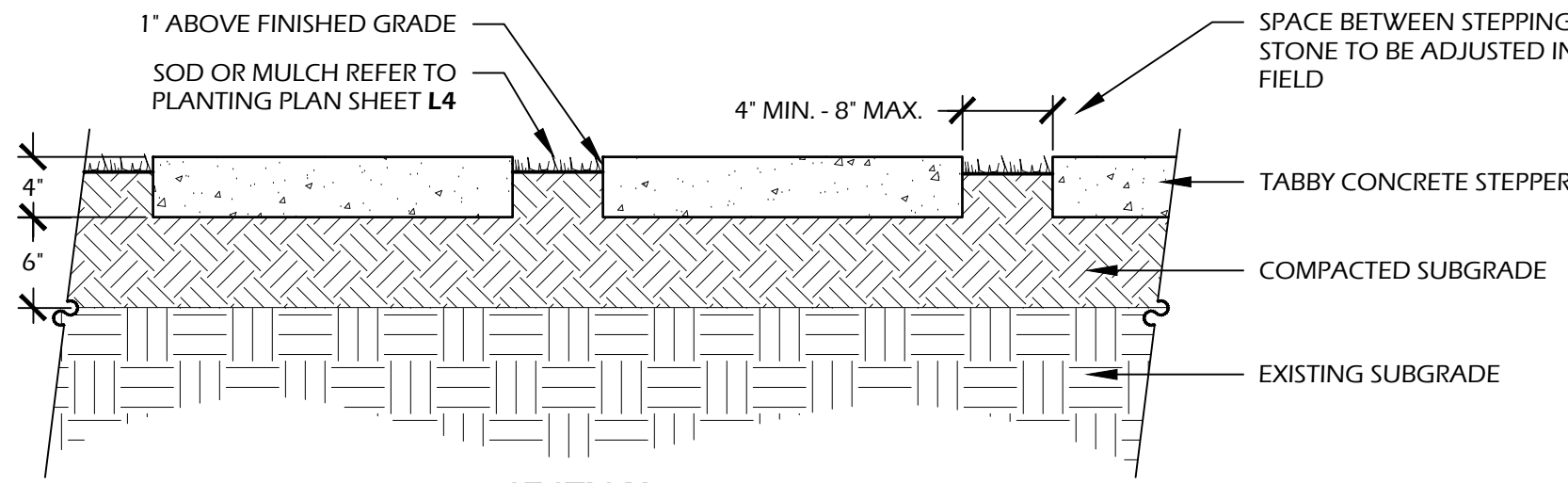

SECTION

1 // L4 GRAVEL DRIVE  
SCALE: 1" = 1' - 0"

2 // L4 TABBY CONCRETE WALK  
SCALE: 1" = 1' - 0"

3 // L4 TABBY STEPPERS  
SCALE: 1" = 1' - 0"

PRODUCT SPECIFICATION SHEET

**NITE-103**

**LED OPTIONS:**

- NITE-140B SC Bayonet
  - Energy Savings - 1.5 Watts
  - Long Life - 40,000 Hrs
  - Color: Warm White
  - Color Temp: 2700°K
  - Luminous Flux: 61-70lm
- NITE-140A SC Bayonet Clear Glass Cover
  - Energy Savings - 2.6 Watts
  - Long Life - 40,000 Hrs
  - Color: Warm White
  - Color Temp: 2700°K
  - Luminous Flux: 61-70lm
- NITE-140B SC Bayonet Opaque Glass Cover
  - Energy Savings - 1.8 Watts
  - Long Life - 40,000 Hrs
  - Color: Warm White
  - Color Temp: 2700°K
  - Luminous Flux: 61-70lm

**SPECIFICATIONS:**

MODEL: NITE-103  
MOUNTING: 1/2" NPT  
FINISH: Copper  
SOCKET: Single Contact Bayonet  
ELECTRICAL: 12V  
LED: 1.5W/2.6W/1.8W Bayonet

**PRODUCT DESCRIPTION / APPLICATIONS:**

Designed to provide safety and direction around pool areas, sidewalks, driveway, and steps. Also used to highlight low ground cover. Ideal for residential and commercial garden settings.

**NOTES:**

Replacement Glass for the Copper Path Light is NITE-103 A.

**MOUNTING ACCESSORY:**

NITE-124 A Replacement Glass

**COMMERCIAL STAKE:** NITE-124 A

**BASE DESIGN: NITE-103**

**DATE: 11/20/19**

**NiteLites** Sustainable Outdoor LEDs

**CREE**

**5107 Market Ave., Franklin, OH 45005**  
Tel: (513) 424-5510 Fax: (513) 424-5542  
www.nitelites.com

PRODUCT SPECIFICATION SHEET

**NITE-025DL**

**LED OPTIONS:**

- NITE-4298BW MR-16
  - Long Life - 40,000 Hrs
  - Energy Savings - 3 Watts
  - Color: Warm White
  - Color Temp: 2700°K
  - Luminous Flux: 280lm
  - Beam Angle: 40°
- NITE-4298BW MR-16
  - Long Life - 40,000 Hrs
  - Energy Savings - 5 Watts
  - Color: Warm White
  - Color Temp: 2700°K
  - Luminous Flux: 490lm
  - Beam Angle: 40°
- NITE-4298BW MR-16
  - Long Life - 40,000 Hrs
  - Energy Savings - 7 Watts
  - Color: Warm White
  - Color Temp: 2700°K
  - Luminous Flux: 650lm
  - Beam Angle: 40°
- NITE-4298BW MR-16
  - Long Life - 40,000 Hrs
  - Energy Savings - 5 Watts
  - Color: Bright White
  - Color Temp: 5000°K
  - Luminous Flux: 490lm
  - Beam Angle: 40°

**SPECIFICATIONS:**

MODEL: NITE-025DL (Down Light)  
MOUNTING: 1/2" NPT  
FINISH: Aged Brass  
SOCKET: All Weather Ceramic  
ELECTRICAL: 12V  
LED: 3W, 5W or 7W MR-16 LED

**PRODUCT DESCRIPTION / APPLICATIONS:**

Angled cut down light is designed to down light larger trees, flag poles, and also can be used to down light large areas such as a sports court.

**Includes mounting base.**

**Adjustable/Knuckle**

**BASE DESIGN: NITE-025DL**

**DATE: 11/20/19**

**NiteLites** Sustainable Outdoor LEDs

**CREE**

**5107 Market Ave., Franklin, OH 45005**  
Tel: (513) 424-5510 Fax: (513) 424-5542  
www.nitelites.com

PRODUCT SPECIFICATION SHEET

**NITE-004**

**LED OPTIONS:**

- NITE-4298BW MR-16
  - Long Life - 40,000 Hrs
  - Energy Savings - 3 Watts
  - Color: Warm White
  - Color Temp: 2700°K
  - Luminous Flux: 280lm
  - Beam Angle: 40°
- NITE-4298BW MR-16
  - Long Life - 40,000 Hrs
  - Energy Savings - 5 Watts
  - Color: Warm White
  - Color Temp: 2700°K
  - Luminous Flux: 490lm
  - Beam Angle: 40°
- NITE-4298BW MR-16
  - Long Life - 40,000 Hrs
  - Energy Savings - 7 Watts
  - Color: Warm White
  - Color Temp: 2700°K
  - Luminous Flux: 650lm
  - Beam Angle: 40°
- NITE-4298BW MR-16
  - Long Life - 40,000 Hrs
  - Energy Savings - 5 Watts
  - Color: Bright White
  - Color Temp: 5000°K
  - Luminous Flux: 490lm
  - Beam Angle: 40°

**SPECIFICATIONS:**

MODEL: NITE-004  
MOUNTING: 1/2" NPT  
FINISH: Aged Brass  
SOCKET: All Weather Ceramic  
ELECTRICAL: 12V  
LED: 3W, 5W or 7W MR-16  
OTHER FINISH: Antique Iron - NITE114  
SOP: Custom finishes available upon request

**PRODUCT DESCRIPTION / APPLICATIONS:**

Designed to up light and down light larger trees, flag poles, and also can be used to down light large areas such as a sports court.

**Includes mounting base.**

**Adjustable/Knuckle**

**BASE DESIGN: NITE-004**

**DATE: 11/20/19**

**NiteLites** Sustainable Outdoor LEDs

**CREE**

**5107 Market Ave., Franklin, OH 45005**  
Tel: (513) 424-5510 Fax: (513) 424-5542  
www.nitelites.com

4 // L4 PATH LIGHT  
SCALE: N.T.S.

5 // L4 DOWN LIGHT  
SCALE: N.T.S.

6 // L4 UP LIGHT  
SCALE: N.T.S.

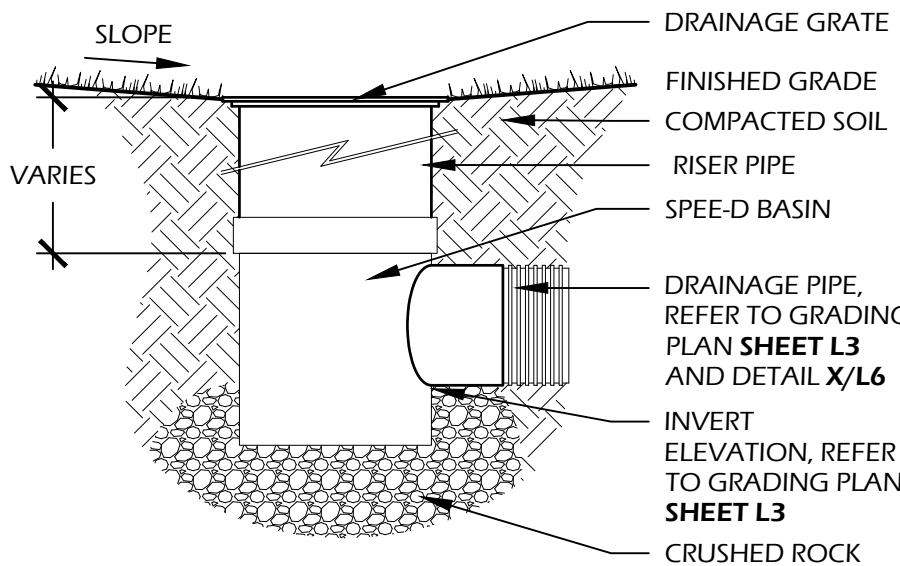

**MANUFACTURER INFO:**  
NATIONAL DIVERSIFIED SALES, INC.  
851 N. HARVARD AVE.  
LINDSAY, CA 93247  
**PHONE:** (800) 726.1994  
**WEB:** WWW.NDSPRO.COM

**DRAINAGE GRATE:** #40, 6" ROUND GRATE  
**PIPE INFO:** STRUCTURAL FOAM POLYOLEFIN GRATE WITH U.V. INHIBITOR

**CATCH BASIN:** #101, 6" ROUND SPEED-BASIN WITH 3" AND 4" LOCKING OUTLET  
**PIPE INFO:** STRUCTURAL FOAM POLYOLEFIN GRATE WITH U.V. INHIBITOR

**RISER:** #66, 6" SEWER AND DRAIN RISER PIPE, LENGTH AND USE AS REQUIRED

**558-187 / 558-192**  
PROTECTED BY COPYRIGHT ©2015 CADDETAILS.COM LTD.  
REVISION DATE 09/23/2015  
CADDETAILS.COM

**KEY COMPONENT**  
www.ndspro.com

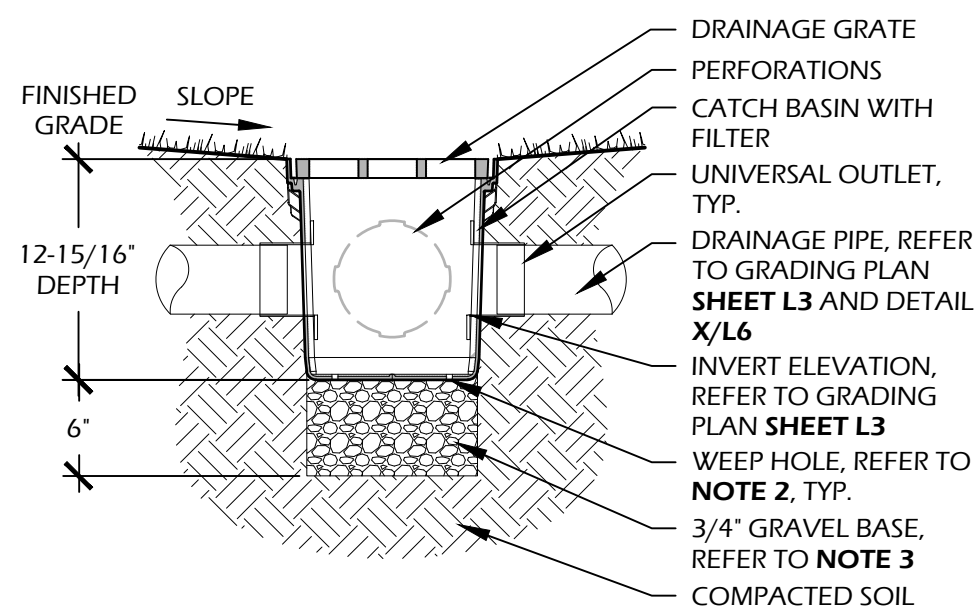

**MANUFACTURER INFO:**  
NATIONAL DIVERSIFIED SALES, INC.  
851 N. HARVARD AVE.  
LINDSAY, CA 93247  
**PHONE:** (800) 726.1994  
**WEB:** WWW.NDSPRO.COM

**DRAINAGE GRATE:** #1211, 12"X12" SQUARE GRATE  
**GRATE COLOR:** BLACK  
**GRATE INFO:** STRUCTURAL FOAM POLYOLEFIN GRATE WITH U.V. INHIBITOR

**CATCH BASIN:** #1200, 12"X12" CATCH BASIN, 2 OPENINGS  
**BASIN COLOR:** BLACK  
**BASIN INFO:** POLYOLEFIN TAPERED CATCH BASIN WITH U.V. INHIBITORS

**FILTER:** #1200FF, 12" CATCH BASIN FILTER  
**FILTER COLOR:** BLUE FRAME / BLACK BAG

**UNIVERSAL OUTLET:** #1266, 6" UNIVERSAL LOCKING OUTLET AND #1206, 6" UNIVERSAL ADAPTER PLUG  
**OUTLET COLOR:** BLACK  
**OUTLET INFO:** STYRENE, USE ADAPTER PLUG AS REQUIRED (WHERE ONLY ONE DRAIN LINE RUNS INTO CATCH BASIN)

**RISER:** #1216, 12"X12" CATCH BASIN RISER, BLACK, STYRENE, USE AS REQUIRED

**NOTES:**  
1. THIS DETAIL IS USED FOR DESIGN INTENT ONLY. REFER TO TO MANUFACTURERS DETAIL AND SPECIFICATIONS FOR ACTUAL INSTALLATION.  
2. DRILL WEEP HOLE TYPICAL OF 4 PLACES AT BOTTOM CORNERS.  
3. GRAVEL BASE SHALL BE USED TO PREVENT STANDING WATER.  
4. GRATE TO BE ATTACHED TO CATCH BASIN WITH SCREW(S) PROVIDED AT TIME OF INSTALLATION.  
5. RISER (IF NEEDED) CAN BE CUT TO ACHIEVE EXACT ELEVATION. DO NOT USE OVER FIVE (5) RISERS WITH CATCH BASIN.  
6. N.D.S. ADAPTERS THAT FIT THIS CATCH BASIN ARE AS FOLLOWS: #1242, #1243, #1245, #1266, AND #1889. USE #1206 IF PLUGGING AN OUTLET.  
7. PERFORATION ON NON OPEN SIDES AND BOTTOM TO BE CUT OUT WHEN ADDING EXTRA OUTLETS.  
8. EXISTING SOILS SHOULD BE EVALUATED TO ENSURE PROPER STRUCTURAL AND PERMEABILITY PROPERTIES.  
9. DO NOT SCALE DRAWING.  
10. THIS DRAWING IS INTENDED FOR USE BY ARCHITECTS, ENGINEERS, CONTRACTORS, CONSULTANTS AND DESIGN PROFESSIONALS FOR PLANNING PURPOSES ONLY.  
11. ALL INFORMATION CONTAINED HEREIN WAS CURRENT AT THE TIME OF DEVELOPMENT BUT MUST BE REVIEWED AND APPROVED BY THE PRODUCT MANUFACTURER TO BE CONSIDERED ACCURATE.  
12. CONTRACTORS NOTE: FOR PRODUCT AND COMPANY INFORMATION VISIT WWW.CADDETAILS.COM/INFO AND ENTER REFERENCE NUMBER 558-187 AND / OR 558-192.

**558-187 / 558-192**  
PROTECTED BY COPYRIGHT ©2015 CADDETAILS.COM LTD.  
REVISION DATE 09/23/2015  
CADDETAILS.COM

**KEY COMPONENT**  
www.ndspro.com

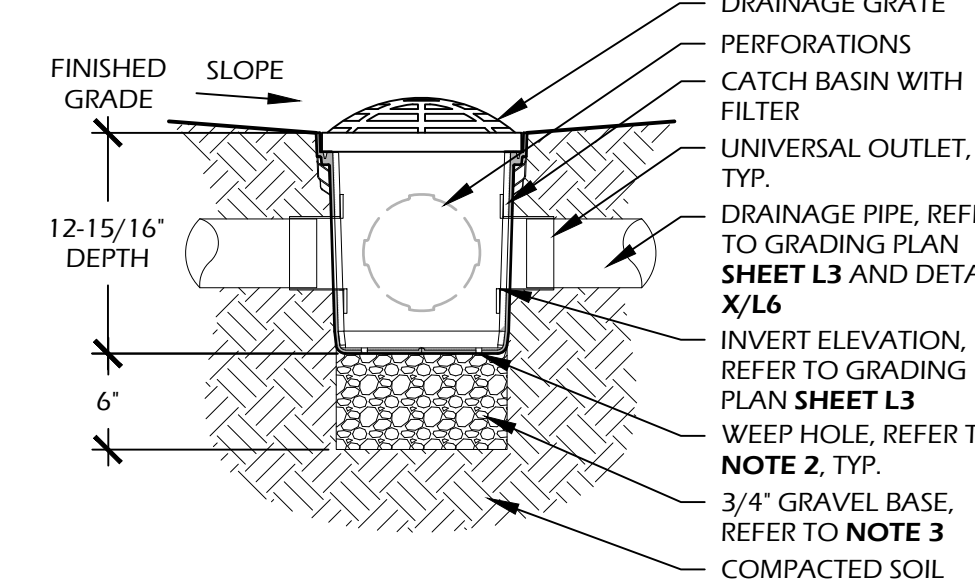

**MANUFACTURER INFO:**  
NATIONAL DIVERSIFIED SALES, INC.  
851 N. HARVARD AVE.  
LINDSAY, CA 93247  
**PHONE:** (800) 726.1994  
**WEB:** WWW.NDSPRO.COM

**DRAINAGE GRATE:** #1290, 12"X12" ATRIUM GRATE  
**GRATE COLOR:** BLACK  
**GRATE INFO:** STRUCTURAL FOAM POLYOLEFIN DOME ATRIUM GRATE WITH U.V. INHIBITOR

**CATCH BASIN:** #1200, 12"X12" CATCH BASIN, 2 OPENINGS  
**BASIN COLOR:** BLACK  
**BASIN INFO:** POLYOLEFIN TAPERED CATCH BASIN WITH U.V. INHIBITORS

**FILTER:** #1200FF, 12" CATCH BASIN FILTER  
**FILTER COLOR:** BLUE FRAME / BLACK BAG

**UNIVERSAL OUTLET:** #1266, 6" UNIVERSAL LOCKING OUTLET AND #1206, 6" UNIVERSAL ADAPTER PLUG  
**OUTLET COLOR:** BLACK  
**OUTLET INFO:** STYRENE, USE ADAPTER PLUG AS REQUIRED (WHERE ONLY ONE DRAIN LINE RUNS INTO CATCH BASIN)

**RISER:** #1216, 12"X12" CATCH BASIN RISER, BLACK, STYRENE, USE AS REQUIRED

**NOTES:**  
1. THIS DETAIL IS USED FOR DESIGN INTENT ONLY. REFER TO TO MANUFACTURERS DETAIL AND SPECIFICATIONS FOR ACTUAL INSTALLATION.  
2. DRILL WEEP HOLE TYPICAL OF 4 PLACES AT BOTTOM CORNERS.  
3. GRAVEL BASE SHALL BE USED TO PREVENT STANDING WATER.  
4. GRATE TO BE ATTACHED TO CATCH BASIN WITH SCREW(S) PROVIDED AT TIME OF INSTALLATION.  
5. RISER (IF NEEDED) CAN BE CUT TO ACHIEVE EXACT ELEVATION. DO NOT USE OVER FIVE (5) RISERS WITH CATCH BASIN.  
6. N.D.S. ADAPTERS THAT FIT THIS CATCH BASIN ARE AS FOLLOWS: #1242, #1243, #1245, #1266, AND #1889. USE #1206 IF PLUGGING AN OUTLET.  
7. PERFORATION ON NON OPEN SIDES AND BOTTOM TO BE CUT OUT WHEN ADDING EXTRA OUTLETS.  
8. EXISTING SOILS SHOULD BE EVALUATED TO ENSURE PROPER STRUCTURAL AND PERMEABILITY PROPERTIES.  
9. DO NOT SCALE DRAWING.  
10. THIS DRAWING IS INTENDED FOR USE BY ARCHITECTS, ENGINEERS, CONTRACTORS, CONSULTANTS AND DESIGN PROFESSIONALS FOR PLANNING PURPOSES ONLY.  
11. ALL INFORMATION CONTAINED HEREIN WAS CURRENT AT THE TIME OF DEVELOPMENT BUT MUST BE REVIEWED AND APPROVED BY THE PRODUCT MANUFACTURER TO BE CONSIDERED ACCURATE.  
12. CONTRACTORS NOTE: FOR PRODUCT AND COMPANY INFORMATION VISIT WWW.CADDETAILS.COM/INFO AND ENTER REFERENCE NUMBER 558-187 AND / OR 558-192.

**DATE:** JULY 24, 2023  
**PROJECT NO.:** XXXXXX  
**DRAWN BY:** MC  
**CHECKED BY:** DK

**FINAL SUBMITTAL PLAN, NOT FOR CONSTRUCTION**

**REVISIONS:**

**DRAWING TITLE**  
**SITE DETAILS**

**DRAWING NUMBER**

L4

**Winter Jones-Heefer Ltd.**  
landscape architecture  
land planning  
www.wjkltd.com

© 2023 WJK LTD.  
DESIGN CONCEPTS, DRAWING, SHEETS, LOGOS, SPECIFICATIONS, DETAILS, WRITTEN MATERIAL SHALL NOT BE USED OR REPRODUCED IN WHOLE OR IN PART IN ANY FORM WITHOUT PRIOR WRITTEN CONSENT OF WJK LTD.  
THIS SHEET TO SCALE AT: 24"X36"

589 Promenade Street, Suite 201 | Bluffton, South Carolina 29910 | ph 843.797.7411

**SITE DEVELOPMENT PLANS FOR**  
**SUOZZI RESIDENCE**  
BLUE CRAB STREET / LOT 24 (#7)  
TABBY RAODS / BLUFFTON, SOUTH CAROLINA

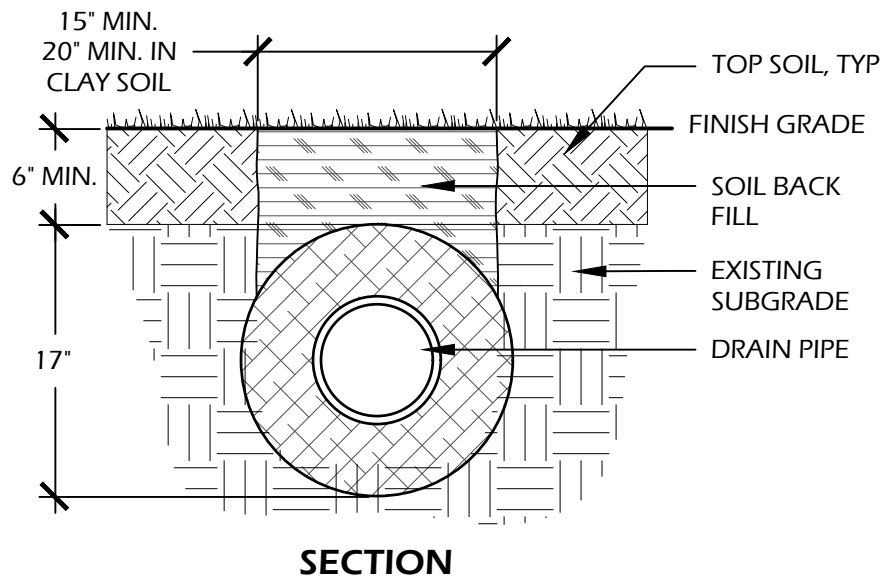

**MANUFACTURER INFO:**  
NATIONAL DIVERSIFIED SALES, INC.  
851 N. HARVARD AVE.  
LINDSAY, CA 93247  
PHONE: (800) 726.1994  
WEB: WWW.NDSPRO.COM

**PIPE:** 17" MESH WITH 8" CORRUGATED PERFORATED PIPE  
**PIPE COLOR:** BLACK  
**PIPE INFO:** POLYETHYLENE SLOTTED DRAIN PIPE SURROUNDED BY 100% RECYCLED POLYSTYRENE AGGREGATE AND ENCLOSED IN 30-SIEVE POLYETHYLENE GEOTEXTILE MESH

**COUPLING:** 8" CORRUGATED INTERNAL COUPLING, AS REQUIRED  
**COUPLING COLOR:** BLACK  
**END CAP:** 8" CORRUGATED END CAP, AS REQUIRED.  
**END CAP COLOR:** BLACK



**SOIL INFO:**  
**SOIL BACK FILL:** TOP SOIL BACK FILL, OR GRAVEL WITH 3" TOP SOIL IN CLAY AREAS

**STORAGE AND FLOW INFO:**

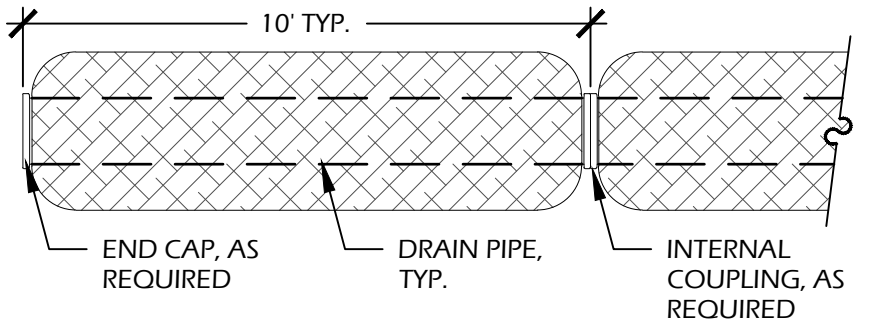

- NOTES:**
1. INSTALL PER MANUFACTURER'S SPECIFICATIONS.
  2. ADDITIONAL COVER MAY BE REQUIRED BASED ON SITE CONDITIONS.
  3. 12' COVER REQUIRED TO OBTAIN AN H-10 LOAD RATING.
  4. DO NOT SCALE DRAWING.
  5. ALL INFORMATION CONTAINED HEREIN WAS CURRENT AT THE TIME OF DEVELOPMENT BUT MUST BE REVIEWED AND APPROVED BY THE PRODUCT MANUFACTURER TO BE CONSIDERED ACCURATE.
- CONTRACTORS NOTE: FOR PRODUCT AND COMPANY INFORMATION VISIT WWW.CADDETAILS.COM/INFO AND ENTER REFERENCE NUMBER 558-028

1 // L5 | 8" FRENCH DRAIN  
SCALE: N.T.S.



© 2023 WJK LTD.  
DESIGN CONCEPTS, DRAWING, SHEETS, LOGOS, SPECIFICATIONS, DETAILS, WRITTEN MATERIAL SHALL NOT BE USED OR REPRODUCED IN WHOLE OR IN PART IN ANY FORM WITHOUT PRIOR WRITTEN CONSENT OF WJK LTD.  
THIS SHEET TO SCALE AT: 24"x36"

SITE DEVELOPMENT PLANS  
FOR  
**SUOZZI RESIDENCE**  
BLUE CRAB STREET / LOT 24 (#7)  
TABBY RAODS / BLUFFTON, SOUTH CAROLINA

DATE: JULY 24, 2023  
PROJECT NO.: XXXXXX  
DRAWN BY: MC  
CHECKED BY: DK

FINAL SUBMITTAL  
PLAN, NOT FOR  
CONSTRUCTION

REVISIONS:

DRAWING TITLE  
SITE DETAILS

DRAWING NUMBER

L5