

Dewberry Engineers, Inc
 800 N. Magnolia Avenue
 Suite 1000
 Orlando, FL 32803
 407.843.5120
 C.A. #8794

REGAL MARINE INDUSTRIES
 BOAT PRODUCTION
 EXPANSION
 BELLE ISLE
 2300 JETPORT DRIVE BELLE
 CITY OF BELLE ISLE, FLORIDA
 CONSTRUCTION PLANS

SEAL

Michael J. Uchivik
 FL RLA # 6666876
 Jan 25, 2023

SCALE

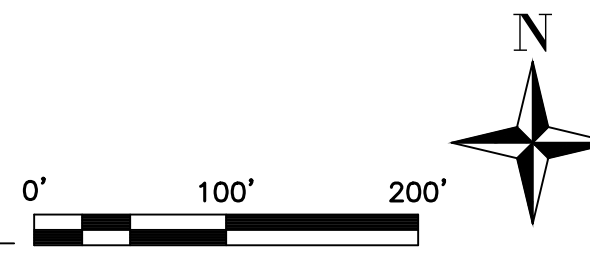

REVISIONS

NO.	DESCRIPTION	DATE

DRAWN BY _____ AH

APPROVED BY _____ MU

CHECKED BY _____ MU

DATE 11 / 9 / 2022

TITLE

**OVERALL
 PLAN**

PROJECT NO. 50150413

L2.00

SHEET NO. 60 OF

LANDSCAPE PLAN
 SCALE: 1"=100'-0"

Q:\REGA_50150413\CAD\Civil\Phase I\Landscapes\REGA - Landscape.dwg

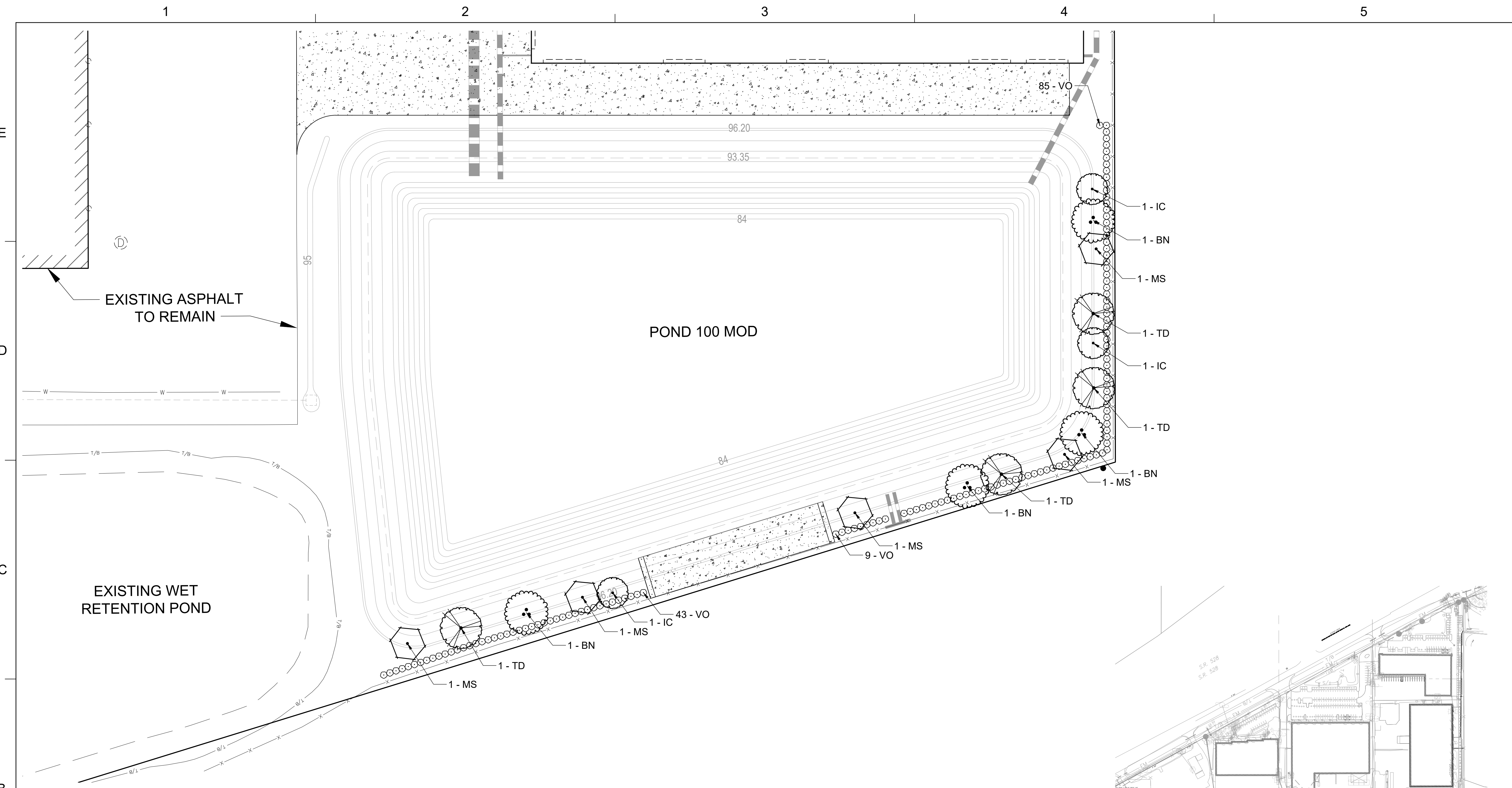

LANDSCAPE PLAN

SCALE: 1"=20'-0"

PLANT SCHEDULE

TREES	CODE	BOTANICAL / COMMON NAME	CAL.	HEIGHT	QTY
	BN	Betula nigra / Multi - Trunk	2" Min.	7' Min.	4
	IC	Ilex cassine / Dahoon Holly	2" Min.	7' Min.	3
	MS	Magnolia virginiana / Sweetbay Magnolia	2" Min.	7' Min.	5
	TD	Taxodium distichum / Bald Cypress	2" Min.	7' Min.	4
SHRUBS	CODE	BOTANICAL / COMMON NAME	SIZE		
	VO	Viburnum odoratissimum / Sweet Viburnum	30" Ht, 5 gal Min.		137

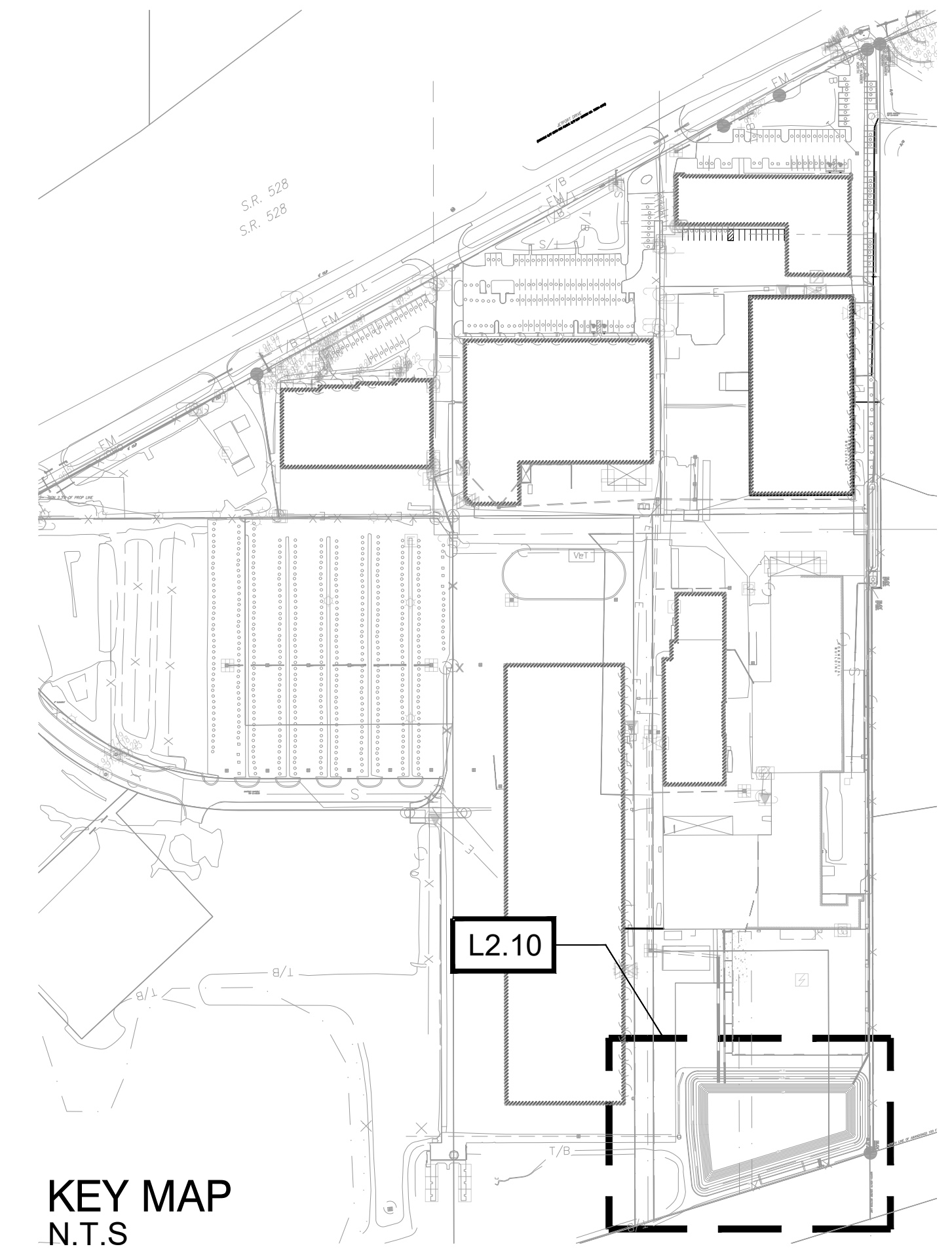

KEY MAP
N.T.S

Dewberry
Dewberry Engineers, Inc
800 N. Magnolia Avenue
Suite 1000
Orlando, FL 32803
407.843.5120
C.A. #8794

REGAL MARINE INDUSTRIES
BOAT PRODUCTION
EXPANSION
BELLE ISLE
2300 JETPORT DRIVE BELLE
CITY OF BELLE ISLE, FLORIDA
CONSTRUCTION PLANS

SEAL
Michael J. Uchink
FL RLA # 666875
Jan 25, 2023

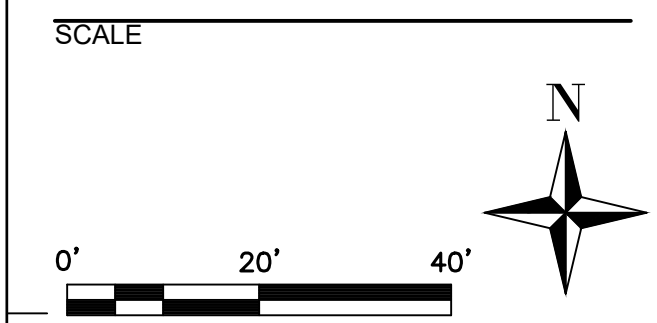

REVISIONS

NO.	DESCRIPTION	DATE

DRAWN BY: _____ AH
APPROVED BY: _____ MU
CHECKED BY: _____ MU
DATE: 11/9/2022

LANDSCAPE PLAN

PROJECT NO. 50150413

L2.10

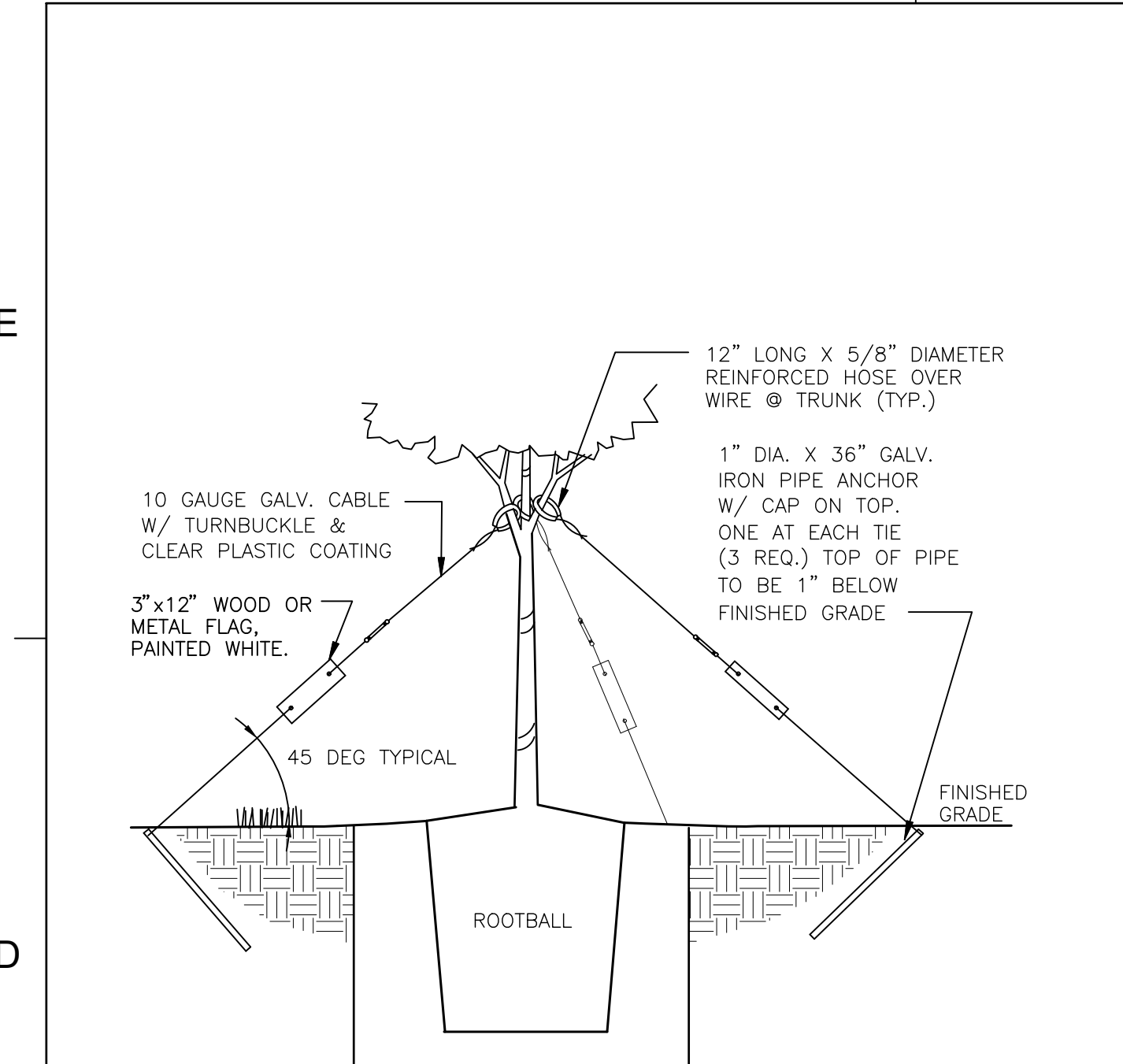

STAKING DETAIL

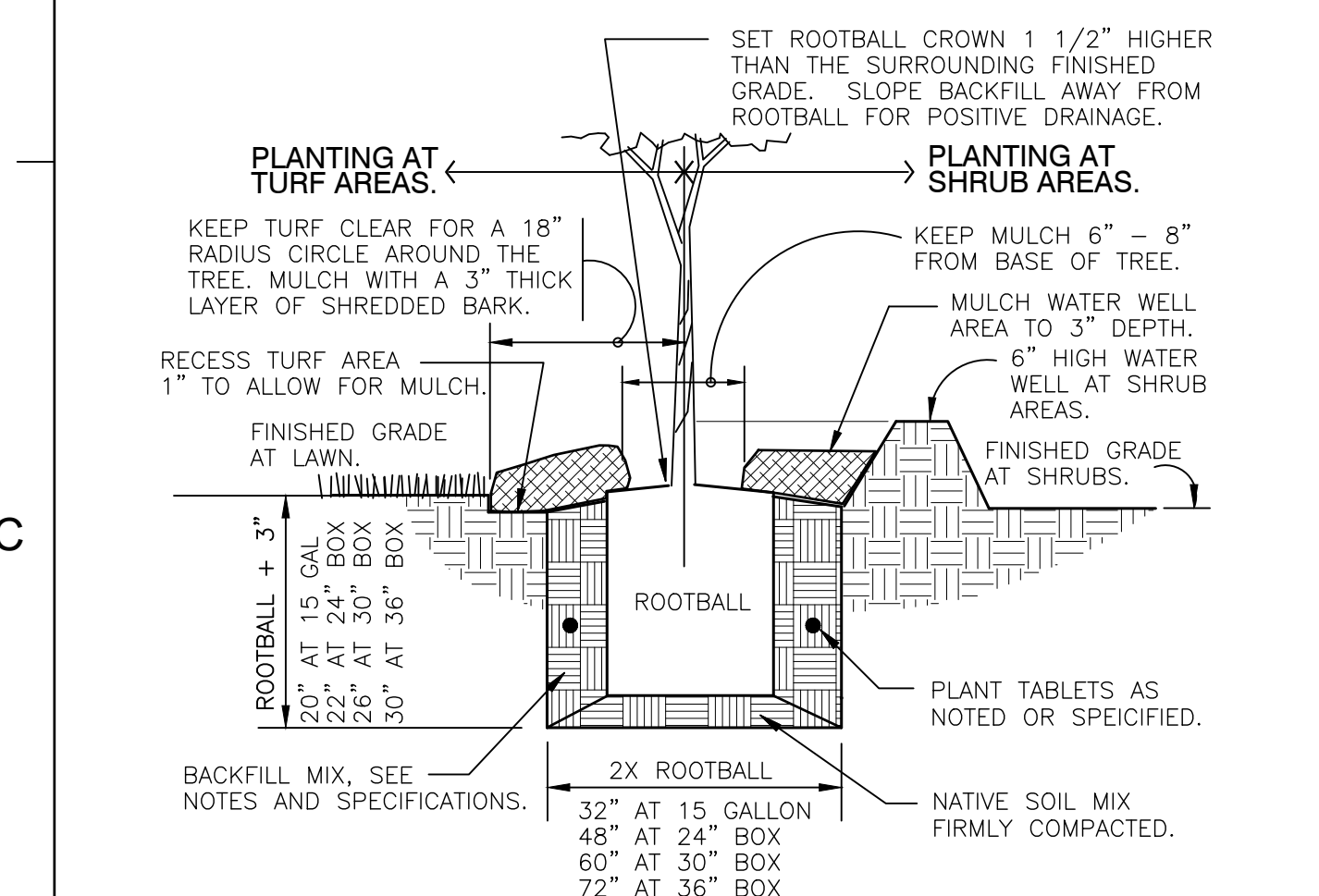

PLANT PIT DETAIL

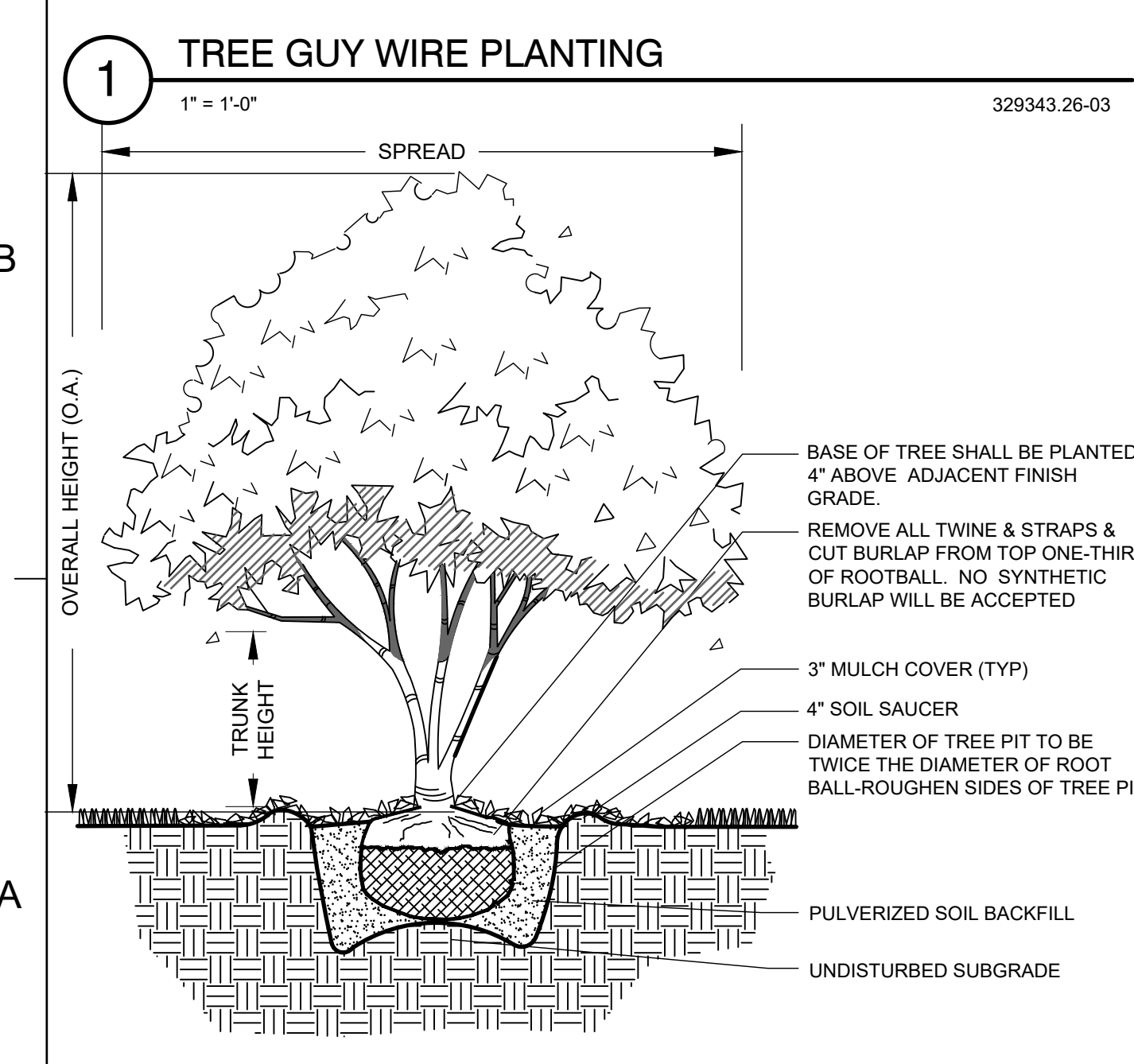

1 TREE GUY WIRE PLANTING
N.T.S. 329343.26-03

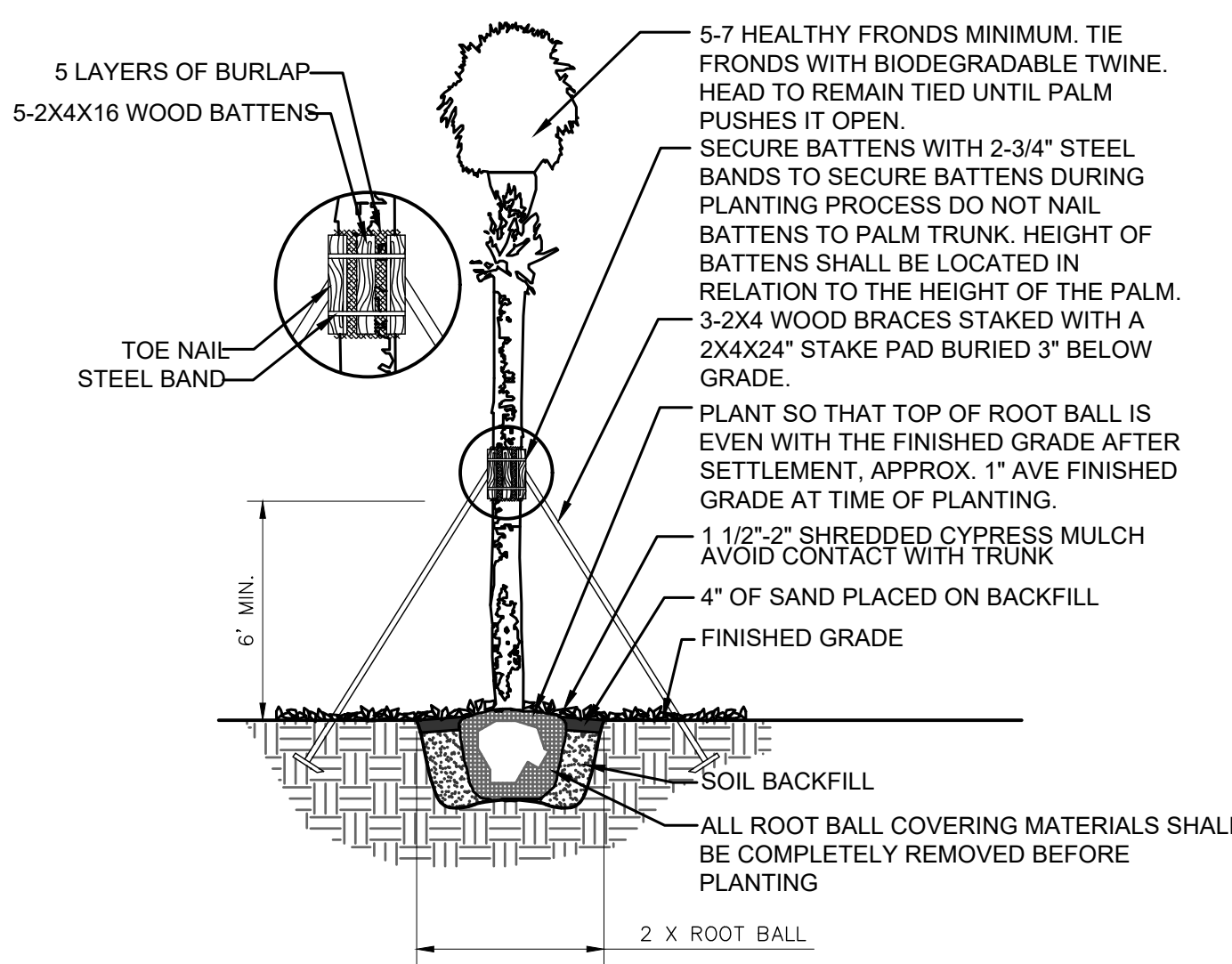

4 PALM STAKING
N.T.S. 329343.32-01

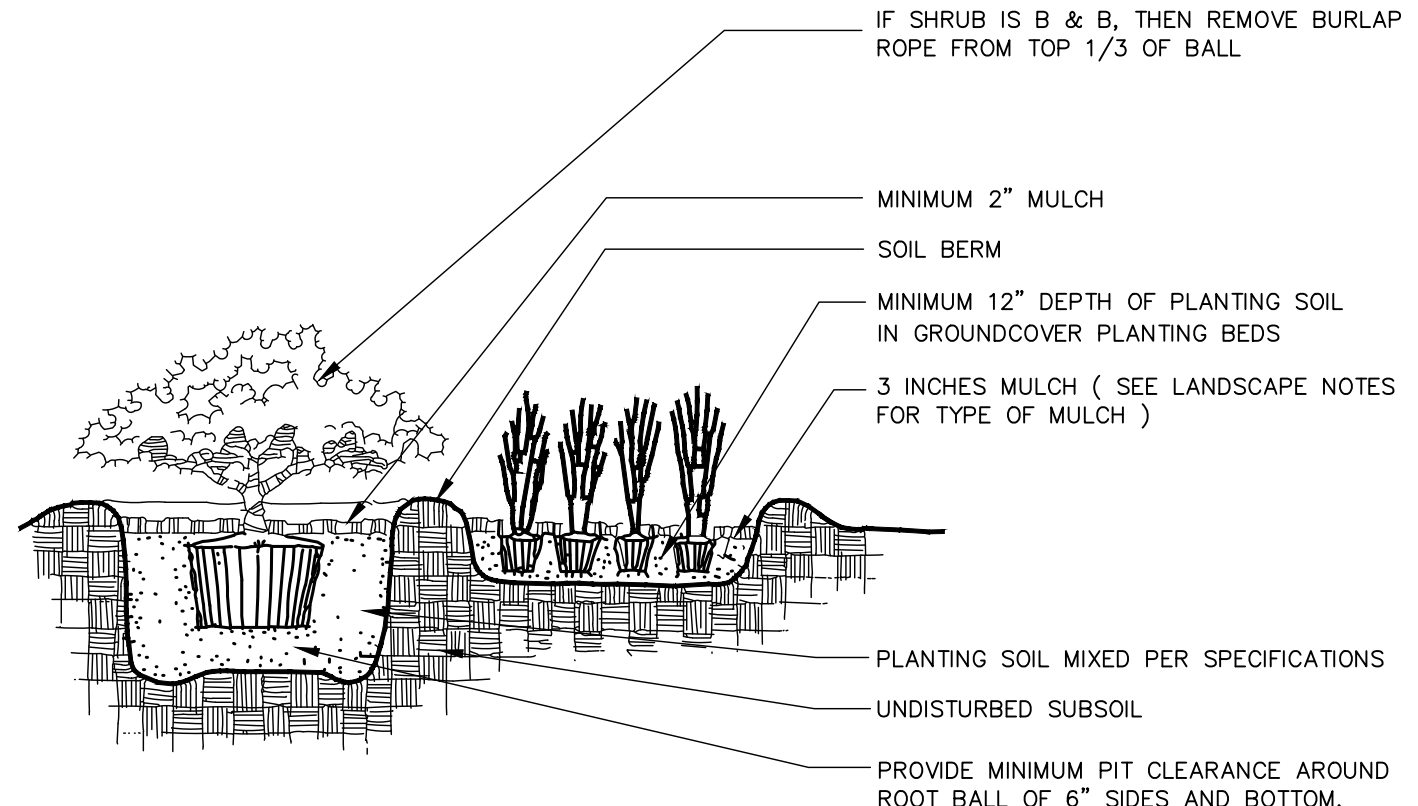
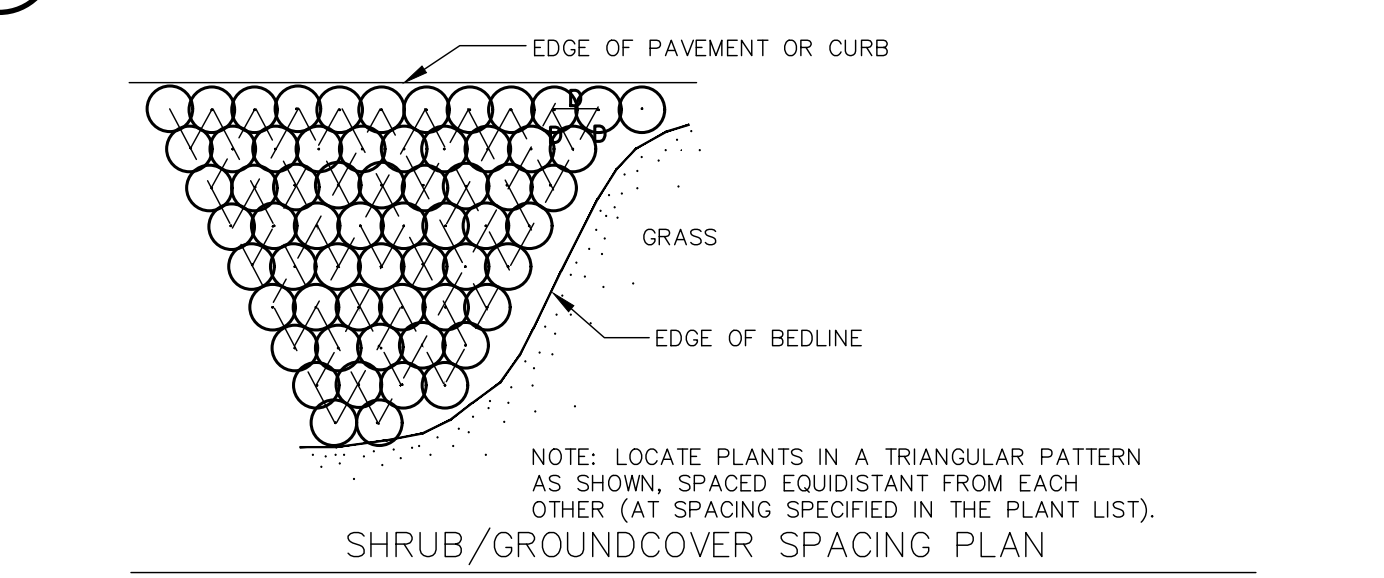

5 SHRUB AND GROUNDCOVER PLANTING
N.T.S. 329333.13-04

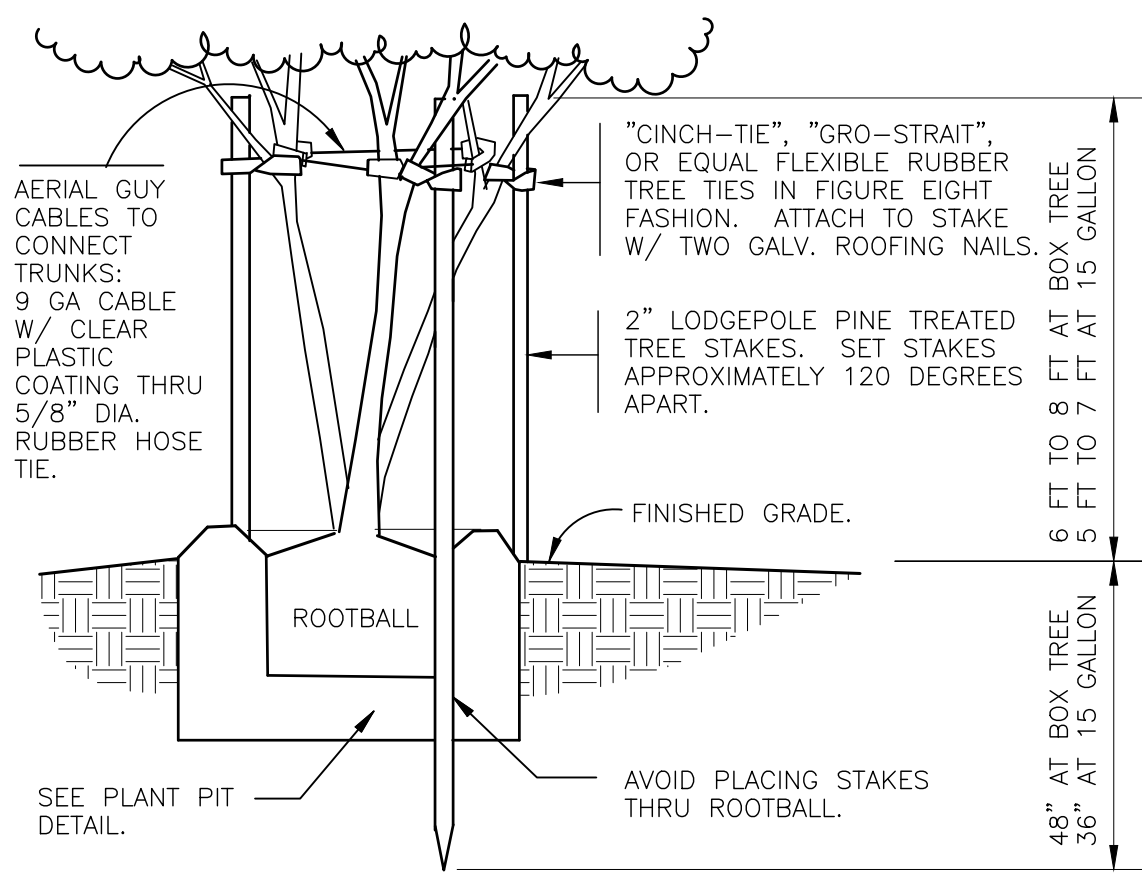

STAKING DETAIL

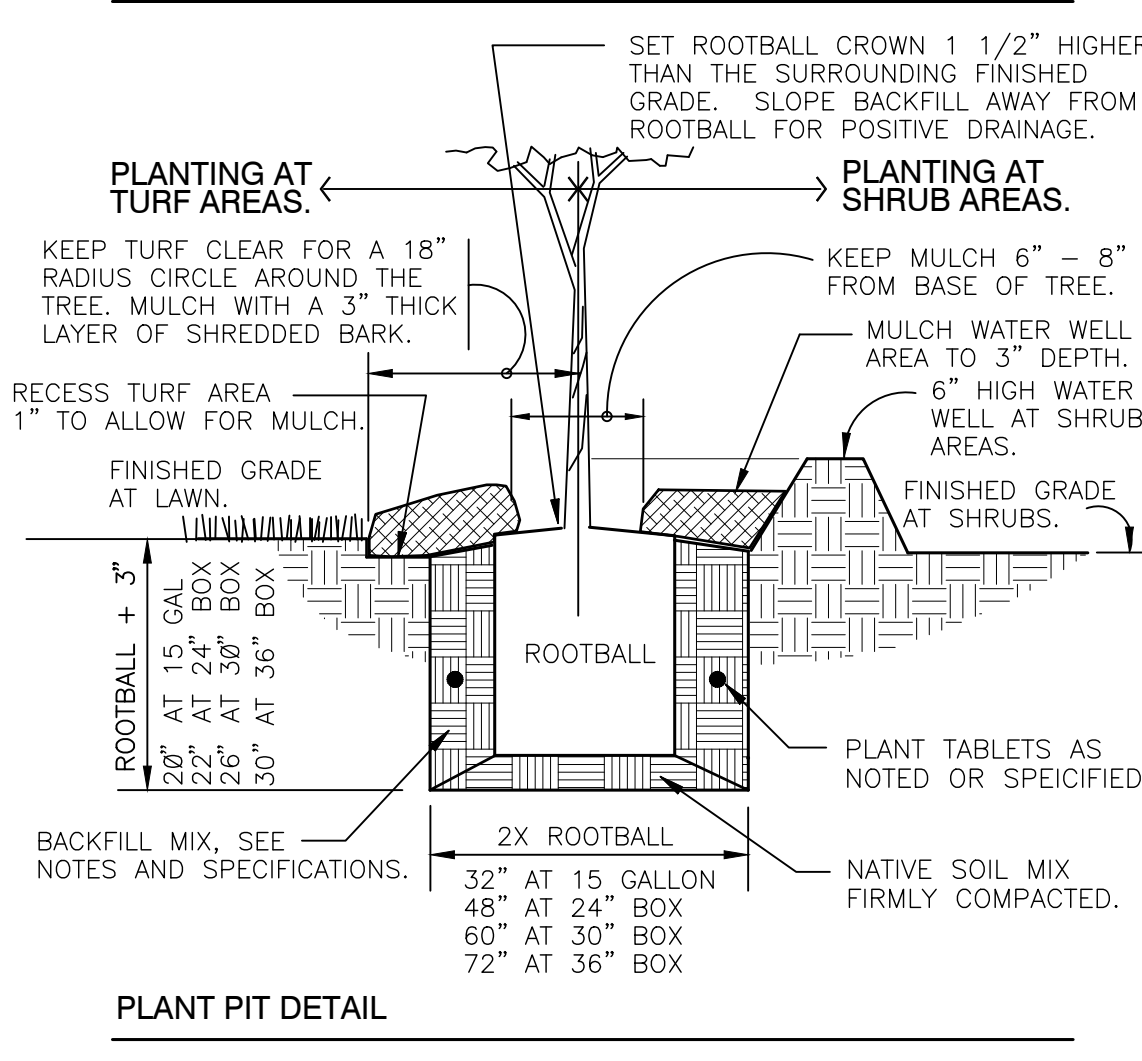

PLANT PIT DETAIL

6 TREE PLANTING MULTI-STAKE
1\"/>

LANDSCAPE NOTES:

- The Landscape Contractor shall be responsible for all materials and all work as called for on the Landscape Plans and in the Landscape Specifications. In the event of variation between quantities shown on plant list and the plans, the plans shall control. The Landscape Contractor shall verify all quantities and report any discrepancies at the time of bidding.
- The Landscape Contractor shall review architectural/engineering plans and become thoroughly familiar with surface and subsurface utilities.
- Every possible safeguard shall be taken to protect building surfaces, equipment and furnishings. The Landscape Contractor shall be responsible for any damage or injury to person or property which may occur as a result of negligence in the execution of the work.
- The work shall be coordinated with other trades to prevent conflicts. Coordinate the planting with the irrigation work to assure availability and proper location of irrigation items and plants.
- All planting shall be performed by personnel familiar with planting procedure and under the supervision of a qualified planting foreman.
- All plant material shall be graded Florida No. 1 or better as outlined under Grades and Standards for Nursery Plants, Part 1 and II, published by the Florida Department of Agriculture and Consumer Services.
- The Landscape Architect or Owner shall have the right, at any stage of the operations, to reject any and all work and materials which, in his opinion, do not meet with the requirements of these specifications.
- Except as otherwise specified, the Landscape Contractor's work shall conform to accepted horticultural practices as used in the trade.
- The minimum acceptable size of all plants, measured after pruning, with branches in normal positions, shall conform to the measurements specified on the drawings, and backfilled with the specified planting soil. The Landscape Contractor shall test fill all tree pits with water before planting to assure proper drainage percolation is available.
- Plants shall be protected upon arrival at the site, by being thoroughly watered and properly maintained until planted.
- All tree pits shall be excavated to size and depth in accordance with the USDA Standard for Nursery Stock 260.1, unless shown otherwise on the drawings, and backfilled with the specified planting soil. The Landscape Contractor shall test fill all tree pits with water before planting to assure proper drainage percolation is available.
- The Landscape Contractor shall be responsible for proper watering of all plants. All plants shall be thoroughly watered at time of planting and kept adequately watered until time of acceptance. It shall be the Landscape Contractor's responsibility to assure that plants are not over watered.
- It shall be the Landscape Contractor's responsibility to prevent plants from falling or being blown over, to re-straighten and replant all plants which lean or fall and to replace all plants which are damaged due to lack of proper guying or staking. The Landscape Contractor shall be legally liable for any damage caused by instability of any plant material.
- All trees and all palms shall be guyed or staked or braced. The Landscape Contractor shall determine which small or multi-trunk trees need to be guyed and staked to maintain plumb. Staking of trees and shrubs, if required, shall be done as per staking and guying diagram prepared by the Landscape Architect. It shall be the responsibility of the Landscape Contractor to remove guys and stakes from the trees and job site after a period of 90 days.
- Plants blown over by high winds, within the guaranteed period, shall not be cause for additional expense to the Owner, but shall be the responsibility of the Landscape Contractor. Damaged plants shall be replaced by the Landscape Contractor at no additional cost to the Owner.
- Sod shall be certified to be free of the imported fire ant. Sod shall have a clean growth of acceptable grass, reasonably free of weeds with not less than 1 1/2\"/>



Dewberry Engineers, Inc
800 N. Magnolia Avenue
Suite 1000
Orlando, FL 32803
407.843.5120
C.A. #8794

REGAL MARINE INDUSTRIES
BOAT PRODUCTION
EXPANSION
BELLE ISLE
2300 JETPORT DRIVE BELLE
CITY OF BELLE ISLE, FLORIDA
CONSTRUCTION PLANS

SEAL

Michael J. Uchayk
FL RLA #666876
Jan 25, 2023

SCALE

REVISIONS

NO.	DESCRIPTION	DATE

DRAWN BY: AH
APPROVED BY: MU
CHECKED BY: MU
DATE: 11/9/2022
TITLE

NOTES & DETAILS

PROJECT NO. 50150413

L3.10