

**Dewberry**  
 Dewberry Engineers, Inc  
 800 N. Magnolia Avenue  
 Suite 1000  
 Orlando, FL 32803  
 407.843.5120  
 C.A. #8794

REGAL MARINE INDUSTRIES  
 BOAT PRODUCTION  
 EXPANSION  
 BELLE ISLE  
 2300 JETPORT DRIVE BELLE  
 CITY OF BELLE ISLE, FLORIDA  
 CONSTRUCTION PLANS

SEAL  
 Michael J Urchuk: A01410D000001783AED2B2D0000549D  
 2023.02.02 08:21:39-0500  
 This item has been digitally signed and sealed by Michael J. Urchuk, P.E., on the date adjacent to the seal. Printed copies of this document are not considered signed and sealed and the signature must be verified on any electronic copies.  
 Michael J. Urchuk  
 P.E. R/A # 6666875  
 FL Jan 25, 2023

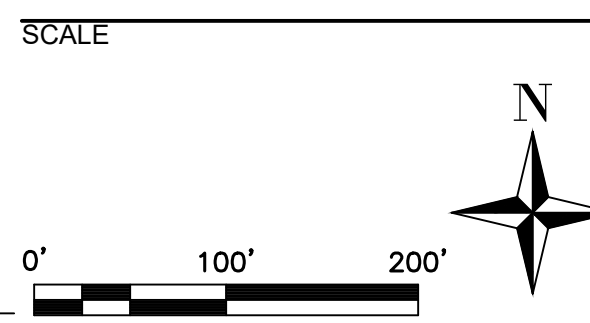

REVISIONS

NO.	DESCRIPTION	DATE

DRAWN BY \_\_\_\_\_ AH  
 APPROVED BY \_\_\_\_\_ MU  
 CHECKED BY \_\_\_\_\_ MU  
 DATE \_\_\_\_\_ 11 / 9 / 2022

TITLE  
**OVERALL PLAN**

PROJECT NO. 50150413

**L2.00**

SHEET NO. 60 OF

LANDSCAPE PLAN  
 SCALE: 1"=100'-0"

Q:\REGA\_50150413\CAD\Civil\Phase I\Landscapes\REGA - Landscape.dwg

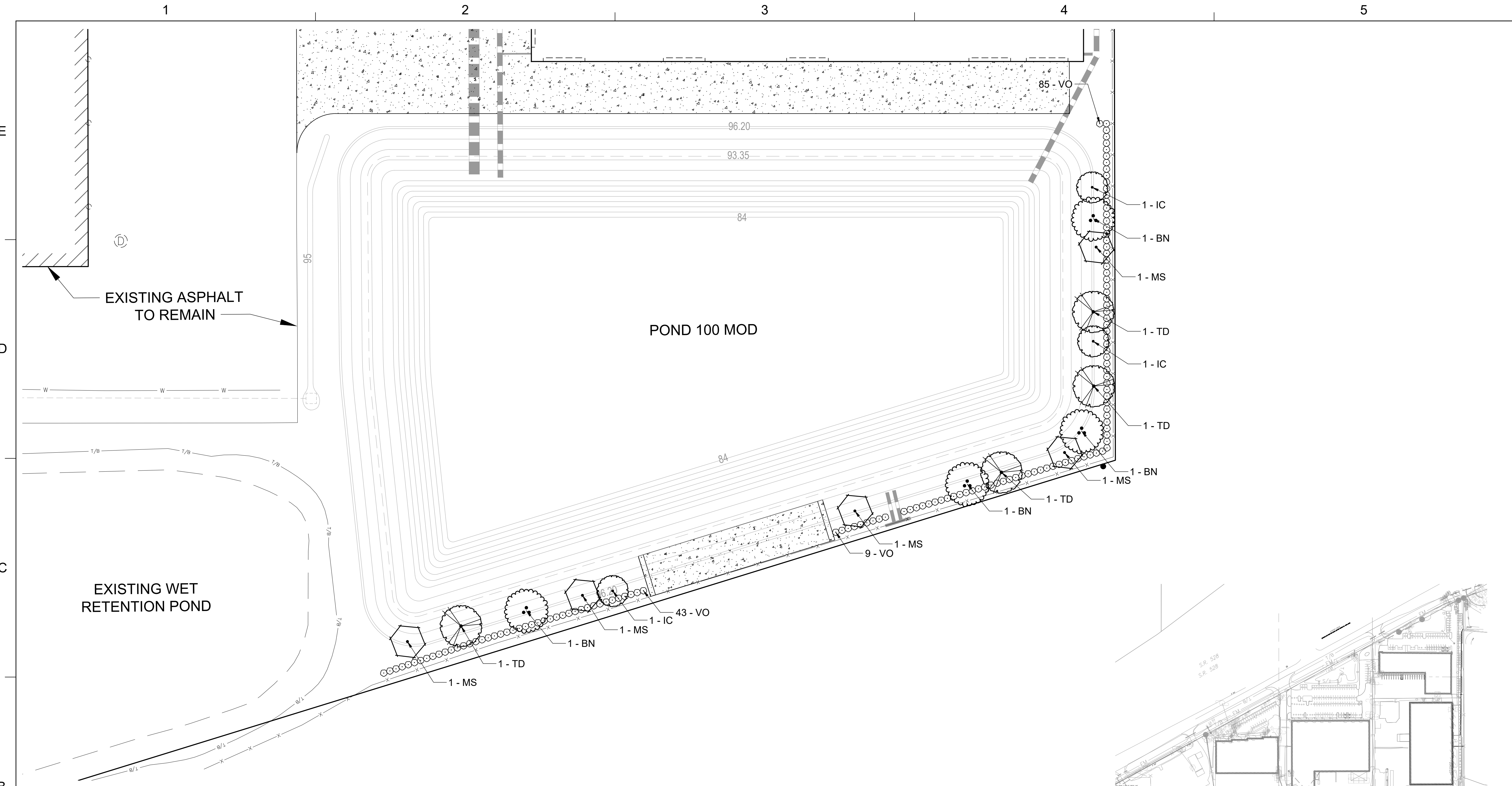

**LANDSCAPE PLAN**

SCALE: 1"=20'-0"

**PLANT SCHEDULE**

TREES	CODE	BOTANICAL / COMMON NAME	CAL.	HEIGHT	QTY
	BN	Betula nigra / Multi - Trunk	2" Min.	7' Min.	4
	IC	Ilex cassine / Dahoon Holly	2" Min.	7' Min.	3
	MS	Magnolia virginiana / Sweetbay Magnolia	2" Min.	7' Min.	5
	TD	Taxodium distichum / Bald Cypress	2" Min.	7' Min.	4
SHRUBS	CODE	BOTANICAL / COMMON NAME	SIZE		
	VO	Viburnum odoratissimum / Sweet Viburnum	30" Ht, 5 gal Min.		137

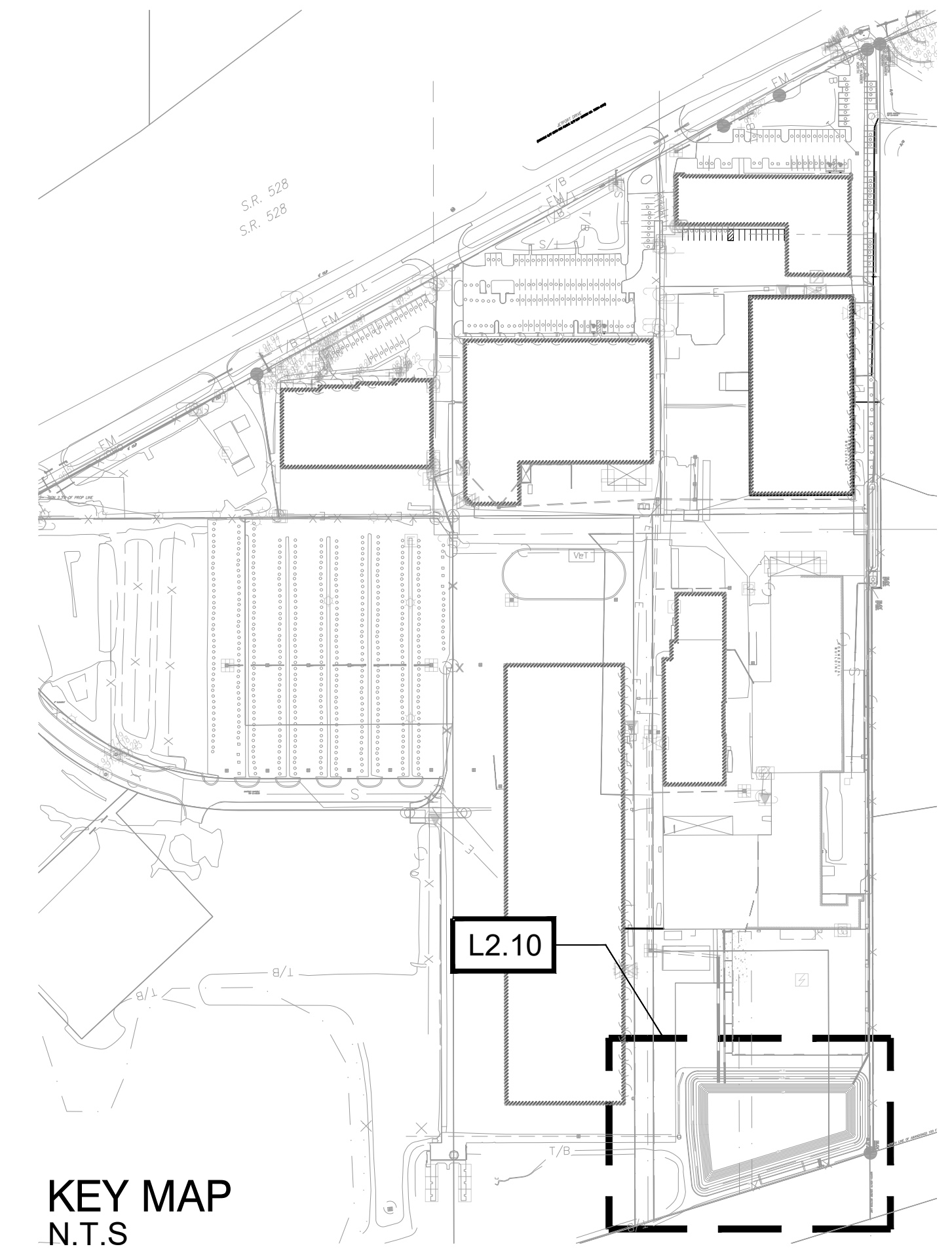

**KEY MAP**  
N.T.S



Dewberry Engineers, Inc  
800 N. Magnolia Avenue  
Suite 1000  
Orlando, FL 32803  
407.843.5120  
C.A. #8794

REGAL MARINE INDUSTRIES  
BOAT PRODUCTION  
EXPANSION  
BELLE ISLE  
2300 JETPORT DRIVE BELLE  
CITY OF BELLE ISLE, FLORIDA  
CONSTRUCTION PLANS

SEAL  
Michael J Urchuk: A01410D000001783AED2B2D0000549D  
2023.02.02 08:21:31-0500  
This item has been digitally signed and sealed by Michael J. Urchuk, P.E., on the date adjacent to the seal. Printed copies of this document are not considered signed and sealed and the signature must be verified on any electronic copies.  
Michael J. Urchuk  
P.E. #666875  
FL #A. #666875  
Jan 25, 2023

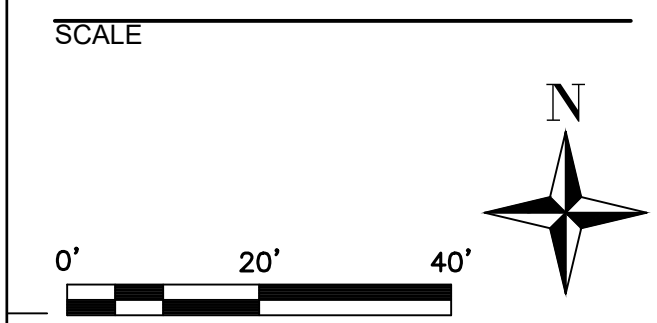

REVISIONS

NO.	DESCRIPTION	DATE

DRAWN BY: \_\_\_\_\_ AH  
APPROVED BY: \_\_\_\_\_ MU  
CHECKED BY: \_\_\_\_\_ MU  
DATE: 11/9/2022

**LANDSCAPE PLAN**

PROJECT NO. 50150413

**L2.10**

NO.	DESCRIPTION	DATE

DRAWN BY            AH

APPROVED BY            MU

CHECKED BY            MU

DATE            11/9/2022

TITLE

**NOTES & DETAILS**

PROJECT NO. 50150413

**L3.10**

LANDSCAPE NOTES:

- The Landscape Contractor shall be responsible for all materials and all work as called for on the Landscape Plans and in the Landscape Specifications. In the event of variation between quantities shown on plant list and the plans, the plans shall control. The Landscape Contractor shall verify all quantities and report any discrepancies at the time of bidding.
- The Landscape Contractor shall review architectural/engineering plans and become thoroughly familiar with surface and subsurface utilities.
- Every possible safeguard shall be taken to protect building surfaces, equipment and furnishings. The Landscape Contractor shall be responsible for any damage or injury to person or property which may occur as a result of negligence in the execution of the work.
- The work shall be coordinated with other trades to prevent conflicts. Coordinate the planting with the irrigation work to assure availability and proper location of irrigation items and plants.
- All planting shall be performed by personnel familiar with planting procedure and under the supervision of a qualified planting foreman.
- All plant material shall be graded Florida No. 1 or better as outlined under Grades and Standards for Nursery Plants, Part 1 and II, published by the Florida Department of Agriculture and Consumer Services.
- The Landscape Architect or Owner shall have the right, at any stage of the operations, to reject any and all work and materials which, in his opinion, do not meet with the requirements of these specifications.
- Except as otherwise specified, the Landscape Contractor's work shall conform to accepted horticultural practices as used in the trade.
- The minimum acceptable size of all plants, measured after pruning, with branches in normal positions, shall conform to the measurements specified on the plant list or as indicated on the landscape drawing. Height and spread dimensions refer to main body of the plant and not extreme branch tip to tip. The caliper of tree trunks is to be taken one foot above the ground level for trees 4" and larger and 6" above ground for trees less than 4".
- Plants shall be protected upon arrival at the site, by being thoroughly watered and properly maintained until planted.
- All tree pits shall be excavated to size and depth in accordance with the USDA Standard for Nursery Stock 260.1, unless shown otherwise on the drawings, and backfilled with the specified planting soil. The Landscape Contractor shall test fill all tree pits with water before planting to assure proper drainage percolation is available.
- The Landscape Contractor shall be responsible for proper watering of all plants. All plants shall be thoroughly watered at time of planting and kept adequately watered until time of acceptance. It shall be the Landscape Contractor's responsibility to assure that plants are not over watered.
- It shall be the Landscape Contractor's responsibility to prevent plants from falling or being blown over, to re-straighten and replant all plants which lean or fall and to replace all plants which are damaged due to lack of proper guying or staking. The Landscape Contractor shall be legally liable for any damage caused by instability of any plant material.
- All trees and all palms shall be guyed or staked or braced. The Landscape Contractor shall determine which small or multi-trunk trees need to be guyed and staked to maintain plumb. Staking of trees and shrubs, if required, shall be done as per staking and guying diagram prepared by the Landscape Architect. It shall be the responsibility of the Landscape Contractor to remove guys and stakes from the trees and job site after a period of 90 days.
- Plants blown over by high winds, within the guaranteed period, shall not be cause for additional expense to the Owner, but shall be the responsibility of the Landscape Contractor. Damaged plants shall be replaced by the Landscape Contractor at no additional cost to the Owner.
- Sod shall be certified to be free of the imported fire ant. Sod shall have a clean growth of acceptable grass, reasonably free of weeds with not less than 1 1/2" of soil firmly adhering to roots. It shall be the responsibility of the Landscape Contractor to measure and determine the exact amount required. This amount shall be verified with the Owner or Landscape Architect before installation.
- The Landscape Contractor shall insure adequate vertical drainage in all plant beds, planters, and sod areas. Vertical drilling through any compacted fill to native soil shall be accomplished to insure drainage. If well drained fill is necessary to assure positive drainage, this issue shall be brought up by the Landscape Contractor at time of bidding.
- The Landscape Contractor shall insure that his work does not interrupt established or projected drainage patterns.
- The Landscape Contractor shall prune, shape and remove dead foliage/limbs from existing plant material to remain. Confirm with the Landscape Architect or Owner the extent of work required at time of bidding.
- Mulch - All plant beds shall be top dressed with 3" shredded hardwood mulch (or approved equal).
- MAINTENANCE PRIOR TO FINAL INSPECTION AND ACCEPTANCE:**
  - Maintenance shall commence after each plant is planted and the maintenance period shall continue until the job or specific phase of the job is accepted by the Landscape Architect or Owner. Extreme care shall be taken to instruct the Owner or his representatives in general maintenance procedures.
  - Plant maintenance shall include watering, pruning, weeding, cultivating, mulching, tightening, and repairing of guys, replacement of sick or dead plants, resetting plants to proper grades or upright positions and restoration of the planting saucer and all other care needed for proper growth of the plants.
  - During the maintenance period and up to the date of final acceptance, the Landscape Contractor shall do all seasonal spraying and/or dusting of trees and shrubs. Upon completion of all planting, an inspection for acceptance of work will be held. The Landscape Contractor shall notify the Landscape Architect or Owner for scheduling of the inspection 10 days prior to the anticipated date.
  - At the time of the inspection, if all of the materials are acceptable, a written notice will be given by the Landscape Architect or Owner to the Landscape Contractor Stating the date when the Maintenance Period ends.

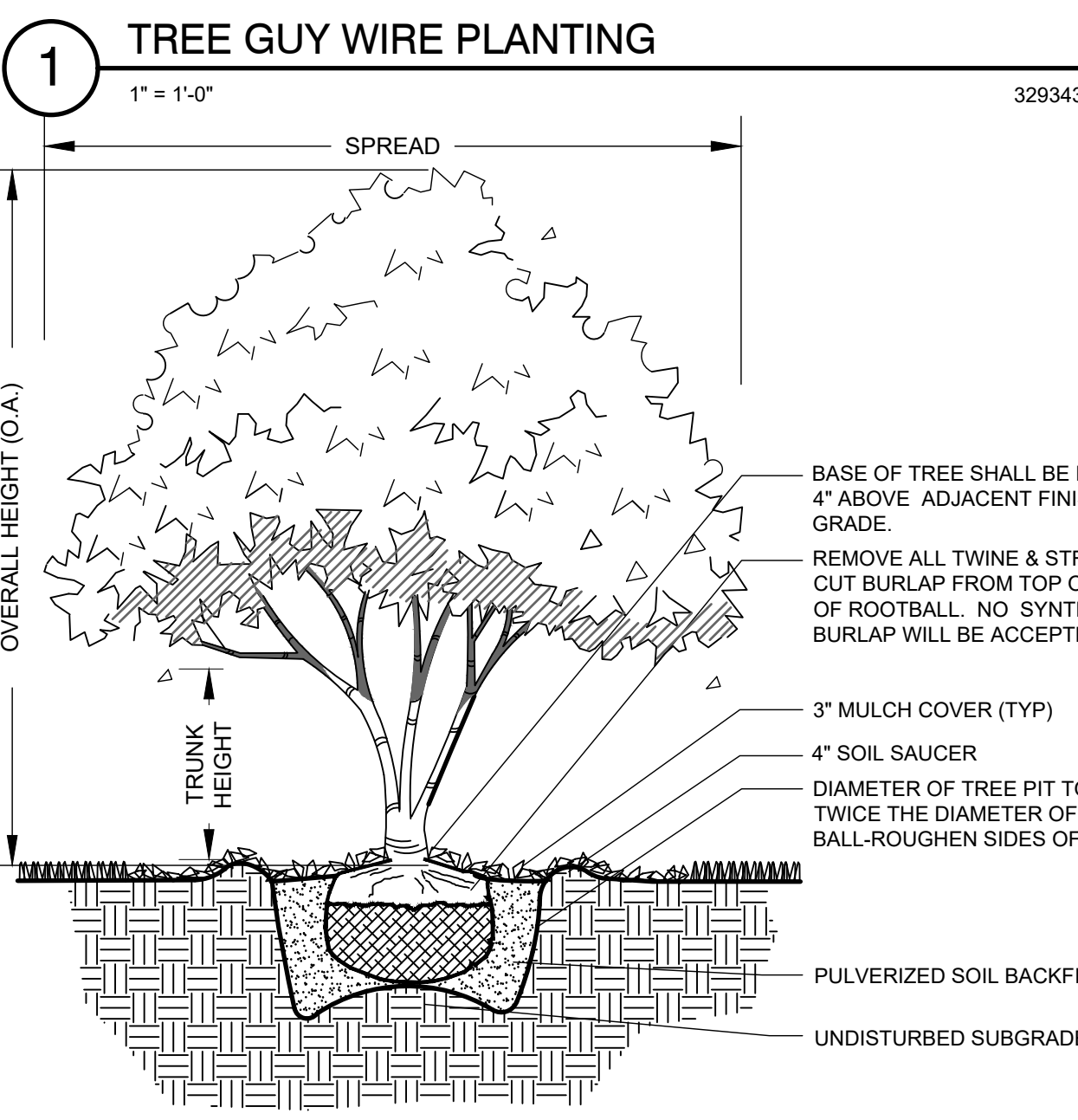
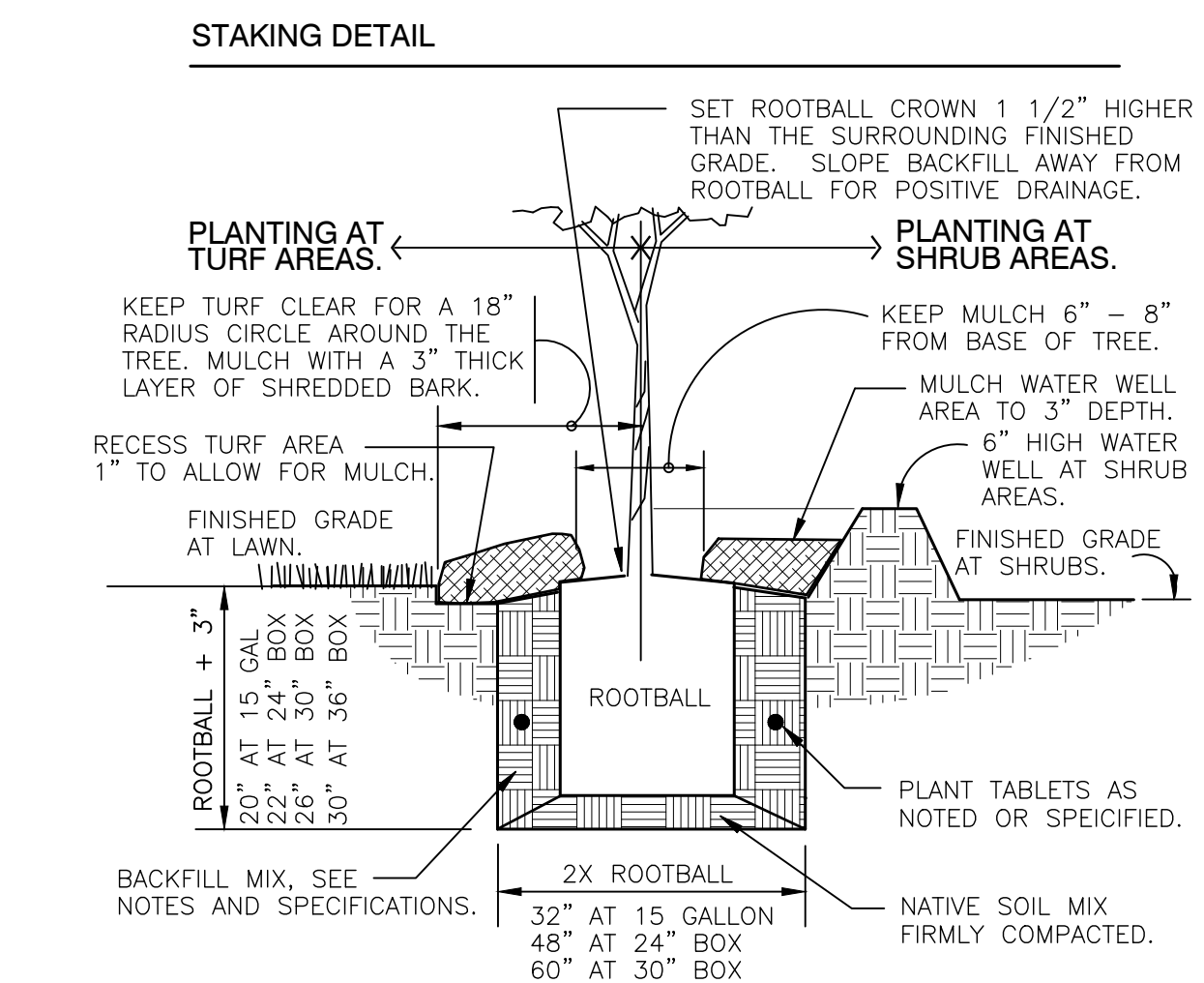
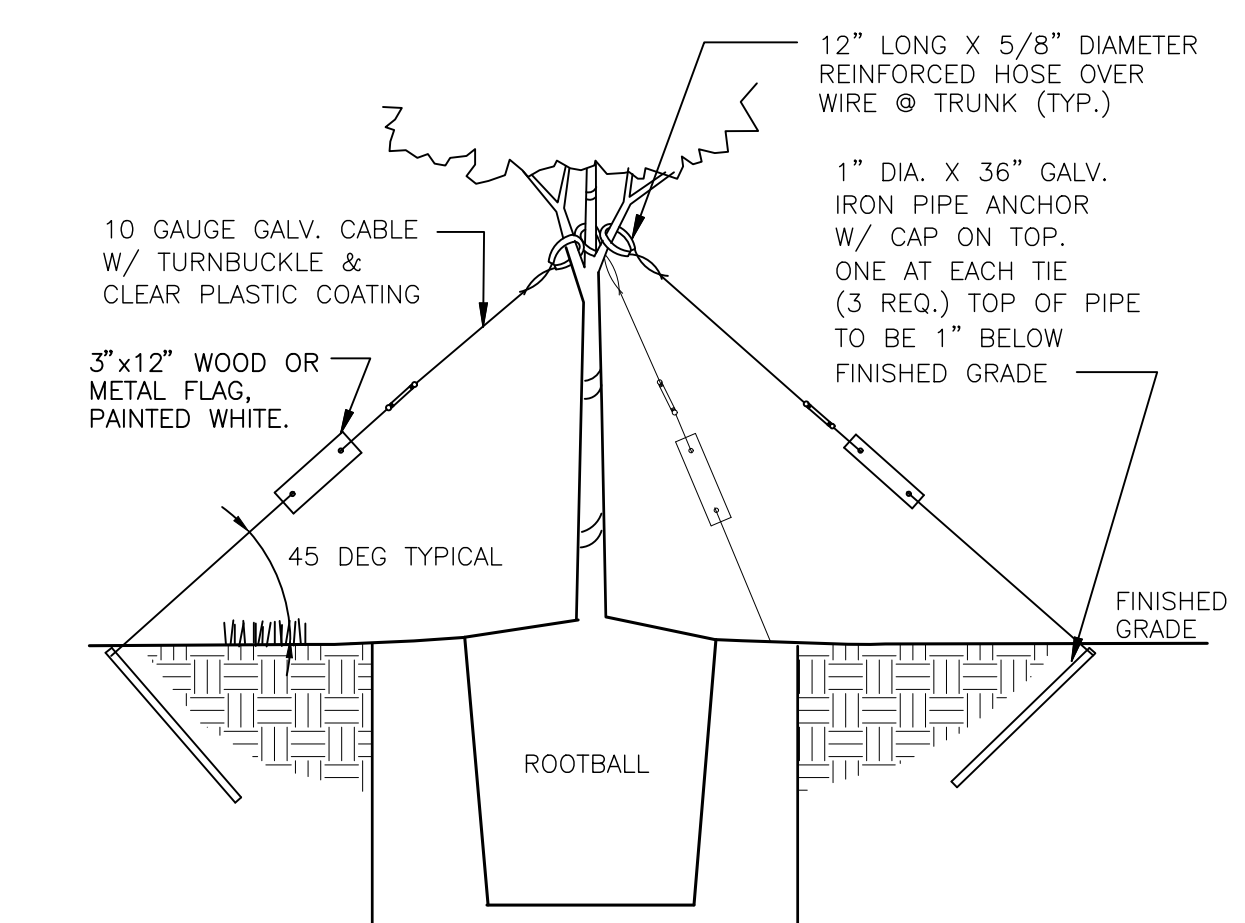

**2 MULTI-STEM TREE PLANTING**  
N.T.S. 329343.33-01

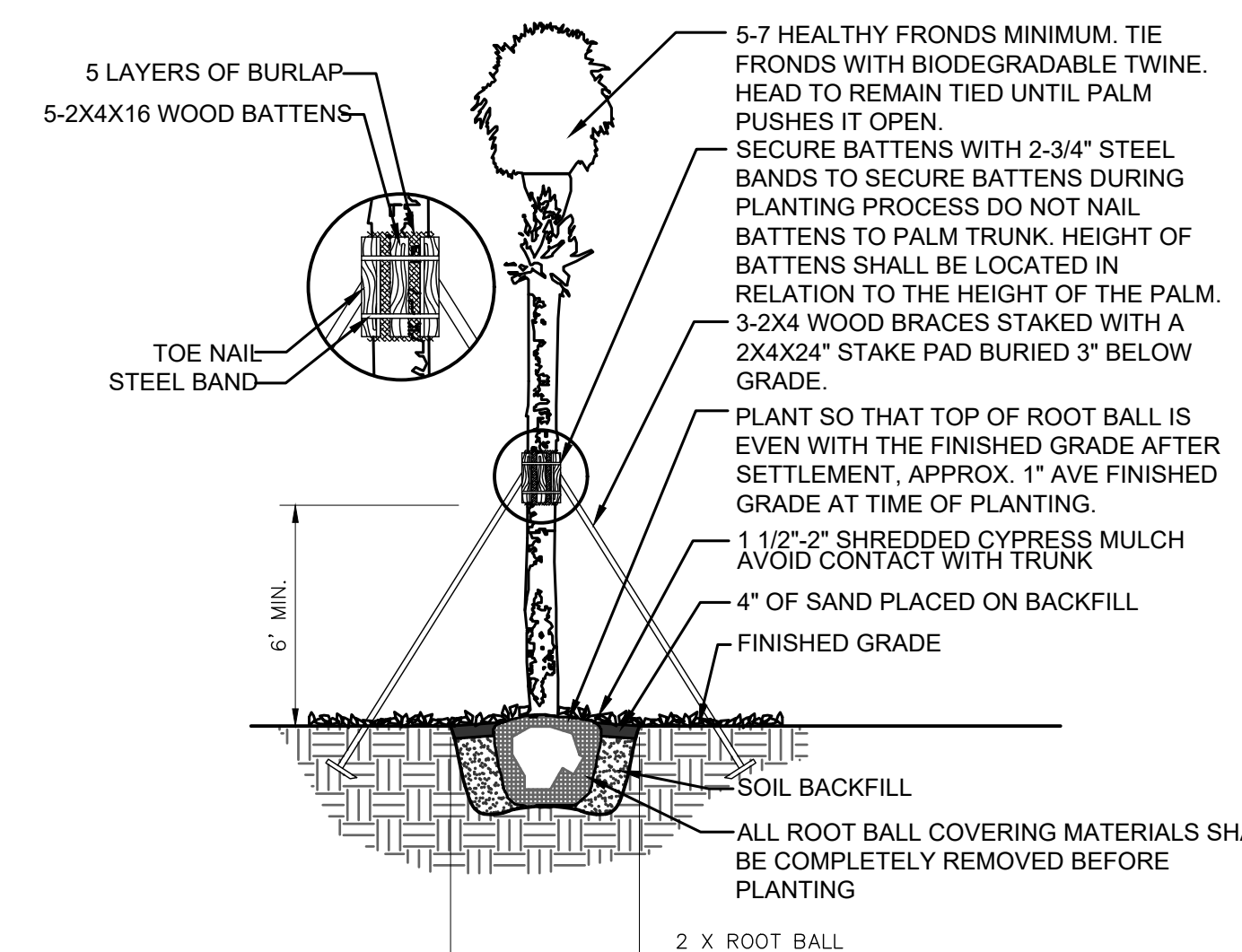

**4 PALM STAKING**  
N.T.S. 329343.32-01

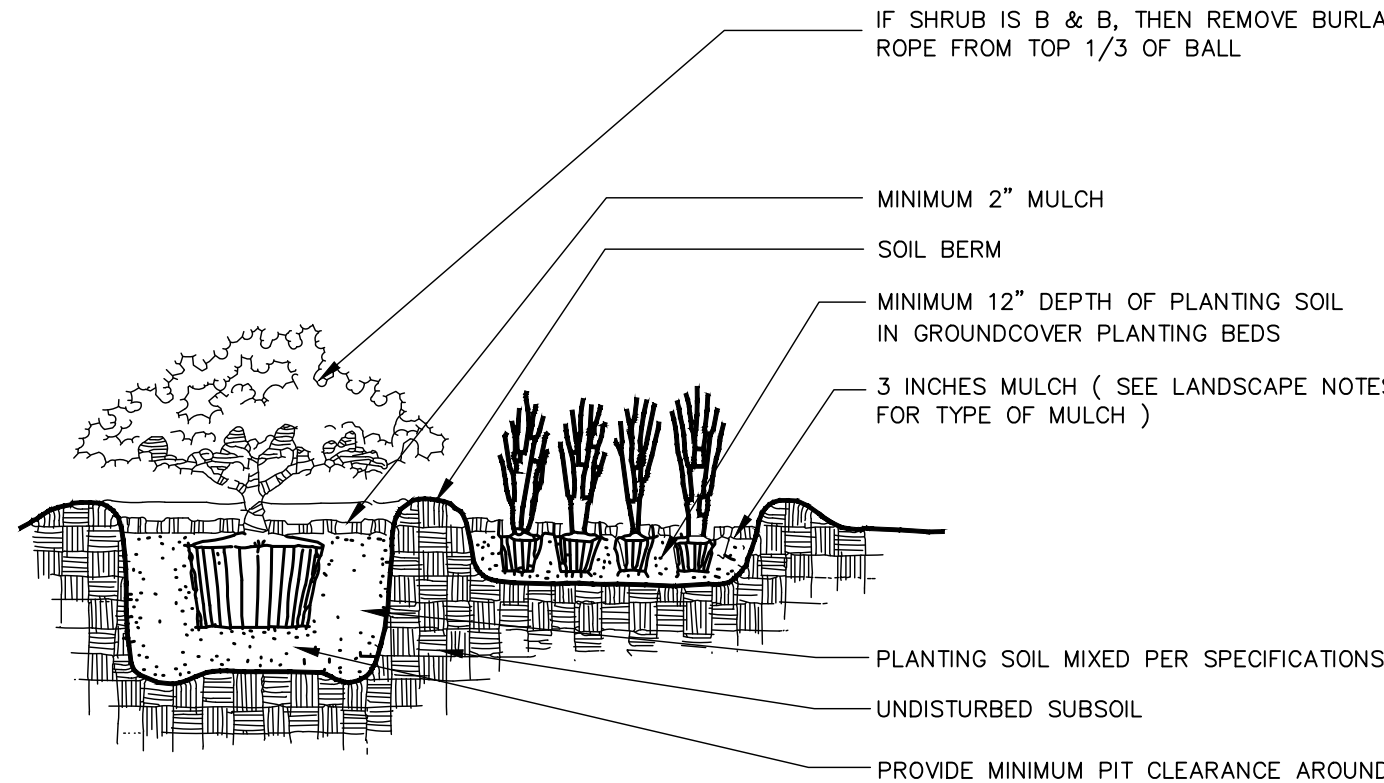
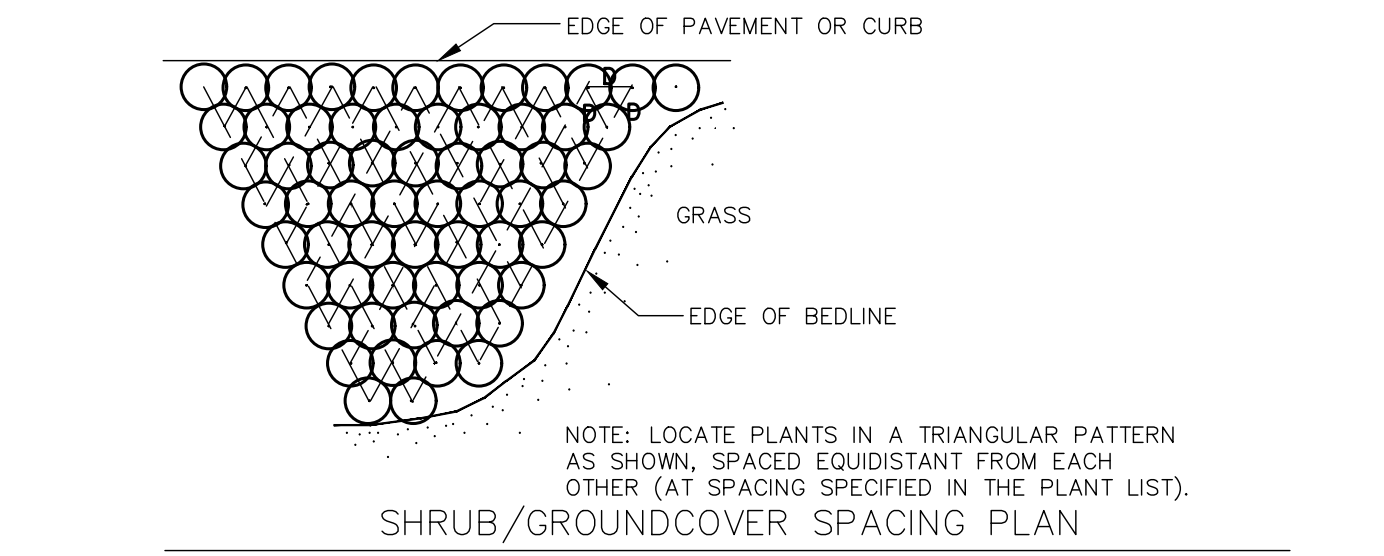

**5 SHRUB AND GROUNDCOVER PLANTING**  
N.T.S. 329333.13-04

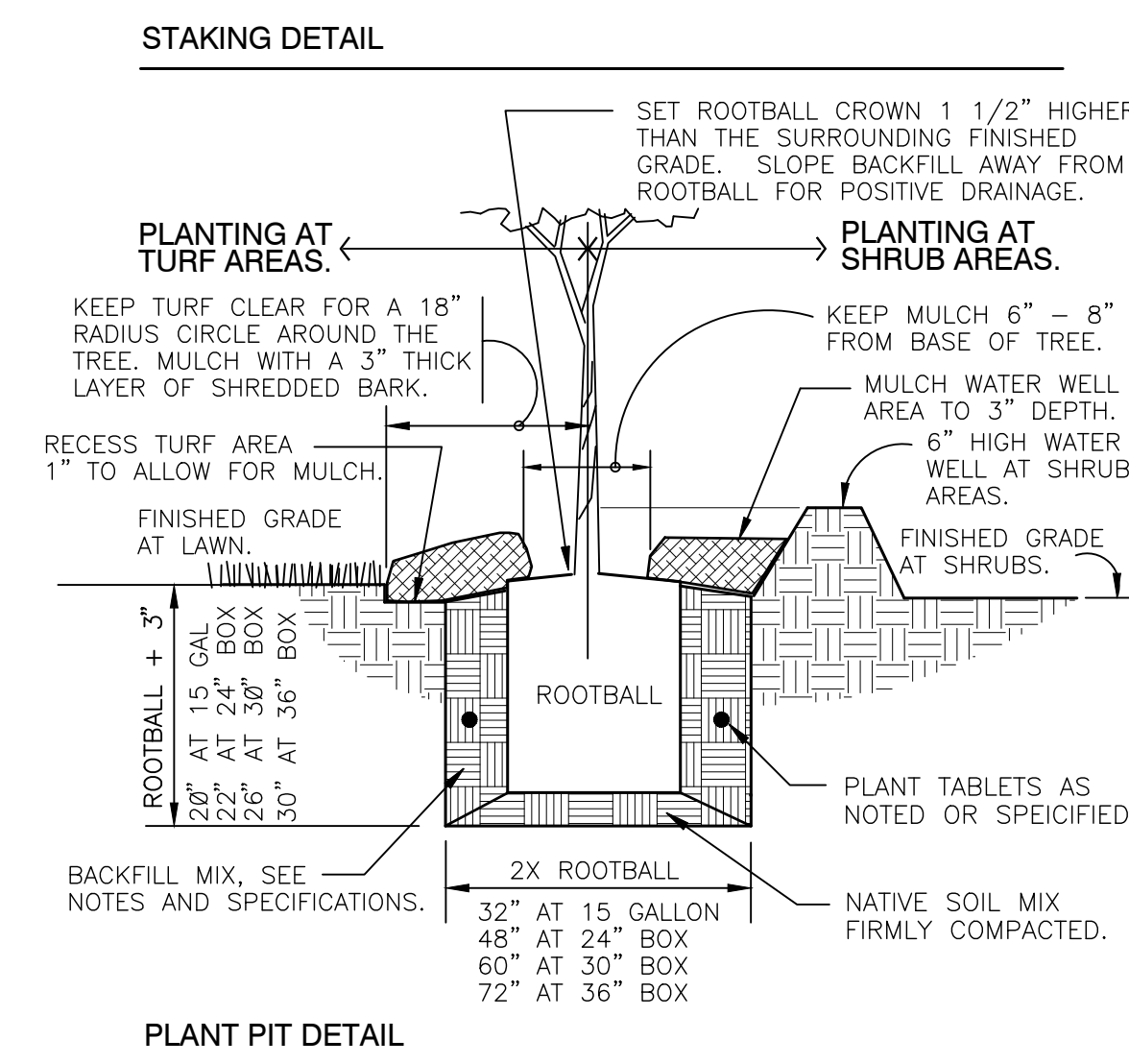
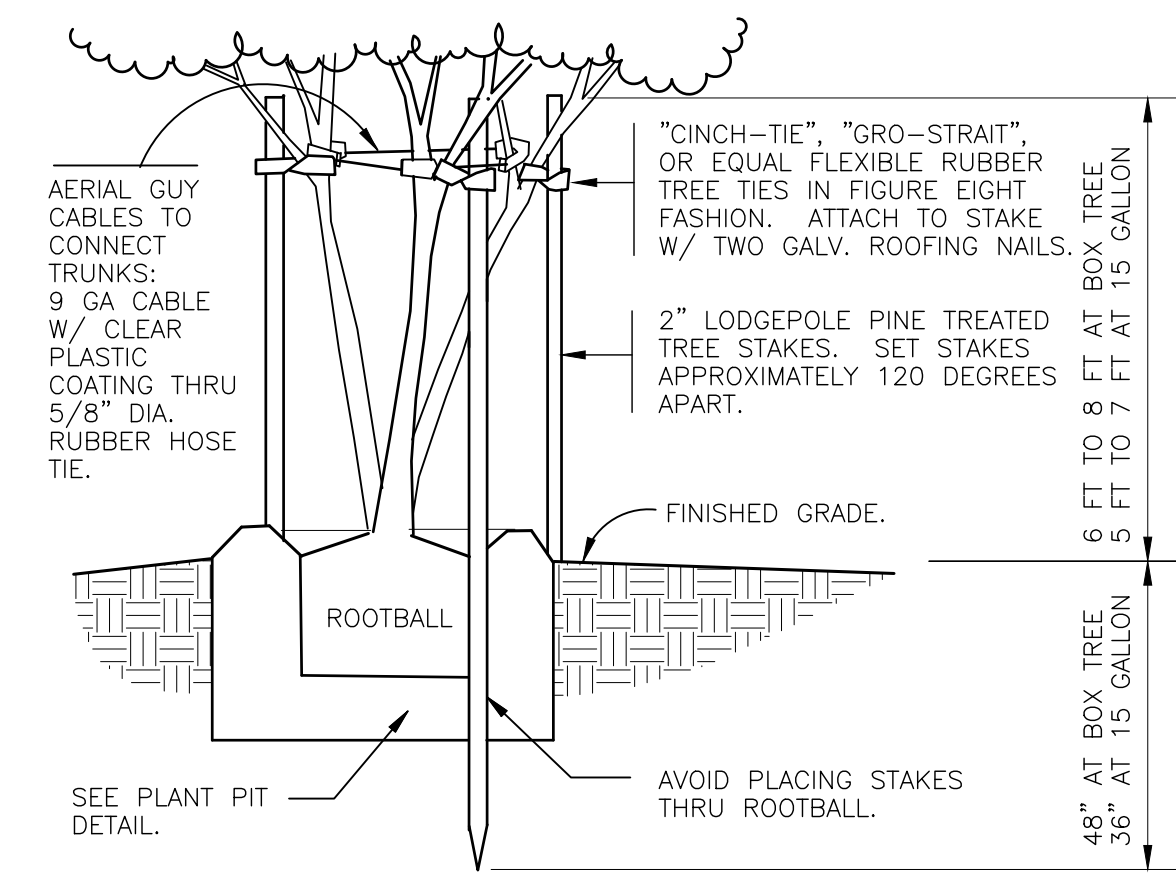

**6 TREE PLANTING MULTI-STAKE**  
1" = 1'-0" 329343.23-03

Q:\REGA\_5014366\CAD\Civil\Phase II\Landscape\REGA - Landscape.dwg