



## **MEMORANDUM**

---

**DATE:** January 30, 2017 (Updated March 28, 2017)  
**TO:** File  
**FROM:** Rick Baldocchi, P.E.  
**RE:** Pine Castle Elementary School - Temporary Swing School  
Existing Conditions and Queue Analysis

---

### **INTRODUCTION**

Orange County Public Schools (OCPS) is in the process of replacing the existing Pershing Elementary School located on Pershing Avenue in unincorporated Orange County, Florida, with a new K-8 school on the same site. While the new school is under construction, the students from the existing Pershing Elementary School will be temporarily transferred to Pine Castle Elementary School located on Waltham Street in Belle Isle, Florida. AVCON, INC. was retained to study the existing school site access at Pine Castle Elementary School. The purpose of this memorandum is to evaluate existing access conditions and to assist OCPS and Zyscovich Architects in evaluating proposed on-site improvements for parent drop-offs, school buses, and parking for the temporary swing school conditions created by the addition of the Pershing Elementary School students.

### **EXISTING PINE CASTLE ELEMENTARY SCHOOL**

#### **Existing Site Conditions**

Pine Castle Elementary School serves pre-kindergarten through fifth grade in the OCPS system. It is located on the north side of Waltham Avenue between Hansel Avenue (SR 527) and Randolph Avenue, just south of Hoffner Avenue (CR 15). The school is primarily accessed off Waltham Avenue, which is converted from two-way traffic to five westbound lanes on Monday through Friday from 7:45 to 8:45 AM and at 2:30 to 3:30 PM (1:30 to 2:30 PM on Wednesday). A police officer partially blocks the intersection of Waltham Avenue at Hansel Avenue to prevent eastbound traffic and to assist vehicles exiting right onto Hansel Avenue from Waltham Avenue.

The existing Pine Castle Elementary does not have an on-site parent loop or school bus loop for loading students. Cornerstone Charter School, a private school, is located on the south side of Waltham Avenue, directly across the street from Pine Castle Elementary School. Pine Castle Elementary School uses the right three lanes for queuing and loading students, and Cornerstone Charter School uses the left two lanes for loading students. School buses for Pine Castle Elementary School queue at the west end of Waltham Avenue near Hansel Avenue, while Cornerstone Charter School does not use school buses. There is a short driveway and loading

zone at the south side of the school on Waltham Avenue, but it does not appear to be used in the afternoon until after most vehicles have cleared Waltham Avenue. Pine Castle Elementary School also has a parking lot with a driveway entrance on Randolph Avenue east of the school. It did not appear to be used for loading students because of the configuration and driveway accessibility during peak school loading times. The existing parking lot has 69 paved and marked parking spaces, plus 2 ADA accessible parking spaces.

Randolph Avenue is a two-lane, local roadway with sidewalk on south side adjacent to Cornerstone Charter School. There is a wide paved shoulder on the north side adjacent to Pine Castle Elementary School. It is separated from the westbound travel lane by traffic cones and appeared to be used primarily for student loading. There is also a paved lane on the south side in front of Cornerstone Charter School that may serve as on-street parking during the day, but serves as the student loading zone after school. Randolph Avenue has a posted speed limit of 25 MPH. There are no school zone signs, pavement markings, speed detection/display signs on Randolph Avenue near the school.

Per OCPS records, student enrollment at Pine Castle Elementary School was 318 students at the time of the traffic counts. School hours were from 8:30 AM to 2:45 PM (1:45 PM Wednesday). The school's website indicated that they had 52 employees, which included 2 administrative, 31 classified and 19 instructional employees. Four school buses were observed serving the school at the time of the traffic counts.

### **Existing Turning Movement Counts**

For this analysis, vehicle turning movement counts and pedestrian crossing counts were taken on a Thursday from 7:45 AM to 8:45 AM and from 2:00 PM to 3:00 PM. Since the school's driveways were not being used during pre-count observations, the counts were performed at the intersections of Waltham Avenue at Hansel Avenue, Waltham Avenue at Randolph Avenue, Randolph Avenue at Wilks Avenue, and Randolph Avenue at Hoffner Avenue. Because Pine Castle Elementary and Cornerstone Charter Academy start and end within 15 minutes of each other, the counts do not identify the destination of the school traffic. Field observations during the counts provide better guidance on the traffic distribution between the two adjacent schools. Complete turning movement counts are attached to this memorandum for additional information.

### **Maximum Observed Queue**

The maximum observed queue at Pine Castle Elementary School was 85 vehicles at approximately five minutes after school was released in the afternoon. This consisted of 35 westbound vehicles on Waltham Avenue between Hansel Avenue and Randolph Avenue, 18 westbound vehicles on Waltham Avenue east of Randolph Avenue, 25 southbound vehicles on Randolph Avenue north of Waltham Avenue and 7 northbound vehicles on Randolph Avenue north of Waltham Avenue. The maximum observed queue included at least 12 westbound

vehicles on Waltham Avenue between Hansel Avenue and Randolph Avenue that were in the queue for Cornerstone Charter School. Vehicles on the remaining roads could not be distinguished between the adjacent schools.

## **EXISTING PERSHING ELEMENTARY SCHOOL**

### **Existing Site Conditions**

Pershing Elementary School serves pre-kindergarten through fifth grade in the OCPS system. It is located on the south side of E. Pershing Avenue between S. Ferncreek Avenue and S. Bumby Avenue. It is approximately 3 miles away from Pine Castle Elementary by vehicle.

Per OCPS records, student enrollment at Pershing Elementary School was 328 students at the time of the traffic counts. School hours were from 8:45 AM to 3:00 PM (2:00 PM Wednesday). The school's website indicated that they had 49 employees total, which included 7 administrative, 17 classified and 25 instructional employees. Two school buses were observed serving the school at the time of the traffic counts.

### **Existing Turning Movement Counts**

For this analysis, vehicle turning movement counts and pedestrian crossing counts were taken on a Thursday from 8:00 AM to 9:00 AM and from 2:15 PM to 3:15 PM. The counts were performed at the entrance and exit driveways for the parking/north loop, the intersection of Pershing Avenue at March Avenue and at the intersection of March Avenue at Overlake Avenue (the south loop). Complete turning movement counts are attached to this memorandum for additional information.

During the AM peak hour, 51 vehicles entered and 54 vehicles exited the parking/north loop, and 107 vehicles entered and 111 vehicles exited the south loop. During the AM peak 15 minutes, 20 vehicles entered and 30 vehicles exited the parking/north loop, and 40 vehicles entered and 42 vehicles exited the south loop. During the PM peak hour, 40 vehicles entered and 66 vehicles exited the parking/north loop, and 42 vehicles entered and 51 vehicles exited the south loop. During the PM peak 15 minutes, 16 vehicles entered and 17 vehicles exited the parking/north loop, and 24 vehicles entered and 46 vehicles exited the south loop.

### **Maximum Observed Queue**

The maximum observed queue at Pershing Elementary School was 47 vehicles at approximately five minutes after school was released in the afternoon. This consisted of 25 vehicles in the parking/north loop, 6 southbound vehicles on March Avenue, and 16 eastbound vehicles on Overlake Avenue.

## **PROPOSED PINE CASTLE ELEMENTARY SCHOOL - TEMPORARY SWING SCHOOL**

### **Enrollment**

If the existing Pine Castle Elementary School campus is intended to accommodate the enrollment at both Pine Castle and Pershing Elementary Schools while serving as a temporary swing school, then the combined enrollment would be 646 students. This combined swing school represents a 103.1% increase over the existing enrollment of 318 students at the existing Pine Castle Elementary School.

### **Staffing**

The existing Pine Castle Elementary School had 52 employees, which included 2 administrative, 31 classified and 19 instructional employees. The existing Pershing Elementary School had 49 employees total, which included 7 administrative, 17 classified and 25 instructional employees. If the current ratio of 52 staff to 318 students at the existing Pine Castle Elementary School is maintained at the temporary swing school, then staff could potentially increase to 106 employees. Combining the entire staff at both schools would result in a total of 101 employees; however, there may be some staffing overlaps at the swing school. If the swing school maintains 7 administrative (maximum of both schools), 39 classified (all of Pine Castle and half of Pershing) and 44 instructional (all of both schools), then the swing school would result in a total of 90 employees. The potential staffing of 90 is 13.9% of the planned enrollment of 646 students.

### **School Buses**

The existing Pine Castle Elementary School had 4 school buses and the existing Pershing Elementary School had 2 school buses observed at the time of the traffic counts. Since Pershing Elementary is approximately 3 miles away from Pine Castle Elementary by vehicle or on-foot, students that currently walk would be encouraged to ride a school bus to the temporary swing school.

School buses in Florida usually hold 65 to 84 elementary school students. For Pershing Elementary School with 328 students, the existing two school buses could transport approximately 130 students. The PM peak hour at Pershing Elementary School showed at least 82 vehicles entering both loops in the afternoon. The combined capacity of the buses and one student per vehicle would leave approximately 116 pedestrians or bicyclists to the school. If the same number of parents drive students, this would require at least 2 additional school buses just to transport the additional pedestrians and bicyclists. Based on these conditions, the temporary swing school would have a total of 8 school buses.

It is possible that the number of parents driving students to/from Pershing Elementary School could decrease given the additional distance to the temporary swing school at Pine Castle Elementary School. The AM peak at Pershing Elementary School showed at least 158 vehicles entering both loops in the morning. Up to 41% of the students currently being driven to school

could be transported by one additional school bus. It should be noted that any decrease in students currently being driven to school may also be offset by more parents driving students that currently walk or bicycle to school. If one additional bus is added to account for changes in students driven to school, the temporary swing school would have a total of 9 school buses.

### **Parking**

OCPS Design Standards for an elementary school calls for 75 total parking spaces minimum as space allows. In general, observed usage calls for one parking space for each staff member plus 10 parking spaces for visitors, which results in at least 100 parking spaces for the temporary swing school.

### **Proposed On-Site Storage**

The maximum observed queue at the existing Pine Castle Elementary School was 85 vehicles at approximately five minutes after school was released in the afternoon; however, this included at least 12 vehicles on Waltham Avenue between Hansel Avenue and Randolph Avenue that were in the queue for Cornerstone Charter School. If 30% of the queued vehicles observed on the surrounding roads were for Cornerstone Charter School, then the maximum observed queue for the existing Pine Castle Elementary could potentially be reduced to 58 vehicles.

Since the temporary swing school enrollment represents a 103.1% increase over the existing enrollment of 318 students at Pine Castle Elementary School, applying this same increase percentage to the maximum observed queue of 58 vehicles at Pine Castle Elementary School results in a potential maximum queue of 118 vehicles.

Alternately, combining with the maximum observed queue of 47 vehicles at Pershing Elementary School with the maximum observed queue of 58 vehicles at Pine Castle Elementary School results in a potential maximum queue of 105 vehicles.

Increasing the observed maximum queue based on the swing school enrollment or combining the maximum observed queues for both school may not provide the best estimate for the potential queue at the temporary swing school. For comparison, the potential parent drop-off/pick-up queue at the temporary swing school was estimated using turning movement counts and observations for similar elementary schools in Orange County, Florida. The queue ranges were then adjusted to determine a comparable range for the potential 646 enrollment at the swing school. Those estimated queue ranges and the average of the queue ranges are shown on the following page.

Pine Castle Elementary Temporary Swing School On-Site Queue Analysis					
Basis for Queue	Enrollment Ratio (Prop. Pine Castle/ Basis School)	Adjusted Peak 15 Minute Exit Volume		Queue Range	
		AM	PM	Min	Max
Based on Avalon ES	0.680	93	41	41	93
Based on Cypress Park ES	2.228	78	72	72	78
Based on Dream Lake ES	0.779	98	76	76	98
Based on Frangus ES	0.973	89	108	90	108
Based on Hungerford ES	2.220	65	60	61	65
Based on Ivey Lane ES	2.000	70	70	70	70
Based on Lake Weston ES	1.086	100	61	61	100
Based on Lockhart ES	1.407	95	106	95	106
Based on Maxey ES	2.212	56	74	56	74
Based on Millennia ES	0.622	84	68	68	84
Based on Oak Hill ES	1.284	94	92	92	94
Based on Rock Lake ES	2.485	80	132	80	132
Based on Riverside ES	1.006	64	68	64	68
		<b>Average Queue</b>		<b>72</b>	<b>90</b>

Based on the similar elementary schools shown above, the projected queue range for 646 students at the temporary swing school would be 72 to 90 vehicles. The maximum queue of 90 vehicles would be 13.9% of the enrollment.

### Proposed Queuing Plan

The existing Pine Castle Elementary School is primarily accessed off Waltham Avenue, which is converted from two-way traffic to five westbound lanes on Monday through Friday from 7:45 to 8:45 AM and at 2:30 to 3:30 PM (1:30 to 2:30 PM on Wednesday). Vehicles queue on Waltham Avenue and Randolph Avenue, both in the through lanes and parked on the shoulders. After conversations with OCPS, City of Belle Isle, and Orange County, Zyscovich Architects developed a queuing plan for Pine Castle Elementary School that would provide an on-site parent loop with a new entrance driveway just north of the existing parking driveway on Randolph Avenue. The existing parking driveway would serve as the exit driveway for the parking/parent loop. Exiting vehicles would be restricted to lefts-out only during peak arrival and departure times. This should minimize swing school vehicles on Waltham Avenue and reduce conflicts with Cornerstone Charter School traffic. It also provides more room for additional school buses to queue on Waltham Avenue in front of the school. The proposed queuing plan shown on the following page provides stacking for 9 school buses, parking for 100 vehicles and on-site parent stacking for 97 vehicles.

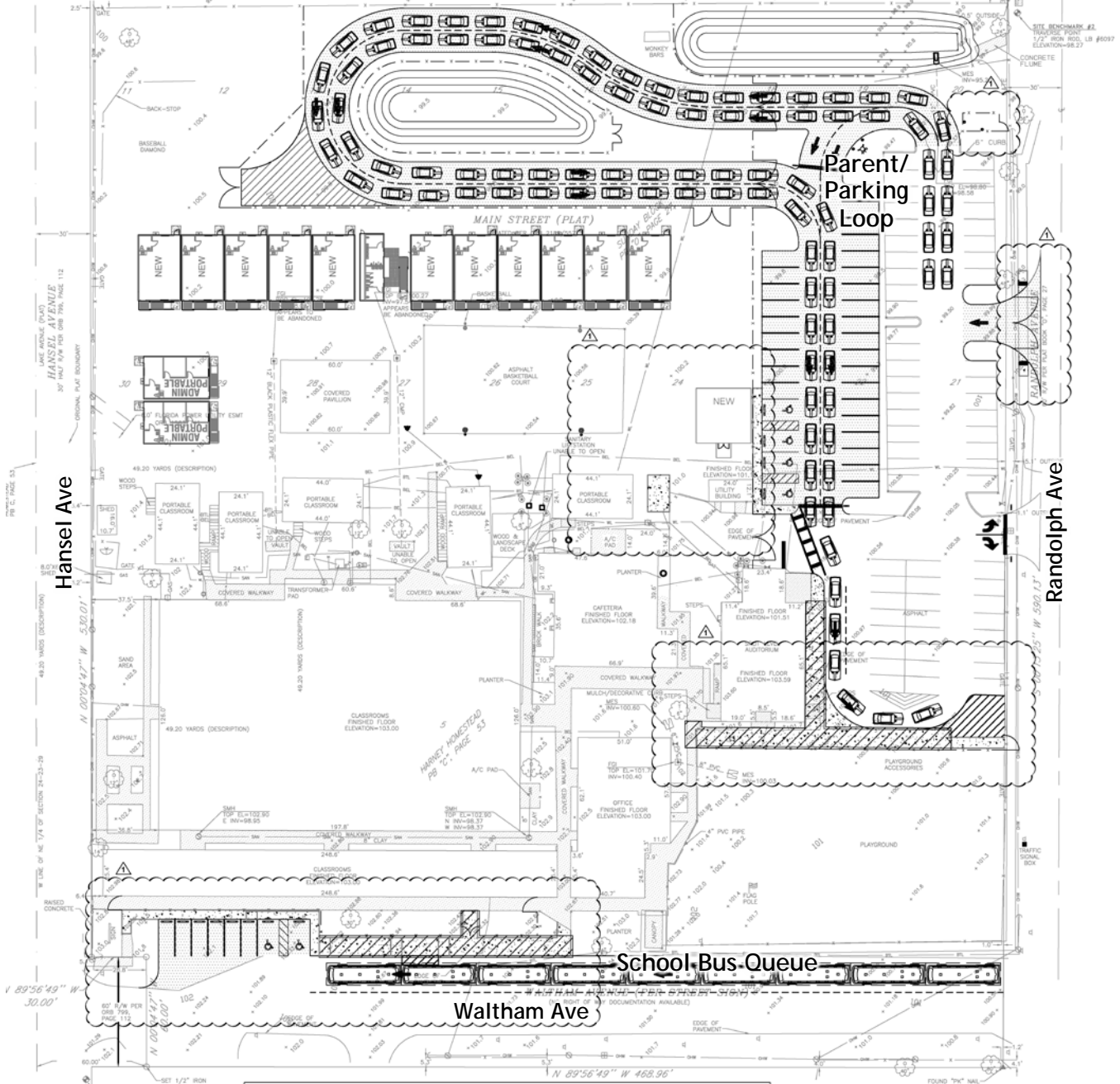
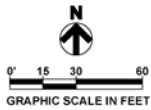

PARKING CALCULATIONS							
CRITERIA (PER OCCPS)	CRITERIA (PER FBC)	STAFF COUNT	STUDENT COUNT	REQUIRED PARKING	PROVIDED PARKING	REQUIRED ADA	PROVIDED ADA
75 SPACES MIN.	1 SPACE PER STAFF + 1 SPACE PER 100 STUDENTS	90	650	97	100	4	6

Proposed Swing School Circulation Plan

## **SUMMARY**

This preliminary analysis is based on a temporary swing school at Pine Castle Elementary that would accommodate 646 students and at least 90 employees. For 646 students, the recommended parent design storage range based on the volumes observed at the existing schools and similar OCPS elementary schools is 90 to 118 vehicles. The recommended design storage volume for school buses is at least 9 school buses. The swing school should also provide at least one parking space for each staff member plus 10 parking spaces for visitors, which results in 100 parking spaces for the proposed school. OCPS Design Standards for an elementary school calls for 75 total parking spaces minimum as space allows.

The proposed queuing plan provides on-site parent stacking for 97 vehicles, which falls within the recommend range for on-site parent storage. The modified school bus loading zone on Waltham Avenue provides stacking for 9 school buses, which meets the recommended school bus storage volume. The expanded parking provides for 100 vehicles, which meets the recommended parking.

This analysis is based on the Pine Castle Elementary School and Pershing Elementary School enrollment, staffing, and traffic counts as indicated at the time of the data collection. If any of the data changes or students are distributed to other schools, then the temporary swing school conditions will need to be reevaluated.

---

**END OF MEMORANDUM**



# Turning Movement Counts





# Accurate Traffic Counts, Inc.

798 Executive Drive, Suite A  
Oviedo, Florida 32765

[info@accuratetraffic.com](mailto:info@accuratetraffic.com)

Station: 001  
Counted by: Gerardo  
Weather: Clear  
Location: Randolph Av at Hoffner Av

File Name : Sta 001\_Randolph Av at Hoffner Av  
Site Code : 00012331  
Start Date : 12/15/2016  
Page No : 1

## Groups Printed- General Traffic

Start Time	Randolph Avenue Southbound				Hoffner Avenue Westbound				Randolph Avenue Northbound				Hoffner Avenue Eastbound				Int. Total
	Left	Thru	Right	App. Total	Left	Thru	Right	App. Total	Left	Thru	Right	App. Total	Left	Thru	Right	App. Total	
07:45	0	0	0	0	11	149	0	160	5	0	5	10	0	141	69	210	380
Total	0	0	0	0	11	149	0	160	5	0	5	10	0	141	69	210	380
08:00	0	0	1	1	7	161	0	168	6	0	12	18	1	122	34	157	344
08:15	0	0	1	1	7	122	1	130	3	0	7	10	2	106	27	135	276
08:30	0	0	1	1	5	172	0	177	2	0	4	6	2	84	4	90	274
*** BREAK ***																	
Total	0	0	3	3	19	455	1	475	11	0	23	34	5	312	65	382	894
*** BREAK ***																	
14:00	0	0	0	0	16	105	0	121	3	0	6	9	1	142	27	170	300
14:15	0	0	0	0	8	98	0	106	6	0	3	9	1	150	31	182	297
14:30	1	0	1	2	6	102	1	109	2	0	3	5	0	178	24	202	318
14:45	0	0	0	0	5	93	1	99	26	0	16	42	0	162	46	208	349
Total	1	0	1	2	35	398	2	435	37	0	28	65	2	632	128	762	1264
Grand Total	1	0	4	5	65	1002	3	1070	53	0	56	109	7	1085	262	1354	2538
Apprch %	20	0	80		6.1	93.6	0.3		48.6	0	51.4		0.5	80.1	19.4		
Total %	0	0	0.2	0.2	2.6	39.5	0.1	42.2	2.1	0	2.2	4.3	0.3	42.8	10.3	53.3	



# Accurate Traffic Counts, Inc.

798 Executive Drive, Suite A  
Oviedo, Florida 32765

[info@accuratetraffic.com](mailto:info@accuratetraffic.com)

Station: 001  
Counted by: Gerardo  
Weather: Clear  
Location: Randolph Av at Hoffner Av

File Name : Sta 001\_Randolph Av at Hoffner Av  
Site Code : 00012331  
Start Date : 12/15/2016  
Page No : 1

## Groups Printed- School Buses

Start Time	Randolph Avenue Southbound				Hoffner Avenue Westbound				Randolph Avenue Northbound				Hoffner Avenue Eastbound				Int. Total
	Left	Thru	Right	App. Total	Left	Thru	Right	App. Total	Left	Thru	Right	App. Total	Left	Thru	Right	App. Total	
07:45	0	0	0	0	0	0	0	0	0	0	1	1	0	0	0	0	1
Total	0	0	0	0	0	0	0	0	0	0	1	1	0	0	0	0	1
08:00	0	0	0	0	0	1	0	1	0	0	0	0	0	0	0	0	1
*** BREAK ***																	
Total	0	0	0	0	0	1	0	1	0	0	0	0	0	0	0	0	1
*** BREAK ***																	
14:00	0	0	0	0	1	0	0	1	0	0	0	0	0	0	0	0	1
*** BREAK ***																	
14:30	0	0	0	0	0	0	0	0	0	0	0	0	0	0	1	1	1
14:45	0	0	0	0	0	1	0	1	0	0	0	0	0	0	1	1	2
Total	0	0	0	0	1	1	0	2	0	0	0	0	0	0	2	2	4
Grand Total	0	0	0	0	1	2	0	3	0	0	1	1	0	0	2	2	6
Apprch %	0	0	0		33.3	66.7	0		0	0	100		0	0	100		
Total %	0	0	0		16.7	33.3	0	50	0	0	16.7	16.7	0	0	33.3	33.3	

ORANGE COUNTY, FLORIDA

**PEDESTRIANS MOVEMENT SUMMARY**

CODE / STATION NO.: 1  
 NORTH / SOUTH: Randolph Avenue  
 OBSERVER: Gerardo  
 WEATHER: Clear  
 REMARKS: \_\_\_\_\_

CITY: Orlando  
 INTERSECTING ROUTE: Hoffner Avenue

COUNTY: Orange  
 MILEPOST: X

**GPS COORDINATES**

Latitude	Longitude
00° 00.000' N	000° 00.000' W

FORM COMPLETED BY: Santiago

DATE: 12/15/2016

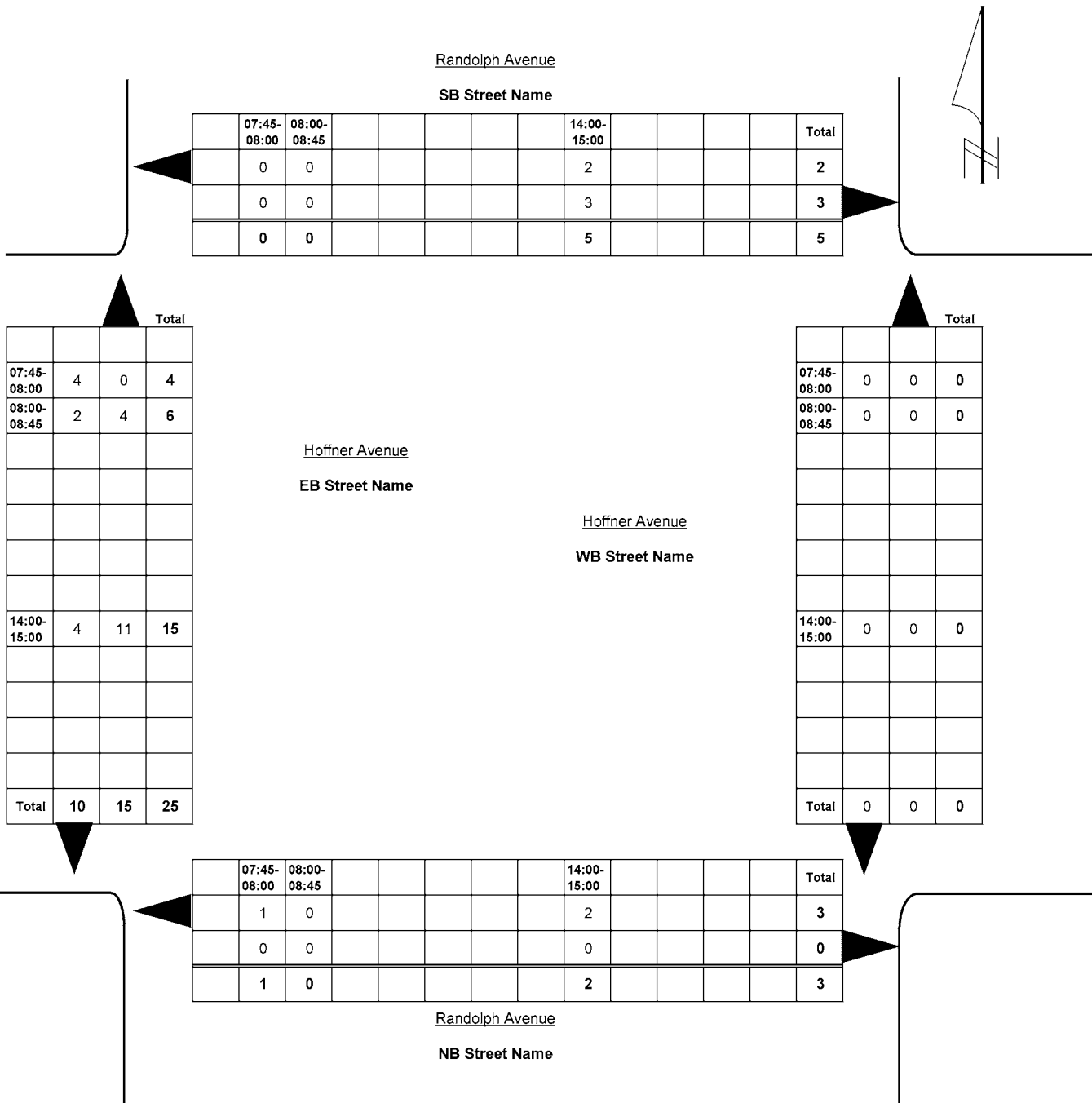

**BICYCLES MOVEMENT SUMMARY**

CODE / STATION NO.: 1  
 NORTH / SOUTH: Randolph Avenue  
 OBSERVER: Gerardo  
 WEATHER: Clear  
 REMARKS: \_\_\_\_\_

CITY: Orlando  
 INTERSECTING ROUTE: Hoffner Avenue

COUNTY: Orange  
 MILEPOST: X

**GPS COORDINATES**

Latitude	Longitude
00° 00.000' N	000° 00.000' W

FORM COMPLETED BY: Santiago

DATE: 12/15/2016

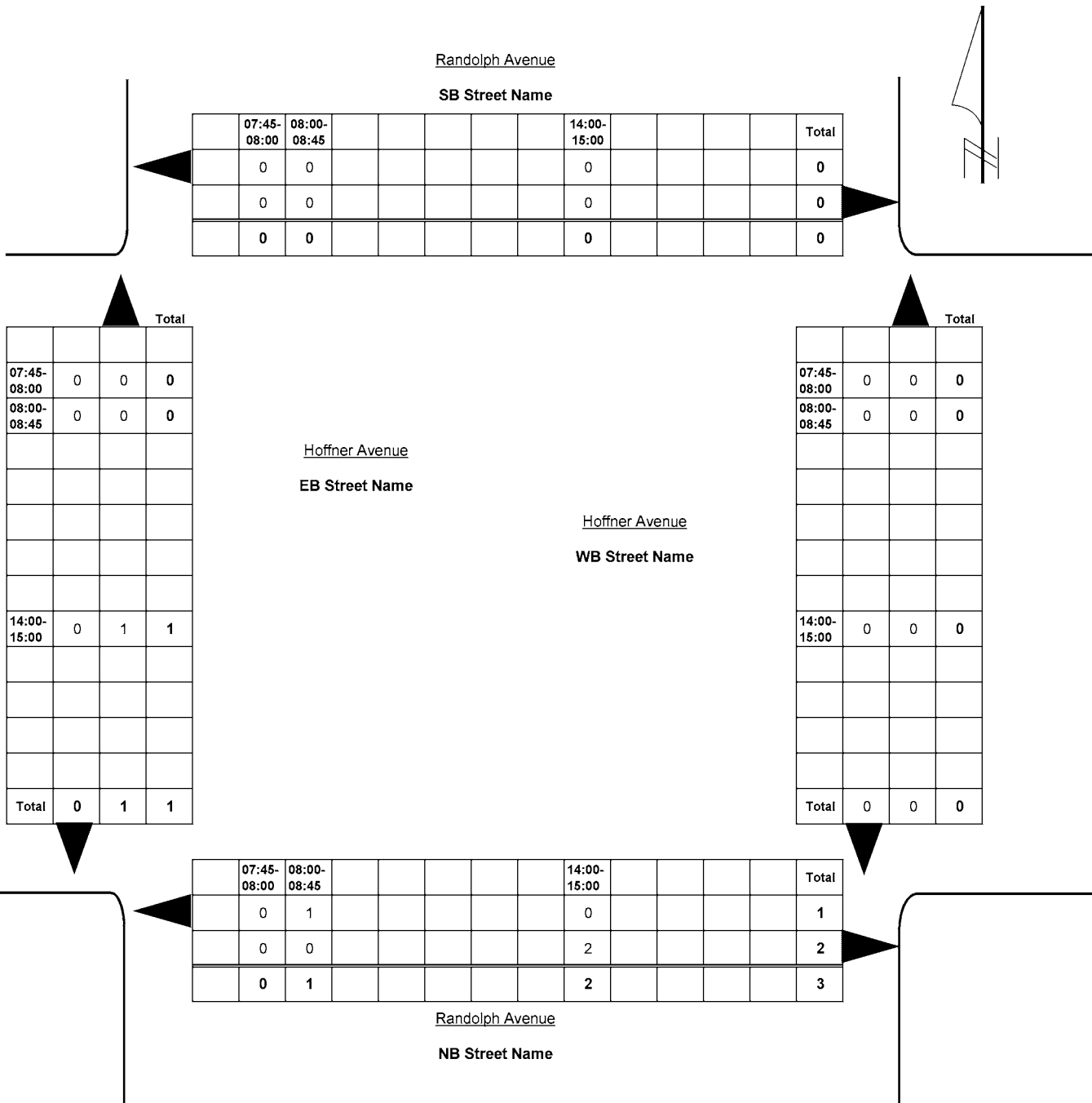





# Accurate Traffic Counts, Inc.

798 Executive Drive, Suite A  
Oviedo, Florida 32765

*info@accuratetraffic.com*

Station: 002

Counted by: Elaine

Weather: Clear

Location: Randolph Av at Pine Castle

File Name : Sta 002\_Randolph Av at Pine Castle Elementary School - Wilks Av

Site Code : 00022294

Start Date : 12/15/2016

Page No : 1

## Groups Printed- General Traffic

Start Time	Randolph Av Southbound				Wilks Av Westbound				Randolph Av Northbound				Pine Castle Elementary School Eastbound				Int. Total
	Left	Thru	Right	App. Total	Left	Thru	Right	App. Total	Left	Thru	Right	App. Total	Left	Thru	Right	App. Total	
07:45	0	73	12	85	6	0	1	7	3	11	1	15	0	1	0	1	108
Total	0	73	12	85	6	0	1	7	3	11	1	15	0	1	0	1	108
08:00	2	32	8	42	4	1	2	7	6	12	1	19	2	1	5	8	76
08:15	2	35	4	41	1	1	1	3	4	8	0	12	4	0	1	5	61
08:30	0	9	0	9	0	0	1	1	2	2	1	5	4	0	10	14	29
*** BREAK ***																	
Total	4	76	12	92	5	2	4	11	12	22	2	36	10	1	16	27	166
*** BREAK ***																	
14:00	2	37	4	43	0	0	1	1	1	7	0	8	2	0	0	2	54
14:15	3	26	6	35	0	0	0	0	2	4	0	6	4	0	1	5	46
14:30	0	27	6	33	3	0	0	3	1	3	1	5	3	0	0	3	44
14:45	4	43	6	53	2	0	8	10	1	9	3	13	19	0	4	23	99
Total	9	133	22	164	5	0	9	14	5	23	4	32	28	0	5	33	243
Grand Total	13	282	46	341	16	2	14	32	20	56	7	83	38	2	21	61	517
Apprch %	3.8	82.7	13.5		50	6.2	43.8		24.1	67.5	8.4		62.3	3.3	34.4		
Total %	2.5	54.5	8.9	66	3.1	0.4	2.7	6.2	3.9	10.8	1.4	16.1	7.4	0.4	4.1	11.8	





# Accurate Traffic Counts, Inc.

798 Executive Drive, Suite A  
 Oviedo, Florida 32765

*info@accuratetraffic.com*

Station: 002

Counted by: Elaine

Weather: Clear

Location: Randolph Av at Pine Castle

File Name : Sta 002\_Randolph Av at Pine Castle Elementary School - Wilks Av

Site Code : 00022294

Start Date : 12/15/2016

Page No : 1

## Groups Printed- School Bus

Start Time	Randolph Av Southbound				Wilks Av Westbound				Randolph Av Northbound				Pine Castle Elementary School Eastbound				Int. Total
	Left	Thru	Right	App. Total	Left	Thru	Right	App. Total	Left	Thru	Right	App. Total	Left	Thru	Right	App. Total	
07:45	0	0	0	0	0	0	0	0	0	1	0	1	0	0	0	0	1
Total	0	0	0	0	0	0	0	0	0	1	0	1	0	0	0	0	1
*** BREAK ***																	
14:00	0	1	0	1	0	0	0	0	0	0	0	0	0	0	0	0	1
*** BREAK ***																	
14:45	0	1	0	1	0	0	0	0	0	0	0	0	0	0	0	0	1
Total	0	2	0	2	0	0	0	0	0	0	0	0	0	0	0	0	2
Grand Total	0	2	0	2	0	0	0	0	0	1	0	1	0	0	0	0	3
Apprch %	0	100	0		0	0	0		0	100	0		0	0	0		
Total %	0	66.7	0	66.7	0	0	0	0	0	33.3	0	33.3	0	0	0	0	

**PEDESTRIANS MOVEMENT SUMMARY**

CODE / STATION NO.: 2  
 NORTH / SOUTH: Randolph Avenue  
 OBSERVER: Elaine  
 WEATHER: Clear  
 REMARKS: \_\_\_\_\_

CITY: Orlando  
 INTERSECTING ROUTE: Pine Castle Elementary School  
Wilks Avenue

COUNTY: Orange  
 MILEPOST: X

**GPS COORDINATES**

Latitude	Longitude
00°00.000' N	000°00.000' W

FORM COMPLETED BY: Santiago

DATE: 12/15/2016

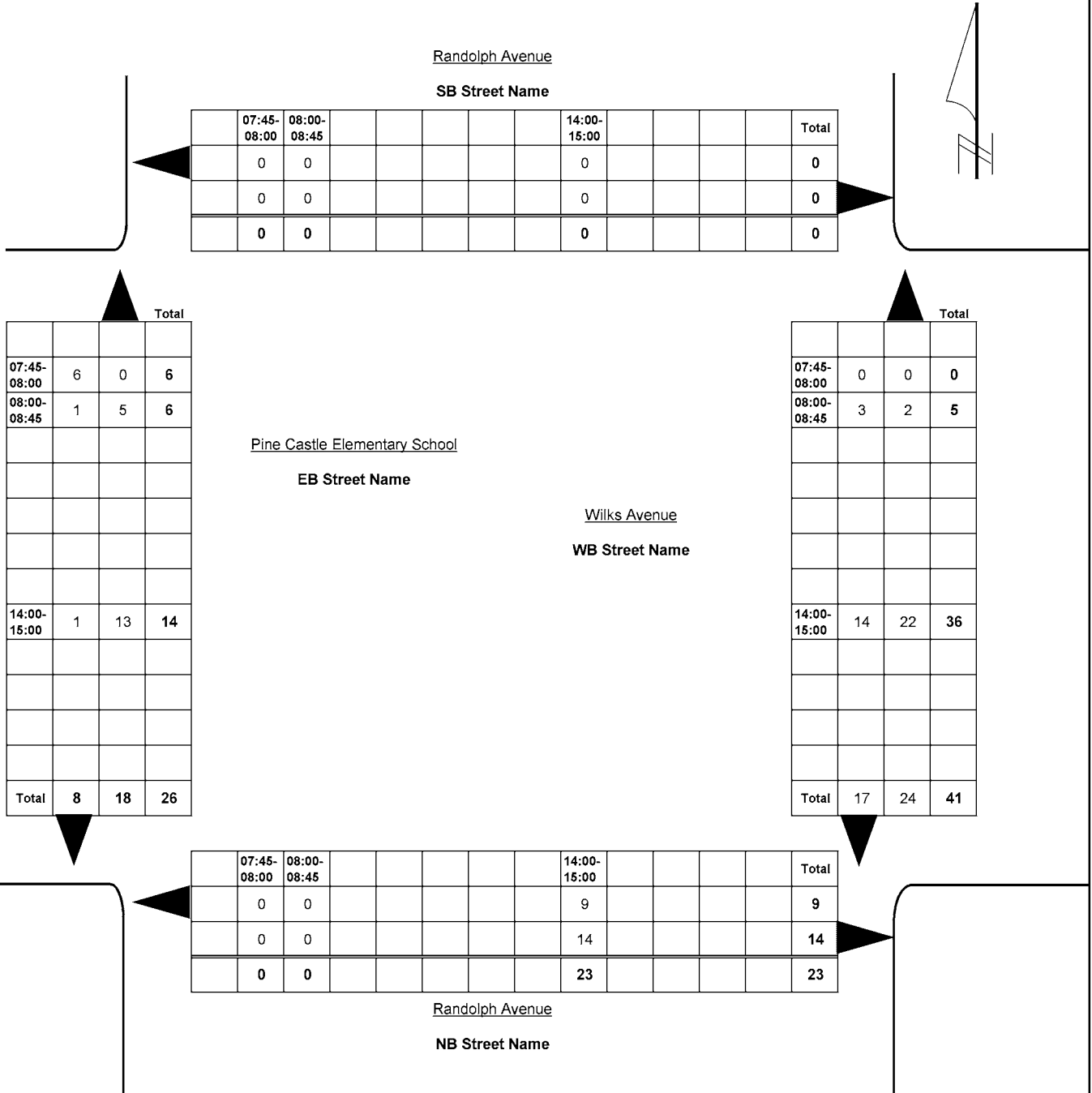

**BICYCLES MOVEMENT SUMMARY**

CODE / STATION NO.: 2  
 NORTH / SOUTH: Randolph Avenue  
 OBSERVER: Elaine  
 WEATHER: Clear  
 REMARKS: \_\_\_\_\_

CITY: Orlando  
 INTERSECTING ROUTE: Pine Castle Elementary School  
Wilks Avenue

COUNTY: Orange  
 MILEPOST: X

**GPS COORDINATES**

Latitude	Longitude
00°00.000' N	000°00.000' W

FORM COMPLETED BY: Santiago

DATE: 12/15/2016

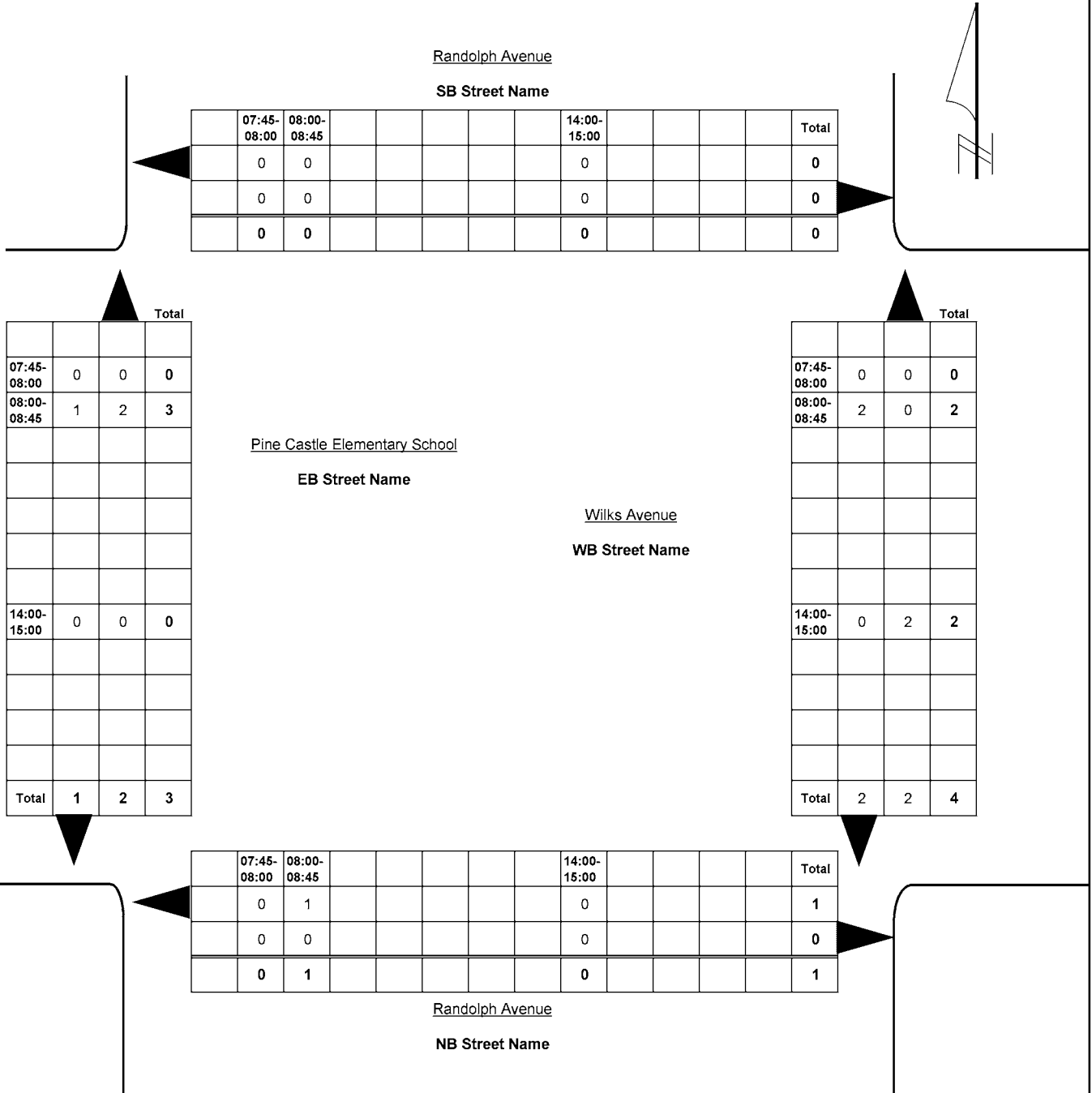





# Accurate Traffic Counts, Inc.

798 Executive Drive, Suite A

Oviedo, Florida 32765

[info@accuratetraffic.com](mailto:info@accuratetraffic.com)

Station: 003

Counted by: Gerardo

Weather: Clear

Location: Randolph Av at Waltham Av

File Name : sta 003\_randolph av at waltham av

Site Code : 00032331

Start Date : 12/20/2016

Page No : 1

## Groups Printed- General Traffic

Start Time	Randolph Av Southbound				Waltham Av Westbound				Randolph Av Northbound				Waltham Av Eastbound				Int. Total
	Left	Thru	Right	App. Total	Left	Thru	Right	App. Total	Left	Thru	Right	App. Total	Left	Thru	Right	App. Total	
07:45	0	34	44	78	44	29	1	74	43	15	4	62	0	0	0	0	214
Total	0	34	44	78	44	29	1	74	43	15	4	62	0	0	0	0	214
08:00	2	8	30	40	6	2	1	9	36	17	2	55	0	0	2	2	106
08:15	1	10	22	33	3	6	0	9	26	10	1	37	1	1	3	5	84
08:30	1	7	12	20	14	7	0	21	4	4	0	8	1	0	2	3	52
*** BREAK ***																	
Total	4	25	64	93	23	15	1	39	66	31	3	100	2	1	7	10	242
*** BREAK ***																	
14:00	7	18	10	35	0	0	0	0	3	8	3	14	0	1	0	1	50
14:15	5	7	3	15	0	0	0	0	3	8	3	14	0	0	0	0	29
14:30	2	16	19	37	20	7	0	27	14	5	1	20	0	0	0	0	84
14:45	1	21	27	49	20	17	1	38	18	12	5	35	0	0	0	0	122
Total	15	62	59	136	40	24	1	65	38	33	12	83	0	1	0	1	285
Grand Total	19	121	167	307	107	68	3	178	147	79	19	245	2	2	7	11	741
Apprch %	6.2	39.4	54.4		60.1	38.2	1.7		60	32.2	7.8		18.2	18.2	63.6		
Total %	2.6	16.3	22.5	41.4	14.4	9.2	0.4	24	19.8	10.7	2.6	33.1	0.3	0.3	0.9	1.5	



# Accurate Traffic Counts, Inc.

798 Executive Drive, Suite A  
Oviedo, Florida 32765

*info@accuratetraffic.com*

Station: 003  
Counted by: Gerardo  
Weather: Clear  
Location: Randolph Av at Waltham Av

File Name : sta 003\_randolph av at waltham av  
Site Code : 00032331  
Start Date : 12/20/2016  
Page No : 1

**Groups Printed- School Bus**

Start Time	Randolph Av Southbound				Waltham Av Westbound				Randolph Av Northbound				Waltham Av Eastbound				Int. Total
	Left	Thru	Right	App. Total	Left	Thru	Right	App. Total	Left	Thru	Right	App. Total	Left	Thru	Right	App. Total	
07:45	0	0	0	0	0	0	0	0	0	1	0	1	0	0	0	0	1
Total	0	0	0	0	0	0	0	0	0	1	0	1	0	0	0	0	1
08:00	0	0	0	0	0	0	0	0	3	0	0	3	0	0	0	0	3
08:15	0	0	0	0	0	0	0	0	0	1	0	1	0	0	0	0	1
*** BREAK ***																	
Total	0	0	0	0	0	0	0	0	3	1	0	4	0	0	0	0	4
*** BREAK ***																	
14:00	0	0	1	1	0	0	0	0	0	0	0	0	0	0	0	0	1
14:15	0	0	0	0	0	0	0	0	1	0	0	1	0	0	0	0	1
*** BREAK ***																	
14:45	0	0	1	1	0	0	0	0	1	0	0	1	0	0	0	0	2
Total	0	0	2	2	0	0	0	0	2	0	0	2	0	0	0	0	4
Grand Total	0	0	2	2	0	0	0	0	5	2	0	7	0	0	0	0	9
Apprch %	0	0	100		0	0	0		71.4	28.6	0		0	0	0		
Total %	0	0	22.2	22.2	0	0	0	0	55.6	22.2	0	77.8	0	0	0	0	

### PEDESTRIANS MOVEMENT SUMMARY

CODE / STATION NO.: 3  
 NORTH / SOUTH: Randolph Avenue  
 OBSERVER: Gerardo  
 WEATHER: Clear  
 REMARKS: \_\_\_\_\_

CITY: Orlando  
 INTERSECTING ROUTE: Waltham Avenue

COUNTY: Orange  
 MILEPOST: X

GPS COORDINATES	
Latitude	Longitude
00° 00.000' N	000° 00.000' W

FORM COMPLETED BY: Santiago

DATE: 12/15/2016

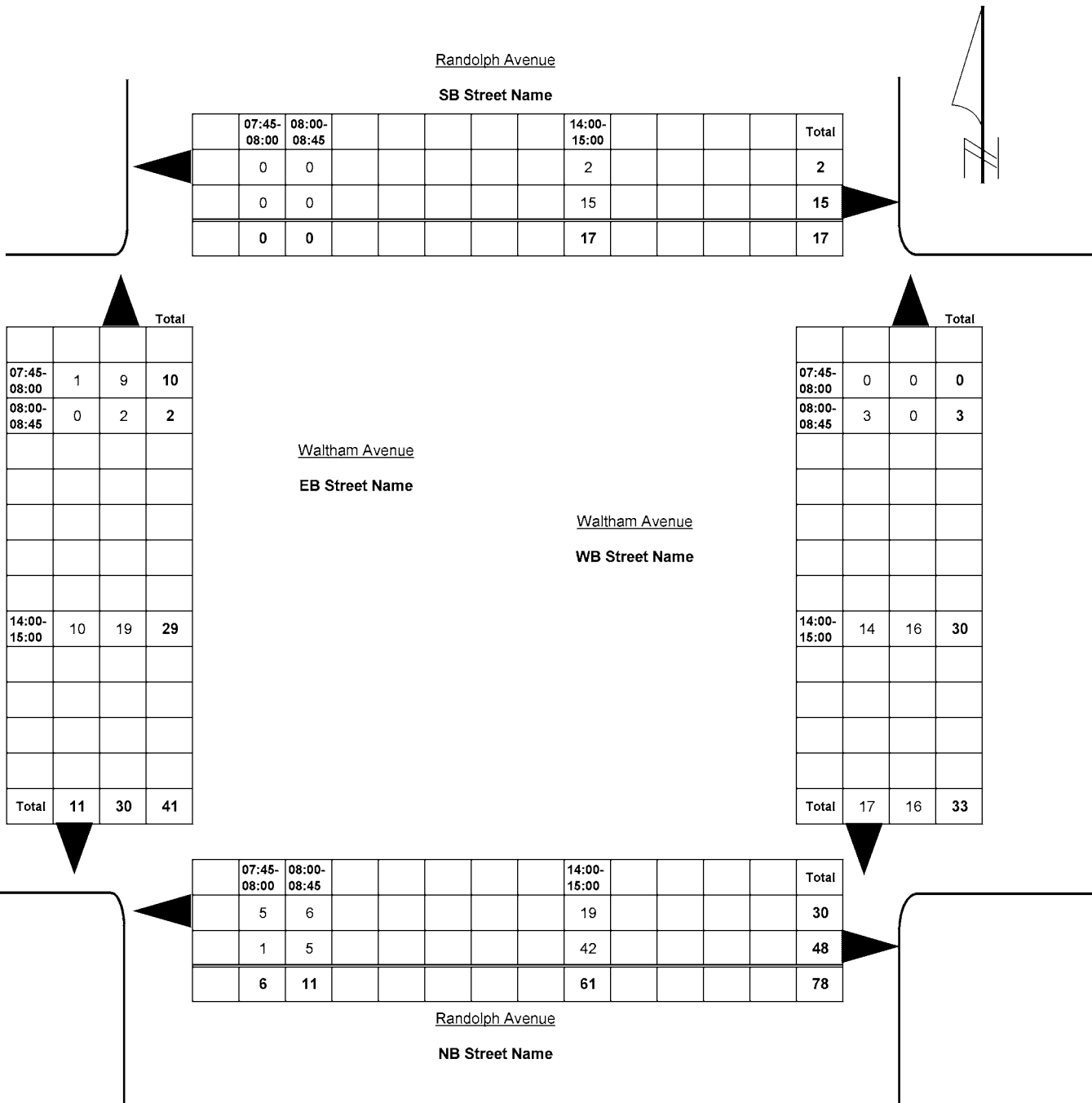

**BICYCLES MOVEMENT SUMMARY**

CODE / STATION NO.: 3  
 NORTH / SOUTH: Randolph Avenue  
 OBSERVER: Gerardo  
 WEATHER: Clear  
 REMARKS: \_\_\_\_\_

CITY: Orlando  
 INTERSECTING ROUTE: Waltham Avenue

COUNTY: Orange  
 MILEPOST: X

**GPS COORDINATES**

Latitude	Longitude
00° 00.000' N	000° 00.000' W

FORM COMPLETED BY: Santiago

DATE: 12/15/2016

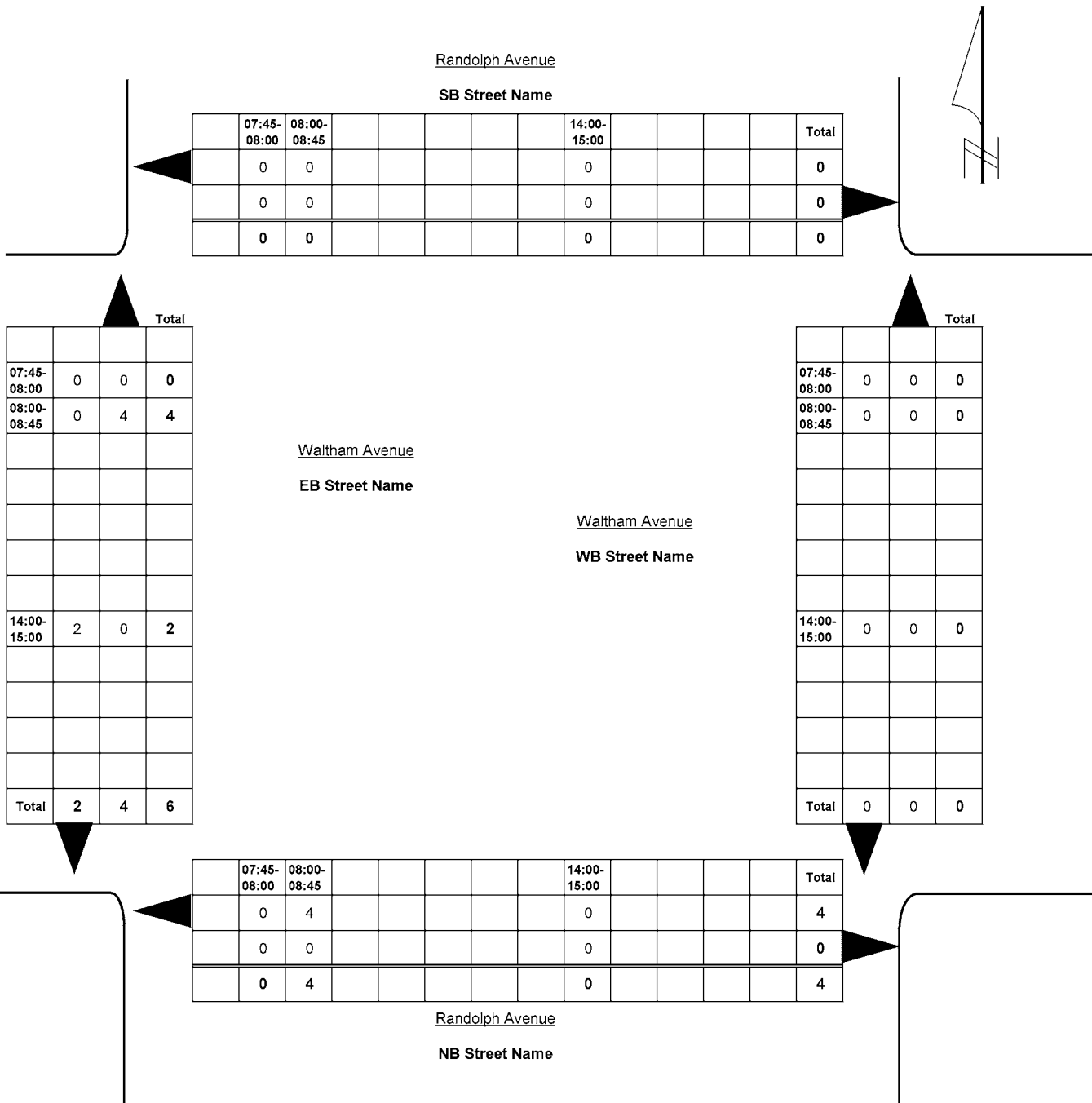







# Accurate Traffic Counts, Inc.

798 Executive Drive, Suite A  
Oviedo, Florida 32765

*info@accuratetraffic.com*

Station: 004  
Counted by: Amaury  
Weather: Clear  
Location: Hansel Av at Waltham Av

File Name : Sta 004\_Hansel Av at Waltham Av  
Site Code : 00042294  
Start Date : 12/15/2016  
Page No : 1

### Groups Printed- General Traffic

Start Time	Hansel Avenue Southbound				Waltham Avenue Westbound				Hansel Avenue Northbound				Waltham Avenue Eastbound				Int. Total
	Left	Thru	Right	App. Total	Left	Thru	Right	App. Total	Left	Thru	Right	App. Total	Left	Thru	Right	App. Total	
07:45	0	0	0	0	0	55	110	165	0	337	0	337	4	1	0	5	507
Total	0	0	0	0	0	55	110	165	0	337	0	337	4	1	0	5	507
08:00	0	0	0	0	0	40	45	85	1	441	0	442	1	0	0	1	528
08:15	0	0	0	0	0	25	31	56	0	315	0	315	0	0	0	0	371
08:30	0	0	0	0	0	15	6	21	4	304	3	311	2	0	0	2	334
08:45	0	0	0	0	0	0	2	2	0	9	0	9	0	0	0	0	11
Total	0	0	0	0	0	80	84	164	5	1069	3	1077	3	0	0	3	1244
*** BREAK ***																	
14:00	0	0	0	0	0	3	7	10	2	434	1	437	5	1	0	6	453
14:15	0	0	0	0	0	1	1	2	1	342	0	343	3	0	0	3	348
14:30	0	0	0	0	0	25	44	69	2	448	0	450	4	0	0	4	523
14:45	0	0	0	0	0	36	62	98	0	367	0	367	3	0	0	3	468
Total	0	0	0	0	0	65	114	179	5	1591	1	1597	15	1	0	16	1792
Grand Total	0	0	0	0	0	200	308	508	10	2997	4	3011	22	2	0	24	3543
Apprch %	0	0	0	0	0	39.4	60.6		0.3	99.5	0.1		91.7	8.3	0		
Total %	0	0	0	0	0	5.6	8.7	14.3	0.3	84.6	0.1	85	0.6	0.1	0	0.7	



# Accurate Traffic Counts, Inc.

798 Executive Drive, Suite A  
Oviedo, Florida 32765

*info@accuratetraffic.com*

Station: 004  
Counted by: Amaury  
Weather: Clear  
Location: Hansel Av at Waltham Av

File Name : Sta 004\_Hansel Av at Waltham Av  
Site Code : 00042294  
Start Date : 12/15/2016  
Page No : 1

### Groups Printed- School Bus

Start Time	Hansel Avenue Southbound				Waltham Avenue Westbound				Hansel Avenue Northbound				Waltham Avenue Eastbound				Int. Total
	Left	Thru	Right	App. Total	Left	Thru	Right	App. Total	Left	Thru	Right	App. Total	Left	Thru	Right	App. Total	
*** BREAK ***																	
08:00	0	0	0	0	0	0	3	3	0	1	0	1	0	0	0	0	4
08:15	0	0	0	0	0	1	0	1	0	1	0	1	0	0	0	0	2
*** BREAK ***																	
Total	0	0	0	0	0	1	3	4	0	2	0	2	0	0	0	0	6
*** BREAK ***																	
14:00	0	0	0	0	0	0	0	0	0	1	0	1	0	0	0	0	1
*** BREAK ***																	
14:30	0	0	0	0	0	0	1	1	0	1	0	1	0	0	0	0	2
14:45	0	0	0	0	0	0	3	3	0	0	0	0	0	0	0	0	3
Total	0	0	0	0	0	0	4	4	0	2	0	2	0	0	0	0	6
Grand Total	0	0	0	0	0	1	7	8	0	4	0	4	0	0	0	0	12
Apprch %	0	0	0		0	12.5	87.5		0	100	0		0	0	0		
Total %	0	0	0		0	8.3	58.3	66.7	0	33.3	0	33.3	0	0	0	0	

**PEDESTRIANS MOVEMENT SUMMARY**

CODE / STATION NO.: 4  
 NORTH / SOUTH: Hansel Avenue  
 OBSERVER: Amaury  
 WEATHER: Clear  
 REMARKS: \_\_\_\_\_

CITY: Orlando  
 INTERSECTING ROUTE: Waltham Avenue

COUNTY: Orange  
 MILEPOST: X

**GPS COORDINATES**

Latitude	Longitude
00° 00.000' N	000° 00.000' W

FORM COMPLETED BY: Santiago

DATE: 12/15/2016

Hansel Avenue

**SB Street Name**

07:45-08:00	08:00-08:45					14:00-15:00				Total
0	0					0				0
0	0					0				0
0	0					0				0



Total

07:45-08:00	08:00-08:45		Total
0	0	0	0
0	2	2	2
14:00-15:00	0	1	1
<b>Total</b>	<b>0</b>	<b>3</b>	<b>3</b>

Waltham Avenue

**EB Street Name**

Waltham Avenue

**WB Street Name**

Total

07:45-08:00	08:00-08:45		Total
0	1	1	1
2	4	6	6
14:00-15:00	0	4	4
<b>Total</b>	<b>2</b>	<b>9</b>	<b>11</b>

Total

07:45-08:00	08:00-08:45					14:00-15:00				Total
0	0					0				0
0	0					0				0
0	0					0				0

Hansel Avenue

**NB Street Name**

ORANGE COUNTY, FLORIDA

**BICYCLES MOVEMENT SUMMARY**

CODE / STATION NO.: 4  
 NORTH / SOUTH: Hansel Avenue  
 OBSERVER: Amaury  
 WEATHER: Clear  
 REMARKS: \_\_\_\_\_

CITY: Orlando  
 INTERSECTING ROUTE: Waltham Avenue

COUNTY: Orange  
 MILEPOST: X

**GPS COORDINATES**

Latitude	Longitude
00° 00.000' N	000° 00.000' W

FORM COMPLETED BY: Santiago

DATE: 12/15/2016

Hansel Avenue

**SB Street Name**

07:45-08:00	08:00-08:45						14:00-15:00				Total
0	0						0				0
0	0						0				0
0	0						0				0



**Total**

07:45-08:00	0	0	0
08:00-08:45	0	0	0
14:00-15:00	0	0	0
<b>Total</b>	<b>0</b>	<b>0</b>	<b>0</b>

Waltham Avenue

**EB Street Name**

Waltham Avenue

**WB Street Name**

**Total**

07:45-08:00	0	0	0
08:00-08:45	0	0	0
14:00-15:00	0	2	2
<b>Total</b>	<b>0</b>	<b>2</b>	<b>2</b>

**Total**

07:45-08:00	08:00-08:45						14:00-15:00				Total
0	0						0				0
0	0						0				0
0	0						0				0

Hansel Avenue

**NB Street Name**





# Accurate Traffic Counts, Inc.

798 Executive Drive, Suite A

Oviedo, Florida 32765

*info@accuratetraffic.com*

Station: 003

Counted by: Amaury Jr

Weather: Clear

Location: E Pershing Av at Pershing Elementary

File Name : sta 003\_e pershing av at pershing elementary school-west driveway

Site Code : 00035706

Start Date : 12/15/2016

Page No : 1

## Groups Printed- General Traffic

Start Time	Ontario Avenue Southbound				E Pershing Avenue Westbound				Pershing Elementary School - West Driveway Northbound				E Pershing Avenue Eastbound				Int. Total
	Left	Thru	Right	App. Total	Left	Thru	Right	App. Total	Left	Thru	Right	App. Total	Left	Thru	Right	App. Total	
08:00	3	2	9	14	4	65	0	69	0	0	0	0	9	37	7	53	136
08:15	4	3	10	17	7	91	2	100	0	0	1	1	9	35	6	50	168
08:30	3	4	18	25	10	91	3	104	0	0	0	0	10	57	10	77	206
08:45	3	1	4	8	4	74	4	82	0	0	0	0	1	27	3	31	121
Total	13	10	41	64	25	321	9	355	0	0	1	1	29	156	26	211	631

\*\*\* BREAK \*\*\*

14:15	1	0	1	2	3	49	1	53	0	0	0	0	6	59	1	66	121
14:30	0	0	5	5	3	61	2	66	0	0	0	0	3	67	4	74	145
14:45	3	4	10	17	3	52	3	58	0	0	0	0	2	72	8	82	157
Total	4	4	16	24	9	162	6	177	0	0	0	0	11	198	13	222	423
15:00	2	4	12	18	4	49	13	66	0	0	1	1	8	65	10	83	168
Grand Total	19	18	69	106	38	532	28	598	0	0	2	2	48	419	49	516	1222
Apprch %	17.9	17	65.1		6.4	89	4.7		0	0	100		9.3	81.2	9.5		
Total %	1.6	1.5	5.6	8.7	3.1	43.5	2.3	48.9	0	0	0.2	0.2	3.9	34.3	4	42.2	



# Accurate Traffic Counts, Inc.

798 Executive Drive, Suite A  
Oviedo, Florida 32765

*info@accuratetraffic.com*

Station: 003

Counted by: Amaury Jr

Weather: Clear

Location: E Pershing Av at Pershing

File Name : sta 003\_e pershing av at pershing elementary school-west driveway

Site Code : 00035706

Start Date : 12/15/2016

Page No : 1

## Groups Printed- School Bus

Start Time	Ontario Avenue Southbound				E Pershing Avenue Westbound				Pershing Elementary School - West Driveway Northbound				E Pershing Avenue Eastbound				Int. Total
	Left	Thru	Right	App. Total	Left	Thru	Right	App. Total	Left	Thru	Right	App. Total	Left	Thru	Right	App. Total	
*** BREAK ***																	
14:30	0	0	0	0	0	0	0	0	0	0	0	0	0	4	0	4	4
14:45	0	0	0	0	0	1	0	1	0	0	0	0	0	0	0	0	1
Total	0	0	0	0	0	1	0	1	0	0	0	0	0	4	0	4	5
15:00	0	0	0	0	2	2	0	4	0	0	0	0	0	0	0	0	4
Grand Total	0	0	0	0	2	3	0	5	0	0	0	0	0	4	0	4	9
Apprch %	0	0	0		40	60	0		0	0	0		0	100	0		
Total %	0	0	0	0	22.2	33.3	0	55.6	0	0	0	0	0	44.4	0	44.4	



ORANGE COUNTY, FLORIDA

**PEDESTRIANS MOVEMENT SUMMARY**

CODE / STATION NO.: 3

CITY: Orlando

COUNTY: Orange

NORTH / SOUTH: Pershing Elementary School West Drwy. INTERSECTING ROUTE: E Pershing Avenue

MILEPOST: X

OBSERVER: Amaury Jr.

WEATHER: Clear

REMARKS: \_\_\_\_\_

**GPS COORDINATES**

Latitude	Longitude
00° 00.000' N	000° 00.000' W

FORM COMPLETED BY: Santiago

DATE: 12/15/2016

Ontario Avenue

**SB Street Name**

	08:00-09:00					14:15-15:00	15:00-15:15				Total
	0					0	0				0
	8					2	2				12
	8					2	2				12

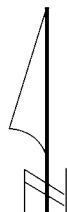

**Total**

08:00-09:00	0	4	4
14:15-15:00	0	0	0
15:00-15:15	0	2	2
<b>Total</b>	<b>0</b>	<b>6</b>	<b>6</b>

E Pershing Avenue

**EB Street Name**

E Pershing Avenue

**WB Street Name**

**Total**

08:00-09:00	2	0	2
14:15-15:00	1	0	1
15:00-15:15	2	0	2
<b>Total</b>	<b>5</b>	<b>0</b>	<b>5</b>

**Total**

	08:00-09:00					14:15-15:00	15:00-15:15				Total
	1					0	4				5
	0					0	0				0
	1					0	4				5

E Pershing Avenue

**NB Street Name**

**BICYCLES MOVEMENT SUMMARY**

CODE / STATION NO.: 3

CITY: Orlando

COUNTY: Orange

NORTH / SOUTH: Pershing Elementary School West Drwy. INTERSECTING ROUTE: E Pershing Avenue

MILEPOST: X

OBSERVER: Amaury Jr.

WEATHER: Clear

REMARKS: \_\_\_\_\_

**GPS COORDINATES**

Latitude	Longitude
00° 00.000' N	000° 00.000' W

FORM COMPLETED BY: Santiago

DATE: 12/15/2016

Ontario Avenue

**SB Street Name**

	08:00-09:00					14:15-15:00	15:00-15:15				Total
	0					0	0				0
	0					0	0				0
	0					0	0				0



**Total**

08:00-09:00	0	0	0
14:15-15:00	0	1	1
15:00-15:15	0	0	0
<b>Total</b>	<b>0</b>	<b>1</b>	<b>1</b>

E Pershing Avenue

**EB Street Name**

E Pershing Avenue

**WB Street Name**

**Total**

08:00-09:00	0	0	0
14:15-15:00	0	0	0
15:00-15:15	3	0	3
<b>Total</b>	<b>3</b>	<b>0</b>	<b>3</b>

**Total**

	08:00-09:00					14:15-15:00	15:00-15:15				Total
	0					0	1				1
	0					0	0				0
	0					0	1				1

E Pershing Avenue

**NB Street Name**







# Accurate Traffic Counts, Inc.

798 Executive Drive, Suite A  
 Oviedo, Florida 32765  
*info@accuratetraffic.com*

Station: 004 File Name : Sta 004\_E Pershing Av at Pershing Elementary School-East Driveway  
 Counted by: Elaine Site Code : 00045705  
 Weather: Clear Start Date : 12/15/2016  
 Location: E Pershing Av at Pershing Elementary School Page No : 1

**Groups Printed- School Bus**

Start Time	One Story House Driveway Southbound				E Pershing Avenue Westbound				Pershing Elementary School East Driveway Northbound				E Pershing Avenue Eastbound				Int. Total
	Left	Thru	Right	App. Total	Left	Thru	Right	App. Total	Left	Thru	Right	App. Total	Left	Thru	Right	App. Total	
08:00	0	0	0	0	0	0	0	0	1	0	0	1	0	0	0	0	1
08:15	0	0	0	0	0	0	0	0	1	0	1	2	0	0	0	0	2
*** BREAK ***																	
Total	0	0	0	0	0	0	0	0	2	0	1	3	0	0	0	0	3
*** BREAK ***																	
14:30	0	0	0	0	0	0	0	0	0	0	0	0	0	4	0	4	4
14:45	0	0	0	0	0	0	0	0	1	0	0	1	0	0	0	0	1
Total	0	0	0	0	0	0	0	0	1	0	0	1	0	4	0	4	5
15:00	0	0	0	0	0	0	0	0	0	0	1	1	0	0	0	0	1
Grand Total	0	0	0	0	0	0	0	0	3	0	2	5	0	4	0	4	9
Apprch %	0	0	0	0	0	0	0	0	60	0	40		0	100	0		
Total %	0	0	0	0	0	0	0	0	33.3	0	22.2	55.6	0	44.4	0	44.4	

**PEDESTRIANS MOVEMENT SUMMARY**

CODE / STATION NO.: 4

CITY: Orlando

COUNTY: Orange

NORTH / SOUTH: Pershing Elementary School East Drwy. INTERSECTING ROUTE: E Pershing Avenue

MILEPOST: X

OBSERVER: Elaine

WEATHER: Clear

REMARKS: \_\_\_\_\_

**GPS COORDINATES**

Latitude	Longitude
00° 00.000' N	000° 00.000' W

FORM COMPLETED BY: Santiago

DATE: 12/15/2016

One Story House Driveway

**SB Street Name**

	08:00-09:00						14:15-15:00	15:00-15:15				Total
	0						0	0				0
	8						2	2				12
	8						2	2				12



E Pershing Avenue

**EB Street Name**

E Pershing Avenue

**WB Street Name**

	Total		
08:00-09:00	0	4	4
14:15-15:00	0	0	0
15:00-15:15	0	2	2
Total	0	6	6

	Total		
08:00-09:00	2	0	2
14:15-15:00	1	0	1
15:00-15:15	2	0	2
Total	5	0	5

	08:00-09:00						14:15-15:00	15:00-15:15				Total
	1						0	4				5
	0						0	0				0
	1						0	4				5

Pershing Elementary School - East Driveway

**NB Street Name**

**BICYCLES MOVEMENT SUMMARY**

CODE / STATION NO.: 4

CITY: Orlando

COUNTY: Orange

NORTH / SOUTH: Pershing Elementary School East Drwy. INTERSECTING ROUTE: E Pershing Avenue

MILEPOST: X

OBSERVER: Elaine

WEATHER: Clear

REMARKS: \_\_\_\_\_

**GPS COORDINATES**

Latitude	Longitude
00° 00.000' N	000° 00.000' W

FORM COMPLETED BY: Santiago

DATE: 12/15/2016

One Story House Driveway

**SB Street Name**

	08:00-09:00					14:15-15:00	15:00-15:15				Total
	0					0	2				2
	5					0	2				7
	5					0	4				9



**Total**

08:00-09:00	0	0	0
14:15-15:00	0	0	0
15:00-15:15	0	0	0
<b>Total</b>	<b>0</b>	<b>0</b>	<b>0</b>

E Pershing Avenue

**EB Street Name**

E Pershing Avenue

**WB Street Name**

**Total**

08:00-09:00	5	0	5
14:15-15:00	0	0	0
15:00-15:15	1	3	4
<b>Total</b>	<b>6</b>	<b>3</b>	<b>9</b>

**Total**

	08:00-09:00					14:15-15:00	15:00-15:15				Total
	0					0	1				1
	0					0	0				0
	0					0	1				1

Pershing Elementary School - East Driveway

**NB Street Name**







# Accurate Traffic Counts, Inc.

798 Executive Drive, Suite A  
 Oviedo, Florida 32765  
*info@accuratetraffic.com*

Station: 001  
 Counted by: Santiago  
 Weather: Clear  
 Location: March Ave at Overlake Av

File Name : Sta 001\_March Av at Overlake Av  
 Site Code : 00011891  
 Start Date : 12/15/2016  
 Page No : 1

### Groups Printed- General Traffic

Start Time	March Avenue Southbound				Overlake Avenue Westbound				One Story House Driveway Northbound				Overlake Avenue Eastbound				Int. Total
	Left	Thru	Right	App. Total	Left	Thru	Right	App. Total	Left	Thru	Right	App. Total	Left	Thru	Right	App. Total	
08:00	17	0	1	18	0	23	17	40	0	0	0	0	0	19	0	19	77
08:15	20	0	3	23	0	15	14	29	0	0	0	0	1	11	0	12	64
08:30	27	0	3	30	0	13	29	42	0	0	0	0	2	13	0	15	87
08:45	0	0	1	1	0	0	0	0	0	0	0	0	0	0	0	0	1
Total	64	0	8	72	0	51	60	111	0	0	0	0	3	43	0	46	229

\*\*\* BREAK \*\*\*

14:15	0	0	2	2	0	0	0	0	0	0	0	0	0	2	0	2	4
14:30	1	0	0	1	0	1	0	1	0	0	0	0	0	0	0	0	2
14:45	8	0	2	10	0	1	3	4	0	0	0	0	3	7	0	10	24
Total	9	0	4	13	0	2	3	5	0	0	0	0	3	9	0	12	30
15:00	10	0	1	11	0	23	23	46	0	0	0	0	2	14	0	16	73
Grand Total	83	0	13	96	0	76	86	162	0	0	0	0	8	66	0	74	332
Apprch %	86.5	0	13.5		0	46.9	53.1		0	0	0		10.8	89.2	0		
Total %	25	0	3.9	28.9	0	22.9	25.9	48.8	0	0	0	0	2.4	19.9	0	22.3	



# Accurate Traffic Counts, Inc.

798 Executive Drive, Suite A  
 Oviedo, Florida 32765

*info@accuratetraffic.com*

Station: 001  
 Counted by: Santiago  
 Weather: Clear  
 Location: March Ave at Overlake Av

File Name : Sta 001\_March Av at Overlake Av  
 Site Code : 00011891  
 Start Date : 12/15/2016  
 Page No : 1

### Groups Printed- School Bus

Start Time	March Avenue Southbound				Overlake Avenue Westbound				One Story House Driveway Northbound				Overlake Avenue Eastbound				Int. Total
	Left	Thru	Right	App. Total	Left	Thru	Right	App. Total	Left	Thru	Right	App. Total	Left	Thru	Right	App. Total	
*** BREAK ***																	
Grand Total	0	0	0	0	0	0	0	0	0	0	0	0	0	0	0	0	0
Apprch %	0	0	0		0	0	0		0	0	0		0	0	0		
Total %																	

ORANGE COUNTY, FLORIDA

**PEDESTRIANS MOVEMENT SUMMARY**

CODE / STATION NO.: 1  
 NORTH / SOUTH: March Avenue  
 OBSERVER: Santiago  
 WEATHER: Clear  
 REMARKS: \_\_\_\_\_

CITY: Orlando  
 INTERSECTING ROUTE: Overlake Avenue

COUNTY: Orange  
 MILEPOST: X

FORM COMPLETED BY: Santiago

DATE: 12/15/2016

**GPS COORDINATES**

Latitude	Longitude
00° 00.000' N	000° 00.000' W

March Avenue

**SB Street Name**

	08:00-09:00						14:15-15:00	15:00-15:15				Total
	1						0	0				1
	0						0	2				2
	1						0	2				3



**Total**

08:00-09:00	0	0	0
14:15-15:00	0	0	0
15:00-15:15	0	1	1
<b>Total</b>	<b>0</b>	<b>1</b>	<b>1</b>

Overlake Avenue

**EB Street Name**

Overlake Avenue

**WB Street Name**

**Total**

08:00-09:00	0	0	0
14:15-15:00	0	0	0
15:00-15:15	1	0	1
<b>Total</b>	<b>1</b>	<b>0</b>	<b>1</b>

**Total**

	08:00-09:00						14:15-15:00	15:00-15:15				Total
	0						0	0				0
	0						0	0				0
	0						0	0				0

One Story House Driveway

**NB Street Name**

**BICYCLES MOVEMENT SUMMARY**

CODE / STATION NO.: 1  
 NORTH / SOUTH: March Avenue  
 OBSERVER: Santiago  
 WEATHER: Clear  
 REMARKS: \_\_\_\_\_

CITY: Orlando  
 INTERSECTING ROUTE: Overlake Avenue

COUNTY: Orange  
 MILEPOST: X

FORM COMPLETED BY: Santiago

DATE: 12/15/2016

**GPS COORDINATES**

Latitude	Longitude
00°00.000' N	000°00.000' W

March Avenue

**SB Street Name**

	08:00-09:00																			Total
	0																			0
	0																			0
	0																			0



**Total**

08:00-09:00	0	0	0	0
14:15-15:00	0	0	0	0
15:00-15:15	0	0	0	0
<b>Total</b>	<b>0</b>	<b>0</b>	<b>0</b>	<b>0</b>

Overlake Avenue

**EB Street Name**

Overlake Avenue

**WB Street Name**

**Total**

08:00-09:00	0	0	0	0
14:15-15:00	0	0	0	0
15:00-15:15	0	0	0	0
<b>Total</b>	<b>0</b>	<b>0</b>	<b>0</b>	<b>0</b>

**Total**

	08:00-09:00																			Total
	0																			0
	0																			0
	0																			0

One Story House Driveway

**NB Street Name**





# Accurate Traffic Counts, Inc.

798 Executive Drive, Suite A  
Oviedo, Florida 32765

[info@accuratetraffic.com](mailto:info@accuratetraffic.com)

Station: 002  
Counted by: Gerardo  
Weather: Clear  
Location: E Pershing Av at March Av

File Name : sta 002\_e pershing av at march av  
Site Code : 00202127  
Start Date : 12/15/2016  
Page No : 1

## Groups Printed- General Traffic

Start Time	March Avenue Southbound				E Pershing Avenue Westbound				March Avenue Northbound				E Pershing Avenue Eastbound				Int. Total
	Left	Thru	Right	App. Total	Left	Thru	Right	App. Total	Left	Thru	Right	App. Total	Left	Thru	Right	App. Total	
08:00	1	0	0	1	15	56	1	72	1	0	16	17	0	35	1	36	126
08:15	2	0	1	3	23	78	1	102	0	0	15	15	0	32	0	32	152
08:30	4	1	1	6	23	84	0	107	2	1	28	31	0	44	3	47	191
08:45	3	0	0	3	1	72	3	76	0	0	1	1	0	28	1	29	109
Total	10	1	2	13	62	290	5	357	3	1	60	64	0	139	5	144	578
*** BREAK ***																	
14:15	2	0	1	3	4	43	0	47	0	0	0	0	0	62	0	62	112
14:30	1	0	0	1	4	58	2	64	1	0	1	2	0	75	0	75	142
14:45	2	0	0	2	9	50	1	60	1	1	6	8	1	71	3	75	145
Total	5	0	1	6	17	151	3	171	2	1	7	10	1	208	3	212	399
15:00	1	0	0	1	9	45	4	58	2	0	27	29	0	52	2	54	142
Grand Total	16	1	3	20	88	486	12	586	7	2	94	103	1	399	10	410	1119
Apprch %	80	5	15		15	82.9	2		6.8	1.9	91.3		0.2	97.3	2.4		
Total %	1.4	0.1	0.3	1.8	7.9	43.4	1.1	52.4	0.6	0.2	8.4	9.2	0.1	35.7	0.9	36.6	



# Accurate Traffic Counts, Inc.

798 Executive Drive, Suite A  
Oviedo, Florida 32765

*info@accuratetraffic.com*

Station: 002  
Counted by: Gerardo  
Weather: Clear  
Location: E Pershing Av at March Av

File Name : sta 002\_e pershing av at march av  
Site Code : 00202127  
Start Date : 12/15/2016  
Page No : 1

### Groups Printed- School Bus

Start Time	March Avenue Southbound				E Pershing Avenue Westbound				March Avenue Northbound				E Pershing Avenue Eastbound				Int. Total
	Left	Thru	Right	App. Total	Left	Thru	Right	App. Total	Left	Thru	Right	App. Total	Left	Thru	Right	App. Total	
*** BREAK ***																	
08:15	0	0	0	0	0	2	0	2	0	0	0	0	0	2	0	2	4
*** BREAK ***																	
08:45	0	0	0	0	0	0	0	0	0	0	0	0	0	1	0	1	1
Total	0	0	0	0	0	2	0	2	0	0	0	0	0	3	0	3	5
*** BREAK ***																	
14:30	0	0	0	0	0	0	0	0	0	0	0	0	0	4	0	4	4
14:45	0	0	0	0	0	1	0	1	0	0	0	0	0	0	0	0	1
Total	0	0	0	0	0	1	0	1	0	0	0	0	0	4	0	4	5
15:00	0	0	0	0	0	1	0	1	0	0	0	0	0	0	0	0	1
Grand Total	0	0	0	0	0	4	0	4	0	0	0	0	0	7	0	7	11
Apprch %	0	0	0	0	0	100	0	100	0	0	0	0	0	100	0	100	
Total %	0	0	0	0	0	36.4	0	36.4	0	0	0	0	0	63.6	0	63.6	

**PEDESTRIANS MOVEMENT SUMMARY**

CODE / STATION NO.: 2  
 NORTH / SOUTH: March Avenue  
 OBSERVER: Gerardo  
 WEATHER: Clear  
 REMARKS: \_\_\_\_\_

CITY: Orlando  
 INTERSECTING ROUTE: E Pershing Avenue

COUNTY: Orange  
 MILEPOST: X

FORM COMPLETED BY: Santiago

DATE: 12/15/2016

**GPS COORDINATES**

Latitude	Longitude
00°00.000' N	000°00.000' W

March Avenue

**SB Street Name**

	08:00-09:00						14:15-15:00	15:00-15:15				Total
	1						3	2				6
	2						1	2				5
	3						4	4				11



**Total**

08:00-09:00	0	1	1
14:15-15:00	0	0	0
15:00-15:15	0	1	1
<b>Total</b>	<b>0</b>	<b>2</b>	<b>2</b>

E Pershing Avenue

**EB Street Name**

E Pershing Avenue

**WB Street Name**

**Total**

08:00-09:00	0	0	0
14:15-15:00	0	0	0
15:00-15:15	1	0	1
<b>Total</b>	<b>1</b>	<b>0</b>	<b>1</b>

**Total**

	08:00-09:00						14:15-15:00	15:00-15:15				Total
	1						0	0				1
	0						0	0				0
	1						0	0				1

March Avenue

**NB Street Name**



