

Owner: Leonal W. Kilgore Revocable Trust
5201 E. 53rd Street North
Kechi, KS 67067

Parcel ID: 00269018

Right of way, Exhibit #2

A tract of land for additional right of way purposes, lying in the NW1/4 of Sec. 24, T26S, R1E, Bearings are referenced to the Kansas State Plane Coordinate System, 1983, South Zone, and being more particularly described as follows:

Commencing at the northwest corner of said NW1/4; thence N88°47'30"E along the north line of said NW1/4, 1187.76 feet; thence S0°44'36"E, perpendicular to said north line, 30.00 feet to the northwest corner of Tract 2 recorded as Document No. 29709587 at the Register of Deeds in Sedgwick County, Kansas for the point of beginning; thence N88°47'30"E, 135.00 feet to the northeast corner of said tract; thence S0°44'36"E, along the east line of said tract, 30.00 feet; thence S88°47'30"W, parallel with the north line of said tract, 135.00 feet to the northeast corner of Reserve EE, Chapel Landing, Bel Aire, Sedgwick County Kansas; thence N0°44'36"W, 30.00 feet to the place of beginning; written by William K. Clevenger, PS-1437 on May 10, 2023.

The tract described above contains 4,050 square feet or 0.09 acres, more or less.

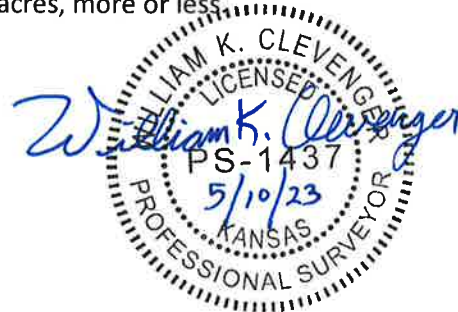

By: _____

William K. Clevenger, KS PS #1437
Garver, LLC
1995 Midfield Road
Wichita, KS 67209
(316) 264-8008

RIGHT OF WAY, EXHIBIT #2

NW CORNER OF
THE NW1/4 OF
SEC. 24, T26S, R1E

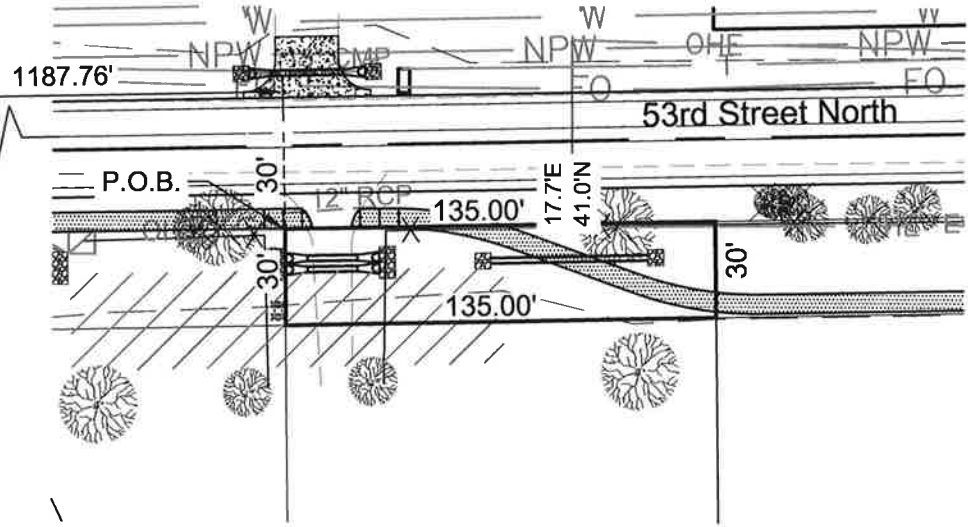

Leonal W Kilgore Revocable Trust
5201 E 53rd Street N
Kechi, KS 67067

PIN: 00269018

Right of Way Area: 4,050 Sq. Ft.±
0.09 Acres±



✕ = PROPOSED TREE REMOVAL

▨ = PROPOSED ADDITIONAL STREET RIGHT OF WAY

(DISTANCE)E = EXISTING EDGE OF PAVEMENT
TO NEW PROPERTY LINE

(DISTANCE)N = NEW EDGE OF PAVEMENT TO
NEW PROPERTY LINE



© 2023 GARVER, LLC. THIS DOCUMENT, ALONG WITH THE IDEAS AND DESIGNS CONVEYED HEREIN, SHALL BE CONSIDERED INSTRUMENTS OF PROFESSIONAL SERVICE AND ARE PROPERTY OF GARVER, LLC. ANY USE, REPRODUCTION, OR DISTRIBUTION OF THIS DOCUMENT, ALONG WITH THE IDEAS AND DESIGN CONTAINED HEREIN, IS PROHIBITED UNLESS AUTHORIZED IN WRITING BY GARVER, LLC OR EXPLICITLY ALLOWED IN THE GOVERNING PROFESSIONAL SERVICES AGREEMENT FOR THIS WORK.



1995 Midfield Road
Wichita, KS 67209
(316) 264-8008

FIGURE NUMBER

SHEET
NUMBER **3 of 6**