



STAFF REPORT

DATE: February 12, 2025

TO: Ted Henry, City Manager

FROM: Anne Stephens, PE, City Engineer

RE: Chapel Landing 5th Paving Bids

BACKGROUND:

The Developer of Chapel Landing 5th is ready to move forward with the construction of the Paving Improvements to support the subdivision.

DISCUSSION:

Garver worked with the Developer to design the paving improvements for Chapel Landing 5th. Bids were accepted on February 11th for the project. Four contractors responded to the solicitation.

Bidder	Total Bid
Engineer's Estimate	\$887,050.00
APAC	\$1,006,315.65
Kansas Paving	\$854,747.95
Pearson	\$996,004.15
Prado	\$899,372.95

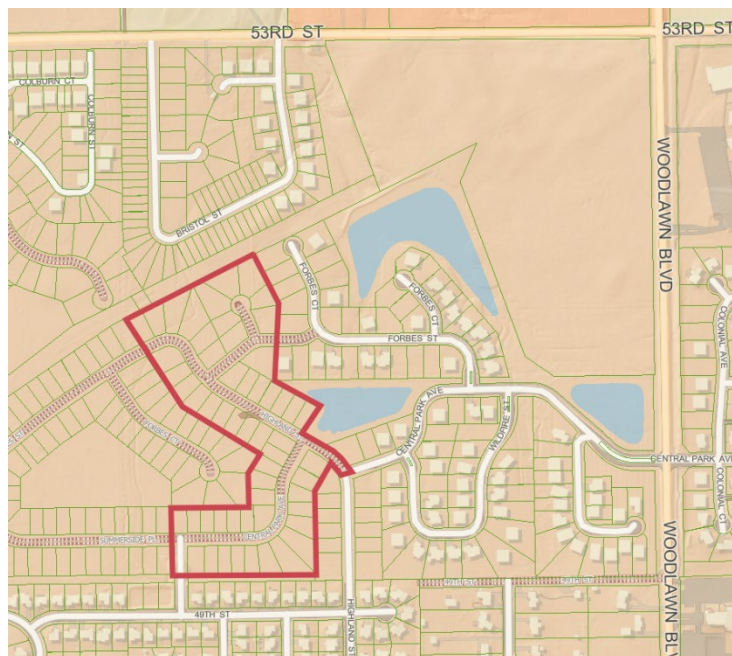

FINANCIAL CONSIDERATIONS: The paving project came in above the Engineer's Estimate from the original petition amount, but the crawl of the petition is enough to cover the additional expenses. The cost of the improvements for these projects will be financed through a bond and spread as special assessments against the benefiting lots.

POLICY DECISION: Staff adhered to the purchasing policy in gathering a minimum of three bids for the project.

RECOMENDATION: Staff recommends that the City Council accept the bid from Kansas Paving in the amount of \$854,747.95.

Chapel Landing 5th Phase 1 Paving Improvements
Bel Aire, Kansas - Bid Tabulations
2/11/2025

Item	Quantity	Unit	Engineer's Estimate		APAC		Kansas Paving		Pearson		Prado	
			Price	Extension	Price	Extension	Price	Extension	Price	Extension	Price	Extension
Paving Improvements												
Site Clearing	1	ls	\$28,524.00	\$28,524.00	\$25,000.00	\$25,000.00	\$79,600.00	\$79,600.00	\$75,000.00	\$75,000.00	\$60,000.00	\$60,000.00
Site Restoration	1	ls	\$5,000.00	\$5,000.00	\$39,000.00	\$39,000.00	\$1,000.00	\$1,000.00	\$20,000.00	\$20,000.00	\$15,000.00	\$15,000.00
Contractor Provided Testing	1	ls	\$1,500.00	\$1,500.00	\$8,000.00	\$8,000.00	\$8,500.00	\$8,500.00	\$8,000.00	\$8,000.00	\$8,000.00	\$8,000.00
Excavation	33487	cy	\$4.75	\$159,063.25	\$2.50	\$83,717.50	\$2.00	\$66,974.00	\$2.50	\$83,717.50	\$2.50	\$83,717.50
Fill, Compacted (95% Density)	30809	cy	\$1.00	\$30,809.00	\$0.50	\$15,404.50	\$0.45	\$13,864.05	\$0.50	\$15,404.50	\$0.50	\$15,404.50
Concrete Pavement (6")	6826	sy	\$44.50	\$303,757.00	\$55.00	\$375,430.00	\$44.00	\$300,344.00	\$48.00	\$327,648.00	\$42.75	\$291,811.50
Crushed Rock Base (5"), Reinforced	8679	sy	\$9.00	\$78,111.00	\$7.00	\$60,753.00	\$8.00	\$69,432.00	\$8.00	\$69,432.00	\$7.00	\$60,753.00
Reinforced Concrete Valley Gutter (7")	346	sy	\$55.00	\$19,030.00	\$73.00	\$25,258.00	\$60.00	\$20,760.00	\$77.00	\$26,642.00	\$63.00	\$21,798.00
Concrete Curb & Gutter, Monolithic (6 5/8")	203	lf	\$5.00	\$1,015.00	\$4.25	\$862.75	\$3.00	\$609.00	\$6.00	\$1,218.00	\$2.00	\$406.00
Concrete Curb & Gutter, Combined (3 5/8")	3714	lf	\$10.00	\$37,140.00	\$14.50	\$53,853.00	\$9.00	\$33,426.00	\$14.00	\$51,996.00	\$10.00	\$37,140.00
Wheelchair Ramps	6	ea	\$750.00	\$4,500.00	\$900.00	\$5,400.00	\$650.00	\$3,900.00	\$750.00	\$4,500.00	\$750.00	\$4,500.00
Inlet Hookups	6	ea	\$650.00	\$3,900.00	\$450.00	\$2,700.00	\$650.00	\$3,900.00	\$550.00	\$3,300.00	\$450.00	\$2,700.00
Pavement Underdrain	120	lf	\$22.00	\$2,640.00	\$22.00	\$2,640.00	\$1.00	\$120.00	\$23.00	\$2,760.00	\$22.00	\$2,640.00
Sawcut	111	lf	\$5.00	\$555.00	\$5.50	\$610.50	\$2.00	\$222.00	\$4.00	\$444.00	\$3.00	\$333.00
Concrete Header	26	sy	\$25.00	\$650.00	\$61.00	\$1,586.00	\$40.00	\$1,040.00	\$55.00	\$1,430.00	\$42.75	\$1,111.50
SWS Pipe, 24" RCP	356	lf	\$70.00	\$24,920.00	\$110.00	\$39,160.00	\$86.00	\$30,616.00	\$110.00	\$39,160.00	\$110.00	\$39,160.00
SWS Pipe, 18" RCP	637	lf	\$60.00	\$38,220.00	\$95.00	\$60,515.00	\$76.00	\$48,412.00	\$99.70	\$63,508.90	\$95.00	\$60,515.00
SWS Pipe, 15" RCP	640	lf	\$50.00	\$32,000.00	\$80.00	\$51,200.00	\$66.00	\$42,240.00	\$89.40	\$57,216.00	\$80.00	\$51,200.00
12" Perforated ADS N-12 Pipe with Sock	175	lf	\$50.00	\$8,750.00	\$75.00	\$13,125.00	\$66.00	\$11,550.00	\$53.15	\$9,301.25	\$75.00	\$13,125.00
12" Drain Basin ADS Nyloplast	1	ea	\$2,000.00	\$2,000.00	\$3,465.00	\$3,465.00	\$3,500.00	\$3,500.00	\$2,600.00	\$2,600.00	\$3,465.00	\$3,465.00
Type 1A Inlet Double (10'x3')	3	ea	\$7,000.00	\$21,000.00	\$9,135.00	\$27,405.00	\$6,900.00	\$20,700.00	\$8,300.00	\$24,900.00	\$9,135.00	\$27,405.00
Type 1A Inlet Double (10'x4')	1	ea	\$7,500.00	\$7,500.00	\$9,085.00	\$9,085.00	\$7,200.00	\$7,200.00	\$9,300.00	\$9,300.00	\$9,085.00	\$9,085.00
Driveway Inlet (Single)	1	ea	\$5,000.00	\$5,000.00	\$8,235.00	\$8,235.00	\$6,800.00	\$6,800.00	\$7,800.00	\$7,800.00	\$8,235.00	\$8,235.00
Backyard (4' Dia.)	7	ea	\$4,500.00	\$31,500.00	\$4,355.00	\$30,485.00	\$3,500.00	\$24,500.00	\$4,975.00	\$34,825.00	\$4,355.00	\$30,485.00
Type A MH (4' Dia.)	1	ea	\$4,000.00	\$4,000.00	\$4,340.00	\$4,340.00	\$4,060.00	\$4,060.00	\$4,500.00	\$4,500.00	\$4,340.00	\$4,340.00
Connect to Existing Structure	1	ea	\$1,500.00	\$1,500.00	\$3,995.00	\$3,995.00	\$2,000.00	\$2,000.00	\$1,800.00	\$1,800.00	\$3,995.00	\$3,995.00
Sand Backfil, Jet & Vibrate	96	lf	\$20.00	\$1,920.00	\$10.00	\$960.00	\$1.00	\$96.00	\$22.00	\$2,112.00	\$10.00	\$960.00
Rip rap, Light Stone	34	sy	\$75.00	\$2,550.00	\$155.00	\$5,270.00	\$99.00	\$3,366.00	\$100.00	\$3,400.00	\$155.00	\$5,270.00
BMP, Drop Inlet Protection	9	ea	\$150.00	\$1,350.00	\$120.00	\$1,080.00	\$120.00	\$1,080.00	\$125.00	\$1,125.00	\$120.00	\$1,080.00
BMP, Curb Inlet Protection	5	ea	\$55.00	\$275.00	\$75.00	\$375.00	\$75.00	\$375.00	\$75.00	\$375.00	\$55.00	\$275.00
BMP, Erosion Control Mat	3529	sy	\$1.75	\$6,175.75	\$1.10	\$3,881.90	\$1.10	\$3,881.90	\$1.00	\$3,529.00	\$1.40	\$4,940.60
Maintain Existing BMP's	1	ls	\$500.00	\$500.00	\$100.00	\$100.00	\$100.00	\$100.00	\$950.00	\$950.00	\$1.00	\$1.00
Street Signage	1	ls	\$2,000.00	\$2,000.00	\$3,365.00	\$3,365.00	\$3,365.00	\$3,365.00	\$3,365.00	\$3,365.00	\$1,500.00	\$1,500.00
Project Seeding	1	ls	\$2,000.00	\$2,000.00	\$21,440.00	\$21,440.00	\$21,440.00	\$21,440.00	\$17,000.00	\$17,000.00	\$13,667.00	\$13,667.00
Sidewalk, 6" Concrete (AE)	1389	sf	\$5.00	\$6,945.00	\$6.50	\$9,028.50	\$5.00	\$6,945.00	\$5.00	\$6,945.00	\$4.15	\$5,764.35
Backyard (5' Dia.)	1	ea	\$5,500.00	\$5,500.00	\$4,770.00	\$4,770.00	\$4,230.00	\$4,230.00	\$5,400.00	\$5,400.00	\$4,770.00	\$4,770.00
Type A MH (5' Dia.)	1	ea	\$5,250.00	\$5,250.00	\$4,820.00	\$4,820.00	\$4,600.00	\$4,600.00	\$5,400.00	\$5,400.00	\$4,820.00	\$4,820.00
			Total	\$887,050.00		\$1,006,315.65		\$854,747.95		\$996,004.15		\$899,372.95