

SITE LAYOUT

# SKYVIEW AT BLOCK 49 3RD ADDITION

Bel Aire, Sedgwick County, Kansas



© 2022 GARVER, LLC  
THIS DOCUMENT, ALONG WITH THE IDEAS AND DESIGNS CONVEYED HEREIN, SHALL BE CONSIDERED INSTRUMENTS OF PROFESSIONAL SERVICE AND ARE PROPERTY OF GARVER, LLC. ANY USE, REPRODUCTION, OR DISTRIBUTION OF THIS DOCUMENT, ALONG WITH THE IDEAS AND DESIGN CONTAINED HEREIN, IS PROHIBITED UNLESS AUTHORIZED IN WRITING BY GARVER, LLC OR EXPLICITLY ALLOWED IN THE GOVERNING PROFESSIONAL SERVICES AGREEMENT FOR THIS WORK.

1995 Midfield Road  
Wichita, KS 67209  
(316) 264-8008

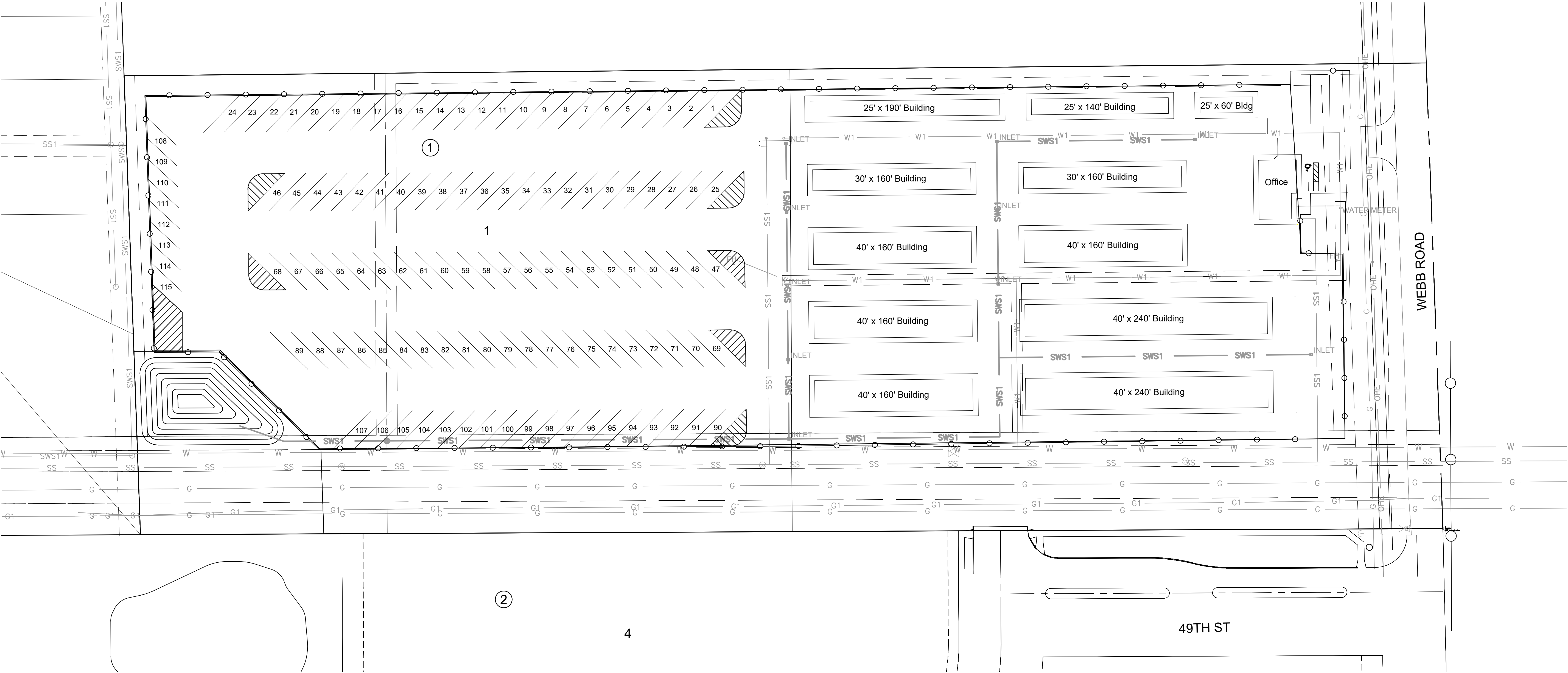
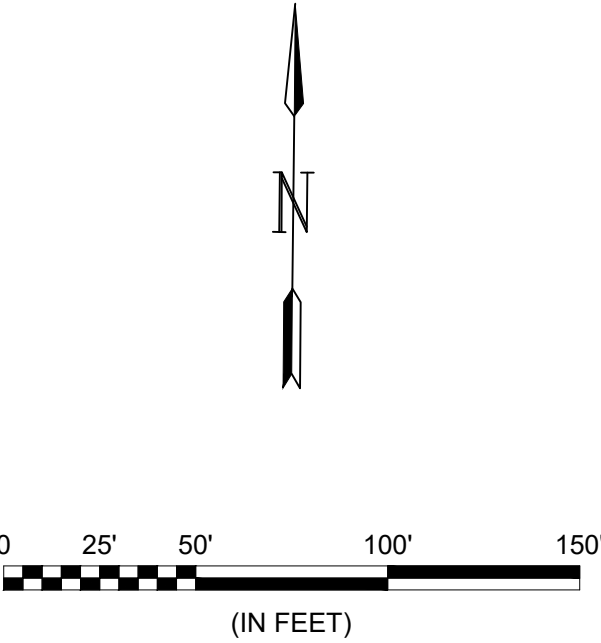

File: L:\2021\12\1504030 - Skyview at Block 49 Storage\Survey\CAD\SITE LAYOUT.dwg Last Save: 1/25/2022 8:24 AM Last saved by: MCarraaPiedra  
Last plotted by: Carraa-Piedra, Mariela Plot Date: 1/25/2022 8:27 AM Plotter used: None

BY:				
DESCRIPTION:				
DATE:				
REV:				
CITY OF BEL AIRE BEL AIRE, KANSAS				
SKYVIEW AT BLOCK 49				
SITE LAYOUT				
JOB NO.: 21S04030 DATE: JAN. 2022 DESIGNED BY: . DRAWN BY: .				
BAR IS ONE INCH ON ORIGINAL DRAWING 0 1" IF NOT ONE INCH ON THIS SHEET, ADJUST SCALES ACCORDINGLY.				
DRAWING NUMBER				
SHEET NUMBER 1 OF 1				