

# CITY OF BEL AIRE

SEDGWICK COUNTY, KANSAS

# SKYVIEW PARK PLAYGROUND

LOTS 14-16, BLOCK D, SKYVIEW 2ND ADDITION  
BEL AIRE, KANSAS

PEC PROJECT NO. 237363-015



**LOCATION MAP**

APRIL 2025

**Sheet Index**

Sheet Number	Sheet Title
G-001	COVER SHEET
G-002	GENERAL NOTES
LS101	SITE PLAN
LS102	AMENITY LAYOUT PLAN
LS501	SITE DETAILS
LG101	SITE GRADING
LG501	EROSION CONTROL DETAILS
LP101	PLANTING PLAN
LP501	PLANTING DETAILS

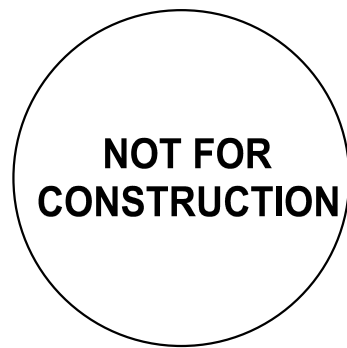
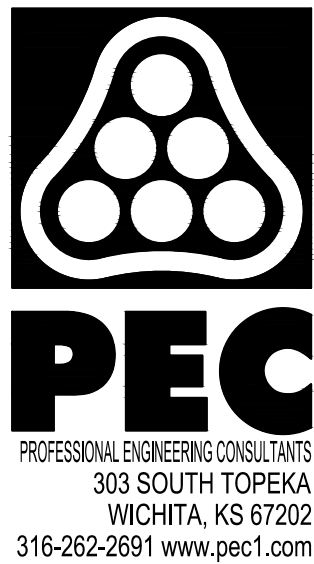

SKYVIEW PARK  
PLAYGROUND  
BEL AIRE, KANSAS

Issue:		
1	90% CD SET	04/28/25
JOB NO.	237363-015	
DATE	APRIL 2025	
PM	KPG	
DESIGNED BY	RKO	
DRAWN BY	RKO	
CHECKED BY	KPG	

COVERSHEET

G-001



SAVED 4/22/2025 1:15:56 PM BY DUSTIN LOHMANN  
PLOTTED 4/28/2025 3:04:30 PM BY DUSTIN LOHMANN  
U:\WICHITA-CIVIL\2023\237363\01512PD4\_PLANS\030G-02\_GENERAL-NOTES.DWG

GENERAL NOTES - (DEMOLITION)

1. PAVEMENT DEMOLITION SHALL BE IN ACCORDANCE WITH PROJECT SPECIFICATIONS.
2. BASE MATERIALS UNDER DEMOLISHED PAVEMENT SHALL BE REMOVED OFF-SITE.
3. ELECTRIC, COMMUNICATION AND MECHANICAL DEMOLITION ARE NOT SHOWN ON CIVIL SHEETS. REFERENCE SITE ELECTRICAL AND MECHANICAL PLANS FOR ELECTRICAL, COMMUNICATION, AND MECHANICAL DEMOLITION.
4. THE CONTRACTOR SHALL COORDINATE WITH THE OWNER PRIOR TO DEMOLITION TO DETERMINE DEMOLITION ITEMS THAT ARE TO BE SALVAGED TO THE OWNER. SALVAGEABLE ITEMS ARE TO BE DELIVERED TO THE OWNER AT LOCATIONS DIRECTED BY THE OWNER. ALL NON-SALVAGED ITEMS ARE TO BE DISPOSED OFF-SITE BY THE CONTRACTOR.
5. CONTRACTOR SHALL PROVIDE NECESSARY MEANS TO PROTECT THE PUBLIC AND TO PROHIBIT ACCESS TO CONSTRUCTION SITE WHILE MAINTAINING ACCESS TO EXISTING FACILITIES.
6. CONTRACTOR SHALL COORDINATE ALL DEMOLITION ACTIVITIES WITH OWNER AND UTILITY COMPANIES. CONTRACTOR SHALL VERIFY UTILITIES ARE OUT OF SERVICE/ABANDONED BEFORE DEMOLITION.
7. CONTRACTOR SHALL PROVIDE NEAT SAW CUTS AT ALL EXISTING CONCRETE AND ASPHALT ABUTTING NEW PAVEMENT AND WHERE EXISTING PAVEMENT IS REMAINING IN PLACE. SAW CUTS IN CONCRETE PAVEMENT SHALL BE AT JOINT LOCATIONS.
8. EXISTING SITE FEATURES (PAVING, UTILITIES, CURBS, SIDEWALK, DRAINAGE, IRRIGATION AND LANDSCAPING) DAMAGED BY CONSTRUCTION AND NOT SHOWN TO BE REMOVED SHALL BE REPLACED TO MATCH EXISTING OR BETTER CONDITIONS PRIOR TO DISTURBANCE.
9. UNLESS OTHERWISE NOTED ON PLANS OR SPECIFICATIONS, ALL DEMOLISHED UTILITIES SHALL BE CAPPED AT THE MAIN CONNECTION. ALL ABANDONED PIPE ENDS SHALL BE PLUGGED.
10. CONTRACTOR SHALL COORDINATE PAVEMENT REMOVAL AND REPLACEMENT WITH PROPOSED UTILITIES CONSTRUCTION. REFERENCE SITE UTILITY PLAN AND CONTACT KANSAS GAS SERVICE FOR PROPOSED UTILITY LOCATIONS. ALL PAVEMENT REMOVAL AND REPLACEMENT SHALL BE SUBSIDIARY TO THE GMP IN THE AGREEMENT.
11. ALL ITEMS LOCATED IN DEMOLITION LIMITS NOT SHOWN SHALL BE IDENTIFIED AND COORDINATED WITH THE OWNER PRIOR TO DEMOLITION.

GENERAL NOTES

1. ALL CONSTRUCTION AND MATERIALS TO COMPLY WITH CITY OF BEL AIRE STANDARD CONSTRUCTION SPECIFICATIONS AND DETAILS, UNLESS OTHERWISE INCLUDED IN THE CONTRACT DOCUMENTS.
2. EACH BIDDER SHALL VISIT THE SITE OF THE PROJECT BEFORE SUBMITTING THE PROPOSAL FOR THIS WORK SO THAT THEY WILL BE FULLY INFORMED OF THE EXISTING FIELD CONDITIONS AND THE OBSTACLES WHICH MIGHT BE ENCOUNTERED. UPON AWARD OF THE CONTRACT THE CONTRACTOR WILL NOT BE GRANTED ANY ADDITIONAL COMPENSATION WITH REGARDS TO TIME AND MONEY FOR CONDITIONS THAT MAY HAVE BEEN EVALUATED DURING ANY INSPECTION OF THE SITE.
3. AT LEAST 72 HOURS PRIOR TO BEGINNING ANY EXCAVATION (EXCLUDING WEEKENDS AND HOLIDAYS), THE CONTRACTOR SHALL CONTACT THE KANSAS ONE-CALL SYSTEM. A UTILITY LOCATION SERVICE, AT (316)-687-2470 OR 811 TO REQUEST THE LOCAL UTILITY COMPANIES TO LOCATE ANY EXISTING LINES WITHIN THE PROJECT AREA.
4. THE CONTRACTOR MUST NOTIFY THE FOLLOWING IN CASE OF AN EMERGENCY:

EMERGENCY DISPATCH: 911  
COX COMMUNICATIONS: 888-249-3530  
EVERGY: 800-383-1183  
AT&T: 800-286-8313  
KANSAS GAS SERVICE: 888-482-4950
6. THE CONTRACTOR SHALL GIVE ALL PROPERTY OWNERS AND/OR TENANTS OF DEVELOPED PROPERTY DIRECTLY ABUTTING THE CONSTRUCTION OF THIS PROJECT A MINIMUM OF SEVEN (7) DAYS ADVANCE NOTICE PRIOR TO THE START OF CONSTRUCTION.
7. THE CONTRACTOR SHALL NOT START WORK ON THE PROJECT UNTIL THE PROJECT INSPECTOR IS ASSIGNED AND IS PRESENT ON THE SITE. ANY WORK DONE WITHOUT INSPECTION WILL BE REQUIRED TO BE UNCOVERED FOR INSPECTION AT THE CONTRACTORS EXPENSE.
8. EXISTING UTILITIES AND THEIR LOCATION, AS SHOWN ON THE DRAWINGS, REPRESENT THE BEST INFORMATION OBTAINABLE FOR DESIGN. LOCATION INFORMATION HAS BEEN OBTAINED FROM THE VARIOUS UTILITY COMPANIES AND IS EITHER FROM COMPANY RECORD DRAWINGS OR COMPANY PROVIDED FIELD LOCATIONS. IT SHOULD BE NOTED THAT OTHER BURIED LINES AND CABLES MAY EXIST WHICH ARE NOT SHOWN ON THESE DRAWINGS. THE CONTRACTOR SHALL HAVE ALL BURIED LINES LOCATED AND FLAGGED IN THE FIELD PRIOR TO COMMENCING WORK. THE CONTRACTOR SHALL CONTACT THE ENGINEER AND REVIEW ANY BURIED LINES LOCATED IF CONFLICTS EXIST. THE CONTRACTOR WILL BE REQUIRED TO WORK AROUND EXISTING UTILITIES WITHIN THE RIGHT-OF-WAY WHICH DO NOT CONFLICT WITH PROPOSED CONSTRUCTION. THE CONTRACTOR SHALL EXERCISE EXTREME CAUTION DURING TRENCHING OPERATIONS TO AVOID DAMAGING THESE LINES. ANY LINES DAMAGED SHALL BE REPLACED OR REPAIRED IMMEDIATELY AS DIRECTED BY THE ENGINEER AT THE CONTRACTOR'S EXPENSE.
9. THE CONTRACTOR SHALL EXPOSE AND VERIFY THE VERTICAL AND HORIZONTAL LOCATION OF EXISTING UTILITIES THAT ARE IN POTENTIAL CONFLICT WITH THE PROPOSED IMPROVEMENTS. THE UTILITY LOCATES SHALL BE PERFORMED PRIOR TO THE START OF CONSTRUCTION AND ANY DISCREPANCIES SHALL BE REPORTED IMMEDIATELY TO THE ENGINEER.
10. THE CONTRACTOR SHALL BE RESPONSIBLE FOR PRESERVING PROPERTY IRONS AND SECTION CORNERS. THE CONTRACTOR SHALL BE REQUIRED TO RE-ESTABLISH ANY PROPERTY IRONS AND SECTION CORNERS WHICH ARE DAMAGED OR DESTROYED BY CONSTRUCTION OPERATIONS. SUCH IRONS AND SECTION CORNERS SHALL BE RE-ESTABLISHED BY A LICENSED LAND SURVEYOR IN ACCORDANCE WITH STATE LAWS.
11. EASEMENTS AND RIGHTS-OF-WAY PROVIDED BY THE OWNER FOR THE PROJECT ARE SHOWN ON THE DRAWINGS. THE CONTRACTOR SHALL BE RESPONSIBLE FOR THE ACQUISITION OF ANY ADDITIONAL TEMPORARY EASEMENTS OR RIGHTS-OF-WAY DESIRED TO USE IN COMPLETING THE WORK.
12. THE CONTRACTOR SHALL CONTAIN THEIR OPERATIONS TO PERMIT LOCAL AND EMERGENCY TRAFFIC THROUGH AND ACROSS CONSTRUCTION AT ALL TIMES. THE CONTRACTOR SHALL UTILIZE WARNING SIGNS, FLASHING LIGHTS, BARRICADES, AND FLAGMEN IN COMPLIANCE WITH THE LATEST VERSION OF THE MANUAL ON UNIFORM TRAFFIC CONTROL DEVICES (MUTCD).
13. RUBBLE FROM THE REMOVAL OF MISCELLANEOUS STRUCTURES INCLUDING ANY TREES REMOVED, TREE TRIMMINGS, AND EXCESS EXCAVATION WHICH IS TO BE WASTED SHALL BE DISPOSED OF ON SITES PROVIDED BY THE CONTRACTOR. THESE SITES SHALL ALSO BE APPROVED BY THE ENGINEER AS TO SUITABILITY, APPEARANCE, AND SITE LOCATION. LOCATIONS THAT, IN THE OPINION OF THE ENGINEER, WILL LEAVE AN
- UNSIGHTLY APPEARANCE WILL NOT BE APPROVED. ALL DISPOSAL SITES MUST BE APPROVED BY THE KANSAS DEPARTMENT OF HEALTH AND ENVIRONMENT. MATERIAL EITHER STOCKPILED OR DISPOSED OF IN A FLOOD PLAIN WILL REQUIRE A KANSAS STATE BOARD OF AGRICULTURE PERMIT. ANY MATERIAL DUMPED IN WATERS OF THE UNITED STATES, FLOODWAYS, OR WETLANDS IS SUBJECT TO U.S. CORPS OF ENGINEERS PERMITTING REGULATIONS. ANY MATERIAL BURIED OR STOCKPILED BEYOND APPROVED CONSTRUCTION LIMITS MAY REQUIRE ARCHAEOLOGICAL INVESTIGATIONS UNLESS BURIED IN A PREVIOUSLY APPROVED DISPOSAL LOCATION.
14. THE CONTRACTOR SHALL AVOID REMOVAL OR TRIMMING OF ANY TREES OR SHRUBS WHERE POSSIBLE. WHERE THE CONTRACTOR BELIEVES THE REMOVAL OR TRIMMING IS UNAVOIDABLE, THIS WORK SHALL BE COORDINATED WITH THE ENGINEER. TREE TRIMMING/REMOVAL SHALL BE COMPLETED IN ACCORDANCE WITH U.S. FISH AND WILDLIFE SERVICE AND KANSAS DEPARTMENT OF WILDLIFE, PARKS, AND TOURISM RESTRICTIONS.
15. THE CONTRACTOR SHALL RESTORE ALL DITCHES, SWALES, ROAD SHOULDERS, AND BANKS TO THEIR ORIGINAL SLOPES AND GRADES EXCEPT AS SHOWN OTHERWISE. WHERE EXISTING ENTRANCE PIPE, DRAINAGE PIPE, SIGNS, FENCES, LANDSCAPING, ETC., CONFLICT WITH THE PROPOSED WORK HEREIN, THEY SHALL BE REMOVED AND REPLACED OR RESET, UNLESS OTHERWISE NOTED ON THE DRAWINGS.
16. THE CONTRACTOR SHALL INSTALL AND/OR MAINTAIN EROSION CONTROL METHODS AS SPECIFIED ON THE PLANS. THE CONTRACTOR SHALL BE RESPONSIBLE FOR MAINTAINING EROSION CONTROL THROUGH THE COMPLETION OF THIS PROJECT. INSTALLATION OF THESE EROSION CONTROL DEVICES DOES NOT RELIEVE THE CONTRACTOR OF THE RESPONSIBILITY OF ABATING SOIL EROSION.
17. THE CONTRACTOR SHALL TAKE CARE TO PREVENT SILT AND DEBRIS FROM ENTERING ANY STORM DRAINAGE SYSTEM DURING CONSTRUCTION. PIPES OR STRUCTURES WHICH CONTAIN MATERIALS FROM THE CONTRACTORS ACTIVITIES SHALL BE THOROUGHLY CLEANED BY THE CONTRACTOR, AT THEIR OWN EXPENSE, PRIOR TO THE FINAL INSPECTION.
18. RECONSTRUCTION OF EROSION CONTROL MEASURES WHICH ARE DESTROYED BY WIND, FLOOD, FIRE, OR BY THE ACTIONS OF THE CONTRACTOR OR OTHERS SHALL BE PERFORMED BY THE CONTRACTOR AS DIRECTED BY THE ENGINEER AT NO ADDITIONAL COST. WHERE ADJUSTMENTS IN QUANTITIES ARE REQUIRED BY FIELD CONDITIONS, THERE SHALL BE NO ADJUSTMENT IN UNIT PRICE.
19. ALL GRASSED AREAS DISTURBED BY CONSTRUCTION OF THE PROPOSED IMPROVEMENTS SHALL BE REPLANTED WITH GRASS AND FERTILIZED IN ACCORDANCE WITH THE PROJECT SPECIFICATIONS. EXISTING GRASSED AREAS DISTURBED BY CONSTRUCTION SHALL BE REPLANTED WITH THE SAME TYPE OF GRASS AS WAS REMOVED, UNLESS OTHERWISE SPECIFIED.
20. THE CONTRACTOR SHALL SEED ALL AREAS DISTURBED BY CONSTRUCTION ACTIVITIES WITH TEMPORARY RYE GRASS. RYE GRASS SEED SHALL BE PLANTED AT A MINIMUM RATE OF SIX (6) POUNDS PER ONE THOUSAND (1,000) SQUARE FEET. THIS TEMPORARY SEEDING MAY BE OMITTED ONLY IF PERMANENT SEEDING/SODDING IS APPLIED. TEMPORARY SEEDING OR PERMANENT SEEDING/SODDING SHALL BE APPLIED WITHIN 14 DAYS AFTER THE AREA HAS BEEN DISTURBED.
21. CONTRACTOR SHALL BE RESPONSIBLE FOR CONSTRUCTION STAKING. STAKING AND BENCH MARKS DESTROYED DURING CONSTRUCTION OPERATIONS SHALL BE REPLACED AT THE CONTRACTOR'S EXPENSE.
22. CONTRACTOR SHALL MAINTAIN UNINTERRUPTED UTILITY SERVICE TO ADJACENT FACILITIES DURING CONSTRUCTION, UNLESS OTHERWISE APPROVED BY OWNER.
23. WRITTEN REQUEST TO THE OWNER WILL BE REQUIRED 72 HOURS PRIOR TO A SCHEDULED UTILITY OUTAGE. THE FIRE DEPARTMENT MUST BE NOTIFIED OF ANY FIRE HYDRANTS OR WATER MAINS TAKEN OUT OF SERVICE.

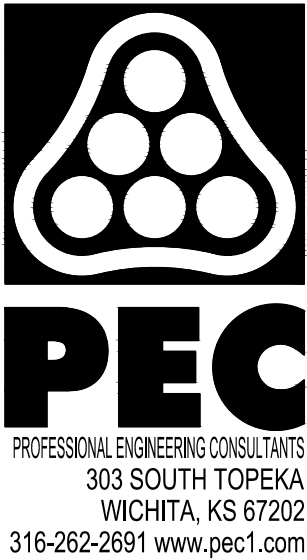

NOT FOR  
CONSTRUCTION

SKYVIEW PARK  
PLAYGROUND  
BEL AIRE, KANSAS

Issue:		
1	90% CD SET	04/28/25
JOB NO.	237363-015	
DATE	APRIL 2025	
PM	KPG	
DESIGNED BY	RKO	
DRAWN BY	RKO	
CHECKED BY	KPG	

GENERAL NOTES

G-002







SAVED 4/22/2025 3:22:56 PM BY DUSTIN LOHMANN  
PLOTTED 4/28/2025 3:04:51 PM BY DUSTIN LOHMANN  
U:\WICHITA-CIVIL\2023\237363\0152PD4\_PLANS\030LS102\_AMENITY-LAYOUT-PLAN.DWG

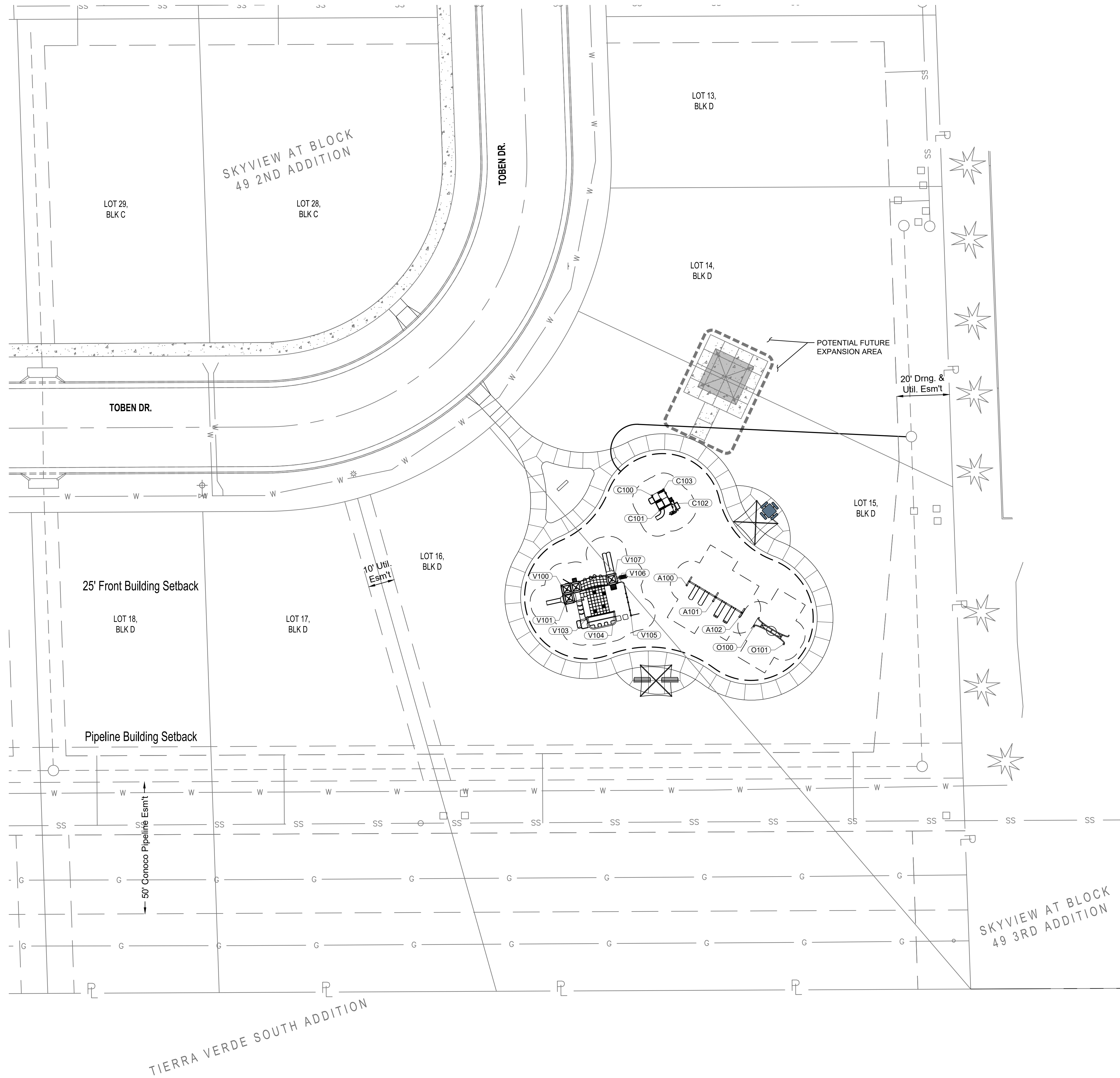

### LAYOUT NOTES

1. REFERENCE G-002 FOR GENERAL NOTES APPLICABLE TO THIS DRAWING.

### PLAYGROUND LAYOUT

POINT ID	NORTHING	EASTING
A100	1718439.13	1679250.56
A101	1718433.15	1679260.58
A102	1718427.17	1679270.60
C100	1718473.11	1679237.34
C101	1718467.50	1679240.30
C102	1718469.92	1679244.73
C103	1718475.54	1679241.77
O100	1718423.57	1679276.05
O101	1718416.84	1679287.34
SU100	1718402.96	1679238.91
SU101	1718462.88	1679276.74
V100	1718439.00	1679203.04
V101	1718432.10	1679204.55
V103	1718426.96	1679212.90
V104	1718429.16	1679223.00
V105	1718427.68	1679229.43
V106	1718440.01	1679224.24
V107	1718443.46	1679223.49

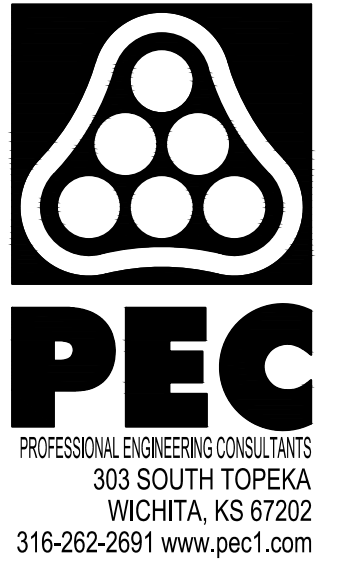

NOT FOR  
CONSTRUCTION

## SKYVIEW PARK PLAYGROUND BEL AIRE, KANSAS

Issue:		
1	90% CD SET	04/28/25
JOB NO.	237363-015	
DATE	APRIL 2025	
PM	KPG	
DESIGNED BY	RKO	
DRAWN BY	RKO	
CHECKED BY	KPG	

AMENITY LAYOUT PLAN

LS102

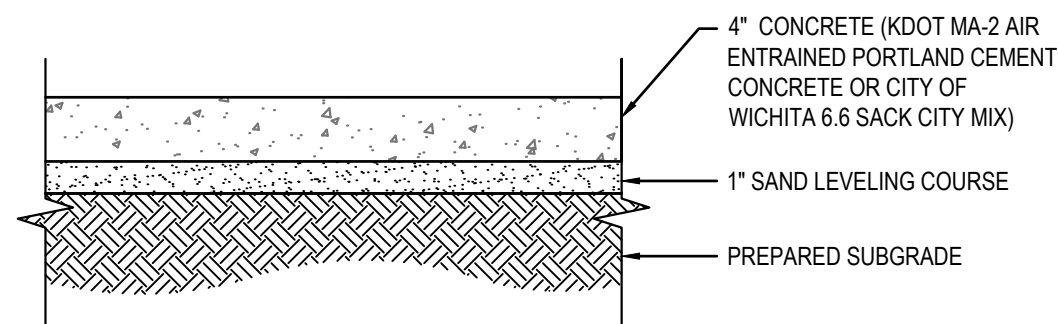

- NOTES:
1. SIDEWALK SHALL BE A MEDIUM BROOM FINISH.
  2. THICKEN SIDEWALK EDGE WHEN ADJACENT TO ARTIFICIAL TURF.

**1 CONCRETE SIDEWALK**  
SCALE: 1" = 1'-0"

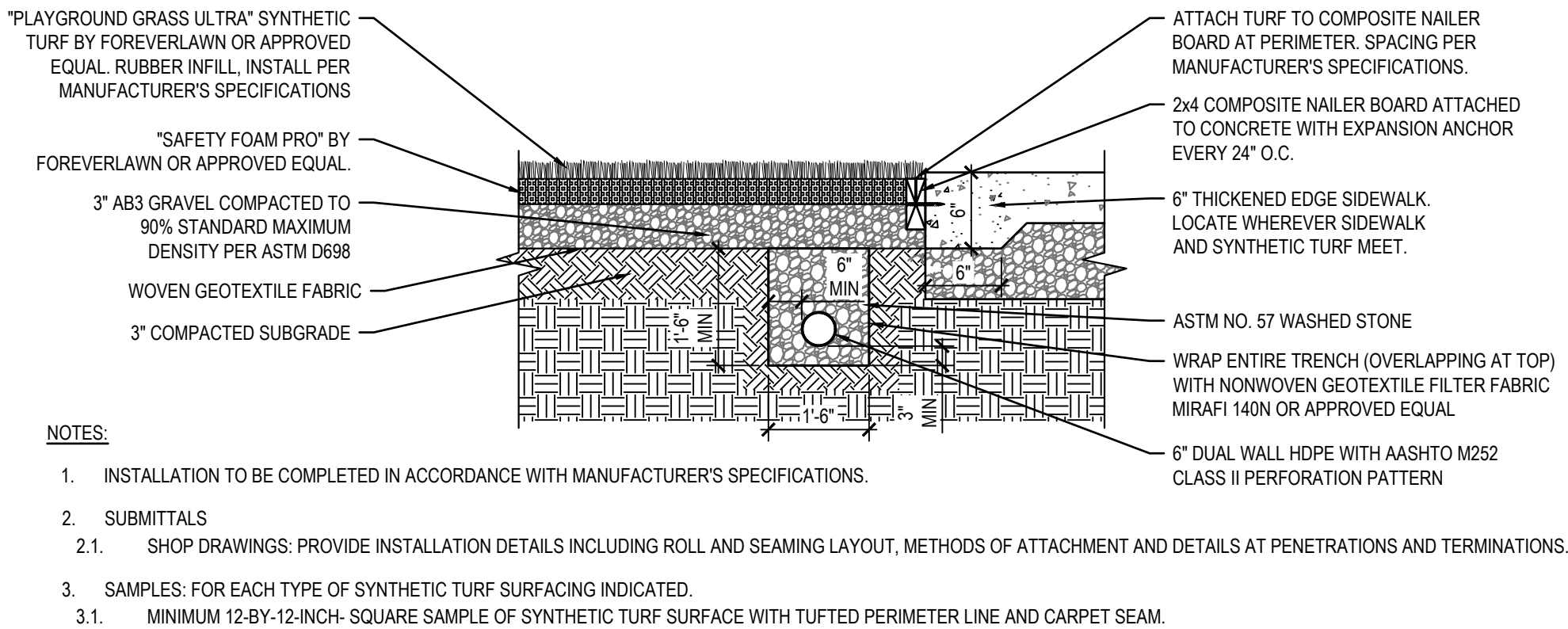

**2 ULTRA PLAYGROUND ARTIFICIAL GRASS**  
SCALE: 1" = 1'-0"

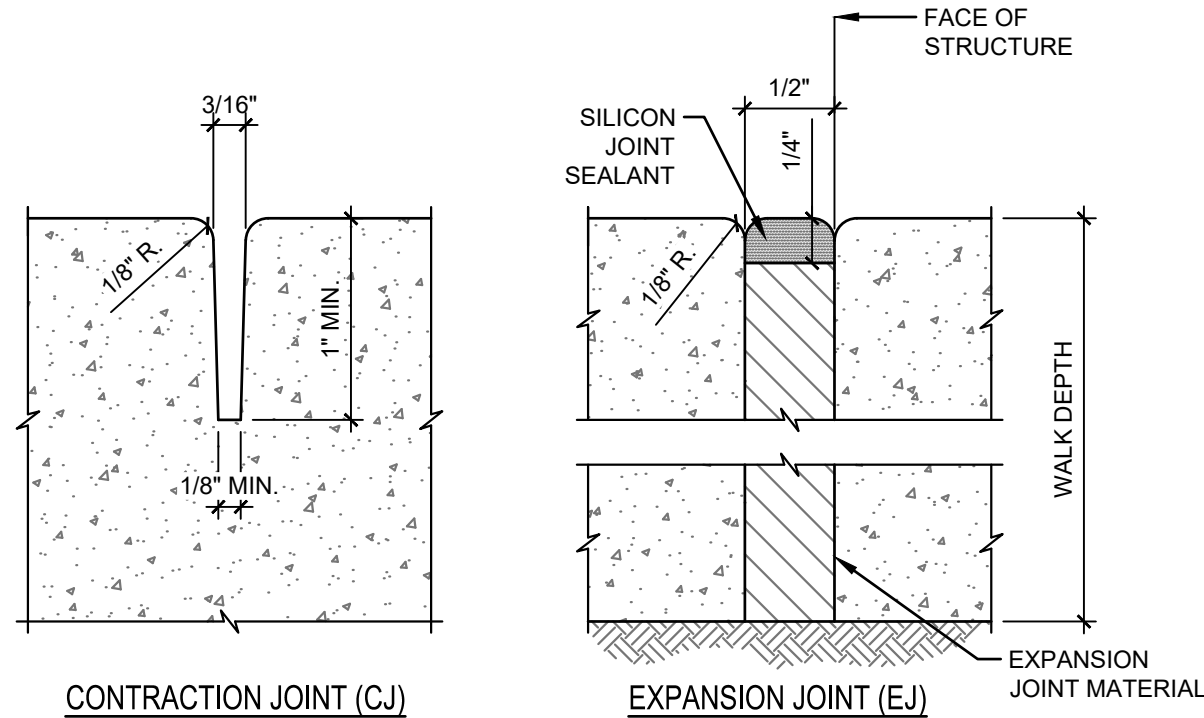

- SIDEWALK CONSTRUCTION JOINT NOTES
1. PROVIDE 1/2\"/>

**3 CONCRETE JOINTING**  
SCALE: 1" = 1"

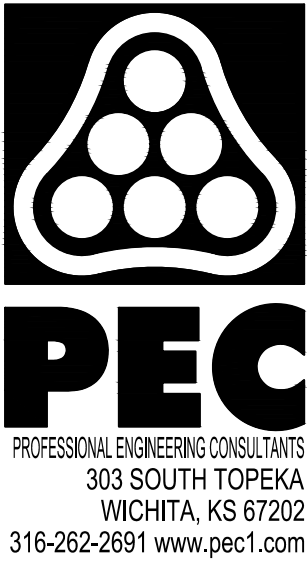

NOT FOR  
CONSTRUCTION

**SKYVIEW PARK  
PLAYGROUND**  
BEL AIRE, KANSAS

Issue:		
1	90% CD SET	04/28/25
JOB NO.	237363-015	
DATE	13 DEC 2024	
PM	KPG	
DESIGNED BY	CES	
DRAWN BY	CES	
CHECKED BY	RKO	

SITE DETAILS

LS501



SAVED 4/29/2025 8:37:03 AM BY DUSTIN LOHMANN  
PLOTTED 4/29/2025 8:37:44 AM BY DUSTIN LOHMANN  
U:\WICHITA-CIVIL\2023\237363\0152PD4\_PLANS\030LG101\_SITE-GRADING.DWG

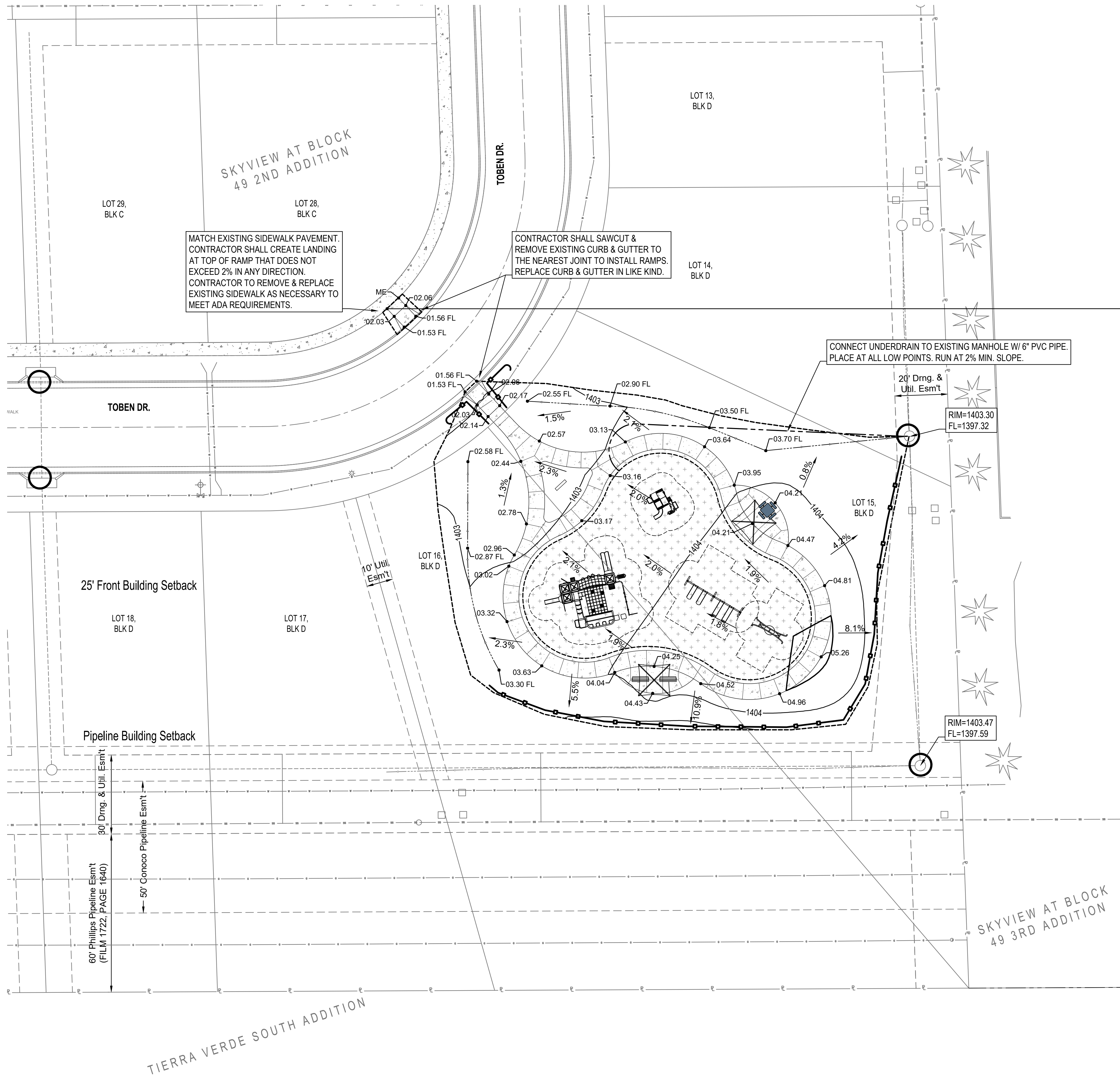

### SITE GRADING NOTES

- ALL FILL MATERIAL BLADED SMOOTH AND SLOPED TO DRAIN.
- CADD FILES FOR GRADING WILL BE MADE AVAILABLE UPON REQUEST.
- THE CONTRACTOR SHALL SATISFY THEMSELVES WITH THE EARTHWORK QUANTITIES AND NO CHANGE ORDER FOR EARTHWORK WILL BE APPROVED. CONTRACTOR TO WASTE ANY EXTRA MATERIAL ONSITE. CONTRACTOR TO ENSURE POSITIVE DRAINAGE IN ALL AREAS WITH NO STANDING WATER OR 'BIRD BATH' AFFECT ONSITE.
- ELEVATIONS NOTED ARE TO FINISHED GRADE. REFERENCE PAVEMENT DETAILS FOR MORE INFORMATION.
- THE TOP 6" OF ALL AREAS TO BE SEEDDED SHALL RECEIVE TOPSOIL MATERIAL SUITABLE FOR GROWTH OF VEGETATION. OVEREXCAVATE 6" THRU AREAS OF CUT FOR PLACEMENT OF TOPSOIL. NO ADDITIONAL PAYMENT SHALL BE MADE FOR DOUBLE-HANDLING OF STOCKPILING. REFERENCE LANDSCAPE PLANS FOR ADDITIONAL INFORMATION.

#### ADA NOTES

- SIDEWALKS SHALL HAVE RUNNING SLOPE NOT STEEPER THAN 1:20. THE CROSS SLOPE OF WALKING SURFACES SHALL NOT BE STEEPER THAN 1:48.
- CURB RAMPS SHALL NOT EXCEED SIX INCHES IN HEIGHT OR HAVE RUNNING SLOPE STEEPER THAN 1:12. CROSS SLOPE OF RAMPS SHALL NOT BE STEEPER THAN 1:48.
- ADA ACCESSIBLE PARKING STALL & ACCESS AISLE SHALL NOT EXCEED 1:48 SLOPE IN ALL DIRECTIONS.
- CONTRACTOR SHALL ADHERE TO THE LATEST ADA REGULATIONS AND REPORT ANY DISCREPANCIES TO THE ENGINEER FOR RESOLUTION PRIOR TO CONSTRUCTION.

### SITE GRADING LEGEND

- 1300 EXISTING MAJOR CONTOUR
- 1301 EXISTING MINOR CONTOUR
- 1300 PROPOSED MAJOR CONTOUR
- 1301 PROPOSED MINOR CONTOUR
- 01.50 PROPOSED SPOT ELEVATION
- 1.00% PROPOSED SLOPE
- PROPOSED GRADING LIMITS

### EROSION CONTROL NOTES

- CONTRACTOR SHALL INSTALL AND MAINTAIN EROSION PROTECTION THROUGHOUT THE ENTIRE PROJECT. THE FOLLOWING QUANTITIES ARE FOR INFORMATION ONLY, AND SHALL BE INCLUDED IN THE EROSION CONTROL LUMP SUM BID ITEMS. EROSION PROTECTION SHALL BE INCLUDED IN THE BID AS FOLLOWS:
- THE EROSION CONTROL DEVICES SHOWN ON THIS SHEET ARE CONSIDERED MINIMUM STANDARDS. WHENEVER SEDIMENT ENTERS THE STREETS, STORM SEWERS, DITCHES, OR PONDS, CONTRACTOR WILL INSTALL ADDITIONAL DEVICES, AS NEEDED, TO CORRECT THE PROBLEM.
- THE EROSION CONTROL DEVICES SHOWN HEREON MUST BE IN PLACE AT ALL TIMES DURING CONSTRUCTION UNTIL SUCH TIME AS THE SITE IS REESTABLISHED WITH PAVING OR GRASS. TEMPORARY OR PERMANENT SEEDING AND MULCH WILL BE INSTALLED WHEN EARTHWORK ACTIVITIES CEASE IN AN AREA FOR 14 DAYS OR MORE.
- ANY MUD INADVERTENTLY TRACKED ONTO ANY STREET SHALL BE CLEANED UP BY THE CONTRACTOR, AT THE END OF EACH DAY'S WORK, OR AS DIRECTED BY THE FIELD ENGINEER.
- CONTRACTOR TO FURNISH A TRUCK WASH-OUT PIT TO BE PLACED AT A CONVENIENT LOCATION THAT DOES NOT CONFLICT WITH CONSTRUCTION. CONTRACTOR SHALL CLEAN OUT AND BACKFILL PIT PRIOR TO FINAL INSPECTION. LOCATION SHALL BE APPROVED BY THE FIELD ENGINEER.

### EROSION CONTROL LEGEND

- PROPOSED SILT FENCE (290 L.F.)
- PROPOSED INLET PROTECTION (4 EA.)



NOT FOR  
CONSTRUCTION

SKYVIEW PARK  
PLAYGROUND  
BEL AIRE, KANSAS

Issue:		
1	90% CD SET	04/28/25
JOB NO.	237363-015	
DATE	APRIL 2025	
PM	KPG	
DESIGNED BY	RKO	
DRAWN BY	RKO	
CHECKED BY	KPG	

SITE GRADING

LG101



EROSION CONTROL DETAIL GENERAL NOTES

1. SEDIMENT BARRIERS SHALL BE INSTALLED AT LOCATIONS SHOWN ON THE PLANS OR AS DIRECTED BY THE ENGINEER. ADDITIONAL SEDIMENT BARRIERS WILL BE INSTALLED AT LOCATIONS AS DIRECTED BY THE ENGINEER WITH NO ADJUSTMENT IN UNIT PRICE.
2. SEDIMENT BARRIERS SHALL BE ERECTED PRIOR TO THE COMMENCEMENT OF EARTHWORK OPERATIONS IN A GIVEN BASIN. REMOVAL AND DISPOSAL OF ACCUMULATED SILT AND DEBRIS AND/OR REMOVAL AND RECONSTRUCTION OF SEDIMENT BARRIERS WILL BE PERFORMED THROUGHOUT THE PROJECT LIFE WHEN DEBRIS REACHES ONE-THIRD THE FENCE HEIGHT OR AS DEEMED NECESSARY BY THE ENGINEER. SEDIMENT BARRIERS AND ACCUMULATED DEBRIS SHALL BE REMOVED AND DISPOSED OF BY THE CONTRACTOR AFTER TURF COVER HAS BEEN ESTABLISHED, UNLESS OTHER ARRANGEMENTS HAVE BEEN AGREED TO.
3. TEMPORARY EROSION CONTROL BERMS AND/OR INTERCEPT DITCHES SHALL BE CONSTRUCTED AT LOCATIONS SHOWN ON THE PLANS OR AS DIRECTED BY THE ENGINEER. ADDITIONAL BERMS AND/OR DITCHES MAY BE REQUIRED AT NO ADJUSTMENT IN UNIT PRICE(S).
4. WHERE TEMPORARY EROSION CONTROL BERMS AND/OR INTERCEPT DITCHES ARE USED, ALL AREAS WHERE FLOW IS CONCENTRATED SHALL BE PROTECTED BY SILTATION BARRIERS PRIOR TO DISCHARGING INTO ANY DITCH, STORM SEWER, OR WATERCOURSE.
5. CONTRACTOR SHALL REMOVE THE TEMPORARY EROSION CONTROL DEVICES WHEN DISTURBED AREAS HAVE 70% OR GREATER COVERAGE OF UNIFORM VEGETATION OR EQUIVALENT PERMANENT NON-VEGETATIVE STABILIZATION (EX. RIPRAP, GRAVEL, ETC.), OR AS DIRECTED BY ENGINEER. AFTER REMOVAL OF THE TEMPORARY EROSION AND POLLUTION CONTROL DEVICES, REMOVE AND DISPOSE OF THE SILT ACCUMULATION IN ACCORDANCE WITH THE REQUIREMENTS NOTED IN THE CONTRACT DOCUMENTS. GRADE, FERTILIZE, SEED, AND MULCH ANY BARE AREAS.

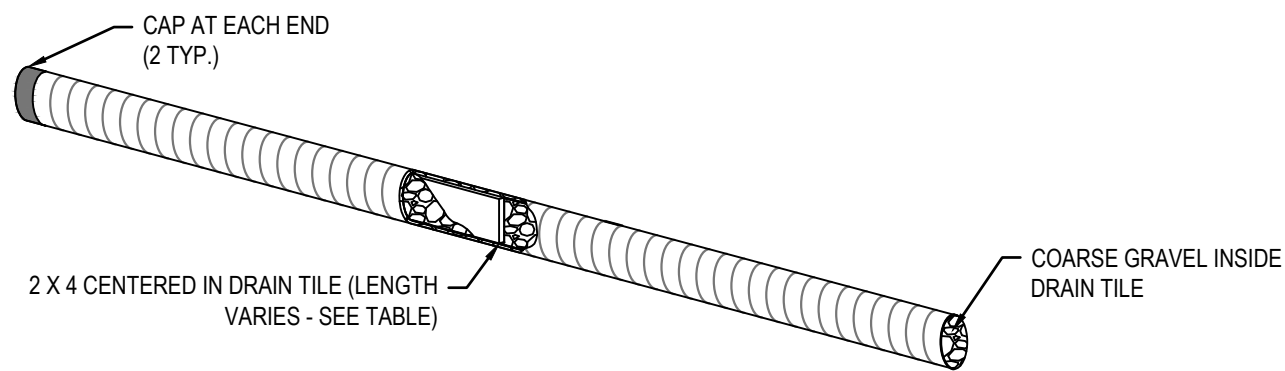
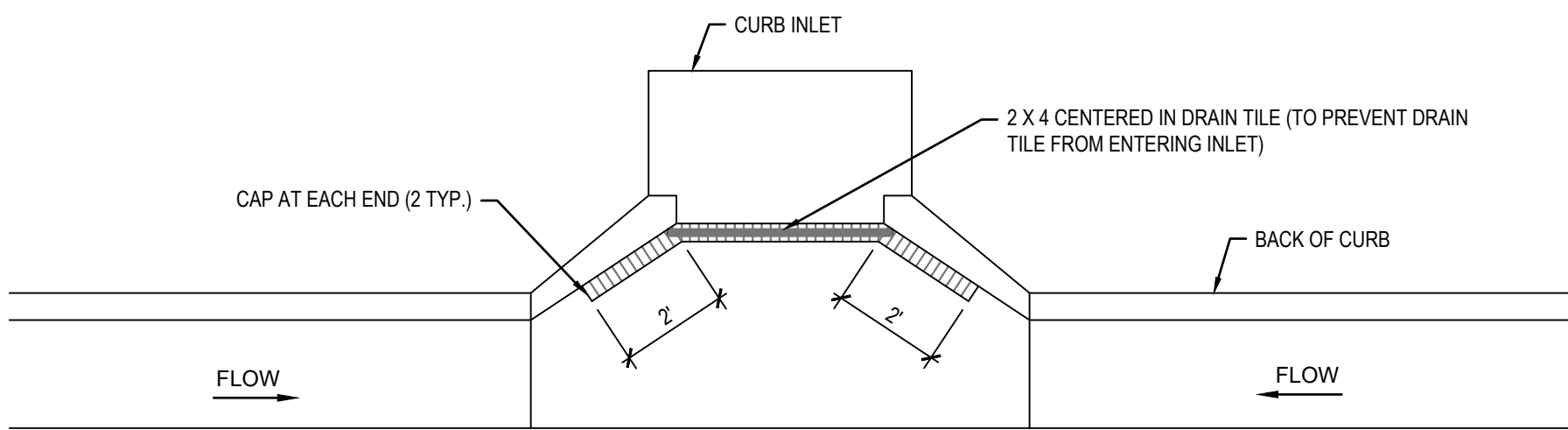

2 X 4 LENGTH		
2 X 4 LENGTH	INLET TYPE	INLET OPENING
5'-6"	1-A	5'-0"
10'-6"	1-A	10'-0"
15'-6"	1-A	15'-0"

NOTE:  
PLACE 4" PERFORATED PVC PIPE, FILLED WITH 1/2" - 1" DIAMETER GRAVEL, IN FRONT OF CURB INLET AS SHOWN.

1 CURB INLET PROTECTION 4" PERFORATED PIPE W/ GRAVEL  
NTS

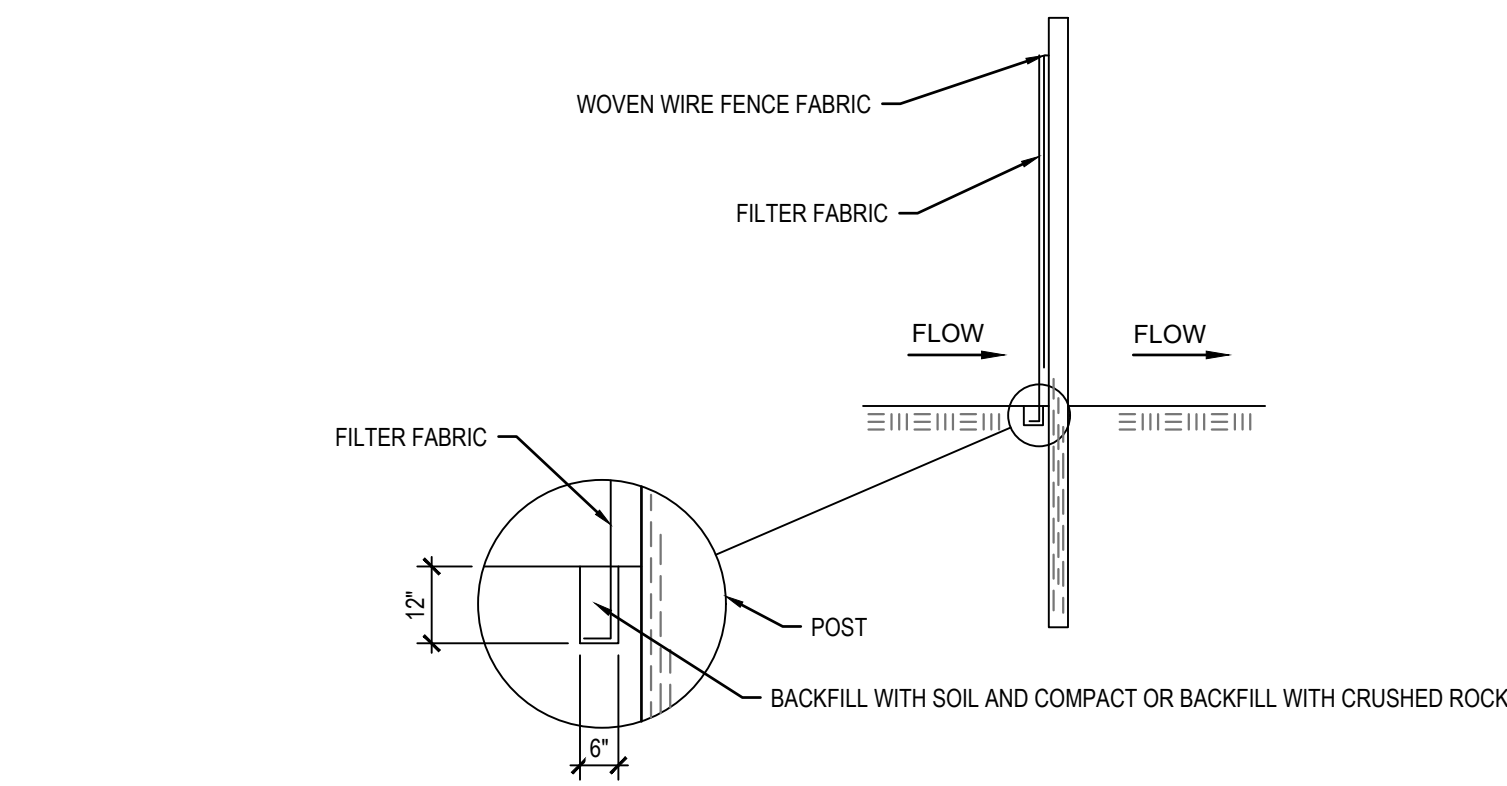

ANCHOR TRENCH DETAIL

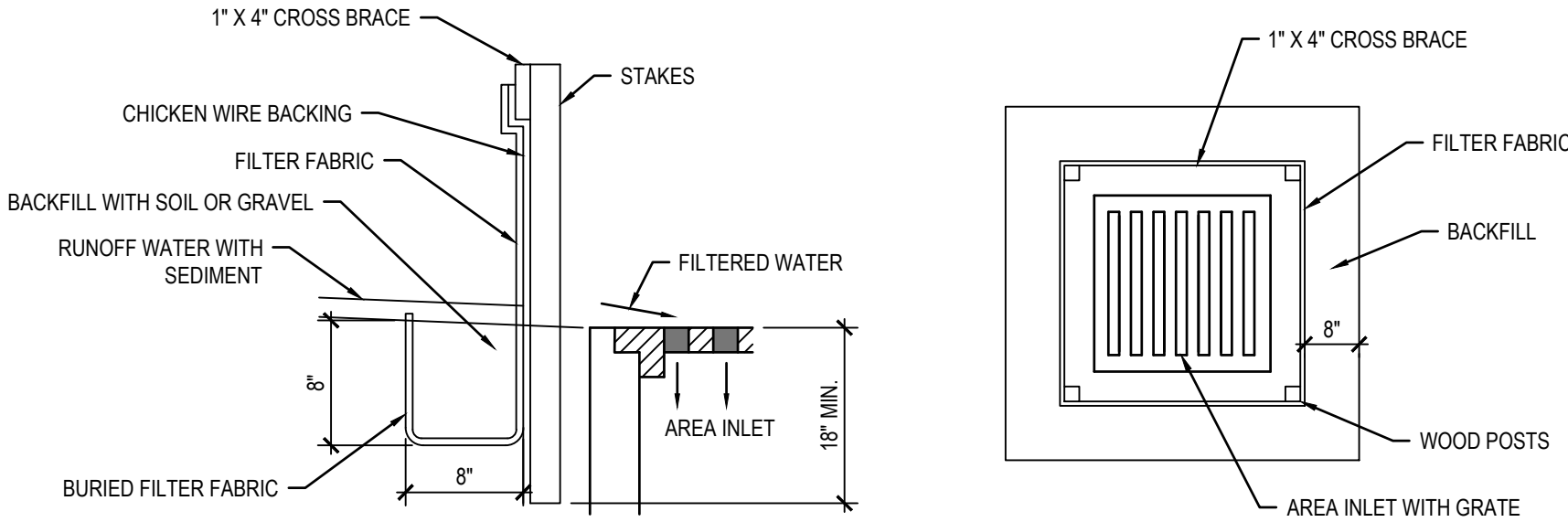

SILT FENCE BARRIERS FOR AREA INLETS NOTES

1. **MATERIAL SPECIFICATION:** SILT FENCE FABRIC SHOULD CONFORM TO THE AASHTO M288 96 SILT FENCE SPECIFICATION. THE WIRE OR POLYMERIC MESH BACKING USED TO HELP SUPPORT THE SILT FENCE FABRIC SHOULD CONFORM TO THE AASHTO M288 96 SILT FENCE SPECIFICATION. THE POSTS USED TO SUPPORT THE SILT FENCE FABRIC SHOULD BE A HARDWOOD MATERIAL WITH THE FOLLOWING MINIMUM DIMENSIONS: 2" SQUARE (NOMINAL) BY 4' LONG. THE MATERIAL USED TO FRAME THE TOPS OF THE POSTS SHOULD BE 1" BY 4" BOARDS. SILT FENCE FABRIC AND SUPPORT BACKING SHOULD BE ATTACHED TO THE WOODEN POSTS AND FRAME WITH STAPLES, WIRE, ZIP TIES, OR NAILS.
2. **PLACEMENT:** PLACE A SILT FENCE DROP INLET BARRIER IN A LOCATION WHERE IT IS UNLIKELY TO BE OVERTOPPED. WATER SHOULD FLOW THROUGH SILT FENCE, NOT OVER IT. SILT FENCE BARRIERS FOR AREA INLETS OFTEN FAIL WHEN REPEATEDLY OVERTOPPED. WHEN USED AS A BARRIER FOR AREA INLETS, SILT FENCE FABRIC AND POSTS MUST BE SUPPORTED AT THE TOP BY A WOODEN FRAME. WHEN A SILT FENCE BARRIER FOR AREA INLETS IS LOCATED NEAR AN INLET THAT HAS STEEP APPROACH SLOPES, THE STORAGE CAPACITY BEHIND THE BARRIER IS DRASTICALLY REDUCED. TIMELY REMOVAL OF SEDIMENT MUST OCCUR FOR A BARRIER TO OPERATE PROPERLY IN THIS LOCATION.
3. **PROPER INSTALLATION METHOD:** EXCAVATE A TRENCH AROUND THE PERIMETER OF THE AREA INLET THAT IS AT LEAST 8" DEEP BY 8" WIDE. DRIVE POSTS TO A DEPTH OF AT LEAST 18" AROUND THE PERIMETER OF THE AREA INLET. THE DISTANCE BETWEEN POSTS SHOULD BE 4' OR LESS. IF THE DISTANCE BETWEEN TWO ADJACENT CORNER POSTS IS MORE THAN 4', ADD ANOTHER POST(S) BETWEEN THEM. CONNECT THE TOPS OF ALL THE POSTS WITH A WOODEN FRAME MADE OF 1" BY 4" BOARDS. USE NAILS OR SCREWS FOR FASTENING. ATTACH THE WIRE OR POLYMERIC-MESH BACKING TO THE OUTSIDE OF THE POST/FRAME STRUCTURE WITH STAPLES, WIRE, ZIP TIES, OR NAILS. ROLL OUT A CONTINUOUS LENGTH OF SILT FENCE FABRIC LONG ENOUGH TO WRAP AROUND THE PERIMETER OF THE AREA INLET. ADD MORE LENGTH FOR OVERLAPPING THE FABRIC JOINT. PLACE THE EDGE OF THE FABRIC IN THE TRENCH, STARTING AT THE OUTSIDE EDGE OF THE TRENCH. LINE ALL THREE SIDES OF THE TRENCH WITH THE FABRIC. BACKFILL OVER THE FABRIC IN THE TRENCH WITH THE EXCAVATED SOIL AND COMPACT. AFTER FILLING THE TRENCH, APPROXIMATELY 24" TO 36" OF SILT FENCE FABRIC SHOULD REMAIN EXPOSED. ATTACH THE SILT FENCE TO THE OUTSIDE OF THE POST/FRAME STRUCTURE WITH STAPLES, WIRE, ZIP TIES, OR NAILS. THE JOINT SHOULD BE OVERLAPPED TO THE NEXT POST. WHEN A SILT FENCE BARRIER FOR AREA INLET IS PLACED IN A SHALLOW MEDIAN DITCH, MAKE SURE THAT THE TOP OF THE BARRIER IS NOT HIGHER THAN THE PAVED ROAD. IN THIS CONFIGURATION, WATER MAY SPREAD ONTO THE ROADWAY CAUSING A HAZARDOUS CONDITION.
4. **LIST OF COMMON PLACEMENT/INSTALLATION MISTAKES TO AVOID:** WATER SHOULD FLOW THROUGH A SILT FENCE BARRIER FOR AREA INLET-NOT OVER IT. PLACE A SILT FENCE BARRIER FOR AREA INLET IN A LOCATION WHERE IT IS UNLIKELY TO BE OVERTOPPED. SILT FENCE BARRIER FOR AREA INLETS OFTEN FAIL WHEN REPEATEDLY OVERTOPPED. DO NOT PLACE POSTS ON THE OUTSIDE OF THE SILT FENCE BARRIER FOR AREA INLET. IN THIS CONFIGURATION, THE FORCE OF THE WATER IS NOT RESISTED BY THE POSTS, BUT ONLY BY THE STAPLES (WIRE, ZIP TIES, NAILS, ETC.). THE SILT FENCE WILL RIP AND FAIL. DO NOT INSTALL SILT FENCE BARRIER FOR AREA INLETS WITHOUT FRAMING THE TOP OF THE POSTS. THE CORNER POSTS AROUND AREA INLETS ARE STRESSED IN TWO DIRECTIONS WHEREAS A NORMAL SILT FENCE IS ONLY STRESSED IN ONE DIRECTION. THIS ADDED STRESS REQUIRES MORE SUPPORT.
5. **INSPECTION AND MAINTENANCE:** SILT FENCE BARRIER FOR AREA INLETS SHOULD BE INSPECTED EVERY 7 DAYS AND WITHIN 24 HOURS OF A RAINFALL OF 1/2" OR MORE. THE FOLLOWING IS A LIST OF QUESTIONS THAT SHOULD BE ADDRESSED DURING EACH INSPECTION:  
  
DOES WATER FLOW UNDER THE SILT FENCE?  
DOES THE SILT FENCE SAG EXCESSIVELY?  
HAS THE SILT FENCE TORN OR BECOME DETACHED FROM THE POSTS?  
DOES SEDIMENT NEED TO BE REMOVED FROM BEHIND THE AREA INLET BARRIER?

2 SILT FENCE BARRIERS FOR AREA INLETS  
NTS

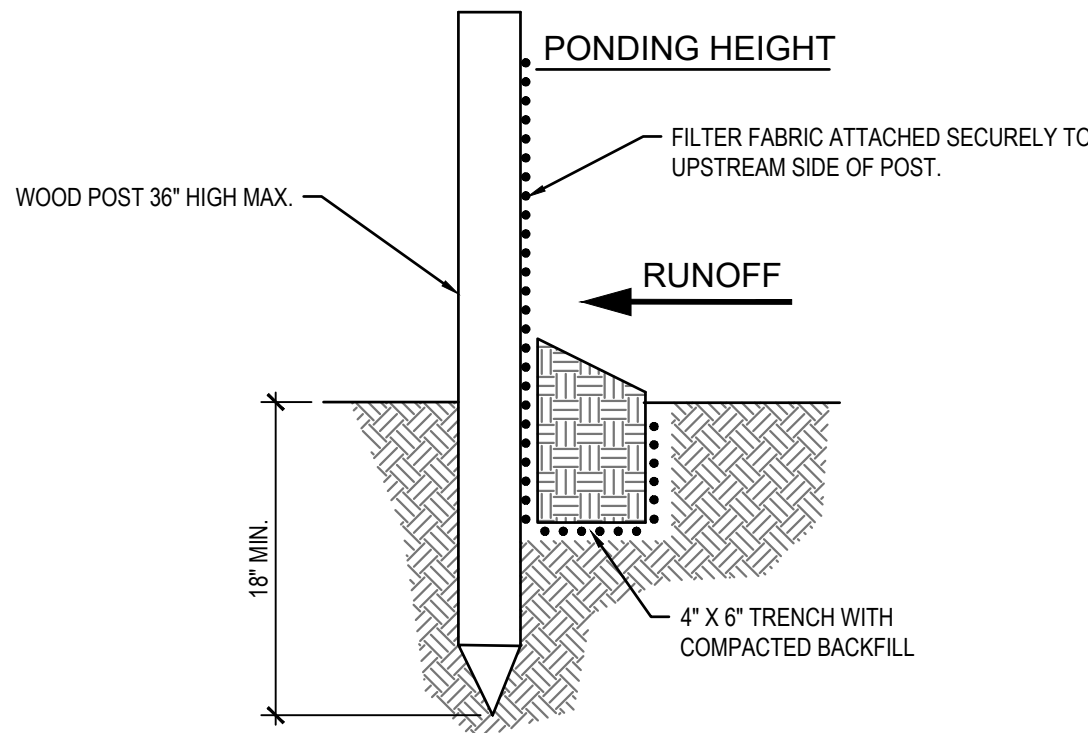

SILT FENCE BARRIERS NOTES

1. **MATERIAL SPECIFICATION:** SILT FENCE FABRIC SHOULD CONFORM TO THE AASHTO M288 SILT FENCE SPECIFICATION. THE POSTS USED TO SUPPORT THE SILT FENCE FABRIC SHOULD BE A HARDWOOD MATERIAL WITH THE FOLLOWING MINIMUM DIMENSIONS: 2" SQUARE (NOMINAL) BY 4' LONG. SILT FENCE FABRIC SHOULD BE ATTACHED TO THE WOODEN POSTS WITH STAPLES, WIRE, ZIP TIES, OR NAILS.
2. **PLACEMENT:** A SLOPE BARRIER SHOULD BE USED AT THE TOE OF A SLOPE WHEN A DITCH DOES NOT EXIST. THE SLOPE BARRIER SHOULD BE PLACED ON NEARLY LEVEL GROUND 5' TO 10' AWAY FROM THE TOE OF A SLOPE. THE BARRIER IS PLACED AWAY FROM THE TOE OF THE SLOPE TO PROVIDE ADEQUATE STORAGE FOR SETTLING OUT SEDIMENT. WHEN PRACTICABLE, SILT FENCE SLOPE BARRIERS SHOULD BE PLACED ALONG CONTOURS TO AVOID A CONCENTRATION OF FLOW. SILT FENCE SLOPE BARRIERS CAN ALSO BE PLACED ALONG RIGHT-OF-WAY FENCE LINES TO KEEP SEDIMENT FROM CROSSING ONTO ADJACENT PROPERTY. WHEN PLACED IN THIS MANNER, THE SLOPE BARRIER WILL NOT LIKELY FOLLOW CONTOURS.
3. **PROPER INSTALLATION METHOD:** EXCAVATE A TRENCH THE LENGTH OF THE PLANNED SLOPE BARRIER THAT IS 6" DEEP BY 4" WIDE. MAKE SURE THAT THE TRENCH IS EXCAVATED ALONG A SINGLE CONTOUR. WHEN PRACTICABLE, SLOPE BARRIERS SHOULD BE PLACED ALONG CONTOURS TO AVOID A CONCENTRATION OF FLOW. PLACE THE SOIL ON THE UPSLOPE SIDE OF THE TRENCH FOR LATER USE. ROLL OUT A CONTINUOUS LENGTH OF SILT FENCE FABRIC ON THE DOWNSLOPE SIDE OF THE TRENCH. PLACE THE EDGE OF THE FABRIC IN THE TRENCH STARTING AT THE TOP UPSLOPE EDGE. LINE ALL THREE SIDES OF THE TRENCH WITH THE FABRIC. BACKFILL OVER THE FABRIC IN THE TRENCH WITH THE EXCAVATED SOIL AND COMPACT. AFTER FILLING THE TRENCH, APPROXIMATELY 24" TO 36" OF SILT-FENCE FABRIC SHOULD REMAIN EXPOSED. LAY THE EXPOSED SILT FENCE UPSLOPE OF THE TRENCH TO CLEAR AN AREA FOR DRIVING IN THE POSTS. JUST DOWNSLOPE OF THE TRENCH, DRIVE POSTS INTO THE GROUND TO A DEPTH OF AT LEAST 18". PLACE POSTS NO MORE THAN 4' APART. ATTACH THE SILT FENCE TO THE ANCHORED POST WITH STAPLES, WIRE, ZIP TIES, OR NAILS.
4. **LIST OF COMMON PLACEMENT/INSTALLATION MISTAKES TO AVOID:** WHEN PRACTICABLE, DO NOT PLACE SILT FENCE SLOPE BARRIERS ACROSS CONTOURS. SLOPE BARRIERS SHOULD BE PLACED ALONG CONTOURS TO AVOID A CONCENTRATION OF FLOW. WHEN THE FLOW CONCENTRATES, IT OVERTOPS THE BARRIER AND THE SILT FENCE SLOPE BARRIER QUICKLY DETERIORATES. DO NOT PLACE SILT-FENCE POSTS ON THE UPSLOPE SIDE OF THE SILT FENCE FABRIC. IN THIS CONFIGURATION, THE FORCE OF THE WATER IS NOT RESTRICTED BY THE POSTS, BUT ONLY BY THE STAPLES (WIRE, ZIP TIES, NAILS, ETC.). THE SILT FENCE WILL RIP AND FAIL. DO NOT PLACE SILT FENCE SLOPE BARRIERS IN AREAS WITH SHALLOW SOILS UNDERLAIN BY ROCK. IF THE BARRIER IS NOT SUFFICIENTLY ANCHORED, IT WILL WASH OUT. SILT FENCE SLOPE BARRIERS MUST BE DUG INTO THE GROUND-SILT FENCE AT GROUND LEVEL DOES NOT WORK BECAUSE WATER WILL FLOW UNDERNEATH.
5. **INSPECTION AND MAINTENANCE:** SILT FENCE SLOPE BARRIERS SHOULD BE INSPECTED EVERY 7 DAYS AND WITHIN 24 HOURS OF A RAINFALL OF 1/2" OR MORE. THE FOLLOWING IS A LIST OF QUESTIONS THAT SHOULD BE ADDRESSED DURING EACH INSPECTION:

ARE THERE ANY POINTS ALONG THE SLOPE BARRIER WHERE WATER IS CONCENTRATING?  
DOES WATER FLOW UNDER THE SLOPE BARRIER?  
DO THE SILT FENCES SAG EXCESSIVELY?  
HAS THE SILT FENCE TORN OR BECOME DETACHED FROM THE POSTS?  
DOES SEDIMENT NEED TO BE REMOVED FROM BEHIND THE SLOPE BARRIER?

3 SILT FENCE BARRIERS DETAIL  
NTS

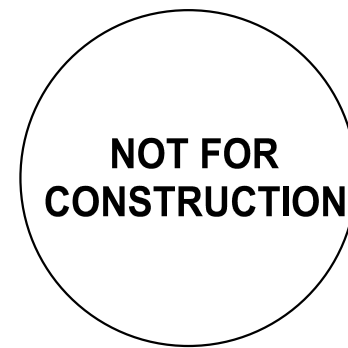
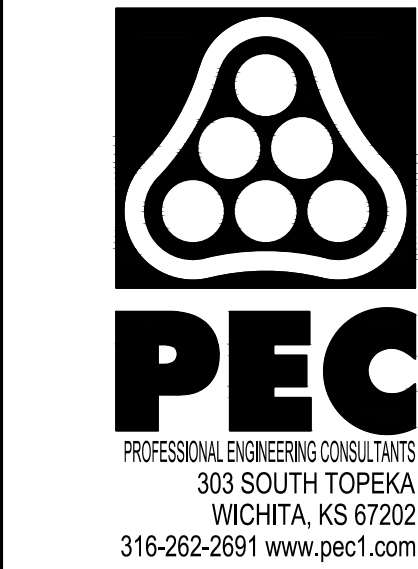

SKYVIEW PARK  
PLAYGROUND  
BEL AIRE, KANSAS

Issue:		
1	90% CD SET	04/28/25
JOB NO.	237363-015	
DATE	APRIL 2025	
PM	KPG	
DESIGNED BY	RKO	
DRAWN BY	RKO	
CHECKED BY	KPG	

EROSION CONTROL DETAILS

LG501





NOT FOR  
CONSTRUCTION

SKYVIEW PARK  
PLAYGROUND  
BEL AIRE, KANSAS

<b>Issue:</b>		
1	90% CD SET	04/28/2025
JOB NO.	237363-015	
DATE	APRIL 2025	
PM	KPG	
DESIGNED BY	RKO	
DRAWN BY	RKO	
CHECKED BY	KPG	

PLANTING PLAN

LP101

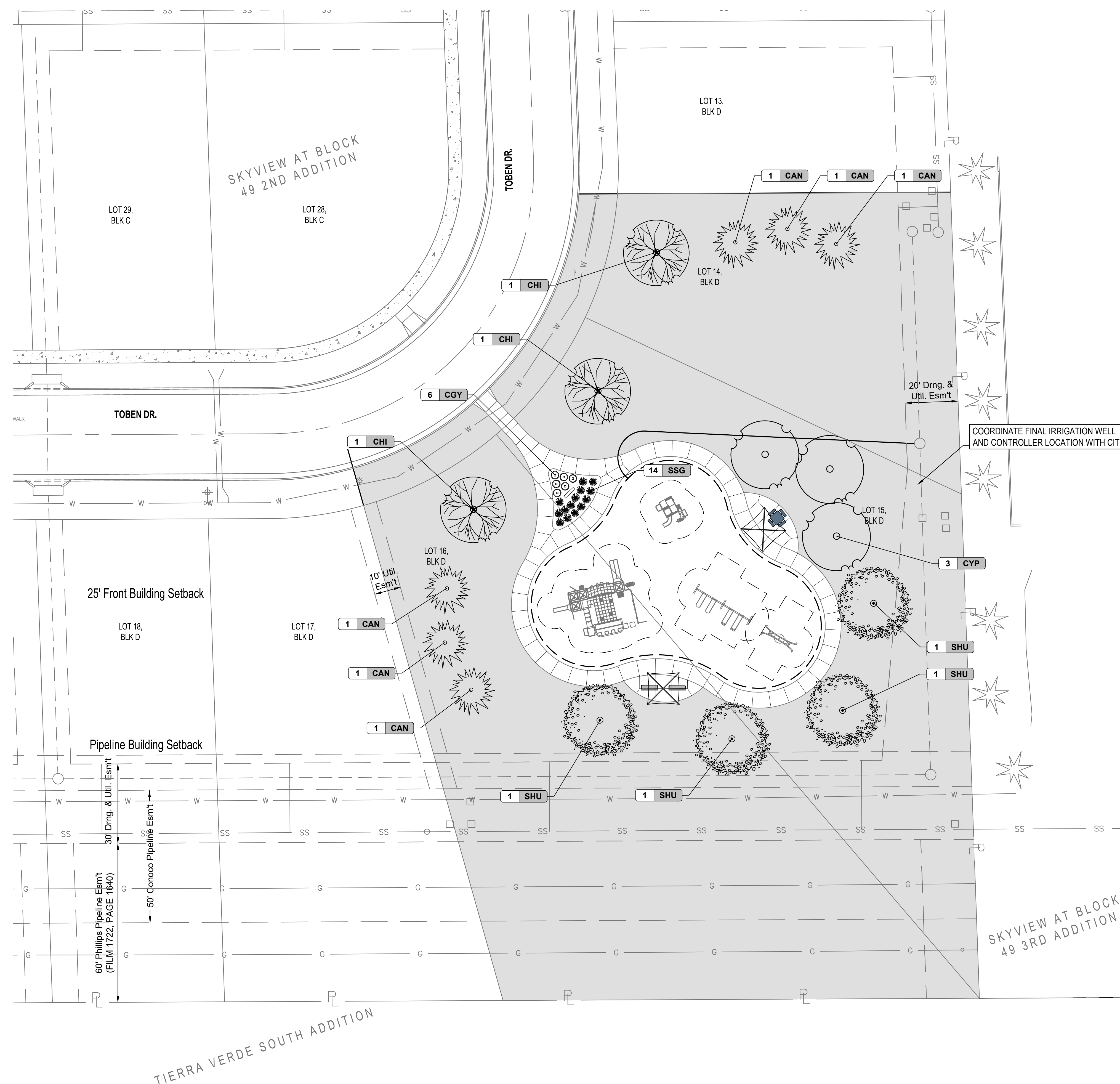

## TURF LEGEND

FESCUE SOD

BID ALTERNATES:

BASE BID: TALL FESCUE SOD WITH PERMANENT  
IRRIGATION. IRRIGATION WELL SHALL BE  
SUBSIDIARY TO IRRIGATION

BID ALTERNATE #1: K-31 FESCUE SEED WITH  
TEMPORARY IRRIGATION. IRRIGATION WELL NO  
INCLUDED

SKYVIEW AT BLOCK  
49 3RD ADDITION

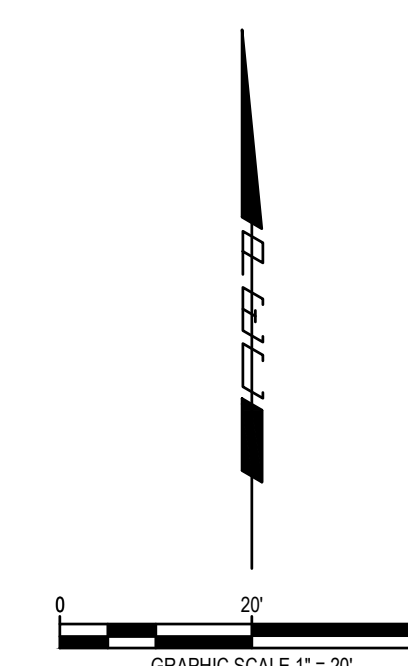

SAVED 4/28/2025 3:03:10 PM BY DUSTIN LOHMANN  
PLOTTED 4/28/2025 3:05:21 PM BY DUSTIN LOHMANN  
J:\HWCHITA-CIVIL\2023\23273630152PD4 PLANS\030LP101 PLANTING-PLAN.DWG



GENERAL LANDSCAPE NOTES

1. CONTRACTOR SHALL MAKE THEMSELVES FAMILIAR WITH ALL APPLICABLE SPECIFICATIONS RELATED TO THE LANDSCAPE PLANS.
2. LANDSCAPE CONTRACTOR IS TO VERIFY THE LOCATION OF ALL UNDERGROUND UTILITIES (INCLUDING THOSE INDICATED ON THE PLAN) PRIOR TO INSTALLATION OF PLANT MATERIAL. UTILITIES CAN BE FLAGGED BY CALLING 811 OR 1-800-344-7233, OR ONLINE AT [www.kansasonecall.com](http://www.kansasonecall.com). DAMAGE TO UTILITIES SHALL BE AVOIDED DURING THE COURSE OF WORK. THE LANDSCAPE CONTRACTOR IS RESPONSIBLE FOR REPAIRING ANY AND ALL DAMAGE TO UTILITIES, STRUCTURES, SITE APPURTENANCES, ETC. WHICH OCCUR AS A RESULT OF THE LANDSCAPE CONSTRUCTION.
3. LANDSCAPE CONTRACTOR SHALL COORDINATE WITH THE MASS GRADING CONTRACTOR TO INSURE THEY THOROUGHLY RIP AND ALLEVIATE ALL COMPACTED SOILS FROM THEIR HAULING AND PLACEMENT OPERATIONS.
4. ALL WATER REQUIRED FOR LANDSCAPE OPERATIONS AND FOR ESTABLISHING LANDSCAPE ON THIS SITE WILL BE PROVIDED BY THE OWNER FROM ON-SITE SOURCES AND SUPPLIED TO THE LANDSCAPE CONTRACTOR AT NO CHARGE.
5. PLANTING DATES FOR PLANT MATERIAL SHALL BE DURING THE MONTHS BETWEEN FEB. 15TH AND MAY 31ST OR SEPT. 15TH AND DEC. 15. PLANTING SHALL ONLY BE CONDUCTED WHEN THE GROUND IS NOT FROZEN, SNOW-COVERED, OR IN AN OTHERWISE UNSUITABLE CONDITION FOR PLANTING. DEVIATION FROM THE ABOVE PLANTING DATES WILL ONLY BE PERMITTED WITH APPROVAL FROM THE OWNER'S REPRESENTATIVE.
6. ALL SHRUB/PERENNIAL PLANTING BEDS SHALL BE TREATED WITH A PRE-EMERGENT HERBICIDE SUCH AS TREFLAN OR EQUAL. APPLY AS PER MANUFACTURER'S RECOMMENDATION. THE PRE-EMERGENT SHALL NOT BE APPLIED UNTIL AFTER ALL PLANTING AND MULCHING WITHIN THESE AREAS ARE COMPLETE. DO NO DISTURB AREAS AFTER APPLICATION. WATER IN AS DIRECTED.
7. INSTALL 4" MIN. DEPTH FINE-SHREDDED, DARK HARDWOOD MULCH IN ALL PLANTING BED AREAS AND WITHIN A 4' DIAMETER CIRCLE AROUND ALL TREES PLANTED IN LAWN AREAS. PULL MULCH AWAY FROM TREE TRUNKS WITHIN 3" OF TRUNK.
8. IF POSSIBLE, BASED ON TIME OF YEAR SITE IS READY FOR LANDSCAPING, PLANT TREES PRIOR TO ROUTING/INSTALLING IRRIGATION LINES AND SUSTAIN TEMPORARILY BY WATERING WITH IRRIGATOR SLOW DRIP IRRIGATION BAGS OR BY HAND WATERING. FOLLOW TREE PLANTING WITH INSTALLATION OF IRRIGATION SYSTEM, THEN BY SODDING AND SEEDING (IF APPLICABLE).
9. FESCUE SOD SHALL BE HARVESTED & PLACED BETWEEN THE DATES OF APRIL 1ST AND JUNE 15TH UNLESS OTHERWISE APPROVED BY THE OWNER'S REPRESENTATIVE. IT IS THE CONTRACTOR'S RESPONSIBILITY TO WATER ALL SOD UNTIL LANDSCAPE JOB IS COMPLETE.
10. AREAS DENOTED AS 'SOD' SHALL BE PLANTED WITH THE FOLLOWING GRASS TYPE: SOD, KANSAS PREMIUM BLEND, OBTAINABLE FROM CRANMER GRASS FARM, INC., 6121 N. 119TH, MAIZE, KANSAS 67101, PH# (316) 722-7230.
11. ALL SOD AREAS SHALL BE INSTALLED AS FOLLOWS: AFTER FINAL GRADE IS ESTABLISHED AND ALL SOIL AREAS DRAIN AS INTENDED, AND ALL SURFACE IRREGULARITIES HAVE BEEN REMOVED, THOROUGHLY PREPARE SODBED BY TILLING TO A MINIMUM DEPTH OF 3" AND HARROWING. ROLL SOD FOLLOWING LAYING FOR GOOD SOD/SOIL CONTACT AND KEEP IN A MOIST (BUT NOT SATURATED) CONDITION FOR FIRST TWO WEEKS TO PROMOTE GOOD ROOTING. FERTILIZE WITH 1 LB. ACTUAL NITROGEN PER 1,000 S.F. AT TIME OF PLANTING.
12. ALL LANDSCAPE AND TURF AREAS SHALL BE WATERED BY AN AUTOMATIC IRRIGATION SYSTEM. IRRIGATION SYSTEM SHALL BE EQUIPPED WITH A RAIN-SENSING DEVICE TO SHUT OFF THE SYSTEM DURING PERIODS OF ADEQUATE RAIN.
13. PLACEMENT OF IRRIGATION CONTROLLER SHALL BE COORDINATED WITH THE OWNER'S REPRESENTATIVE.
14. COORDINATE LANDSCAPE PLANTING WITH IRRIGATION CONTRACTOR. THE TREE PLANTINGS SHALL BE IN PLACE OR STAKED BEFORE IRRIGATION LINE ROUTING BEGINS TO AVOID CONFLICTS. THE IRRIGATION SYSTEM SHALL BE COMPLETE AND FULLY FUNCTIONAL IN ALL LAWN AREAS BEFORE SOD/SEED IS PLACED.
15. ALL PLANTS SHALL CONFORM TO ANSI Z60.1 FOR SIZE AND QUALITY STANDARDS.
16. LABEL EACH PLANT WITH A SECURELY ATTACHED, WATERPROOF TAG BEARING LEGIBLE DESIGNATION OF BOTH BOTANICAL AND COMMON NAME. DO NOT REMOVE UNTIL AFTER PROVISIONAL ACCEPTANCE.
17. SUBSTITUTION OF PLANT SPECIES FOR THOSE LISTED IN THE PLANT LIST IS NOT PERMISSIBLE. ONLY SIZE WILL BE CONSIDERED.
18. ALL PLANTS MUST BE HEALTHY, VIGOROUS MATERIAL; FREE OF PEST AND DISEASES. ALL PLANTS MUST BE CONTAINER-GROWN OR BALLED AND BURLAPPED AS INDICATED IN THE PLANT LIST. ALL TREES SHALL BE STRAIGHT-TRUNKED, OR OF TYPICAL FORM TO THE SPECIES, FULL-HEADED AND MEET THE REQUIREMENTS AS SPECIFIED. ALL TREES MUST BE STAKED.
19. STAKES AND GUYING SHALL BE REMOVED AT THE END OF ONE FULL GROWING SEASON.
20. ALL PLANTS ARE SUBJECT TO THE APPROVAL OF THE LANDSCAPE ARCHITECT BEFORE, DURING, AND AFTER INSTALLATION. REJECTED PLANTS SHALL BE REMOVED IMMEDIATELY.
21. ALL LANDSCAPE PLANTS SHALL BE GUARANTEED FOR ONE YEAR FOLLOWING INITIAL ACCEPTANCE. DEAD OR DEFICIENT PLANTINGS SHALL BE ACCEPTABLY REPLACED, IN PROPER PLANTING SEASON, ONE TIME AT NO COST TO THE OWNER. SOD AREAS MAY BE FINAL ACCEPTED AT TIME OF COMPLETION OF ESTABLISHMENT WITH NO FURTHER GUARANTEE REQUIRED.
22. LANDSCAPE CONTRACTOR SHALL BE RESPONSIBLE FOR MAINTAINING, (INCLUDING WATERING AND MOVING), SOD AREAS UNTIL ACCEPTANCE OF THESE AREAS. WHEN READY, THE LANDSCAPE CONTRACTOR SHALL REQUEST INSPECTION OF ESTABLISHED SODDED AREAS BY THE OWNER'S REPRESENTATIVE.
23. TOPSOIL FOR ALL LANDSCAPE BEDS SHALL BE A MINIMUM OF EIGHTEEN INCHES (18") DEPTH. TURF AREAS SHALL HAVE A MINIMUM OF SIX INCHES (6") OF TOPSOIL.

PLANT SCHEDULE

KEY	QTY	COMMON NAME	BOTANICAL NAME	SIZE & METHOD OF HANDLING	NOTES
DECIDUOUS TREES					
CHI	3	CHINESE PISTACHE	PISTACIA CHINENSIS 'KEITH DAVEY'	15'-20' MIN. HT. / B&B	MALE TREES ONLY
SHU	4	SHUMARD OAK	QUERCUS SHUMARDII	2.5" CAL. / B&B	BRANCHING HT. 5' MIN.
CYP	3	'SHAWNEE BRAVE' BALDCYPRESS	TAXODIUM DISTICHUM 'SHAWNEE BRAVE'	2.5" CAL. / B&B	BRANCHING HT. 5' MIN.
EVERGREEN TREES					
CAN	6	CANAERTI JUNIPER	JUNIPERUS VIRGINIANA 'CANAERTII'	7' - 8' MIN. HT.	
SHRUBS					
CGY	6	'COLOR GUARD' YUCCA	YUCCA FILAMENTOSA 'COLOR GUARD'	#3 CONT.	
ORNAMENTAL GRASSES					
SSG	14	'SHENANDOAH' SWITCHGRASS	PANICUM VIRGATUM 'SHENANDOAH'	#1 CONT.	
TURF GRASS					
SOD	5,400 SY	'FESCUE: GARD'N WISE 'FESCUE/BLUE MIXTURE'			SOD

\*ALTERNATE #1 - K-31 GRASS SEED

- NOTES:  
BALL OF PLANT TO BE KEPT MOIST AND PROTECTED FROM DAMAGE PRIOR TO PLANTING. ADD ROOT STIMULATOR TO SURFACE IMMEDIATELY AFTER PLANTING AS PER THE MANUFACTURER'S RECOMMENDATIONS. PLANTING DEPTH OF ROOTBALL SHALL BE EQUAL TO ITS ORIGINAL PLANTING DEPTH AT NURSERY.

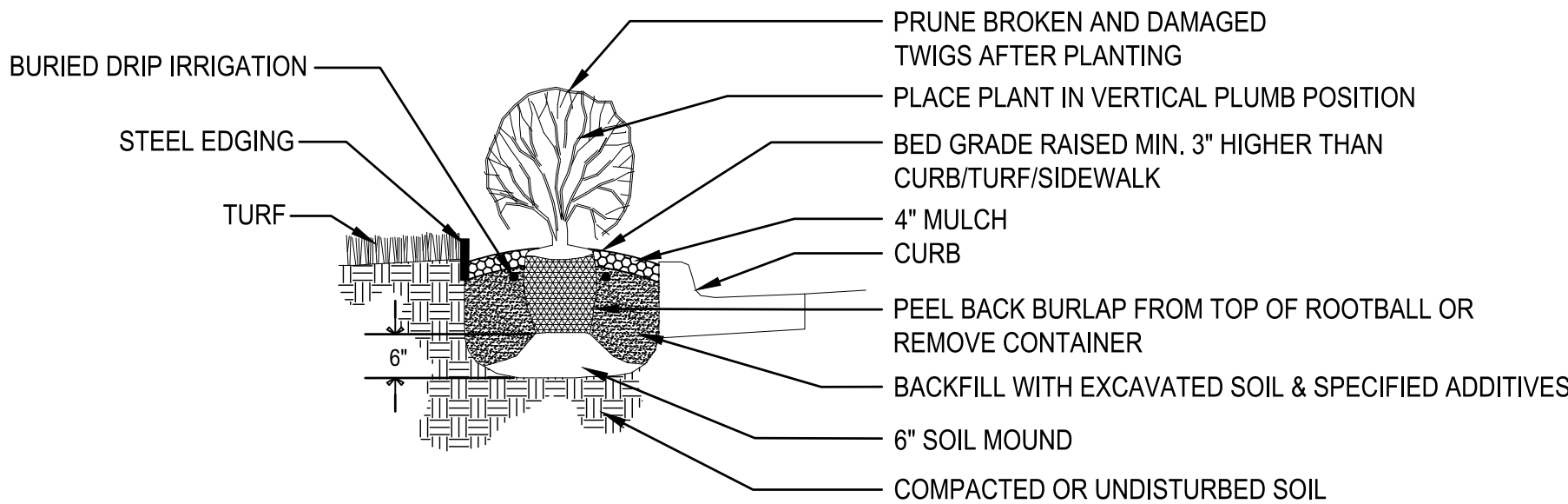

1 SHRUB PLANTING DETAIL  
NTS

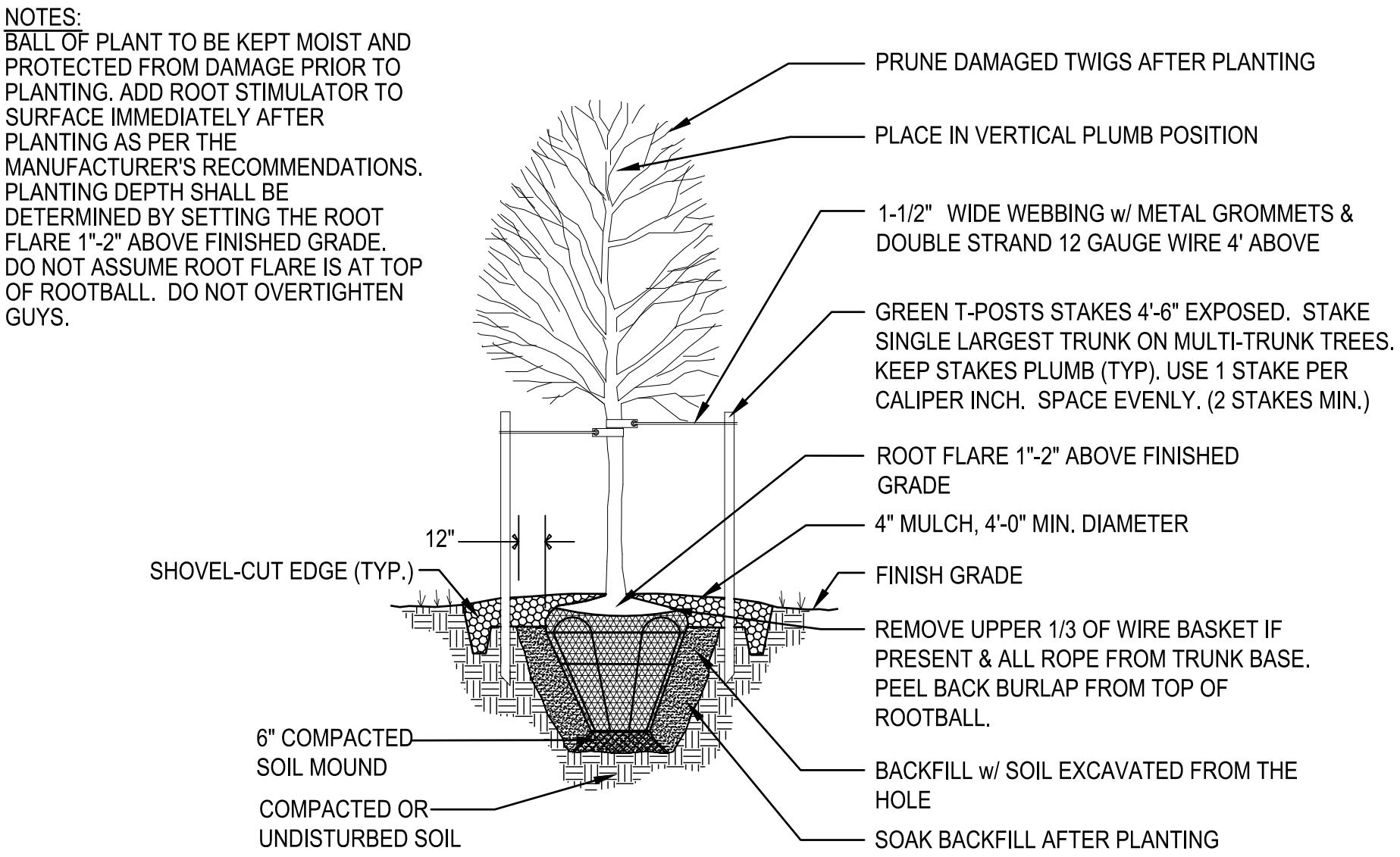

2 TREE PLANTING IN TURF AREA  
NTS

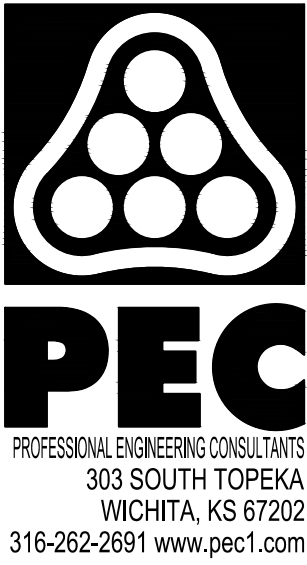

NOT FOR  
CONSTRUCTION

SKYVIEW PARK  
PLAYGROUND  
BEL AIRE, KANSAS

Issue:		
1	90% CD SET	04/28/25
JOB NO.	237363-015	
DATE	APRIL 2025	
PM	KPG	
DESIGNED BY	RKO	
DRAWN BY	RKO	
CHECKED BY	KPG	

PLANTING DETAILS

LP501  
LP501 OF 9