

LEGEND

EXIST. CONTOUR	(203)
PROPOSED CONTOUR	203
PROPOSED FIRE HYDRANT	
GRASS DRAINAGE SWALE	
STORM DRAIN INLET	
PROPOSED STORM DRAIN	SD
POROUS PAVEMENT	
CURB & GUTTER	
CURB	
ZERO CURB	
PROPERTY LINE	
EXIST. STORM DRAIN	
RETAINING WALL	

LEGAL DESCRIPTION
 PARCELS 1 THROUGH 4 OF LOT 124 OF TRACT 31468-2, IN THE CITY OF BEAUMONT, COUNTY OF RIVERSIDE, STATE OF CALIFORNIA, AS SHOWN BY MAP ON FILE IN BOOK 388, PAGES 7 THROUGH 15, INCLUSIVE OF MAPS, IN THE OFFICE OF THE COUNTY RECORDER OF SAID COUNTY.

ASSESSOR'S PARCEL:
 419-020-059-6

OWNER:
 SUNDANCE L.L.C.
 CONTACT: SOLOMON LEVY
 2371 FENTON STREET
 CHULA VISTA, CA 91914
 T619-286-2278 F619-660-1966

APPLICANT:
 McARDLE ASSOCIATES ARCHITECTS
 CONTACT: KAY WILLIS
 5838 EDISON PLACE SUITE 100
 CARLSBAD, CA 92008
 T760-431-7775 F760-431-7585

UTILITY PURVEYORS:
 WATER/SEWER: BEAUMONT/CHERRY VALLEY WATER DISTRICT
 1-951-845-9581
 ELECTRICITY: SO. CAL. EDISON
 1-800-655-4555
 GAS: THE GAS COMPANY
 1-800-427-2200
 TELEPHONE: VERIZON
 1-800-483-4000
 CABLE: TIME WARNER
 1-760-964-2783
 SCHOOL DIST.: BEAUMONT UNIFIED
 1-951-845-1631

ZONING DATA:
 GENERAL PLAN DESIGNATION: SP (SUNDANCE)
 EXISTING SITE ZONE: SP (SUNDANCE)
 EXISTING USE: VACANT LOT
 PROPOSED USE: OFFICE/COMMERCIAL
 SITE AREA: 13.6 ACRES
 FEMA FLOOD ZONE DESIGNATION: C
 FEMA PANEL NUMBER: 060245 0815A

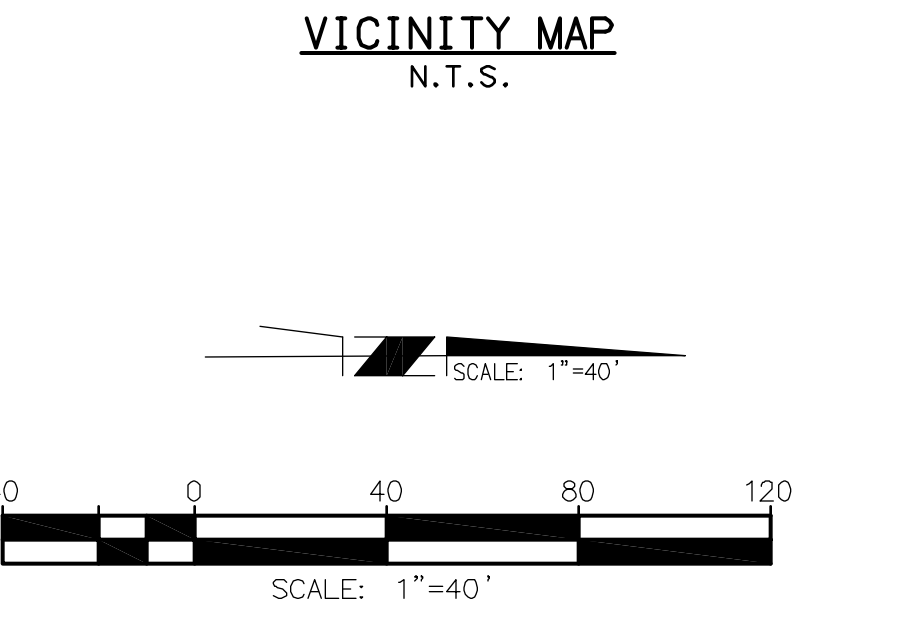
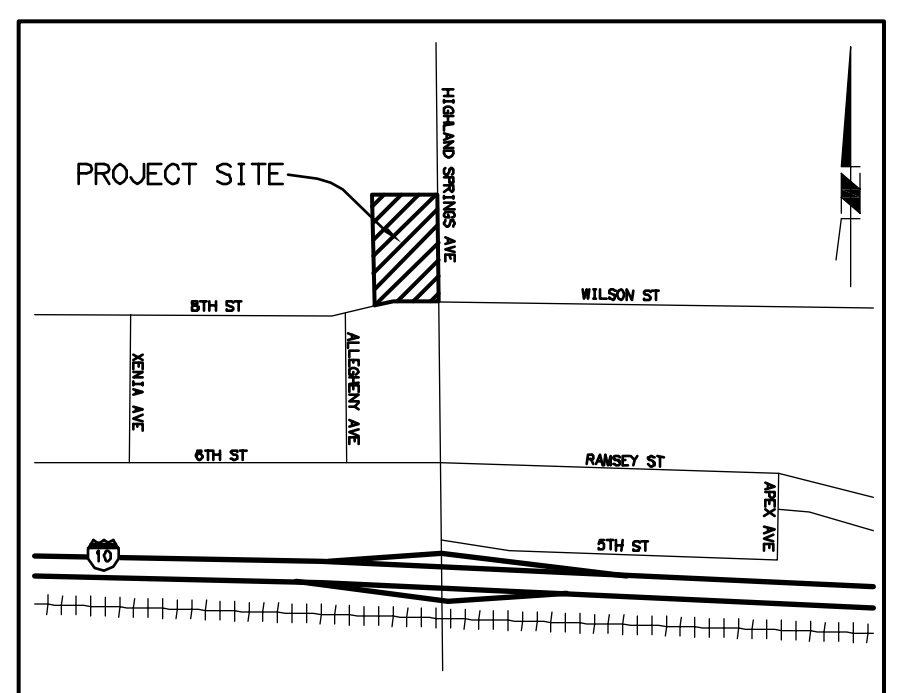

CONSTRUCTION
 DESIGN
 PLANNING

RBF CONSULTING

6050 AVENIDA ENCINAS STE 280
 CARLSBAD, CALIFORNIA 92008
 760.476.9883 • FAX 760.476.9884 • WWW.RBF.COM

REGISTERED PROFESSIONAL ENGINEER
 No. C60283
 Exp. 08-30-08
 CIVIL
 STATE OF CALIFORNIA

SUNDANCE CORPORATE CENTER
 NEIGHBORHOOD DEVELOPMENT
 BEAUMONT, CALIFORNIA

TRACT MAP NO. 35789

Date: 7/27/07
 Project:
 File:
 Revisions: 11/16/07
 01/14/08

TENTATIVE TRACT MAP