

**bluespace**  
INTERIORS

CLIENT  
CITY OF BEAUMONT

ADDRESS  
650 EAST 8TH STREET  
BEAUMONT, CA

SALES EXECUTIVE  
JEANETTE BARBER

PROJECT NAME  
BUILDING C STATIONS

DRAWING TITLE  
FURNITURE PLAN

DRAWN BY  
LINDA NANCE

SCALE  
NOT TO SCALE

FILE PATH

REVISIONS		DATE
1	REVISION DESCRIPTION	04/29/22
2		02/06/20
3		02/06/20
BILLABLE REVISIONS		
4		02/06/20
5		02/06/20
6		02/06/20

All specifications, drawings, concepts, designs, intellectual and written material represent herein constitute unique and unpublished work of bluespace Interiors and may not be copied, used by or disclosed to others without written consent of bluespace Interiors

APPROVED BY \_\_\_\_\_  
DATE \_\_\_\_\_

APPROVED BY \_\_\_\_\_  
DATE \_\_\_\_\_

CLIENT  
CITY OF BEAUMONT  
ADDRESS  
550 EAST 6TH STREET,  
BEAUMONT, CA  
PROJECT NAME

OFFICES  
SALES EXECUTIVE  
GEOMETRIC BARBER  
DRAWING TITLE

FURNITURE PLAN  
DRAWN BY LINDA NAJICA SCALE 1/8" = 1'-0" TO SCALE

#	REVISION DESCRIPTION	DATE
1	INITIAL LAYOUT	04/20/22
2		00/00/00
3		00/00/00

#	REVISION DESCRIPTION	DATE
4		00/00/00
5		00/00/00
6		00/00/00
7		00/00/00
8		00/00/00
9		00/00/00
10		00/00/00

SHEET NUMBER

2 / 4

FILE PATH  
All specifications, drawings, concepts, designs, intellectual and written material represent herein constitute unique and unpublished work of bluespace interiors and may not be copied, used by or disclosed to others without written consent of bluespace interiors

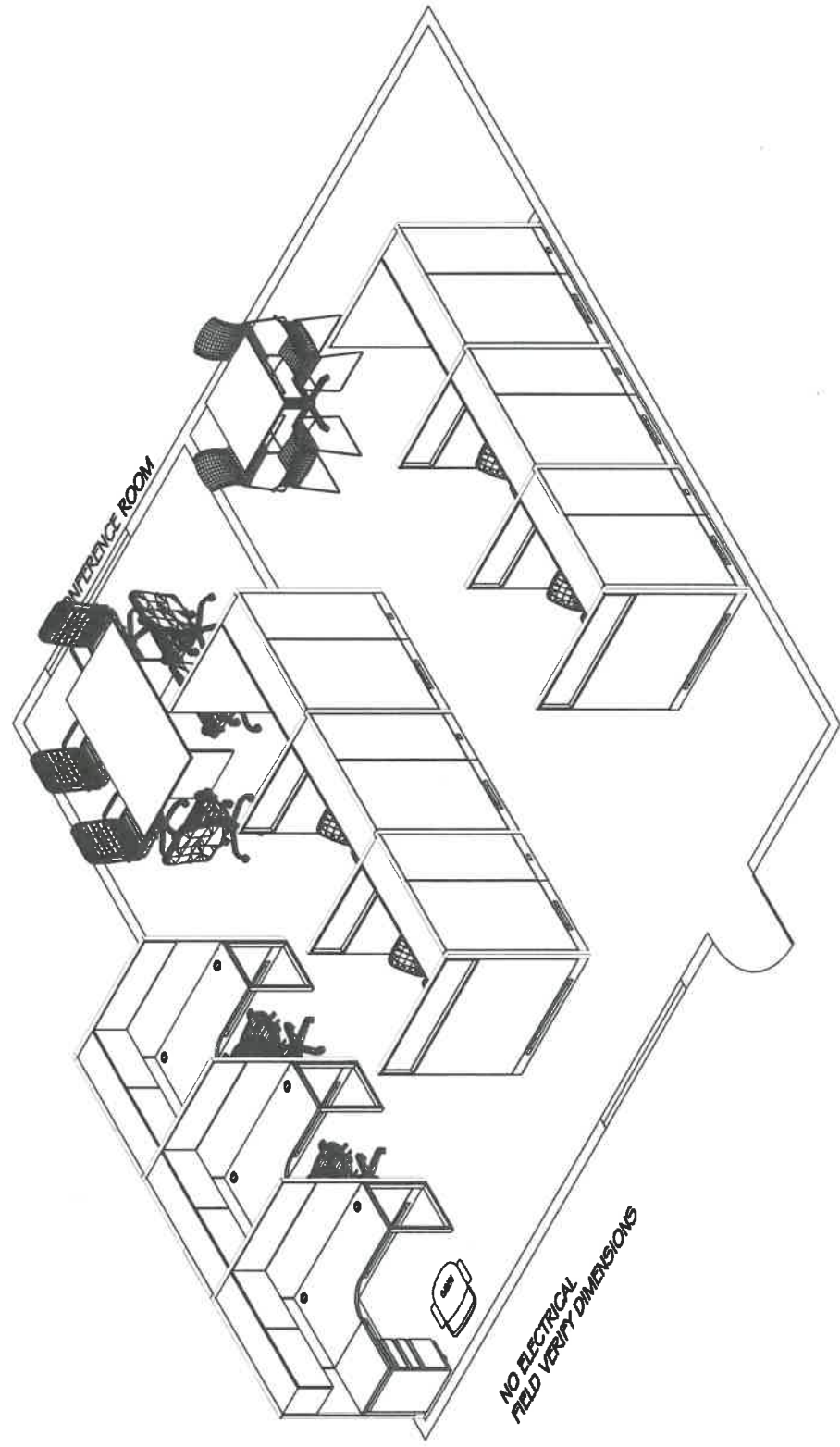

NO ELECTRICAL  
FIELD VERIFY DIMENSIONS

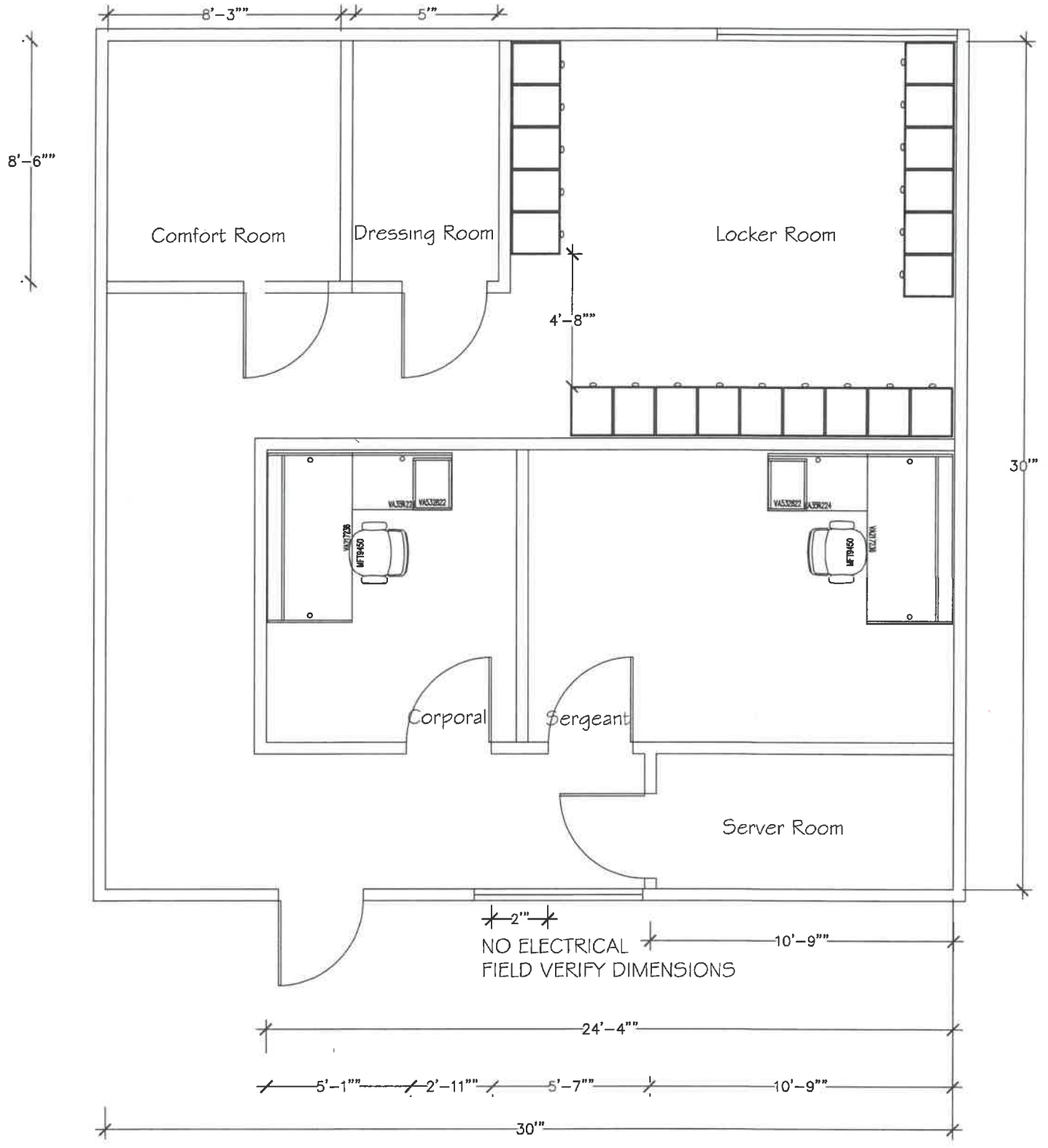

**bluespace**  
INTERIORS

CLIENT  
CITY OF BEAUMONT  
ADDRESS  
800 EAST 6TH STREET  
BEAUMONT, CA  
SALES EXECUTIVE  
JEANETTE BARBER

PROJECT NAME  
BUILDING C STATIONS  
DRAWING TITLE  
FURNITURE PLAN  
DRAWN BY  
LINDA HANCOCK  
CHECKED BY  
3 OF 4  
SCALE  
NOT TO SCALE  
FILE PATH

REVISIONS		
#	REVISION DESCRIPTION	DATE
1	REVISED LAYOUT	06/06/22
2		02/09/20
3		02/09/20
RELEASABLE REVISIONS		
4		02/09/20
5		02/09/20
6		02/09/20

All specifications, drawings, concepts, designs, intellectual and written material represent herein constitute unique and unpublished work of bluespace Interiors and may not be copied, used by or disclosed to others without written consent of bluespace Interiors

APPROVED BY  
DATE

APPROVED BY \_\_\_\_\_

DATE \_\_\_\_\_

CLIENT

CITY OF BEAUMONT

ADDRESS

550 EAST 6TH STREET,  
BEAUMONT, CA

PROJECT NAME

OFFICES

SALES EXECUTIVE

JEANETTE BARBER

DRAWING TITLE

**FURNITURE PLAN**

DRAWN BY: LARDA HANZE SCALE: 1/8" = 1'-0" DATE: 09/09/00

REVISIONS

#	REVISION DESCRIPTION	DATE
1	INITIAL LAYOUT	9/9/02
2		00/00/00
3		00/00/00

BILLABLE REVISIONS

4		00/00/00
5		00/00/00
6		00/00/00
7		00/00/00
8		00/00/00
9		00/00/00
10		00/00/00

SHEET NUMBER

**4 / 4**

FILE PATH:

C:\Program Files\Bluespace\Projects\02\_01\_00\02\_01\_00\_001.dwg

All specifications, drawings, concepts, designs, intellectual and written material represent herein constitute unique and unpublished work of bluespace interiors and may not be copied, used by or disclosed to others without written consent of bluespace interiors

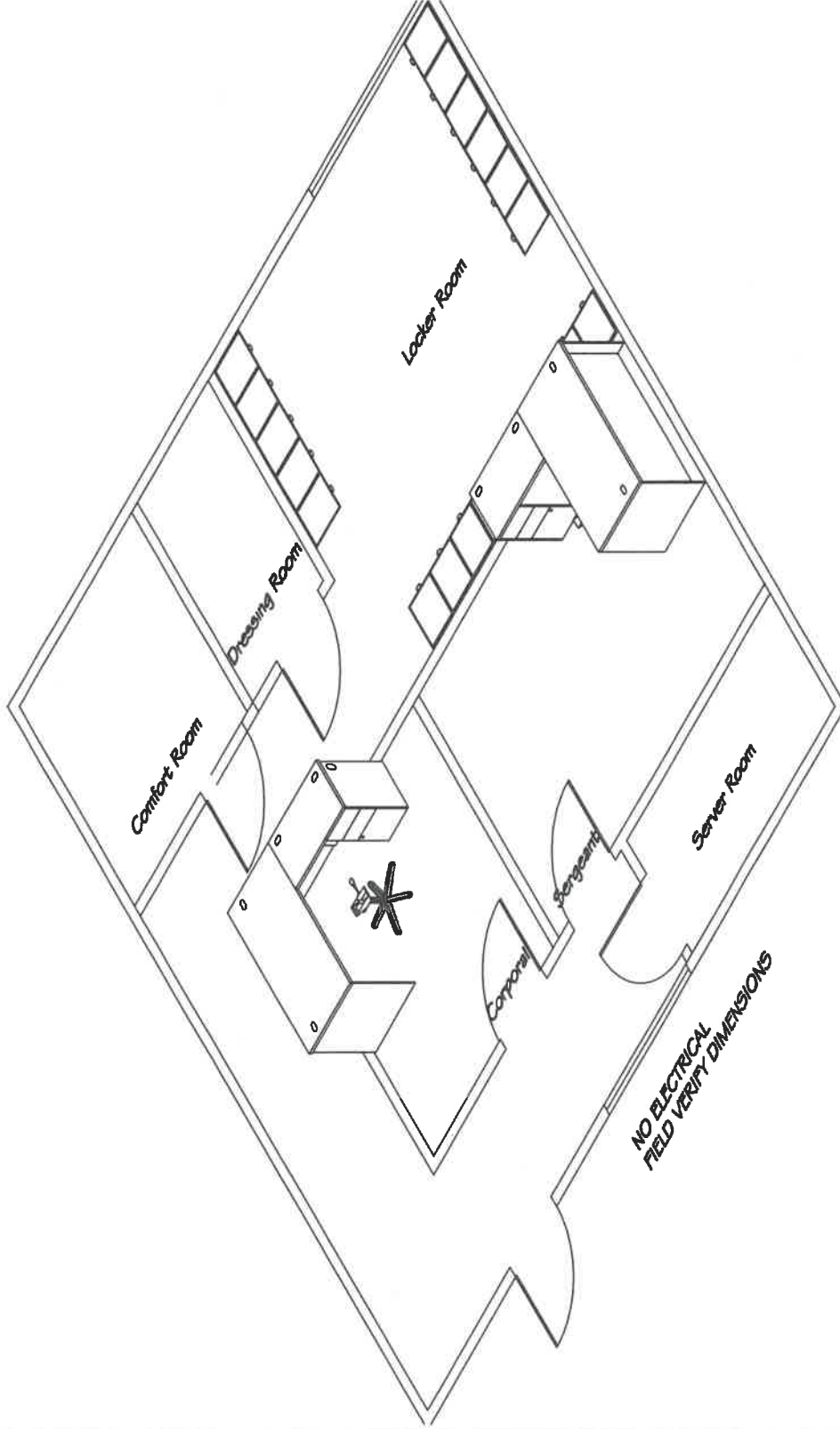

**NO ELECTRICAL  
FIELD VERIFY DIMENSIONS**

**Furniture Quotation**

**Building C**

Prepared For: Laurie Miller  
 City of Beaumont  
 550 E 6th Street

Quote Expires: 7/1/2022

Page 1 of 5  
 6/3/2022  
 11:52:23AM

Beaumont CA 92223  
 951-769-8520 x326

Quote # Q153362

City of Beaumont Bldg C KG 6.2.2022.visual.sp4

Sold By: Steve Noble

Prep. by: Karina Guevara

**Lead Time = 6-8 weeks | Finishes TBD | Rialto Bid #19-20-011**

Line#	Qty	Part #	Part Description	List	Discount	Sell	Extended Sell
<b>Conference room</b>							
1	1	ALEVA717242MY	TABLE RECT 72X42	\$658.00	45.00	\$361.90	\$361.90
		MY	Mahogany				LAMINATE FINISHES
						<b>Sub Total Sell</b>	<b>\$361.90</b>
<b>Corporal</b>							
2	1	ALEVA217236MY	VALENCIA SERIES, STRAIGHT FRONT DESK SHELL, 72"W x 36"D x 29 1/2"H	\$668.00	45.00	\$367.40	\$367.40
		MY	Mahogany				LAMINATE FINISHES
3	1	ALEVA532822MY	VALENCIA SERIES, B/B/F FULL PEDESTAL, 16"W x22"D x28"H	\$567.00	45.00	\$311.85	\$311.85
		MY	Mahogany				LAMINATE FINISHES
4	1	ALEVA354224MY	Valencia Return Bridge 42x23.5	\$368.00	45.00	\$202.40	\$202.40
		MY	Mahogany				LAMINATE FINISHES
		R	RIGHT				SHELL CONFIGURATIONS
						<b>Sub Total Sell</b>	<b>\$881.65</b>
<b>Kitchen</b>							
5	1	ALETBH283B	28H BASE BLACK	\$360.00	45.00	\$198.00	\$198.00
		CM2	MAHOGANY				LAMINATE FINISHES
6	1	ALETTSQ36CM	36 SQUARE TOP	\$231.00	45.00	\$127.05	\$127.05
		CM2	MAHOGANY				LAMINATE FINISHES
						<b>Sub Total Sell</b>	<b>\$325.05</b>
<b>Sergeant</b>							
7	1	ALEVA217236MY	VALENCIA SERIES, STRAIGHT FRONT DESK SHELL, 72"W x 36"D x 29 1/2"H	\$668.00	45.00	\$367.40	\$367.40
		MY	Mahogany				LAMINATE FINISHES
8	1	ALEVA532822MY	VALENCIA SERIES, B/B/F FULL PEDESTAL, 16"W x22"D x28"H	\$597.00	45.00	\$328.35	\$328.35
		MY	Mahogany				LAMINATE FINISHES
9	1	ALEVA354224MY	Valencia Return Bridge 42x23.5	\$368.00	45.00	\$202.40	\$202.40
		MY	Mahogany				LAMINATE FINISHES

Prepared For: Laurie Miller  
 City of Beaumont  
 550 E 6th Street

Quote Expires: 7/1/2022

Page 2 of 5  
 6/3/2022

Beaumont CA 92223  
 951-769-8520 x326

Quote # Q153362

City of Beaumont Bldg C KG 6.2.2022.visual.sp4

Sold By: Steve Noble

Prep. by: Karina Guevara

**Lead Time = 6-8 weeks | Finishes TBD | Rialto Bid #19-20-011**

Line#	Qty	Part #	Part Description	List	Discount	Sell	Extended Sell
		L	LEFT			SHELL CONFIGURATIONS	

**Sub Total Sell \$898.15**

**Workstations**

10	5	HECSL	"L" Connector Strap	\$20.00	45.00	\$11.00	\$55.00
11	6	HECST	"T" Connector Strap	\$28.00	45.00	\$15.40	\$92.40
12	1	HF22	Master Key (One Key)	\$37.00	45.00	\$20.35	\$20.35
13	6	HCTL241L	Left-hand Cantilever 24"D	\$57.00	45.00	\$31.35	\$188.10
		\$(P1)	Select P1 Paint			Select Paint Color	
		~	Undecided PAINT Option			Select Grade 1 Paint	
14	3	HCTL242	24D Cantilever One Pair	\$105.00	45.00	\$57.75	\$173.25
		\$(P1)	P1 Paint Opts			Select Paint Color	
		~	Undecided PAINT Option			Select Grade 1 Paint	
15	5	HEC65PLN	65H "L" Connector Post	\$180.00	45.00	\$99.00	\$495.00
		\$(P1)	P1 Paint Opts			Select Paint Grade	
		~	Undecided PAINT Option			Select Grade 1 Paint	
16	6	HEC65PTN	65H "T" Connector Post	\$174.00	45.00	\$95.70	\$574.20
		\$(P1)	P1 Paint Opts			Select Paint Grade	
		~	Undecided PAINT Option			Select Grade 1 Paint	
17	11	HEFEC65P	Panel Finished End Covers 65H	\$82.00	45.00	\$45.10	\$496.10
		\$(P1)	P1 Paint Opts			Select Paint Color	
		~	Undecided PAINT Option			Select Grade 1 Paint	
18	9	HETC24	Panel Top Cap 24"W	\$48.00	45.00	\$26.40	\$237.60
		\$(P1)	P1 Paint Opts			Select Paint Color	
		~	Undecided PAINT Option			Select Grade 1 Paint	
19	9	HETC36	Panel Top Cap 36"W	\$74.00	45.00	\$40.70	\$366.30
		\$(P1)	P1 Paint Opts			Select Paint Color	
		~	Undecided PAINT Option			Select Grade 1 Paint	
20	11	HETC60	Panel Top Cap 60"W	\$106.00	45.00	\$58.30	\$641.30
		\$(P1)	P1 Paint Opts			Select Paint Color	
		~	Undecided PAINT Option			Select Grade 1 Paint	
21	1	HEWS65P	Wall Starter Kit for Panels 65H	\$133.00	45.00	\$73.15	\$73.15
		\$(P1)	P1 Paint Opts			Select Paint Color	
		~	Undecided PAINT Option			Select Grade 1 Paint	

Prepared For: Laurie Miller  
 City of Beaumont  
 550 E 6th Street

Quote Expires: 7/1/2022

Page 3 of 5  
 6/3/2022  
 11:52:23AM

Beaumont CA 92223  
 951-769-8520 x326

Quote # Q153362

City of Beaumont Bldg C KG 6.2.2022.visual.sp4

Sold By: Steve Noble

Prep. by: Karina Guevara

**Lead Time = 6-8 weeks | Finishes TBD | Rialto Bid #19-20-011**

Line#	Qty	Part #	Part Description	List	Discount	Sell	Extended Sell
22	6	HHN831124	Flat Bracket 24D	\$81.00	45.00	\$44.55	\$267.30
		.S	Color: Charcoal			Select Color Option	
23	9	HLSL24280	24"D x 28"H O-Leg Support for Wksf (single leg)	\$409.00	45.00	\$224.95	\$2,024.55
		\$(P1)	P1 Paint Opts			Select Paint Color	
		~	Undecided PAINT Option			Select Grade 1 Paint	
24	9	HLSLPBR	Voi O-Leg to Panel Bracket Right (Qty 1)	\$128.00	45.00	\$70.40	\$633.60
		\$(P1)	P1 Paint Opts			Select Paint Color	
		~	Undecided PAINT Option			Select Grade 1 Paint	
25	9	HSCKTPS	Straight Connector Kit	\$26.00	45.00	\$14.30	\$128.70
		.X	No Option			Select Paint Color	
26	9	HWSB2	Worksurface Bracket Kit	\$59.00	45.00	\$32.45	\$292.05
		\$(P1)	P1 Paint Opts			Select Paint Color	
		~	Undecided PAINT Option			Select Grade 1 Paint	
27	9	HF23C	Lock Core Replacement Kit Brushed Chrome	\$60.00	45.00	\$33.00	\$297.00
		.X101E	KEY NUMBER: 101E			Select Key Number	
28	9	HETP6524FP	Tackable Panel w/o TC 65H x 24W	\$455.00	45.00	\$250.25	\$2,252.25
		\$(A)	Gr A Fabric			Fabric Selection	
		~	Undecided FABRIC Option			Gr A Fab	
		\$(P1)	P1 Paint Opts			Select Paint Color	
		~	Undecided PAINT Option			Select Grade 1 Paint	
29	9	HETP6536FP	Tackable Panel w/o TC 65H x 36W	\$515.00	45.00	\$283.25	\$2,549.25
		\$(A)	Gr A Fabric			Fabric Selection	
		~	Undecided FABRIC Option			Gr A Fab	
		\$(P1)	P1 Paint Opts			Select Paint Color	
		~	Undecided PAINT Option			Select Grade 1 Paint	
30	2	HETP6560FP	Tackable Panel w/o TC 65H x 60W	\$622.00	45.00	\$342.10	\$684.20
		\$(A)	Gr A Fabric			Fabric Selection	
		~	Undecided FABRIC Option			Gr A Fab	
		\$(P1)	P1 Paint Opts			Select Paint Color	
		~	Undecided PAINT Option			Select Grade 1 Paint	
31	9	HRVOH60FM	Around Overhead-Metal Flipper Door 60"	\$1,051.00	45.00	\$578.05	\$5,202.45
		\$(P1)	P1 Paint Opts			Select Paint Color	
		~	Undecided PAINT Option			Select Grade 1 Paint	
		.L	Lock: Lock			Select Lock Option	
32	9	HVFB23R	Box/Box/File 28H x 22 7/8D x 15W	\$704.00	45.00	\$387.20	\$3,484.80

Prepared For: Laurie Miller  
 City of Beaumont  
 550 E 6th Street

Quote Expires: 7/1/2022

Page 4 of 5  
 6/3/2022

Beaumont CA 92223  
 951-769-8520 x326

Quote # Q153362

City of Beaumont Bldg C KG 6.2.2022.visual.sp4

Sold By: Steve Noble

Prep. by: Karina Guevara

**Lead Time = 6-8 weeks / Finishes TBD / Rialto Bid #19-20-011**

Line#	Qty	Part #	Part Description	List	Discount	Sell	Extended Sell
		.L	Lock: Lock			Select Lock Option	
		\$(P1)	P1 Paint Opts			Select Paint Color	
		~	Undecided PAINT Option			Select Grade 1 Paint	
33	9	HWR2424PN	Systems Rectanular Wksfc Edgeband 24D X 24W No Grom	\$377.00	45.00	\$207.35	\$1,866.15
		\$(L1STD)	Grd L1 Standard Laminates			Select Laminate	
		~	Undecided LAMINATE Option			Laminate Selection	
		~	Undecided EDGE Option			Select Edgeband Color	
34	9	HETP6560DP	Tackable Top Tier Glass Panel w/o TC 65H x 60W	\$882.00	45.00	\$485.10	\$4,365.90
		\$(A)	Gr A Fabric			Fabric Selection	
		~	Undecided FABRIC Option			Gr A Fab	
		\$(P1)	P1 Paint Opts			Select Paint Color	
		~	Undecided PAINT Option			Select Grade 1 Paint	
		~	Undecided GLASS Option			Select Glass	
35	9	HWV73AARP	Systems 60x36x24x24Rt Corner Cove Worksurface Edgebnd	\$750.00	45.00	\$412.50	\$3,712.50
		\$(L1STD)	Grd L1 Standard Laminates			Select Laminate	
		~	Undecided LAMINATE Option			Laminate Selection	
		~	Undecided EDGE Option			Select Edgeband Color	
		~	Undecided GROMMET Option			Select Grommet Color	
		DSASSEMBLY	Assembly/Set in Place/Removal of Debris	\$4,765.00		\$4,765.00	\$4,765.00
		PRJMGTFEE	Project Management Fee	\$545.14		\$545.14	\$545.14
		SALES TAX	Sales Tax 7.750%	\$2,976.40		\$2,976.40	\$2,976.40
						<b>Sub Total Sell</b>	<b>\$31,173.45</b>
						<b>Total Sell:</b>	<b>\$41,926.74</b>



Prepared For: Laurie Miller  
City of Beaumont  
550 E 6th Street

Quote Expires: 7/1/2022

Page 5 of 5  
6/3/2022

Beaumont CA 92223  
951-769-8520 x326

Quote # Q153362

City of Beaumont Bldg C KG 6.2.2022.visual.sp4

Sold By: Steve Noble

Prep. by: Karina Guevara

*Lead Time = 6-8 weeks | Finishes TBD | Rialto Bid #19-20-011*

Line#	Qty	Part #	Part Description	List	Discount	Sell	Extended Sell
-------	-----	--------	------------------	------	----------	------	---------------

There are NO refunds, returns, cancellations or exchange privileges on Special Orders. All orders over \$7,500.00 require a 50% deposit. Balance due is subject to normal payment terms and based on approved credit. Please review all specifications carefully before ordering and initial each page of this quotation. Some orders may require additional time due to production schedules and may exceed the time quoted. bluespace interiors cannot guarantee delivery from manufacturers by a certain date. A quoted date is an estimate and not a condition of sale. Installation and delivery to be performed during normal business hours unless otherwise quoted. Inside delivery and set up requires the receiving area to be prepared for the furniture installation. It is Customer's responsibility that the site be clean and free of debris prior to installation. An additional charge will be incurred if the area is not ready for delivery. Delays caused by the customer requiring storage will be billed at the current monthly pallet rate. In the event bluespace interiors' personnel remove or assist in removing existing furniture or equipment not provided in this proposal, Customer shall pay for this Service at the current rate and be separately invoiced. The decision to repair or replace any damaged or defective merchandise will be made by bluespace interiors and or the manufacturer.

**Acceptance of this proposal indicates acceptance of the above terms and conditions.**

Approved by: Name \_\_\_\_\_ Title \_\_\_\_\_

Date: \_\_\_\_\_