

PROPOSAL
MESA FENCE CO. INC

Date: 4-11-2022

Residential/ Ranch/ Commercial

1303 W. Oleander Ave, Perris, Ca. 92571

Cell-951-830-1696/Fax 657-1179

Lic. #954583

John Cooke

www.mesafenceco.com

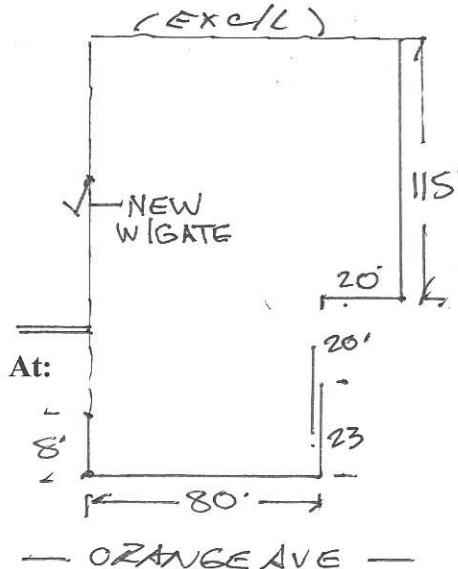

Proposal Submitted To:

Name Beaumont Police Department
Street 660 Orange Ave
City Beaumont
State CA
Phone 951-769-8500

Work To Be Performed At:

Street
City
State Ca
Date of Plans

We hereby propose to furnish the materials and perform the labor necessary for the completion of installing 8' & 2' tall iron fence as follows:

#1- Remove 850' existing 6' tall chain link fence and haul away. This would include installing 615' of temp fence next to the school.

TOTAL, \$ 3,800.00

#2- Install 911' of 8' tall straight spear top iron fence, with 1-4' man gate (next to building) and 1-16' roll gate (at alley). Cost would also include 251' of 2' tall iron fence, to match 8' fence, on top of walls and spear top fence on top of 2-25' roll gates.

TOTAL, \$ 85,743.00

Materials are as follows: 2 1/2" x 11 ga x 10' posts, set in concrete. Panels are 94" x 94" spear top (see attachment). All material is pre-galvanized and powder coated black. Panels are bolted to the posts with self-tapping screws. Fence on wall will be bolted to the top of the wall and gate height extension will be welded on. Complete job will take approximately 10 day to install.

ALTERNATE BID: Install 286' of 8' fence to match above, with 1-20' roll gate at adjacent parking lot. This would include bolting the posts to the concrete with galvanized flanges, welded to the posts. Gate track would be bolted to the concrete as well.

TOTAL, \$21,113.00

Totals include prevailing wages. (If not needed, please call for lower Totals.)

All material is guaranteed to be as specified, and the above work to be performed in accordance with the drawings and specifications submitted for above work and completed in a substantial workmanlike manner for the sum of:

Dollars \$ 110,656.00

With payments to be made as follows: NET 30 IF ACCEPTABLE, PLEASE SIGN AND RETURN. THANK YOU.

Any alteration or deviation from the above specifications involving extra costs, will be executed only upon written orders, and will become an extra charge over and above the estimate. All agreements are contingent upon strikes, accidents or delays beyond our control. Owner is to carry fire and all other liability insurance on above property. M.F.CO. Inc. is not responsible for damage to unmarked utilities, including sprinklers. Workmen's Compensation and Liability Insurance on above work to be taken out by: M.F.CO.INC

NOTICE: Cancellation of proposal must be given in writing no less than 1 week prior to work commencing. A 10% fee for restocking of material will be applied if notice is not given.

Respectfully submitted:

Per. MESA FENCE CO. INC.

NOTE- This proposal may be withdrawn by us if not accepted within: 15 days.

ACCEPTANCE OF PROPOSAL

The above prices, specifications and conditions are satisfactory and are hereby accepted. You are authorized to do work as specified. Payment will be made as outlined above.

Date _____

Signature _____

Signature _____