

**GENERAL NOTES:**

1. ALL STRUCTURAL STEEL, UNLESS OTHERWISE NOTED, SHALL BE ASTM A-36, MINIMUM YIELD STRENGTH 36,000 PSI.
2. ALL STRUCTURAL ALUMINUM MEMBERS, UNLESS OTHERWISE NOTED, SHALL BE OF ALLOY 6063-T5 OR GREATER.
3. ALL HOLES TO BE DRILLED OR PUNCHED.
4. STEEL WELDING SHALL CONFORM TO AMERICAN WELDING SOCIETY STANDARD D1. 1-10. ELECTRODES SHALL CONFORM TO AWS 5.1, CLASS E70S-5.
5. ALUMINUM WELDING SHALL CONFORM TO AMERICAN WELDING SOCIETY STANDARD D1. 2-08. ELECTRODES SHALL CONFORM TO AWS/SFA 5.10 CLASS ER4043.
6. ALL WELDING TO BE DONE AT TOLAR MANUFACTURING COMPANY, INC. FACILITY.
7. ALL CORPORATE PROCEDURES, INCLUDING FABRICATION, MUST BE IN COMPLIANCE WITH TOLAR MANUFACTURING CO. INC'S QUALITY CONTROL MANUAL
8. CONCRETE PAD SIZES SHOWN ARE STANDARD MINIMUM REQUIREMENTS AND ARE FOR REFERENCE ONLY. THE PAD MAY NEED TO BE REINFORCED OR ENLARGED DEPENDING ON LOCAL CODES AND LOADING CONDITIONS

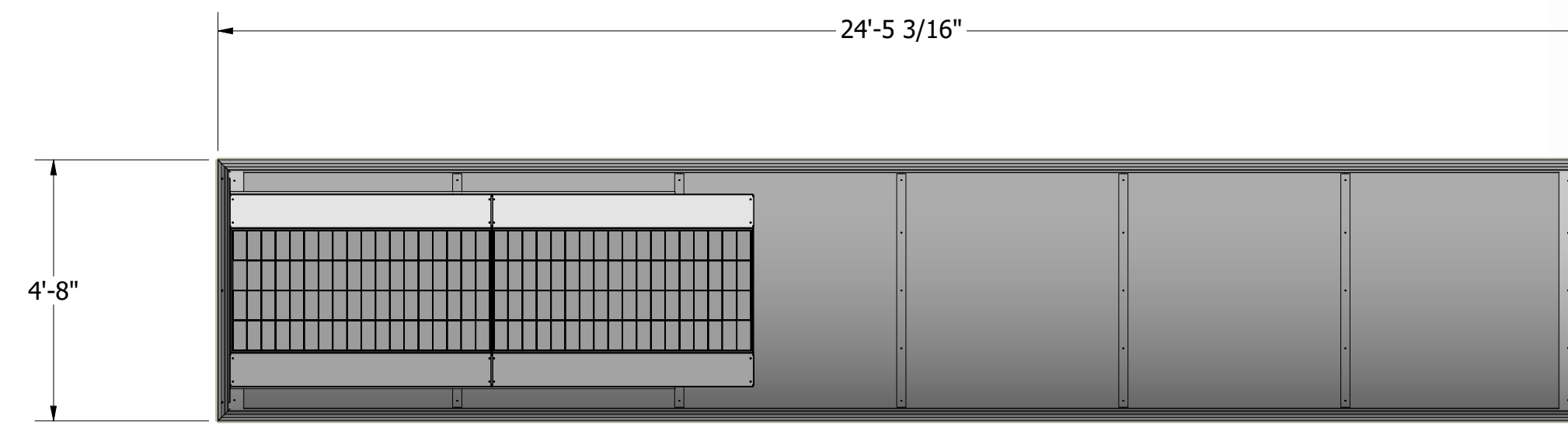

TOP VIEW  
SCALE 3/8"=1'-0"

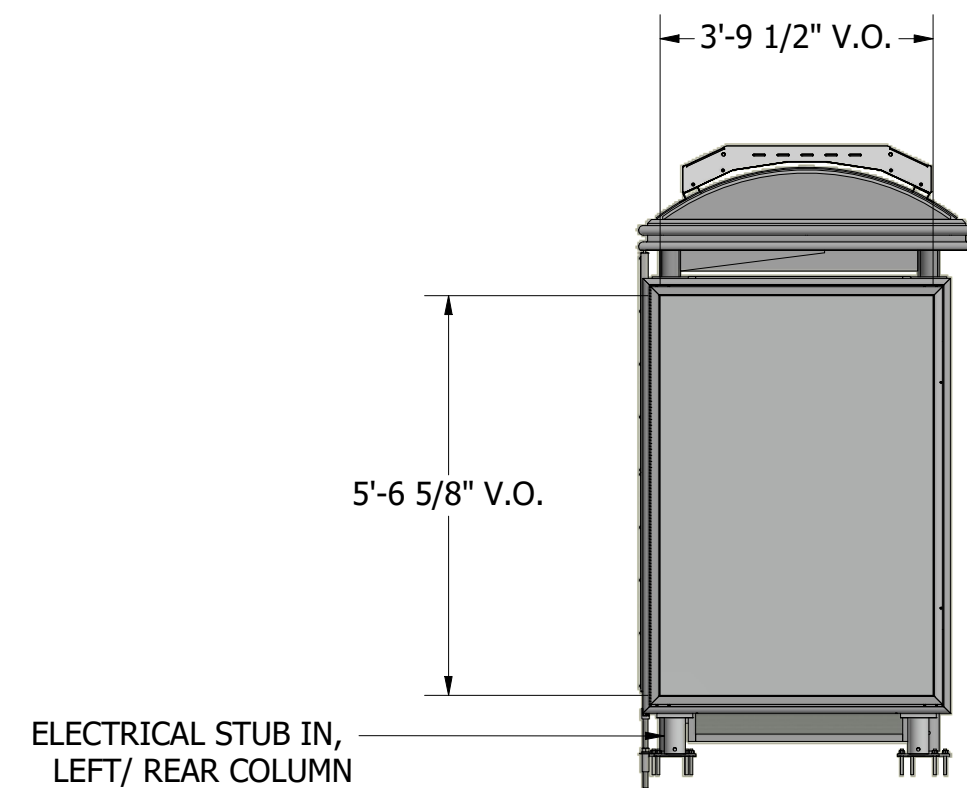
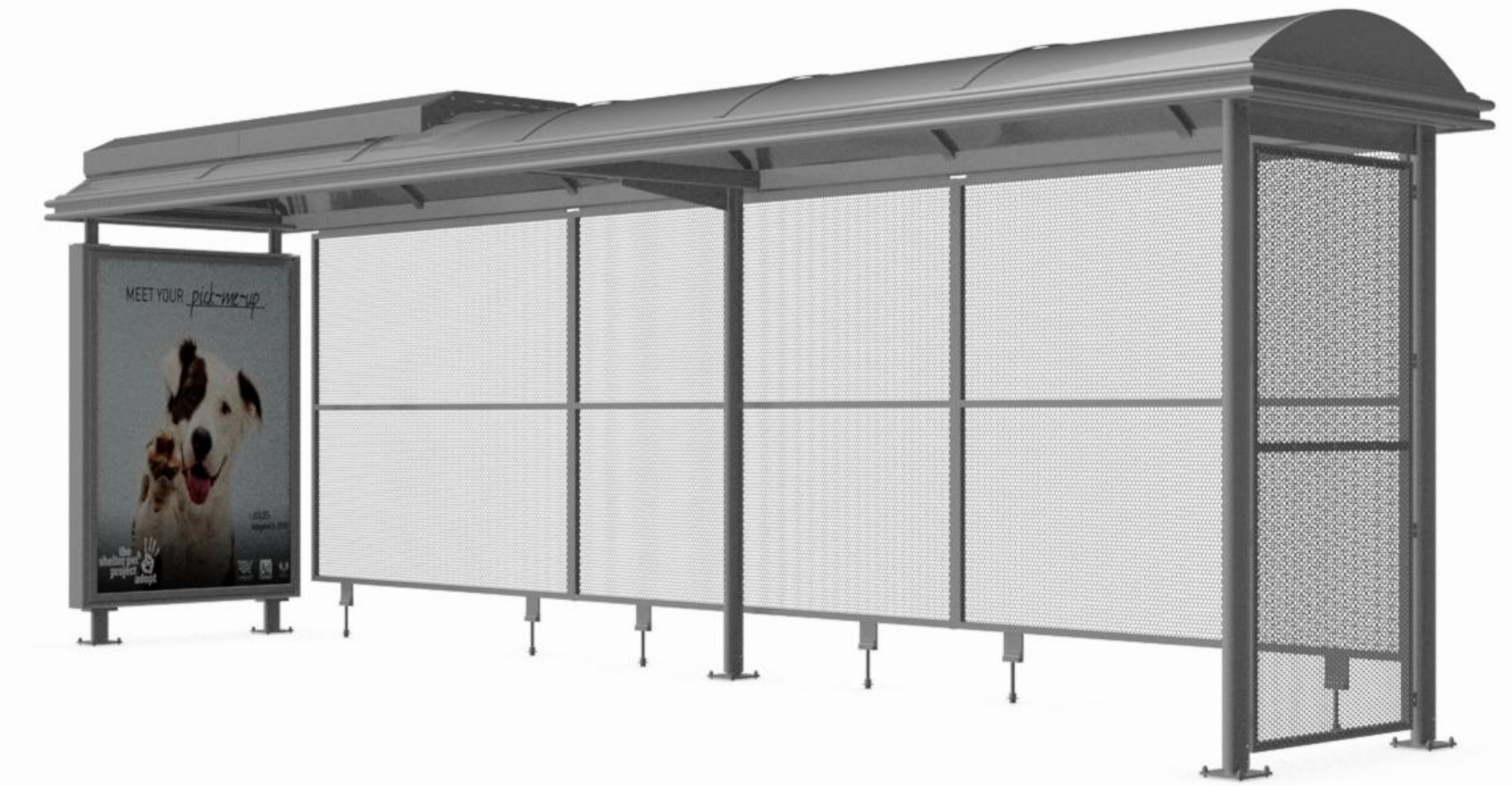

ELECTRICAL STUB IN,  
LEFT/ REAR COLUMN

SIDE VIEW  
SCALE 3/8"=1'-0"

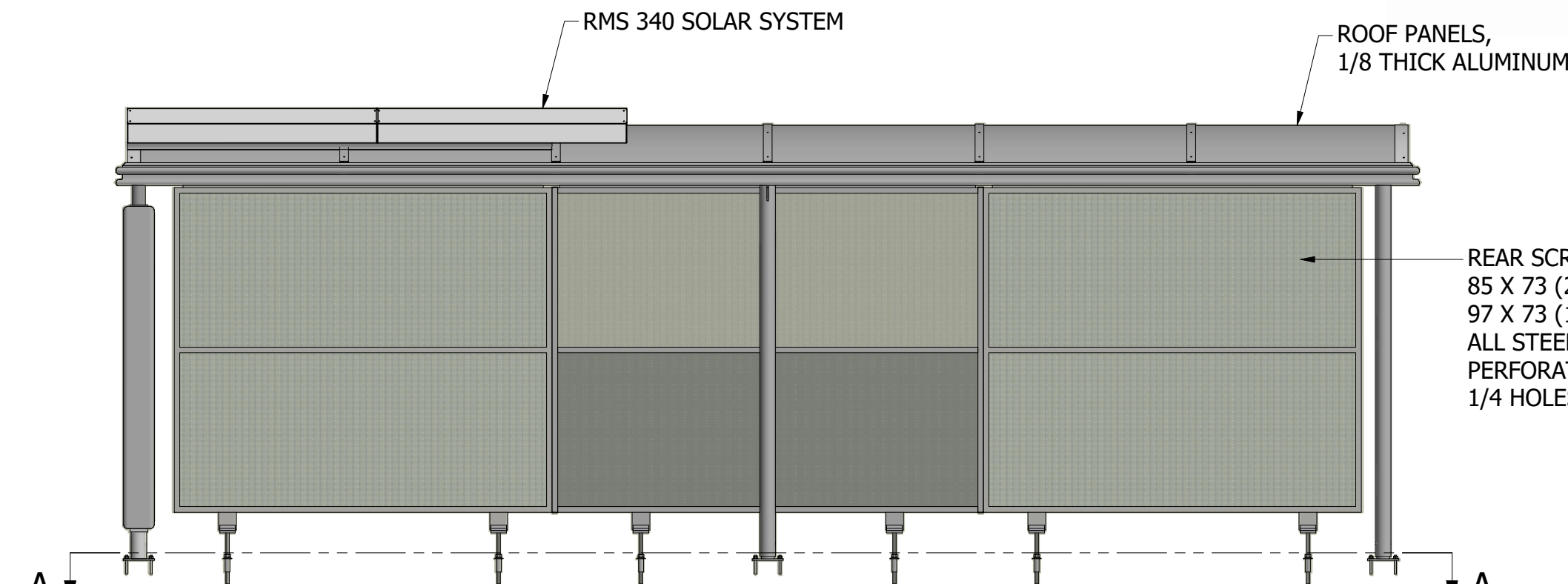

FRONT VIEW  
SCALE 3/8"=1'-0"

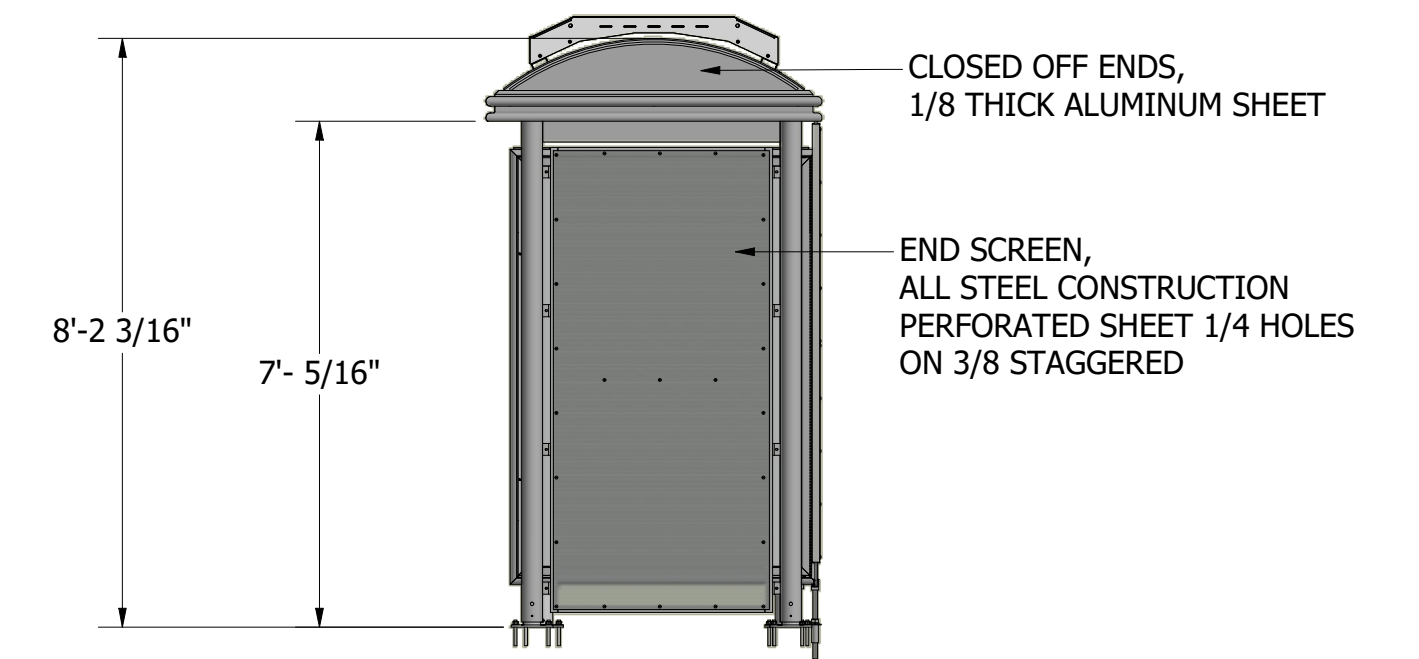

SIDE VIEW  
SCALE 3/8"=1'-0"

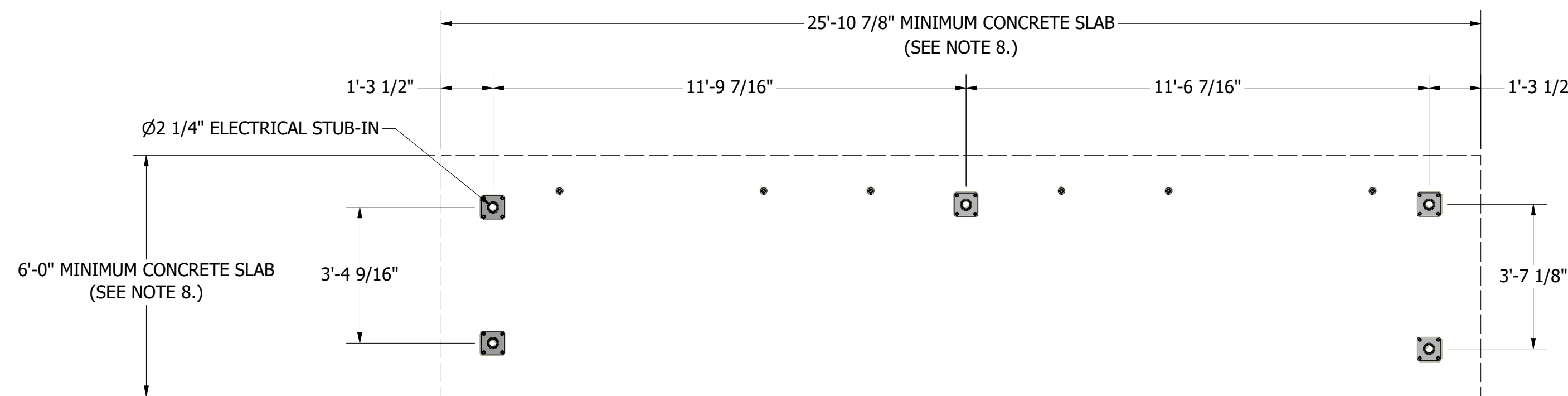

SECTION A-A  
FLOOR PLAN  
SCALE 3/8"=1'-0"

<p>THE DESIGN AND DRAWINGS REMAIN THE INTELLECTUAL PROPERTY OF TOLAR MFG. AND ARE PROTECTED BY LAW. THEY MAY NOT BE ALTERED, REPRODUCED OR USED FOR FABRICATION WITHOUT EXPRESSED WRITTEN CONSENT FROM TOLAR MFG. ALL DOCUMENTS TO BE RETURNED TO TOLAR MFG. AT COMPLETION OF WORK. CONTRACTOR TO SITE VERIFY ALL DETAILS AND DIMENSIONS AND REPORT ANY AND ALL DISCREPANCIES TO TOLAR MFG. BEFORE COMMENCING WITH THAT RELATED PORTION OF THE WORK.</p>				<p><b>TOLAR</b> TOLAR MANUFACTURING COMPANY, INC 258 Mariah Circle, Corona CA. 92879</p>	
<p>DESCRIPTION: 24'ADLDPM - SOLAR</p>					
<p>CUSTOMER/VENDOR: BEAUMONT, CA</p>				<p>PAGE: 1 of 1</p>	
SIZE: D	MATL: VARIES	DWG NO: 41041-00	REV: -		
SCALE: AS NOTED	DATE: 4/28/2021	DRAWN BY: RFarr			

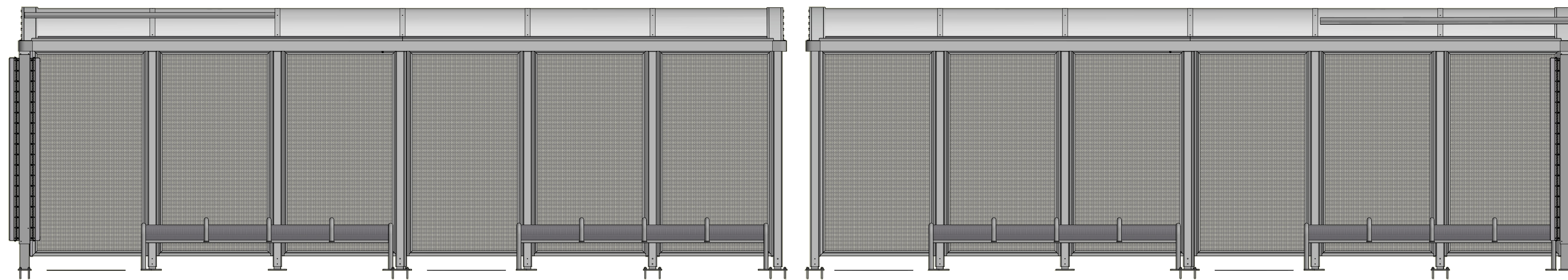

FRONT VIEW  
 41036-00 (LEFT) & 41037-00 (RIGHT)  
 SCALE 7/16"=1'-0"

THE DESIGN AND DRAWINGS REMAIN THE INTELLECTUAL PROPERTY OF TOLAR MFG. AND ARE PROTECTED BY LAW. THEY MAY NOT BE ALTERED, REPRODUCED OR USED FOR FABRICATION WITHOUT EXPRESSED WRITTEN CONSENT FROM TOLAR MFG. ALL DOCUMENTS TO BE RETURNED TO TOLAR MFG. AT COMPLETION OF WORK. CONTRACTOR TO SITE VERIFY ALL DETAILS AND DIMENSIONS AND REPORT ANY AND ALL DISCREPANCIES TO TOLAR MFG. BEFORE COMMENCING WITH THAT RELATED PORTION OF THE WORK.

<b>TOLAR</b>		<b>TOLAR MANUFACTURING COMPANY, INC</b>		258 Mariah Circle, Corona CA. 92879	
DESCRIPTION 24' AD LOW DOME NIAGARA SHELTER					
CUSTOMER/VENDOR		BEAUMONT, CA		PAGE: 2 of 2	
SIZE	MATL.	VARIES		DWG NO.	REV
D				41036-00	-
SCALE	AS NOTED	DATE	4/27/2021	DRAWN BY:	RFarr

**GENERAL NOTES:**

1. ALL STRUCTURAL STEEL, UNLESS OTHERWISE NOTED, SHALL BE ASTM A-36, MINIMUM YIELD STRENGTH 36,000 PSI.
2. ALL STRUCTURAL ALUMINUM MEMBERS, UNLESS OTHERWISE NOTED, SHALL BE OF ALLOY 6063-T5 OR GREATER.
3. ALL HOLES TO BE DRILLED OR PUNCHED.
4. STEEL WELDING SHALL CONFORM TO AMERICAN WELDING SOCIETY STANDARD D1. 1-10. ELECTRODES SHALL CONFORM TO AWS 5.1, CLASS E70S-5.
5. ALUMINUM WELDING SHALL CONFORM TO AMERICAN WELDING SOCIETY STANDARD D1. 2-08. ELECTRODES SHALL CONFORM TO AWS/SFA 5.10 CLASS ER4043.
6. ALL WELDING TO BE DONE AT TOLAR MANUFACTURING COMPANY, INC. FACILITY.
7. ALL CORPORATE PROCEDURES, INCLUDING FABRICATION, MUST BE IN COMPLIANCE WITH TOLAR MANUFACTURING CO. INC'S QUALITY CONTROL MANUAL
8. CONCRETE PAD SIZES SHOWN ARE STANDARD MINIMUM REQUIREMENTS AND ARE FOR REFERENCE ONLY. THE PAD MAY NEED TO BE REINFORCED OR ENLARGED DEPENDING ON LOCAL CODES AND LOADING CONDITIONS

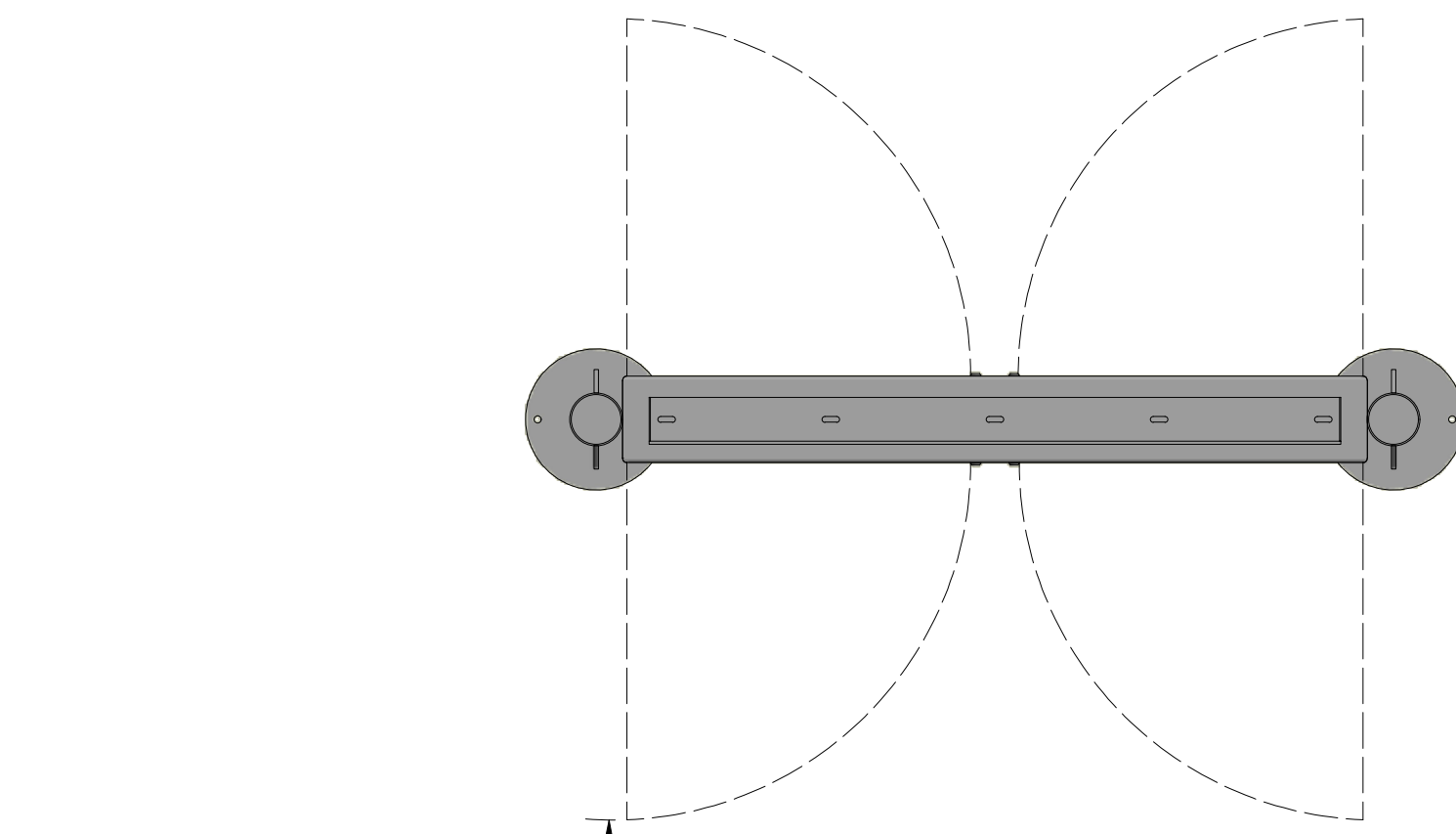

TOP VIEW  
SCALE 3/4"=1'-0"

R2'-6 7/16" DOORS SWING OUTWARDS

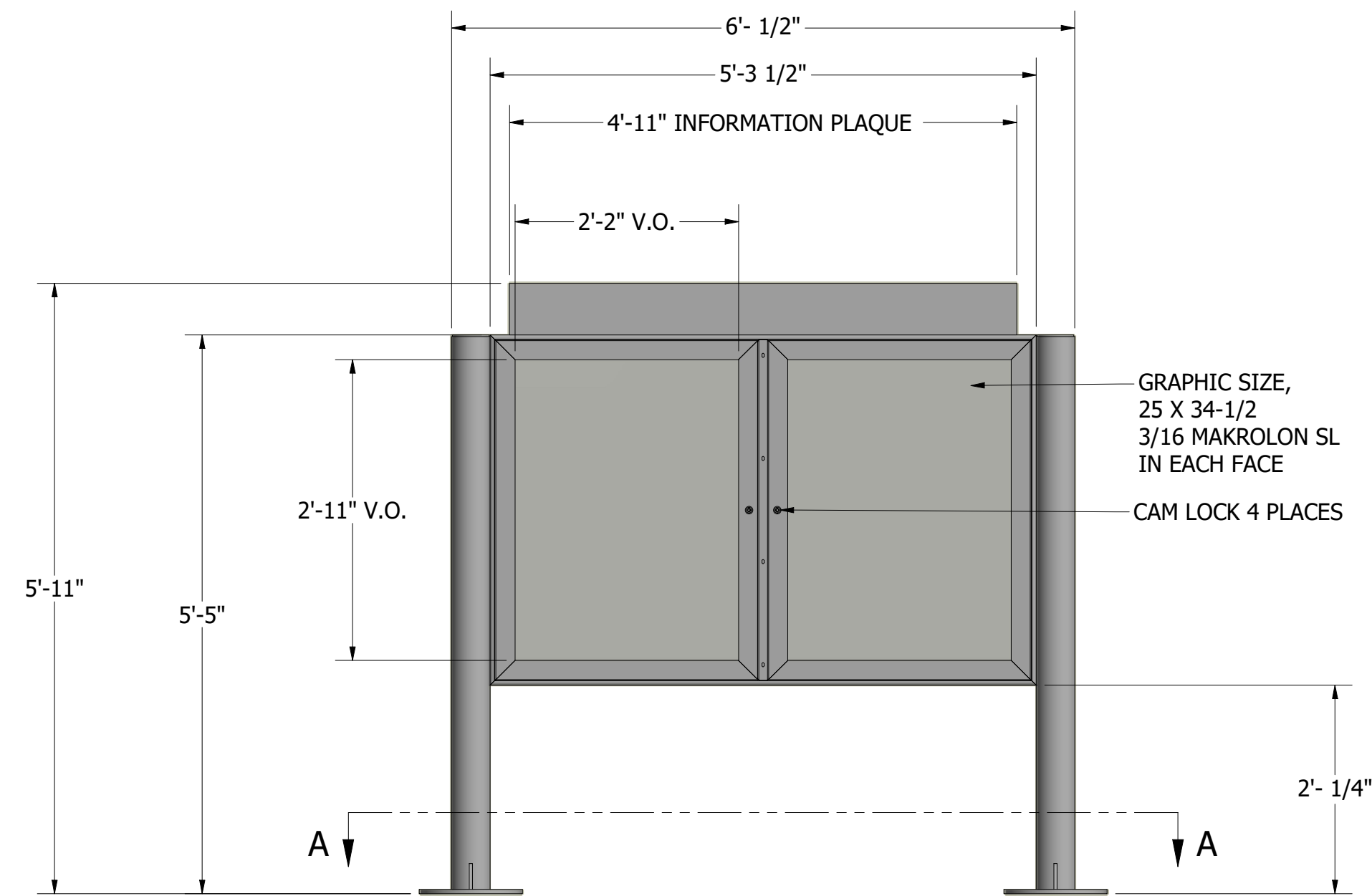

FRONT VIEW  
SCALE 3/4"=1'-0"

GRAPHIC SIZE,  
25 X 34-1/2  
3/16 MAKROLON SL  
IN EACH FACE

CAM LOCK 4 PLACES

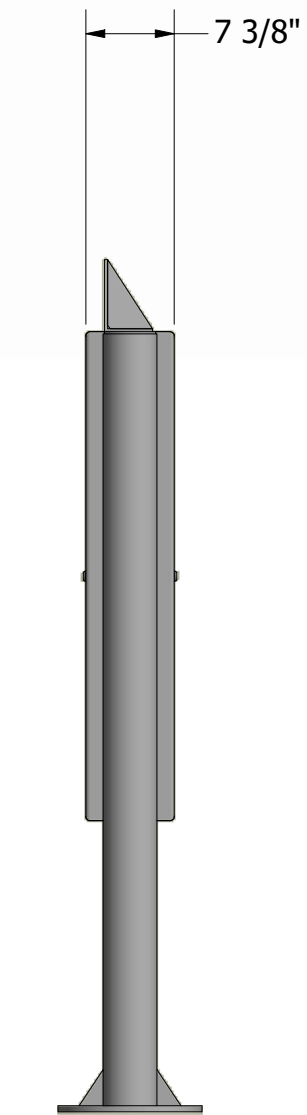

SIDE VIEW  
SCALE 3/4"=1'-0"

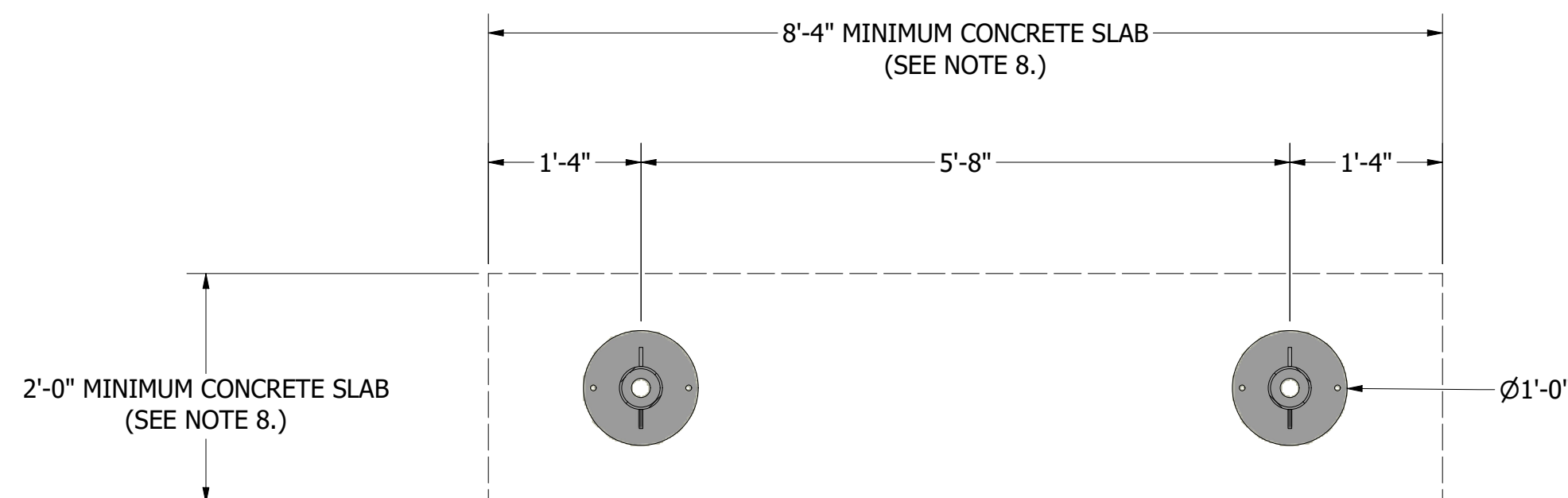

SECTION A-A  
SCALE 3/4"=1'-0"



THE DESIGN AND DRAWINGS REMAIN THE INTELLECTUAL PROPERTY OF TOLAR MFG. AND ARE PROTECTED BY LAW. THEY MAY NOT BE ALTERED, REPRODUCED OR USED FOR FABRICATION WITHOUT EXPRESSED WRITTEN CONSENT FROM TOLAR MFG.		TOLAR TOLAR MANUFACTURING COMPANY, INC 258 Mariah Circle, Corona CA. 92879	
DESCRIPTION FLAT FREE-STANDING KIOSK, 4 DOOR			
CUSTOMER/VENDOR BEAUMONT, CA		PAGE: 1 of 1	
SIZE D	MATL VARIES	DWG NO. 41047-00	REV -
SCALE AS NOTED	DATE 4/28/2021	DRAWN BY: RFarr	