

LIFT STATION NO. 16 RECONSTRUCTION

BAXTER, MINNESOTA

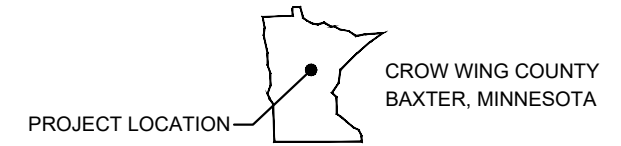

INDEX TO DRAWINGS

SHEET NO.	DESCRIPTION
1	TITLE SHEET
2	SITE PLAN - EXISTING CONDITIONS & DEMOLITION
3	SITE PLAN - PROPOSED IMPROVEMENTS
4	EXISTING PLAN VIEW - DEMOLITION
5	EXISTING SECTION VIEW - DEMOLITION
6	PROPOSED PLAN VIEW
7	PROPOSED SECTION VIEW

CITY OFFICIALS

MAYOR:	DARREL OLSON
CITY COUNCIL:	MARK CROSS CONNIE LYSCIO ZACK TABATT JOHN WARD
UTILITIES COMMISSION:	ROCK YLINIEMI - CHAIR JACK CHRISTOFFERSON DOUGLAS STENBERG JOHN BRENNY
CITY ADMINISTRATOR:	BRADLEY CHAPULIS
PUBLIC WORKS DIRECTOR / CITY ENGINEER:	TREVOR WALTER

APPROVALS

RECOMMENDED FOR APPROVAL _____	CITY CONSULTING ENGINEER	DATE _____
RECOMMENDED FOR APPROVAL _____	PUBLIC WORKS DIRECTOR / CITY ENGINEER	DATE _____

WIDSETH
ARCHITECTS • ENGINEERS • SCIENTISTS • SURVEYORS

MEMBER COUNTY AND THIS PLAN, SPECIFICATION OR REPORT WAS PREPARED BY ME OR UNDER MY DIRECT SUPERVISION AND THAT I AM A DULY LICENSED PROFESSIONAL ENGINEER UNDER THE LAWS OF THE STATE OF MINNESOTA.

BY: _____ DATE: _____

REVISIONS: _____

DATE: JUNE 2021 AS SHOWN

SCALE: _____ DRAWN BY: _____ CHECKED BY: _____

INITIALS _____

JOB NUMBER: 2022-10274

LIFT STATION 16 RECONSTRUCTION
CITY OF BAXTER
BAXTER

TITLE SHEET

SHEET NO. **1**

DATE: VALUE LC. NO. VALUE VALUE

W:\msn-mn\loc\files\Projects\City of Baxter-32232\2022-10274\CADD\Civil\C-TS-2022-10274.dwg Plotted by: Aric Welch 5/27/2022 10:15:16 AM © 2022 WIDSETH

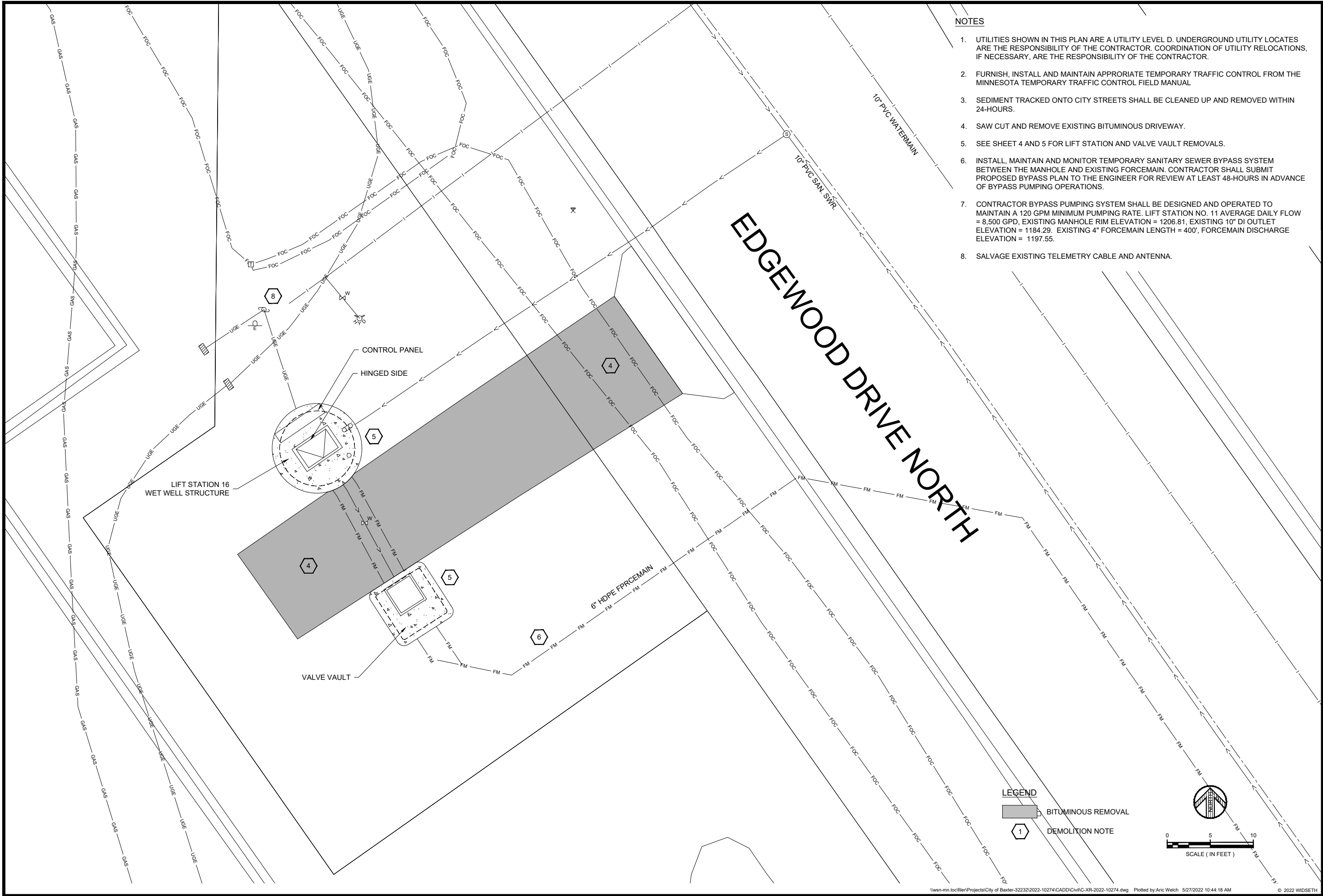

NOTES

1. UTILITIES SHOWN IN THIS PLAN ARE A UTILITY LEVEL D. UNDERGROUND UTILITY LOCATES ARE THE RESPONSIBILITY OF THE CONTRACTOR. COORDINATION OF UTILITY RELOCATIONS, IF NECESSARY, ARE THE RESPONSIBILITY OF THE CONTRACTOR.
2. FURNISH, INSTALL AND MAINTAIN APPROPRIATE TEMPORARY TRAFFIC CONTROL FROM THE MINNESOTA TEMPORARY TRAFFIC CONTROL FIELD MANUAL
3. SEDIMENT TRACKED ONTO CITY STREETS SHALL BE CLEANED UP AND REMOVED WITHIN 24-HOURS.
4. SAW CUT AND REMOVE EXISTING BITUMINOUS DRIVEWAY.
5. SEE SHEET 4 AND 5 FOR LIFT STATION AND VALVE VAULT REMOVALS.
6. INSTALL, MAINTAIN AND MONITOR TEMPORARY SANITARY SEWER BYPASS SYSTEM BETWEEN THE MANHOLE AND EXISTING FORCEMAIN. CONTRACTOR SHALL SUBMIT PROPOSED BYPASS PLAN TO THE ENGINEER FOR REVIEW AT LEAST 48-HOURS IN ADVANCE OF BYPASS PUMPING OPERATIONS.
7. CONTRACTOR BYPASS PUMPING SYSTEM SHALL BE DESIGNED AND OPERATED TO MAINTAIN A 120 GPM MINIMUM PUMPING RATE. LIFT STATION NO. 11 AVERAGE DAILY FLOW = 8,500 GPD, EXISTING MANHOLE RIM ELEVATION = 1206.81, EXISTING 10" DI OUTLET ELEVATION = 1184.29. EXISTING 4" FORCEMAIN LENGTH = 400', FORCEMAIN DISCHARGE ELEVATION = 1197.55.
8. SALVAGE EXISTING TELEMETRY CABLE AND ANTENNA.

LEGEND

-  BITUMINOUS REMOVAL
-  DEMOLITION NOTE

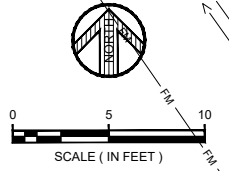

WIDSETH

ARCHITECTS • ENGINEERS • SCIENTISTS • SURVEYORS

DATE:	JUNE 2021	REVISIONS DESCRIPTION:		BY:	
SCALE:	AS SHOWN	DATE:		DATE:	06/16/2021
DRAWN BY:	INITIALS	DATE:		DATE:	
CHECKED BY:	INITIALS	DATE:		DATE:	
JOB NUMBER:	2022-10274	DATE:		DATE:	

LIFT STATION 16 RECONSTRUCTION

CITY OF BAXTER

BAXTER

EXISTING SITE PLAN

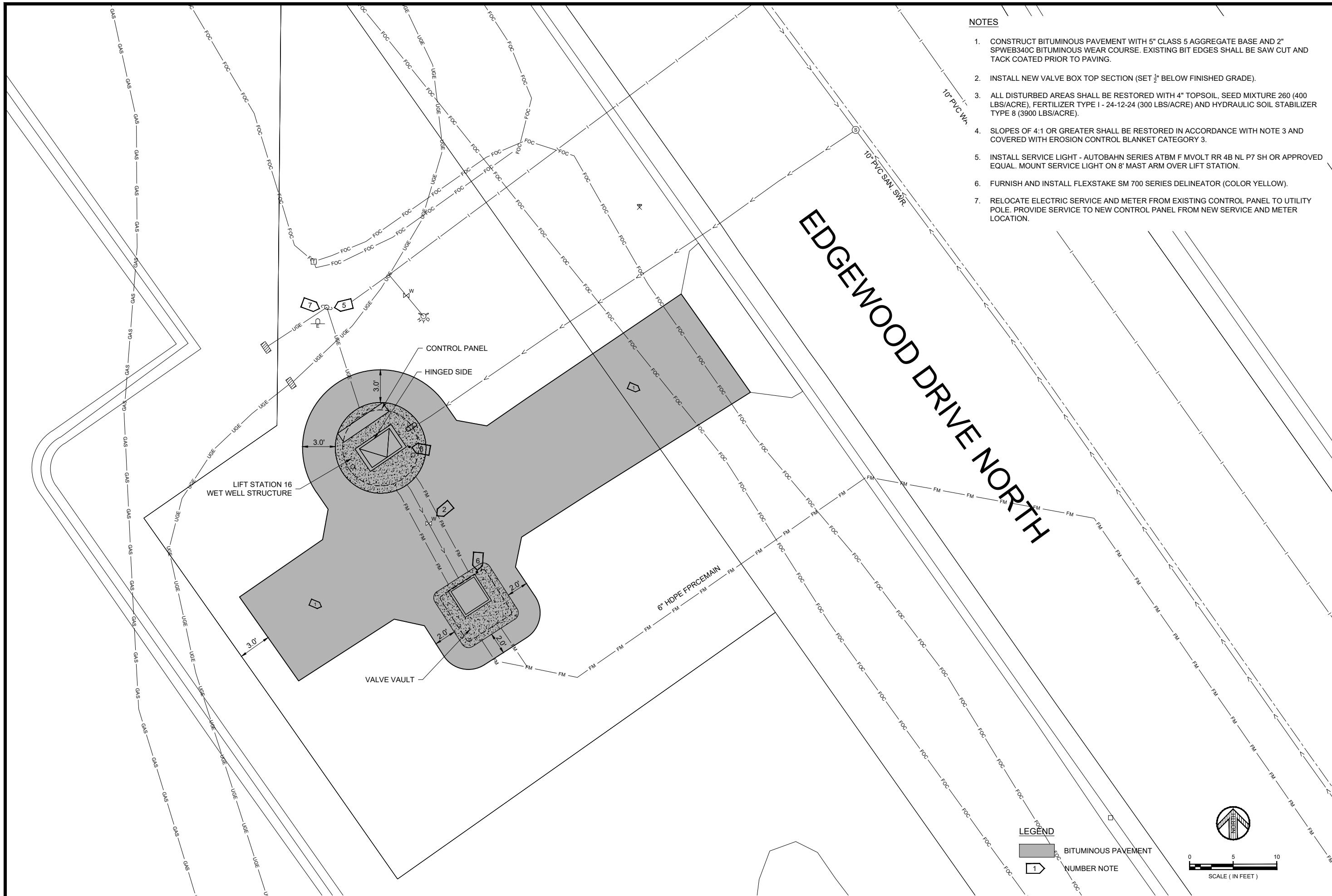

SHEET NO. **2**
© 2022 WIDSETH



NOTES

1. CONSTRUCT BITUMINOUS PAVEMENT WITH 5" CLASS 5 AGGREGATE BASE AND 2" SPWEB340C BITUMINOUS WEAR COURSE. EXISTING BIT EDGES SHALL BE SAW CUT AND TACK COATED PRIOR TO PAVING.
2. INSTALL NEW VALVE BOX TOP SECTION (SET 1/2" BELOW FINISHED GRADE).
3. ALL DISTURBED AREAS SHALL BE RESTORED WITH 4" TOPSOIL, SEED MIXTURE 260 (400 LBS/ACRE), FERTILIZER TYPE 1 - 24-12-24 (300 LBS/ACRE) AND HYDRAULIC SOIL STABILIZER TYPE 8 (3900 LBS/ACRE).
4. SLOPES OF 4:1 OR GREATER SHALL BE RESTORED IN ACCORDANCE WITH NOTE 3 AND COVERED WITH EROSION CONTROL BLANKET CATEGORY 3.
5. INSTALL SERVICE LIGHT - AUTOBAHN SERIES ATBM F MVOLT RR 4B NL P7 SH OR APPROVED EQUAL. MOUNT SERVICE LIGHT ON 8' MAST ARM OVER LIFT STATION.
6. FURNISH AND INSTALL FLEXSTAKE SM 700 SERIES DELINEATOR (COLOR YELLOW).
7. RELOCATE ELECTRIC SERVICE AND METER FROM EXISTING CONTROL PANEL TO UTILITY POLE. PROVIDE SERVICE TO NEW CONTROL PANEL FROM NEW SERVICE AND METER LOCATION.

LEGEND

-  BITUMINOUS PAVEMENT
-  NUMBER NOTE

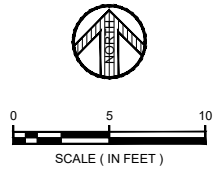

WHEREBY CERTIFY THAT THIS PLAN, SPECIFICATION OR REPORT WAS PREPARED BY ME OR UNDER MY DIRECT SUPERVISION AND THAT I AM A DULY LICENSED PROFESSIONAL ENGINEER UNDER THE LAWS OF THE STATE OF MINNESOTA.
DATE: 06/16/2021 LIC. NO. VALUE

DATE	REVISION DESCRIPTION

DATE: JUNE 2021	AS SHOWN
SCALE: AS SHOWN	INITIALS
DRAWN BY: BAXTER	CHECKED BY: BAXTER
JOB NUMBER: 2022-10274	DATE: 06/16/2021

LIFT STATION 16 RECONSTRUCTION
CITY OF BAXTER
BAXTER
PROPOSED SITE PLAN

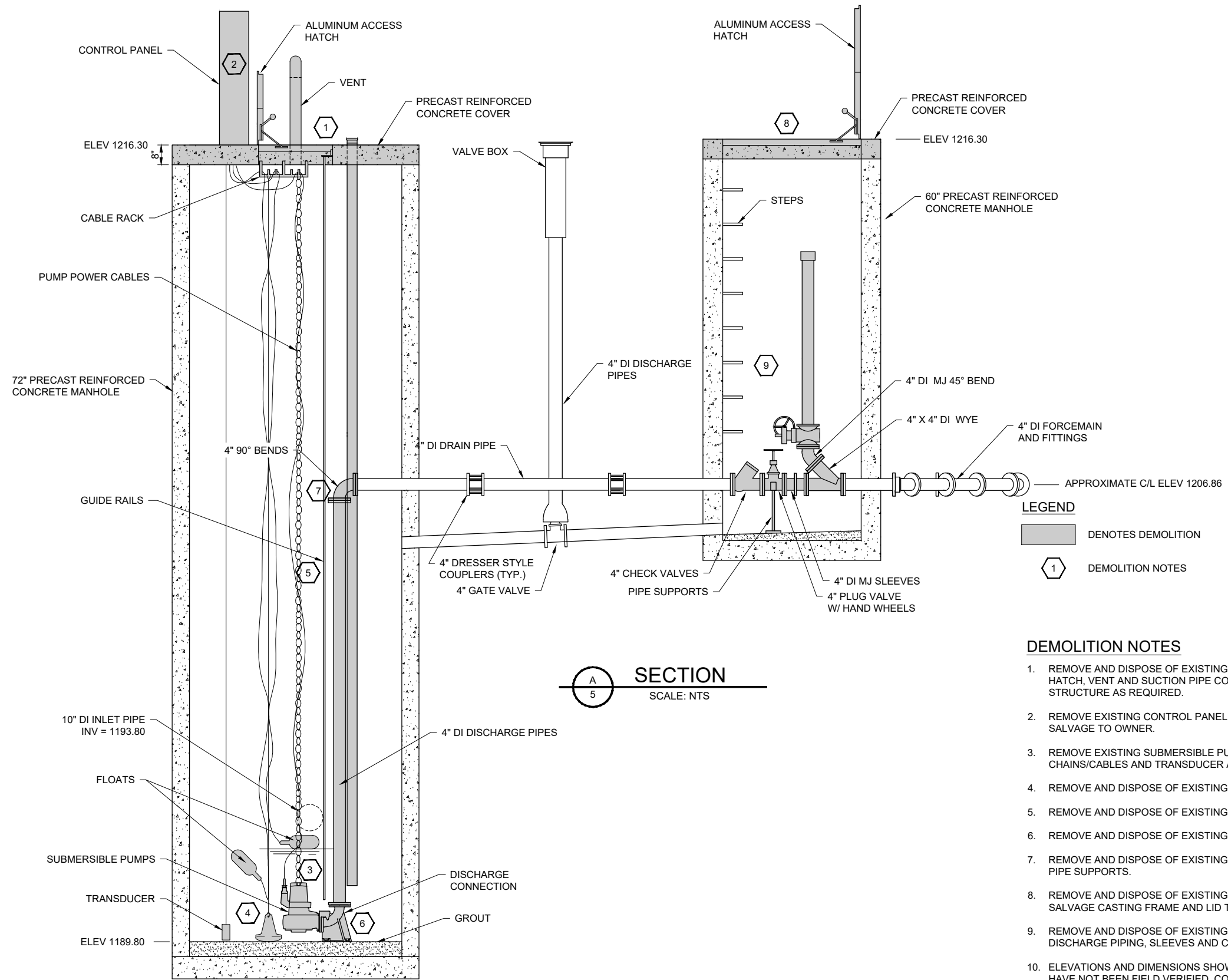

SECTION
SCALE: NTS

LEGEND

- DENOTES DEMOLITION
- DEMOLITION NOTES

DEMOLITION NOTES

1. REMOVE AND DISPOSE OF EXISTING LIFT STATION COVER, ALUMINUM ACCESS HATCH, VENT AND SUCTION PIPE CONNECTION. EXCAVATE AROUND STRUCTURE AS REQUIRED.
2. REMOVE EXISTING CONTROL PANEL AND RELATED COMPONENTS AND SALVAGE TO OWNER.
3. REMOVE EXISTING SUBMERSIBLE PUMPS, POWER CABLES, LIFT CHAINS/CABLES AND TRANSDUCER AND SALVAGE TO OWNER.
4. REMOVE AND DISPOSE OF EXISTING ANCHOR, CABLE AND FLOATS.
5. REMOVE AND DISPOSE OF EXISTING PUMP GUIDE SYSTEM AND SUPPORTS.
6. REMOVE AND DISPOSE OF EXISTING PUMP BASE ELBOWS.
7. REMOVE AND DISPOSE OF EXISTING 4" DISCHARGE PIPING, 4" 90° BENDS AND PIPE SUPPORTS.
8. REMOVE AND DISPOSE OF EXISTING CONCRETE VALVE VAULT COVER AND SALVAGE CASTING FRAME AND LID TO OWNER.
9. REMOVE AND DISPOSE OF EXISTING 4" CHECK VALVE, 4" PLUG VALVES, 4" DISCHARGE PIPING, SLEEVES AND COUPLINGS.
10. ELEVATIONS AND DIMENSIONS SHOWN ON THE PLAN ARE APPROXIMATE AND HAVE NOT BEEN FIELD VERIFIED. CONTRACTOR SHALL FIELD VERIFY EXISTING DISCHARGE PIPING SPACING AND ELEVATIONS PRIOR TO PRECAST SHOP DRAWING SUBMITTAL.

THIS DOCUMENT IS THE PROPERTY OF WIDSETH ARCHITECTS, ENGINEERS, SCIENTISTS & SURVEYORS. IT IS TO BE USED ONLY FOR THE PROJECT AND SITE SPECIFICALLY IDENTIFIED HEREIN. ANY REUSE OR MODIFICATION OF THIS DOCUMENT WITHOUT THE WRITTEN CONSENT OF WIDSETH ARCHITECTS, ENGINEERS, SCIENTISTS & SURVEYORS IS STRICTLY PROHIBITED. THE USER AGREES TO HOLD WIDSETH ARCHITECTS, ENGINEERS, SCIENTISTS & SURVEYORS HARMLESS FROM ANY AND ALL CLAIMS, DAMAGES, LOSSES AND EXPENSES, INCLUDING REASONABLE ATTORNEY'S FEES, ARISING OUT OF OR RESULTING FROM THE USE OF THIS DOCUMENT.

REV#	DATE	DESCRIPTION

DATE: JUNE 2021	SCALE: AS SHOWN	DRAWN BY: INITIALS	CHECKED BY: INITIALS	JOB NUMBER: 2022-10274
-----------------	-----------------	--------------------	----------------------	------------------------

LIFT STATION 16 RECONSTRUCTION
CITY OF BAXTER
BAXTER
DEMO SECTION

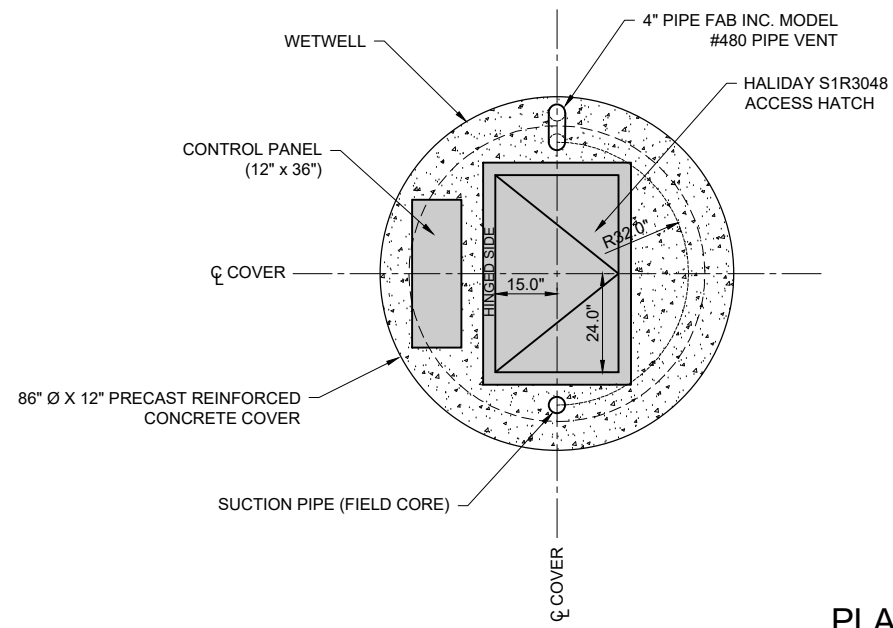

PLAN VIEW - TOP
SCALE: 1/4" = 1'-0"

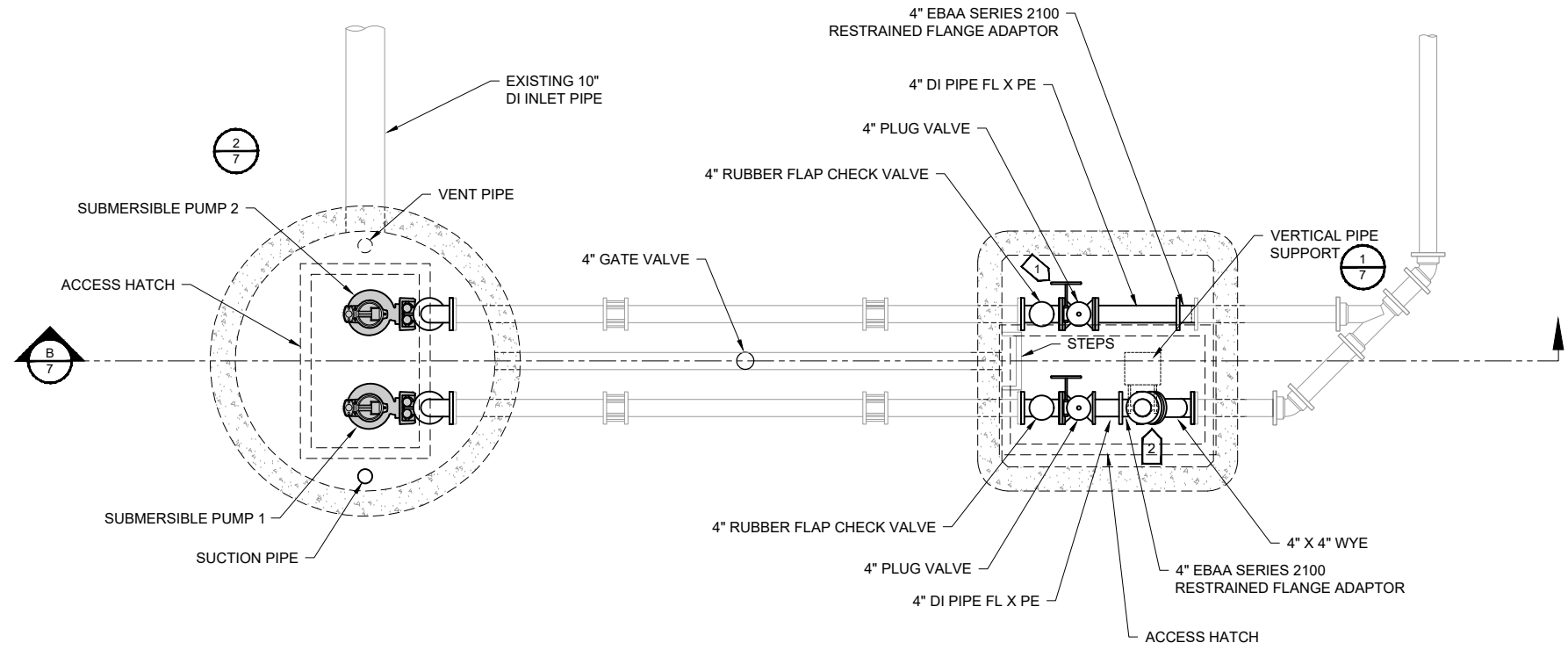
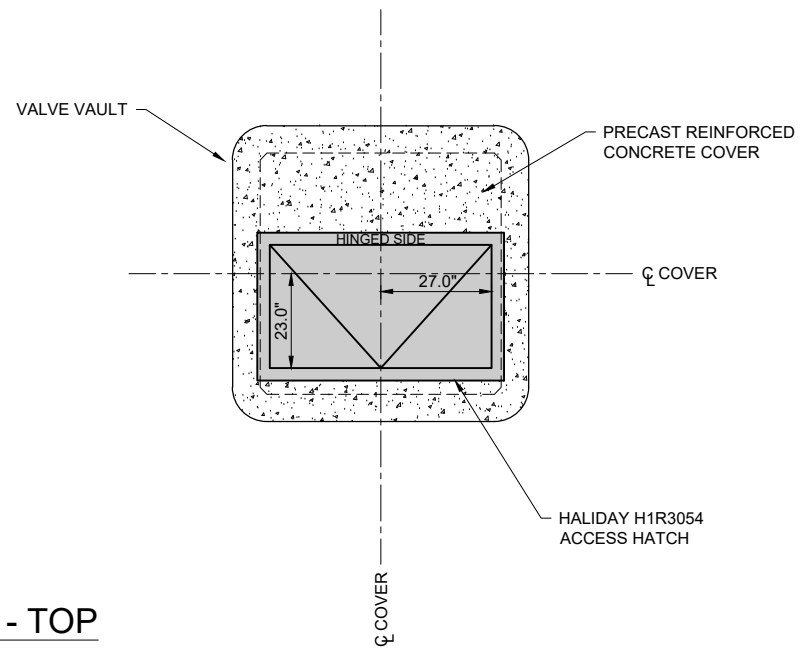

PLAN VIEW - INSIDE STRUCTURE
SCALE: 1/4" = 1'-0"

- LEGEND**
- ITEMS SUPPLIED BY OWNER AND INSTALLED BY CONTRACTOR
 - CONSTRUCTION NOTES (SEE SHEET 7)

WIDSETH

ARCHITECTS • ENGINEERS • SCIENTISTS • SURVEYORS

MINNESOTA PROFESSIONAL ENGINEERING BOARD REPORT NO. 2022-10274
THIS REPORT WAS PREPARED BY ME OR UNDER MY DIRECT SUPERVISION AND I AM A DULY LICENSED PROFESSIONAL ENGINEER UNDER THE LAWS OF THE STATE OF MINNESOTA.

DATE: 06/16/2021 LIC. NO. VALUE

REVISIONS DESCRIPTION	DATE	REV#	BY

DATE: JUNE 2021	SCALE: AS SHOWN	DRAWN BY: INITIALS	CHECKED BY: INITIALS	JOB NUMBER: 2022-10274

LIFT STATION 16 RECONSTRUCTION
CITY OF BAXTER
BAXTER
PROPOSED PLAN

6

SHEET NO.

