

LEGEND

	MEDIUM DUTY ASPHALT PMT. (80,000 ESALs)
	MEDIUM/HEAVY DUTY TRAFFIC REINFORCED CONCRETE PAVEMENT SEE SECTION BELOW
	PERVIOUS PAVER
	CONCRETE SIDEWALK
	ALTERNATE A9 PERVIOUS PAVER
	PROPOSED FIRE LANE STRIPING

NOTES:

- CONTRACTOR TO REFER TO THE GEOTECHNICAL REPORT, PROJECT NO. AA42-108-02, DATED DECEMBER 7, 2021 FOR RECOMMENDATIONS FOR PAVEMENT DESIGN, JOINT SPACING AND SUBGRADE PREPARATION BY RABA KISTNER CONSULTANTS, INC. CONTRACTOR IS ALSO RESPONSIBLE TO VERIFY THAT THE REPORT HAS NOT BEEN MODIFIED PRIOR TO CONSTRUCTION.
- PER THE GEOTECH REPORT, THE CONTRACTOR MAY ELECT TO CONSTRUCT PARKING SPACES WITH LIGHT DUTY ASPHALT PAVEMENT. HOWEVER, DRIVEWAYS, DRIVE AISLES AND CHANNELED TRAFFIC AREAS MUST BE CONSTRUCTED OF MEDIUM DUTY ASPHALT PAVEMENT. THE BUS LOOP AND BUS ENTRY DRIVE MUST BE CONSTRUCTED OF HEAVY DUTY ASPHALT PAVEMENT.
- CONTRACTOR SHALL BE RESPONSIBLE FOR PLACING ALL SLEEVES FOR WET AND DRY UTILITIES PRIOR TO POURING CONCRETE.
- SEE SHEET C303&C304 FOR PAVING, AND STRIPING DETAILS.
- MAXIMUM CROSS SLOPE ON SIDEWALKS SHALL BE 2% MAXIMUM AND 5% RUNNING SLOPE. RUNNING SLOPE ON CURB RAMPS SHALL BE 8.33% MAXIMUM WITH 2% MAXIMUM CROSS SLOPE. CONTRACTOR SHALL VERIFY GRADES PRIOR TO POURING CONCRETE.
- GROUND SURFACES ALONG ACCESSIBLE ROUTES MUST BE STABLE, FIRM, AND SLIP RESISTANT.

FAYETTE STREET

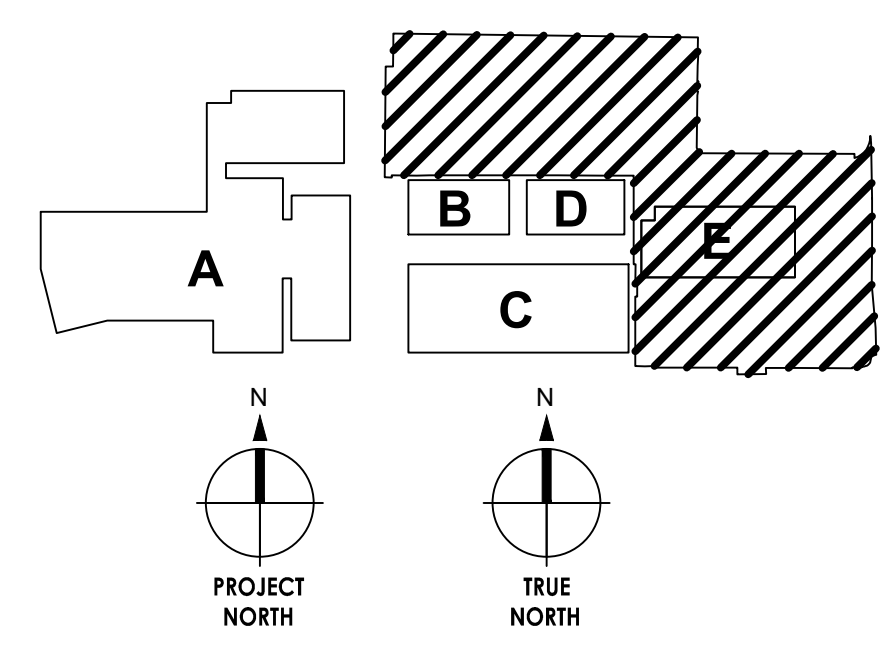
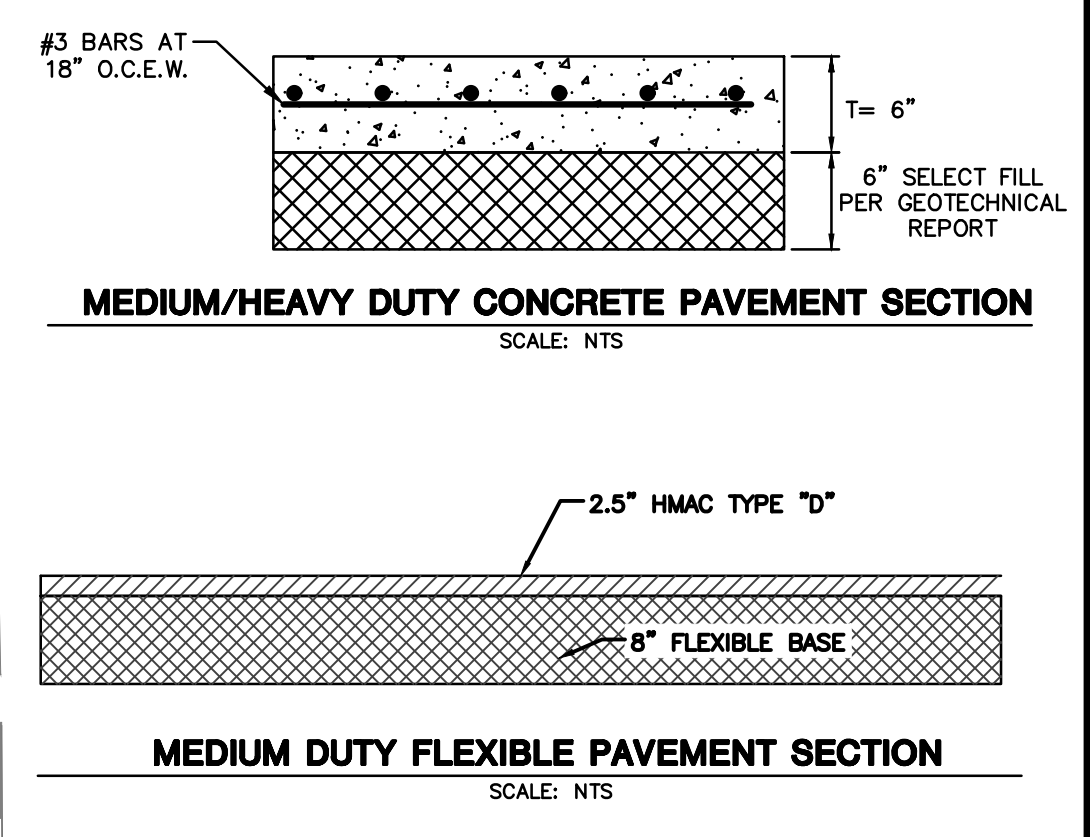

Revision	By	App'd	YYYYMMDD

Issued	By	App'd	YYYYMMDD

Permit/Seal



Client/Project
BASTROP ISD

MINA ES ADDITIONS AND RENOVATIONS
1203 Hill St
Bastrop, TX 78602
Title

PAVING & STRIPING PLAN
Approved Copy
wing No.
C301

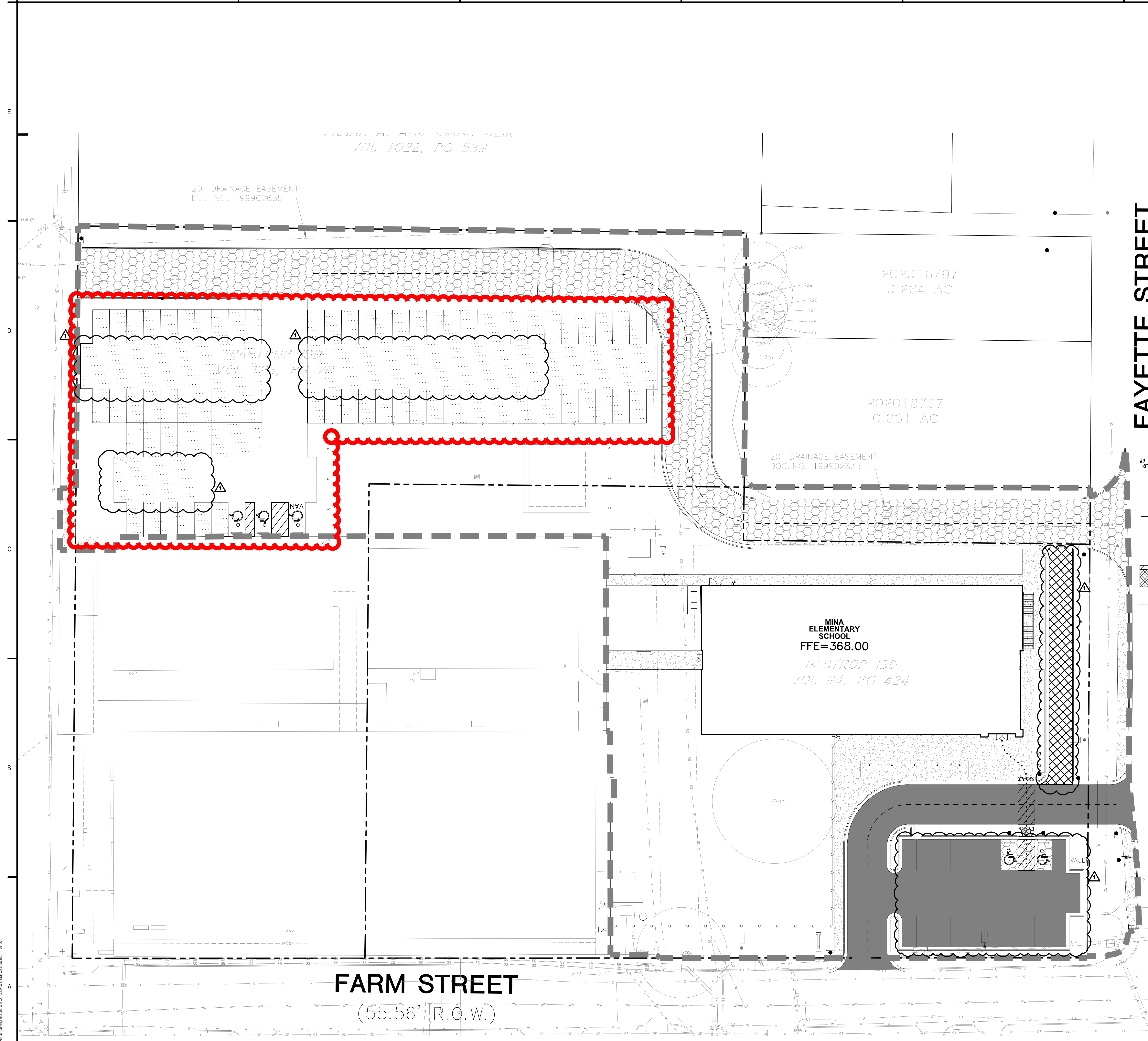

11/18/2022 10:52 AM
 C:\Users\mike.gerhart\OneDrive\Documents\Projects\2022\Bastrop\Bastrop_ISD_Paving_Stripping_Plan.dwg
 20220822 10:52 AM
 ORIGINAL SHEET ARCH01

THE LOCATION OF EXISTING UNDERGROUND UTILITIES SHOULD BE DETERMINED PRIOR TO ANY CONSTRUCTION. THE CONTRACTOR SHALL BE RESPONSIBLE FOR ANY AND ALL DAMAGE TO EXISTING UTILITIES. CALL 811 PRIOR TO ANY CONSTRUCTION.