

This document, together with the concepts and designs presented herein, is an instrument of service, is intended only for the specific purpose and client for which it was prepared. Reuse of and improper reliance on this document without written authorization and adaptation by Kinley-Horn and Associates, Inc. shall be without liability to Kinley-Horn and Associates, Inc.



PROPOSED GRADE LINE

EXISTING GRADE LINE

DORAYTON-PARKER COMPANIES, LLC.
17 WEST McDONOUGH STREET
SAVANNAH, GEORGIA 31401
PHONE: 912-231-1001

[illegible]

RICHMOND COUNTY, GEORGIA
PARCEL ID: 157 0008 010, 157 0007 000, & 157 0008 000



SHEET NUMBER
C4-51

Drawing name: K:\SAV_Civil\01477400_Pecan\01477400_01 - SANITARY SEWER PROFILES.dwg C4-52 FORCE MAIN PROFILE Jul 14, 2023 11:08am by: david.smith

This document, together with the concepts and designs presented herein, is an instrument of service, is intended only for the specific purpose and client for which it was prepared. Reuse of and improper reliance on this document without written authorization and adaptation by Kimley-Horn and Associates, Inc. shall be without liability to Kimley-Horn and Associates, Inc.

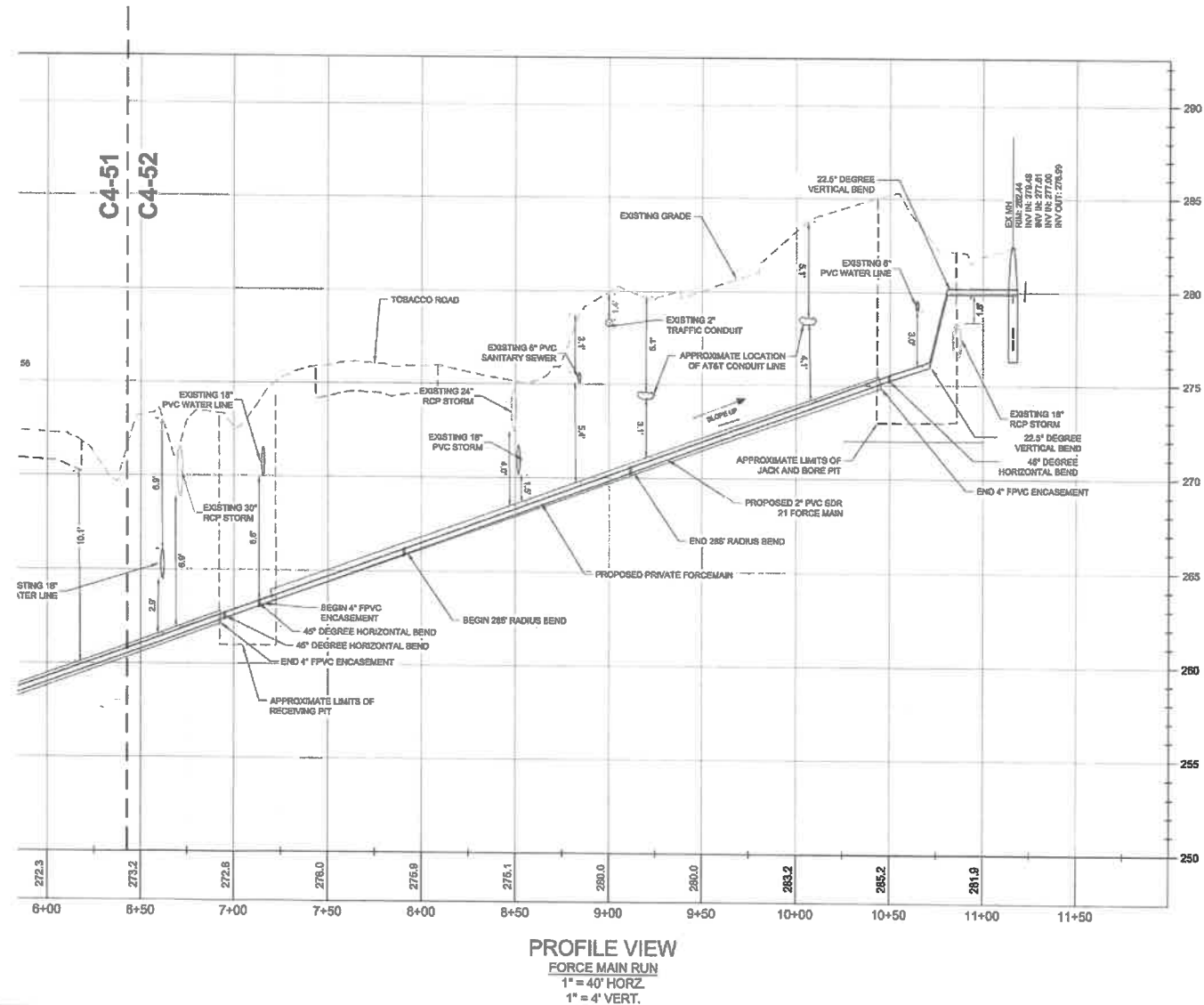
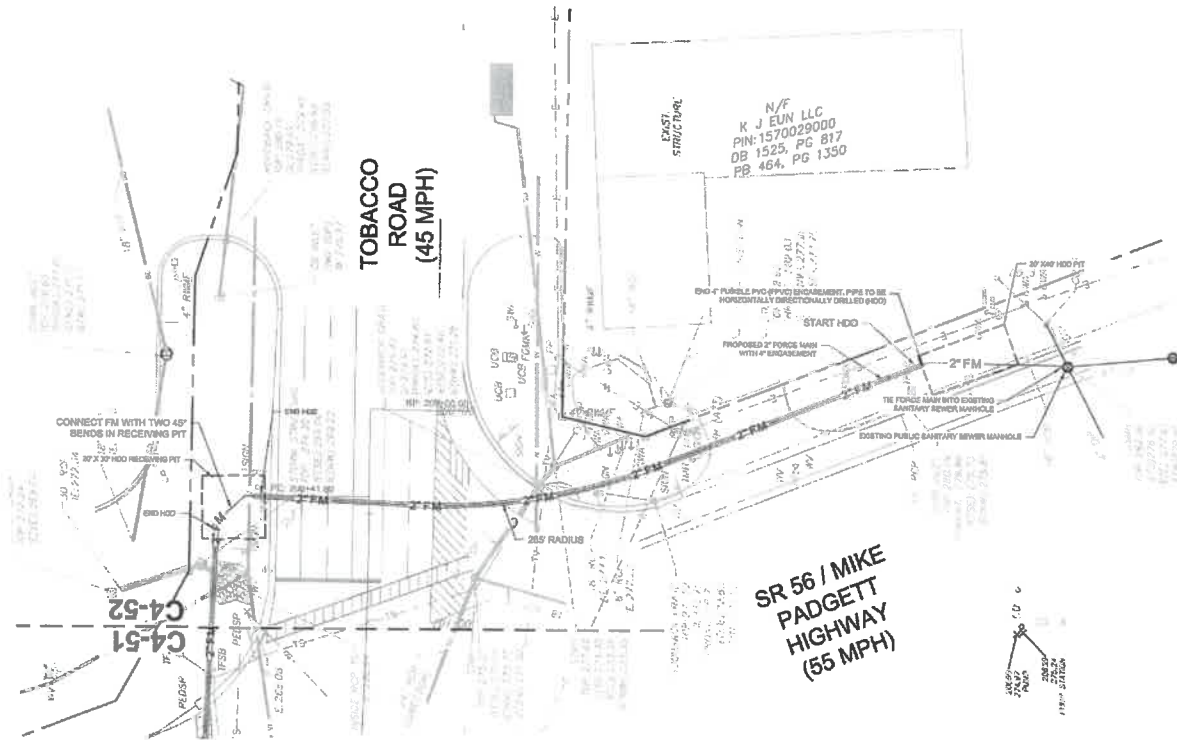

SANITARY SEWER PROFILE NOTES:

1. LOCATION OF UTILITIES ARE SHOWN BASED ON UTILITY LOCATE FROM BADGER DAYLIGHTING ON 03/01/2023.
2. ALL PIPE LENGTHS SPECIFIED IN THESE PLANS ARE THE HORIZONTAL DISTANCE AND ARE SHOWN FOR REFERENCE ONLY. IT IS THE RESPONSIBILITY OF THE CONTRACTOR TO DETERMINE ACTUAL LENGTHS BASED ON PROPOSED PIPE SLOPE. PIPE LENGTHS IN PLANS ARE MEASURED FROM CENTER OF STRUCTURE TO CENTER OF STRUCTURE UNLESS OTHERWISE NOTED.
3. CONTRACTOR TO FIELD VERIFY EXISTING INVERT FOR SANITARY SEWER SERVICE CONNECTIONS PRIOR TO CONSTRUCTION. CONTRACTOR SHALL NOTIFY ENGINEER OF DISCREPANCY PRIOR TO PROCEEDING.
4. CONTRACTOR TO LOCATE UTILITIES PRIOR TO CONSTRUCTION.
5. ALL SANITARY SEWER PIPE SHALL BE INSTALLED PER CITY OF AUGUSTA STANDARDS AND SPECIFICATIONS.
6. IF ANY CONFLICTS, DISCREPANCIES, OR ANY OTHER UNSATISFACTORY CONDITIONS ARE DISCOVERED, EITHER ON THE CONSTRUCTION DOCUMENTS OR FIELD CONDITIONS, THE CONTRACTOR MUST NOTIFY THE ENGINEER IMMEDIATELY AND SHALL NOT COMMENCE FURTHER OPERATION UNTIL THE CONFLICTS, DISCREPANCIES, OR OTHER UNSATISFACTORY CONDITIONS ARE RESOLVED.

PROFILE LINE LEGEND:

- PROPOSED GRADE LINE
- - - - - EXISTING GRADE LINE

EXHIBIT A-2

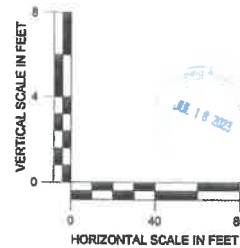

Kimley»Horn

Kimley-Horn and Associates, Inc.

SAVANNAH, GEORGIA 31401

PHONE (910) 231-4384

WWW.KIMLEY-HORN.COM

Parker's kitchen

DRAYTON-PARKER COMPANIES, LLC.

17 WEST McDONOUGH STREET

SAVANNAH, GEORGIA 31401

PHONE 912-281-1001

PROJECT

PARKER'S - SR 56 & TOBACCO ROAD

CITY OF AUGUSTA

RECONSTRUCTION, GEORGIA

PARCEL ID: 10 0000 NW, 10 0000 SW, 10 0000 SE, 10 0000 NE

PROFESSIONAL SEAL

NO. 1000000000

DATE 07/17/2023

PROJECT NO. 014774010

TITLE

FORCE MAIN PROFILE

SHEET NUMBER

C4-52

This document, together with the concepts and designs presented herein, as an instrument of service, is intended only for the specific purpose and client for which it was prepared. Ruses of and improper reliance on this document without written authorization and adaptation by Kimley-Horn and Associates, Inc. shall be without liability to Kimley-Horn and Associates, Inc.

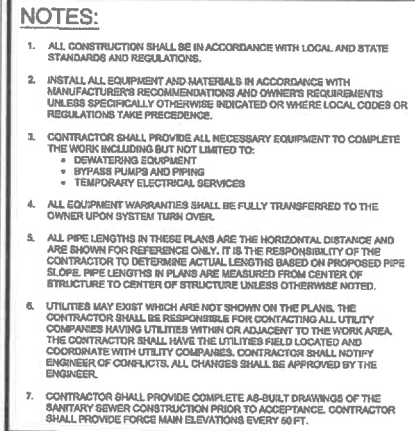
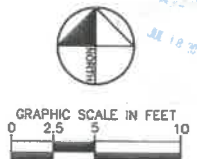

EXHIBIT A-3

[illegible]

PARKER'S - SR 56 & TOBACCO ROAD
CITY OF AUGUSTA
RICHMOND COUNTY, GEORGIA
PARCEL ID: 157 0006 010, 157 0007 000, & 157 0008 000



GSWCC NO. (LEVEL 1)	0000073524
DRAWN BY	DRV
DESIGNED BY	DRV
REVIEWED BY	DDS
DATE	07/17/2023
PROJECT NO.	014774010
TITLE	
LIFT STATION PLAN	
SHEET NUMBER	
C4-53	

Kimley»Horn

© 2022 KIMLEY-HORN AND ASSOCIATES, INC.
544 E GORDON STREET
SAVANNAH, GEORGIA 31401
PHONE (912) 231-4384
WWW.KIMLEY-HORN.COM

Parker's *kitchen*
DRAYTON-PARKER COMPANIES, LLC.
17 WEST McDONOUGH STREET
SAVANNAH, GEORGIA 31401
PHONE: 912-231-1001