



UTILITIES DEPARTMENT

Wes Byne, P.E.
Director

TO: Andy Penick
Director, Procurement Department

THRU: Wes Byne, P.E. *FWByne*
Director, Utilities Department

FROM: Stephen Orton, P.E.

CC:

DATE: 4/14/2026

SUBJECT: JUSTIFICATION FOR EMERGENCY REQUESTS

The two (2) sodium hypochlorite tanks at our Highland Ave. Water Treatment Plant have developed cracks, which has rendered them out of service. This incident has cut our storage capacity by 2/3.

To meet EPD guidelines for our chlorine discharge residual for potable water and to avoid a possible delay in water filtration and distribution, it is imperative to have it repaired the soonest time possible.

Wes Byne will submit an agenda to be approved by the Commission to justify this repair. We would like to request that as we wait for the approval, please allow Procurement to release the purchase order so that Carl Eric Johnson can mobilize their team that will do the repair as soon as possible.

Thank you for your prompt attention and immediate action to this matter.

Sincerely,

Wes Byne and Stephen Orton

Nancy M. Williams

From: Andy Penick
Sent: Monday, April 20, 2026 1:32 PM
To: Tess T. Thompson; Nancy M. Williams
Cc: Wes Byne; Stephen Orton; Debra Beazley
Subject: RE: Emergency Request to Repair Sodium Hypochlorite Tank-Highland WTP

Tess,
This is approved please proceed as needed.

Regards,

Andy Penick, CPSM, GCPM, GCPA, MBA

Director of Procurement
Augusta, Georgia Government
535 Telfair Street, Suite 605, Augusta, GA 30901
Office: (706) 821-4820 | Mobile: (762) 383-9357
Email apenick@augustaga.gov | www.augustaga.gov

From: Tess T. Thompson <TThompson@augustaga.gov>
Sent: Monday, April 20, 2026 12:32 PM
To: Andy Penick <apenick@augustaga.gov>; Nancy M. Williams <NWilliams@augustaga.gov>
Cc: Wes Byne <WByne@augustaga.gov>; Stephen Orton <SOorton@augustaga.gov>; Debra Beazley <dbeazley@augustaga.gov>
Subject: Emergency Request to Repair Sodium Hypochlorite Tank-Highland WTP
Importance: High

Good afternoon, Andy, and Nancy! Hope your day is great!

Attached you will find an emergency requisition for the repair of two sodium hypochlorite tanks at our Highland Water Treatment Plant.

Wes and Steve would like to request for an emergency PO so that the vendor, Carl Eric Johnson, can mobilize their team as soon as the PO becomes available.

An agenda will be submitted to the Commission by Steve Orton to justify the repair.

Thank you for your kind consideration to this request. Let us know if you may need additional information to proceed.

Tess Thompson, MSA

Finance Manager
Utilities Department
Augusta, GA 30901
Tel . No. 706-312-4147

Fax No. 706-312-4123
tthompson@augustaga.gov



“For I know the plans I have for you,”
declares the Lord, “plans to prosper you and not to harm you
plans to give you hope and a future!”-Jeremiah 29:11

This e-mail contains confidential information and is intended only for the individual named. If you are not the named addressee, you should not disseminate, distribute or copy this e-mail. Please notify the sender immediately by e-mail if you have received this e-mail by mistake and delete this e-mail from your system. The City of Augusta accepts no liability for the content of this e-mail or for the consequences of any actions taken on the basis of the information provided, unless that information is subsequently confirmed in writing. Any views or opinions presented in this e-mail are solely those of the author and do not necessarily represent those of the City of Augusta. E-mail transmissions cannot be guaranteed to be secure or error-free as information could be intercepted, corrupted, lost, destroyed, arrive late or incomplete, or contain viruses. The sender therefore does not accept liability for any errors or omissions in the content of this message which arise as a result of the e-mail transmission. If verification is required, please request a hard copy version.
AED:104.1

**AUGUSTA UTILITIES DEPARTMENT
IN-HOUSE REQUISITION**

CHECK ALL THAT APPLY:

- WATER
 SEWER
 SUPPLIES
 SERVICE
 EQUIPMENT
 TOOLS
 SAFETY
 OFFICE
 CHEMICAL
 GASES
 REPAIR
 MAINTENANCE
 LAB
 UNIFORM
 LIFT STATION
 OTHER

REQUISITION #

- IT
 SCADA
 INVENTORY
 BID ITEM
 ROUTINE
 EMERGENCY
 SOLE SOURCE
 PREFER ITEM

DATE: 4/14/2026

DIVISION Highland Water Filter Plant

FUND #: 506043520 5425110

SHIP TO:

VENDOR:

ADDRESS:

PHONE #:

QUOTED BY:

Carl Eric Johnson, Inc

1750 MACLEOD DR, LAWRENCEVILLE, GA 30043

(912) 352-0762

Adrian Daniels

2822 Central ave. Augusta, Ga 30901

ITEM #	ITEM DESCRIPTION	QUANTITY	UNIT PRICE	TOTAL PRICE	UNIT PRICE	TOTAL PRICE	UNIT PRICE	TOTAL PRICE
1.	4400 Gallon Sodium Hypochlorite Tank	1	28,725.00	28,725.00		0.00		0.00
2.				0.00		0.00		0.00
3.				0.00		0.00		0.00
4.	10500 Gallon Sodium Hypochlorite Tank	1	64,313.00	64,313.00		0.00		0.00
5.				0.00		0.00		0.00
6.				0.00		0.00		0.00
7.				0.00		0.00		0.00
8.				0.00		0.00		0.00
9.				0.00		0.00		0.00
10.				0.00		0.00		0.00
11.				0.00		0.00		0.00
12.				0.00		0.00		0.00
13.				0.00		0.00		0.00
14.				0.00		0.00		0.00
SHIPPING CHARGES			8,800.00	8,800.00		0.00		0.00
TOTAL				101,838.00		0.00		0.00

JUSTIFICATION AND EXPLANATION FOR PURCHASE:

tanks for sodium Hypochlorite

REQUESTED BY: Steve Olson

APPROVED BY: *John Goodenough*

Approved:
John Goodenough
AUD Director



Date: April 8, 2026
Attn: Stephen Orton
sorton@augustaga.gov
706-836-7283
Quote No. 27-0097
Subject: 10500GAL & 4400GAL SAFE-Tanks for Sodium Hypochlorite

Thank you for the opportunity to be considered for your chemical storage needs.

Poly Processing Company offers reliable, robust tank systems for safe storage of harsh chemicals. Cross-linked polyethylene storage tanks offer a margin of safety that meets or exceeds ASTM D-1998 standards. This material strength is then combined with rotational molding as the manufacturing process. Rotational Molding differs from FRP and Steel in that it creates a seamless, homogenous part with no welds, joints, composites, or seams. This is the surest way to avoid chemical leaks and a major benefit over Fiberglass and Steel tanks.

If honored with an order, we can provide an exact drawing of fittings placement to get your signed approval on, and your equipment would be on site in approximately 6 weeks from your approval of that drawing.

Please contact me if I can answer any questions or revise this proposal in any way.

Thank You,

Ozzy Castellanos



Poly Processing Tank Offering

◆ = Distinguishing Feature from Others

This mark denotes Innovations in this proposal developed by Poly Processing Company (PPC) or its sister Chemical Company. PPC is unique among storage tank manufacturers, in being privately held. This allows heavy R&D each year for innovations not expensed by shareholder-controlled companies. See below or ask us on any feature having this mark, as to how it differs from others in longevity, safety, maintenance, or operational costs.

TANK SYSTEM: Sodium Hypochlorite

For storing: Sodium Hypochlorite, 9 - 15%, SPG 1.2

Application Parameters: Outdoor/To 100F/NSF/Wind 0/Seismic 0/Pneumatically Filled>/Non-Scrubber

Diameter: 9'-7" | Height: 10'-3" | Dome Manway Size: 24"

Stock Number: 72004400441VA

Download links below are of the basic tank before assembly. Complete Approval Drawings available with PO.

[PDF Drawing](#) / [CAD \(dwg file\)](#) / [3D-CAD \(stp file\)](#) | [PDF Gallon per Inch chart](#) | .

Primary Tank (Quantity: 1)

4400 SAFE-Tank◆ Inside Primary Tank

1.90 specific gravity wall thickness

Crosslinked Polyethylene (XLPE)◆ ,Black

Tank wall includes Oxidation Resistance additives(OR1000)◆

Containment Tank (Quantity: 1)

4400 SAFE-Tank◆ Nested Containment Outside Tank

1.90 specific gravity wall thickness

Crosslinked Polyethylene (XLPE)◆ ,Black

Lid/Manway (Quantity: 1)

Cover 24" Manway with 8" Mushroom Vent ,Black (polyethylene) with vent screen

Fill (Quantity: 1)

Bulkhead fitting Assembly 2" Socket x socket PVC/viton nsf

Level Fitting (Quantity: 1)

Universal Ball Dome Fitting 2" Bulkhead fitting Style PVC/viton nsf

Inner Tank Fitting (Quantity: 1)

BOSS_fitting (Bolted One-piece Sure Seal)◆ 2" Assembly (polyethylene)/PVC/Titanium/viton nsf

Pump Feed (Quantity: 1)

Transition Fitting with Containment and Flex◆

Outlet Endplate: 2" with containment around outlet pipe and built-in flex.

PVC/litharge Viton /Titanium with Expansion Joint PTFE

Vent (Quantity: 1)

U-vent 4" PVC

WARRANTY:5 Years, Full Replacement, Non-Prorated

System Subtotal: \$28,725.00



TANK SYSTEM: Sodium Hypochlorite

For storing: Sodium Hypochlorite, 9 - 15%, SPG 1.2

Application Parameters: Outdoor/To 100F/NSF/Wind 0/Seismic 0/Pneumatically Filled>/Non-Scrubber

Diameter: 11'-0" | Height: 17'-3" | Dome Manway Size: 24"

Stock Number: 42010500441LA

Download links below are of the basic tank before assembly. Complete Approval Drawings available with PO.

[PDF Drawing](#) / [CAD \(dwg file\)](#) / [3D-CAD \(stp file\)](#) | [PDF Gallon per Inch chart](#) | -

Primary Tank (Quantity: 1)

10500 SAFE-Tank◆ Inside Primary Tank

1.90 specific gravity wall thickness

Crosslinked Polyethylene (XLPE)◆ ,Black /Or1000

Color: Natural (yellowish white)

Containment Tank (Quantity: 1)

10500 SAFE-Tank◆ Nested Containment Outside Tank

1.90 specific gravity wall thickness

Crosslinked Polyethylene (XLPE)◆ ,Black

Lid/Manway (Quantity: 1)

Cover 24" Manway with 8" Mushroom Vent ,Black (polyethylene) with vent screen

Fill (Quantity: 1)

Bulkhead fitting Assembly 2" Socket x socket PVC/viton nsf

Level Fitting (Quantity: 1)

Universal Ball Dome Fitting 2" Bulkhead fitting Style PVC/viton nsf

Inner Tank Fitting (Quantity: 1)

BOSS_ fitting (Bolted One-piece Sure Seal)◆ 2" Assembly (polyethylene)/PVC/Titanium/viton nsf

Pump Feed (Quantity: 1)

Transition Fitting with Containment and Flex◆

Outlet Endplate: 2" with containment around outlet pipe and built-in flex.

PVC/litharge Viton /Titanium with Expansion Joint PTFE

Vent (Quantity: 1)

U-vent 4" PVC

WARRANTY:5 Years, Full Replacement, Non-Prorated

System Subtotal: \$64,313.00

\$93,038.00

Estimated Shipping to Augusta GA: \$8,800.00

Order Grand Total: \$101,838.00

Quote pricing guaranteed 30 days, subject to change after 05-08-2026

Freight quoted is an estimate at time of quote. Actual freight charged will be passed through from carrier at time of shipment.



NOTES:

COMPONENTS IN THIS PROPOSAL

While the Tank Offering section above highlights the overall systems, this grid details individual components and accessories for a more complete look.

LABEL	STOCK#	DESCRIPTION	QTY
Tank System		Application: Sodium Hypochlorite	
Usage:		Sodium Hypochlorite	
Chemical:		Sodium Hypochlorite, 9 - 15%, SPG 1.2	
Op Env:		Outdoor/To 100F/NSF/Wind 0/Seismic 0/Pneumatically Filled>/Non-Scrubber	
Nominal_Tank>		Nominal_Tank> 4400 Safe-tank Inside Primary Tank, Sodium Hypochlorite 9 -	
Primary Tank	72004400441	4400 Safe-tank Inside Primary Tank 1.90 specific gravity wall thickness, Crosslinked Polyethylene (XLPE)◆,Black Tank wall includes Oxidation Resistance additives(OR1000)◆	1
Comments:		WEIGHT: 1315 DIA: 9'-7" HT: 10'-3" TOP: 24"	
Containment:		Containment Tank	
Containment Tank	72104950411	4400 Safe-tank Nested Containment Outside Tank1.90 specific gravity wall thickness, Crosslinked Polyethylene (XLPE)◆,Black	1
Comments:		WEIGHT: 1200 DIA: 10'-3" HT: 8'-5"	
Lid/Cover:		Lid/Cover/Manway	
Lid/Manway	10645	Cover 24" Manway with 8" Mushroom Vent ,Black (polyethylene)with vent screen	1
Fill/Discharge:		Fill/Discharge	
Fill	11107	Bulkhead fitting Assembly 2" Socket x socket PVC/viton nsf	1
Comments:		To be installed at Flat Dome location	
	2063	Flange Adapter 2" Threaded PVC	1
Dome:		Dome Fittings	
Level Fitting	8145	Universal Ball Dome Fitting 2" Bulkhead fitting Style PVC/viton nsf	1
	2063	Flange Adapter 2" Threaded PVC	1
Sidewall:		Sidewall Fittings	
Inner Tank Fitting	9746	BOSS_fitting (Bolted One-piece Sure Seal)◆ 2" Assembly Pe/PVC/Titanium/viton nsf	1
Pump Feed	9756	Transition Fitting 2" with containment around outlet pipe and built-in flex. PVC/litharge Viton /Titanium with Expansion Joint PTFE	1
	2063	Flange Adapter 2" Threaded PVC	1
Venting:		Venting	
Vent	3275	U-vent 4" PVC	1
Tank System		Application: Sodium Hypochlorite	
Usage:		Sodium Hypochlorite	
Chemical:		Sodium Hypochlorite, 9 - 15%, SPG 1.2	
Op Env:		Outdoor/To 100F/NSF/Wind 0/Seismic 0/Pneumatically Filled>/Non-Scrubber	
Nominal_Tank>		Nominal_Tank> 10500 Safe-tank Inside Primary Tank, Sodium Hypochlorite 9 -	
Primary Tank	42010500441	10500 Safe-tank Inside Primary Tank 1.90 specific gravity wall thickness, Crosslinked Polyethylene (XLPE)◆,Black /Or1000,Color: Natural (yellowish white)	1
Comments:		WEIGHT: ? DIA: 11'-0" HT: 17'-3" TOP: 24"	



Containment:		Containment Tank	
Containment Tank	42112350411	10500 Safe-tank Nested Containment Outside Tank 1.90 specific gravity wall thickness, Crosslinked Polyethylene (XLPE) ◆ ,Black	1
Comments:		WEIGHT: 7 DIA: 11' 11" HT: 15' 4"	
Lid/Cover:		Lid/Cover/Manway	
Lid/Manway	10645	Cover 24" Manway with 8" Mushroom Vent ,Black (polyethylene)with vent screen	1
Fill/Discharge:		Fill/Discharge	
Fill	11107	Bulkhead fitting Assembly 2" Socket x socket PVC/viton nsf	1
Comments:		To be installed at Flat Dome location	
	2063	Flange Adapter 2" Threaded PVC	1
Dome:		Dome Fittings	
Level Fitting	8145	Universal Ball Dome Fitting 2" Bulkhead fitting Style PVC/viton nsf	1
	2063	Flange Adapter 2" Threaded PVC	1
Sidewall:		Sidewall Fittings	
Inner Tank Fitting	9746	BOSS_fitting (Bolted One-piece Sure Seal) ◆ 2" Assembly Pe/PVC/Titanium/viton nsf	1
Pump Feed	9756	Transition Fitting 2" with containment around outlet pipe and built-in flex. PVC/litharge Viton /Titanium with Expansion Joint PTFE	1
	2063	Flange Adapter 2" Threaded PVC	1
Venting:		Venting	
Vent	3275	U-vent 4" PVC	1



THIS PROPOSAL CONTAINS...

The following are referenced in one or more places above.

1) Crosslinked Polyethylene (XLPE) Included!

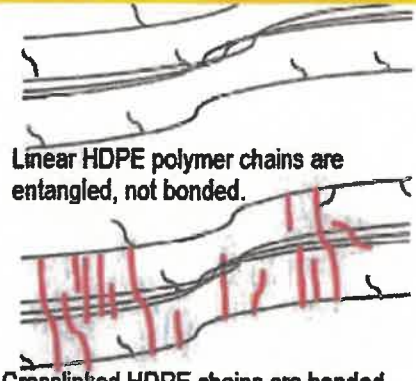

Linear HDPE polymer chains are entangled, not bonded.

Crosslinked HDPE chains are bonded

- XLPE is still HDPE, but the HDPE polymer chains are crosslinked to each other for superior strength.
- XLPE is all about strength, not chemical compatibility. It is still HDPE, but stronger.
- XLPE is 5x stronger than linear HDPE. It is a thermoset vs thermoplastic (linear)
- 20 times the environmental stress crack resistance (ESCR) over linear HDPE.
- Considerably longer tank life (vs linear) & best warranty in the industry.
- MORE INFO: and video demonstration- please visit [Crosslink vs Non-Crosslinked video](#)

2) NSF61 System Certification Included!



- Only system completely certified by NSF for fittings, gaskets, and other components.
- Over 35 chemicals certified under PPC NSF Product and Service Listing.
- Others may be NSF61 for Potable water only- not chemicals.
- NSF61 documentation and system decal on tank wall.
- MORE INFO: Please download our [NSF/ANSI 61 Certification Guide](#)



3) Anti-Oxidation System (OR1000) Included!

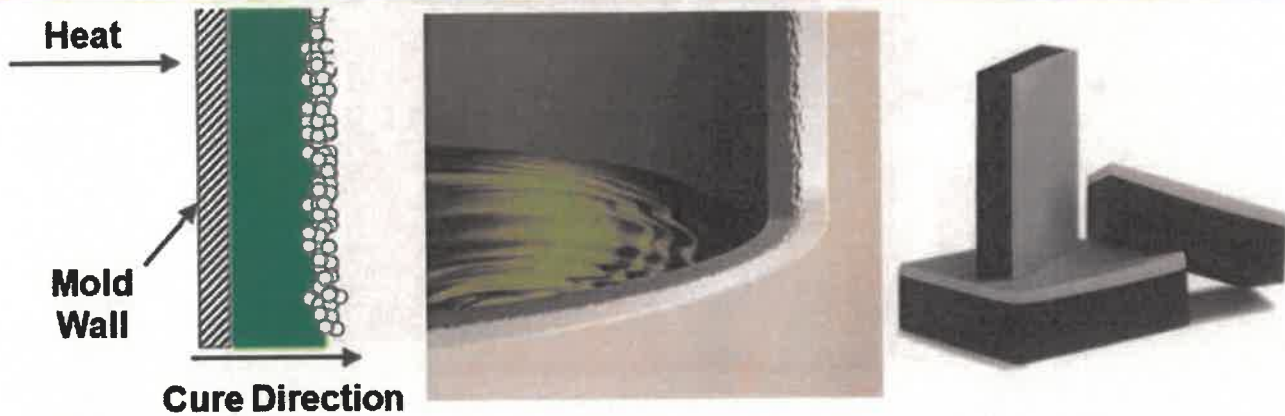

Extends any PE tank life containing oxidizing chemicals.

- 4 times the antioxidant strength of any polyethylene on the market today.
- Polyethylene with OR additives is blended, baked in, and covalently bonded with rotomolding process- NOT just a liner.
- NSF61 Certified.
- Added as a 'double shot' towards end of cooking cycle leaving anti-oxidants in the field vs being 'cooked away'.
- Longest warranty in the Industry.
- MORE INFO: and video demonstration- please visit [Engineered Resins for specific chemicals](#)

4) BOSS Fitting Included!



More leak proof than any fitting on the market

- Is constructed of polyethylene for chemical compatibility with your tank
- Has an innovative backing ring design to reduce stress on the fitting and make it three times stronger than plastic fittings.
- Is easy to maintain, since the pipe connection is extended beyond the sidewall of the tank.
- MORE INFO: Video, pictures, benefits - please visit [BOSS 5 things](#)

5) SAFE TANK SYSTEM Included!



A primary tank nested inside another containment tank (double wall tank)

- Containment tank meets 110% capacity of the primary tank.
- Covered containment so rain or wash water can not jeopardize the containment capacity or chemical reaction.
- Portable to new location vs concrete berm
- In event of breach chemical still useable (simply becomes a single wall tank).
- In event of breach no lost production time (Allows scheduling a repair vs Shut Down).
- Exterior tank acts as a sun shield and protects the contents of the tank from UV degradation.
- MORE INFO: Guides, pictures, benefits - please visit [SAFE-tank website info](#)

6) Transition Fitting Included!

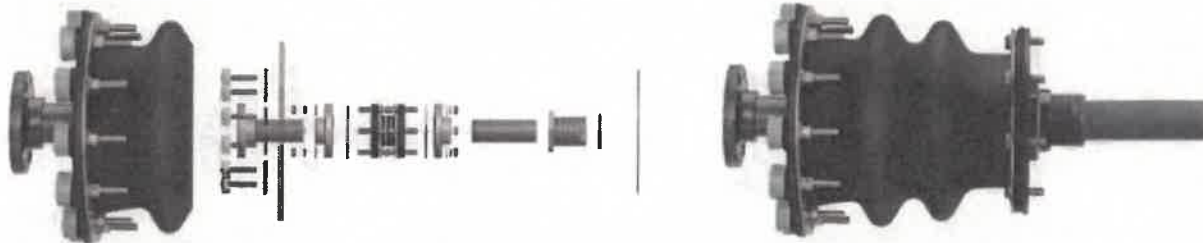

CONTAINED bottom discharge capability in a system that supports 110% secondary containment requirements. Some systems by others do not encapsulate the outlet and could empty contents when gasket fails.

- Containment of the expansion joint and connections eliminates the threat of uncontained chemical leaks that could occur in the outlet piping.
- Piping layouts can be fully contained by connecting a dual-wall piping system onto the ANSI endplate fitting.
- Drain fittings that are flexible and move with the individual tanks.
- Meets 10 state standards for Federal, and State regulation compliance.
- MORE INFO: Pictures and guide, please visit [Transition Fitting](#)



7) Best Warranty in the Industry. Included!



No Proration

Others provide only credit for unused time.



Factory Field Service Department

Others do not have Field Service to assist.



Standard Published Warranty

Others have no public published standard. Its case by c

Poly Processing is privately held, unlike others, so there are no shareholders to satisfy or committees to go through for approval. The whole system is replaced, not just remaining time credit dollars issued. Compare references to see who honors warranties. More Info- please visit [Comparing Warranties](#)

Additional Value from Poly Processing Company

- Over 50 years Manufacturing, Serving & Innovating for the chemical feed industry!
- Privately held. PPC cares about safety, innovation, & customers- not shareholders.
- Born from it's sister chemical company still operating- PPC knows chemical storage at a root level.
- Fastest deliveries and response times in the Industry.
- Technical Support staff-dozens of people across 3 plants- to assist you quickly- 12 hrs per day!
- Tanks built to ASTM D 1998 and certified with documentation.
- Factory 4 Hour Hydro Test on your finished tanks and signed documentation.
- Factory Impact Test per ASTM D1998 and documentation.
- Factory Gel test per ASTM D-1998 and documentation.
- Ultrasonic wall thickness testing per ASTM and signed documentation.
- NSF61 "system" certification for chemical- others only tank wall.
- Approval and As-Built drawings include full fitting details unlike others.
- Support Teams out of three factories in CA / LA / VA covers North America.
- 7 Regional Managers living in each area of country to assure your satisfaction.
- Factory Field Service Team that can come to your location for any need. [\[more\]](#)
- FDA Compliant.
- 3D CAD files available. 3D Drafting Team for custom needs.
- Turnkey Installation available with local contractor partners.
- 'Library of Congress for tanks'- none compare to our website resources.
- Project management team for after PO to shipment ease of business.



☛ Tanks washed and shrink wrapped for clean delivery. Others do not.

FITTINGS AND ACCESSORIES REFERENCE

Please refer to proposal above for specific materials and sizes. The following exist on this proposal but this list may not be complete to every item quoted. Our website shows additional fittings if needed.



Flange Adapter

A flange attached to a nipple pipe. Allows plumbing connections between tank fittings and the flange of a component. See proposal sections above for size and type included.

To download a PDF drawing click here: [Download Flange Adapter PDF](#)



Bulk Head Fitting

A common fitting not unique to Poly Processing, it must be installed from the inside of the tank. We recommend it not be used on the bottom sidewall of tanks greater than 3,000 gallons or tanks greater than 6 feet in height. [See drawing- click here](#)



U-Vent

A common fitting not unique to Poly Processing, Standard venting for outdoor tanks. In PVC, in sizes 2 to 6 inches.

More Info: [Other vent choices and drawings- click here](#)



Mushroom Vent

Installed on tank dome, vents to compensate for positive or negative pressure buildup in a tank. See above for your specific size and material. Proper venting is related to fill inlet size and method of fill.

More Info: [Other vent choices, sizing and drawings- click here](#)

Payment Terms & Conditions:

- 1) NET30 Standard Purchase Order
- 2) Blanket PO with Appropriate Approval/Credentials
- 3) Credit card: CEJCO Accepts VISA, MasterCard or American Express (2% surcharge applies on total order on Amex cards)
- 4) Cash in Advance
- 5) Cancellation of order may result in a 35% fee of entire order before release to fabrication & 100% cancellation fee after release to manufacturing
- 6) This quote may be revised as necessary to account for any tariffs applicable to the subject products, or inputs thereof.
- 7) Additional charges may apply after three or more revisions to drawings, submittals, or project documents.
- 8) Taxes and duties not included in proposal

Freight: Prepaid and Added to Final Invoice

Should this proposal become an order, please address and send to:

Carl Eric Johnson, Inc.
1725-Q Macleod Drive
Lawrenceville, GA 30043
Email: customerservice@cejco.com

If you have any additional questions, or require any additional information, please let us know. We appreciate your consideration of our proposal and look forward to the opportunity to work with you further.

If you have any additional questions, or require any additional information, please let us know. Our portfolio includes a large range of engineered fluid handling products beyond the scope of this proposal, and we have design engineers who can assist with a vast variety of Pumps, Tanks, Heat Exchangers, Filters, Skids, Controls & Automation, Repairs, and Turnkey Installations. We appreciate your consideration of our proposal and look forward to the opportunity to work with you further.

Sincerely,
Ozzy Castellanos

Carl Eric Johnson, Inc.
1725Q Macleod Drive
Lawrenceville, GA 30043
Phone: 678-377-3100
Email: ocastellanos@cejco.com