

ST. JOHNS PARK ADA AND SIDEWALKS FOR THE TOWN OF ASHLAND CITY ASHLAND CITY, TENNESSEE (CHEATHAM COUNTY)

NOVEMBER 2021

CONTRACTOR'S NOTES:

THE CONTRACTORS WORK TO BE PERFORMED UNDER THIS PROJECT WILL CONSIST OF FURNISHING ALL EQUIPMENT, LABOR, TOOLS AND SUPERVISION NECESSARY FOR THE CONSTRUCTION OF THE PROPOSED WORK AND ALL OTHER RELATED WORK AS LISTED IN THE PLANS AND SPECIFICATIONS.

THE CONTRACTOR SHALL VERIFY ALL DIMENSIONS, UTILITY LOCATIONS, ELEVATIONS, EXISTING INVERTS PRIOR TO CONSTRUCTION, IF A DISCREPANCY IS FOUND, THE CONTRACTOR SHALL NOTIFY THE ENGINEER OR REPRESENTATIVE IMMEDIATELY.

ALL WORK SHALL COMPLY WITH ALL LOCAL, STATE AND FEDERAL CODES AND LAWS. ALL NECESSARY LICENSES AND PERMITS SHALL BE THE CONTRACTOR'S RESPONSIBILITY.

PORTLAND SHOULD BE 3,000 PSI COMPRESSIVE STRENGTH AT 28 DAYS, 4-INCH MAXIMUM SLUMP AND 5 TO 7 PERCENT AIR ENTRAINED.

ALL WORK PERFORMED SHALL BE IN THE BEST RECOGNIZED TRADE PRACTICES AND TO ENTIRE SATISFACTION OF THE OWNER.

ALL GRASS AREAS DISTURBED WITHIN THE PROJECT THAT ARE 3:1 OR GREATER REQUIRES SOD OR EROSION CONTROL BLANKETS.

UTILITY COMPANIES:

GAS :
PIEDMONT NATURAL GAS
1259 S DICKERSON RD
GOODLETTSVILLE, TN 37072
(704) 364-3120

WATER/SEWER/STORMWATER :
TOWN OF ASHLAND CITY
233 TENNESSEE WALTZ PKY
SUITE 102
ASHLAND CITY, TN 37015
(615) 792-7553

ELECTRIC :
CEMC
315 N MAIN ST
ASHLAND CITY, TN 37015
(615) 792-5651

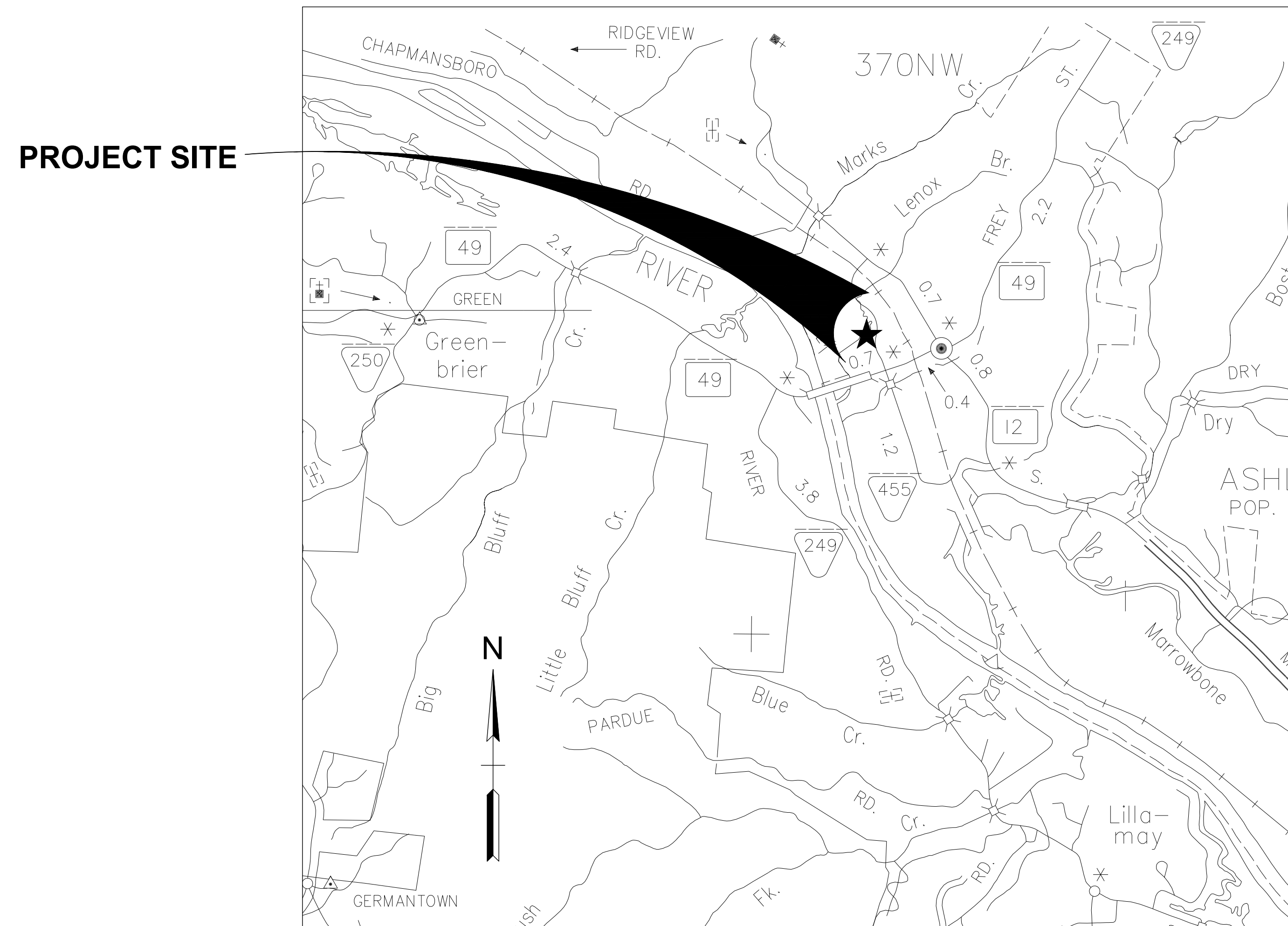
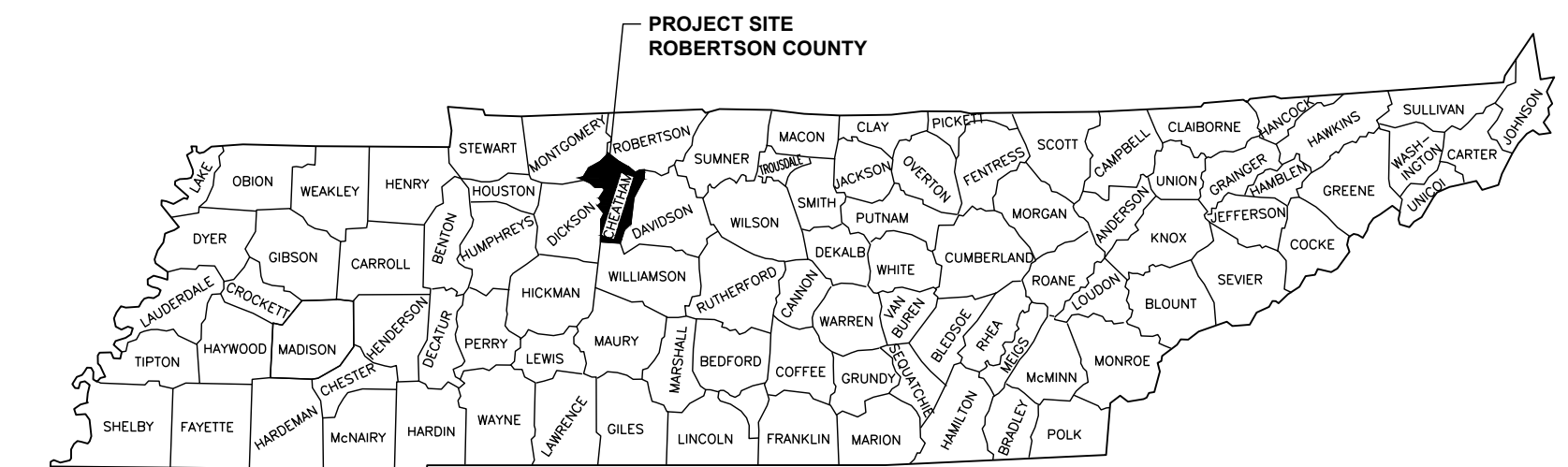

LOCATION MAP

INDEX OF DRAWINGS

SHEET	DESCRIPTION
T1	TITLE SHEET
C1	EXISTING LAYOUT
C2	PROPOSED LAYOUT
C3	SITE DETAILS

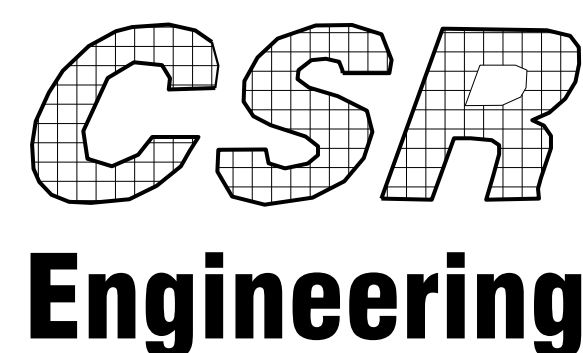
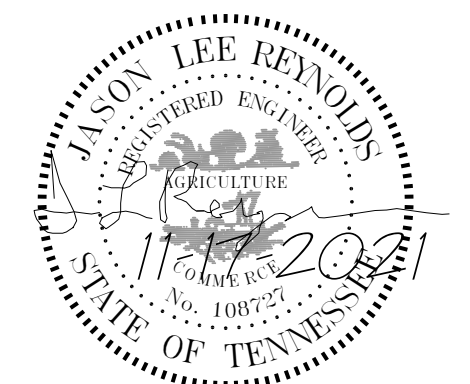

CSR Engineering, Inc.
1116 Main Street
Pleasant View, TN 37146
P: 615.212.2389
F: 615.246.3815
www.csrengineers.com



IT IS THE CONTRACTOR'S RESPONSIBILITY TO CONTACT UTILITY COMPANIES PRIOR TO ANY CONSTRUCTION. THE LOCATION OF UTILITIES SHOWN ON THESE PLANS ARE APPROXIMATE AND POSSIBLY INCOMPLETE. THEREFORE CERTIFICATION TO THE LOCATION OF ALL UNDERGROUND UTILITIES IS WITHHELD.

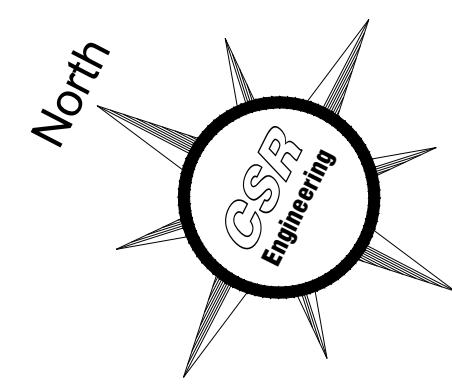

(055C B 005.00-4.7 ACRES)
ASHLAND CITY PLAYGROUND
RECORD BOOK 134,
PAGE 118,
R.O.C.C.
ZONED: C1-C2



CSR Engineering
 CSR Engineering, Inc.
 118 N Greenwood St.
 Lebanon, TN 37087
 P: 615.212.2389
 F: 615.246.3815
 www.csrengineers.com



EXISTING LAYOUT
ST. JOHNS ADA & SIDEWALKS
FOR
CITY OF WHITE HOUSE



NO.	DATE	BY	DESCRIPTION

DESIGNER **MFH**
REVIEWER **JLR**

PROJECT **21-804**

DATE **11-17-21**

SHEET **C1**

PURPOSE FOR ISSUE: CONSTRUCTION

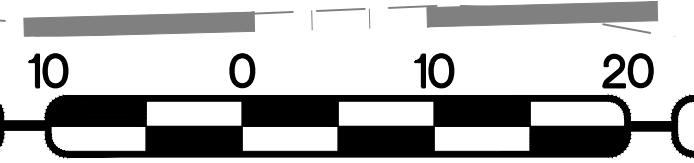

SCALE: 1"=10'



NOTES: 1/2" PREMOLDED FIBER EXPANSION / CONTRACTION JOINTS ARE TO BE PLACED 25' (MAX) APART AND SHALL BE CARRIED THROUGH THE CURB CROSS SECTION.

ALL CONTROL JOINTS NOT EXCEEDING 5' SPACING SHALL BE 1/2" WIDE CUT TO A DEPTH NOT LESS THAN 1" USING A GROOVING TOOL.

SAW CUT OF JOINTS SHALL NOT BE PERMITTED.

ALL SURFACES EXCEEDING 5' IN WIDTH SHALL HAVE CONTROL JOINTS AT 10' SPACING IN EACH DIRECTION AND SHALL BE 1/2" WIDE CUT TO A DEPTH NOT LESS THAN 1" USING A GROOVING TOOL.

ALL FLAT WORK SHALL CONFORM TO THE CURRENT ADA STANDARDS.

ALL AREAS DISTURBED WITHIN THE PROJECT LIMITS SHALL BE REPAIRED IN LIKE KIND.

ALL TURF AREAS SHALL BE STABILIZED WITH SEEDING AND STRAW UPON FINAL COMPLETION OF THE WORK.

ANY AREA OUTSIDE OF THE PROJECT LIMITS SHALL BE RETURNED TO PRE CONSTRUCTION CONDITION AT NO ADDITIONAL COST TO THE OWNER.

ALL CONCRETE SHALL HAVE A LIGHT BROOM FINISH.

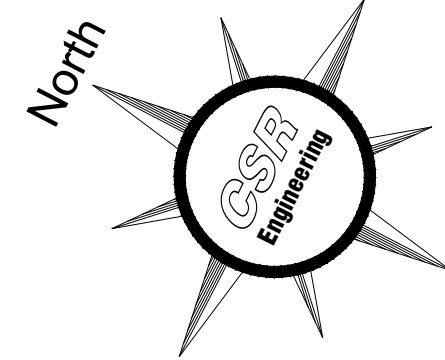

(055C B 005.00-4.7 ACRES)
ASHLAND CITY PLAYGROUND
RECORD BOOK 134,
PAGE 118,
R.O.C.C.
ZONED: C1-C2

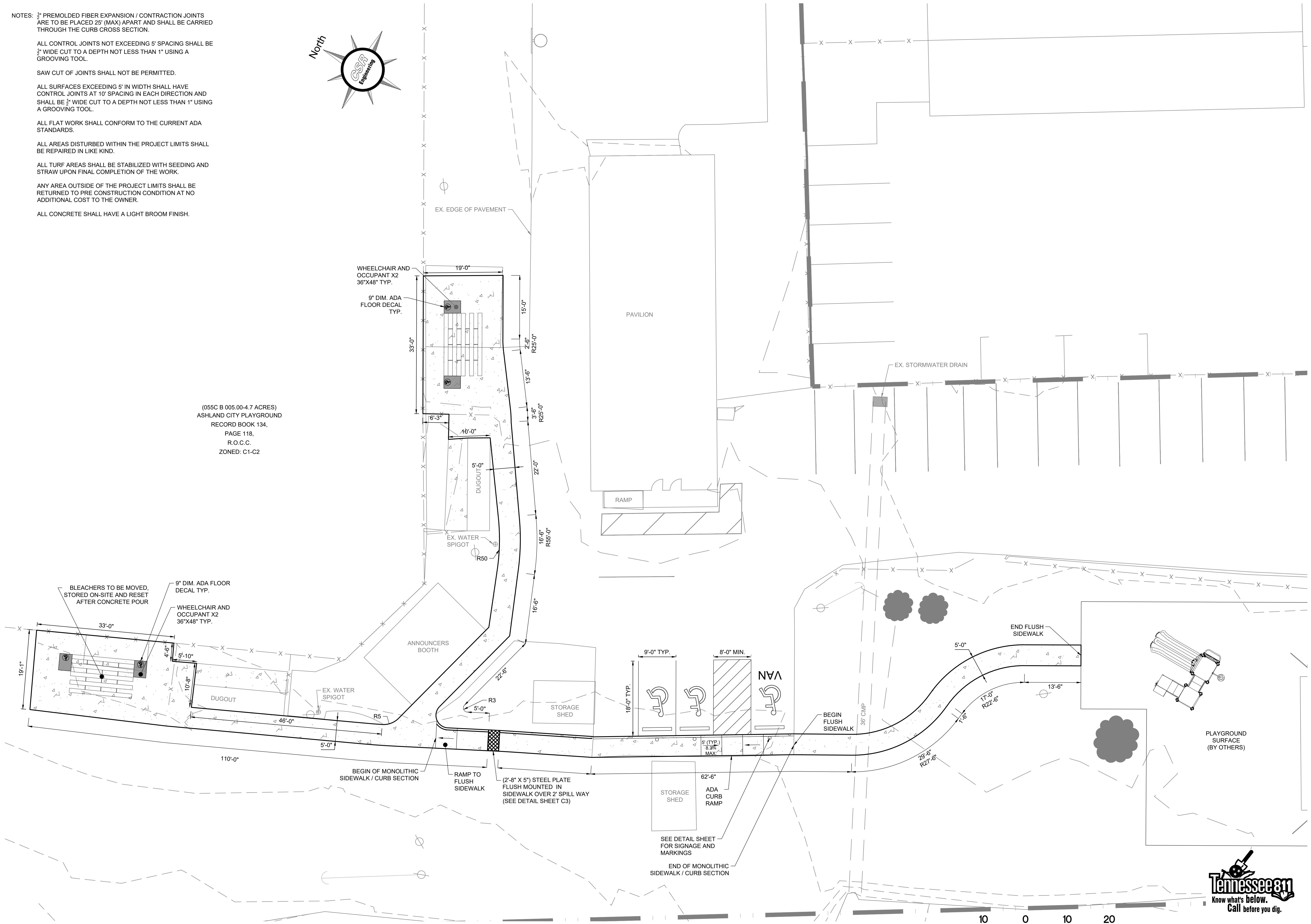

CSR Engineering
 CSR Engineering, Inc.
 118 N Greenwood St.
 Lebanon, TN 37087
 P: 615.212.2389
 F: 615.246.3815
 www.csrengineers.com



PROPOSED LAYOUT
 ST. JOHNS ADA & SIDEWALKS
 FOR
 CITY OF WHITE HOUSE



REVISIONS	
NO.	DESCRIPTION

DESIGNER **MRH**
 REVIEWER **JLR**

PROJECT **21-804**

DATE **11-17-21**

SHEET **C2**



PURPOSE FOR ISSUE: CONSTRUCTION SCALE: 1"=10'

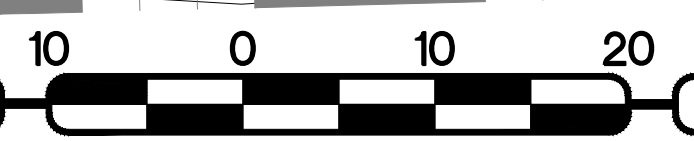

REVISIONS	
NO.	DESCRIPTION

DESIGNER **MFH**
REVIEWER **JLR**

PROJECT **21-804**

DATE **11-17-21**

SHEET **C3**

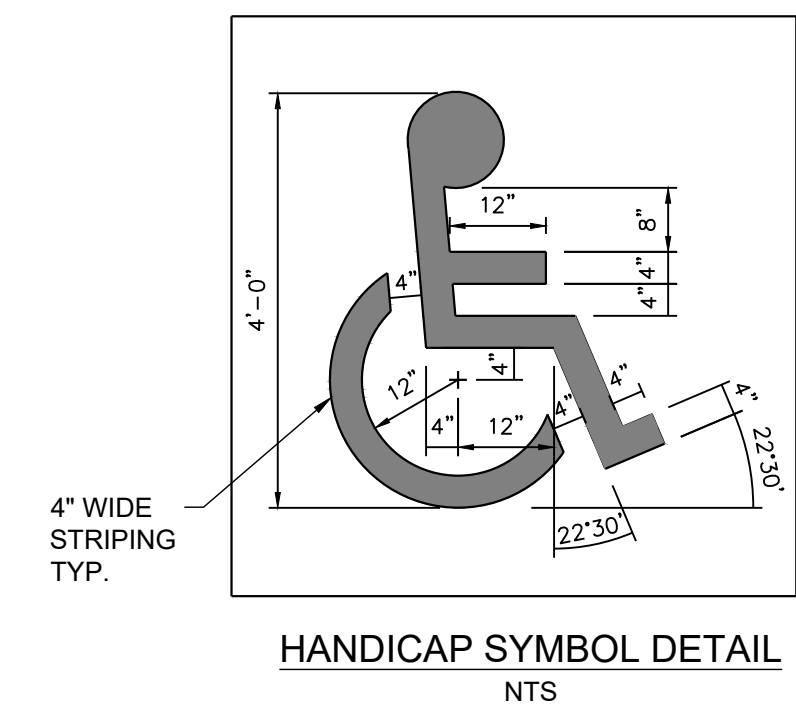
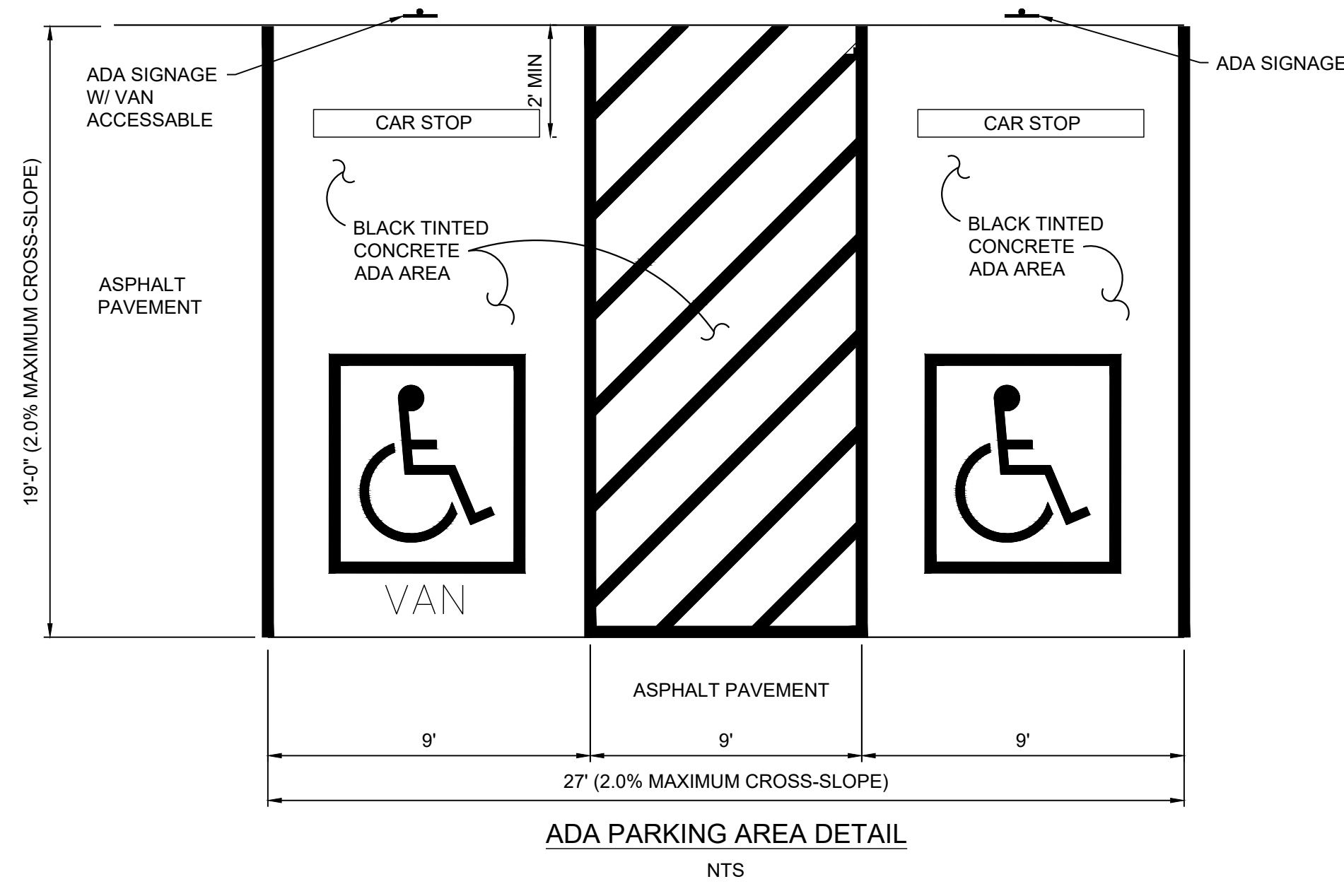

SYMBOL TO BE PAINTED ON ALL HANDICAP SPACES WITH REFLECTIVE TRAFFIC PAINT PER LOCAL CODES AND ADA GUIDELINES

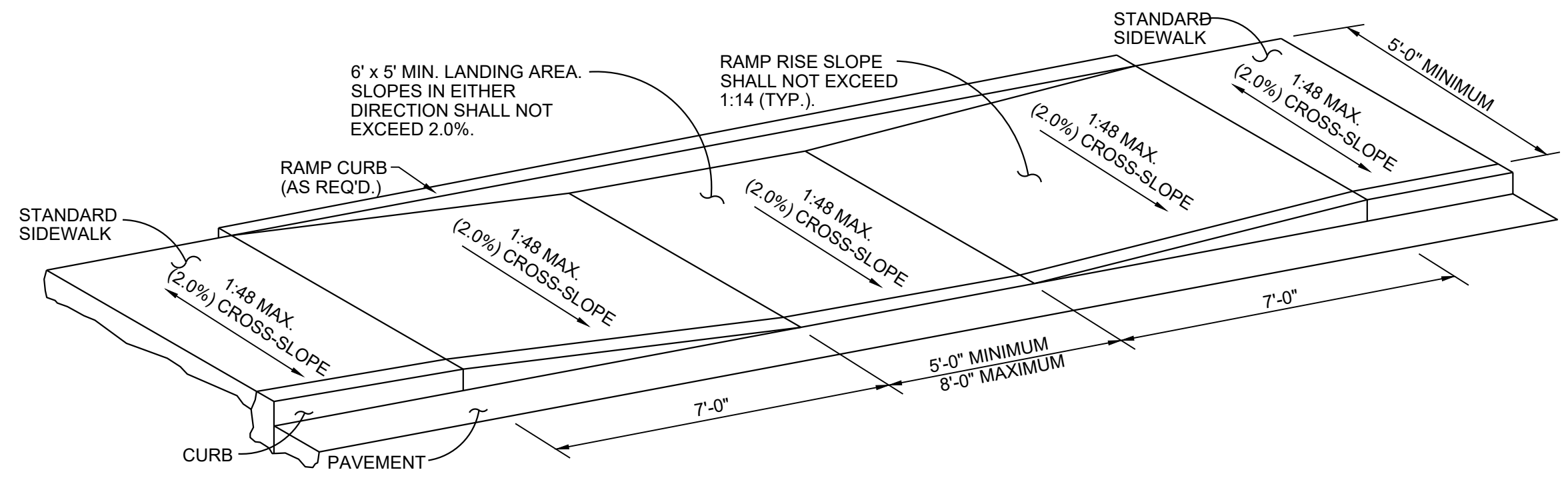
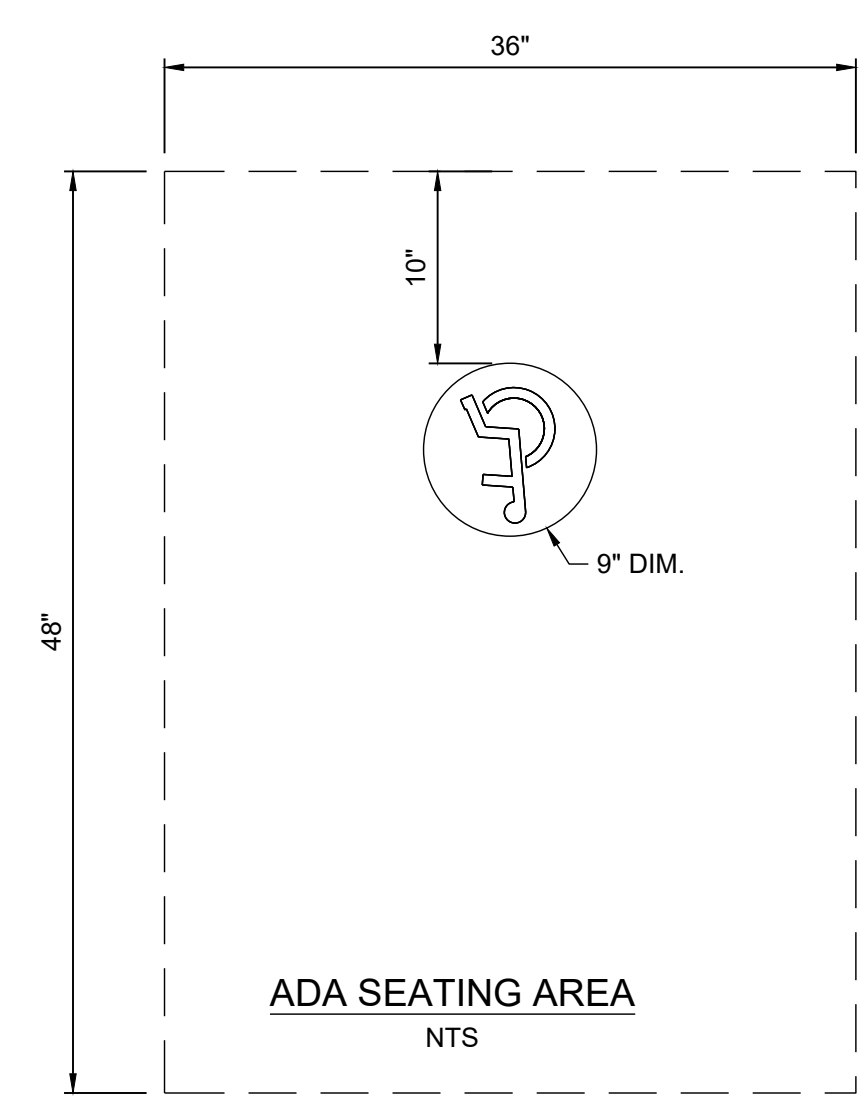
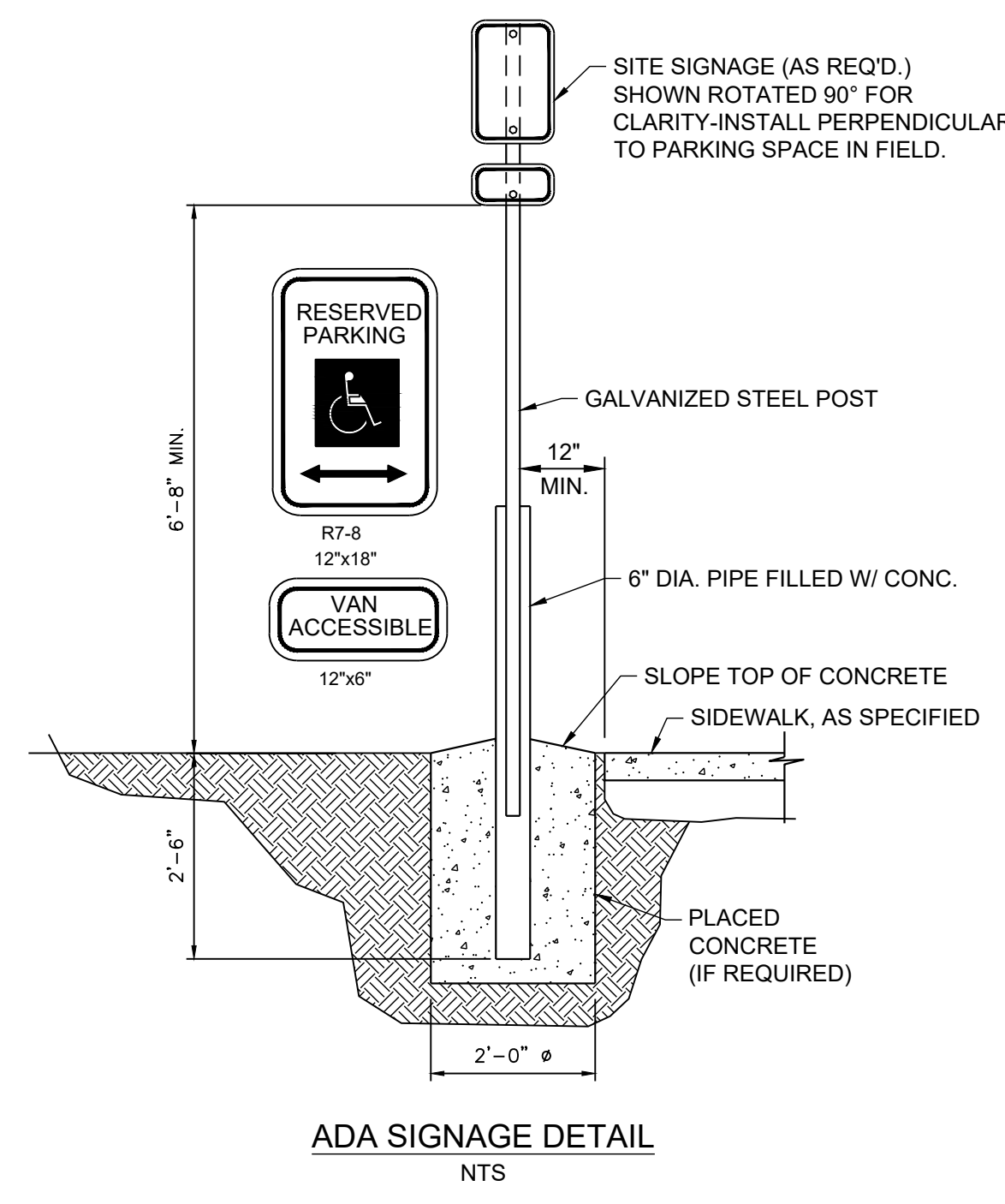

CURB RAMP SHALL MEET ALL FEDERAL, STATE AND LOCAL CODES AND SPECIFICATIONS. SURFACES SHALL MEET THE GUIDELINES OF THE "ADA STANDARDS" MOST CURRENT ADDITION FOR ACCESSIBILITY. THE GUTTER SLOPE SHALL NOT EXCEED 1:20 ADJACENT TO THE RAMP.

