



SCALE: 1" = 300'

C Street Canal

Country Club
Tracts

912'

109'

800'

300'

200'

622'

Kansas Avenue

U.S. Highway 77 Bypass

US-166

Thompson Garden
Addition
Lots 13-16
Block 8

DESCRIPTION: (AREA REQUESTED TO BE REMOVED FROM SFHA ZONE AE)

A tract of land situated in the Northeast Quarter of Section 19, Township 34 South, Range 4 East of the 6th Principal Meridian, Cowley County, Kansas, being more particularly described as follows: Commencing at the Southwest corner of Lot 13, Block 8, Thompson Garden Addition, Arkansas City, Kansas, thence Westerly along the North Right-of-Way of Kansas Avenue a distance of 622 feet, more or less, to the East line of Country Club Tracts extended; thence Northerly along said East line a distance of 800 feet; thence Easterly parallel with the North Right-of-Way of Kansas Avenue a distance of 912 feet, more or less, to a point on the West Right-of-Way of U.S. Highway 77; thence Southerly along said West Right-of-Way a distance of 601 feet, more or less, to the Northeast corner of Lot 18, Block 8, Thompson Garden Addition; thence Westerly along the North line of said Lot 18 extended, a distance of 300 feet, more or less, to the Northwest corner of said Lot 13, thence Southerly along the West line of said Lot 13 a distance of 200 feet, more or less, to the Point of Beginning.

PREPARED FOR:

City of Arkansas City
118 W Central
Arkansas City, KS 67005

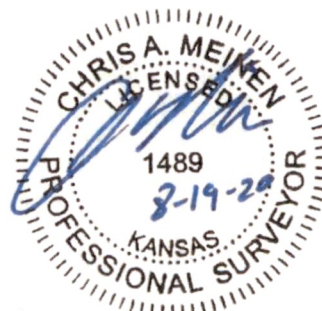

SMITH + OAKES

P.O. BOX 696 / 110 W BRYANT RD, ARKANSAS CITY, KS 67005
PHONE / 620-442-4756 / INFO@SMITHANDOAKES.COM

DATE: 8/19/2020

DRAWN BY: THR

SHEET: 1 OF 1

PROJECT # 40-037