

STAFF REPORT

Transportation Plan Amendments

August 12, 2025 Town Council Meeting



The Bicycle and Pedestrian System Plan Map (Plan) represents a network of current and future facilities that provide guidance on what is likely to be suitable for long term growth, connectivity, and recreation. The Plan does not require a schedule for implementation, nor does it set aside funding for improvements. Instead, it helps the Town establish long term priorities and identify requirements for new development. The Plan was last amended on May 27, 2025.

The purpose of the public hearing is to consider amendments to the Bicycle and Pedestrian System Plan Map along New Hill Olive Chapel Road to make a decision.

A map of the proposed Plan amendments are displayed in Figure 1.



Figure 1. Proposed amendments to the Bicycle and Pedestrian System Plan Map

Explanation of Proposed Amendments

The proposed amendments to the Plan are associated with Apex Gateway – Phase 2C. This development plans to reconstruct New Hill Olive Chapel Road between New Hill Road and US 64, as displayed in Figure 2.

Add Proposed Side Path

The addition of side path is proposed along the east side of New Hill Olive Chapel Road between New Hill Road and Amberlight Road to provide an off-road bicycle and pedestrian connection to the existing greenway and sidewalk along Amberlight Road that connects to the Triangle Math and Science Academy K-8 and High School. This would replace the paved shoulder treatment, which is typically used in rural contexts, and is no longer applicable to this section of New Hill Olive Chapel Road, which is an entry to the Triangle Math and Science

STAFF REPORT

Transportation Plan Amendments

August 12, 2025 Town Council Meeting



Academy and a residential neighborhood. The proposed side path is displayed on the Apex Gateway – Phase 2C Construction Drawing Submittal in Figure 2.

Remove Proposed Paved Shoulder

While New Hill Road continues north of US 64 as NC 751, New Hill Olive Chapel Road dead ends at US 64. Bicycle facilities are not planned along US 64 due to safety concerns associated with the high-speed vehicular traffic and conflicts with future interchanges. Given the proposed addition of side path to New Hill Olive Chapel Road, and the lack of a connecting bicycle facility to the north, it is recommended to remove the proposed paved shoulder from this roadway. Proposed Paved Shoulder is maintained along New Hill Road and along New Hill Olive Chapel Road, south of New Hill Road.

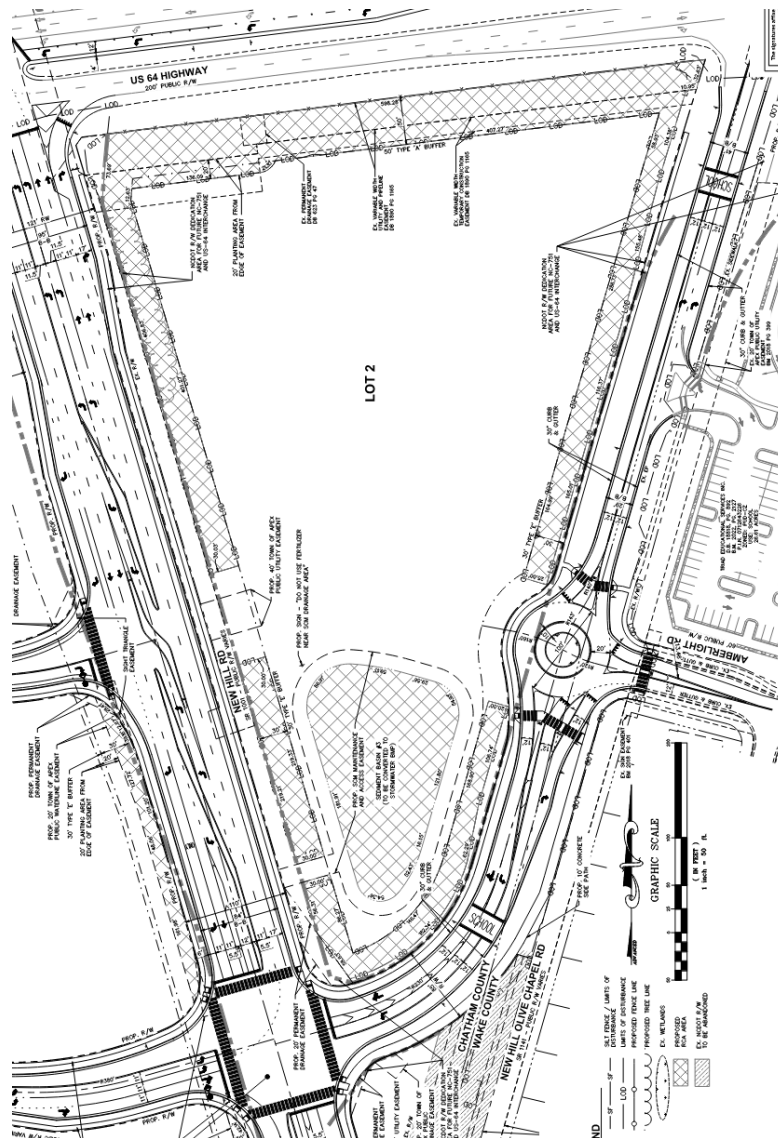

Figure 2. Apex Gateway - Phase 2C Construction Drawing Submittal Excerpt

STAFF REPORT

Transportation Plan Amendments

August 12, 2025 Town Council Meeting



Staff Recommendation:

Planning Department staff; Parks, Recreation, and Cultural Resources Department staff; and Transportation Infrastructure and Development staff recommend approval of the proposed amendments.

Planning Board Recommendation:

At their July 14, 2025, meeting, the Planning Board considered and unanimously recommended approval of the proposed amendments.