

**LEGEND**

- SUBJECT PARCEL
- ADJACENT PARCEL
- TIE LINE
- EASEMENT
- PUBLIC WATER EASEMENT
- PUBLIC SANITARY EASEMENT

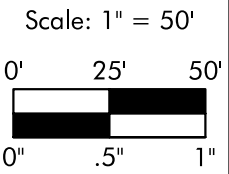

Prepared By:

**ACRO**  
 DEVELOPMENT SERVICES  
 LAND SURVEYING • CIVIL ENGINEERING

601 S. Cedar Street, Suite 101  
 Charlotte, NC 28202  
 980-224-8518  
 acro@acro-ds.com

NC Firm No. P-2329

ACRO Project Number:  
 2023-021

Survey Prepared For / Owner:  
**HENDRICK AUTOMOTIVE GROUP**

Project Location:  
 1210 Laura Village Drive,  
 Town of Apex, Wake County,  
 North Carolina

Project Name:  
**TAC Toyota Apex**

Date:  
 07/1/24

Sheet Title:  
**PUBLIC WATERLINE  
 AND SANITARY SEWER  
 EASEMENT DEDICATION**

Sheet Number:  
**2/2**

LINE TABLE		
LINE #	DIRECTION	LENGTH
L1	S66°24'10"W	40.23
L2	N56°23'54"W	23.79
L3	N66°24'10"E	44.83
L4	N21°24'10"E	193.05
L5	N01°05'50"W	22.33
L6	N22°24'48"W	18.95
L7	N67°24'48"W	111.93
L8	N22°07'13"E	20.00
L9	S67°24'48"E	120.38
L10	S22°24'48"E	31.00
L11	S01°05'50"E	30.07
L12	S21°24'10"W	205.31
L13	N77°10'43"W	30.40
L14	N22°06'40"E	98.52
L15	N44°51'41"W	41.98
L16	N69°20'06"E	32.89
L17	S44°51'41"E	48.35
L18	S22°06'40"W	113.46

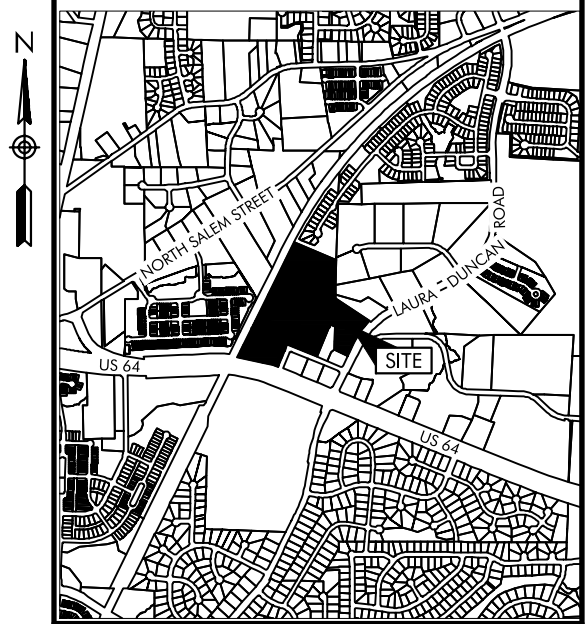

**NOMENCLATURE**

- B.M. BOOK OF MAPS
- P.N. PARCEL NUMBER
- PG. PAGE
- AC. ACRE
- D.B. DEED BOOK
- TYP TYPICAL
- SDE STORM DRAINAGE EASEMENT
- SSMH SANITARY SEWER MANHOLE
- MISC. MISCELLANEOUS
- RPOB REFERENCE POINT OF BEGINNING
- TPOB TRUE POINT OF BEGINNING

**NOTE**

THIS MAP MAY NOT BE A CERTIFIED SURVEY AND HAS NOT BEEN REVIEWED BY A LOCAL GOVERNMENT AGENCY FOR COMPLIANCE WITH ANY APPLICABLE LAND DEVELOPMENT REGULATIONS AND HAS NOT BEEN REVIEWED FOR COMPLIANCE WITH RECORDING REQUIREMENTS FOR PLATS.

**SURVEYOR'S CERTIFICATION**

I CERTIFY THAT THIS MAP WAS DRAWN UNDER MY SUPERVISION FROM AN ACTUAL SURVEY MADE UNDER MY SUPERVISION (DEED DESCRIPTIONS RECORDED IN THE DEEDS AND MAPS LISTED HEREON); THAT THE BOUNDARIES NOT SURVEYED ARE INDICATED AS DRAWN FROM DOCUMENTS REFERENCED HEREON; THAT THE RATIO OF PRECISION IS THAT OF A CLASS A SURVEY; THAT THIS GROUND SURVEY WAS PERFORMED AT THE 95 PERCENT CONFIDENCE LEVEL TO MEET FEDERAL GEOGRAPHIC DATA COMMITTEE STANDARDS; THAT THIS SURVEY WAS PERFORMED TO MEET THE REQUIREMENTS FOR A PLANIMETRIC SURVEY TO THE ACCURACY OF CLASS A AND THAT THIS MAP MEETS THE REQUIREMENTS OF THE STANDARDS OF PRACTICE FOR LAND SURVEYING IN NORTH CAROLINA (21 NCAC 56. 1600).

**MONUMENTATION**

- 1/2" REBAR FOUND UNLESS OTHERWISE STATED
- ◆ MAGNETIC NAIL FOUND

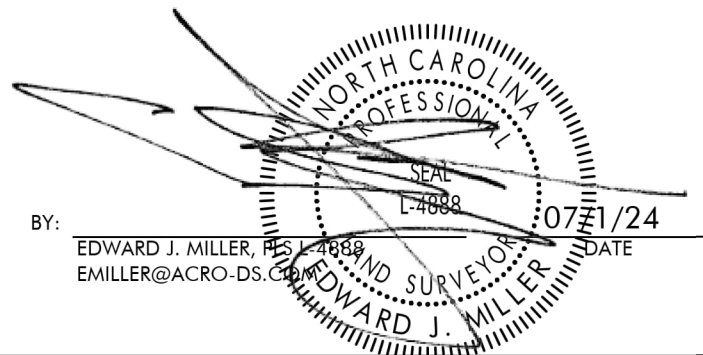

BY: EDWARD J. MILLER, PLS, L-4888 DATE 07/1/24  
 EMILLER@ACRO-DS.COM

Prepared By:

**ACRO**  
 DEVELOPMENT SERVICES  
 LAND SURVEYING • CIVIL ENGINEERING

601 S. Cedar Street, Suite 101  
 Charlotte, NC 28202  
 980-224-8518  
 acro@acro-ds.com

NC Firm No. P-2329

ACRO Project Number:  
 2023-021

Survey Prepared For / Owner:  
**HENDRICK AUTOMOTIVE GROUP**

Project Location:  
 1210 Laura Village Drive,  
 Town of Apex, Wake County,  
 North Carolina

Project Name:  
**TAC Toyota Apex**

Date:  
 07/1/24

Sheet Title:  
**PUBLIC WATERLINE  
 AND SANITARY SEWER  
 EASEMENT DEDICATION**

Sheet Number:  
**1/2**