

LAWRENCE PROPERTY LOT 1

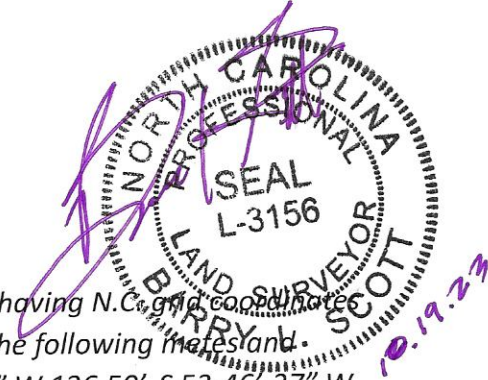

Beginning at a point on the Western R/W of Horton Rd. said point having N.C. grid coordinates of N= 702,451.03' & E= 2,012,535.45' NAD'83/2011; thence runs the following metes and bounds S 81-33'-19" W 219.74', S 53-46'-27" W 202.60', S 75-15'-45" W 136.50', S 53-46'-27" W 23.80', S 32-17'-09" W 40.95', S 53-46'-27" W 95.00', S 36-13'-33" E 140.03', S 60-03'-08" W 360.10', N 70-02'-56" W 190.98', N 01-32'-08" E 936.99', N 82-52'-11" E 788.76', S 84-51'-13" E 17.22', S 70-06'-05" E 42.08', S 54-48'-14" E 42.69', S 38-39'-12" E 41.12', S 22-54'-39" E 43.63', S 14-54'-41" E 47.61', S 13-58'-01" E 49.70', S 13-35'-09" E 49.88', S 13-36'-24" E 50.13', S 13-55'-12" E 49.99', S 13-41'-55" E 49.99', S 13-36'-55" E 49.72', S 12-38'-19" E 49.06', S 10-05'-34" E 18.22' to the point and place of beginning. This parcel contains 742,949 sq. ft. or 17.06 acres

HORTON RD. R/W

Beginning at a point on the Western R/W of Horton Rd. said point having N.C. grid coordinates N= 702,451.03' & E= 2,012,535.45' NAD '83/2011; thence runs the following metes and bounds N 10-05'-34" W 18.22', N 12-38'-19" W 49.06', N 13-36'-55" W 49.72', N 13-41'-55" W 49.99', N 13-55'-12" W 49.99', N 13-36'-24" W 50.13', N 13-35'-09" W 49.88', N 13-58'-01" W 49.70', N 14-54'-41" W 47.61', N 22-54'-39" W 43.63', N 38-39'-12" W 41.12', N 50-59'-03" E 30.00', S 38-39'-12" E 45.46", S 22-54'-39" E 49.88', S 14-54'-41" E 49.95', S 13-58'-01" E 50.05', S 13-35'-09" E 49.97, S 13-36'-24" E 50.04', S 13-55'-12" E 49.97, S 13-41'-55" E 50.07', S 13-36'-51" E 50.00', S 12-38'-19" E 49.98', S 10-05'-34" E 19.75', S 81-33'-19" W 30.01' to the point and place of beginning. This description is the Western 1/2 of Horton Rd. (based on a 60' R/W), along the Lawrence frontage and contains 15,213 sq. ft. or 0.35 acres.

LAWRENCE LOT 1 & R/W

Beginning at point on the Western R/W of Horton Rd. said point having N.C. grid coordinates of N=702,451.03' & E=2,012,535.45' NAD'83/2011; thence runs the following metes & bounds; S 81-33'-19" W 219.74', S 53-46'-27" W 202.60', S 75-15'-45" W 136.50', S 53-46'-27" W 23.80', S 32-17'-09" W 40.95', S 53-46'-27" W 95.00', S 36-13'-33" E 140.03', S 60-03'-08" W 360.10' N 70-02'-56" W 190.98', N 01-32'-08" E 936.99', N 82-52'-11" E 788.76', S 84-51'-13" E 17.22', S 70-06'-05" E 42.08', S 54-48'-14" E 42.69', N 50-59'-03" E 30.00', S 38-39'-12" E 45.46', S 22-54'-39" E 49.88', S 14-54'-41" E 49.95', S 13-58'-01" E 50.05', S 13-35'-09" E 49.97', S 13-36'-24" E 50.04', S 13-55'-12" E 49.97', S 13-41'-55" E 50.07', S 13-36'-51" E 50.00', S 12-38'-19" E 49.98', S 10-05'-34" E 19.75', S 81-33'-19" W 30.01' to the point and place of beginning. This description is lot 1 & the Western 1/2 of Horton Rd. R/W containing 758,162 sq. ft. or 17.41 acres.