

PAVED PARKING, 90°

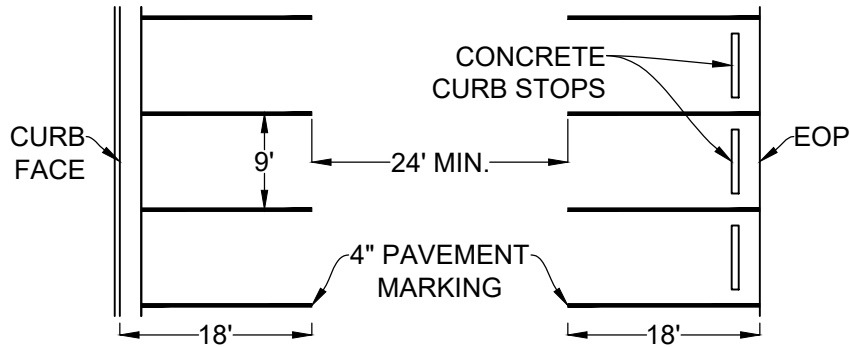

PAVEMENT LOT STRUCTURE
 2" ASPHALT SURFACE COARSE
 6" AGGREGATE BASE COARSE
 COMPACTED SUBGRADE

GRAVEL PARKING

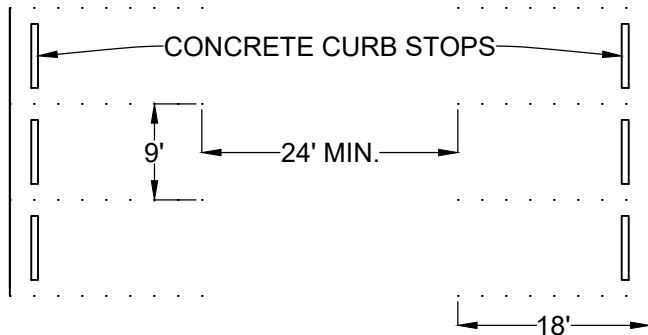

GRAVEL LOT STRUCTURE
 1.5" #78M STONE
 6" AGGREGATE BASE COARSE
 COMPACTED SUBGRADE

PAVED PARKING, PARALLEL

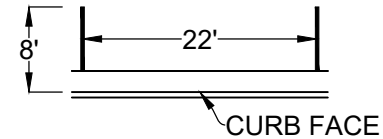

NOTES FOR PAVED PARKING LOTS:

1. CONCRETE STOP NOT REQUIRED IF CURB IS USED. IF SIDEWALK IS AGAINST BACK OF CURB, A MINIMUM 6' WIDTH IS REQUIRED WITHOUT CURB STOPS.
2. AN ELECTRIC PLAN MUST BE SUBMITTED TO THE PLANNING AND ELECTRIC DEPARTMENTS FOR APPROVAL.
3. A PLANTING PLAN MUST BE SUBMITTED TO THE PLANNING DEPARTMENT FOR APPROVAL.
4. NUMBER OF REQUIRED ADA SPACES FOR PAVED PARKING AREAS ARE LISTED IN THE CURRENT NC BUILDING CODE.
5. ALL ADA PARKING SPACES MUST DIRECTLY CONNECT TO PUBLIC ACCESS ROUTES THAT MEET ADA REQUIREMENTS.
6. ADA PARKING SPACES MUST MEET ADA DIMENSIONS.

NOTES FOR GRAVEL PARKING LOTS:

1. DRIVE AISLES MUST BE REPAIRED OR REPLACED WITH #78M STONE EVERY SIX (6) MONTHS.
2. AN ELECTRIC PLAN MUST BE SUBMITTED TO THE PLANNING AND ELECTRIC DEPARTMENTS FOR APPROVAL.
3. A PLANTING PLAN MUST BE SUBMITTED TO THE PLANNING DEPARTMENT FOR APPROVAL.

RESIDENTIAL STREET

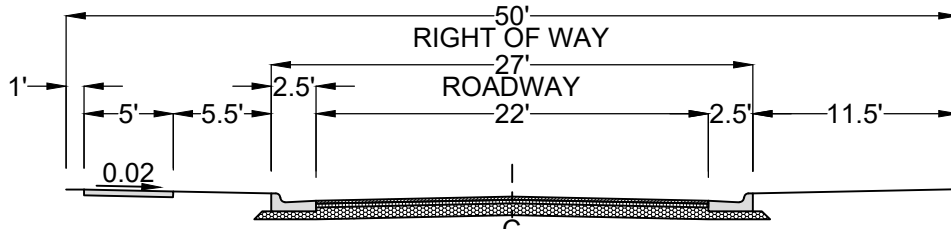

PAVEMENT DESIGN:
 2" ASPHALT CONCRETE SURFACE COURSE
 2.5" ASPHALT CONCRETE INTERMEDIATE COURSE
 8" AGGREGATE BASE COURSE

ALLEY

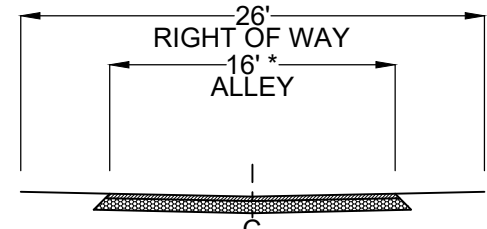

PAVEMENT DESIGN:
 3" ASPHALT CONCRETE SURFACE COURSE
 8" AGGREGATE BASE COURSE
 * ONE WAY ALLEY OPTIONAL WITH VALLEY GUTTER (16' B-B)

RURAL RESIDENTIAL STREET

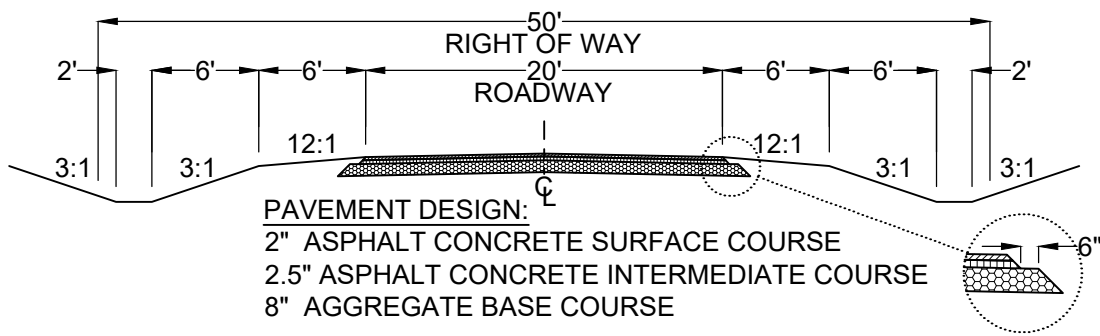

PAVEMENT DESIGN:
 2" ASPHALT CONCRETE SURFACE COURSE
 2.5" ASPHALT CONCRETE INTERMEDIATE COURSE
 8" AGGREGATE BASE COURSE

NOTE:

1. NORMAL CROWN (REVERSE CROWN FOR ALLEYS) OF 1/4 INCH PER FOOT SHALL BE USED UNLESS OTHERWISE DIRECTED BY TOWN ENGINEER.
2. WATER AND SEWER UTILITIES SHALL NOT BE SERVED FROM THE ALLEY RIGHT OF WAY.
3. RURAL RESIDENTIAL STREET MAY BE USED WHERE PERMITTED BY THE UDO.
4. GRASSED SWALES SHALL MEET THE APPLICABLE DESIGN REQUIREMENTS SET FORTH IN THE DWQ BMP MANUAL.
5. GRASSED SWALES MAY BE SUBJECT TO THE REQUIREMENTS SET FORTH IN UDO SECTION 6.1.12.

MINOR COLLECTOR STREET

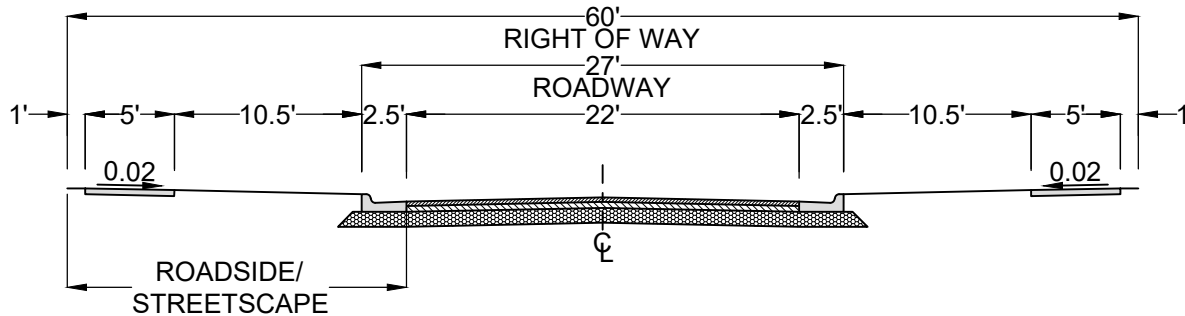

MAJOR COLLECTOR STREET / 2-LANE URBAN THOROUGHFARE

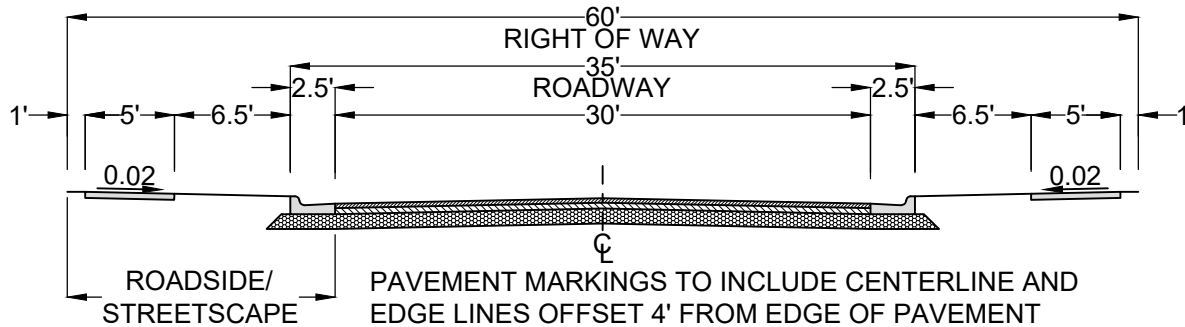

2-LANE RURAL THOROUGHFARE

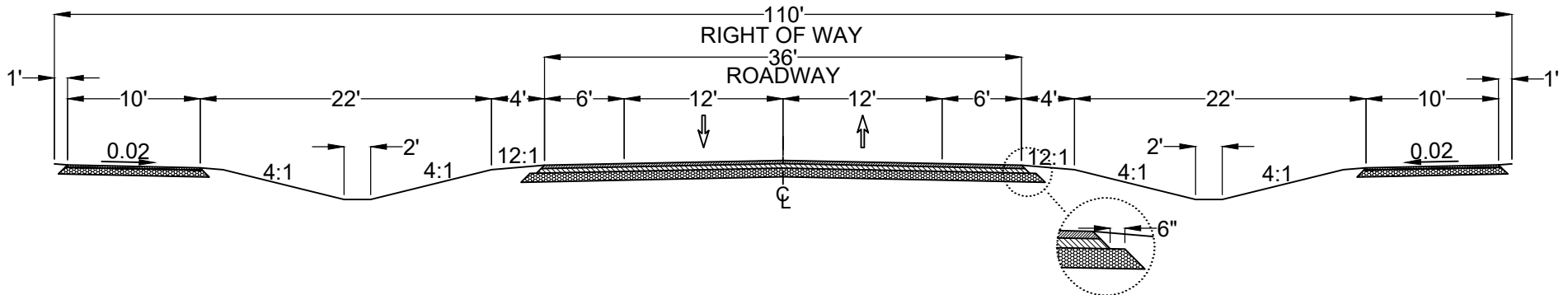

NOTE:

1. PAVEMENT DESIGN SHOWN IS THE MINIMUM FOR THE RESPECTIVE TYPICAL SECTION. CALCULATED PAVEMENT DESIGN MAY DIFFER.
2. NORMAL CROWN OF 1/4 INCH PER FOOT SHALL BE USED UNLESS OTHERWISE DIRECTED BY TOWN ENGINEER.
3. ROADSIDE/STREETSCAPE TREATMENTS ARE CONTEXT SENSITIVE. REFER TO ADVANCE APEX: THE 2045 TRANSPORTATION PLAN FOR APPROPRIATE CONTEXT, AND BICYCLE AND PEDESTRIAN PLANNED FACILITIES MAP.

PAVEMENT DESIGN:

- 3" ASPHALT CONCRETE SURFACE COURSE
- 4" ASPHALT CONCRETE INTERMEDIATE COURSE
- 10" AGGREGATE BASE COURSE

3-LANE THOROUGHFARE

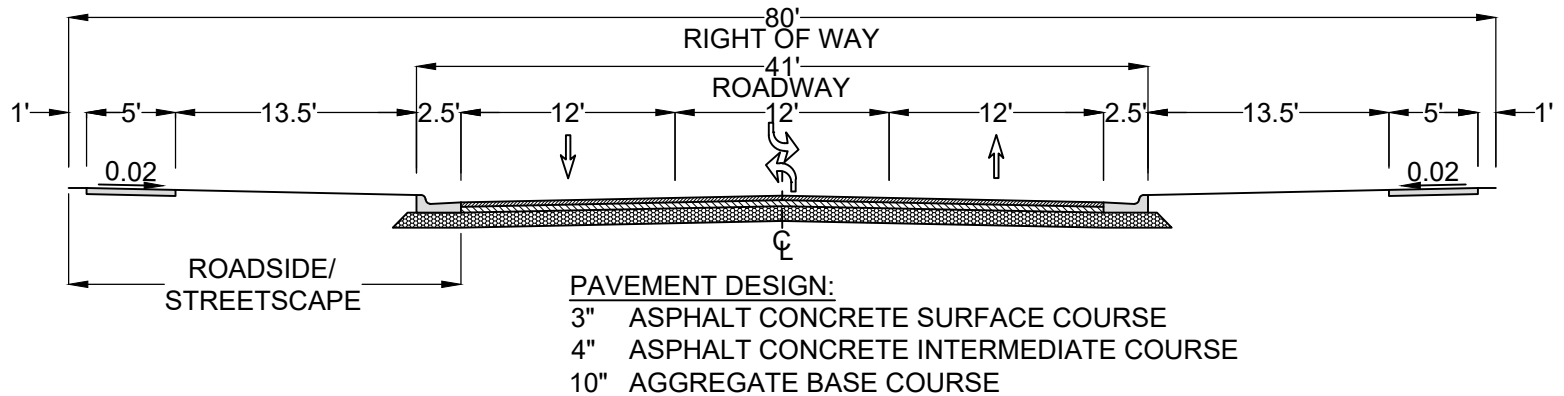

6-LANE THOROUGHFARE

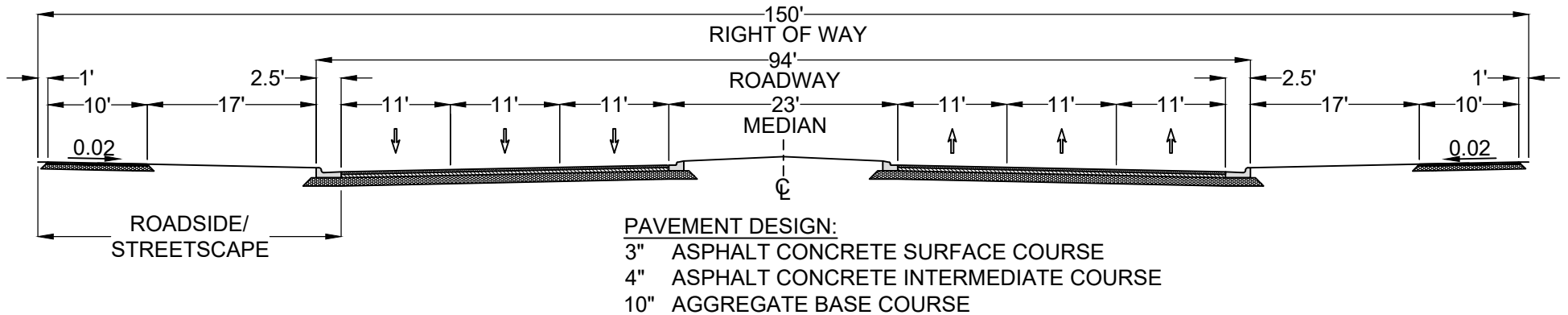

NOTE:

1. PAVEMENT DESIGN SHOWN IS THE MINIMUM FOR THE RESPECTIVE TYPICAL SECTION. CALCULATED PAVEMENT DESIGN MAY DIFFER.
2. NORMAL CROWN OF 1/4 INCH PER FOOT SHALL BE USED UNLESS OTHERWISE DIRECTED BY TOWN ENGINEER.
3. LANE WIDTHS SHALL BE MARKED PER THE DIMENSIONS SHOWN.
4. ROADSIDE/STREETSCAPE TREATMENTS ARE CONTEXT SENSITIVE. REFER TO ADVANCE APEX: THE 2045 TRANSPORTATION PLAN FOR APPROPRIATE CONTEXT, AND BICYCLE AND PEDESTRIAN PLANNED FACILITIES MAP.

APEX PEAKWAY

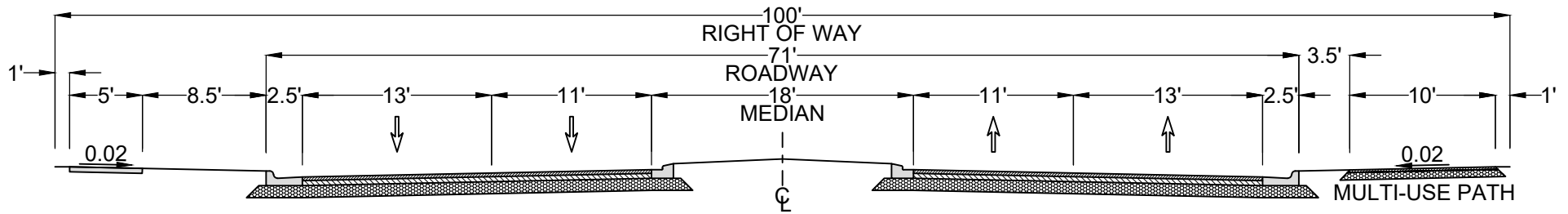

PAVEMENT DESIGN:
 3" ASPHALT CONCRETE SURFACE COURSE
 4" ASPHALT CONCRETE INTERMEDIATE COURSE
 10" AGGREGATE BASE COURSE

MULTI-USE PATH PAVEMENT DESIGN:
 2" ASPHALT CONCRETE SURFACE COURSE
 6" AGGREGATE BASE COURSE

4-LANE MEDIAN-DIVIDED THOROUGHFARE

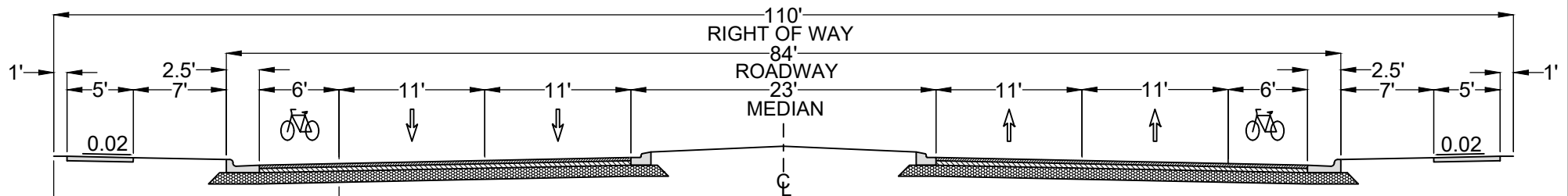

PAVEMENT DESIGN:
 3" ASPHALT CONCRETE SURFACE COURSE
 4" ASPHALT CONCRETE INTERMEDIATE COURSE
 10" AGGREGATE BASE COURSE

NOTE:

1. PAVEMENT DESIGN SHOWN IS THE MINIMUM FOR THE RESPECTIVE TYPICAL SECTION. CALCULATED PAVEMENT DESIGN MAY DIFFER.
2. NORMAL CROWN OF 1/4 INCH PER FOOT SHALL BE USED UNLESS OTHERWISE DIRECTED BY TOWN ENGINEER.
3. LANE WIDTHS SHALL BE MARKED PER THE DIMENSIONS SHOWN.
4. APEX PEAKWAY SHALL UTILIZE THE 4-LANE MEDIAN-DIVIDED THOROUGHFARE WITH MULTI-USE PATH TYPICAL.
5. ROADSIDE/STREETSCAPE TREATMENTS ARE CONTEXT SENSITIVE. REFER TO ADVANCE APEX: THE 2045 TRANSPORTATION PLAN FOR APPROPRIATE CONTEXT, AND BICYCLE AND PEDESTRIAN PLANNED FACILITIES MAP.
6. A MINIMUM 4-FOOT WIDE BIKE LANE CAN BE USED IN TOWN CENTER AND TRANSIT-ORIENTED DEVELOPMENT CONTEXT AREAS IF ADJACENT TO A STANDARD CURB AND GUTTER SECTION AND WITHOUT A PARKING LANE.

**TOWN OF APEX
STANDARDS**

EFFECTIVE: NOVEMBER 19, 2019

**STREET TYPICAL SECTIONS
4-LANE THOROUGHFARE**

STD. NO.

300.01

SHEET 4 OF 4

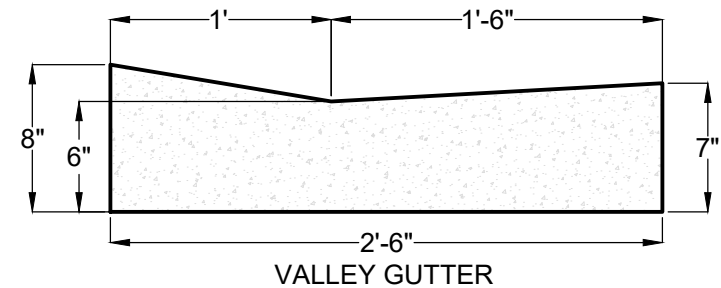
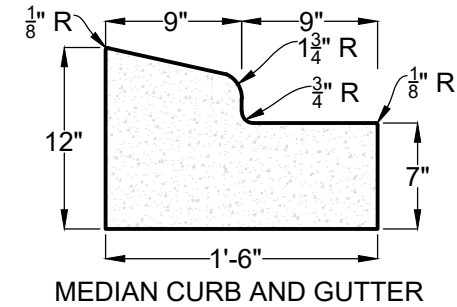
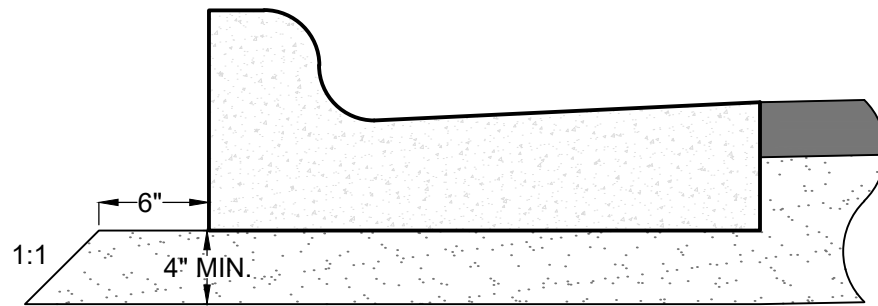
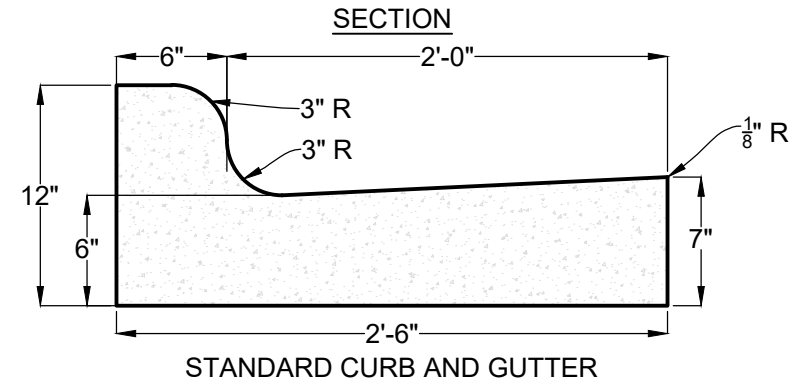
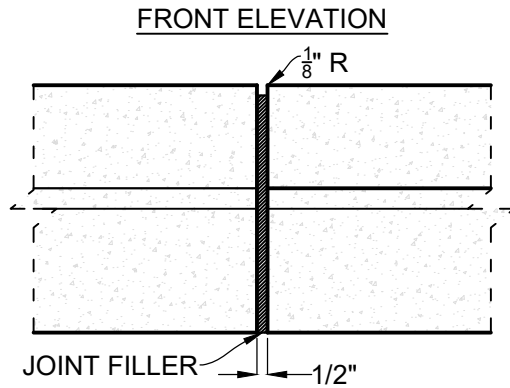

NOTES:

1. CONCRETE SHALL BE 3000 PSI.
2. CONTRACTION JOINTS SHALL BE SPACED AT 10' INTERVALS OR 15' INTERVALS WHEN A MACHINE IS USED.
3. EXPANSION JOINTS SHALL BE SPACED AT 50' INTERVALS.
4. FINISH ALL CONCRETE WITH CURING COMPOUND.
5. FOLLOW ALL APPLICABLE ACI REQUIREMENTS.
6. VALLEY CURB SHALL ONLY BE USED FOR APPROVED APPLICATIONS.

**TOWN OF APEX
STANDARDS**

EFFECTIVE: NOVEMBER 19, 2019

CONCRETE CURB AND GUTTER

STD. NO.

300.03

SHEET 1 OF 1

TYPICAL REGULATORY SIGNS

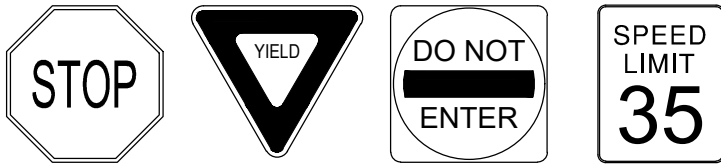

SIGN SIZES	APPROACH TYPE	
	SINGLE LANE	MULTI-LANE
R1-1 (STOP)	30" x 30"	36" x 36"
R1-2 (YIELD)	36" x 36" x 36"	48" x 48" x 48"
R5-1 (DO NOT ENTER)	30" x 30"	36" x 36"
R2-1 (SPEED LIMIT)	24" x 30"	30" x 36"

* FOR OTHER TYPES OF REGULATORY SIGNS CONSULT THE MUTCD

CROSSWALK SIGNS

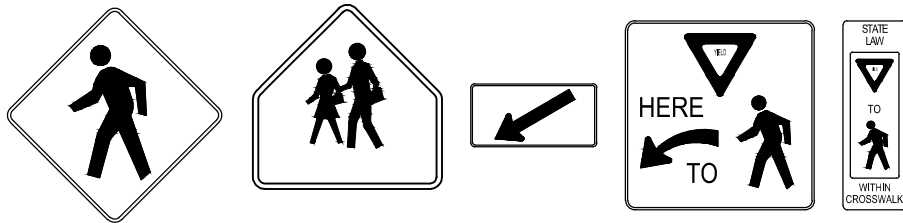

SIGN SIZES	APPROACH TYPE	
	SINGLE LANE	MULTI-LANE
W11-2 (PEDESTRIAN)	30" x 30"	36" x 36"
S1-1 (SCHOOL)	36" x 36"	36" x 36"
W16-7P (ARROW PLAQUE)	24" x 12"	24" x 12"
R1-5 (YIELD HERE TO PEDS)	36" x 36"	36" x 36"
R1-6/R1-6B (IN-STREET CROSSING)	12" x 36"	12" x 36"

POST-MOUNTED STREET NAME SIGN (D3-1)

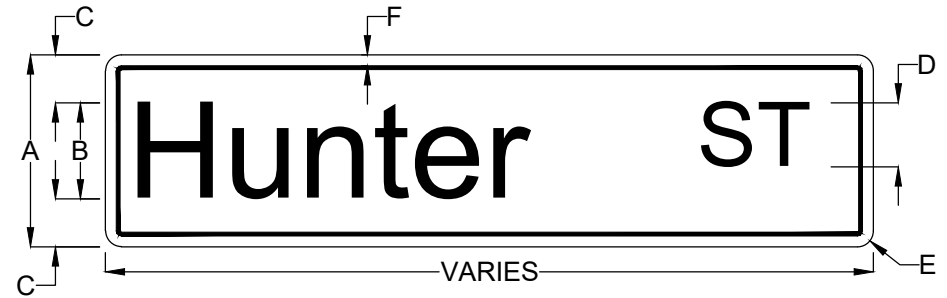

SIGN TYPE	SIGN DIMENSIONS					
	A	B	C	D	E	F
STANDARD	9"	6"	1.5"	4"	0.75"	0.5"
MULTI-LANE (> 40 MPH)	12"	8"	2"	6"	0.75"	0.5"

NOTES:

1. SHEETING MATERIAL FOR ALL SIGNS SHALL BE HIGH INTENSITY PRISMATIC (HIP) TYPE IV MULTI-LAYER SHEETING.
2. ALL STREET NAME SIGNS INSTALLED IN RESIDENTIAL AREAS SHALL COMPLY WITH STANDARD DIMENSIONS. STREET NAME SIGNS SHALL BE GREEN WITH WHITE LEGEND AND BORDER. LETTERING SHALL BE COMPOSED OF UPPER AND LOWER-CASE LETTERS. LOWER-CASE LETTERS SHALL BE 75% THE HEIGHT OF UPPER-CASE LETTERS. STREET SUFFIXES SHALL BE UPPER-CASE LETTERS. FONT TYPE SHALL BE HIGHWAY GOTHIC SERIES C. 36-INCH BLADES SHALL BE STANDARD FOR STREET NAMES, WITH 15 CHARACTERS OR LESS.
3. STREET NAME SIGNS SHALL BE FABRICATED USING WHITE (HIP) SHEETING AS A BASE LAYER WITH GREEN (HIP) SHEETING OVERLAYED. THE LEGEND SHALL BE DIGITALLY CUT OR PRINTED FROM THE OVERLAY LAYER.
4. SCHOOL CROSSING SIGNS SHALL HAVE A FLUORESCENT YELLOW-GREEN BACKGROUND WITH BLACK LEGEND AND BORDERS.
5. IF IN-STREET CROSSING SIGNS ARE USED IN SCHOOL AREAS, R1-6B SIGN SHALL BE USED INSTEAD OF R1-6 SIGN.
6. REFER TO MUTCD FOR ALL OTHER GUIDANCE.

SIGN PLACEMENT

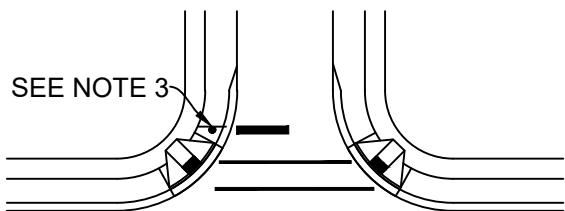
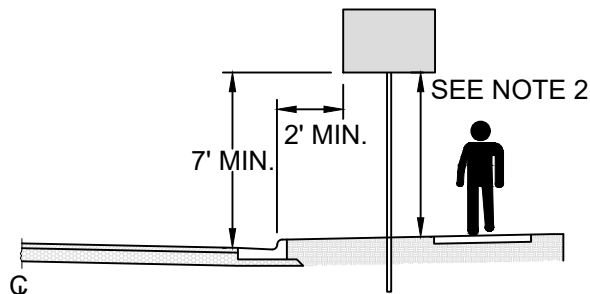
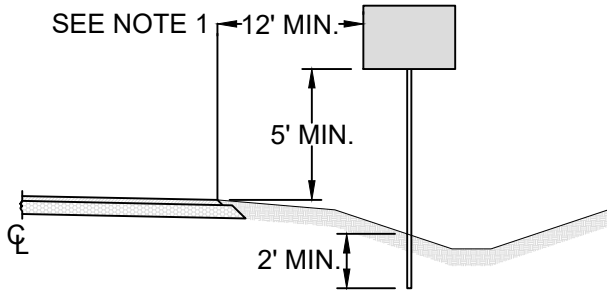

MAJOR ROAD

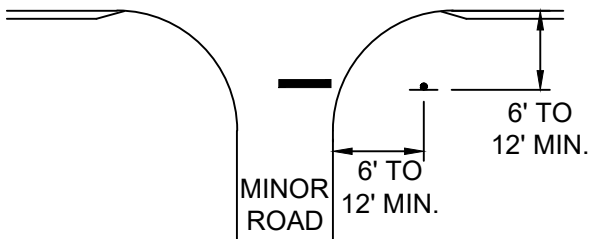

SIGN MOUNTING DETAIL

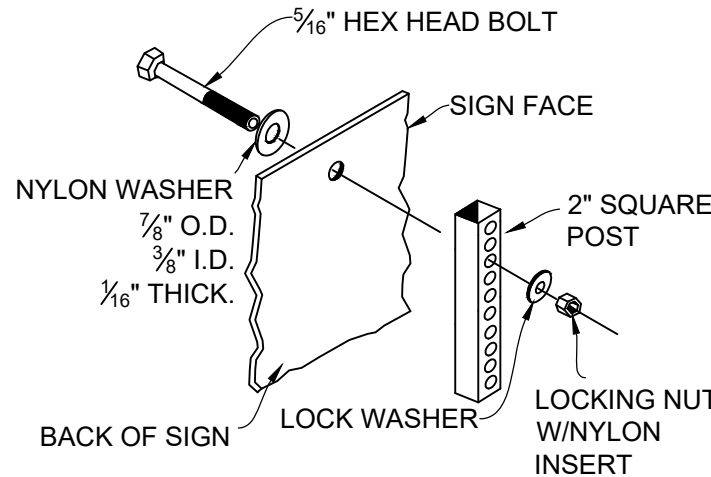

RETROFIT ASSEMBLY DETAIL (TOWN USE ONLY)

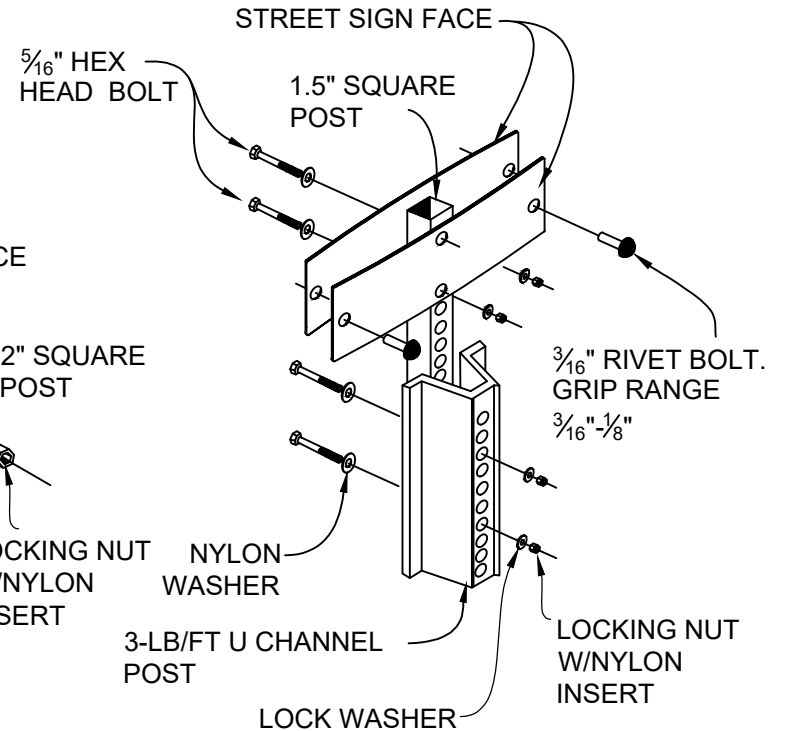

NOTES:

1. MINIMUM LATERAL OFFSET FROM EDGE OF TRAVELED WAY SHOULD BE 12 FEET.
2. ON CURB SECTIONS PROVIDE A MINIMUM VERTICAL CLEARANCE OF 7 FEET FROM EDGE OF TRAVELED WAY. WHERE SIDEWALKS ARE PRESENT PROVIDE A MINIMUM VERTICAL CLEARANCE OF 7 FEET FROM EDGE OF TRAVELED WAY OR TOP OF SIDEWALK, WHICHEVER IS HIGHER.
3. WHERE CROSSWALKS EXIST, SIGNS SHOULD BE PLACED WITHIN 4 FEET IN ADVANCE OF THE CROSSWALK. STREET NAME SIGNS MAY BE PLACED ABOVE A REGULATORY STOP OR YIELD SIGN WITH NO REQUIRED VERTICAL SEPARATION.
4. ALL NEW SIGNS SHALL BE POSTED ON 14 GAUGE, 2" PERFORATED SQUARE SIGN POSTS. ALL STREET NAME SIGNS RETROFITTED TO EXISTING U-CHANNEL SHALL BE POSTED ON 1.5" SQUARE SIGN POSTS. SIGN RETOROFITTING SHALL BE FOR TOWN USE ONLY.
5. ON ALL ROADWAYS EXCEPT STREETS WITH STANDARD CURB AND GUTTER AND SPEED LIMITS EQUAL TO OR LESS THAN 25 MPH, ALL SIGNS WITHIN CLEAR ZONE SHALL BE OF A BREAKAWAY DESIGN THAT COMPLIES WITH THE LATEST EDITION OF AASHTO MANUAL FOR ASSESSING SAFETY HARDWARE (MASH) AND NCHRP REPORT 350.

TOWN OF APEX
STANDARDS

EFFECTIVE: NOVEMBER 19, 2019

STREET SIGNS
PLACEMENT & INSTALLATION

STD. NO.

300.26

SHEET 2 OF 4

OCTAGON

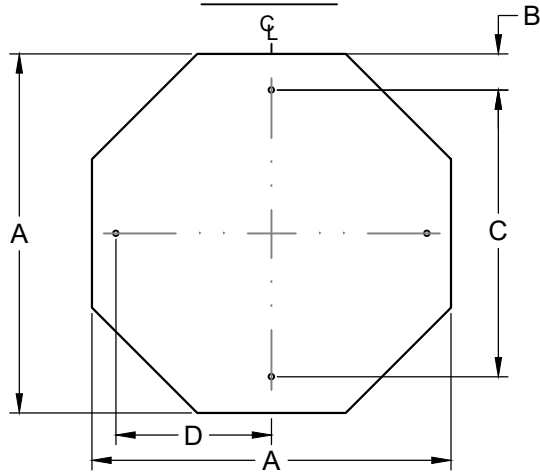

A	B	C	D
30"	3"	24"	-
36"	3"	30"	16"

DIAMOND

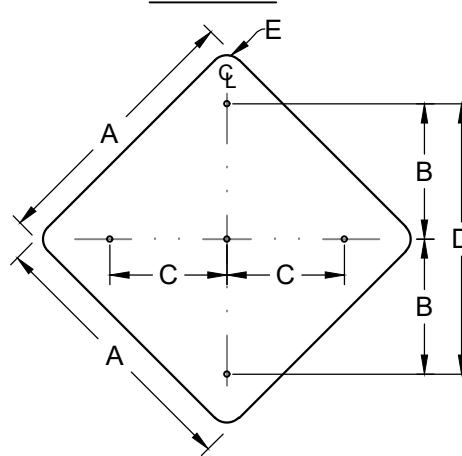

A	B	C	D	E
18"/24"	-	-	18"/24"	1.5"
30"	15"	16"	-	1.875"
36"	18"	16"	-	2.25"

VERTICAL RECTANGLE

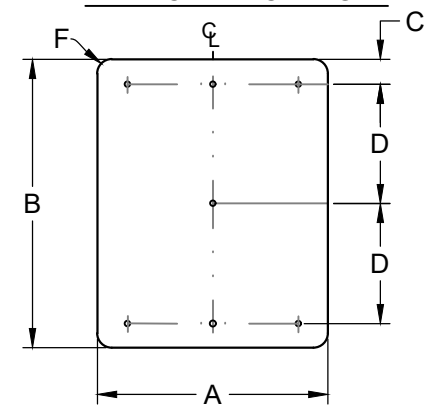

A	B	C	D	E	F
12"	18"	1.5"	-	-	1.5"
18"	24"	1.5"	-	-	1.5"
24"	30"	3"	-	-	1.5"
30"	36"	3"	15"	-	1.875"
36"	42"	3"	18"	16"	2.25"

PENTAGON (SCHOOL)

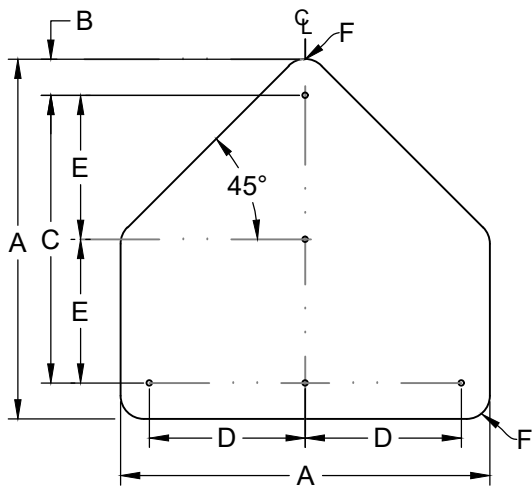

A	B	C	D	E	F
30"	3"	24"	-	-	1.875"
36"	3"	-	16"	15"	2.25"

SQUARE

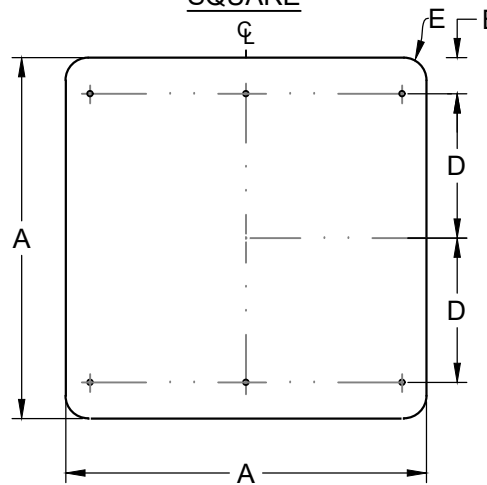

A	B	C	D	E
12"	1"	-	-	1.5"
18" / 24"	1.5"	-	-	1.5"
30"	3"	-	-	1.875"
36"	3"	16"	15"	2.25"

EQUILATERAL TRIANGLE

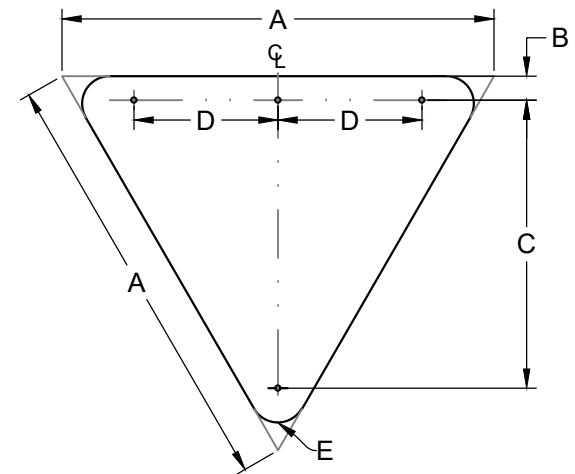

A	B	C	D	E
36"	2"	24"	-	1.5"
48"	3"	32"	16"	1.5"

BREAKAWAY SIGN
PLACEMENT

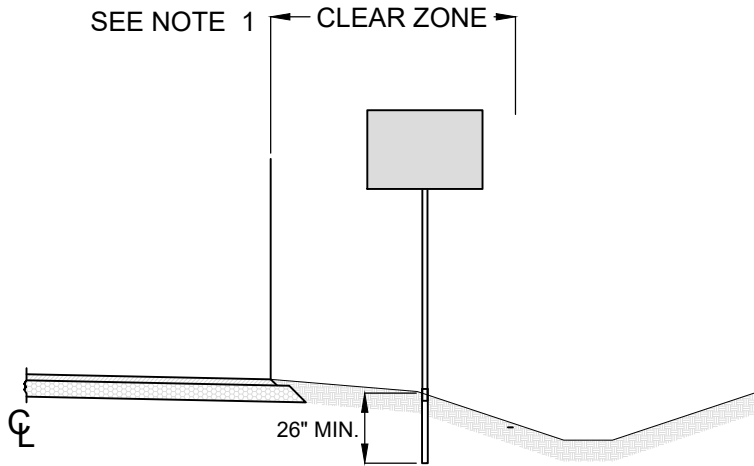

POST INSTALLATION

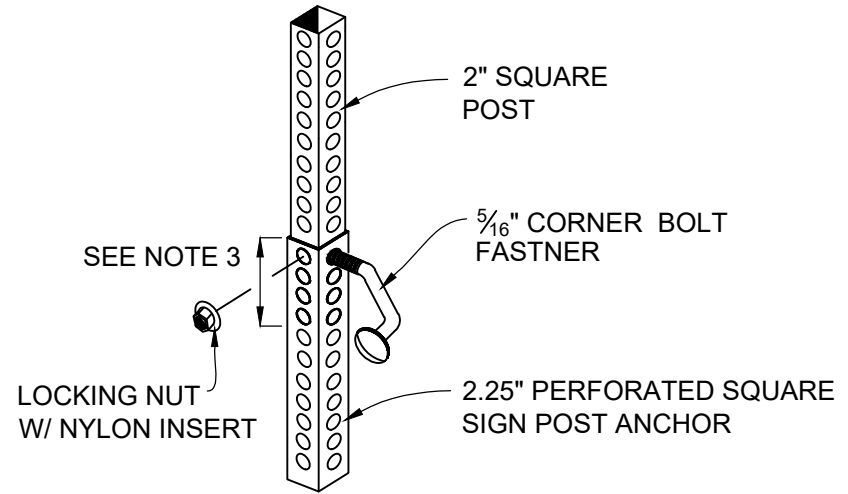

ANCHOR INSTALLATION

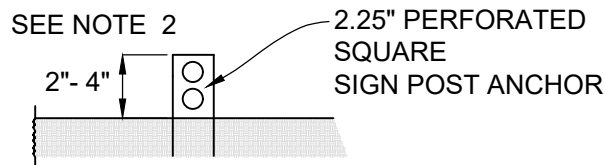

NOTES:

1. ON ALL ROADWAYS EXCEPT STREETS WITH STANDARD CURB AND GUTTER AND SPEED LIMITS EQUAL TO OR LESS THAN 25 MPH, ALL SIGNS WITHIN CLEAR ZONE SHALL BE OF A BREAKAWAY DESIGN THAT COMPLIES WITH THE LATEST EDITION OF AASHTO MANUAL FOR ASSESSING SAFETY HARDWARE (MASH) AND NCHRP REPORT 350.
2. DRIVE ANCHOR MINIMUM 26 INCHES INTO THE GROUND. LEAVE 2 INCHES MINIMUM TO 4 INCHES MAXIMUM TO PROTRUDE ABOVE SURFACE.
3. FIT POST INTO ANCHOR. FASTEN CORNER BOLT THROUGH THE FOURTH HOLE ON THE POST AND THE FIRST HOLE ON THE ANCHOR.

SECTION A-A

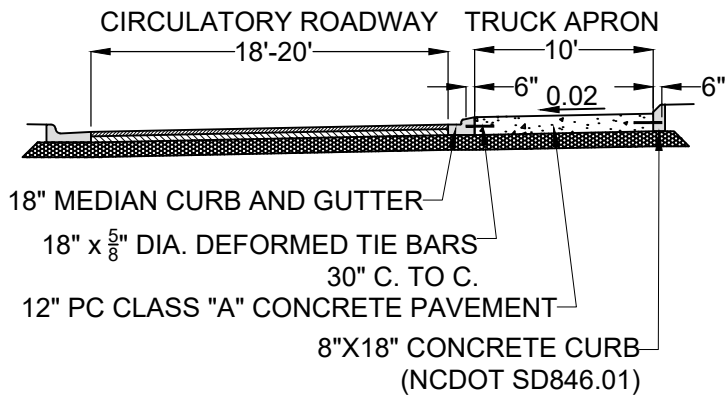

YIELD LINE DETAIL

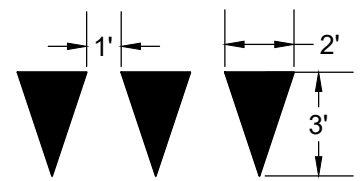

R6-4 DETAIL

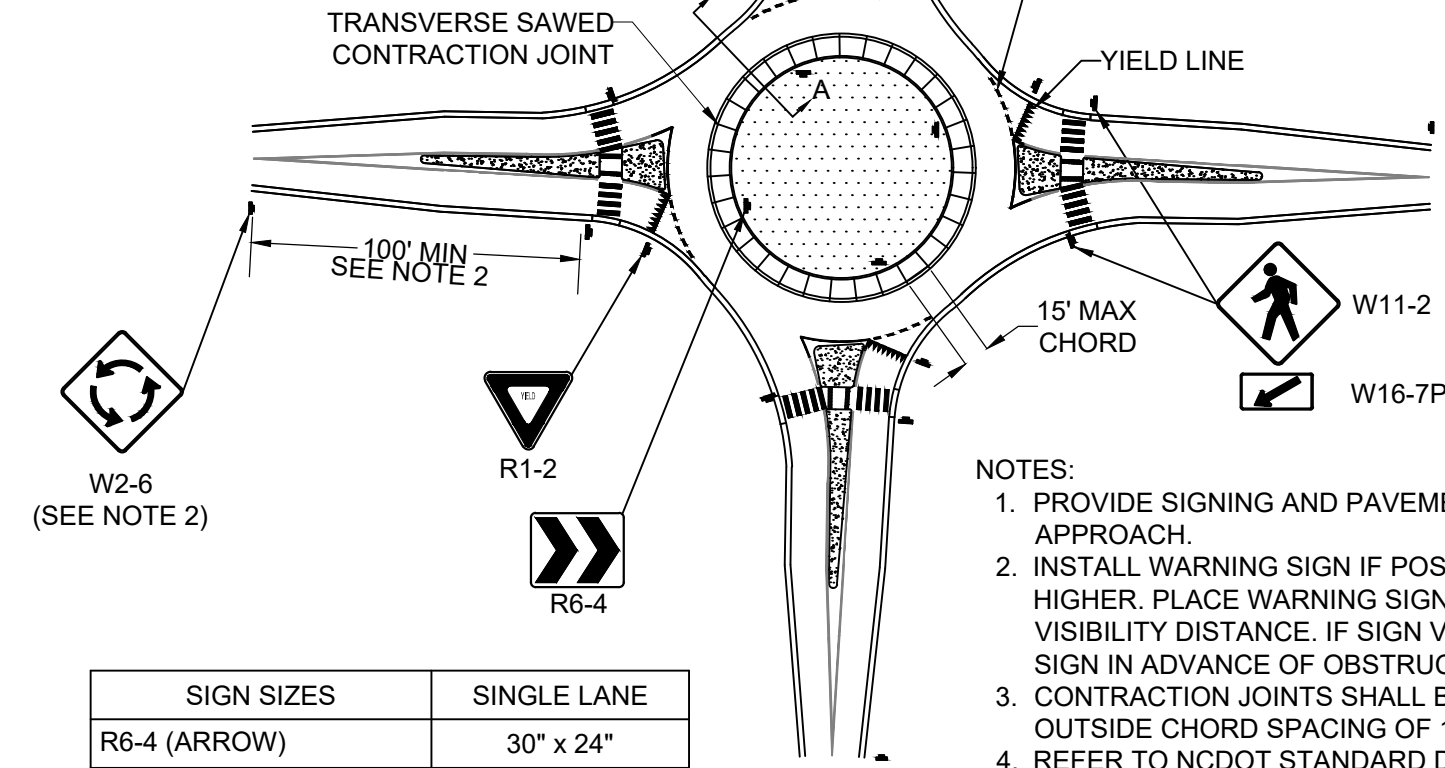
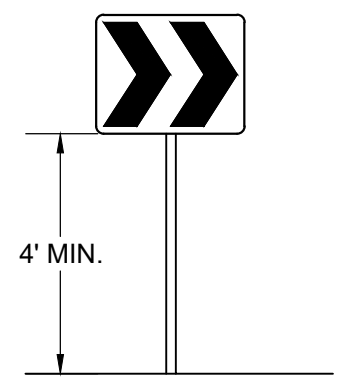

- NOTES:
1. PROVIDE SIGNING AND PAVEMENT MARKINGS ON EACH LEG OF THE APPROACH.
 2. INSTALL WARNING SIGN IF POSTED SPEED LIMIT IS 40 MPH OR HIGHER. PLACE WARNING SIGN TO PROVIDE 180 FEET MINIMUM VISIBILITY DISTANCE. IF SIGN VISIBILITY IS OBSTRUCTED, PLACE SIGN IN ADVANCE OF OBSTRUCTION.
 3. CONTRACTION JOINTS SHALL BE EQUALLY SPACED, WITH MAX OUTSIDE CHORD SPACING OF 15 FEET.
 4. REFER TO NCDOT STANDARD DRAWINGS 700.01 FOR TRANSVERSE CONTRACTION JOINT DETAIL.

SIGN SIZES	SINGLE LANE
R6-4 (ARROW)	30" x 24"
W2-6 (INTERSECTION)	30" x 30"

TOWN OF APEX
STANDARDS

EFFECTIVE: NOVEMBER 19, 2019

SINGLE-LANE ROUNDABOUT

STD. NO.

300.29

SHEET 1 OF 1

PLAN VIEW

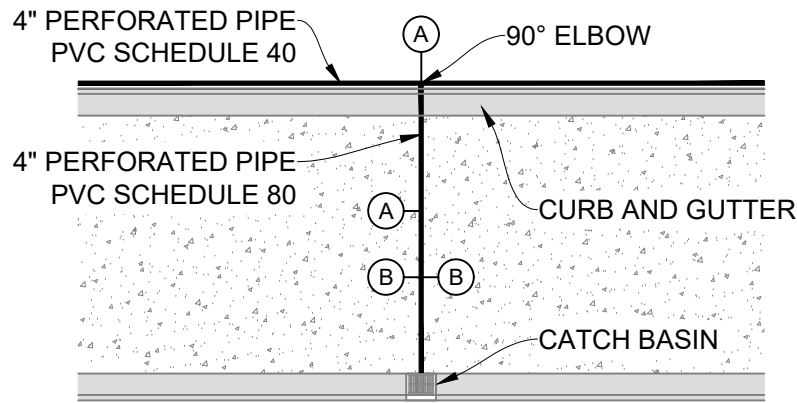

SECTION A-A

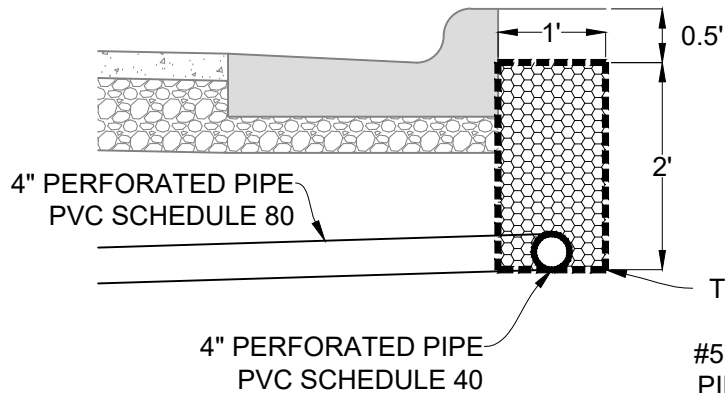

2 FEET MIN. COVER

TYPE 1 GEOTEXTILE FABRIC (NON-WOVEN)
#57 STONE, WRAP STONE AND PIPE W/ 6" MINIMUM OVERLAP

SECTION B-B

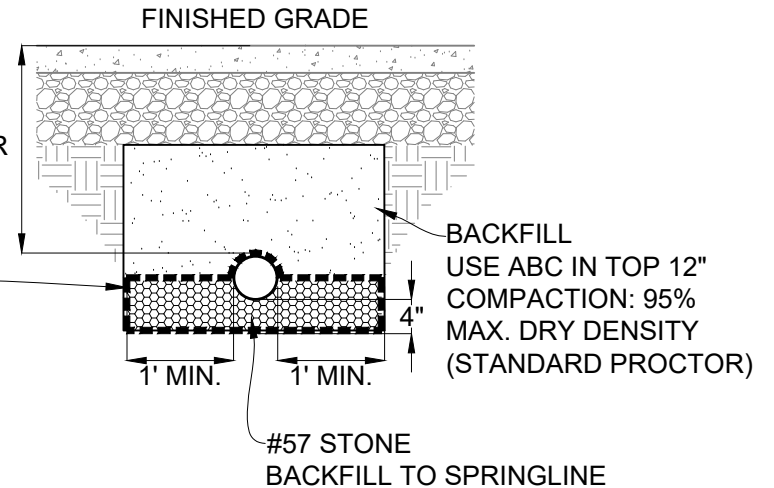

BACKFILL
USE ABC IN TOP 12"
COMPACTION: 95%
MAX. DRY DENSITY
(STANDARD PROCTOR)

#57 STONE
BACKFILL TO SPRINGLINE

NOTE:

1. UNDERDRAINS ARE REQUIRED WHERE DETERMINED BY THE ENGINEER.
2. CONNECT UNDERDRAIN PIPE TO STORM DRAIN CATCH BASIN.
3. BACKFILL MATERIAL SHALL BE APPROVED SUITABLE MATERIAL.

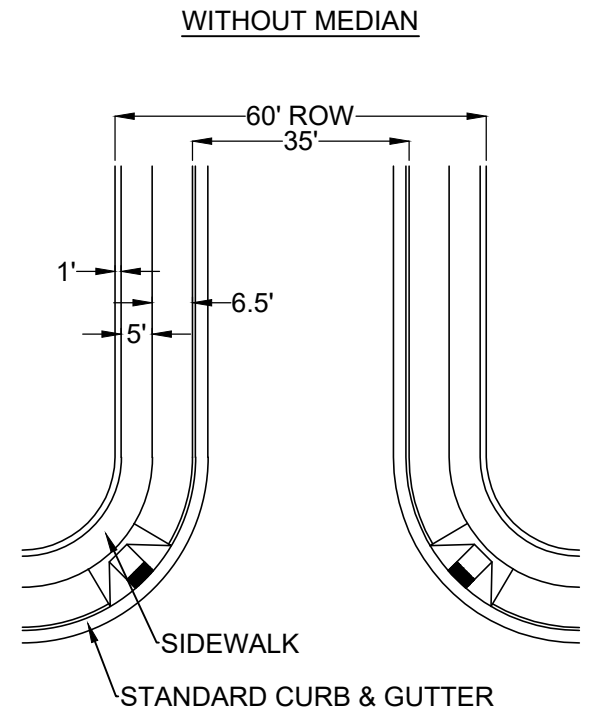
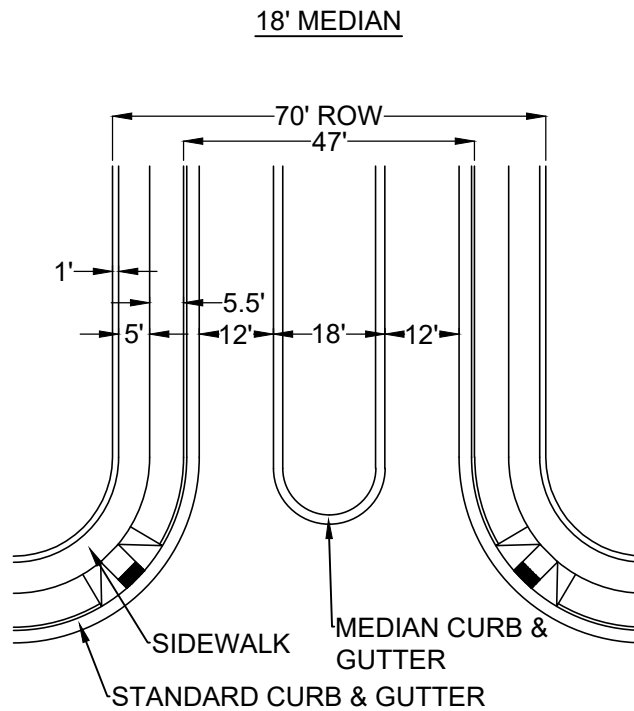
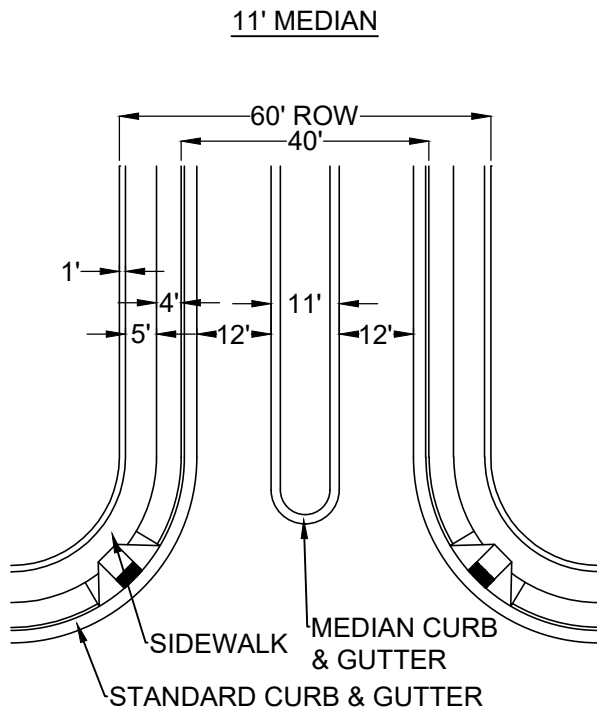

NOTES:

1. MEDIAN REQUIRED FOR MAIN ENTRANCE TO DEVELOPMENTS WITH MORE THAN 50 LOTS.
2. FOR ENTRANCE WITHOUT MEDIAN, USE 35' B-B WIDTH FOR FIRST BLOCK OF DEVELOPMENT OR AS OTHERWISE APPROVED.