

**VICINITY MAP**

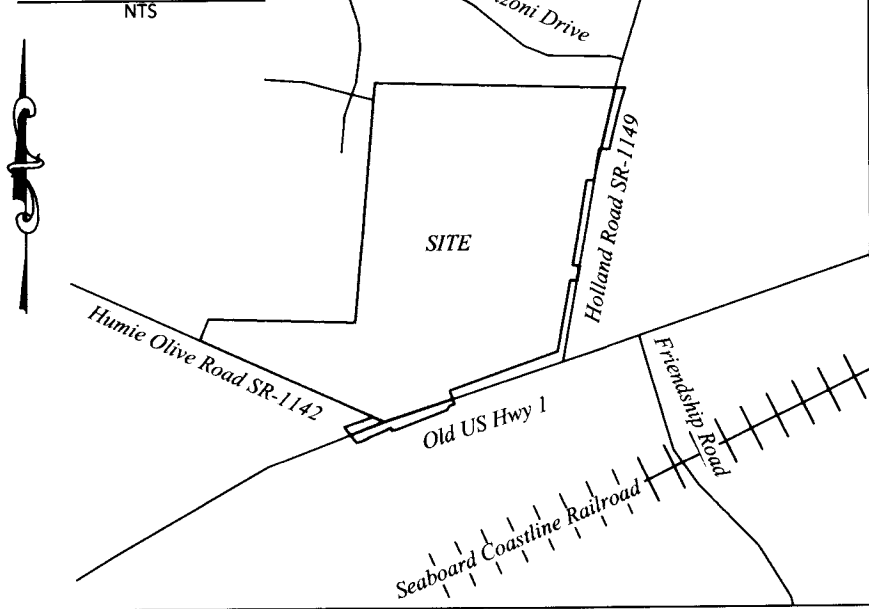

- REFERENCES:**  
 BM 1992, PG 933  
 BM 2000, PG 1931  
 BM 2005, PG 1522  
 BM 2010, PG 1132  
 BM 2013, PG 1405  
 DB 16078, PG 788  
 DB 8718, PG 1301  
 DB 8718, PG 1292  
 DB E, PG 835  
 DB 18763, PG 1063  
 DB 8718, 1304  
 DB 5746, PG 146

**Owner Information**

REID:0193211  
 Shelba W Clem, P Diane Williams & Lisa W Krummel  
 3007 Buckingham Way, Apex, NC, 27502  
 REID:0087601  
 Annie P & Billy Stroup  
 1924 Old US 1 Hwy #1S, Apex, NC, 27502  
 REID:0334537  
 RGNC-10, LLC  
 7307 NW 122nd Avenue, Parkland, FL, 33076  
 REID:0160076  
 Joanne Pendergraft Hearn Heirs (Bonnie Wood)  
 1115 Dycus Road, Sanford, NC, 27330  
 REID:0070103  
 Pamela Purefoy, Francis T Bullock & Ernestine Smith  
 3116 Holland Road, Apex, NC, 27502  
 REID:0160074  
 Johnny & Carolyn M Pendergraft  
 2212 Old US 1 Hwy#1S, Apex, NC, 27502  
 REID:0197638  
 David Ray Powell  
 861 Bethlehem Church Rd, Youngsville NC, 27596

**GENERAL NOTES**

- This survey was prepared by Bateman Civil Survey Co., under the supervision of Jeffrey W. Baker, PLS.
- Property lines shown were taken from existing field evidence, existing deeds and/or plats of public record, and information supplied to the surveyor by the client.
- No investigation into the existence of jurisdictional wetlands or riparian buffers performed by this firm.
- Surveyor has made no investigation or independent search for easements of record, encumbrances, restrictive covenants, ownership title evidence or any other facts that an accurate and current title search may disclose.
- All distances are horizontal ground distances and all bearings are North Carolina State Plane Coordinate System unless otherwise shown.
- No Grid Monuments found within 2000'.
- Areas are by coordinate computation.
- Tied to the National CORS Network through NC YRS.
- This plat is considered preliminary unless signed & sealed by a Licensed Surveyor.

CLASS OF SURVEY: D  
 POSITIONAL ACCURACY: 0.06'  
 TYPE OF GPS FIELD PROCEDURE: NC CORS NETWORK  
 DATES OF SURVEY: MAY - JULY 2021  
 DATUM/EPOCH: NAD83/NSRS2011  
 GEOID MODEL: 18  
 COMBINED GRID FACTOR(S): 0.999888420  
 UNITS: US SURVEY FEET

"I, Jeffrey W. Baker, certify that this plat was drawn under my supervision from an actual survey made under my supervision (deed description recorded in Book 16078, Pg 788, Book 8718, Pg 1301, Book 8718, Pg 1292, Book E, Pg 835, Book 18763, Pg 1063, Book 8718, Pg 1304, Book 5746, Pg 146); that the boundaries not surveyed are clearly indicated as drawn from information found in Book 1992, Pg 933, Book 2000, Pg 1931, Book 2005, Pg 1522, Book 2005, Pg 1522, Book 2013, Pg 1405; that the ratio of precision or positional accuracy as calculated is 1:10000+; that this plat was prepared in accordance with G.S. 47-30 as amended, witness my original signature, license number and seal this 14th day of August, A.D. 2023."

*Jeffrey W. Baker*  
 Professional Land Surveyor  
 License Number-4412

I, Jeffrey W. Baker, Professional Land Surveyor No. L-4412 certify That the survey is of another category, such as the recombination of existing parcels, a court-ordered survey, or other exceptions to the definition of subdivision.

*Jeffrey W. Baker* 8/14/23  
 Jeffrey W. Baker, PLS L-4412 date



Required Base Information:	
Project Information	
Name	The Summit
Address	7528 Humie Olive Road, 2236 Old US-1 Hwy, 1001, 1004, 1005 Red Cardinal Lane, 3104, 3116 Holland Road, Apex, NC
Parcel IDs	# 0720992587, #0720998487, # 0730091779, #0731001087, #0731004075, #0731003359
Owner's Information:	
Name	Shelba W Clem, P Diane Williams & Lisa W Krummel, Annie P & Billy Stroup, RGNC-10, LLC, Joanne Pendergraft Hearn Heirs, Pamela Purefoy, Francis T Bullock & Ernestine Smith, Johnny & Carolyn M Pendergraft, David Ray Powell
Address	3007 Buckingham Way, Apex, NC, 27502 1924 Old US 1 Hwy #1S, Apex, NC, 27502 7307 NW 122nd Avenue, Parkland, FL, 33076 1115 Dycus Road, Sanford, NC, 27330 3116 Holland Road, Apex, NC, 27502 2212 Old US 1 Hwy#1S, Apex, NC, 27502 861 Bethlehem Church Rd, Youngsville NC, 27596
Phone Number	(754) 875-2975 Mr. Geno Ray
E-mail Address	geno@lginvest.net
Surveyor's or Professional Engineer's Information	
Name	Jeffrey W. Baker
Seal	North Carolina
Registration	L-4412
Date Of The Survey And Plat Preparation	05/09/2023
Zoning District And Zoning Case #	21CZ14 / PUD-CZ
Annexation #	
Township, County, State	Buckhorn, Wake, North Carolina
Primary Or Secondary Watershed	Primary
FEMA Designated Floodplain?	'X' (Map 3720073000K, Date 7/19/2022) 'X' (Map 3720072000K, Date 7/19/2022) 'X' (Map 3720073100K, Date 7/19/2022) 'X' (Map 3720072100K, Date 7/19/2022)

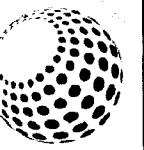

**Bateman Civil Survey Company**

Engineers • Surveyors • Planners  
 2524 Reliance Ave., Apex, NC 27539  
 Phone: 919.577.1080 Fax: 919.577.1081  
 NCBELS FIRM No. C-2378

**ANNEXATION MAP  
 For The Town of Apex**

Buckhorn Township / Wake County / Apex / North Carolina  
 REID:0193211, 0087601, 0334537, 0160076, 0070103, 0160074 & 0197638

Rev: 6/27/23  
 Drawn: JCH  
 Checked: BN  
 Scale: na  
 Date: 5/31/2023  
 Project: 210357

ANNEXATION # \_\_\_\_\_ I Allen Coleman, CMC, NCCCC, Town Clerk, Apex, North Carolina certify this is a true and exact map of annexation adopted the \_\_\_\_\_ day of \_\_\_\_\_, 20\_\_\_\_, by the Town Council. I set my hand and seal of the Town of Apex, \_\_\_\_\_ Day / Month / Year

Allen Coleman, CMC, NCCCC, Town Clerk

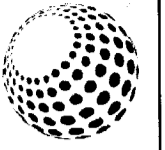

**Bateman Civil Survey Company**  
 Engineers • Surveyors • Planners  
 2524 Reliance Ave., Apex, NC 27539  
 Phone: 919.577.1080 Fax: 919.577.1081  
 NCBELS FIRM No. C-2378

**ANNEXATION MAP**  
**For The Town of Apex**  
 Buckhorn Township / Wake County / Apex / North Carolina  
 REID:0193211, 0087601, 0334537, 0160076, 0070103, 0160074 & 0197638

Rev: 8/27/23  
 Drawn: JCH  
 Checked: JWB  
 Scale: 1"=100'  
 Date: 5/31/2023  
 Project: 210357

**2 of 2**

**LEGEND**

- NAIL FOUND
- IRON PIPE/PIN FOUND
- ⊙ COMPUTED POINT
- BM BOOK OF MAPS
- DB DEED BOOK
- N/F NOW OR FORMERLY
- R/W RIGHT OF WAY
- POC POINT OF COMMENCEMENT
- POB POINT OF BEGINNING
- EIP EXISTING IRON PIPE
- ERRS EXISTING RAILROAD SPIKE
- EPK EXISTING PK NAIL
- BOUNDARY LINE
- - - EXISTING PROPERTY LINE
- - - EASEMENT LINE
- - - NEW CORPORATE LIMITS
- - - EXISTING CORPORATE LIMITS
- - - ANNEXATION AREA

Line #	Direction	Length
L1	S88°19'24"E	339.43
L2	S88°18'19"E	125.81
L3	N05°08'57"E	754.01
L4	N05°08'57"E	237.74
L5	S88°41'36"E	630.83
L6	S88°22'38"E	318.67
L7	S16°36'59"W	29.83
L8	S14°47'09"W	57.10
L9	S13°34'48"W	58.46
L10	S12°15'11"W	59.64
L11	S10°51'46"W	57.69
L12	S10°06'24"W	56.38
L13	S09°41'43"W	68.40
L14	S09°41'43"W	228.74
L15	S09°46'21"W	98.04
L16	S09°44'05"W	30.03
L17	S09°56'33"W	62.62
L18	S10°27'07"W	140.48
L19	S84°27'46"E	7.97
L20	S13°06'20"W	161.42
L21	S71°01'04"W	194.85
L22	S02°07'36"W	5.36
L23	S71°12'43"W	609.79
L24	N65°06'16"W	365.03
L25	N65°04'49"W	28.91
L26	N65°33'00"W	160.67
L27	N66°25'10"W	96.93
L28	N23°47'37"E	143.50
L29	S88°22'38"E	79.35
L30	S17°12'05"W	13.32
L31	S17°04'02"W	37.06
L32	S15°46'08"W	55.32
L33	S14°32'05"W	56.80
L34	S13°12'12"W	57.87
L35	S11°50'52"W	42.20
L36	N87°21'07"W	42.94
L37	S10°51'46"W	6.88
L38	S10°06'24"W	56.07
L39	S09°41'43"W	68.29
L40	S09°41'43"W	228.76

Line #	Direction	Length
L41	S09°46'21"W	98.06
L42	S09°44'05"W	30.07
L43	S09°56'33"W	62.67
L44	N88°20'16"W	30.36
L45	N71°12'43"E	334.46
L46	S18°47'17"E	59.54
L47	S71°11'06"W	22.49
L48	S29°47'22"W	20.05
L49	S66°51'41"W	105.25
L50	S70°21'31"W	117.65
L51	S79°37'28"W	20.87
L52	N19°02'39"W	12.99
L53	N57°40'59"W	85.44

**Adjoinder Information**

A) Bella Casa Homeowners Association Inc  
 PIN: 0721909863, REID: 0439538  
 DB 16826, Pg 2506, BM 2016, Pg 1360  
 Zoned: MD-CZ, Use: Common Area

B) Bella Casa Homeowners Association Inc  
 PIN: 0731000924, REID: 0427371  
 DB 16255, Pg 912, BM 2015, Pg 129  
 Zoned: MD-CZ, Use: Common Area

C) Marc Chadwick  
 PIN: 0731001666, REID: 0427359  
 DB 17636, Pg 965, BM 2015, Pg 129  
 Zoned: MD-CZ, Use: Single Family

D) Thomas C & Jodi L Clark  
 PIN: 0731003635, REID: 0427358  
 DB 16386, Pg 2162, BM 2015, Pg 129  
 Zoned: MD-CZ, Use: Single Family

E) James D & Clyde L Evans  
 PIN: 0731005747, REID: 0021100  
 DB 3265, Pg 761  
 Zoned: RR, Use: Single Family

F) Roman Catholic Diocese of Raleigh LLC  
 PIN: 0731006698, REID: 0191290  
 DB 13301, Pg 659, BM 2008, Pg 2094  
 Zoned: RR, Use: Vacant

G) Roman Catholic Diocese of Raleigh LLC  
 PIN: 0731101525, REID: 0379146  
 DB 13301, Pg 659, BM 2012, Pg 830  
 Zoned: RR, Use: Church

H) Western Wake Bible Chapel  
 PIN: 0731009204, REID: 0145652  
 DB 17026, Pg 2586, BM 1981, Pg 154  
 Zoned: RR, Use: Vacant

**Adjoinder Information**

H) Western Wake Bible Chapel  
 PIN: 0731009204, REID: 0145652  
 DB 17026, Pg 2586, BM 1981, Pg 154  
 Zoned: RR, Use: Vacant

I) Joyce Kelly  
 PIN: 0730093122, REID: 0049223  
 DB 1769, Pg E  
 Zoned: RR, Use: Single Family

J) Miller Land Group LLC  
 PIN: 0720999210, REID: 0087305  
 DB 17412, Pg 99  
 Zoned: B1, Use: Business

K) Downtown Friendship LCC  
 PIN: 0720988948, REID: 0031759  
 DB 18566, Pg 168  
 Zoned: TF-CZ, Use: Vacant

L) Downtown Friendship LCC  
 PIN: 0720985958, REID: 0067365  
 DB 18877, Pg 2622  
 Zoned: MORR-CZ, Use: Single Family

M) David Ray Powell  
 PIN: 0720993254, REID: 0071500  
 DB 5746, Pg 146  
 Zoned: RR, Use: Vacant

**Owner Information**

REID:0193211  
 Shelba W Clem, P Diane Williams & Lisa W Krummel  
 3007 Buckingham Way, Apex, NC, 27502  
 REID:0087601  
 Annie P & Billy Stroup  
 1924 Old US 1 Hwy #1S, Apex, NC, 27502  
 REID:0334537  
 RGNC-10, LLC  
 7307 NW 122nd Avenue, Parkland, FL, 33076  
 REID:0160076  
 Joanne Pendergraft Hearn Heirs (Bonnie Wood)  
 1115 Dycus Road, Sanford, NC, 27330  
 REID:0070103  
 Pamela Purefoy, Francis T Bullock & Emistine Smith  
 3116 Holland Road, Apex, NC, 27502  
 REID:0160074  
 Johnny & Carolyn M Pendergraft  
 2212 Old US 1 Hwy #1S, Apex, NC, 27502  
 REID:0197638  
 David Ray Powell  
 861 Bethlehem Church Rd, Youngsville NC, 27596

N/F  
 Shelba W Clem,  
 Diane P Williams &  
 Lisa W Krummel  
 PIN: 0720992587  
 REID: 0193211  
 DB 16078, Pg 788  
 BM 1992, Pg 933  
 Zoning: PUD-CZ  
 Use: Single Family

N/F  
 David R Powell  
 PIN: 0720998487  
 REID: 0197638  
 DB 5746, Pg 146  
 BM 2013, Pg 1405  
 Zoning: PUD-CZ  
 Use: Single Family

N/F  
 NDJ Ventures LLC  
 PIN: 0720993901  
 REID: 0296869  
 DB 15713, Pg 1486  
 BM 2021, Pg 794  
 Zoning: RR  
 Use: Vacant

N/F  
 Elizabeth G &  
 Elizabeth R Clark  
 PIN: 0721902492  
 REID: 0296870  
 DB 16788, Pg 681  
 Zoning: RR  
 Use: Vacant

N/F  
 Terry G & Tina L Withoutukas  
 PIN: 0721907619  
 REID: 0439529  
 DB 17010, Pg 2455  
 BM 2016, Pg 1360  
 Zoning: MD-CZ  
 Use: Vacant

N/F  
 Daniel R & Ellen R Griffin  
 PIN: 0721908740  
 REID: 0439528  
 DB 16994, Pg 472  
 BM 2016, Pg 1360  
 Zoning: MD-CZ  
 Use: Vacant

N/F  
 Joann Hearn  
 Pendergraft Heirs  
 Pendergraft  
 PIN: 0731001087  
 REID: 0160076  
 DB 16-E, Pg 835  
 BM 2005, Pg 1522  
 Zoning: PUD-CZ  
 Use: Single Family

N/F  
 Johnny & Carolyn  
 Pendergraft  
 PIN: 0730091779  
 REID: 0160074  
 DB 8718, Pg 1292  
 BM 2000, Pg 1931  
 Zoning: PUD-CZ  
 Use: Single Family

N/F  
 RGNC-10 LLC  
 PIN: 0731004075  
 REID: 0334537  
 DB 18763, Pg 1063  
 BM 2005, Pg 1522  
 Zoning: PUD-CZ  
 Use: Vacant

N/F  
 Pamela Purefoy &  
 Frances T Bullock  
 PIN: 0730095707  
 REID: 0070103  
 DB 8718, Pg 1304  
 BM 2000, Pg 1931  
 Zoning: PUD-CZ  
 Use: Single Family

N/F  
 David R Powell  
 PIN: 0720998487  
 REID: 0197638  
 DB 5746, Pg 146  
 BM 2013, Pg 1405  
 Zoning: PUD-CZ  
 Use: Single Family

N/F  
 David R Powell  
 PIN: 0720998487  
 REID: 0197638  
 DB 5746, Pg 146  
 BM 2013, Pg 1405  
 Zoning: PUD-CZ  
 Use: Single Family

N/F  
 David R Powell  
 PIN: 0720998487  
 REID: 0197638  
 DB 5746, Pg 146  
 BM 2013, Pg 1405  
 Zoning: PUD-CZ  
 Use: Single Family

N/F  
 Joann Hearn  
 Pendergraft Heirs  
 Pendergraft  
 PIN: 0731001087  
 REID: 0160076  
 DB 16-E, Pg 835  
 BM 2005, Pg 1522  
 Zoning: PUD-CZ  
 Use: Single Family

N/F  
 RGNC-10 LLC  
 PIN: 0731004075  
 REID: 0334537  
 DB 18763, Pg 1063  
 BM 2005, Pg 1522  
 Zoning: PUD-CZ  
 Use: Vacant

N/F  
 Pamela Purefoy &  
 Frances T Bullock  
 PIN: 0730095707  
 REID: 0070103  
 DB 8718, Pg 1304  
 BM 2000, Pg 1931  
 Zoning: PUD-CZ  
 Use: Single Family

N/F  
 David R Powell  
 PIN: 0720998487  
 REID: 0197638  
 DB 5746, Pg 146  
 BM 2013, Pg 1405  
 Zoning: PUD-CZ  
 Use: Single Family

N/F  
 David R Powell  
 PIN: 0720998487  
 REID: 0197638  
 DB 5746, Pg 146  
 BM 2013, Pg 1405  
 Zoning: PUD-CZ  
 Use: Single Family

N/F  
 David R Powell  
 PIN: 0720998487  
 REID: 0197638  
 DB 5746, Pg 146  
 BM 2013, Pg 1405  
 Zoning: PUD-CZ  
 Use: Single Family

N/F  
 Joann Hearn  
 Pendergraft Heirs  
 Pendergraft  
 PIN: 0731001087  
 REID: 0160076  
 DB 16-E, Pg 835  
 BM 2005, Pg 1522  
 Zoning: PUD-CZ  
 Use: Single Family

N/F  
 RGNC-10 LLC  
 PIN: 0731004075  
 REID: 0334537  
 DB 18763, Pg 1063  
 BM 2005, Pg 1522  
 Zoning: PUD-CZ  
 Use: Vacant

N/F  
 Pamela Purefoy &  
 Frances T Bullock  
 PIN: 0730095707  
 REID: 0070103  
 DB 8718, Pg 1304  
 BM 2000, Pg 1931  
 Zoning: PUD-CZ  
 Use: Single Family

N/F  
 David R Powell  
 PIN: 0720998487  
 REID: 0197638  
 DB 5746, Pg 146  
 BM 2013, Pg 1405  
 Zoning: PUD-CZ  
 Use: Single Family

N/F  
 David R Powell  
 PIN: 0720998487  
 REID: 0197638  
 DB 5746, Pg 146  
 BM 2013, Pg 1405  
 Zoning: PUD-CZ  
 Use: Single Family

N/F  
 David R Powell  
 PIN: 0720998487  
 REID: 0197638  
 DB 5746, Pg 146  
 BM 2013, Pg 1405  
 Zoning: PUD-CZ  
 Use: Single Family

