

City Hall Annex

 NEW PARTITION AND ASSOCIATED COMPONENTS

2 FLOOR PLAN LEGEND
1/4" = 1'-0"

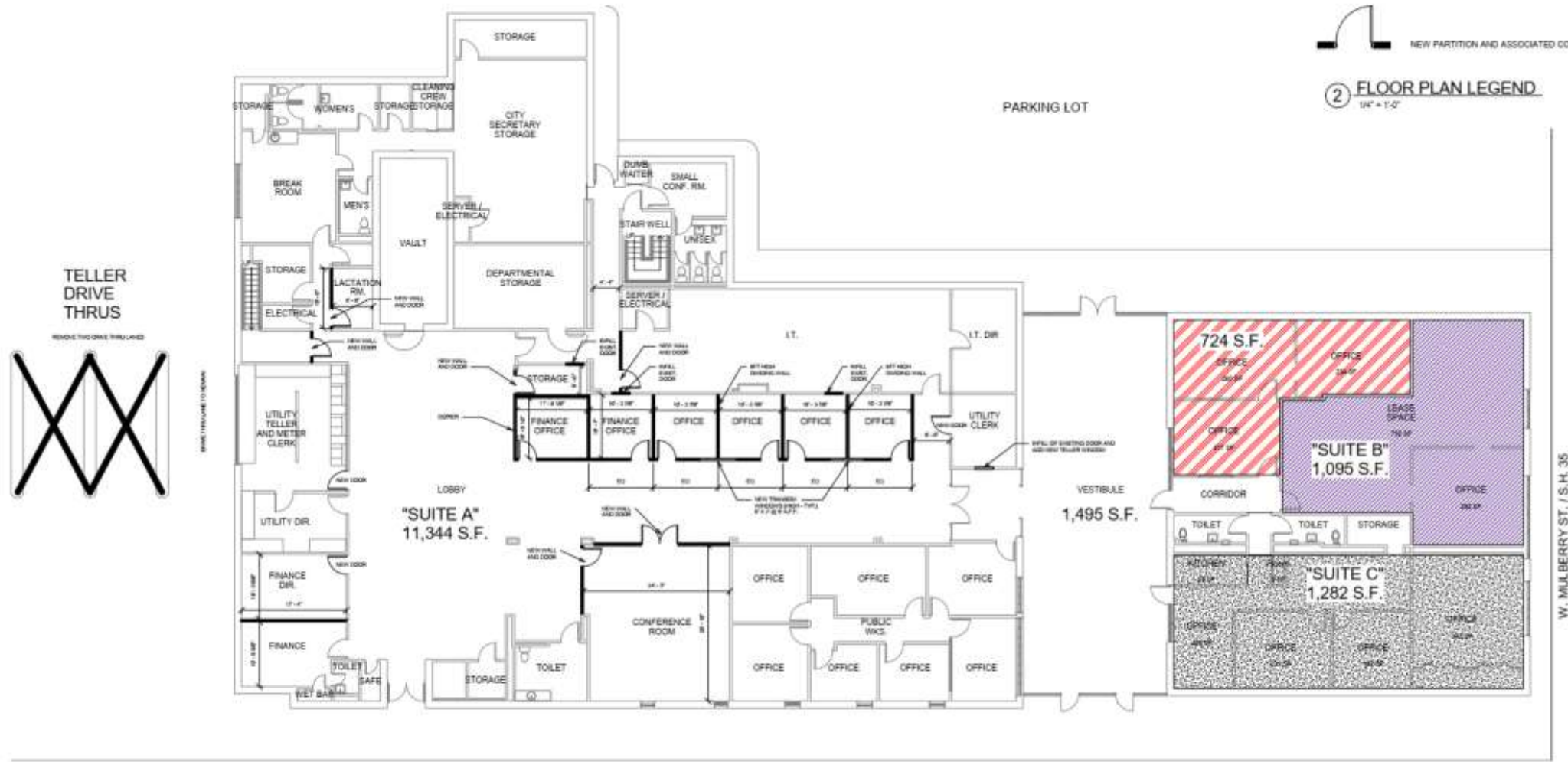

1 CONCEPTUAL FLOOR PLAN
1/8" = 1'-0"

ANGELTON CITY HALL ANNEX
CONCEPTUAL FLOOR PLAN



01/18/2024



Lease Side

Lease Side Remodel

	Price	Funded	Bids	HUB	CO-OP	Notes
Roof repair- leaks	\$ 3,150	Y	Y	N	Y	Local
Mold remediation	\$ 12,261	Y	Y	N/A	Y	HUB's were contact and submitted
Fire extinguishers lease side	\$ 601	Y	N	N/A	N/A	Local
Exterior wall paint and patch	\$ 16,756	Y	Y	N/A	N	
Mold testing	\$ 2,400	Y	N/A	N/A	N/A	
Asbestos testing	\$ 2,310	Y	N/A	N/A	N/A	
Lease side (C) LED lights and smoke alarms	\$ 4,282	Y	Y	N	N	Local
Lease side (B) LED light	\$ 2,682	Y	Y	N	N	Local
Power Survey	\$ 433	Y	N/A	N/A	N/A	
Window wraps lease side (C)	\$ 780	Y	N/A	N/A	N/A	Local
Window wraps lease side (B)	\$ 910	Y	N/A	N/A	N/A	Local
Lease outdoor signage	\$ 8,995	Y	Y	N	N	Local
Lease side build out	\$ 44,006	Y	Y	N	Y	HUB's were contact and submitted
Total	\$ 99,565					



City Side

Funded by Annual Facility Budget

	Price	Funded	Bids	HUB	CO-OP	Notes
LED lights exterior	\$ 5,690	Y	Y	N	N	Local
Ceiling tile replacement	\$ 1,700	Y	N/A	N/A	N/A	In-House
Fire extinguishers City side	\$ 1,800	Y	N/A	N/A	N/A	local
After construction Cleaning	\$ 1,988	Y	N/A	Y	N	Citys current cleaning company
Parking lot stripping /parking stop	\$ 2,254	Y	Y	N	N	Local
Exterior concrete work	\$ 2,500	Y	Y	N	N	Local
Window tinting	\$ 1,171	Y	Y	N	N	Local
Conference table/furniture	\$ 4,500	Y	N/A	N/A	N/A	
Signage - interior	\$ 600	Y	N/A	N/A	N/A	
Doors and locks	\$ 1,300	Y	N/A	N/A	N/A	
Shelving	\$ 1,200	Y	N/A	N/A	N/A	
Total	\$ 24,702					

Funding for City Side Remodel

	Price	Funded	Bids	HUB	CO-OP	Notes
Power to Annex	\$ 85,593	Y	Y	N	Y	HUB's were contact and submitted
City side remodel	\$ 274,447		Y	N	Y	HUB's were contact and submitted
Fire detection	\$ 45,465		Y	N	Y	.
Fire suppression						
LED lights Interior City side	\$ 24,445		Y	N	N	Local
IT	\$ 76,057					In-House
City signage	\$ 17,950		Y	N	N	HUB's were contact and submitted
Electronics- printer contract	\$ 250					
Atrium painting	\$ 6,000		Y	N	N	HUB's were contact and submitted
AC						Unknown Electric
Electrical work - City side general						
Total	\$ 444,615					
Roof	\$ 134,850		Y	N	Y	needed for wind insurance