

CERTIFICATE OF SURVEYOR
 I, Karl F. Scherbel, of Alton, Wyoming, hereby certify that this map was made from notes taken during an actual survey made by me and by persons under my supervision during February 2026 and from reports in this office of the surveyors and other persons employed by me in this survey. I am a duly Licensed Professional Surveyor in the State of Wyoming and the above represents that survey and those records.

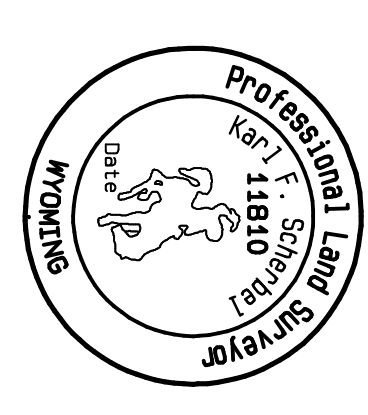

- LEGEND**
- Indicates 9/5/8" steel reinforcing rod with an aluminum cap inscribed "PLS 6447", found.
 - ⊗ Indicates a calculated position, no monument found or set.
 - ⊕ Indicates a fire hydrant.
 - ⊞ Indicates a telecommunication junction box.
 - ⊠ Indicates an electrical junction box.
 - ⊡ Indicates a plotted lot line of record.
 - Indicates an easement line.
 - Indicates a right-of-way line.
 - Indicates a culinary water line.
 - Indicates a sanitary sewer line.
 - Indicates a building setback line.
 - Indicates edge of traveled surface.

IMPERVIOUS AREA
 Total Impervious area: 3718 sq ft
 Total lot area: 17869 sq ft
 Percent Impervious: 21%

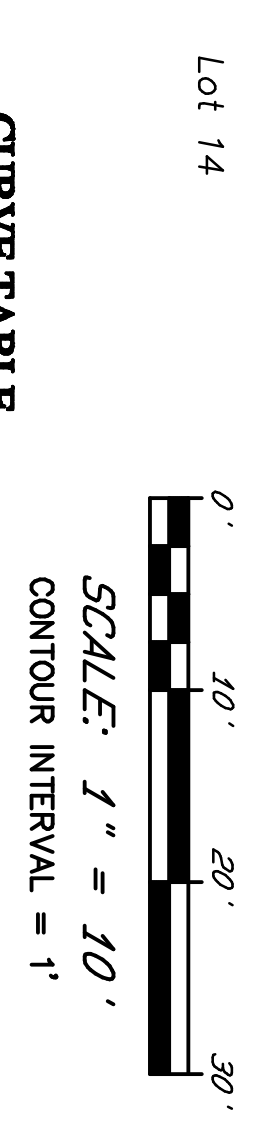
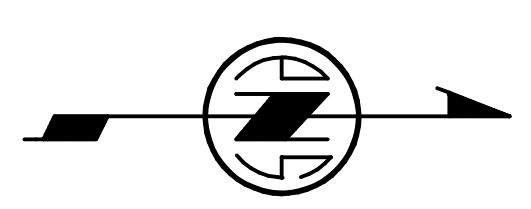

CURVE TABLE

CURVE	LENGTH	DELTA	RADIUS	CHORD BEARING	CHORD	TANGENT
C1	97.71	31°59'28"	173.00'	S47°21'33"E	98.45'	50.16'
C2	70.95	28°02'08"	145.00'	S49°46'12"E	70.24'	38.20'
C3	10.01	35°17'13"	145.00'	S53°46'50"E	10.01'	5.01'

**ADVANCE PLAT -
 SUBJECT TO CORRECTION
 AND APPROVAL**

**SITE PLAN
 FOR
 G & A CONSTRUCTION, LLC
 OF
 ALPINE MEADOWS LOT 79
 WITHIN THE INCORPORATED LIMITS
 OF THE TOWN OF ALPINE
 LINCOLN COUNTY, WYOMING**

SURVEYOR SCHERBEL, LTD.
 PROFESSIONAL LAND SURVEYORS

DATE: 12 February 2026
 DRAWN BY: Karl F. Scherbel
 CALCULATED BY: Karl F. Scherbel
 CHECKED BY: Ryan Stegeman
 FIELD BOOK: _____
 DRAWING FILE: ALPINE/79/2026

POY 90, 916, 917, 918, 919, 920, 921, 922, 923, 924, 925, 926, 927, 928, 929, 930, 931, 932, 933, 934, 935, 936, 937, 938, 939, 940, 941, 942, 943, 944, 945, 946, 947, 948, 949, 950, 951, 952, 953, 954, 955, 956, 957, 958, 959, 960, 961, 962, 963, 964, 965, 966, 967, 968, 969, 970, 971, 972, 973, 974, 975, 976, 977, 978, 979, 980, 981, 982, 983, 984, 985, 986, 987, 988, 989, 990, 991, 992, 993, 994, 995, 996, 997, 998, 999, 1000

2120/2026-SSLD
 287702026